

1:35 SCALE

Faun SLT-56 Tank Transporter

ITEM NO.00203

德國56噸坦克運輸車



READ BEFORE ASSEMBLY

- Study and understand this instructions thoroughly before beginning assembly.
- Remove all injection pins carefully using a modeling file.
- Cut off the photo-etched parts carefully using a modeling knife. Be sure not to lose small parts.
- Apply instant cement to photo etched parts and shafts. Apply too much instant cement will cause movable parts to stick. Apply cement carefully.
- Extra care should be taken to avoid personal injury when handling the photo etched parts.
- Some parts should depend on decals. Select prior to assembly.
- Tools recommended: (Not included in this kit)
- Cement; Side cutters; Long nose pliers; Modeling knife; Modeling life; Tweezers; Pin vise; Scissors; Instant cement.
- Soft cloth and sand paper will also assist in construction.
- Glue and paints are not included in the kit. Use plastic cement or paints only.
- Keep out of reach of small children. Children must not be allowed to suck any part, or pull vinyl bag over the head.

装配之前仔细阅读

- 小心用模型锉刀锉平所有零件表面的注射浇口。
- 小心用刀片切下蚀刻片零件，不要遗失小零件。
- 用强力快干胶水粘合蚀刻片零件和金属轴。过量的快干胶水使用可能导致可动零件会粘住，小心涂胶。
- 取蚀刻片时应特别注意安全，防止利边划伤手指。
- 某些零件表面需贴上水贴纸，请选择在装配的同时进行。
- 推荐模型工具(自备)：胶水，水口剪刀，长咀钳，刀片，锉刀，镊子钳，钻，剪刀，瞬间快干胶。
- 软布同砂纸同时也应该是必备工具。
- 请使用塑料胶水和油漆，模型内不含。
- 谨防小孩吸吮塑料零件，或者将塑料袋套在头上，制作时应将套材远离小孩接触。

水贴纸的使用：

1. 从水贴上剪下印花；
2. 将印花放入温水中浸10秒，然后放在干净布上。
3. 拿着印花纸板将印花移到模型上；
4. 手指蘸水将印花移到适当的位置；
5. 用软布轻压印花直至水干，气泡消失。

DECAL APPLICATION

1. Cut off decal from sheet.
2. Dip the decal in tepid water 40° C for about 10 sec. and place on a clean cloth.
3. Hold the backing sheet edge and slide decal onto the model.
4. Move decal into position by wetting decal with finger.
5. Press decal gently down with a soft cloth until excess water and air bubbles are gone.

部品图 Parts

A

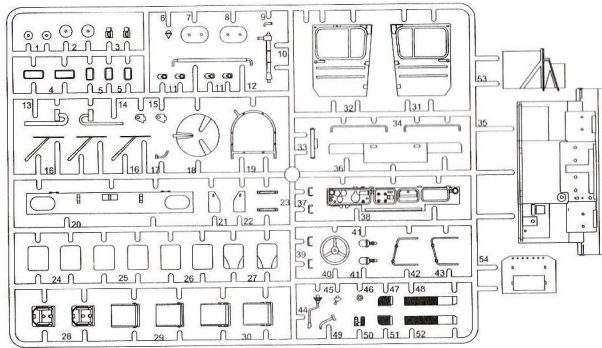

B

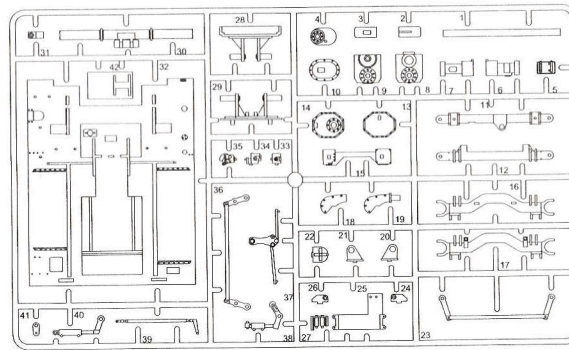

G

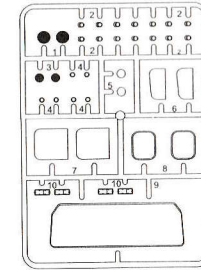

《蚀刻片》
Photo etched part(PE)

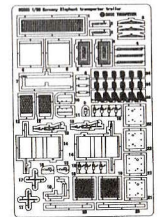

C1×2

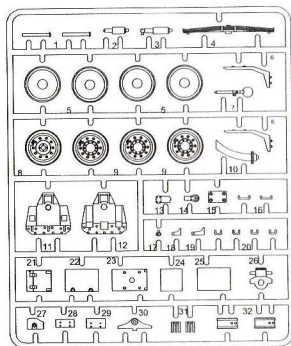

C2×2

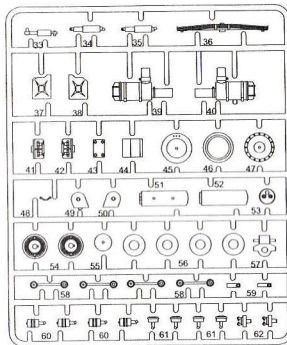

D

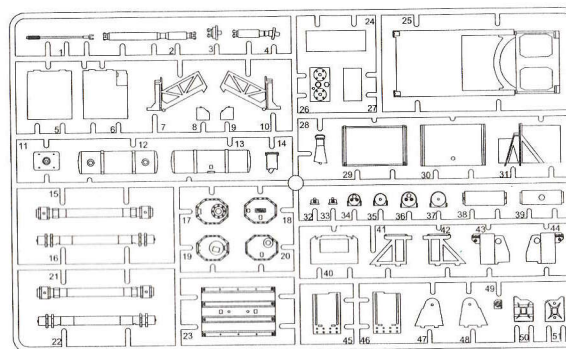

J×2

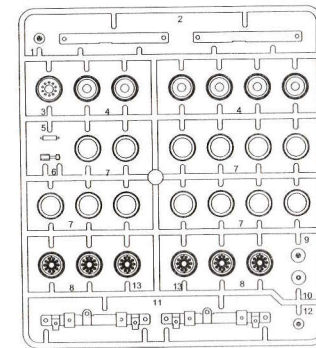

K

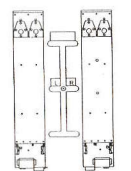

E

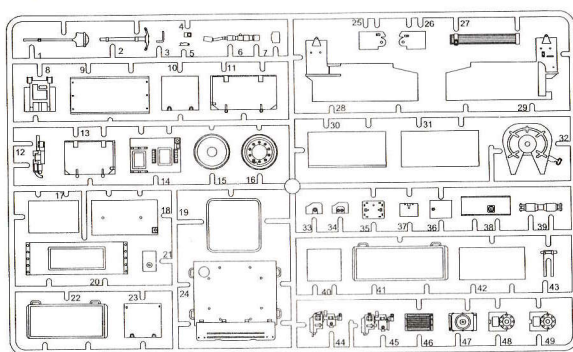

F

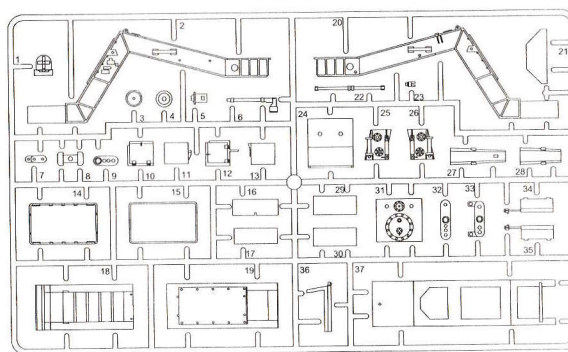

《平板》
Deck

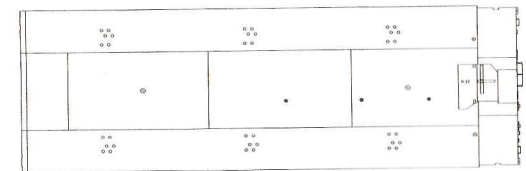

《驾驶室》
Cab

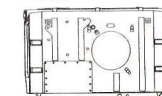

《轮胎(大)》
Tyre(big)



《轮胎(小)》
Tyre(small)



X9

X26

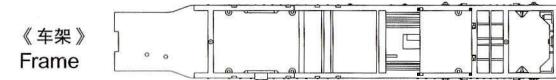
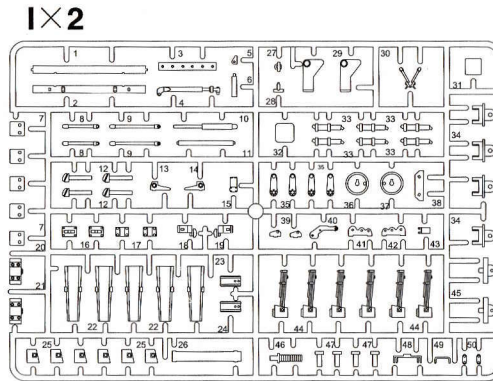
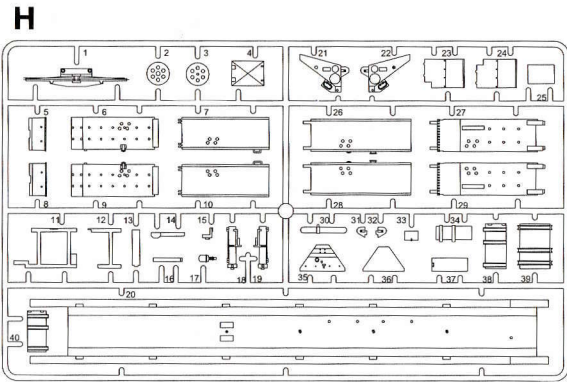

《金属轴》×2
Metal shaft × 2
φ 2.5 × 73mm

《金属轴》×2
Metal shaft × 2
φ 2.0 × 75mm



《棉绳》
Rope

《胶管》
Hose



file / sand
锉平



option
选择



no cement
不涂胶水



decal
贴纸



cyanoacrylate glue
使用强力胶



weight
配重



make hole
钻孔



cut / remove
切除



bend
弯曲

牵引车组装说明

TRACTOR Assembly instructions

1 透明窗的安装 Transparent window assembly

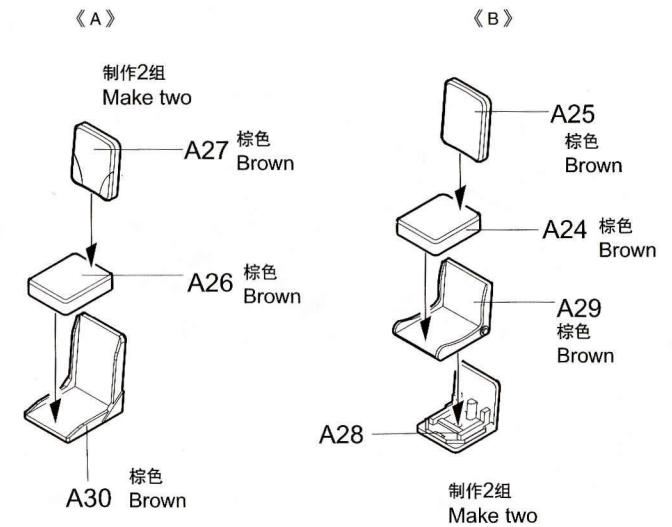
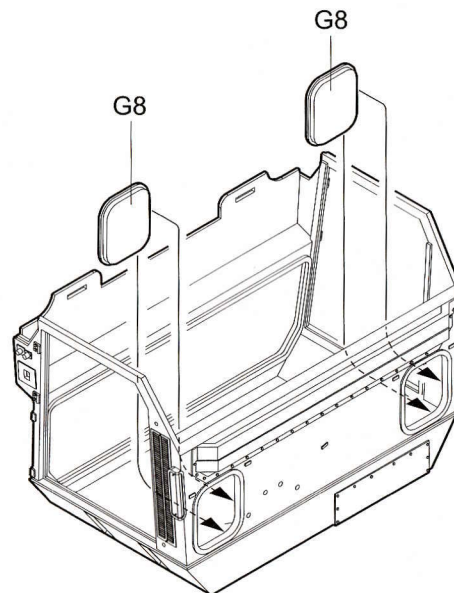
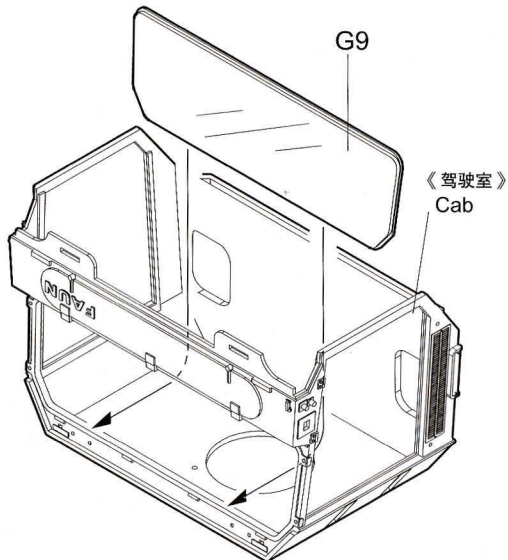

2 底盘的组装
Chassis assembly

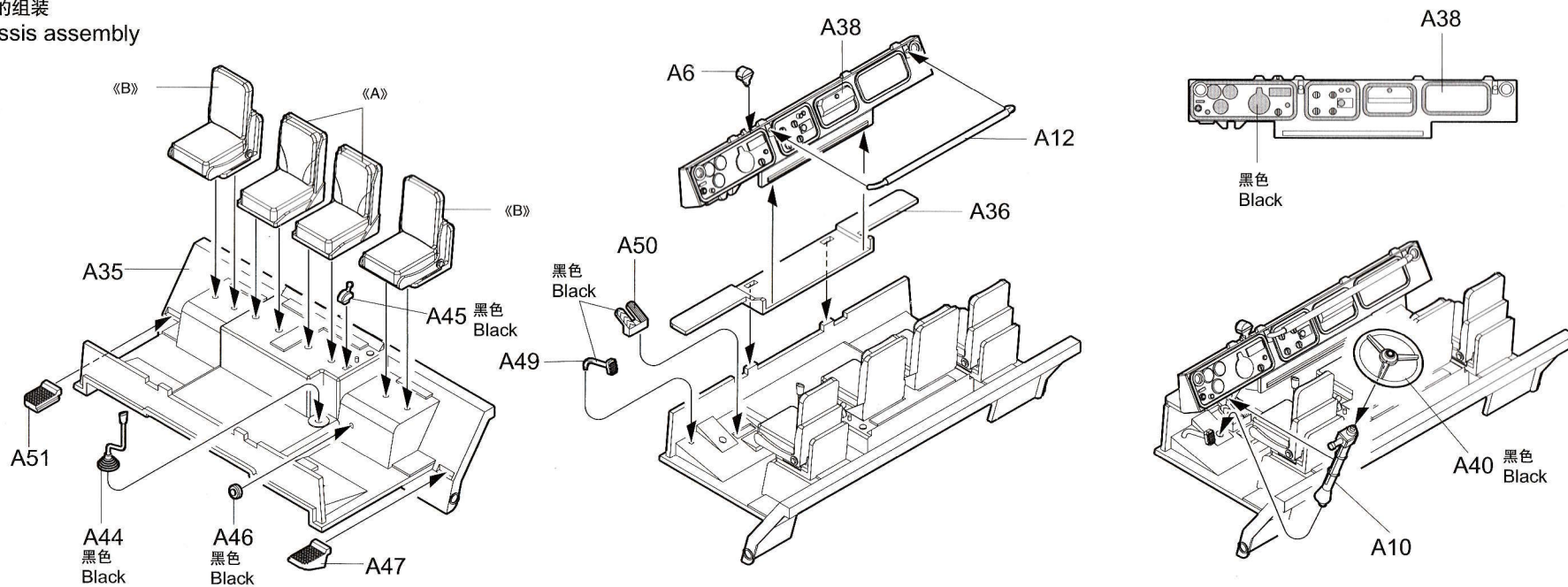

3 驾驶室的组装
Inner cab assembly

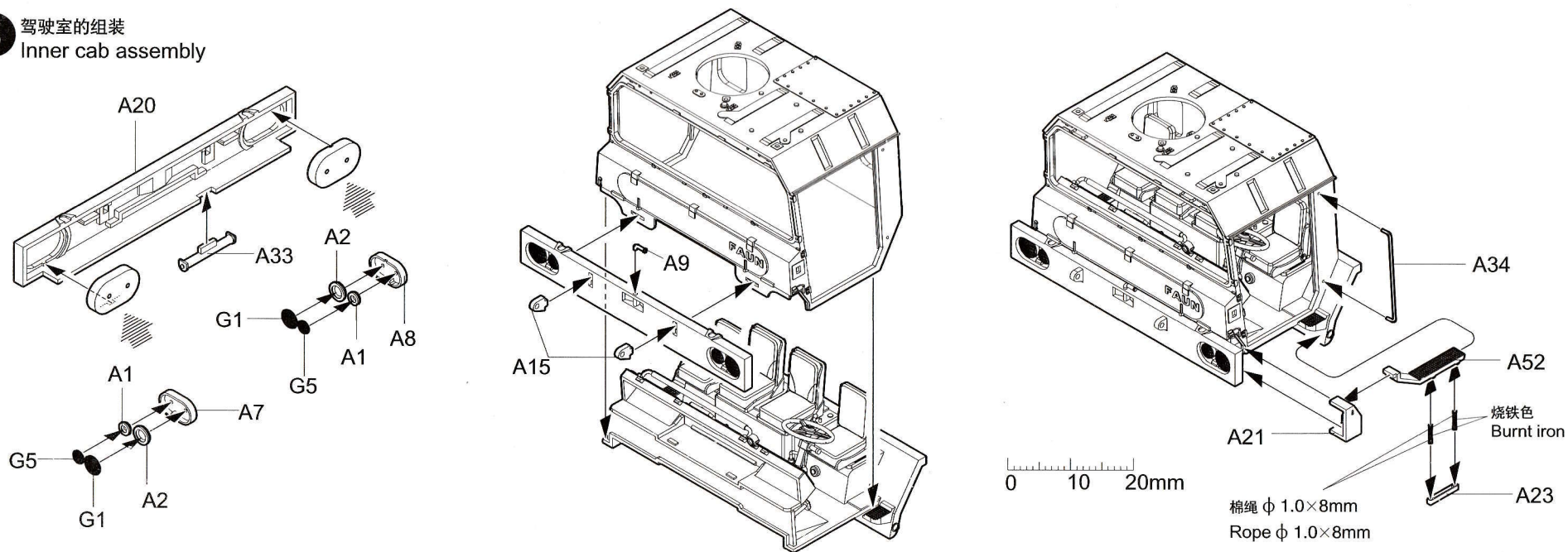

4 驾驶室的组装
Inner cab assembly

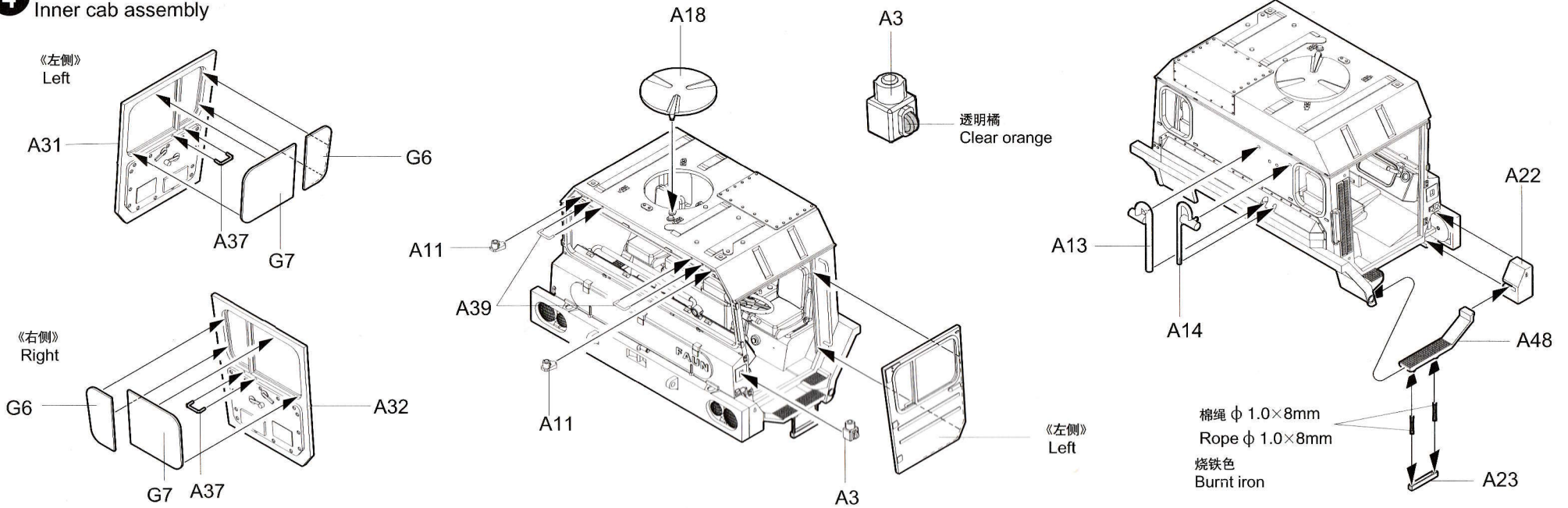

5 驾驶室的组装
Inner cab assembly

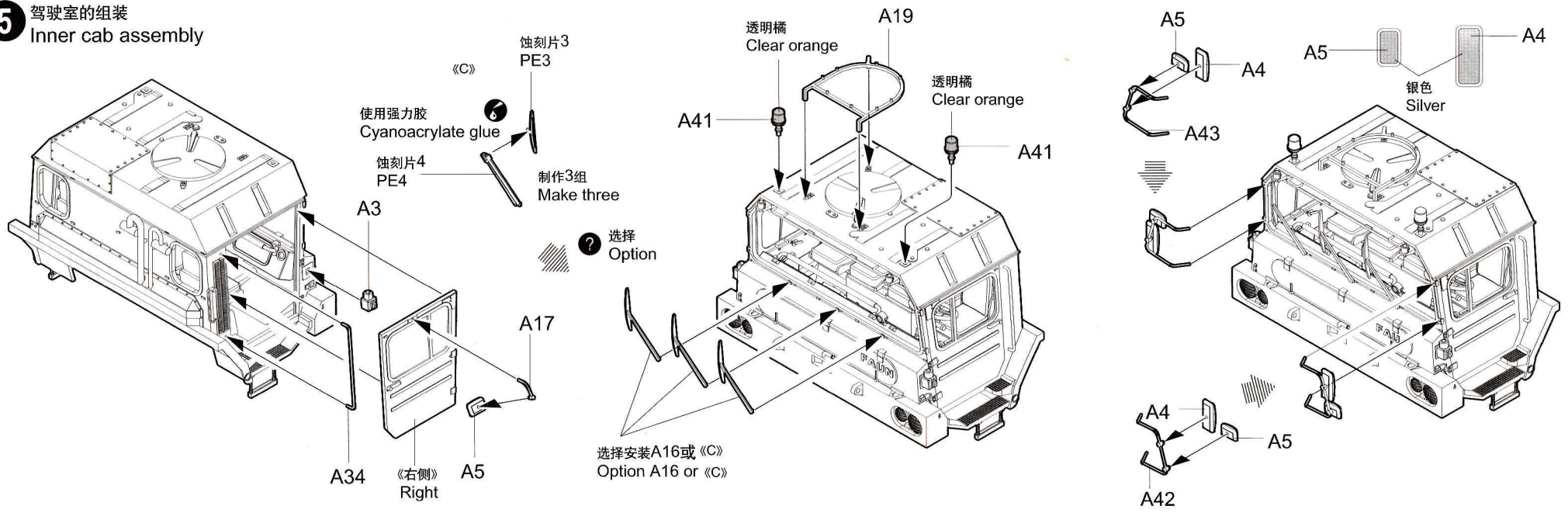

6 车架的组装
Frame assembly

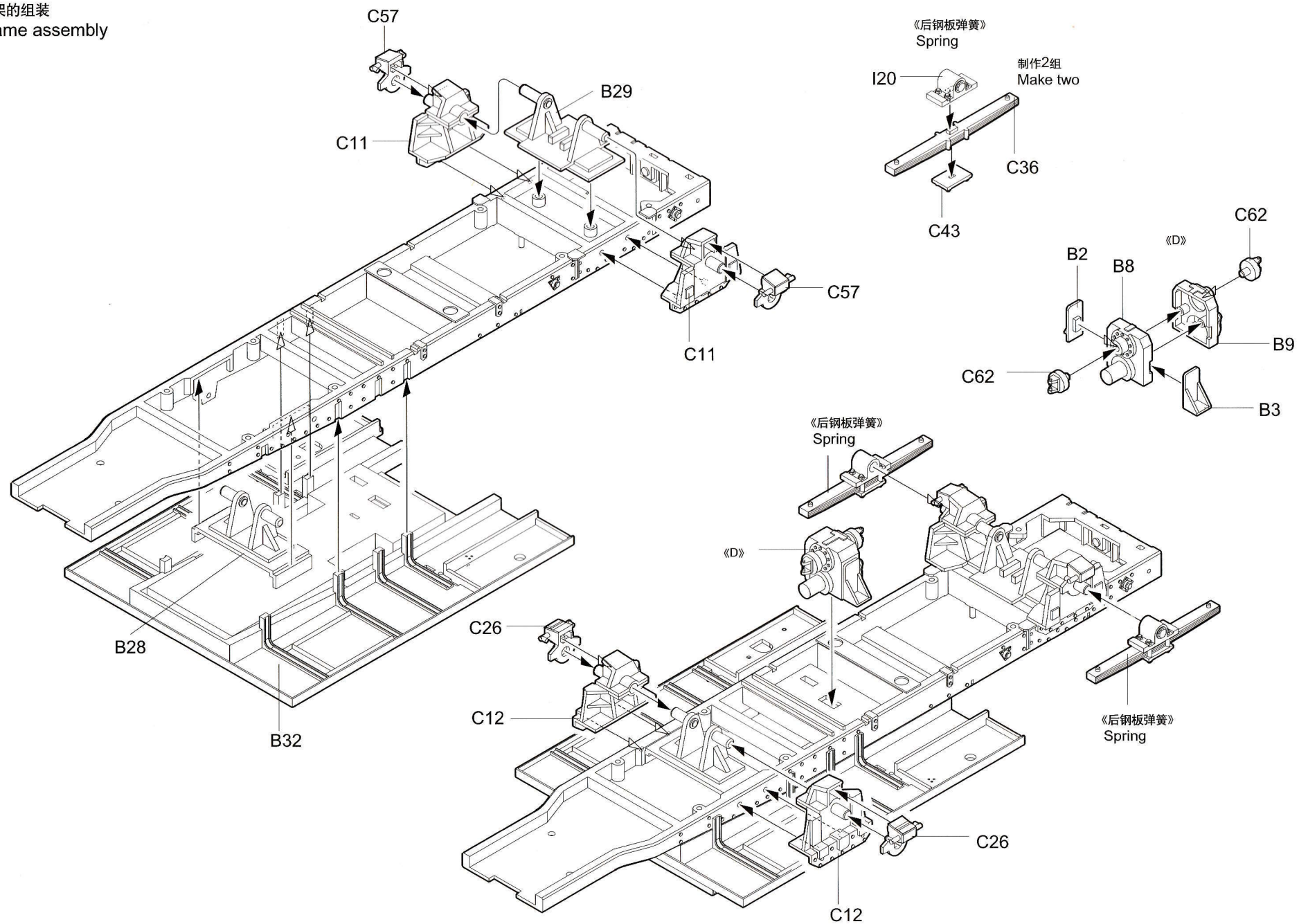

7 后桥安装
Attaching rear axles

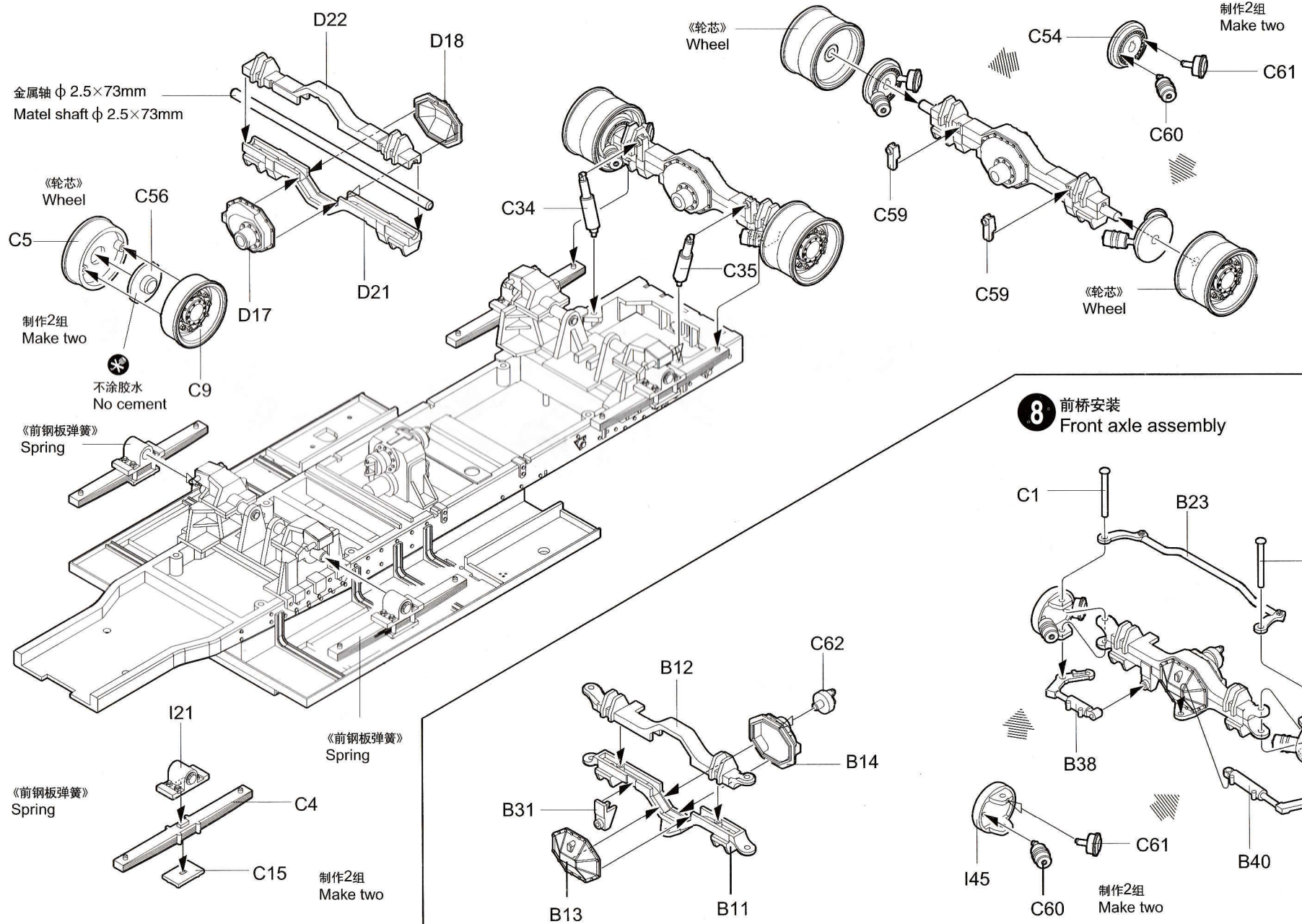

8 前桥安装
Front axle assembly

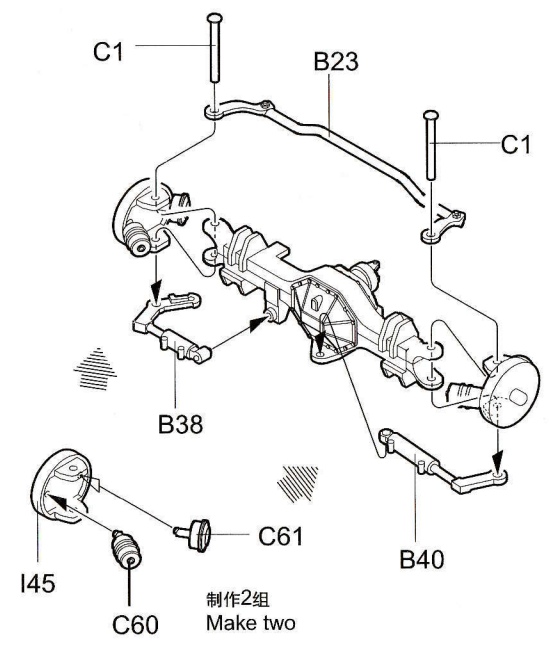

10 中桥安装
Attaching center axles

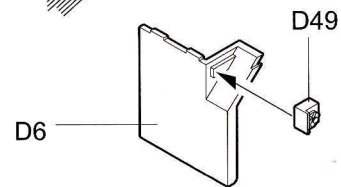
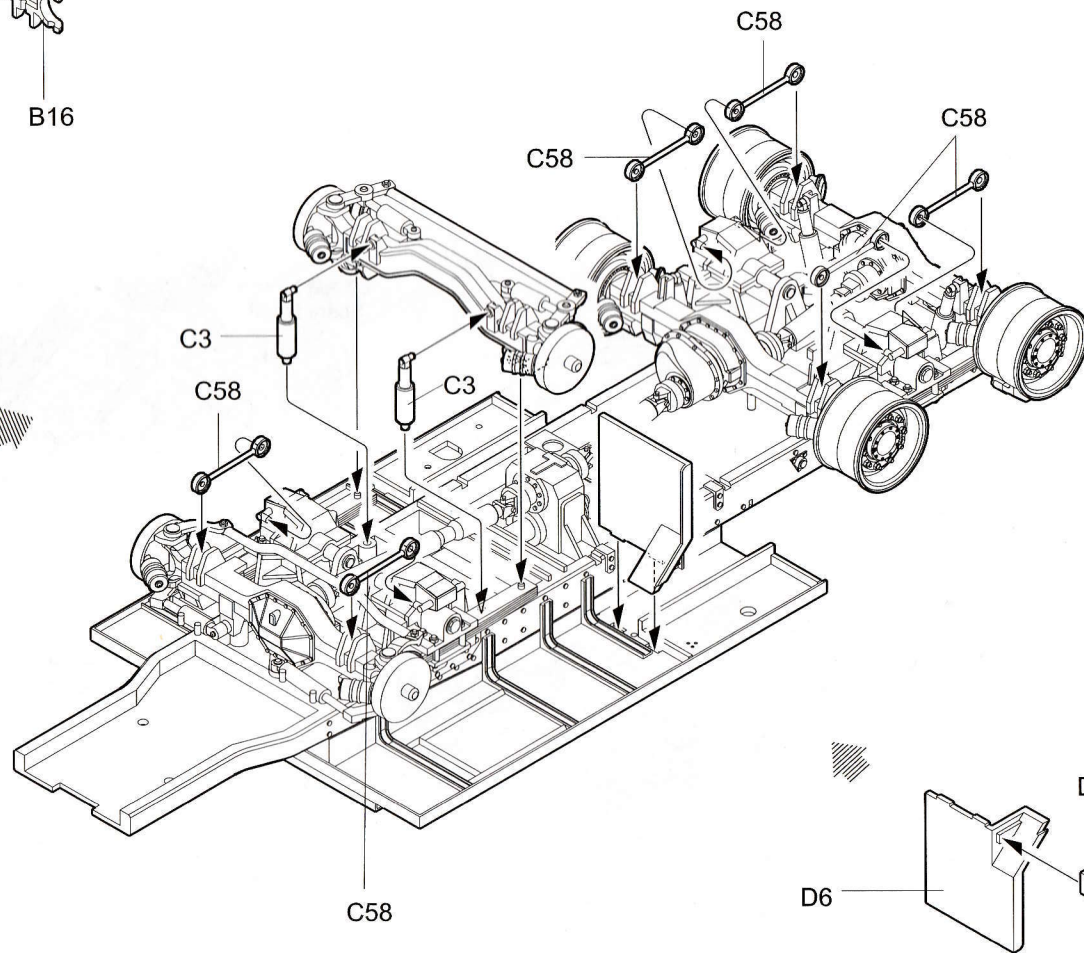
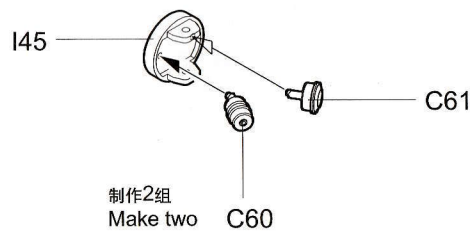
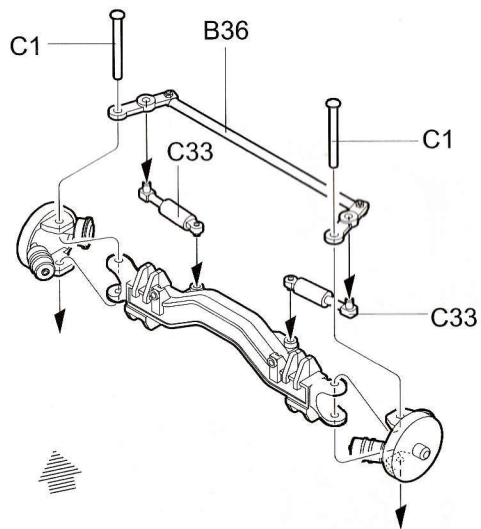
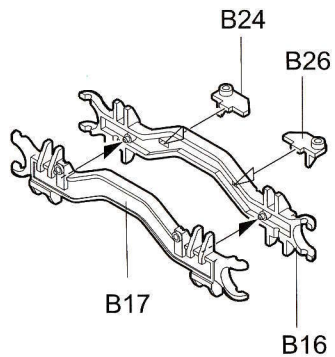

11 备用胎安装
Attaching spare tire

《备用胎》
Spare tire

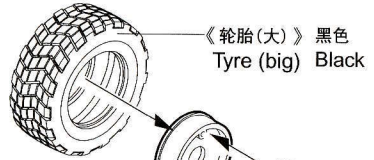

E15
E16

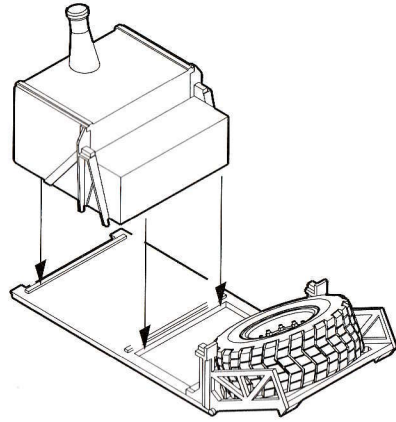

《备用胎》
Spare tire

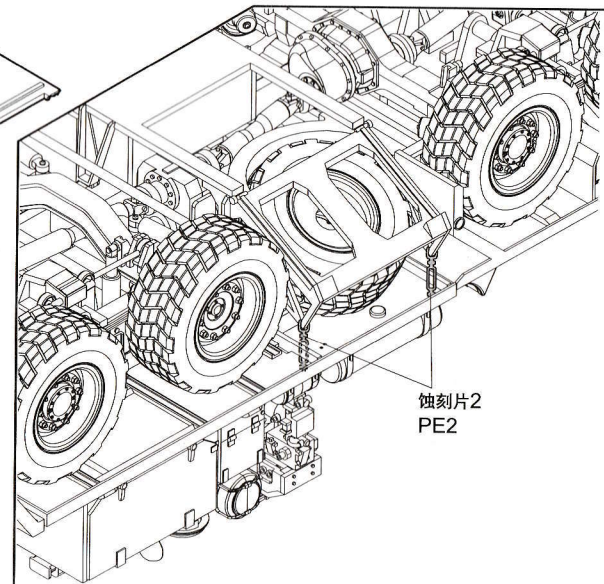
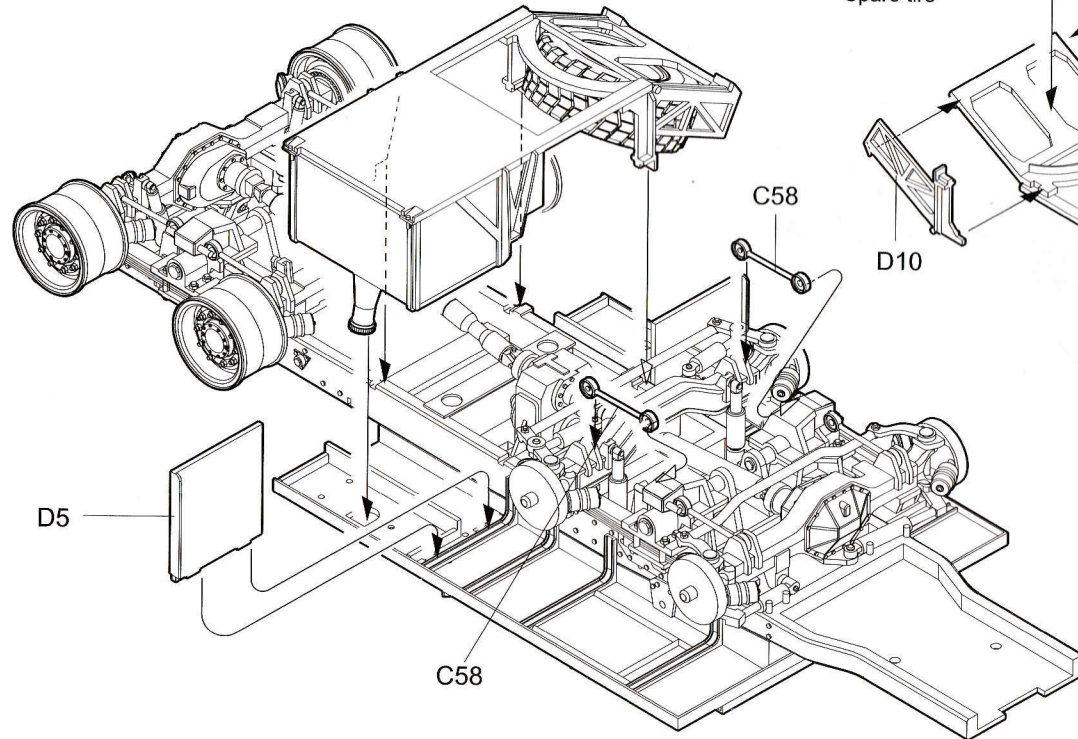
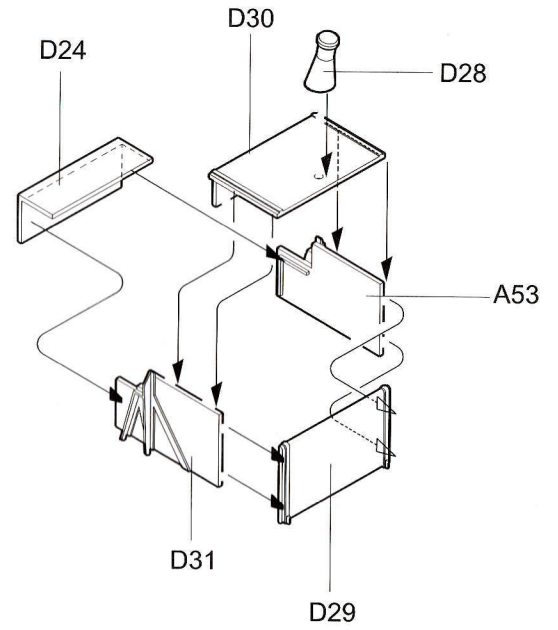
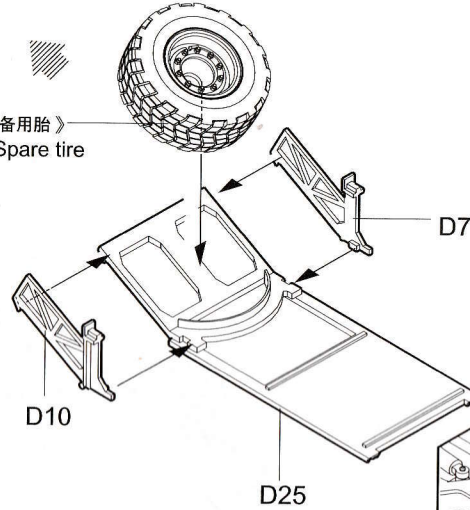

12 驾驶室安装
Attaching cab

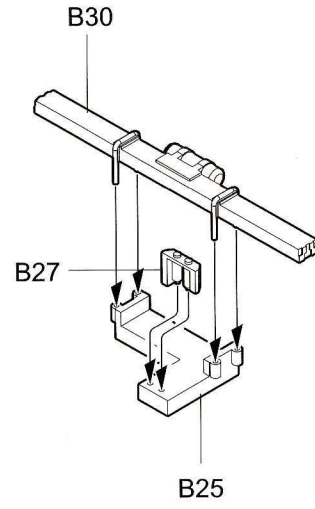
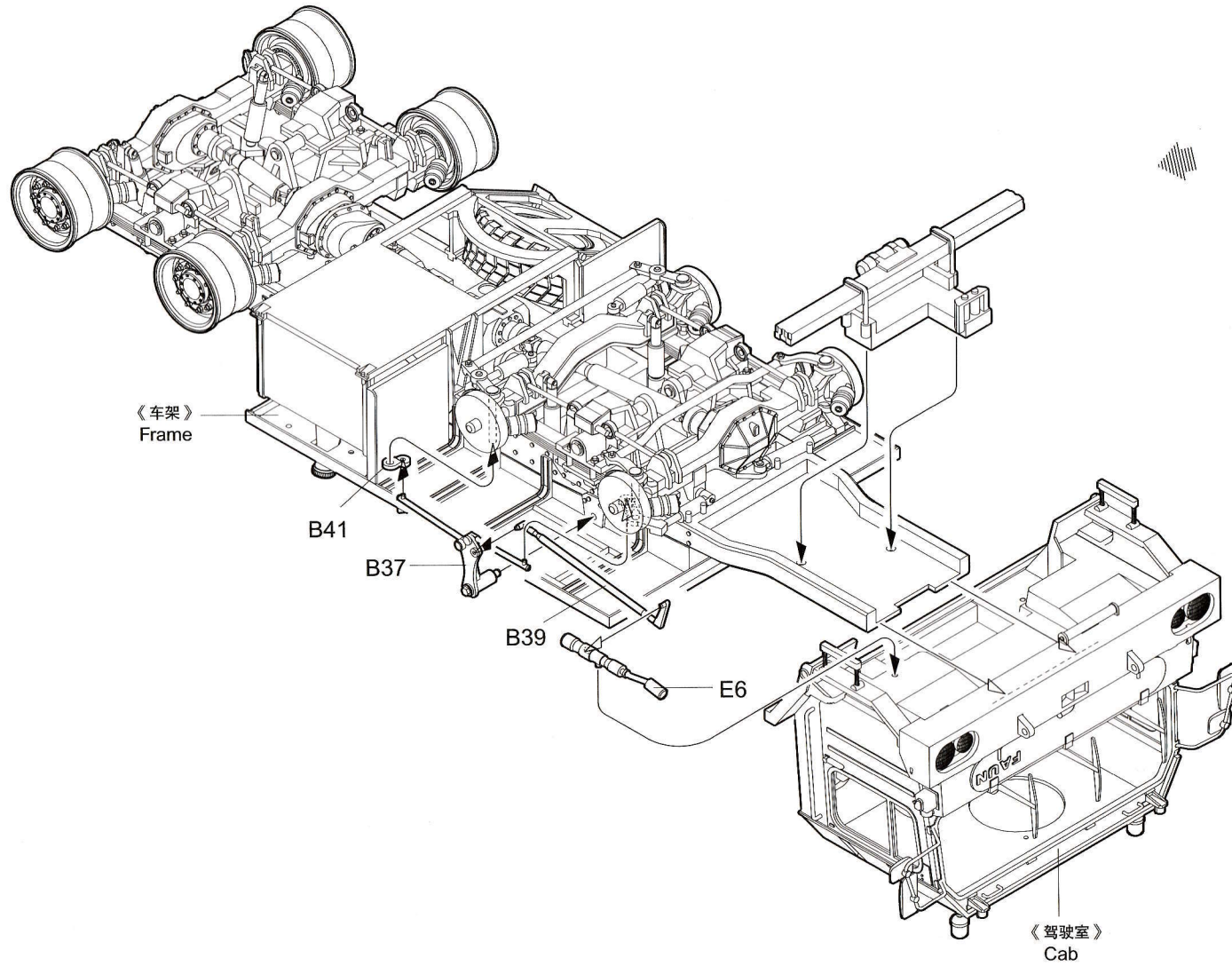

13 轮胎安装
Attaching tyre assembly

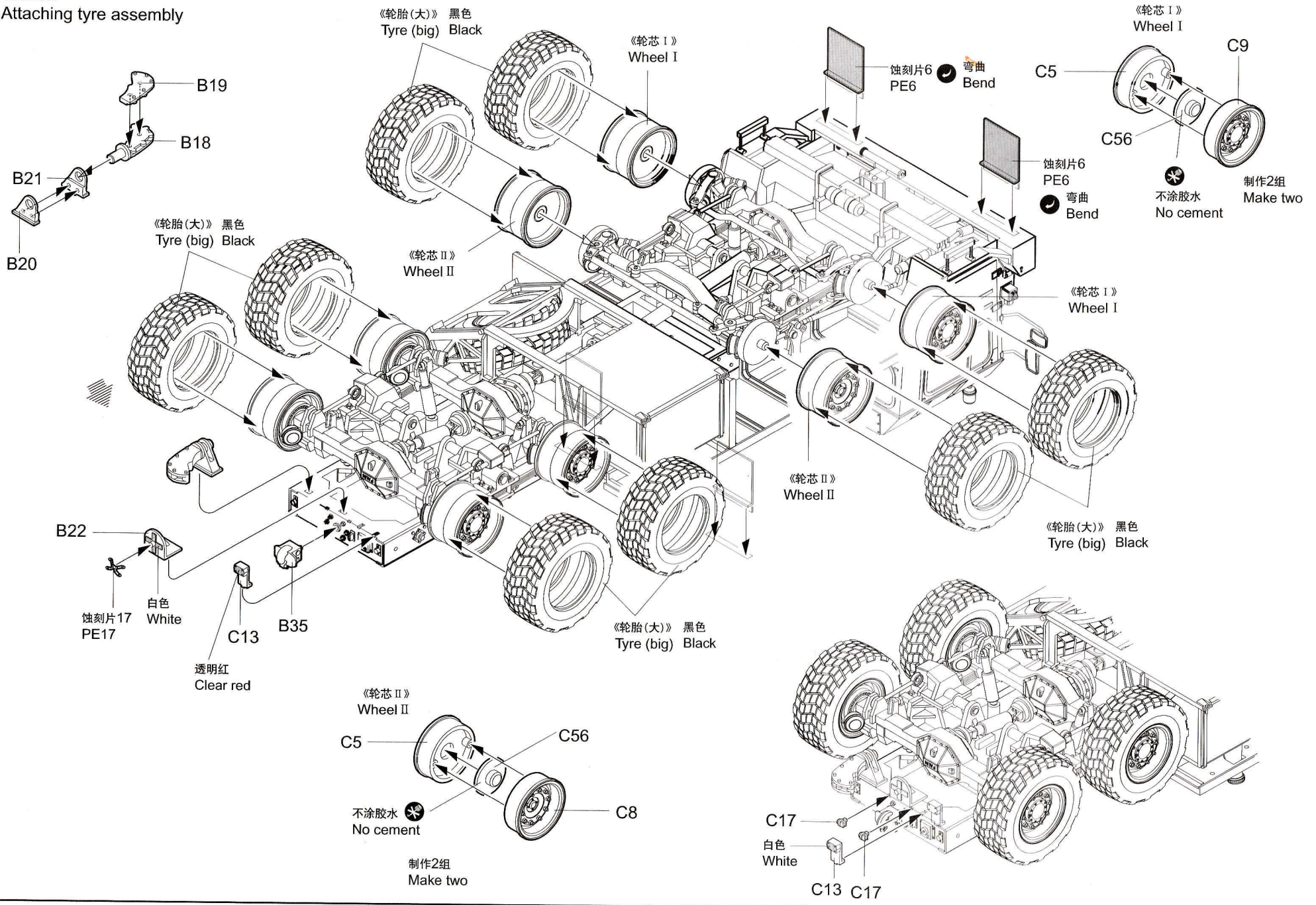

14 左侧工具箱的组装
Left toolbox assembly

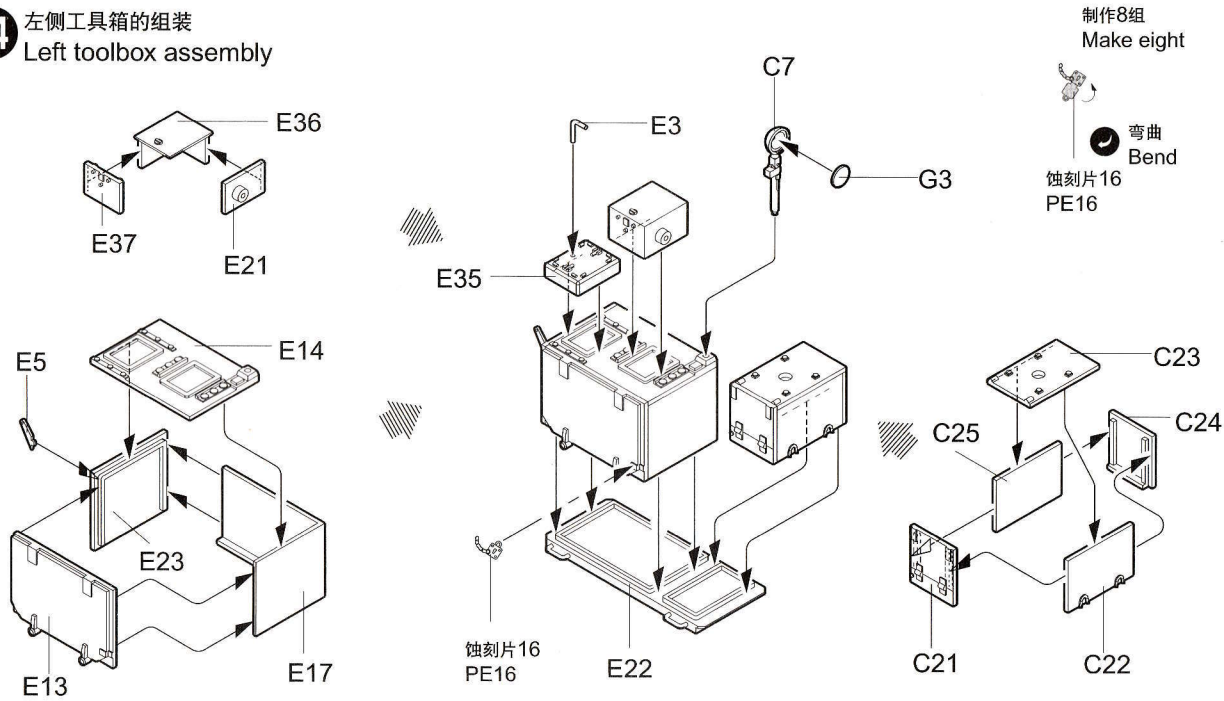

15 右侧工具箱的组装
Right toolbox assembly

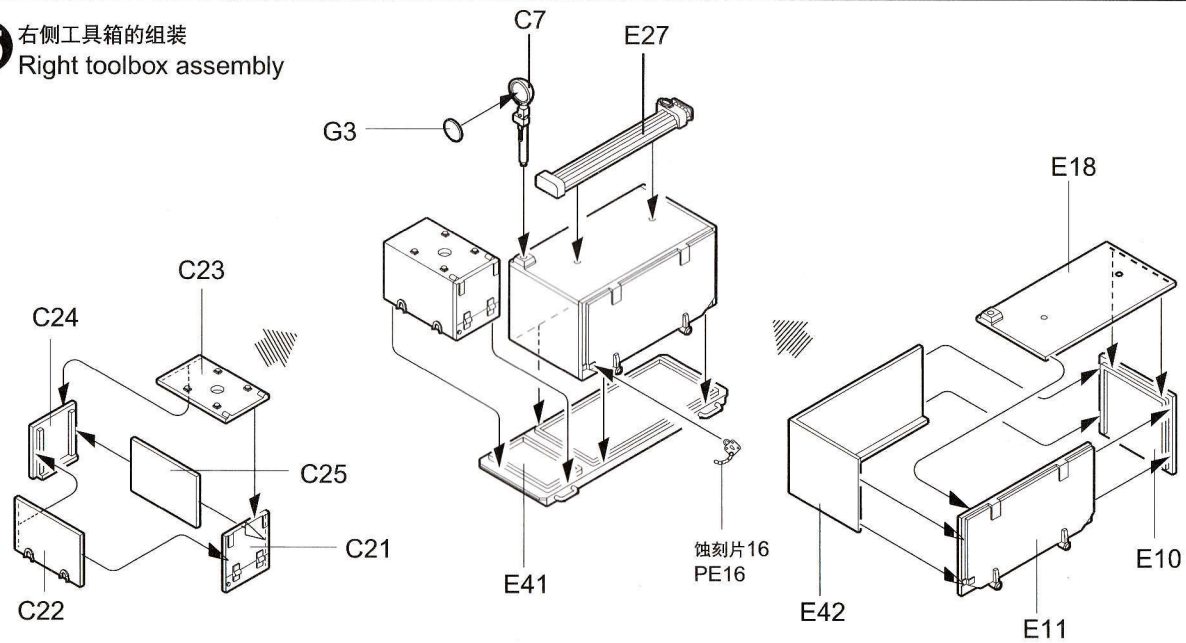

16 右侧挡泥板组装
Right fender assembly

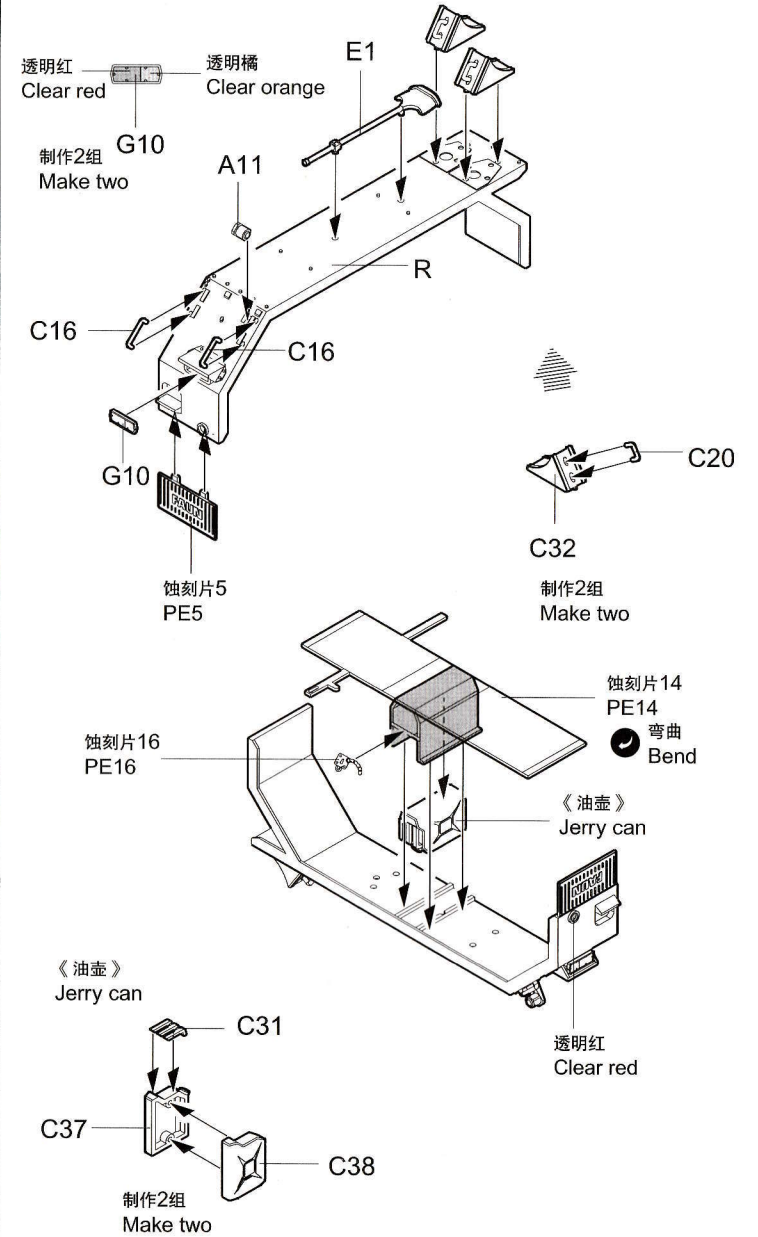

17 挡泥板安装
Attaching fender

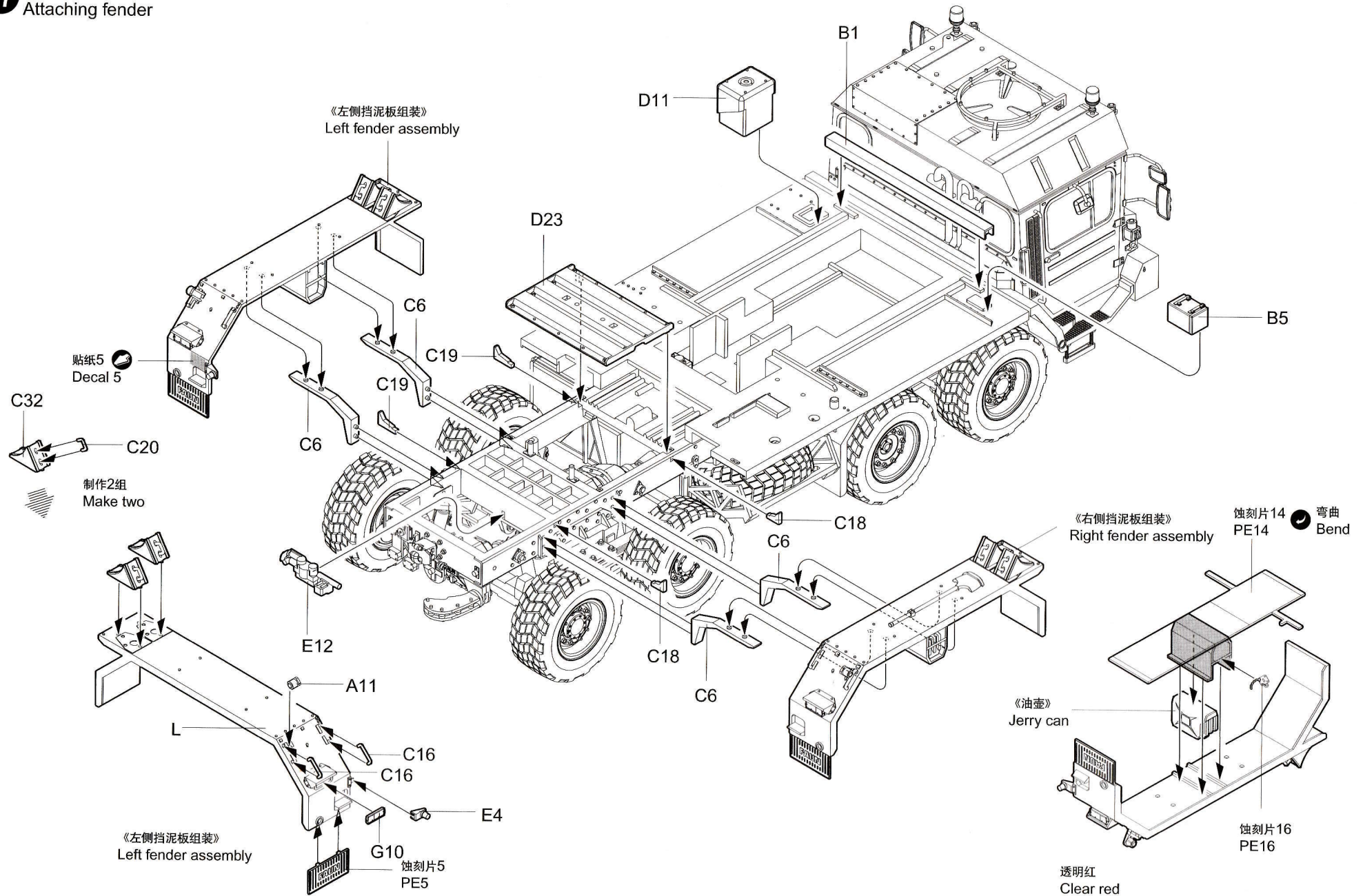

18 散热器安装
Attaching radiator

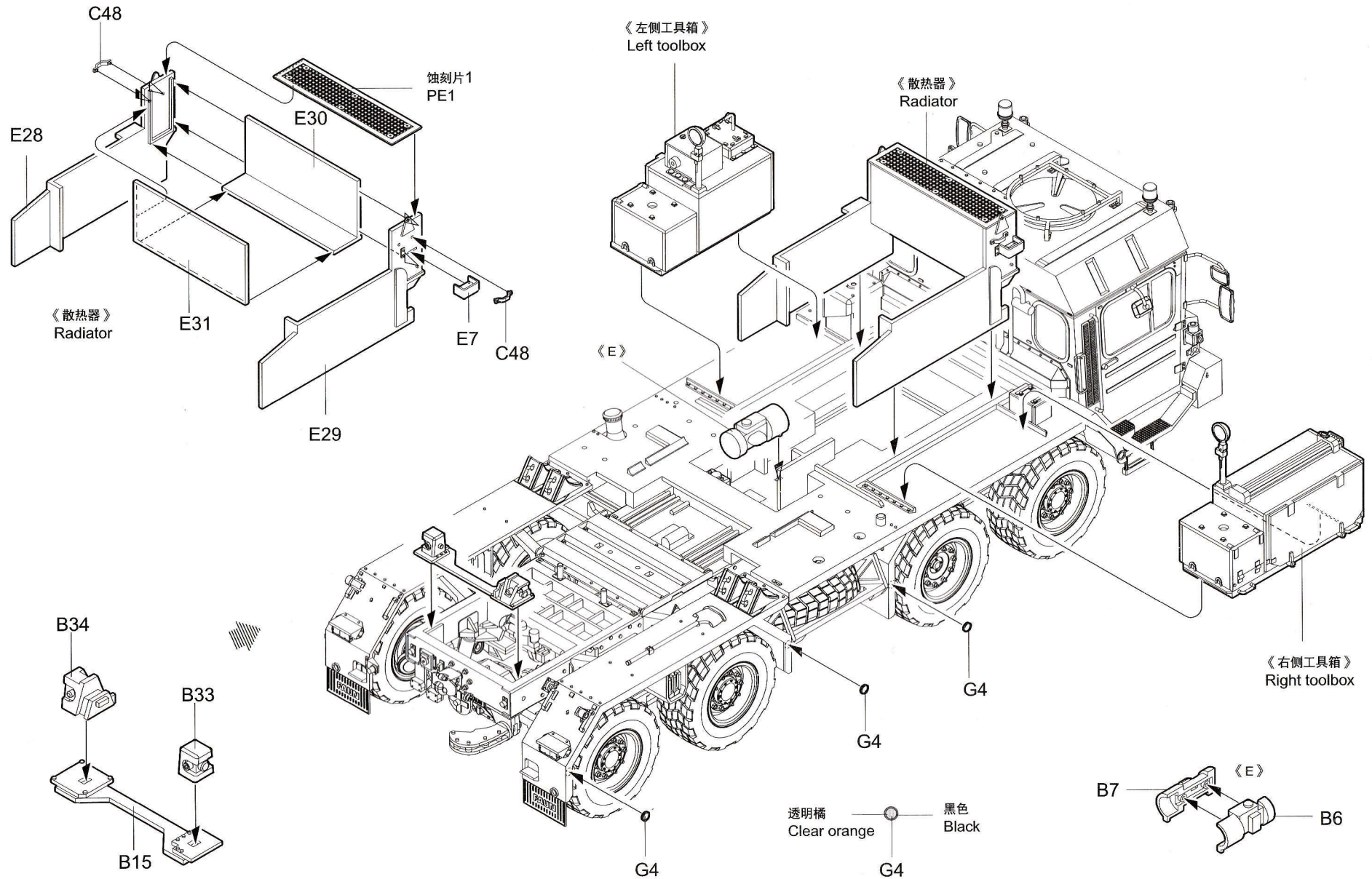

20 左侧绞盘安装
Attaching left winch

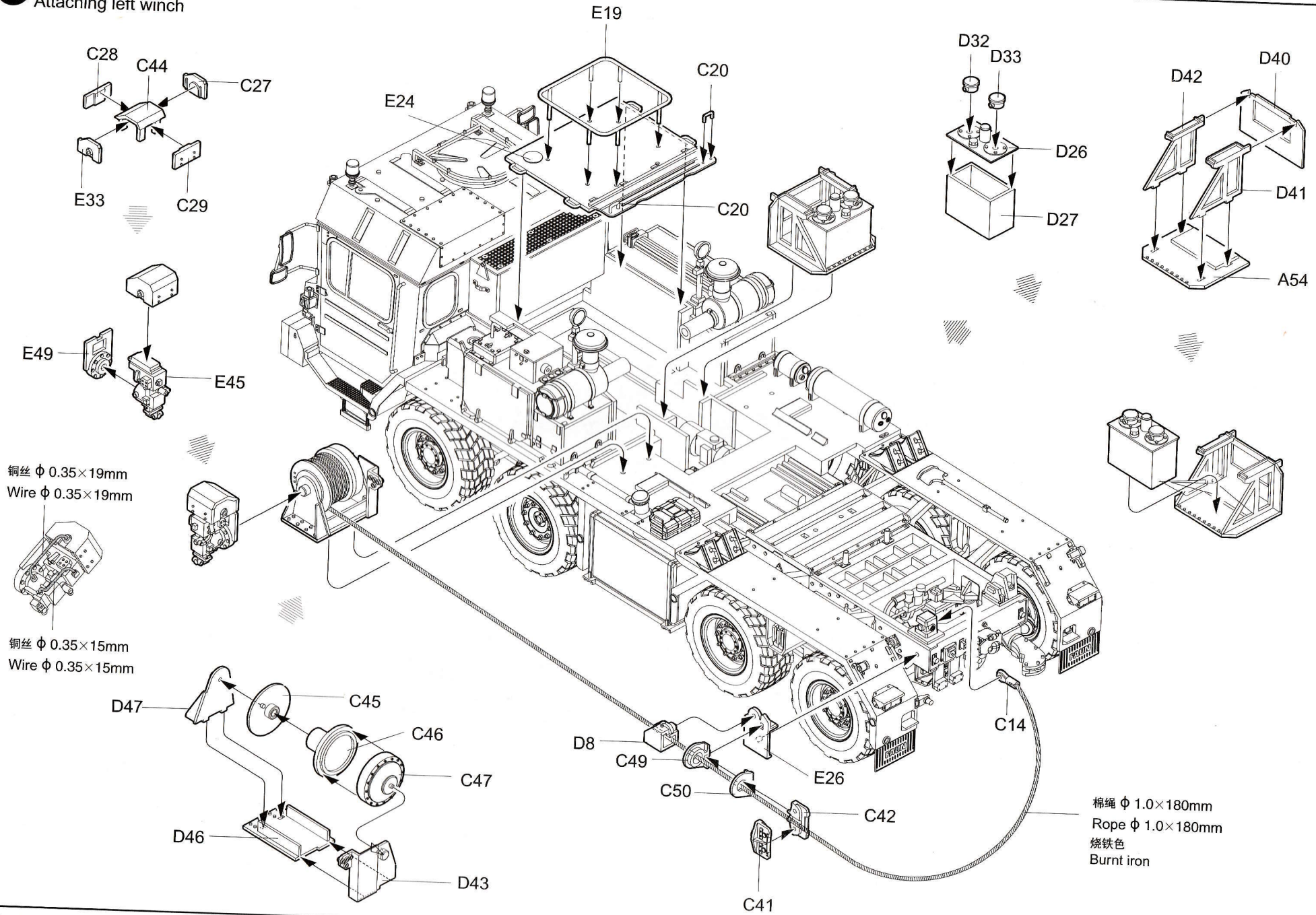

21 右侧绞盘安装
Attaching right winch

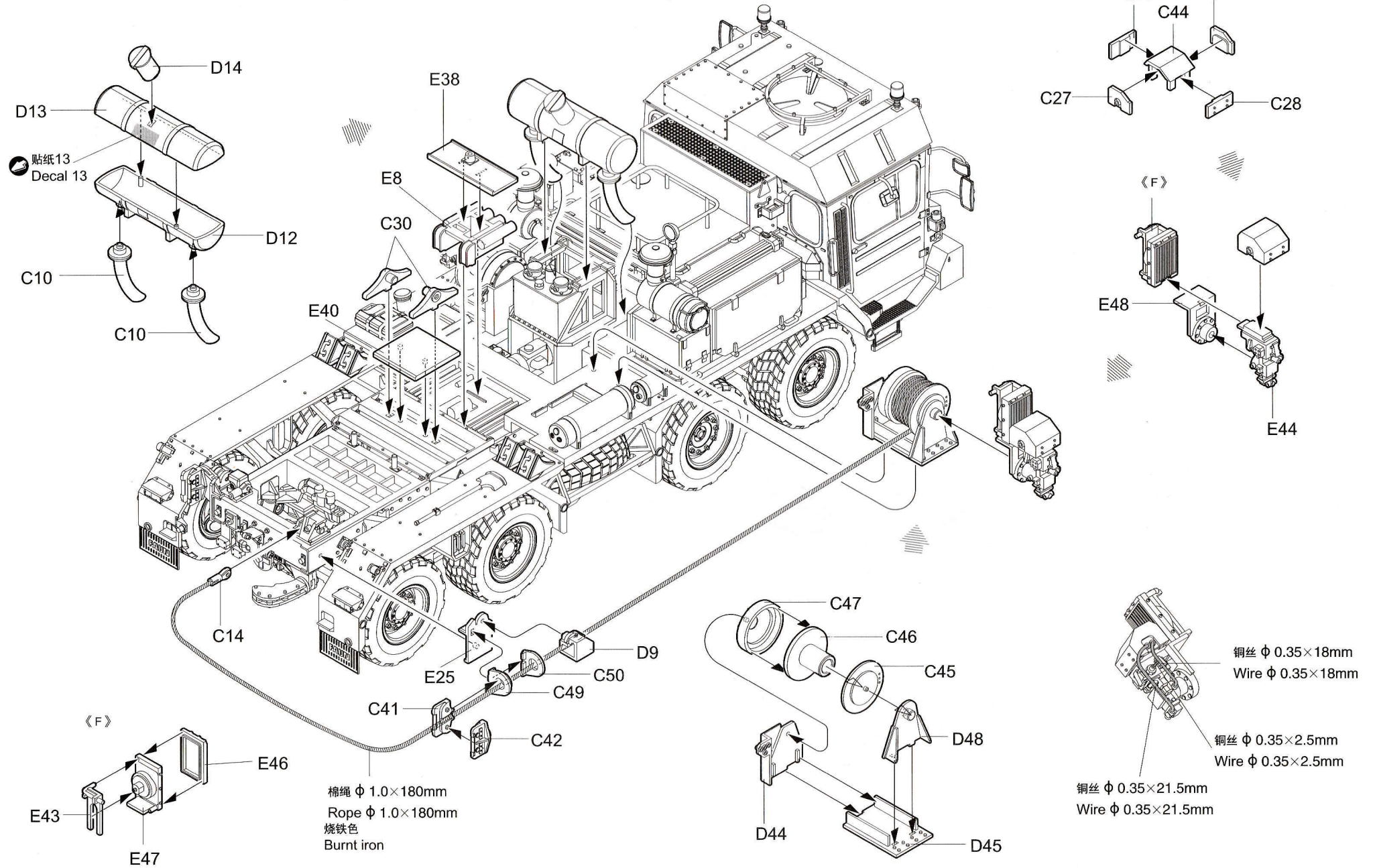

22 半拖车接轮组装
Fifth-wheel assembly

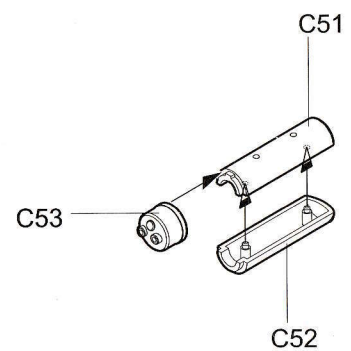
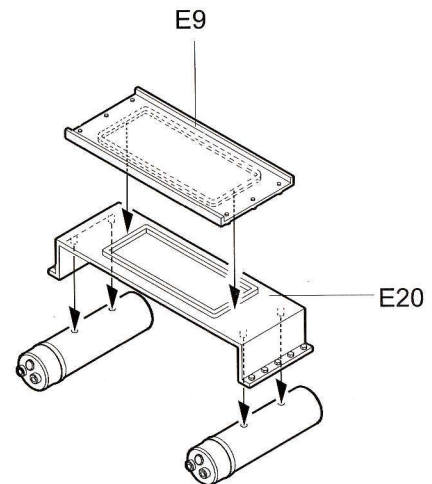
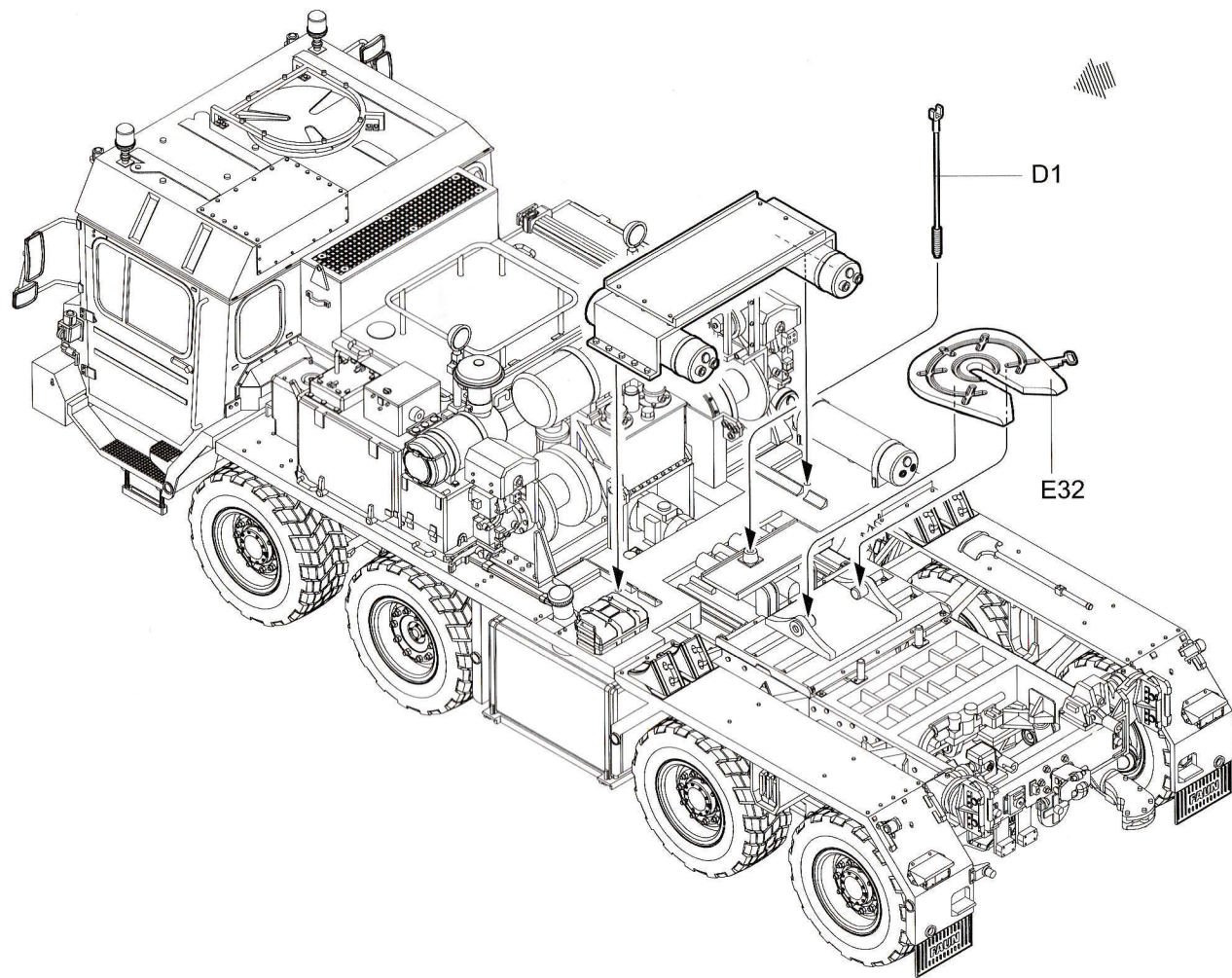

制作2组
Make two

23

连接管组装

Add PVC hose and pipes as shown

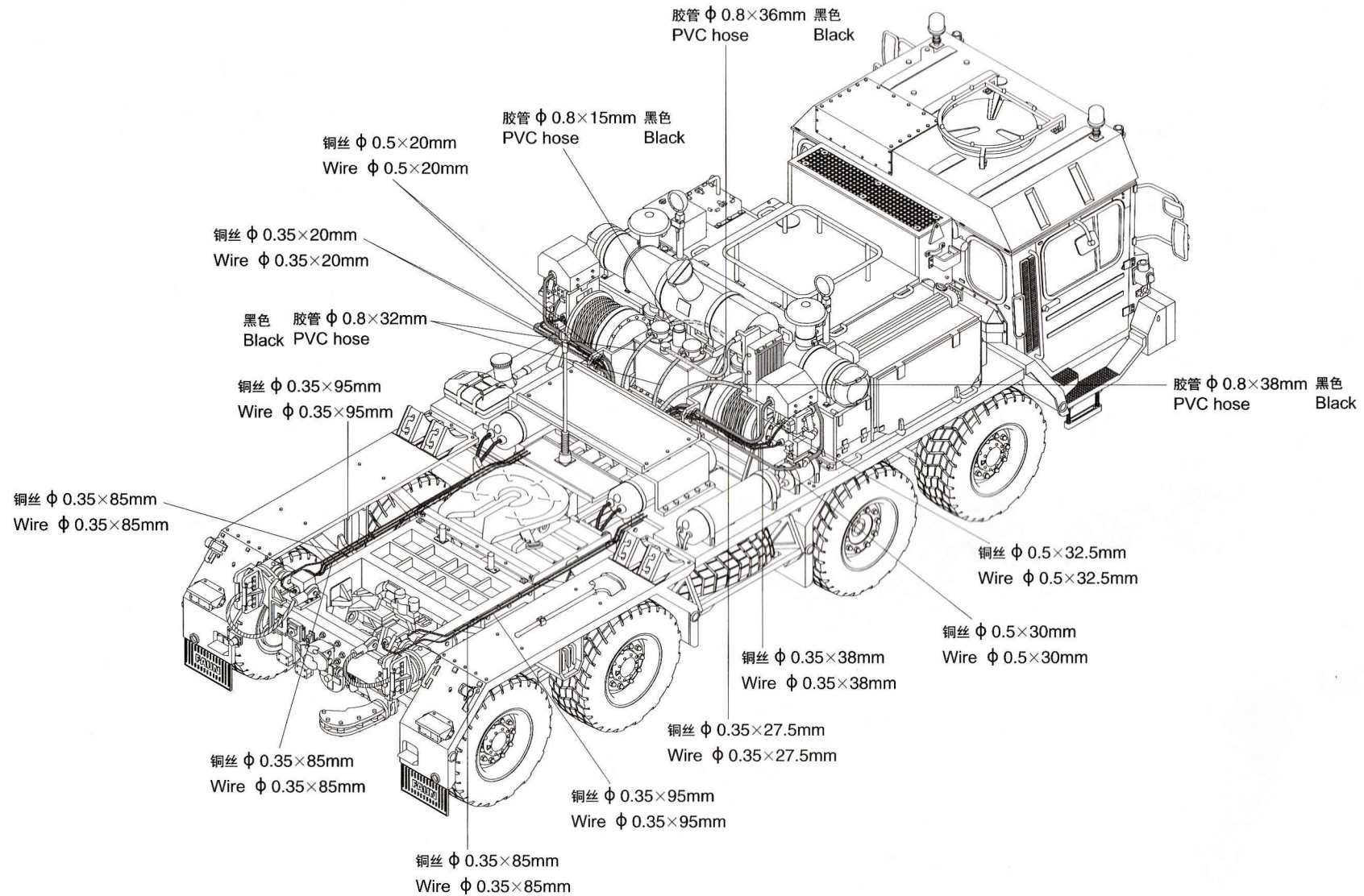

24 连接管组装
Add PVC hose and pipes as shown

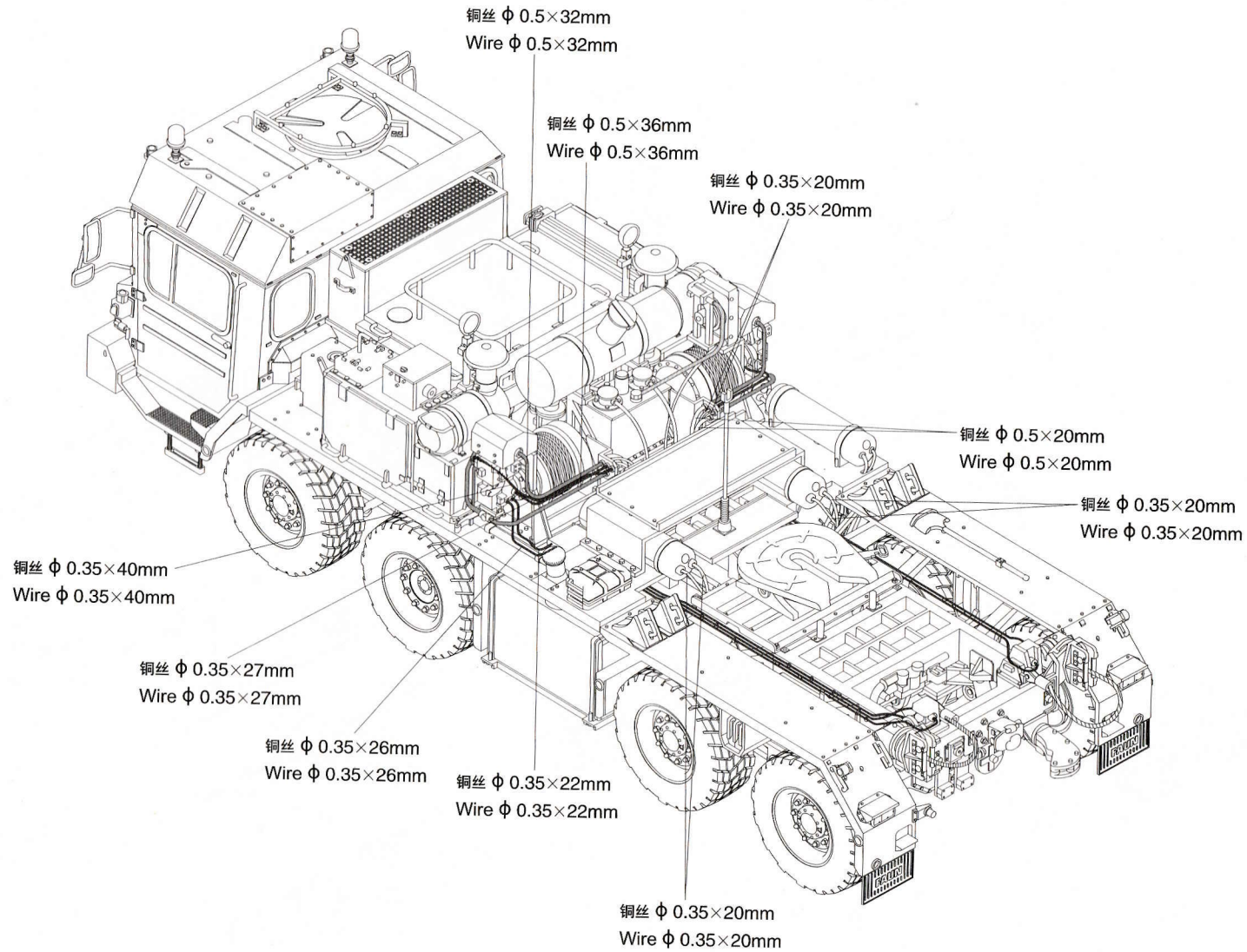

拖板组装说明书
TRAILER Assembly instructions

1 平板组装
Deck assembly

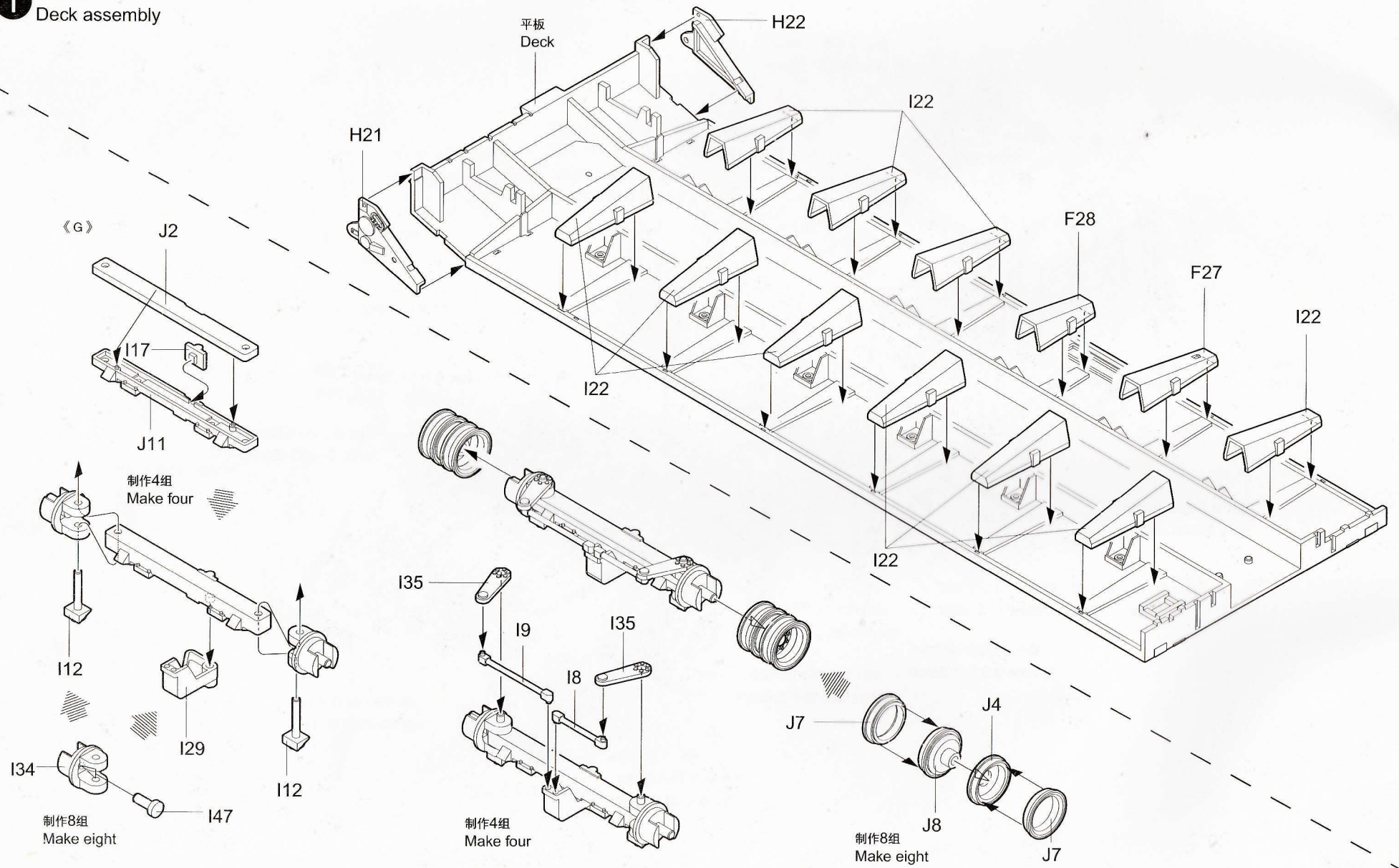

2 平板组装
Deck assembly

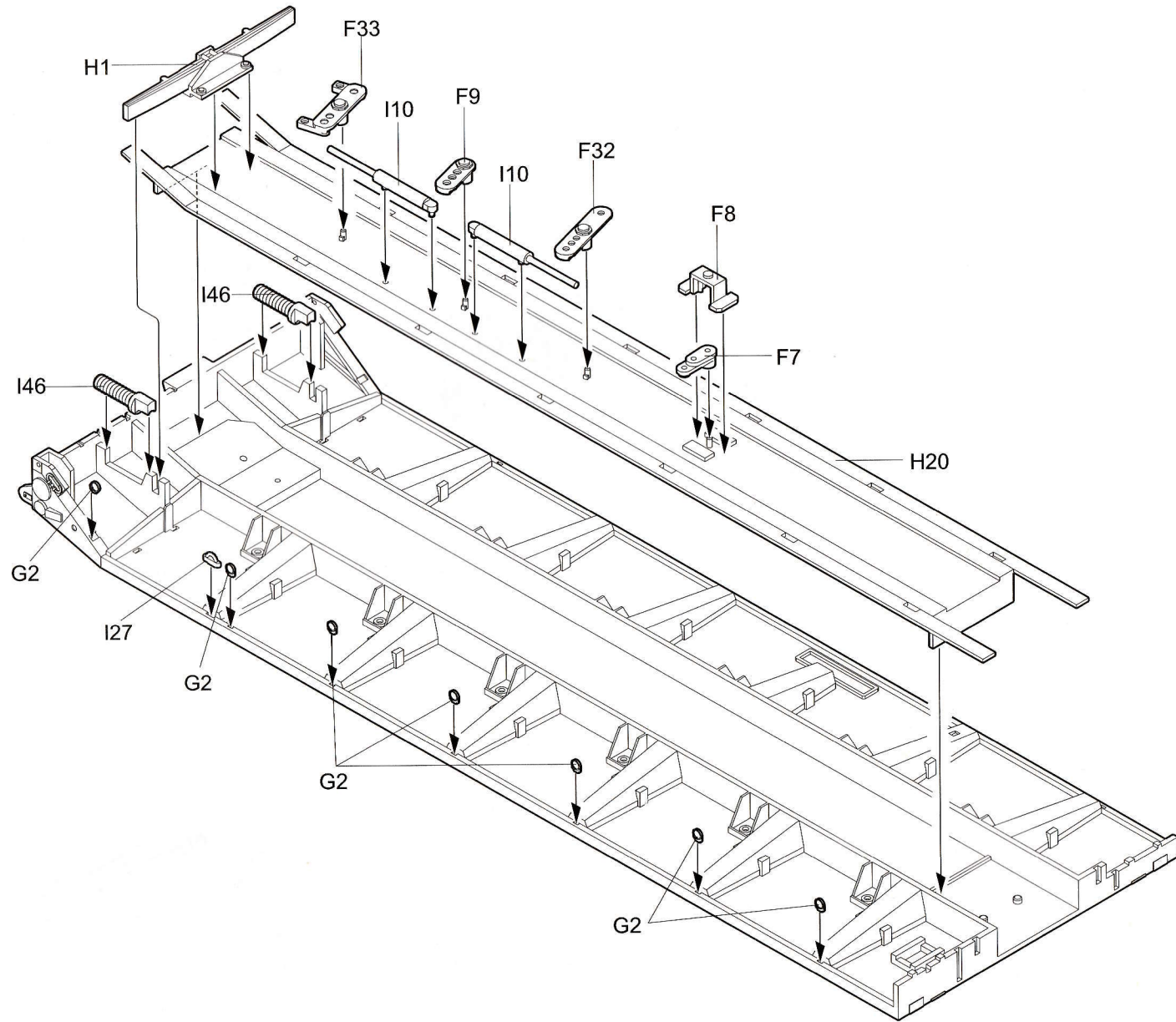

透明橘
Clear orange

黑色
Black

G2

制作14组
Make fourteen

3 钢板弹簧安装
Attaching spring

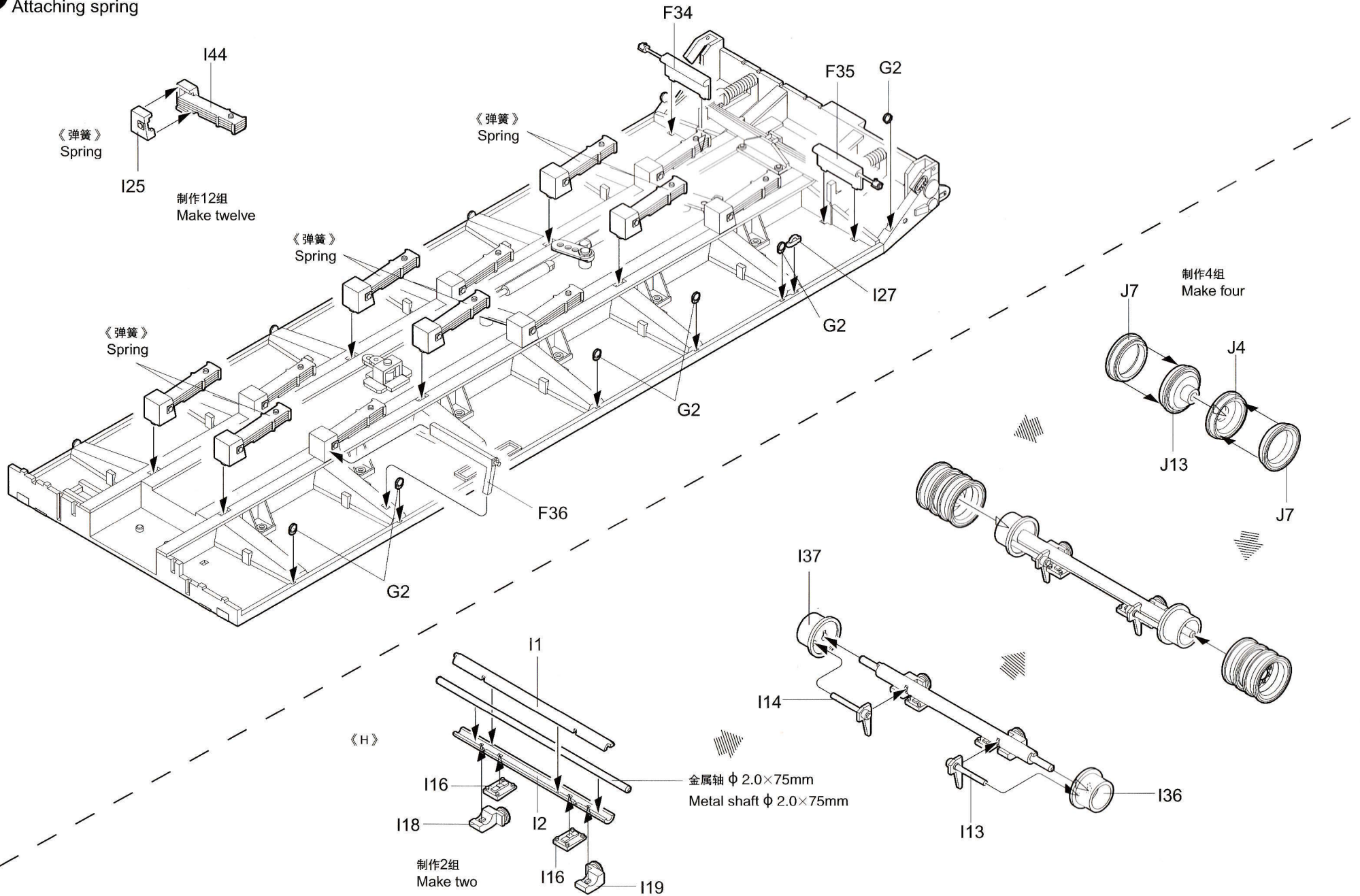

4 平板安装
Attaching deck

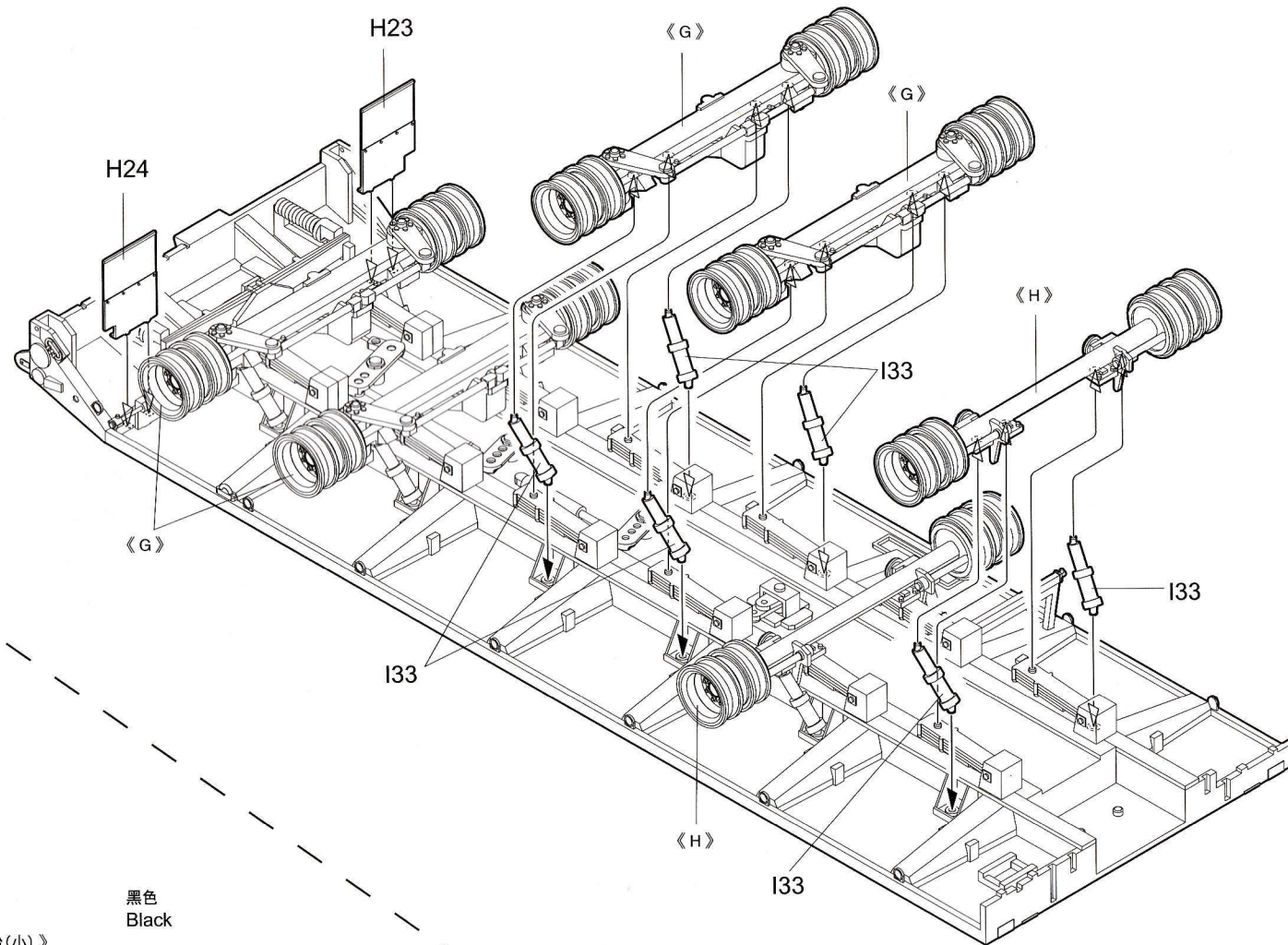

5 备用胎组装
Spare tire assembly

《备用胎》
Spare tire

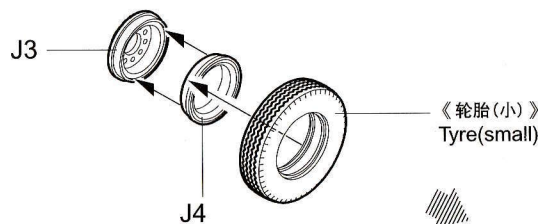

制作2组
Make two

黑色
Black

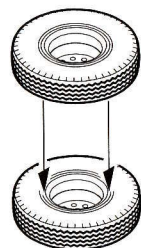

6 起重臂组装
Crane assembly

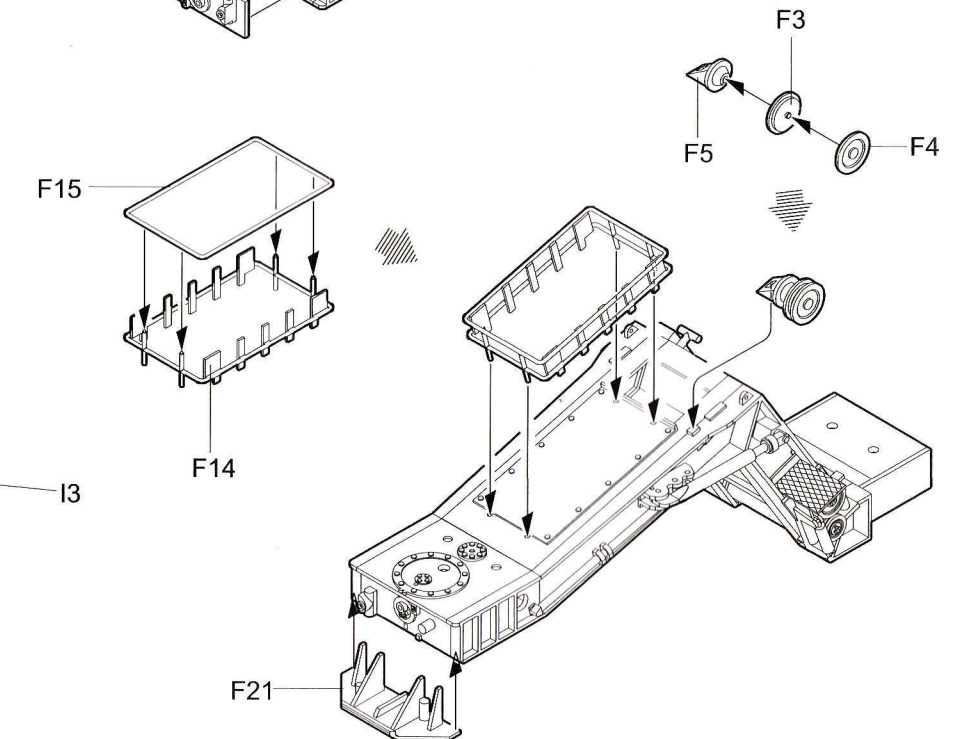
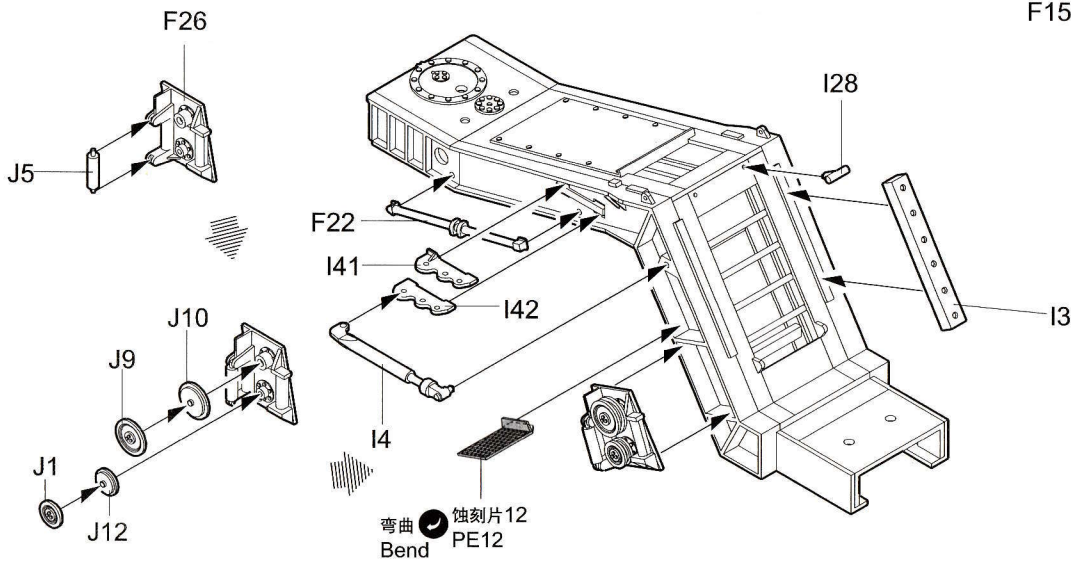
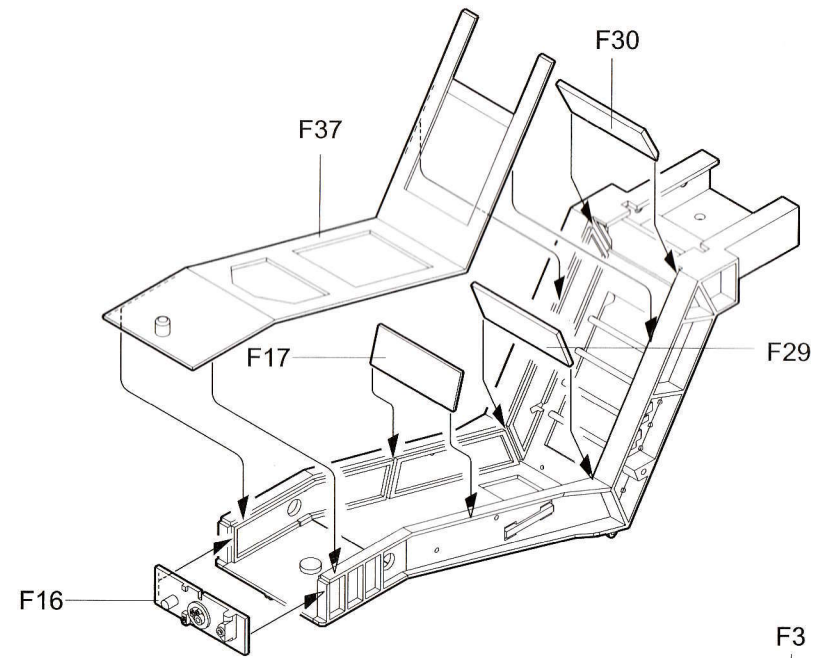
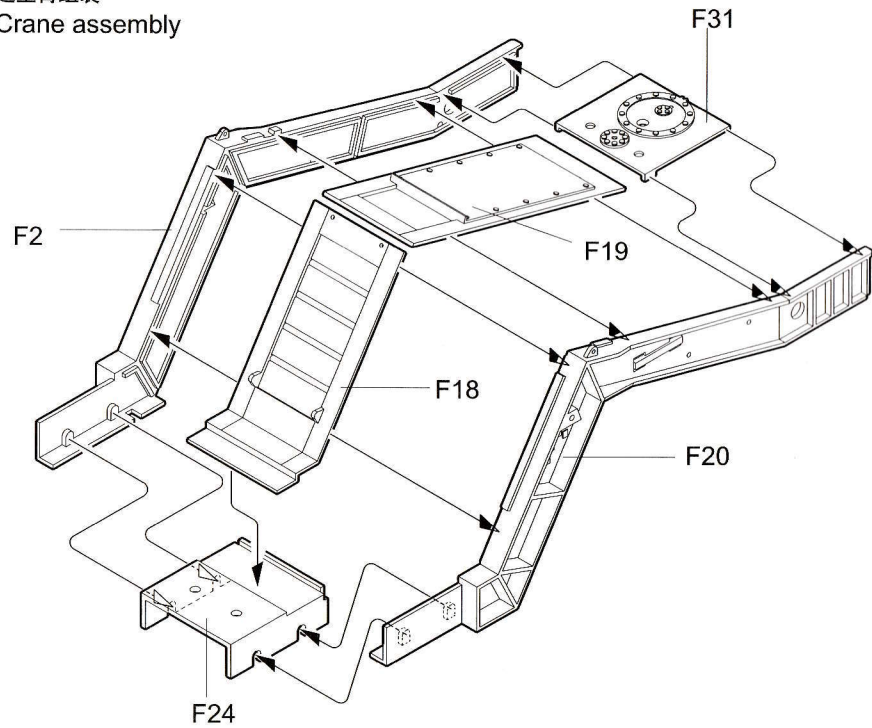

7 起重臂组装
Attaching crane

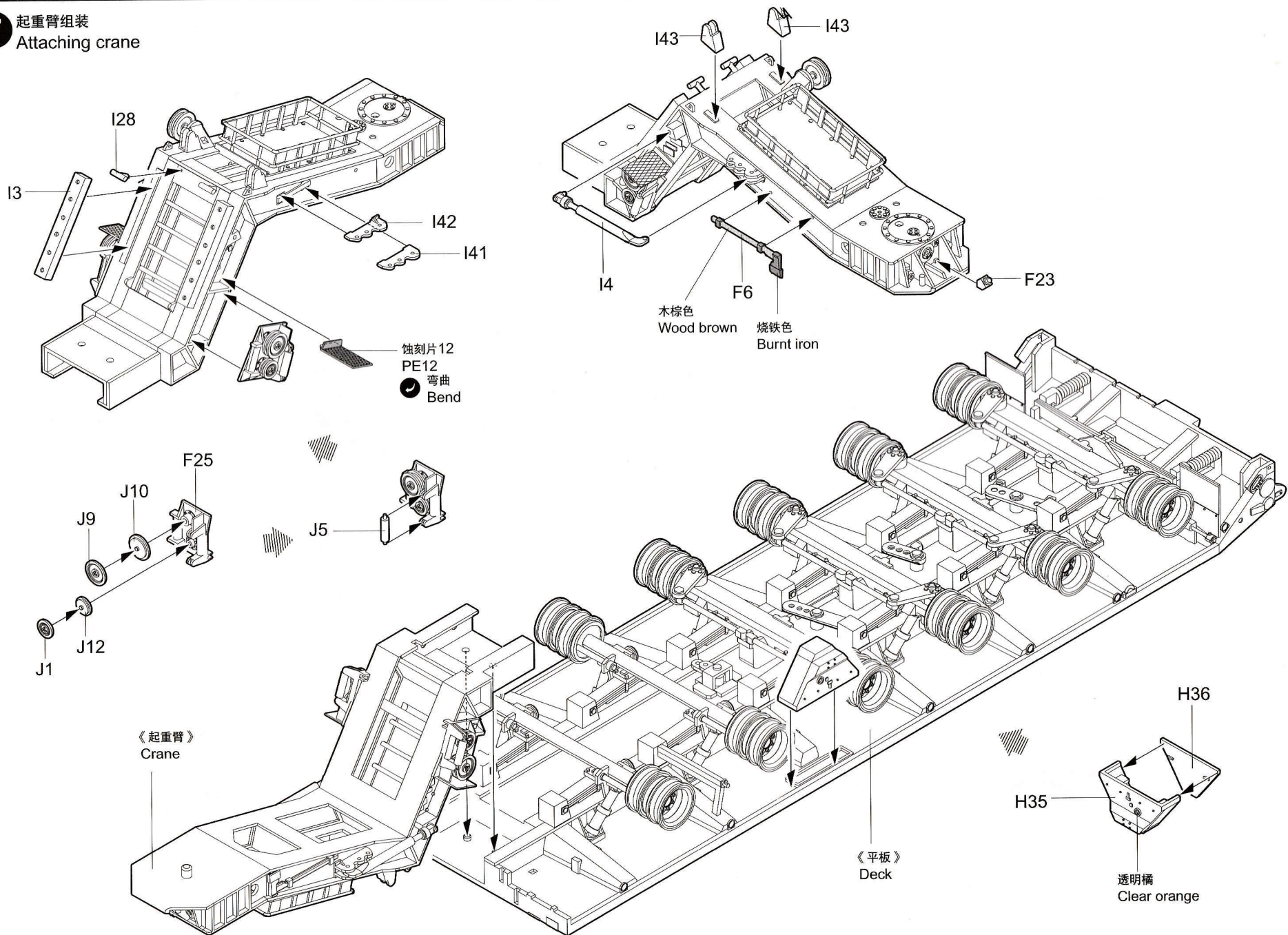

9 平板组装
Deck assembly

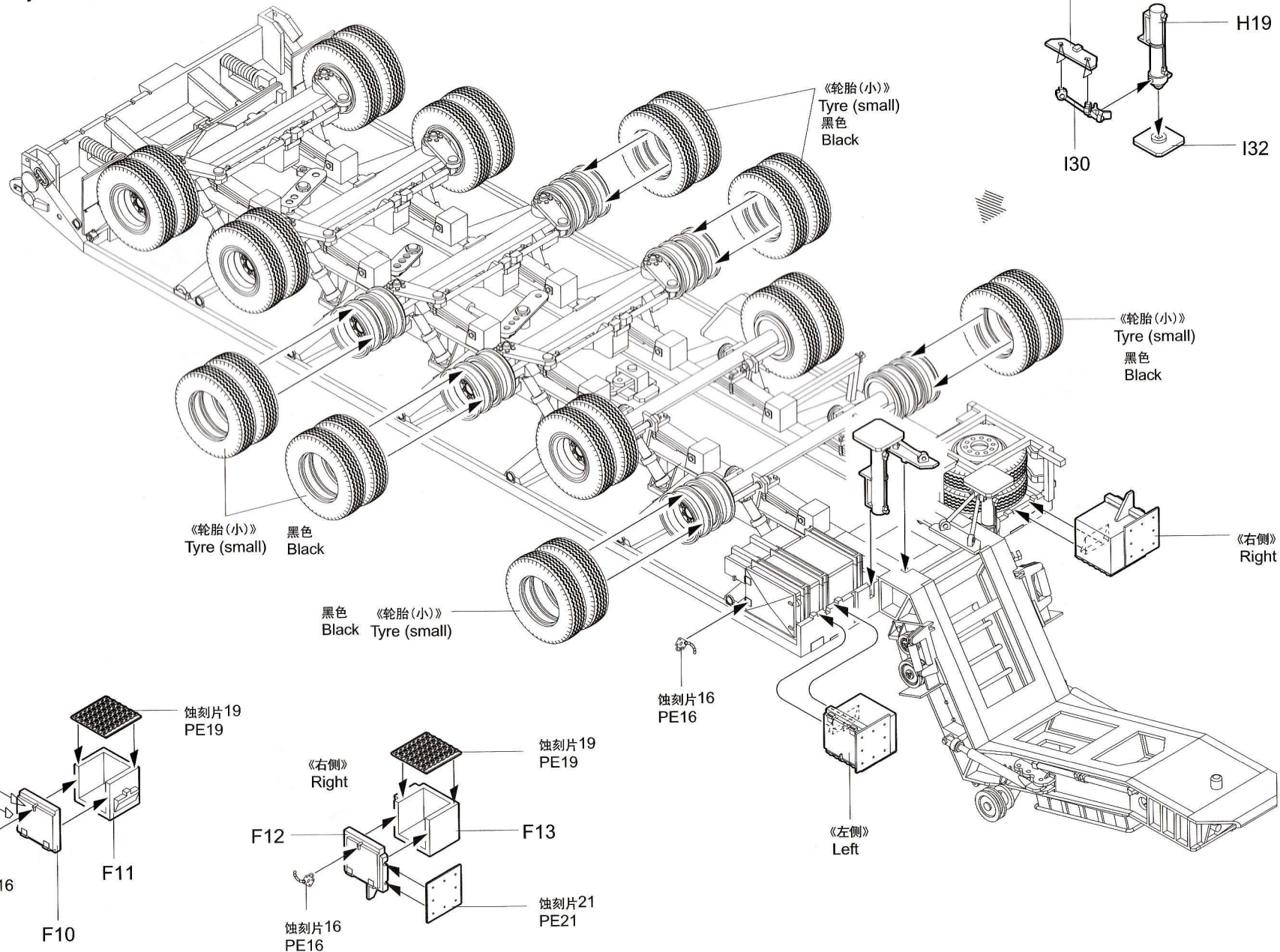

10 平板组装
Deck assembly

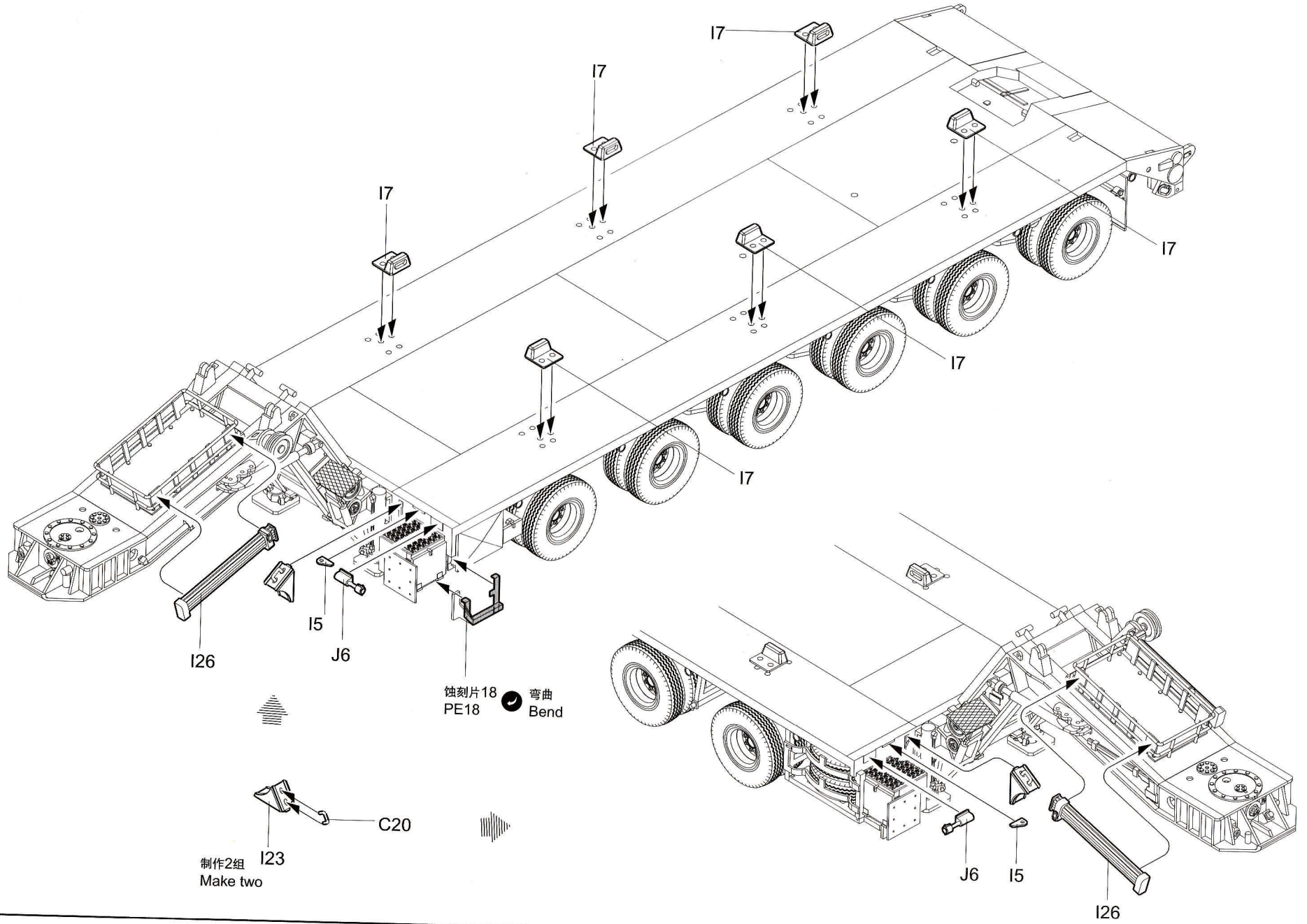

12 右侧连接桥安装
Attaching right connect axle

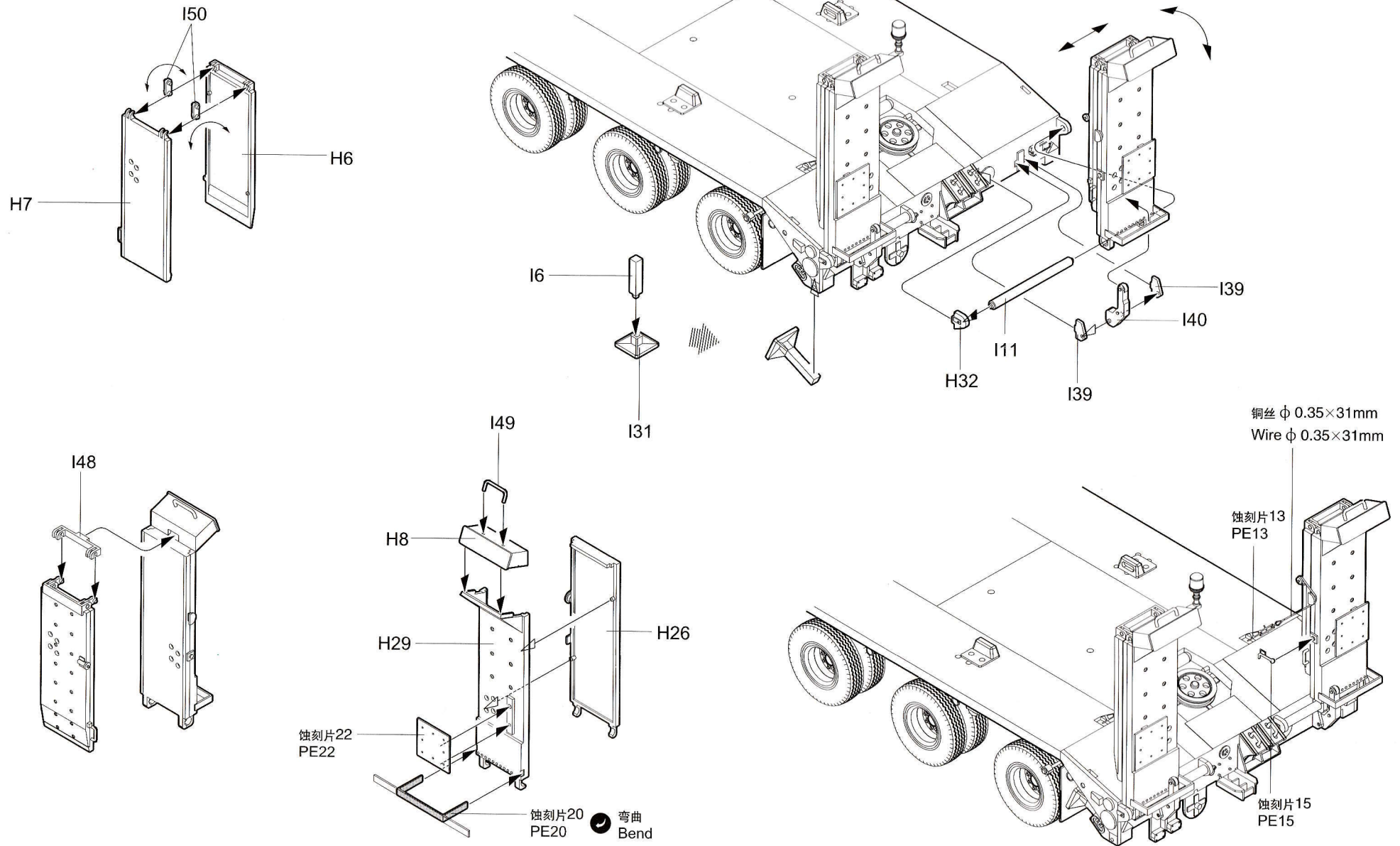

13 连接桥打开状态安装
Attaching open connect axle

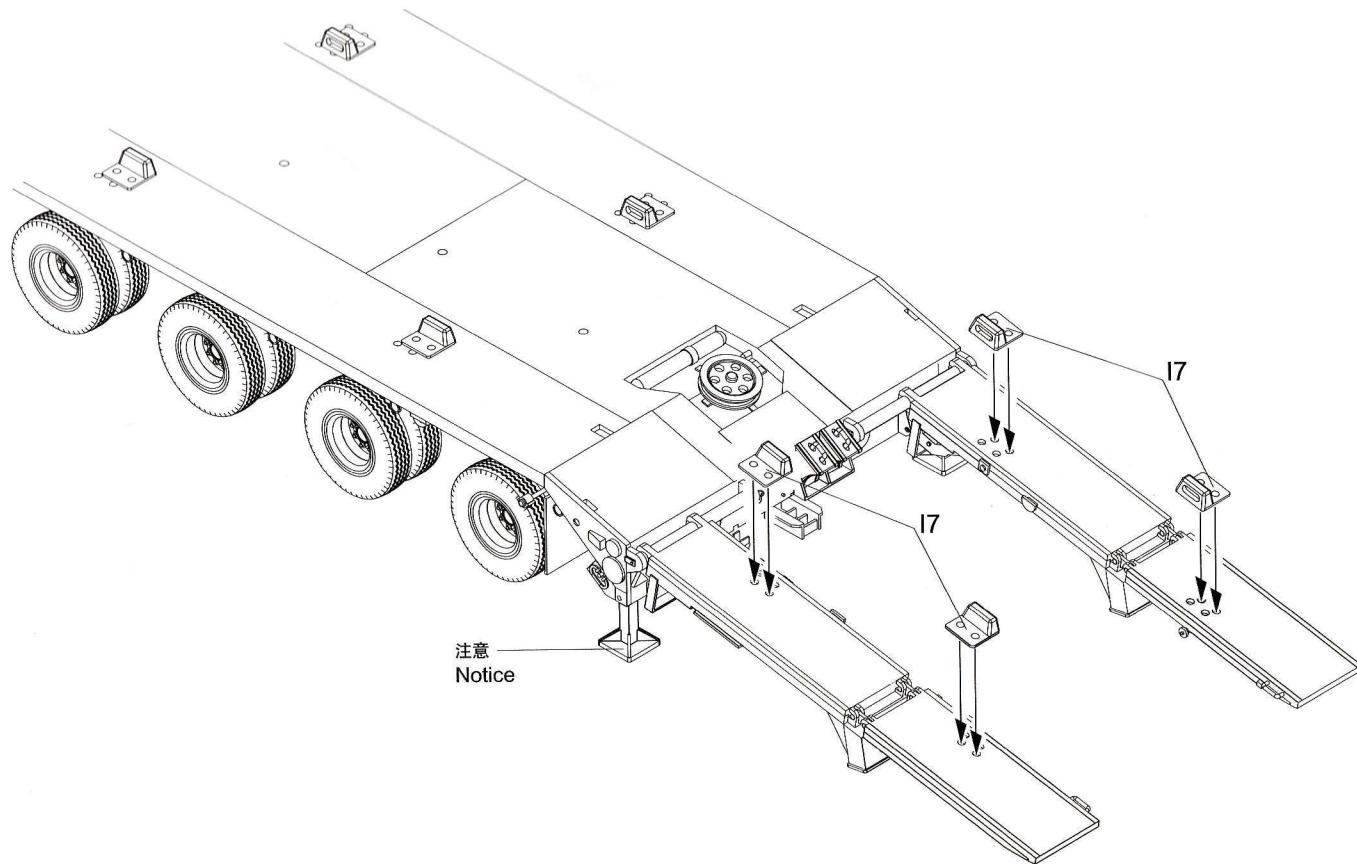
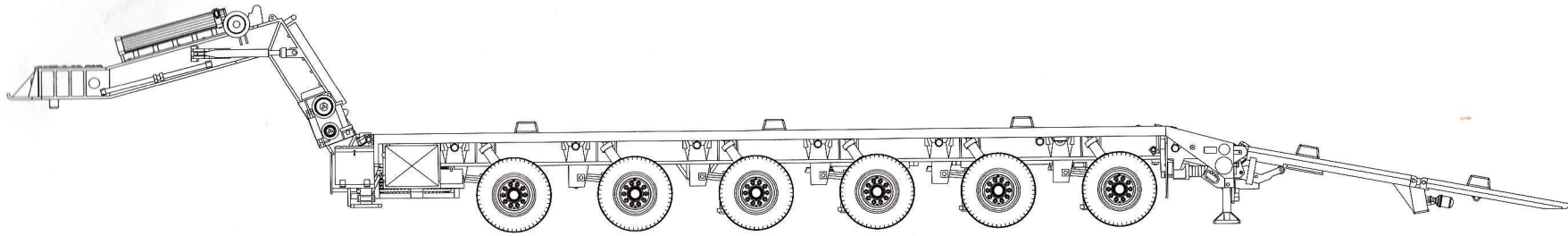

注意
Notice

14 连接拖板
Attaching trailer

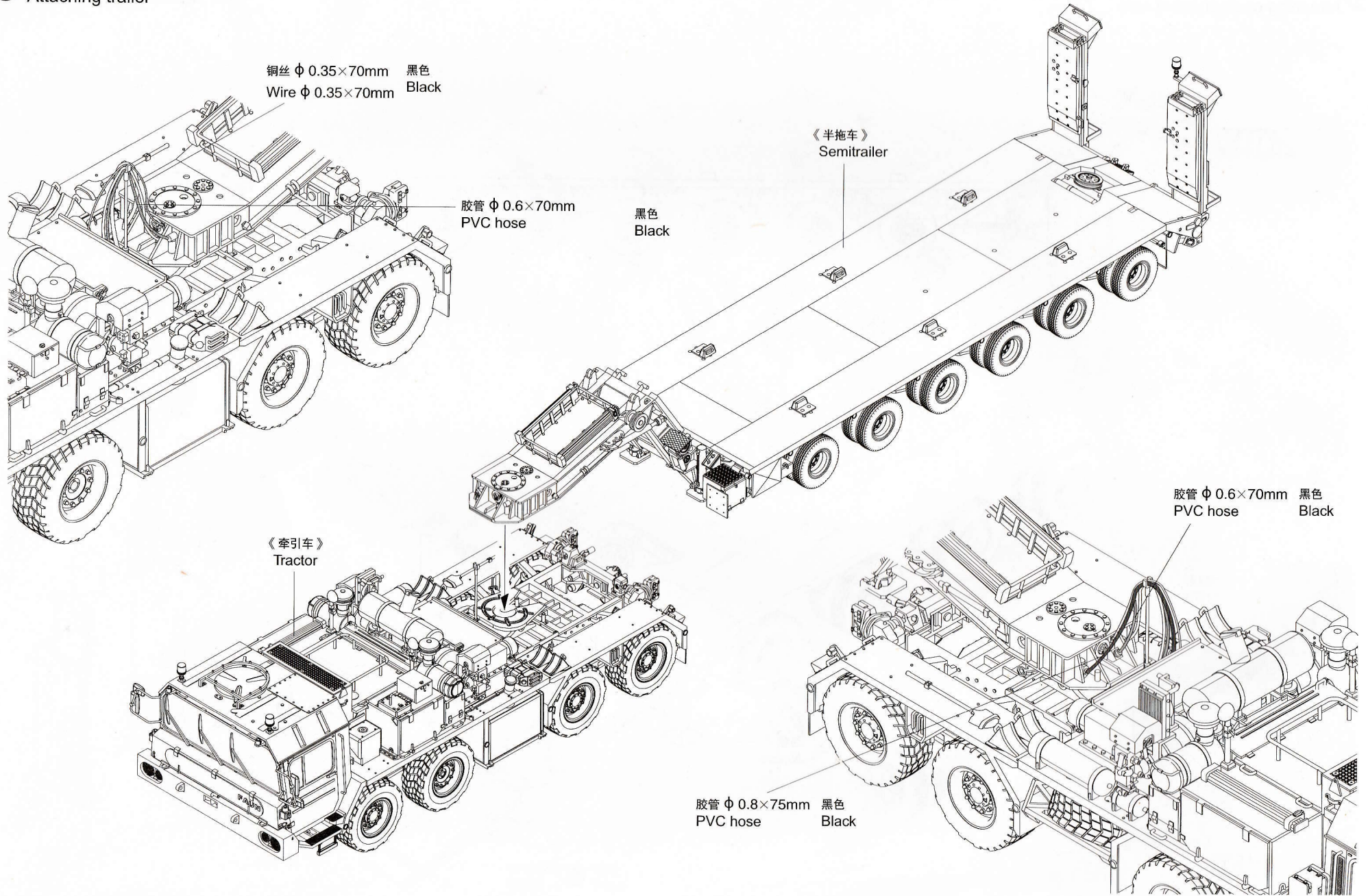

涂装同标贴指示 Painting & Marking Guide

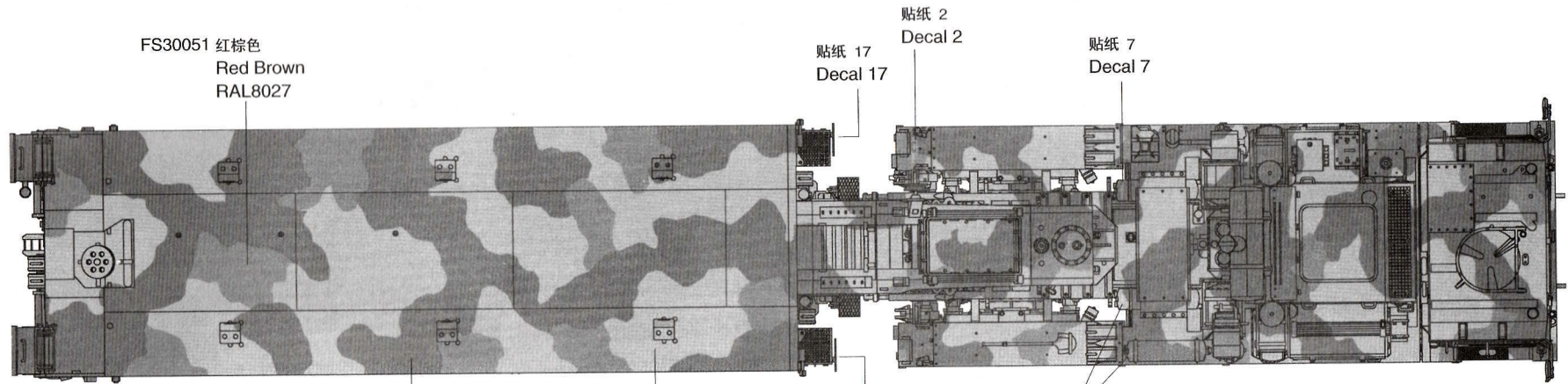
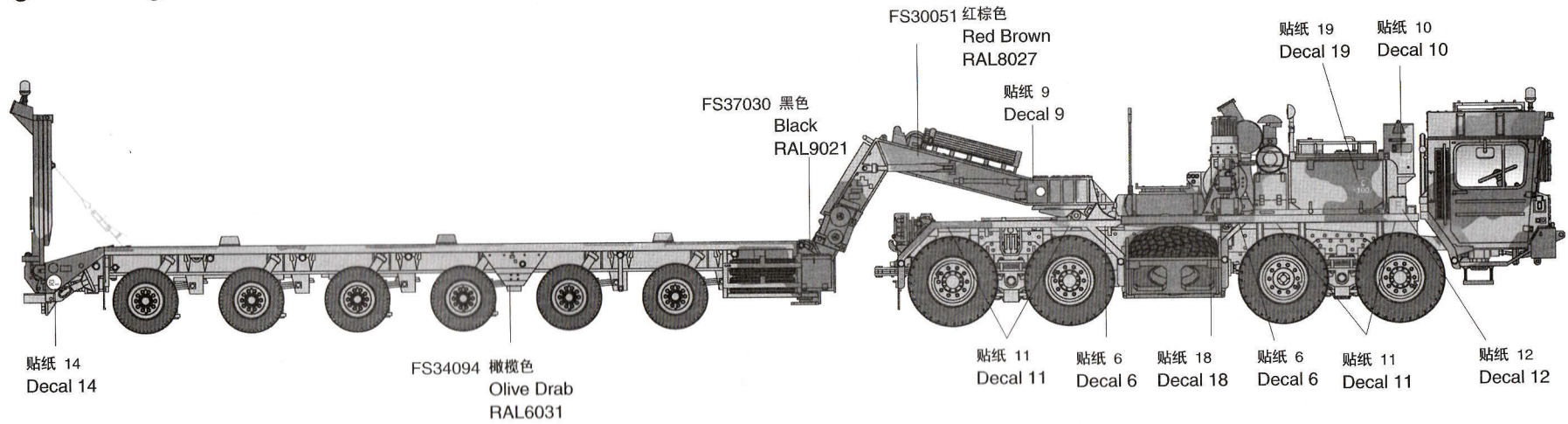

FS34094 橄榄色
Olive Drab
RAL6031



FS30051 红棕色
Red Brown
RAL8027



FS37030 黑色
Black
RAL9021

Collor Used:	Fd.stand.#	Testors color	Floquil color	Gunze Sangyo.
	FS34094	1710	F505354	TC10
	FS30051	4263	F505352	TC11
	FS37030	1749	F505350	TC12

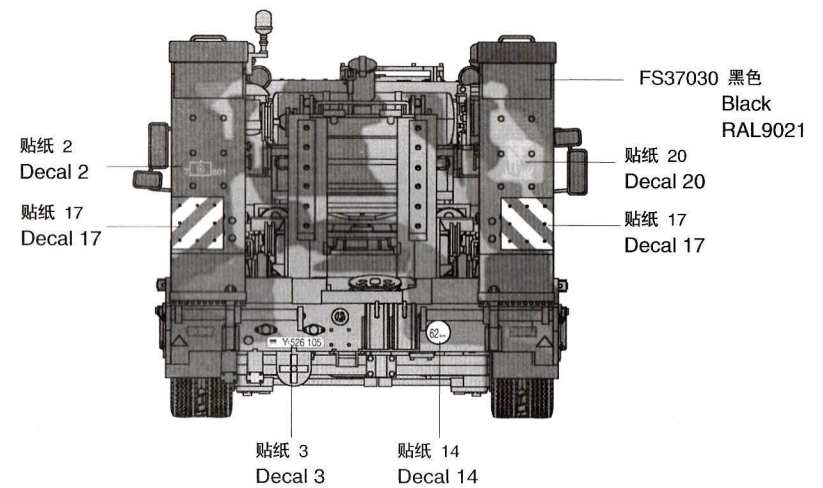
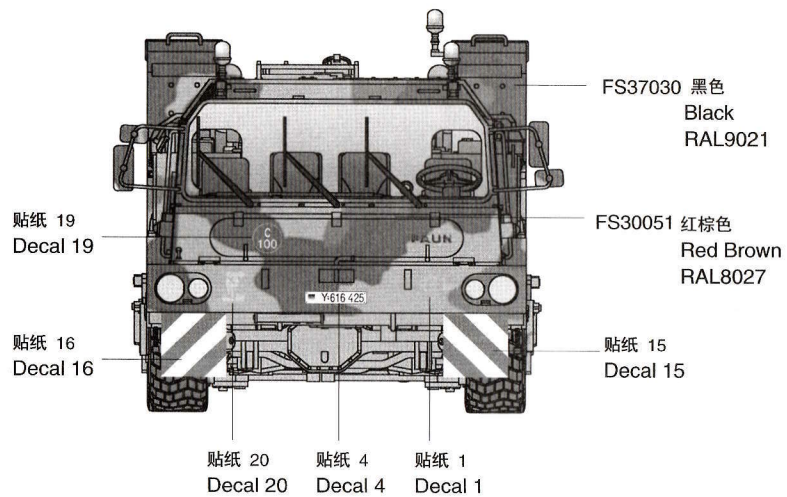
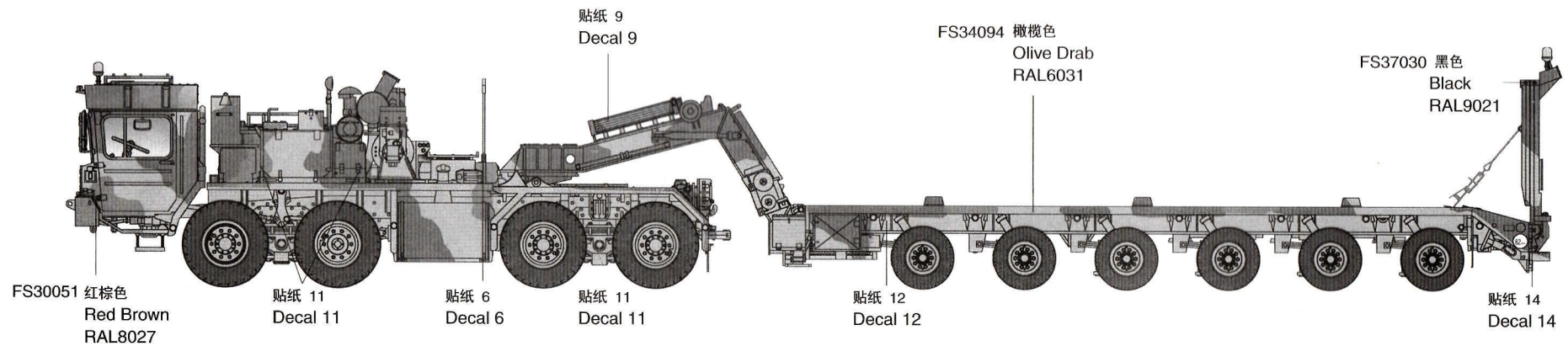

FS34094 橄榄色
Olive Drab
RAL6031



FS30051 红棕色
Red Brown
RAL8027



FS37030 黑色
Black
RAL9021