

**eduard**

**LIMITED**



# HRÁBĚ SU-25K

**Instruction sheet**

**1/48**

11176-NAV1



Carefully read instruction sheet before assembling. When you use glue or paint, do not use near open flame and use in well ventilated room. Keep out of reach of small children. Children must not be allowed to suck any part, or pull vinyl bag over the head.



Před započítím stavby si pečlivě prostudujte stavební návod. Při používání barev a lepidel pracujte v dobře větrané místnosti. Lepidla ani barvy nepoužívejte v blízkosti otevřeného ohně. Model není určen malým dětem, mohlo by dojít k požití drobných dílů.

## INSTRUCTION SIGNS \* INSTR. SYMBOLS \* INSTRUKTION SINNBILDEN \* SYMBOLES \* 記号の説明

OPTIONAL  
VOLBABEND  
OHNOUTSAND  
BROUSITOPEN HOLE  
VYVRTAT OTVORSYMETRICAL ASSEMBLY  
SYMETRICKÁ MONTÁŽREMOVE  
ODŘÍZNOUTREVERSE SIDE  
OTOČITAPPLY EDUARD MASK  
AND PAINT  
POUŽÍT EDUARD MASK  
NABARVITPLEASE CHECK THE LATEST VERSION OF THE INSTRUCTIONS ON [www.eduard.com](http://www.eduard.com)

## PARTS



## DÍLY



## TEILE



## PIÈCES



## 部品

## PLASTIC PARTS

A&gt;

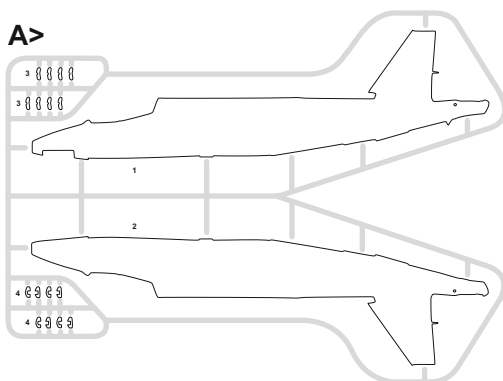

B&gt;

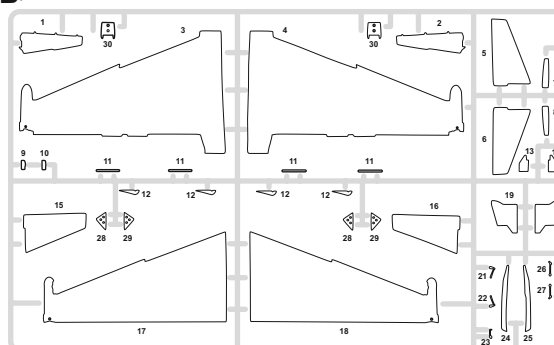

E&gt; 2 pcs.

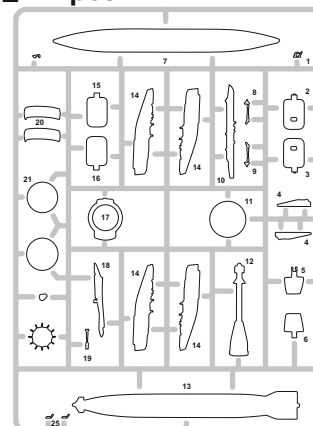

H&gt; 4 pcs.

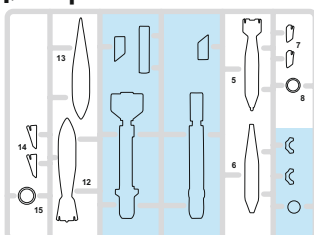

K&gt; 4 pcs.

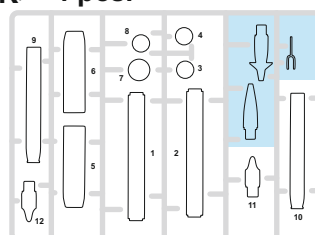

D&gt;

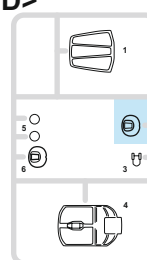

C&gt;

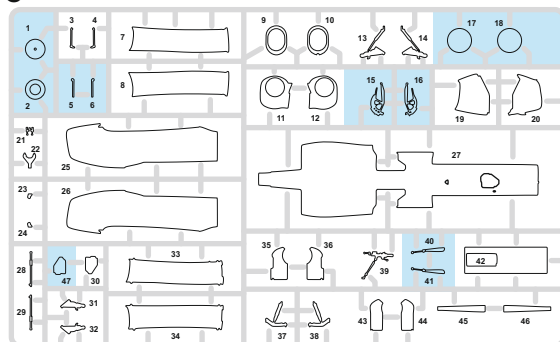

F&gt;

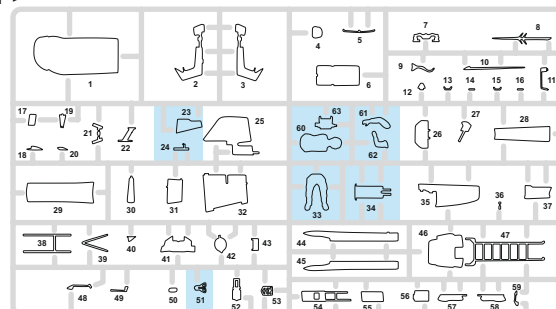

## RP - RESIN PARTS



2 pcs.

2 pcs.



R13



R8



R6



R7



R11



2 pcs.

R12



R4



R5



## PE - PHOTO ETCHED DETAIL PARTS

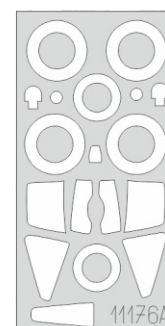
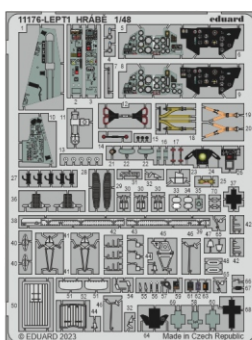

-Parts not for use. -Teile werden nicht verwendet. -Pièces à ne pas utiliser. -Tyto díly nepoužívejte při stavbě. - 使用しない部品





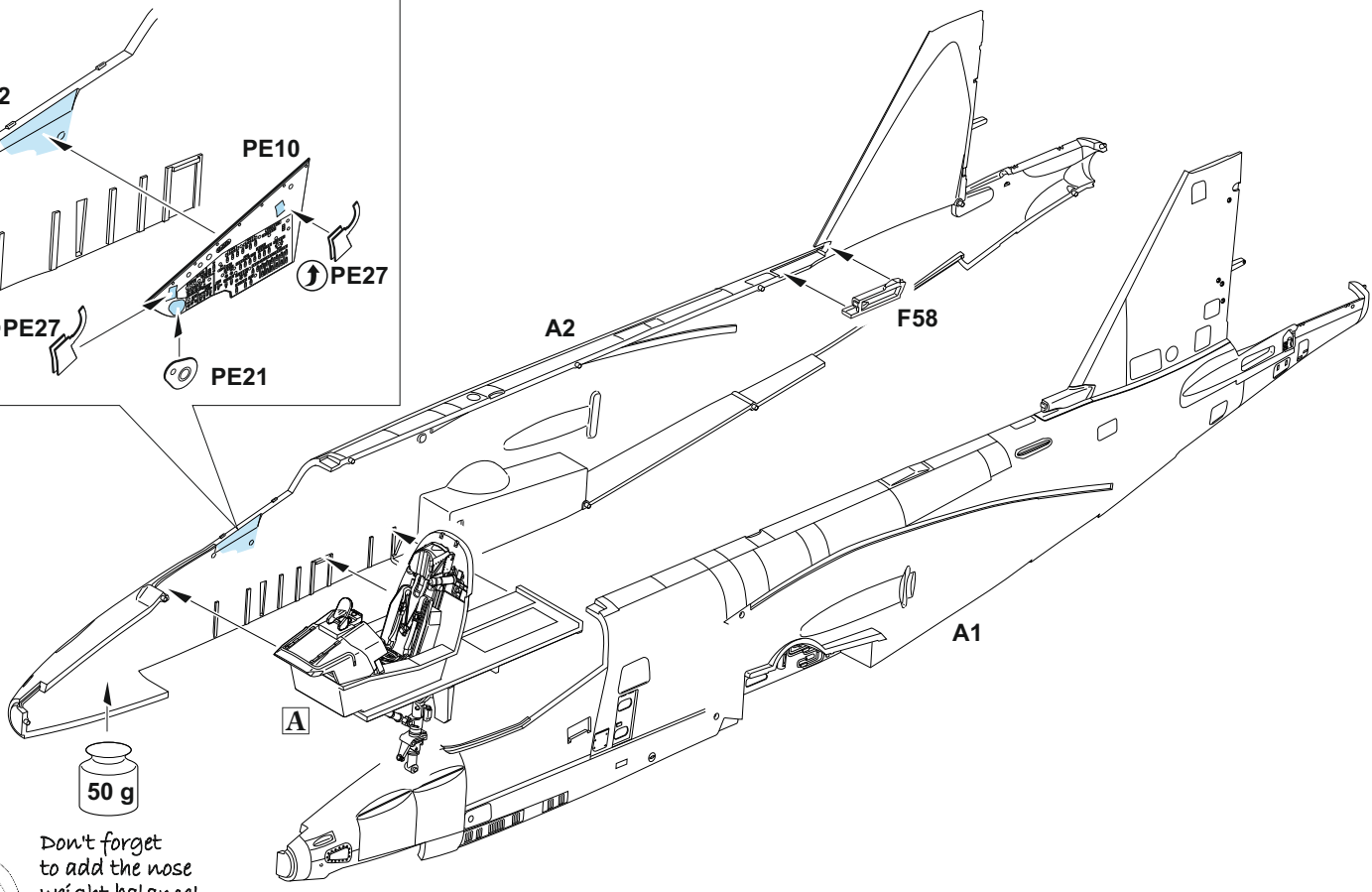
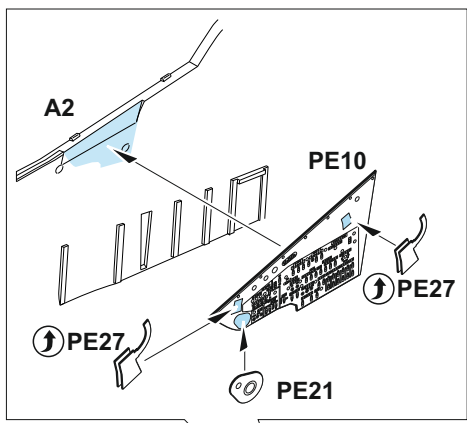
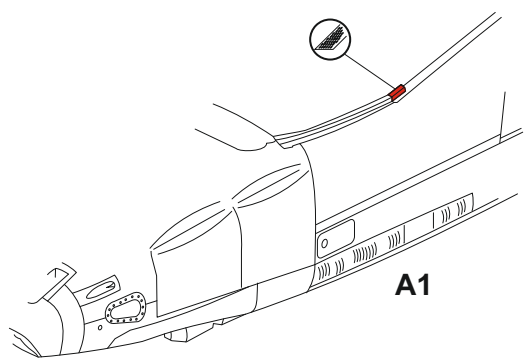
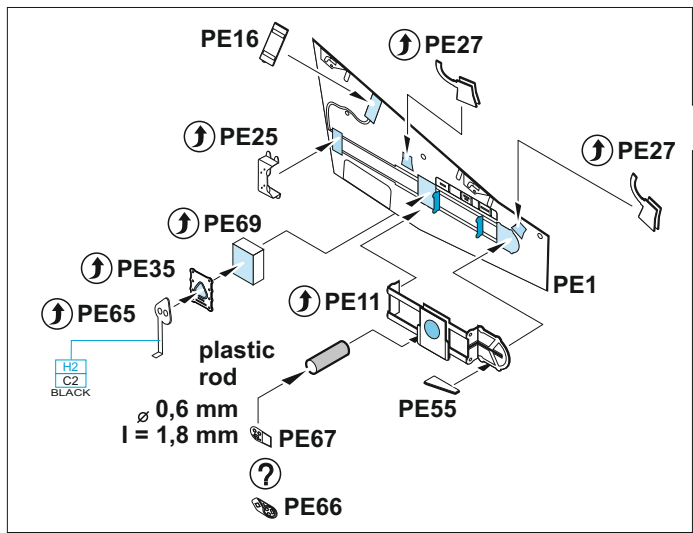
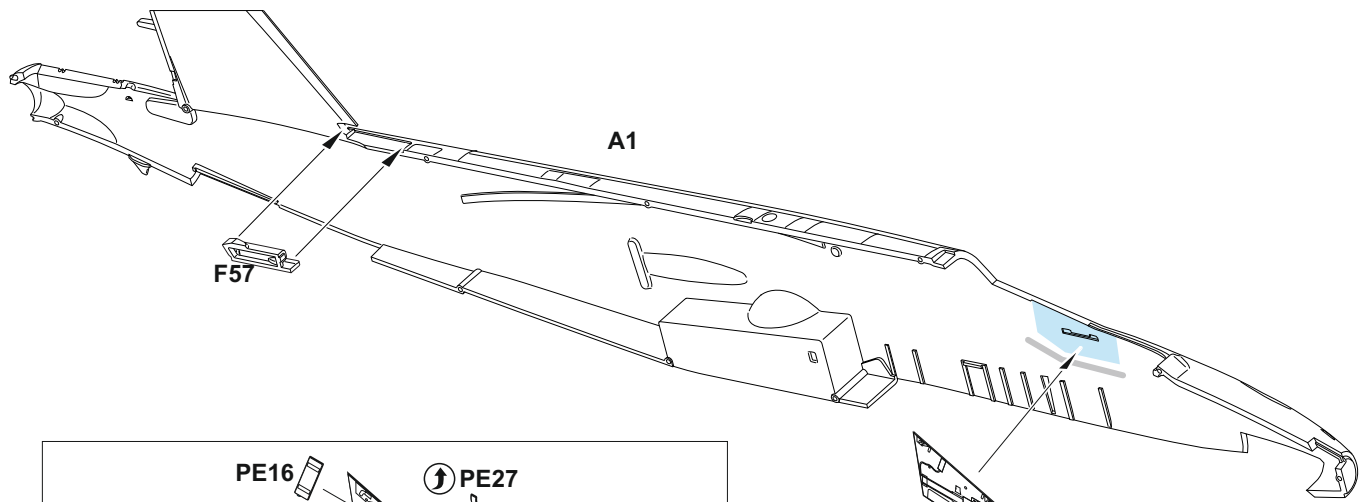

50 g

Don't forget to add the nose weight balance!



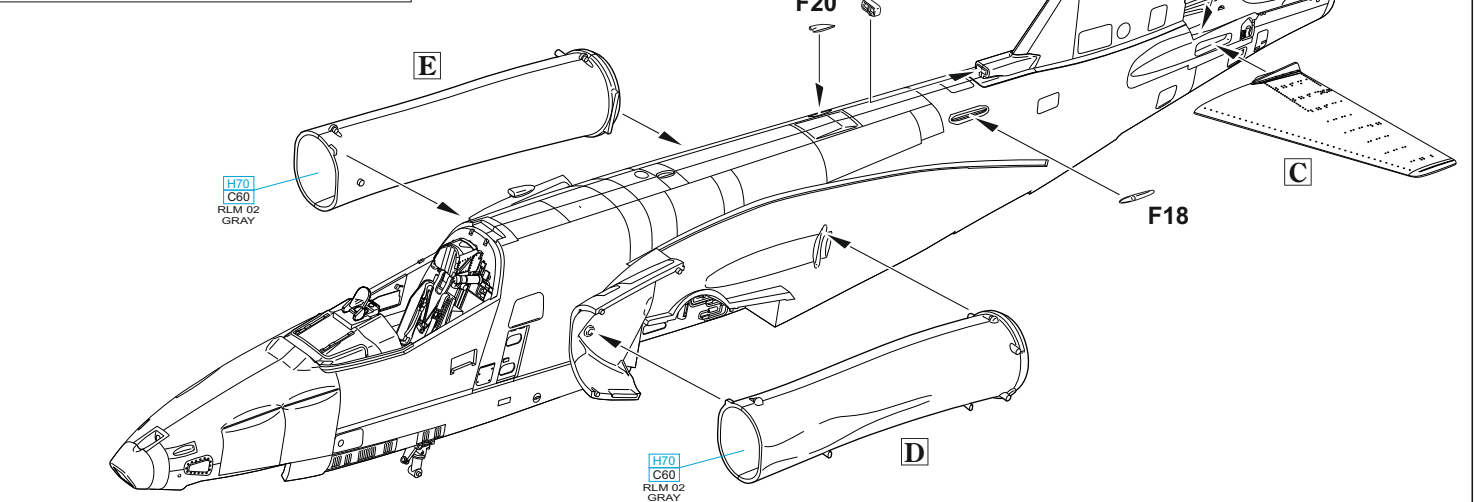
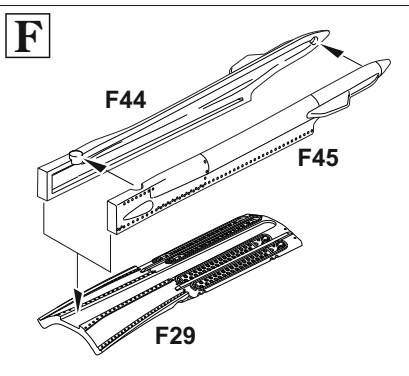
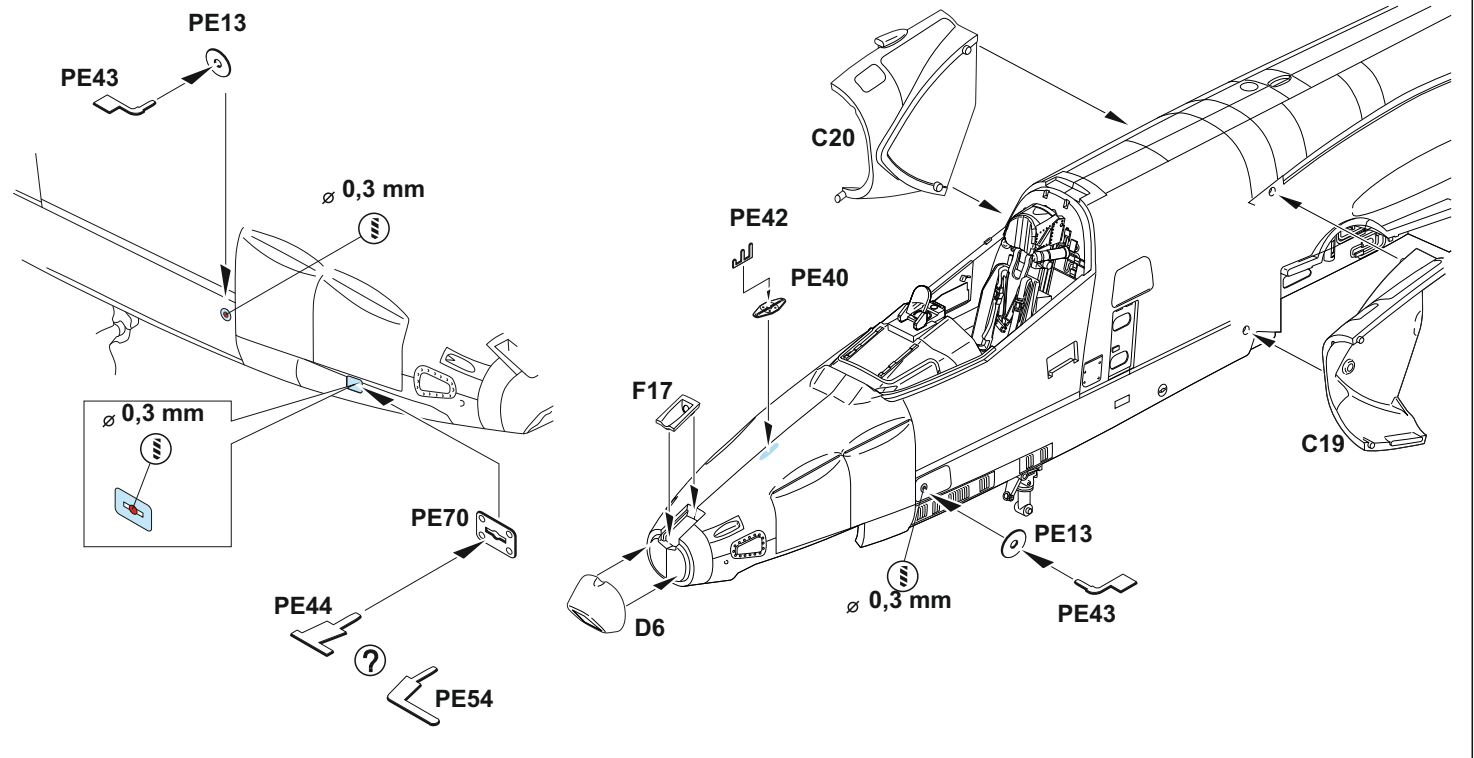
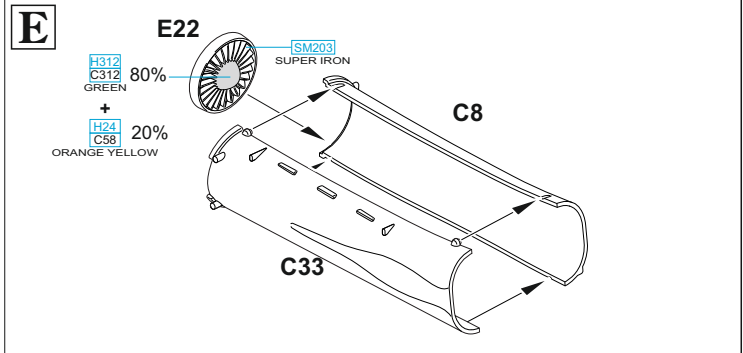
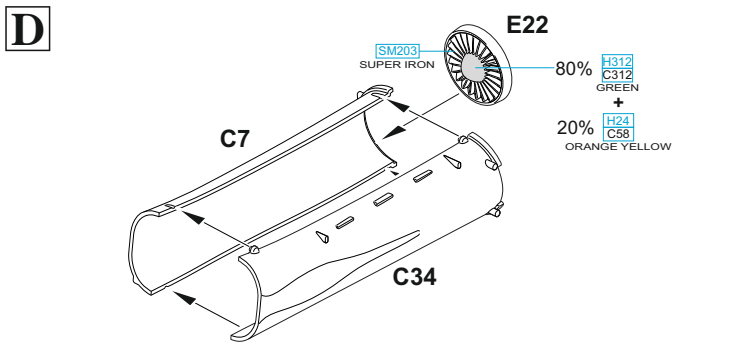

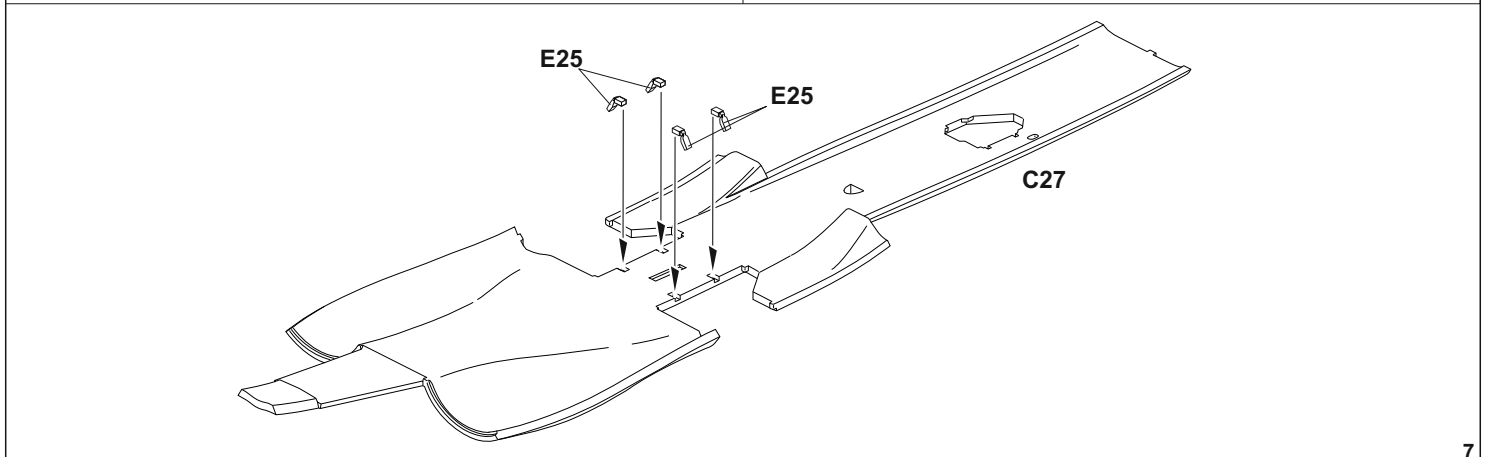
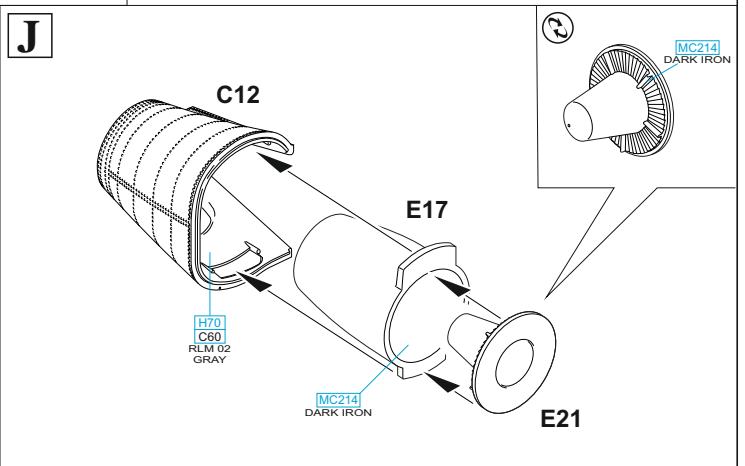
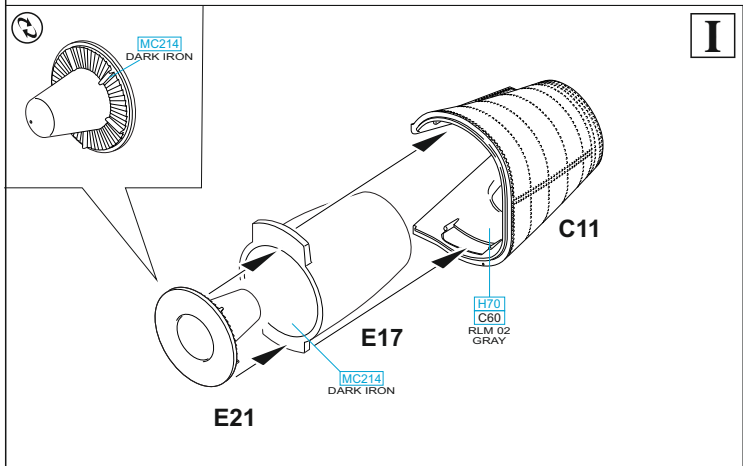
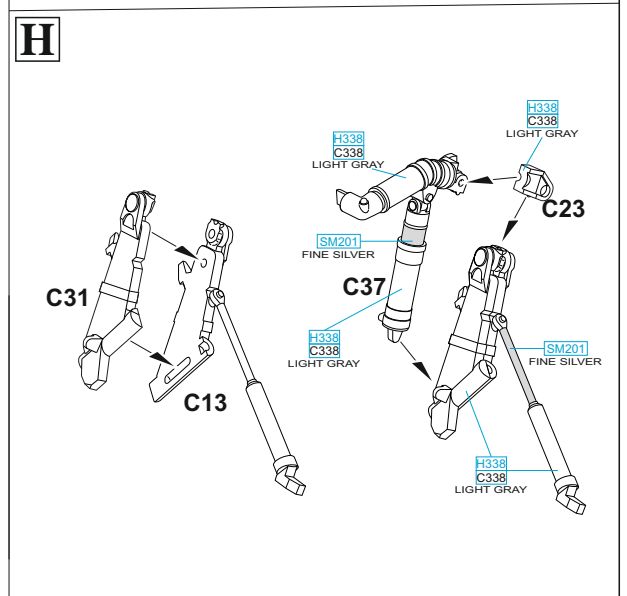
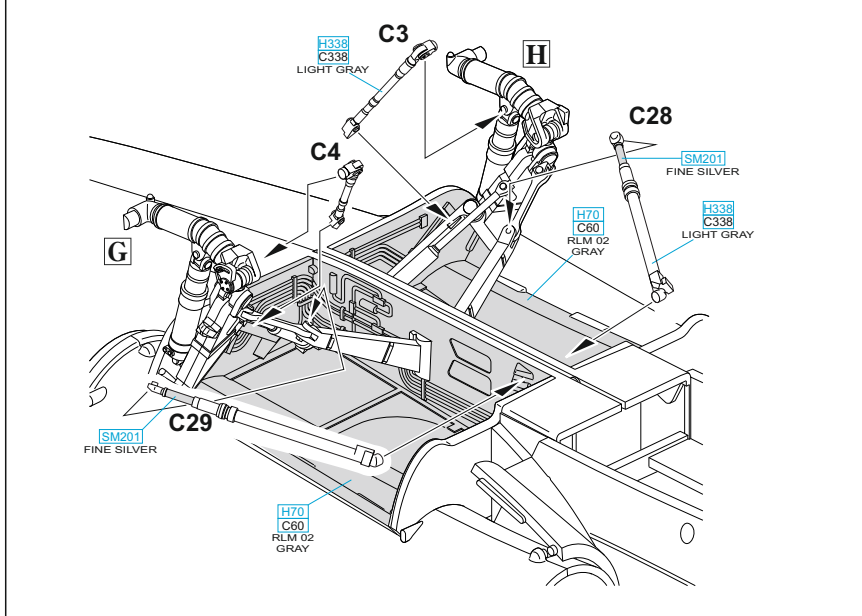
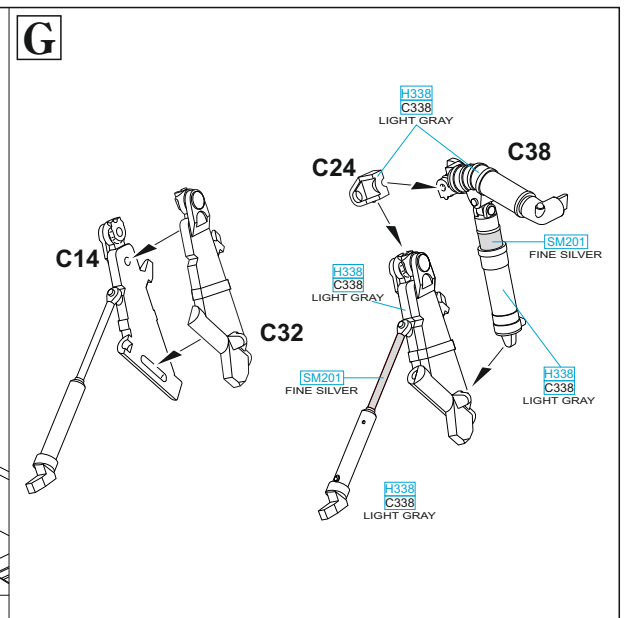
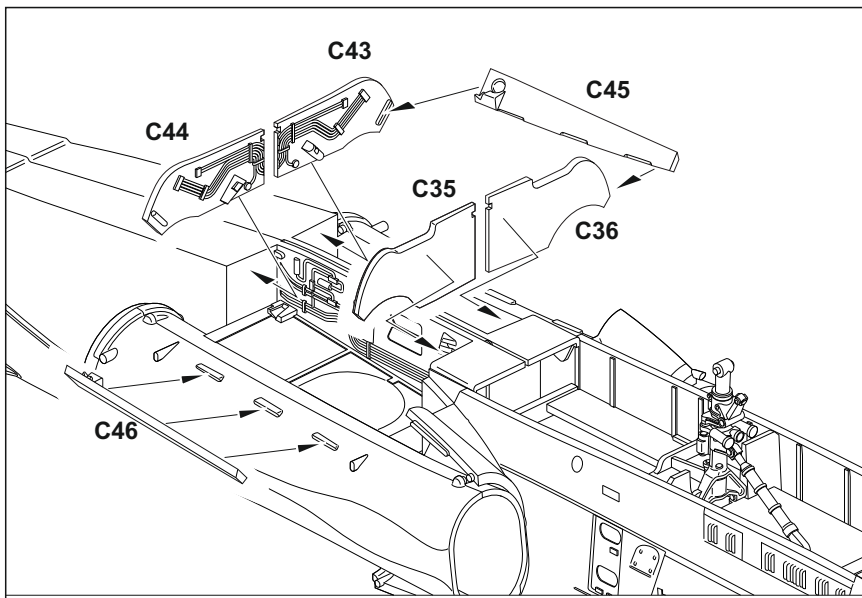

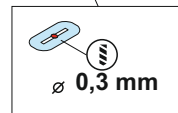
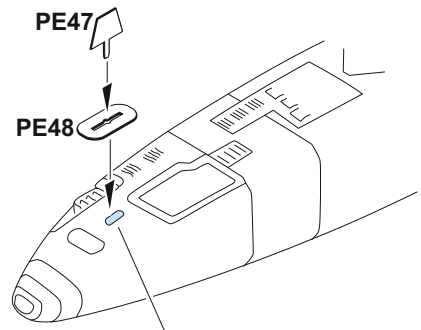
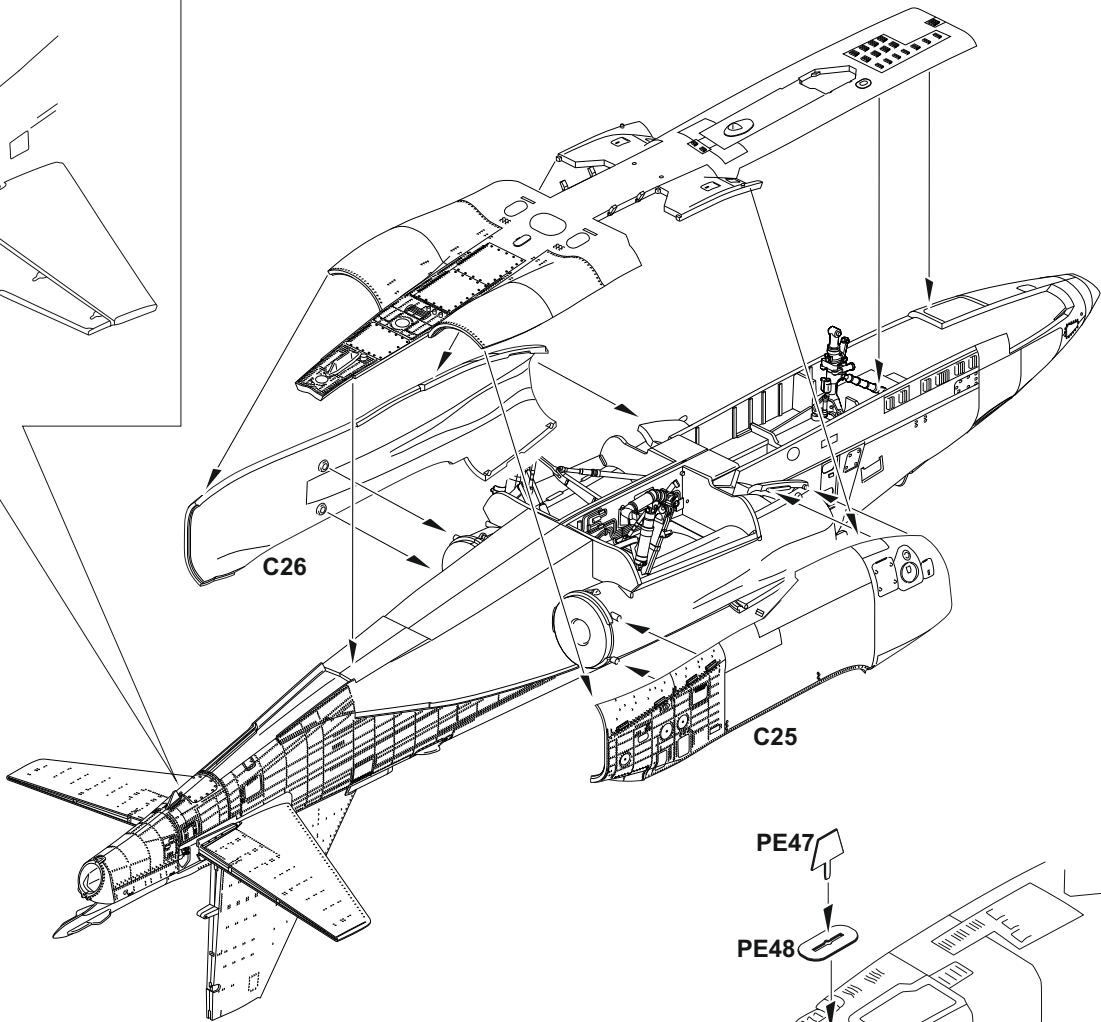
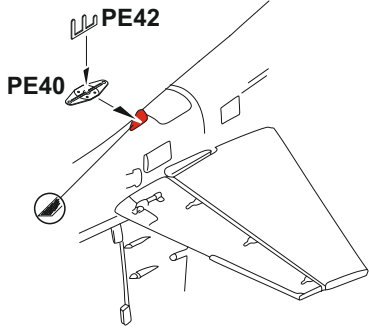

**K**

F52, F53 - MARKINGS **A, D, E, F, J**  
 R11 - MARKINGS **B, C, G, H, I**

MC214 DARK IRON

F53

F52

R11

MC214 DARK IRON

H70 C60 RLM 02 GRAY

**eduard BRASSIN**

F35

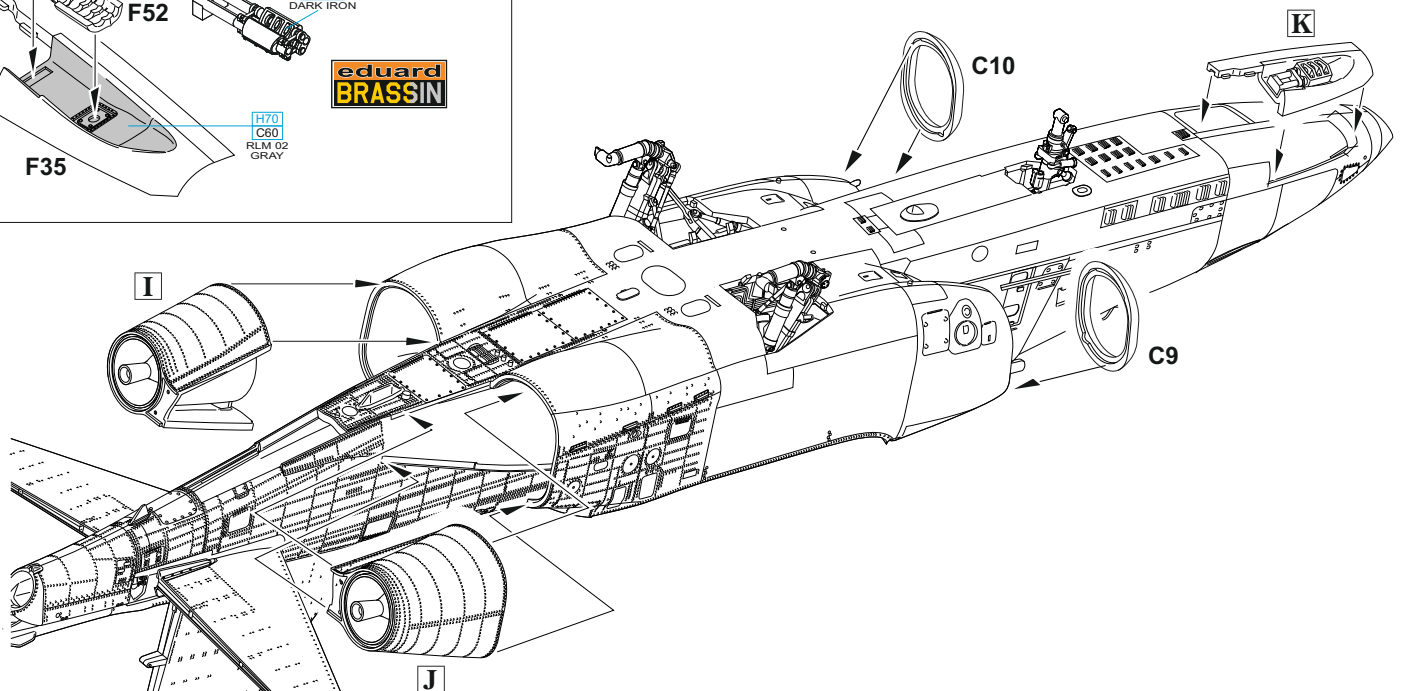

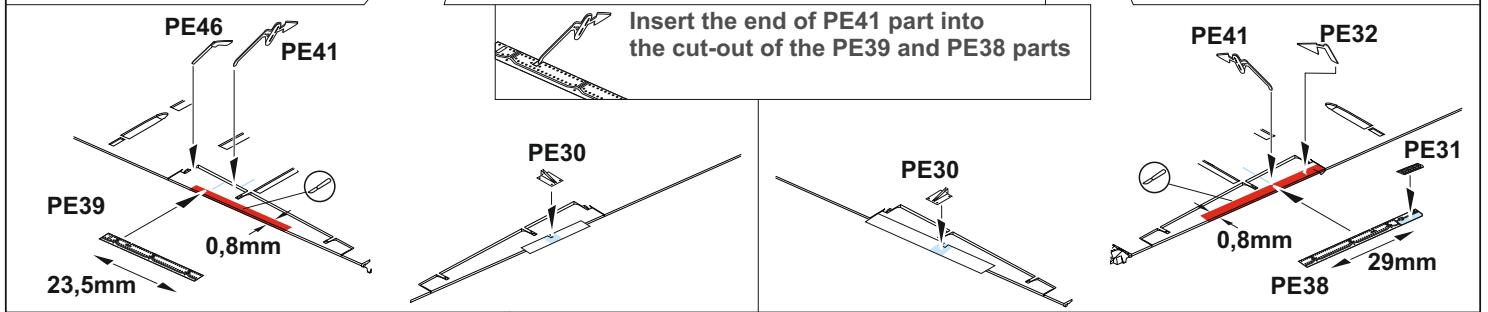
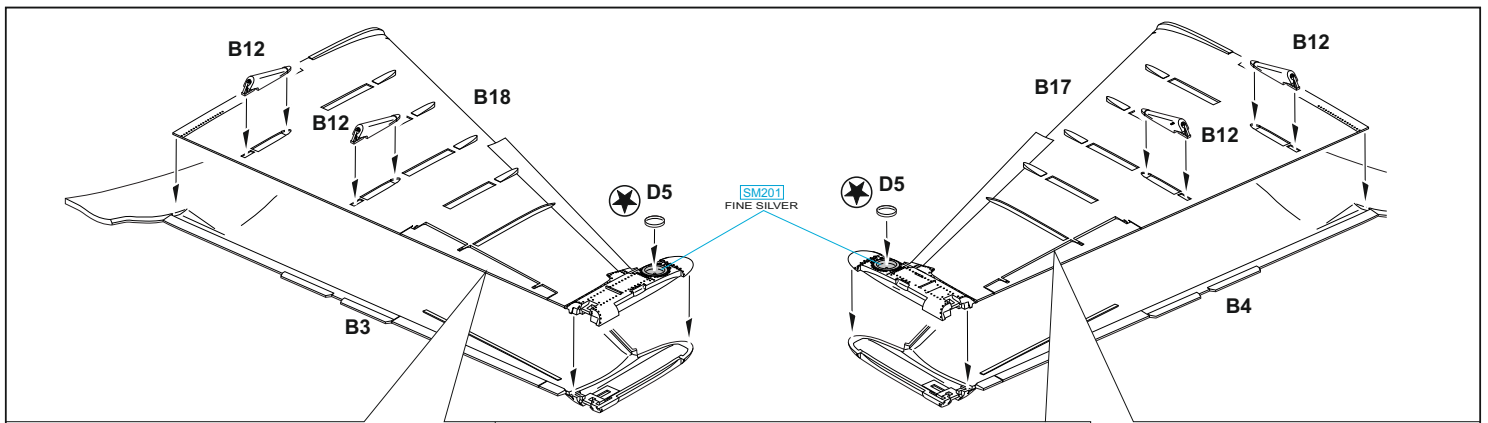

**L** MARKINGS A, D, E, F, G, H, I, J ONLY

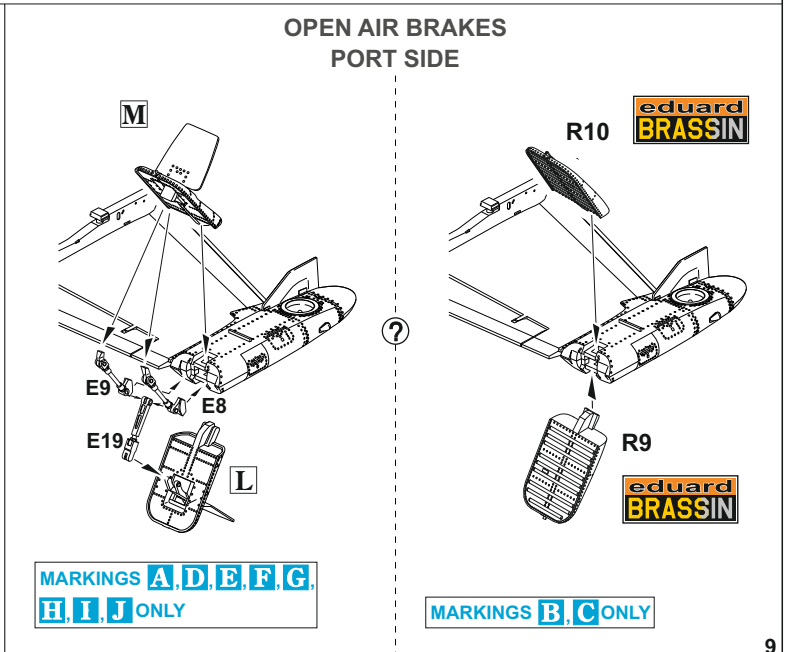
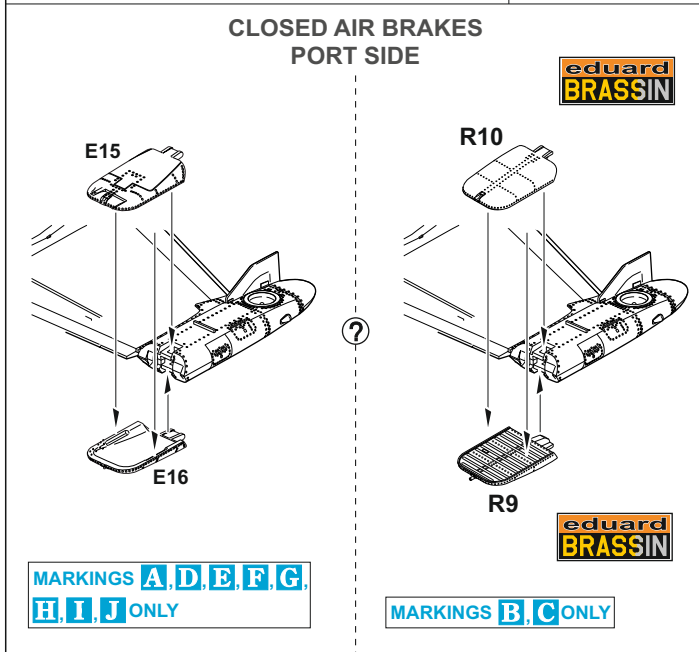
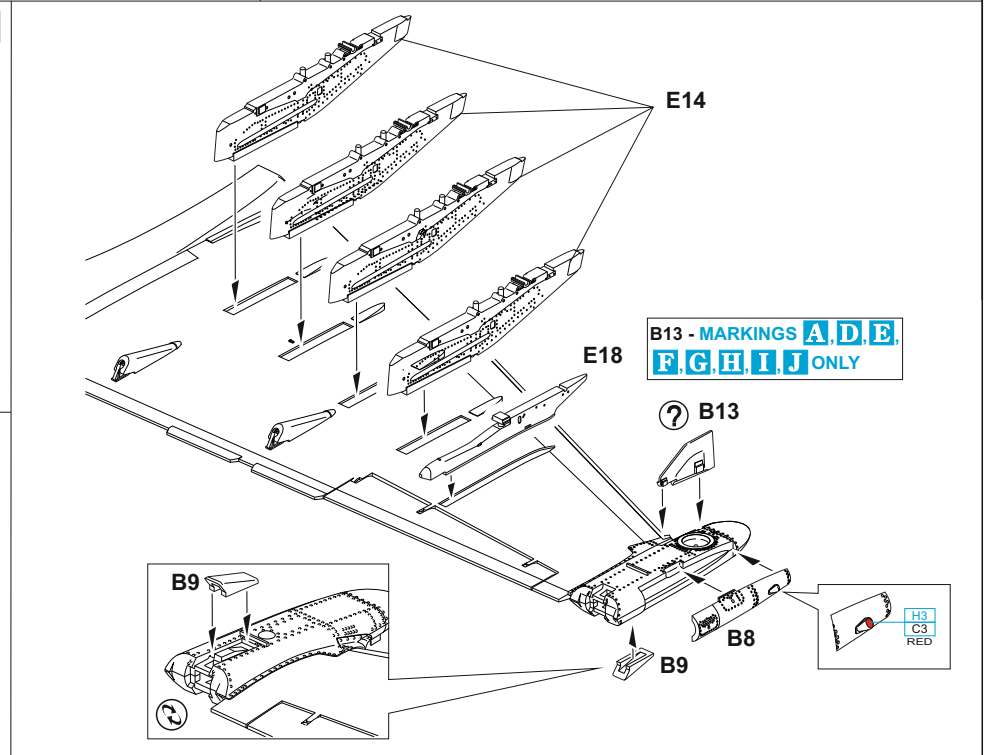
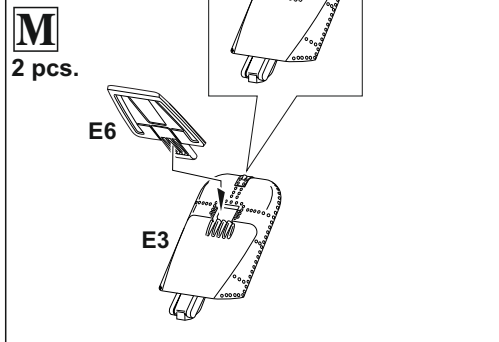
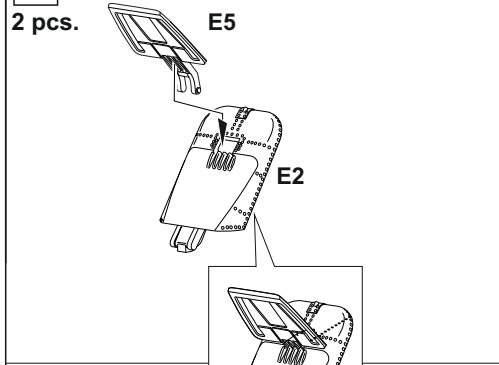

CLOSED AIR BRAKES  
STARBOARD SIDE

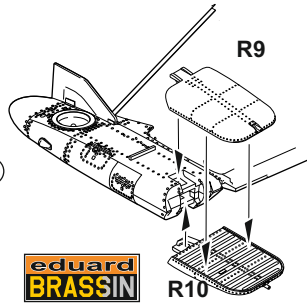
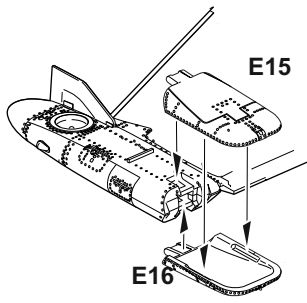

MARKINGS **A, D, E, F, G,**  
**H, I, J** ONLY

MARKINGS **B, C** ONLY

OPEN AIR BRAKES  
STARBOARD SIDE

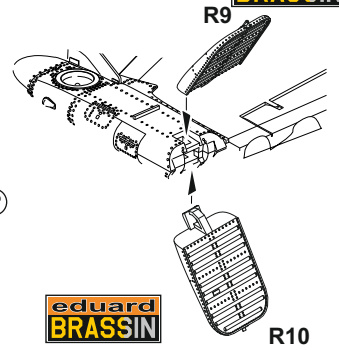
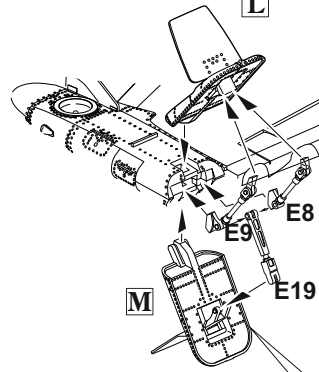

MARKINGS **A, D, E, F, G,**  
**H, I, J** ONLY

MARKINGS **B, C** ONLY

B14 - MARKINGS **A, D, E,**  
**F, G, H, I, J** ONLY

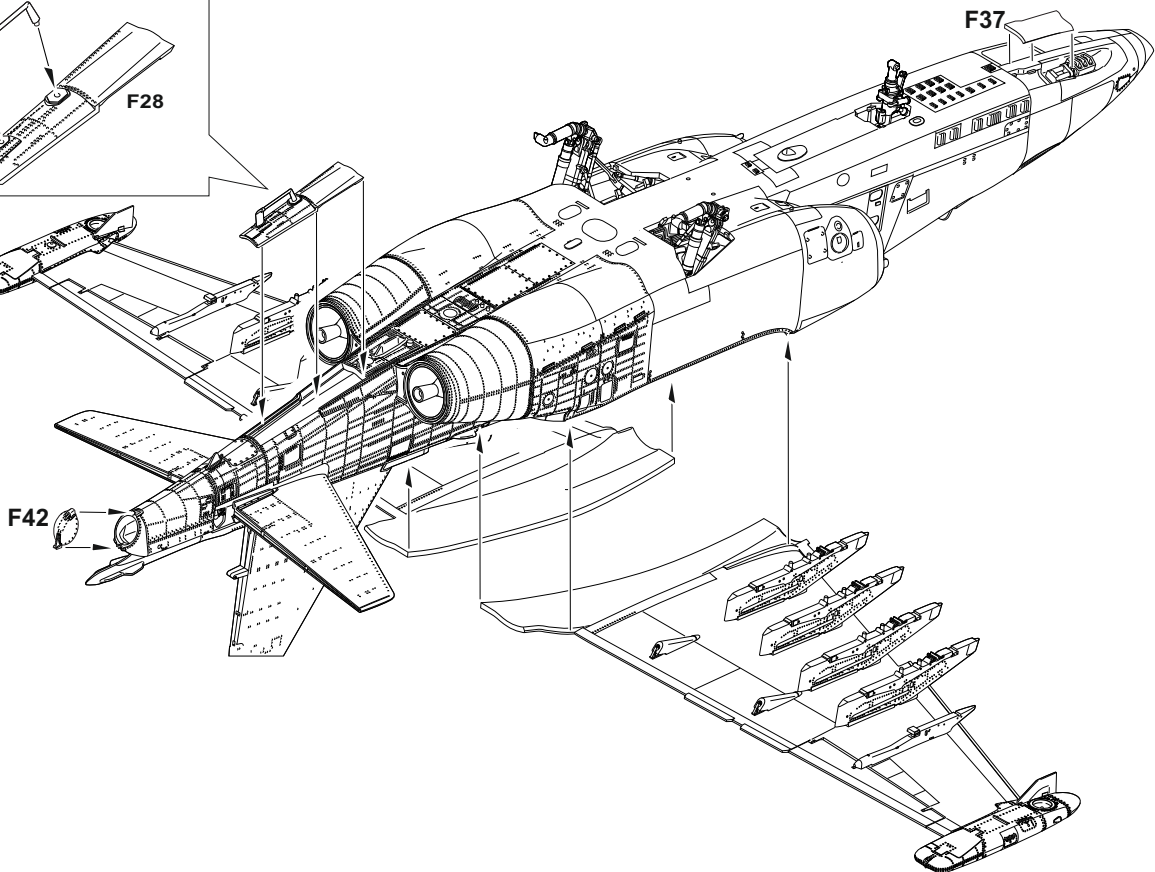
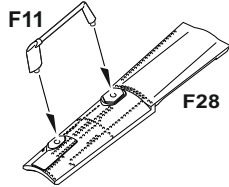
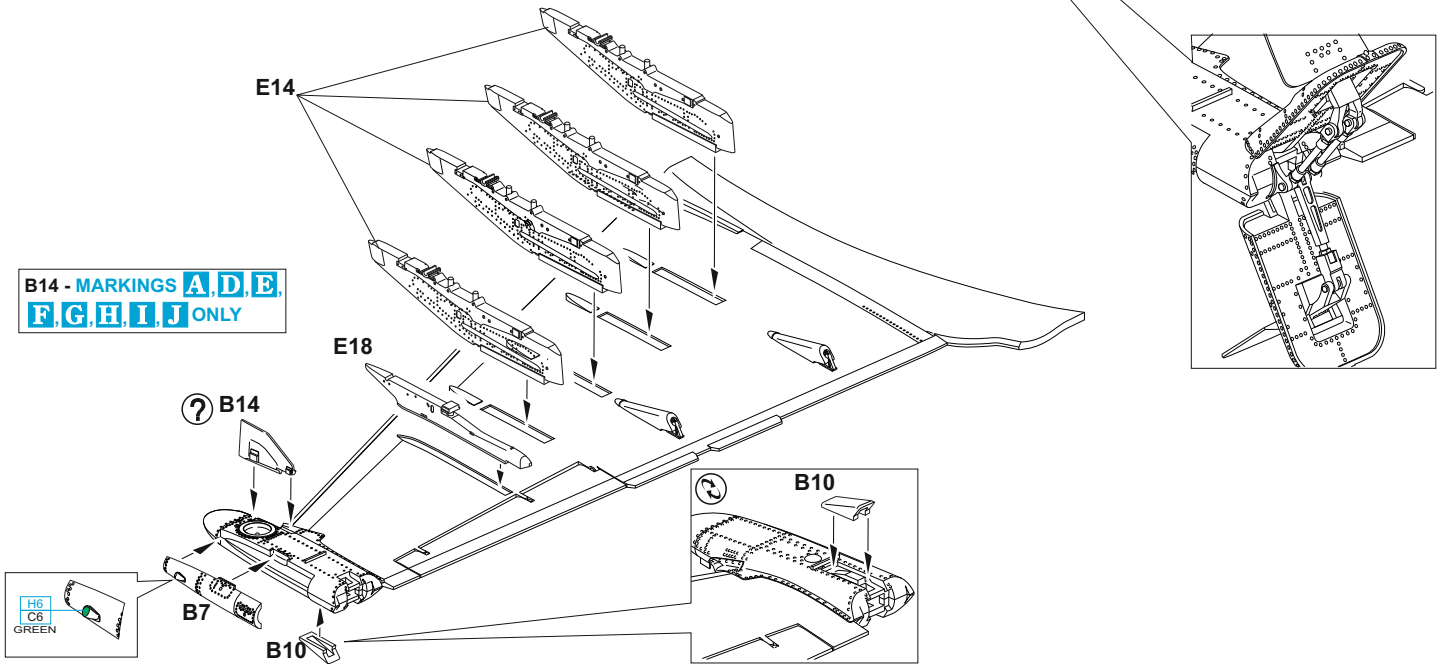

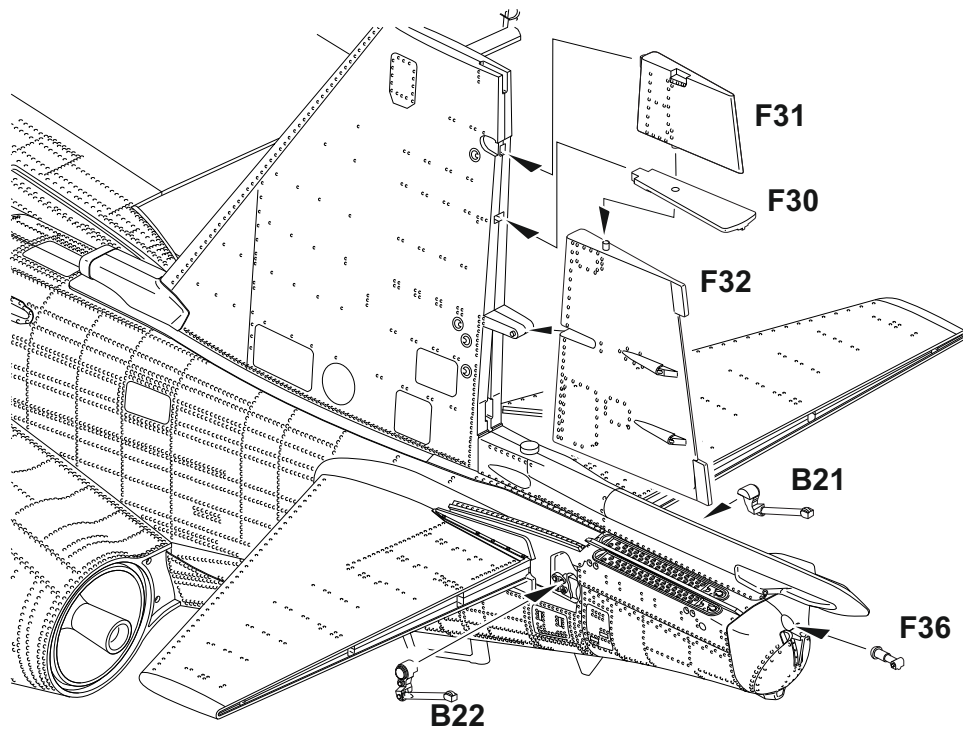

eduard  
BRASSIN

R12

R12

eduard  
BRASSIN

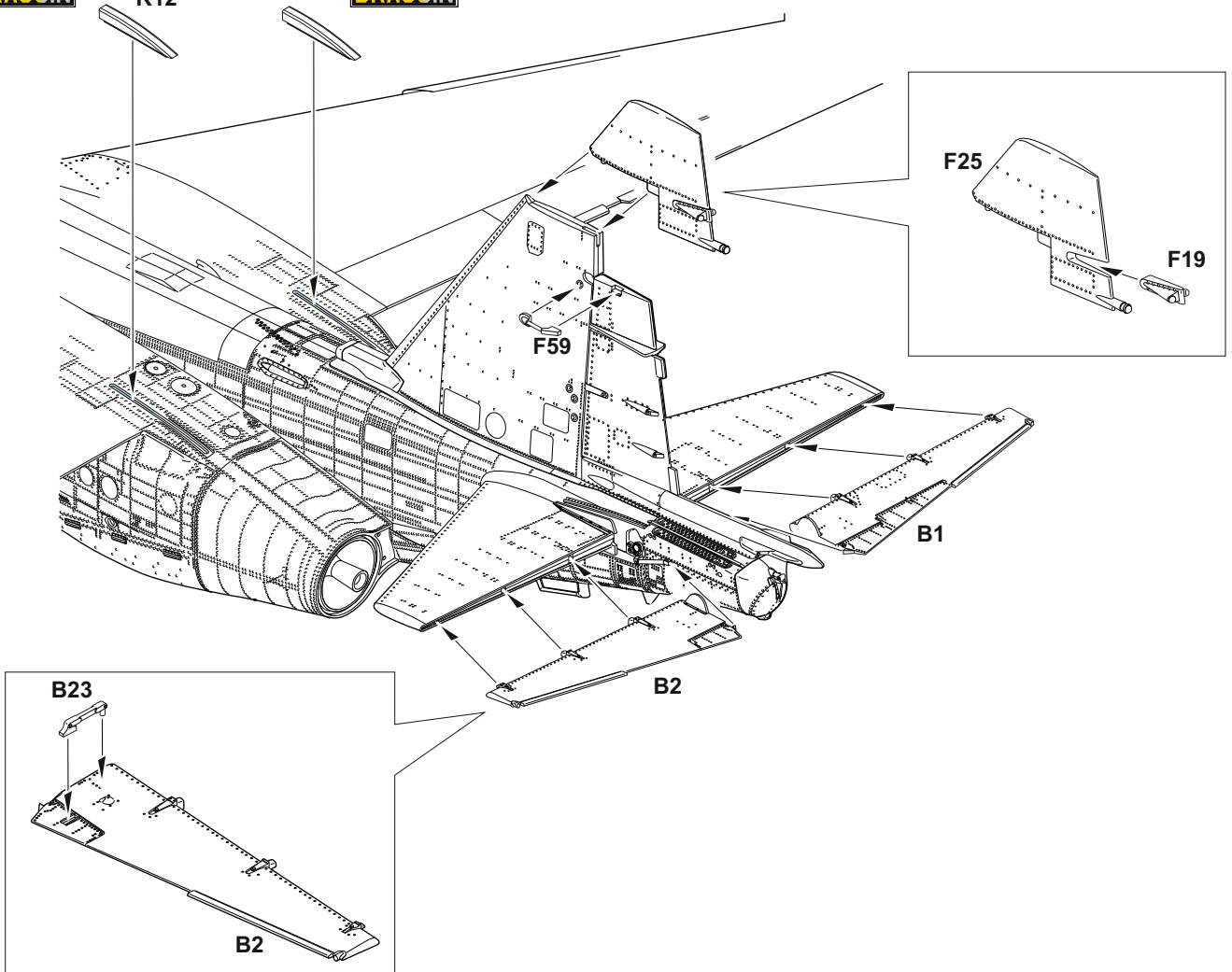

**eduard BRASSIN**

**R4** **R5**

H77 C137 TIRE BLACK

H26 C66 BRIGHT GREEN

**R6** **R8**

H77 C137 TIRE BLACK

H26 C66 BRIGHT GREEN

H12 C33 FLAT BLACK

H26 C66 BRIGHT GREEN

H57 C73 AIRCRAFT GRAY

H77 C137 TIRE BLACK

PE51 H26 C66 BRIGHT GREEN

**R8 - MARKINGS B, C ONLY**

**N** **O** **P**

H70 C60 RLM 02 GRAY

H70 C60 RLM 02 GRAY

H33 C81 RUSSET

H12 C33 FLAT BLACK

H338 C338 LIGHT GRAY

**N**

B26

H70 C60 RLM 02 GRAY

B20

**O**

B27

H70 C60 RLM 02 GRAY

B19

**P**

C30

H70 C60 RLM 02 GRAY

F49

E26

H338 C338 LIGHT GRAY

**Q**

K11

H33 C81 RUSSET

H12 C33 FLAT BLACK

H338 C338 LIGHT GRAY

K9

K12

K10

**R**

For painting of the external tanks follow the corresponding camouflage scheme

E13

E7

**MARKINGS B, C**

H12 C33 FLAT BLACK

PE7

PE58

PE59

PE68

**MARKINGS A, D, E, F, G, H, I, J**

H26 C66 BRIGHT GREEN

PE23

PE61

PE58

**D1** **F22** **F26** **F13**

H26 C66 BRIGHT GREEN

"ES" marked decal for individual aircraft

H325 C325 GRAY

F26

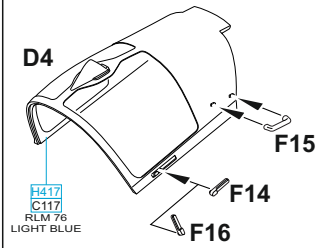
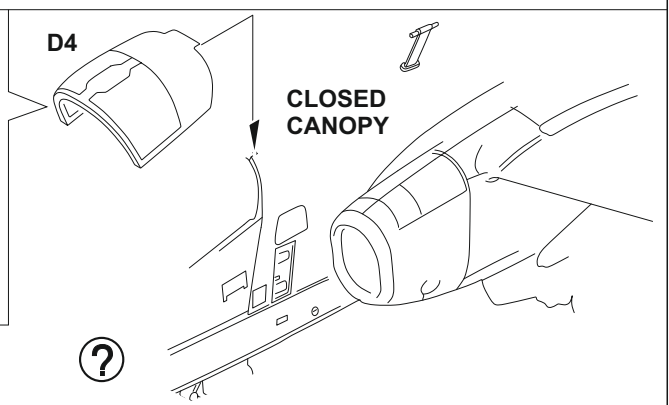
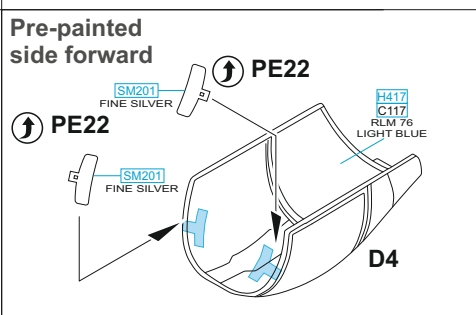
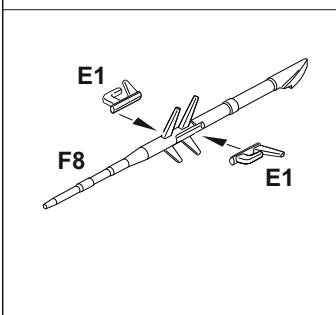
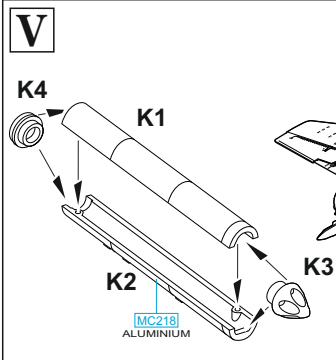
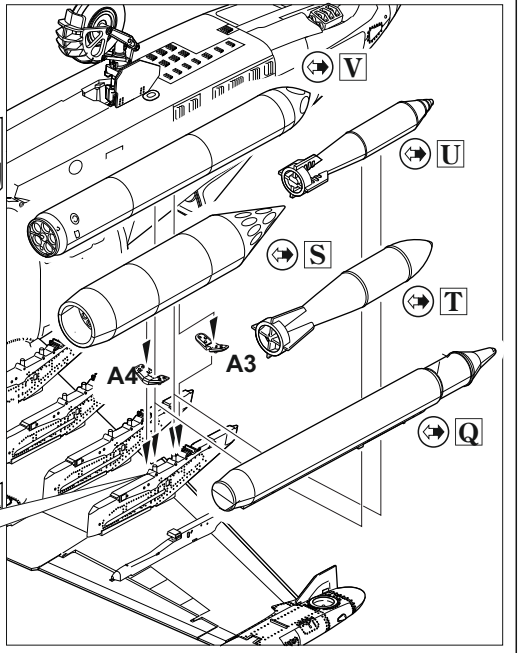
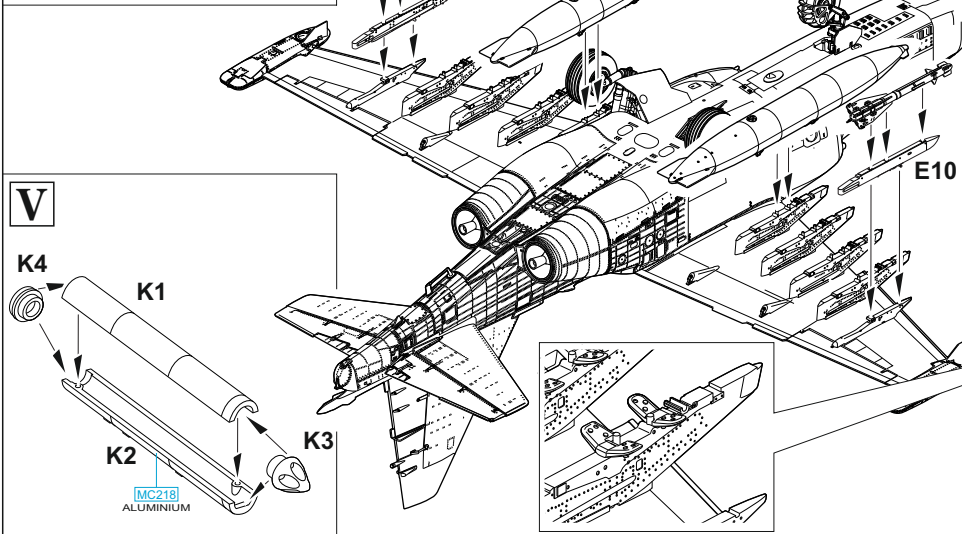
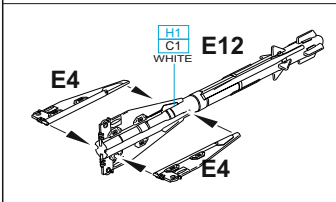
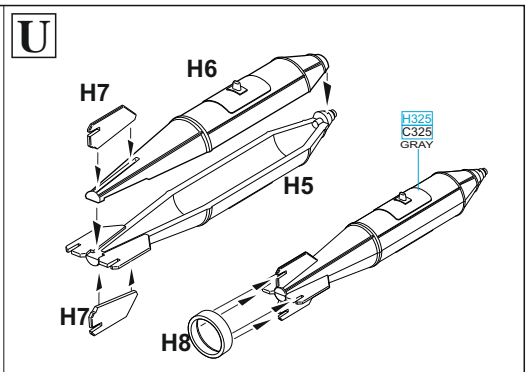
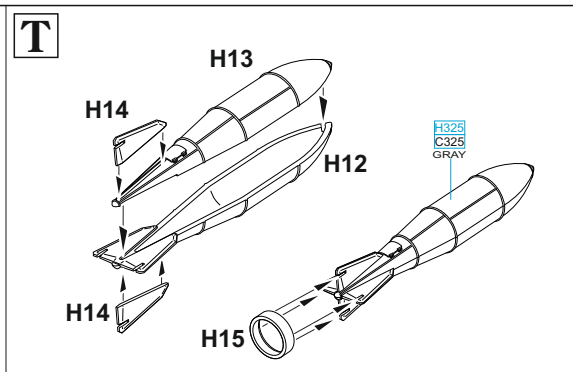
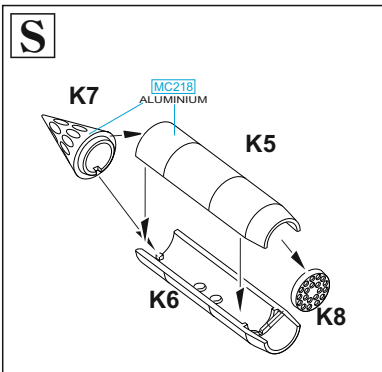

F5 - MARKINGS **A, D, E, F, G, H, I, J**  
R13 - MARKINGS **B, C**

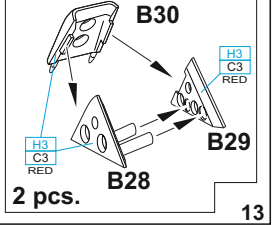
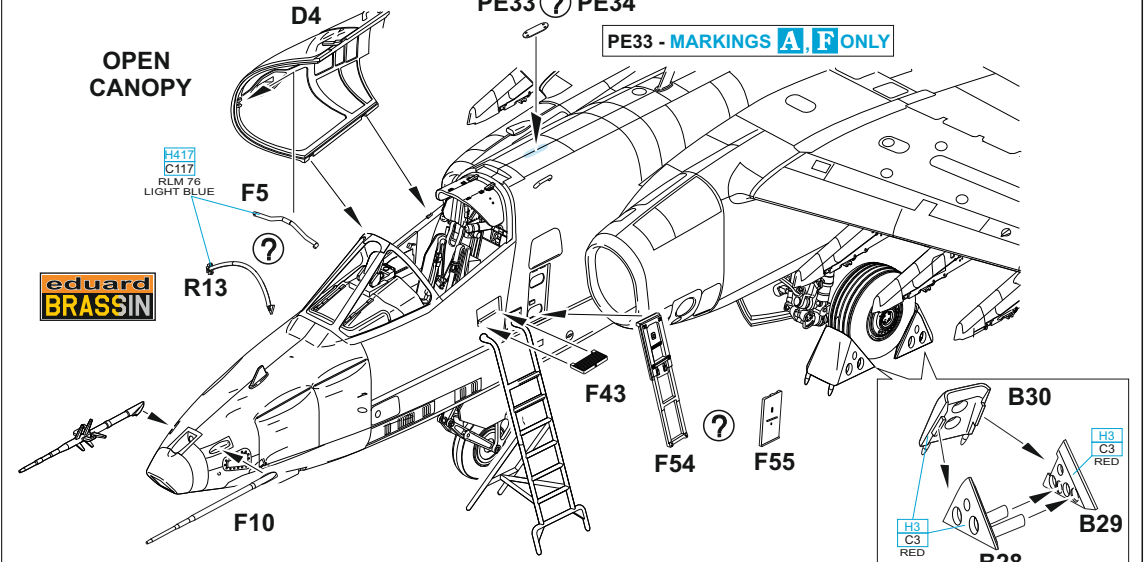

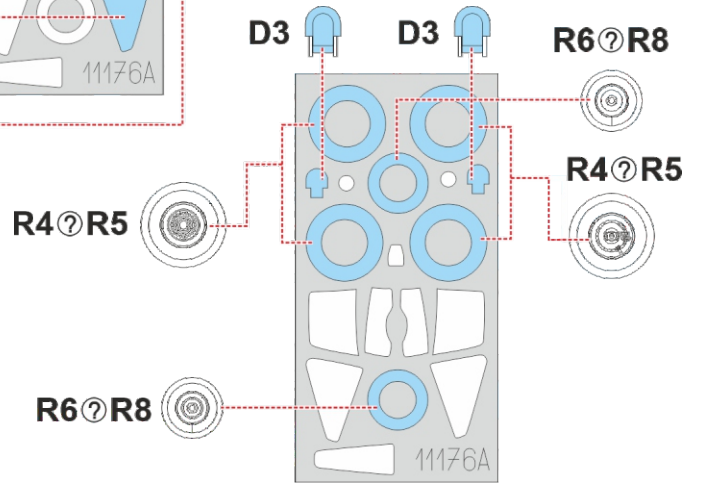
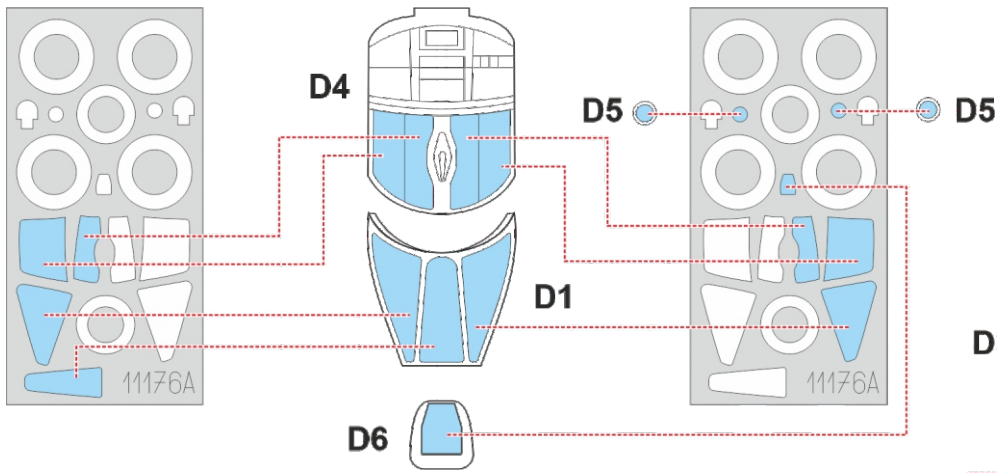

# Su-25

**PTB-800 – Russian stencils**

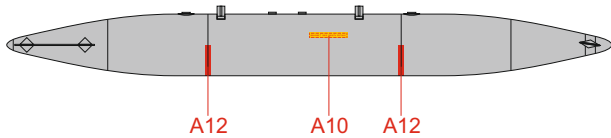
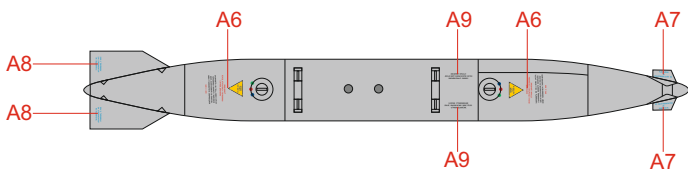
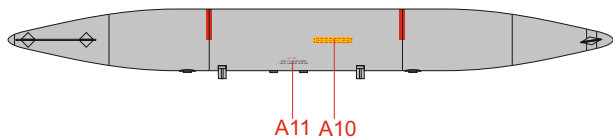

**PTB-800 – Slovak stencils**

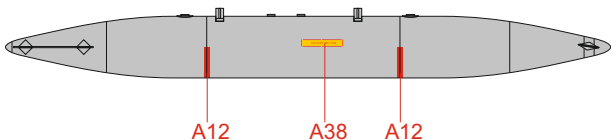
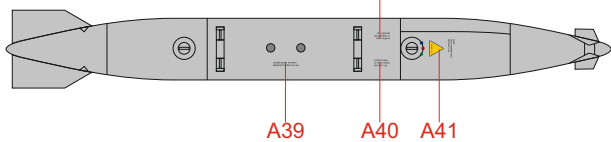
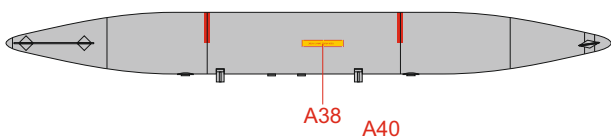

**S-25 OFM**

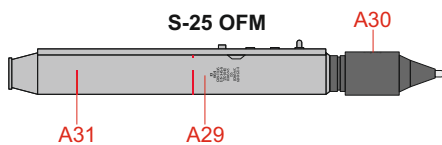

**FAB 500 M62**

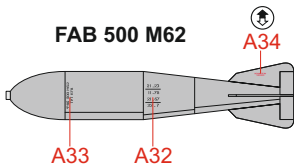

**RBK-250  
PTAB-2.5**

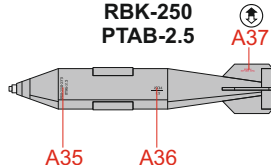

**APU-60**

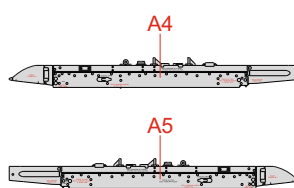

**R-60**

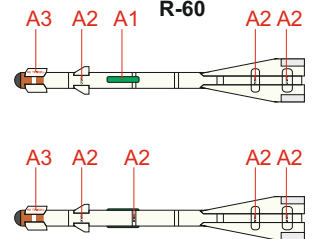

**B-8**

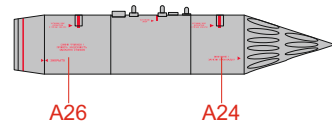
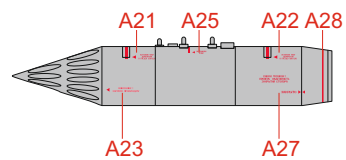

**B-13**

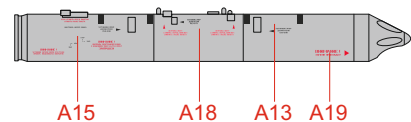
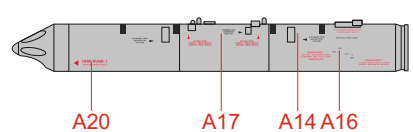

# STENCILING POSITIONS



# B 5007, 30 Fighter Bomber Regiment, Hradec Králové, Czechoslovakia, April 1984

One of the first delivery batch of eight Su-25Ks in their original form, i.e., with black fuselage numbers. The aircraft were delivered from the USSR with national insignia only, numbers were applied after acceptance by Czechoslovak Air Force. Aircraft of the series 5 and 6 were not equipped with lateral control boosters, i.e., control of the ailerons. Therefore, they were equipped with large trim tabs on the ailerons. The black fuselage numbers were difficult to read on the dark camouflage colors and were therefore outlined in white. Subsequently, they were painted in full white. While still with black number, the aircraft was shiny new and did not sport any signs of wear.

ČESKOU VERZI TEXTU NALEZNETE NA  
[www.eduard.com](http://www.eduard.com)  
 POD KATALOGOVÝM ČÍSLEM 11176

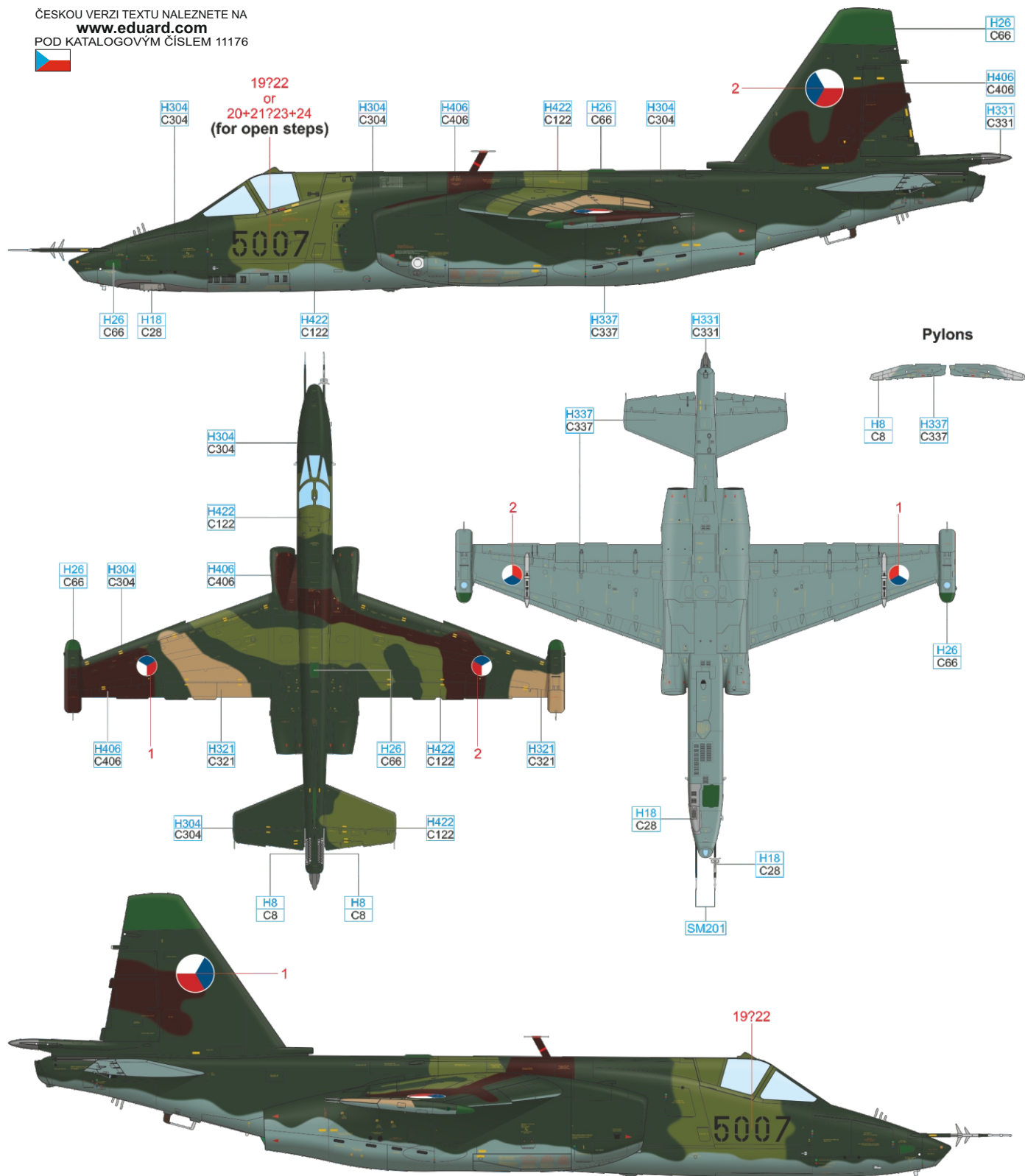

BRIGHT GREEN	H26 C66	STEEL	H18 C28	SILVER	H8 C8	DARK SEAGRAY	H331 C331	SUPER FINE SILVER 2	SM201
GRAYISH BLUE	H337 C337	OLIVE DRAB	H304 C304	GREEN	H422 C122	LIGHT BROWN	H321 C321	BROWN	H406 C406

# C 6019, 30 Attack Aviation Regiment, Pardubice, Czechoslovakia, August 1988

Various nose arts appeared on the Czechoslovak Su-25Ks. The first attempts were just quickly and easily removable chalk drawings. Such a drawing, the silhouette of a seated girl with a screwdriver, was sketched on this aircraft as well, and as there were no objections from the commanding officers, it was decided to paint colorful and more durable nose art. Aircraft engineer Antonín Fidranský decided to create a drawing of a girl and a shark's mouth by washable colors. Also, the emblem of the 30 Attack Aviation Regiment, last used on the MiG-15bisSB, appeared on this aircraft. The painting of "Anča" (Annie) as the aircraft was named, probably occurred on the weekend of August 20 and 21, 1988, just before the planned live ammunition gunnery exercise. But the taxiing accident of aircraft No. 1008 dashed any hope of getting the "Anča" into the air, because the incident was followed by the arrival of the AAIC (Aircraft Accident Inquiry Commission). Due to that, the paintwork was quickly washed out to avoid any unwanted interest from the AAIC. This aircraft was manufactured on October 18, 1984, and first flown in Czechoslovakia on January 18, 1985. The last flight was conducted on May 27, 1998. When discharged, the aircraft had 917 hrs logged and 15 mins of flight time. After its retirement it was sold to the USA on April 10, 2004.

ČESKOU VERZI TEXTU NALEZNETE NA  
[www.eduard.com](http://www.eduard.com)  
 POD KATALOGOVÝM ČÍSLEM 11176

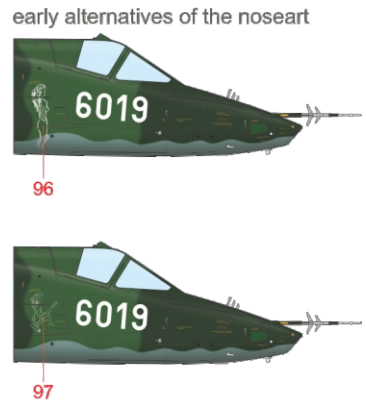
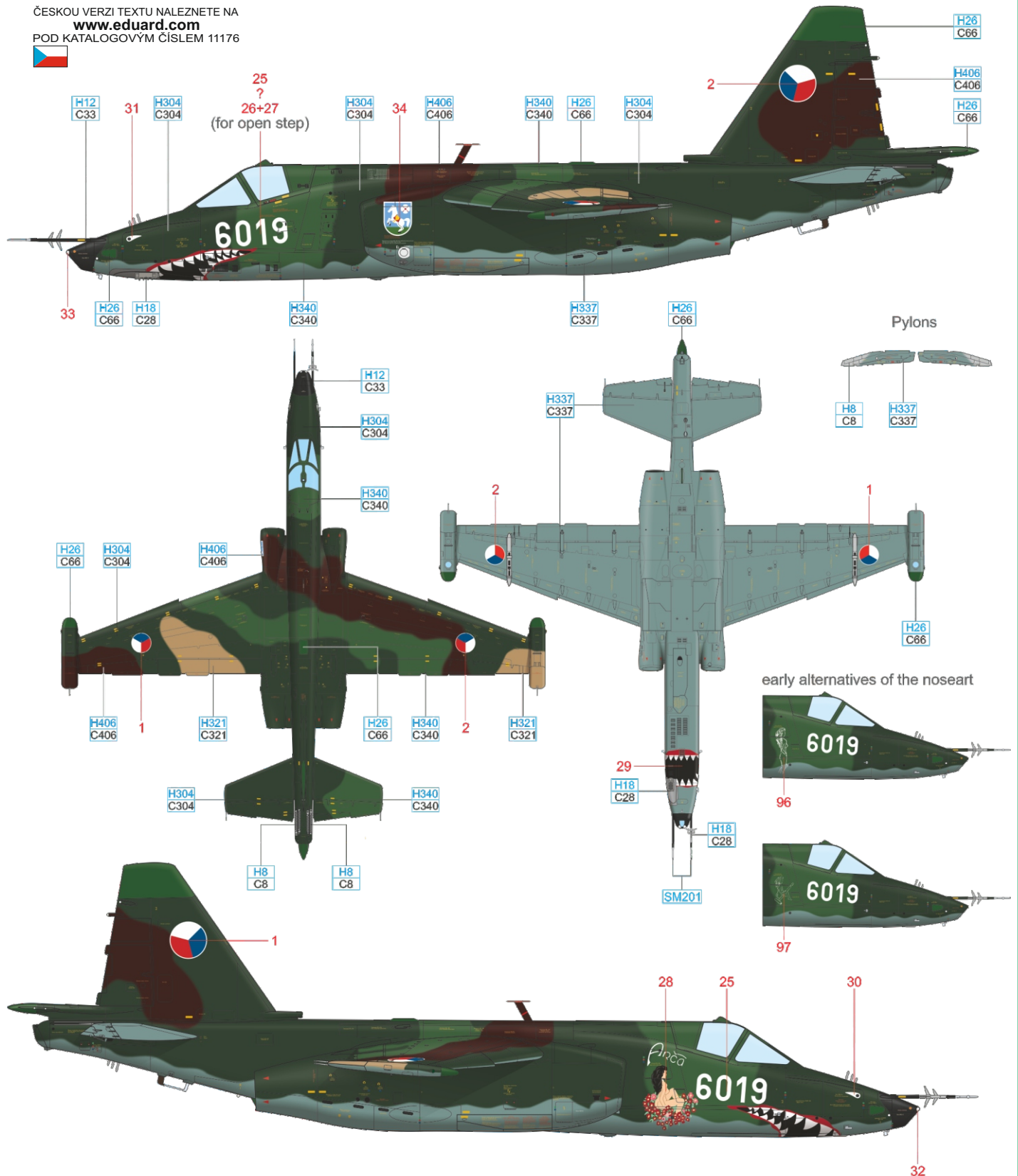

BRIGHT GREEN	H26 C66	STEEL	H18 C28	SILVER	H8 C8	FLAT BLACK	H12 C33	SUPER FINE SILVER 2	SM201
GRAYISH BLUE	H337 C337	OLIVE DRAB	H304 C304	FIELD GREEN	H340 C340	LIGHT BROWN	H321 C321	BROWN	H406 C406

# D 1002, 30 Attack Aviation Regiment, Pardubice, Czech Republic, May 1993

Aircraft of fuselage number 1002 changed its camouflage and markings several times. In May 1993, it underwent a revision of R-1 level at the Čáslav Aircraft Repair Base and a distinctive shark's mouth, red trim on the white fuselage number and a large 30 Attack Aviation Regiment inscription on the directional stabilizer were applied. Less than a year later, the entire vertical fin and rudder were painted in tricolor livery with Lubrifilm company advertisement. This Su-25K was manufactured in Tbilisi on May 15, 1987, and landed at the Pardubice base on June 27 of the same year. It was one of the aircraft that were transferred to the air base in Náměšť in 1994. In 1996 it was overhauled and discharged in 2001 after a total flight time of 703 hrs and 43 mins. The aircraft was sold to a new user in 2003.

ČESKOU VERZI TEXTU NALEZNETE NA  
[www.eduard.com](http://www.eduard.com)  
 POD KATALOGOVÝM ČÍSLEM 11176

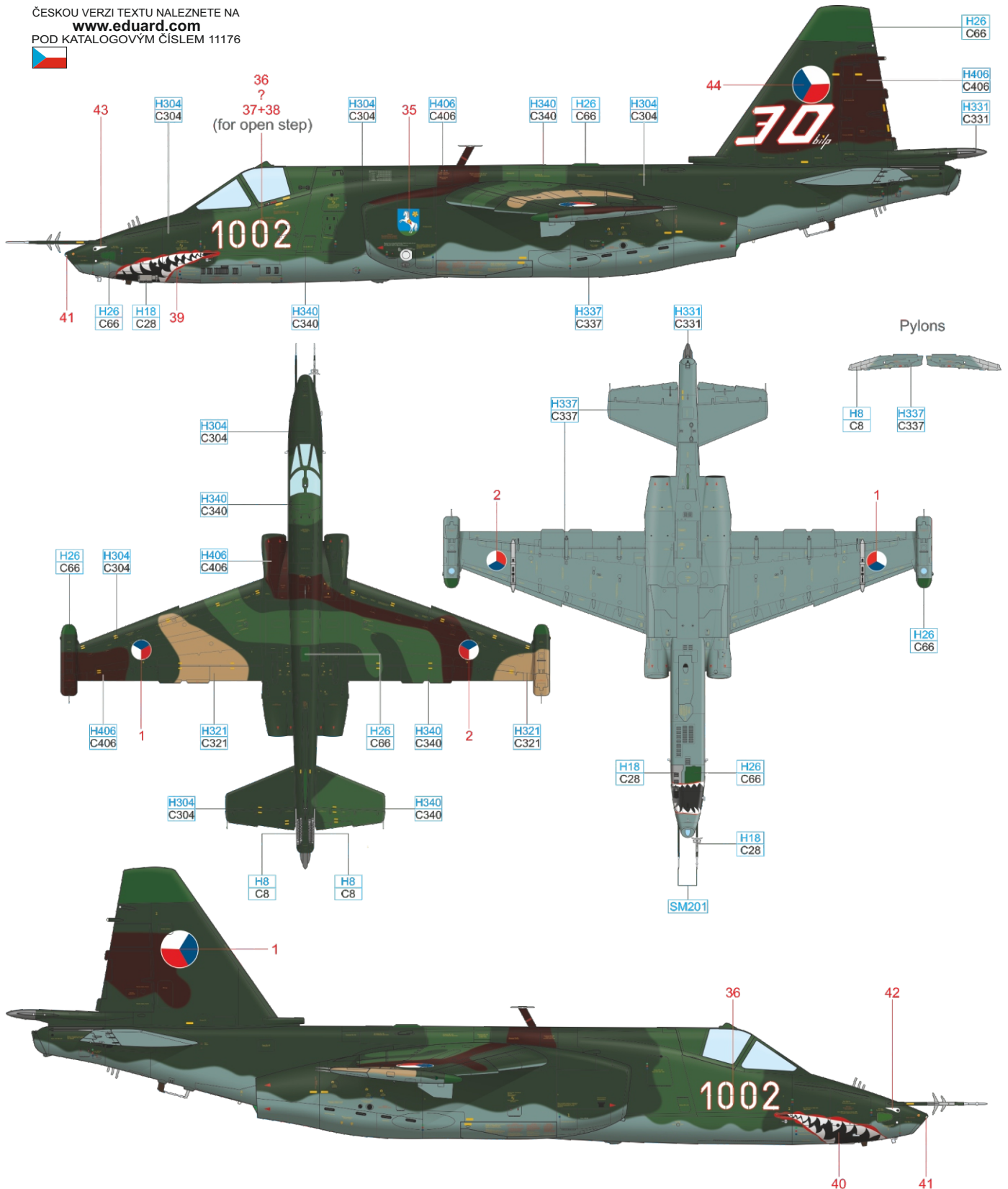

BRIGHT GREEN	H26 C66	STEEL	H18 C28	SILVER	H8 C8	DARK SEAGRAY	H331 C331	SUPER FINE SILVER 2	SM201
GRAYISH BLUE	H337 C337	OLIVE DRAB	H304 C304	FIELD GREEN	H340 C340	LIGHT BROWN	H321 C321	BROWN	H406 C406





Along with the 1002, the 8076 was also painted in a special livery. In its case, it was an application of the eagle motif that the 322 TS had as its emblem. The implementation of this coloring took only three days from May 15 to 17. The aircraft had the original camouflage in good condition and so received only the nose paint job and, as was customary, the auxiliary tanks were also decorated accordingly.

ČESKOU VERZI TEXTU NALEZNETE NA  
[www.eduard.com](http://www.eduard.com)

POD KATALOGOVÝM ČÍSLEM 11176

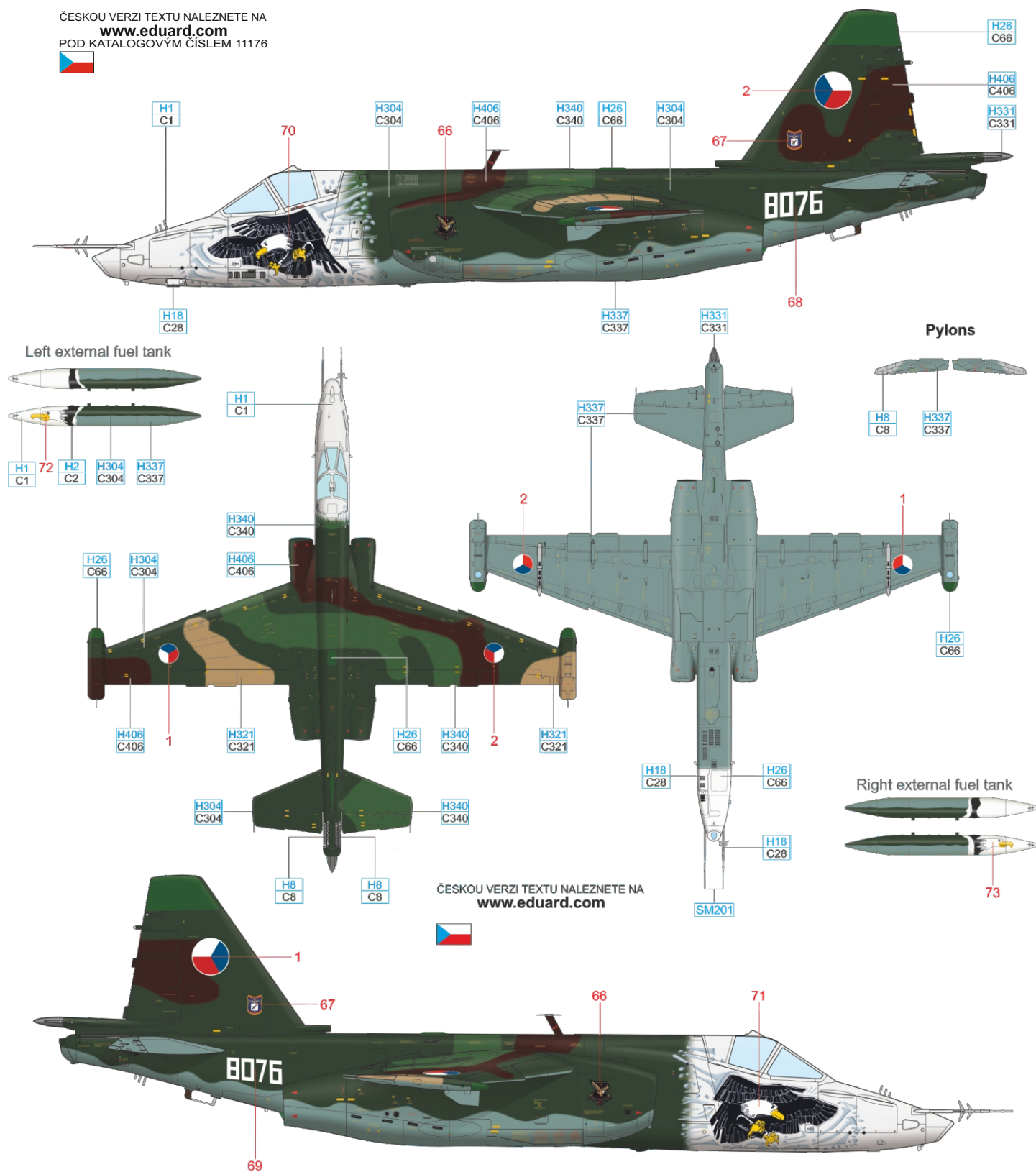

ČESKOU VERZI TEXTU NALEZNETE NA  
[www.eduard.com](http://www.eduard.com)



WHITE	H1 C1	BLACK	H2 C2				
BRIGHT GREEN	H26 C66	STEEL	H18 C28	SILVER	H8 C8	DARK SEAGRAY	H331 C331
GRAYISH BLUE	H337 C337	OLIVE DRAB	H304 C304	FIELD GREEN	H340 C340	LIGHT BROWN	H321 C321
						BROWN	H406 C406
							SUPER FINE SILVER 2
							SM201





# J 1027, 3 Fighter Bomber Regiment, Trenčín airfield, Slovakia, August 1994

The Slovak Su-25K named "Bizon" (Buffalo) became the most attractively colored Slovak aircraft of the type. The design was created by Pavol Homer and Jozef Horváth. Preparations started on July 17, 1994 and the "Bizon" flew for the first time on July 28 and 29 with the unfinished paint job. It was completed on August 14 and it was presented in premiere at the SIAF 1994 Air Show on August 21 in Bratislava. The "Bizon" was the only Su-25 that also bore the emblem of the 1 Technical Squadron. After completing its service in the Slovak Air Force, the aircraft was sold in 2004 to Armenia.

ČESKOU VERZI TEXTU NALEZNETE NA  
[www.eduard.com](http://www.eduard.com)  
 POD KATALOGOVÝM ČÍSLEM 11176

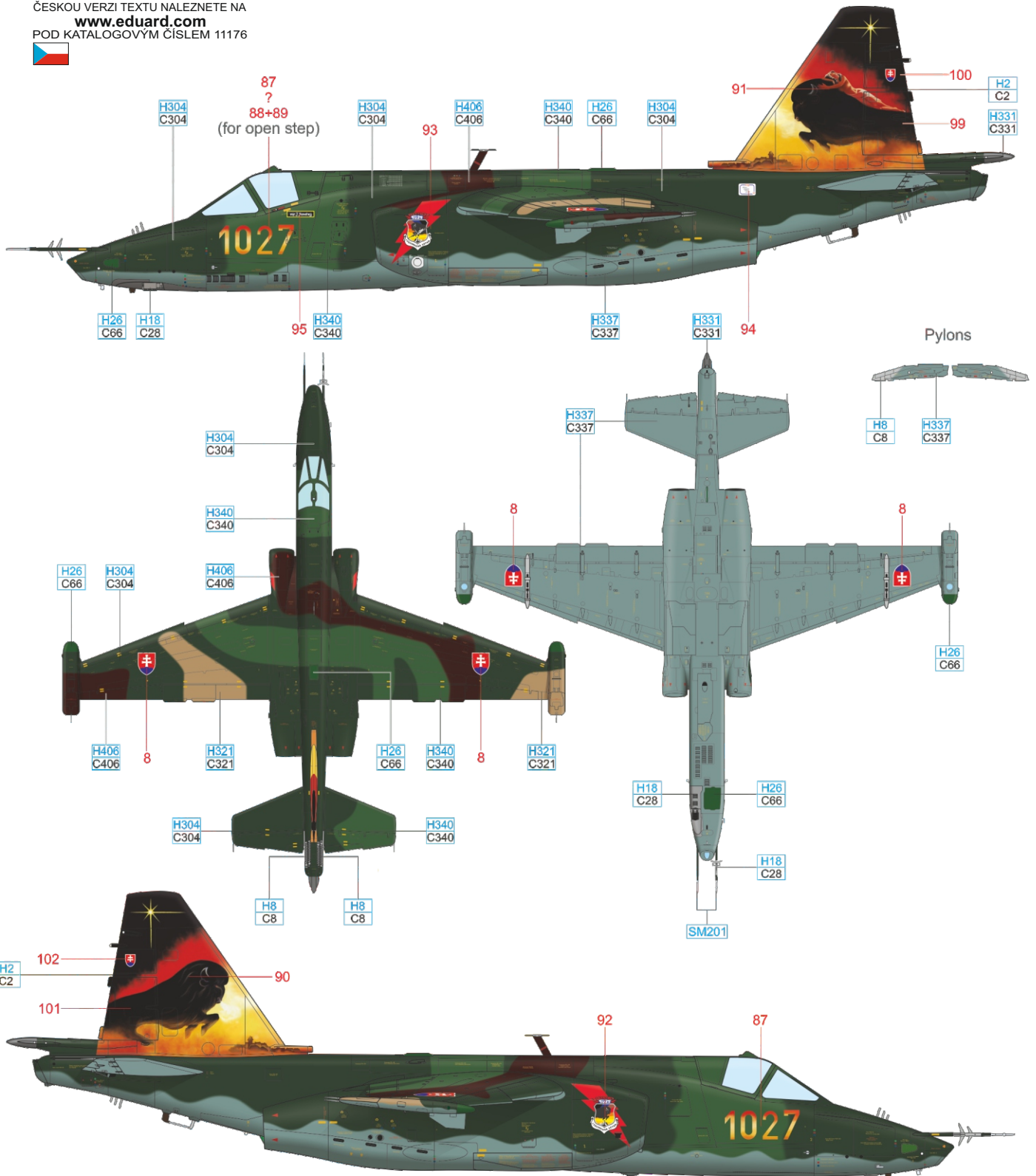

BRIGHT GREEN	H26 C66	STEEL	H18 C28	SILVER	H8 C8	DARK SEAGRAY	H331 C331	SUPER FINE SILVER 2	SM201
GRAYISH BLUE	H337 C337	OLIVE DRAB	H304 C304	FIELD GREEN	H340 C340	LIGHT BROWN	H321 C321	BROWN	H406 C406
								BLACK	H2 C2

