

eduard

**LIMITED
EDITION**

15,000th

P-40N *Warhawk*



INSTRUCTION SHEET



1/48

11193-NAV 1

ATTENTION



UPOZORNĚNÍ



ACHTUNG



ATTENTION



注意



Carefully read instruction sheet before assembling. When you use glue or paint, do not use near open flame and use in well ventilated room. Keep out of reach of small children. Children must not be allowed to suck any part, or pull vinyl bag over the head.



Před započítím stavby si pečlivě prostudujte stavební návod. Při používání barev a lepidel pracujte v dobře větrané místnosti. Lepidla ani barvy nepoužívejte v blízkosti otevřeného ohně. Model není určen malým dětem, mohlo by dojít k požití drobných dílů.

INSTRUCTION SIGNS



INSTR. SYMBOLS



INSTRUKTION SINNBILDEN



SYMBLES

記号の説明

OPTIONAL
VOLBABEND
OHNOUTSAND
BROUSITOPEN HOLE
VYVRTAT OTVORSYMETRICAL ASSEMBLY
SYMETRICKÁ MONTÁŽREMOVE
ODRÍZNOUTREVERSE SIDE
OTOČITAPPLY EDUARD MASK
AND PAINT
POUŽIT EDUARD MASK
NABARVIT

PLEASE CHECK THE LATEST VERSION OF THE INSTRUCTIONS ON www.eduard.com

PARTS



DÍLY



TEILE



PIÈCES



部品

PLASTIC PARTS

C>

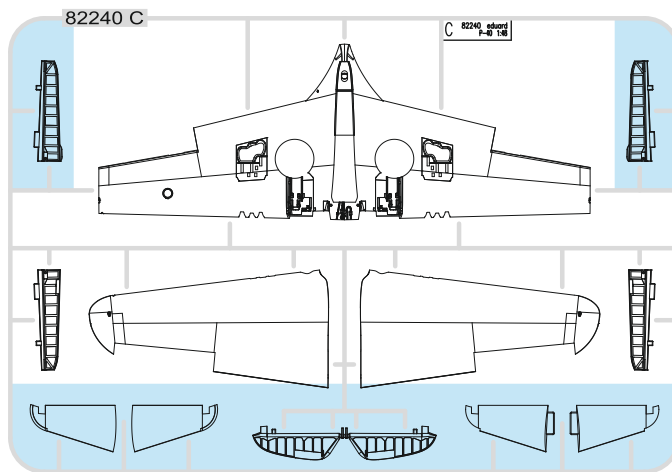

D>

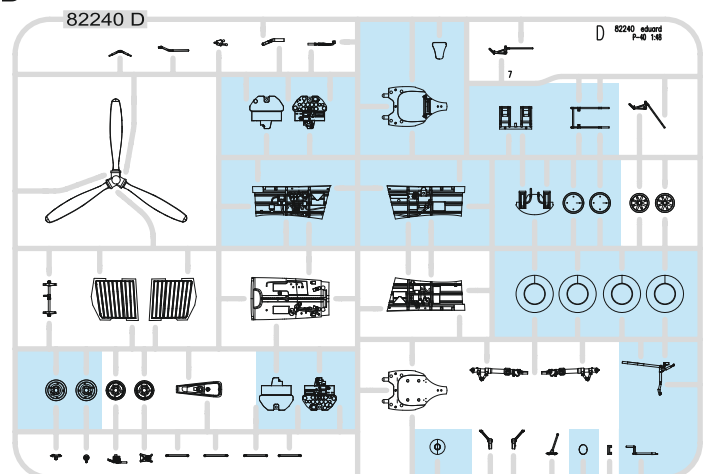

E>

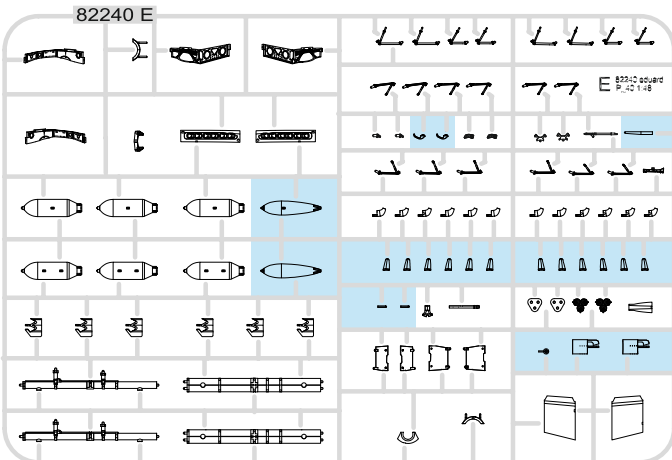

F>

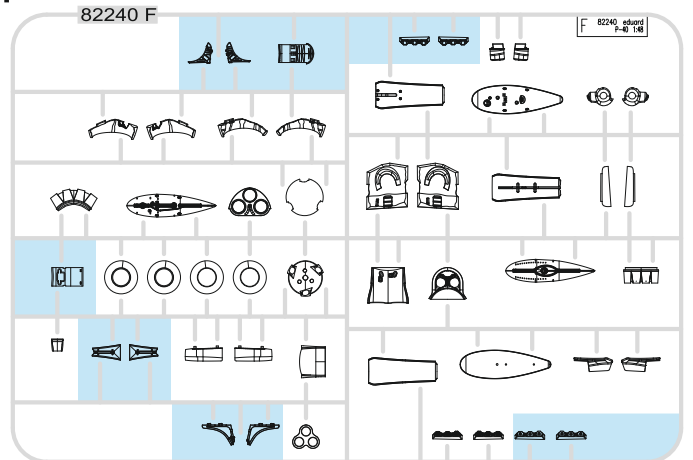

G>



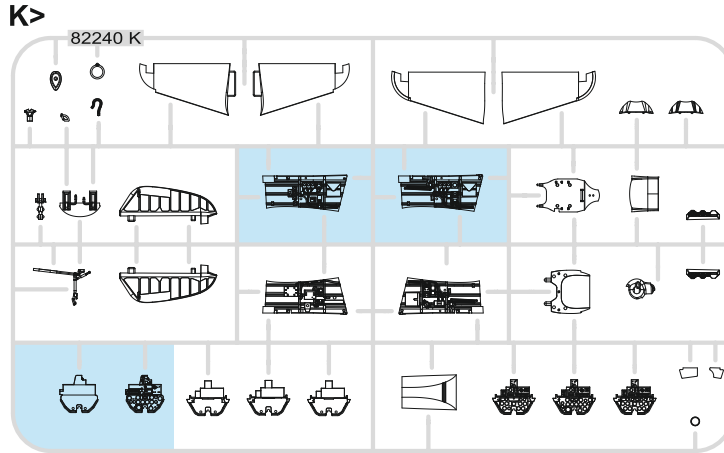
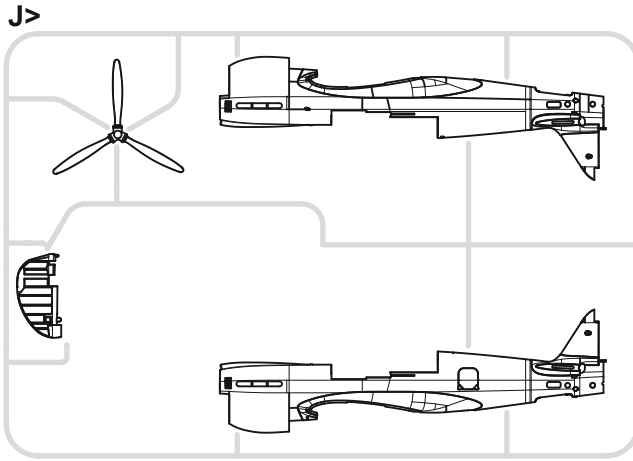

eduard
MASK

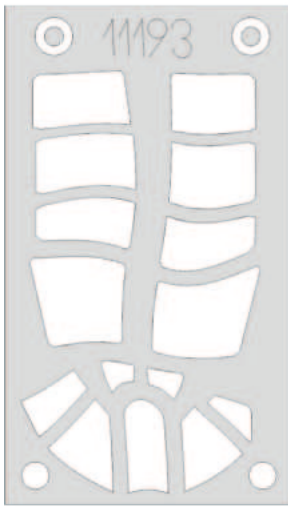

PE - PHOTO ETCHED DETAIL PARTS

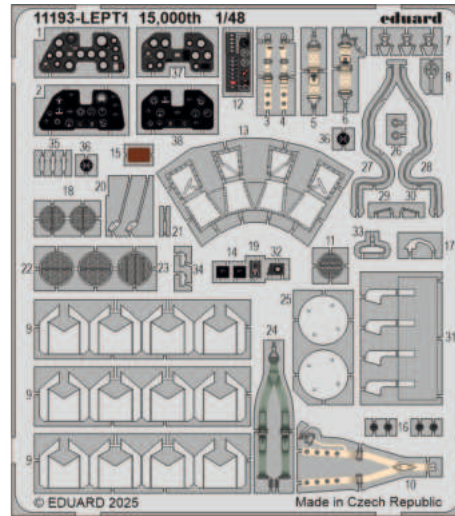

-Parts not for use. -Teile werden nicht verwendet. -Pièces à ne pas utiliser. -Tyto díly nepoužívejte při stavbě. - 使用しない部品

COLOURS



BARVY



FARBEN



PEINTURE



色

GSI Creos (GUNZE)		
AQUEOUS	Mr.COLOR	
H8	C8	SILVER
H11	C62	FLAT WHITE
H12	C33	FLAT BLACK
H27	C44	TAN
H52	C12	OLIVE DRAB
H53	C13	NEUTRAL GRAY
H76	C161	BURNT IRON
H77	C137	TIRE BLACK
H84	C42	MAHOGANY
H85	C45	SAIL COLOR
H90	C47	CLEAR RED

GSI Creos (GUNZE)		
AQUEOUS	Mr.COLOR	
H94	C138	CLEAR GREEN
H306	C306	MEDIUM GRAY
H314	C314	BLUE
H327	C327	RED
H328	C328	BLUE
	C352	CHROMATE YELLOW
Mr.METAL COLOR		
Mr.COLOR SUPER METALLIC		
SM201		SUPER FINE SILVER
SM206		SUPER CHROME SILVER
SM212		ALUMINIUM

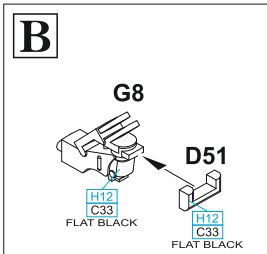
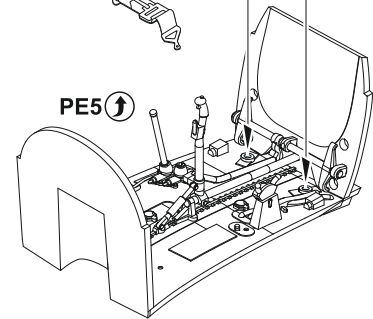
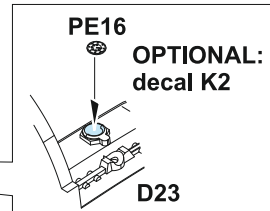
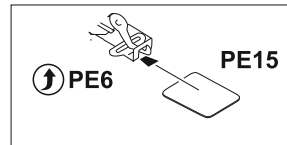
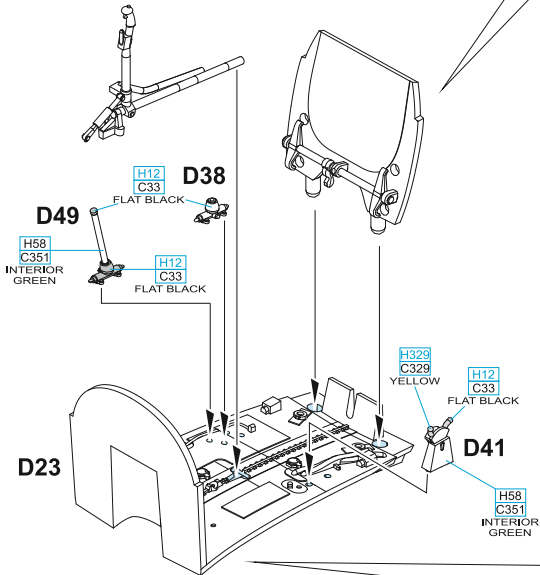
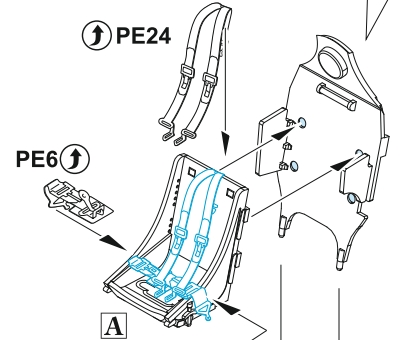
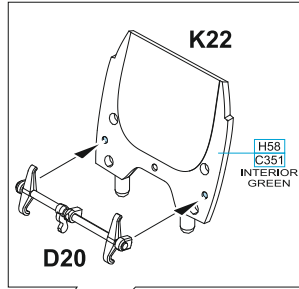
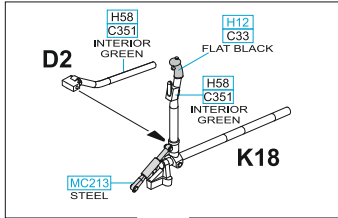
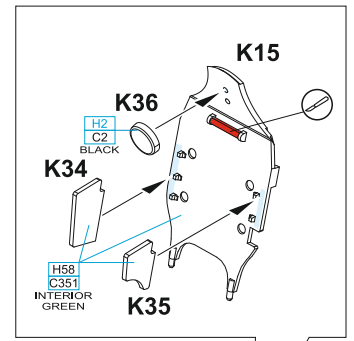
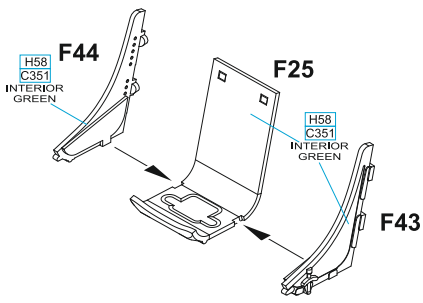
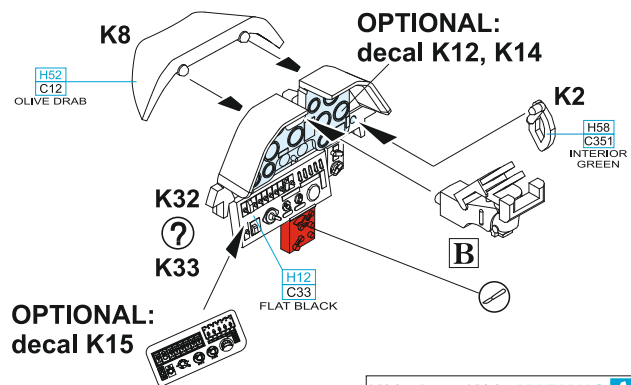
A**C**

K32, decal K14 - MARKING A
 K33, decal K12 - MARKING B

MARKING A ONLY

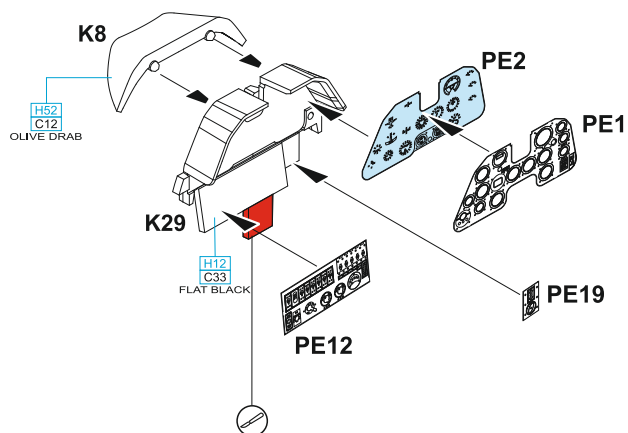

MARKING B ONLY

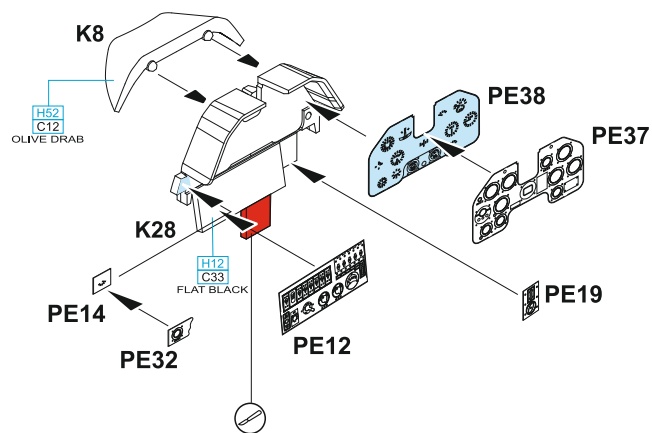

D

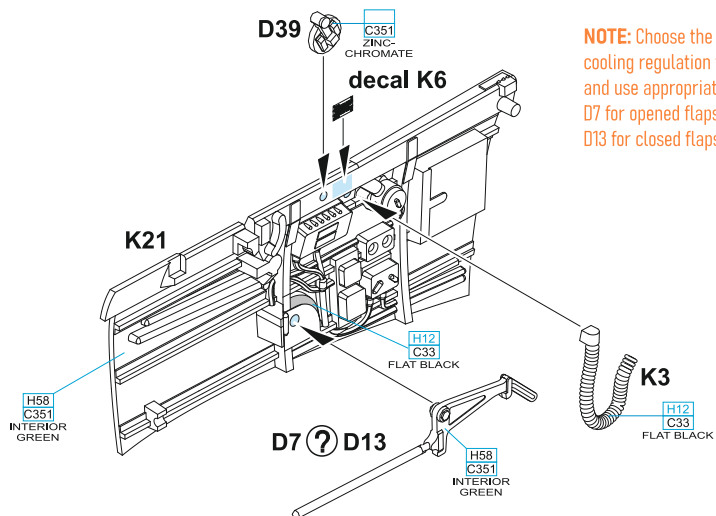

E

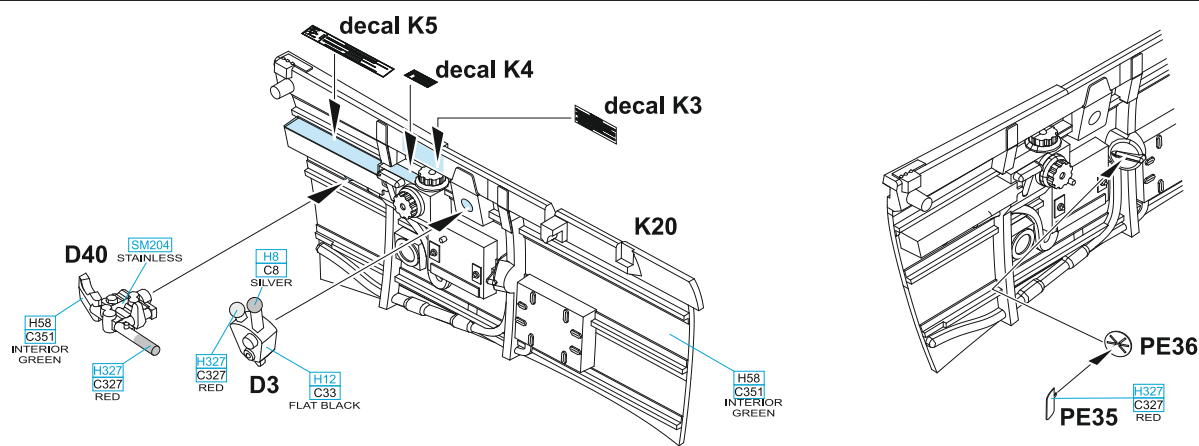

F

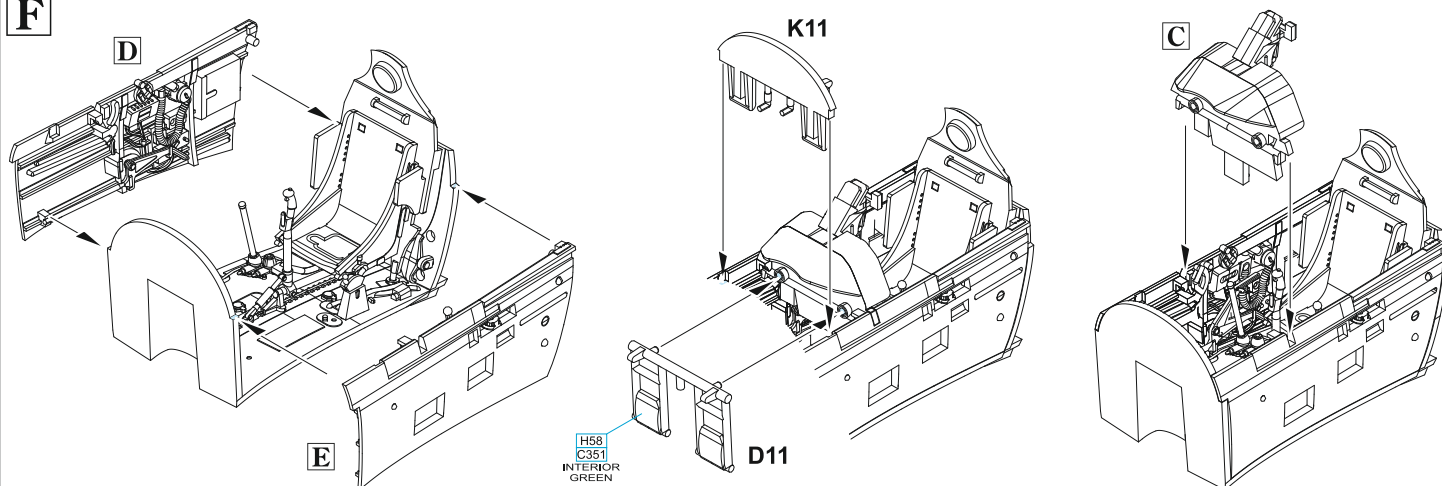

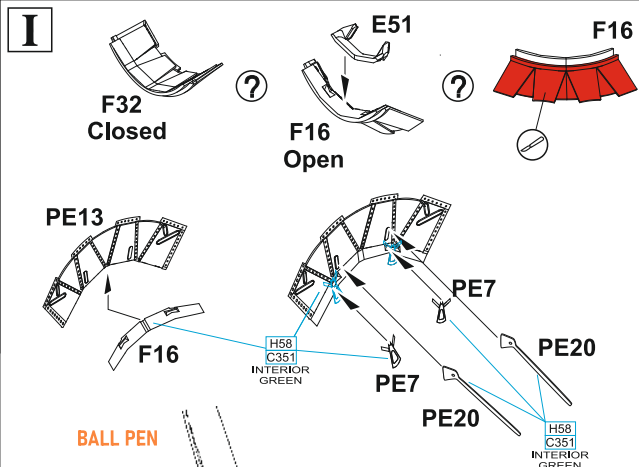
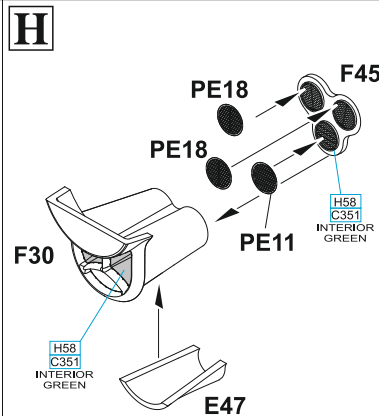
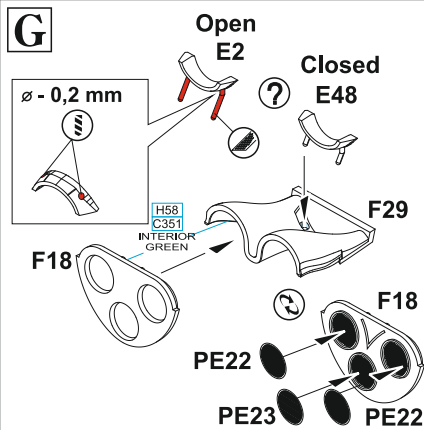
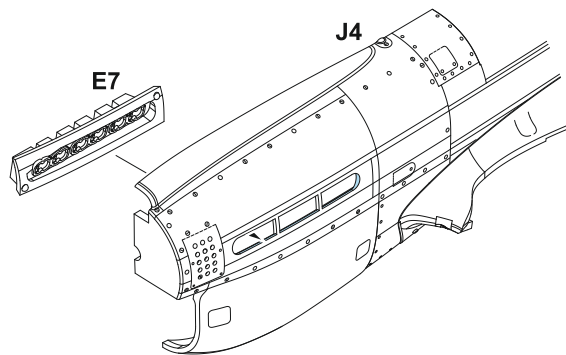
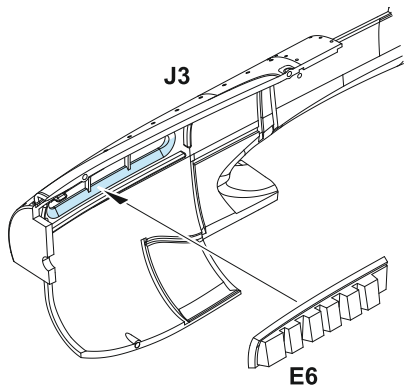

NOTE: Scribe 0,1 mm deep and 0,5 mm long hollow inside of the vertical fin to allow for installation of the PE34 antennae bracket part.

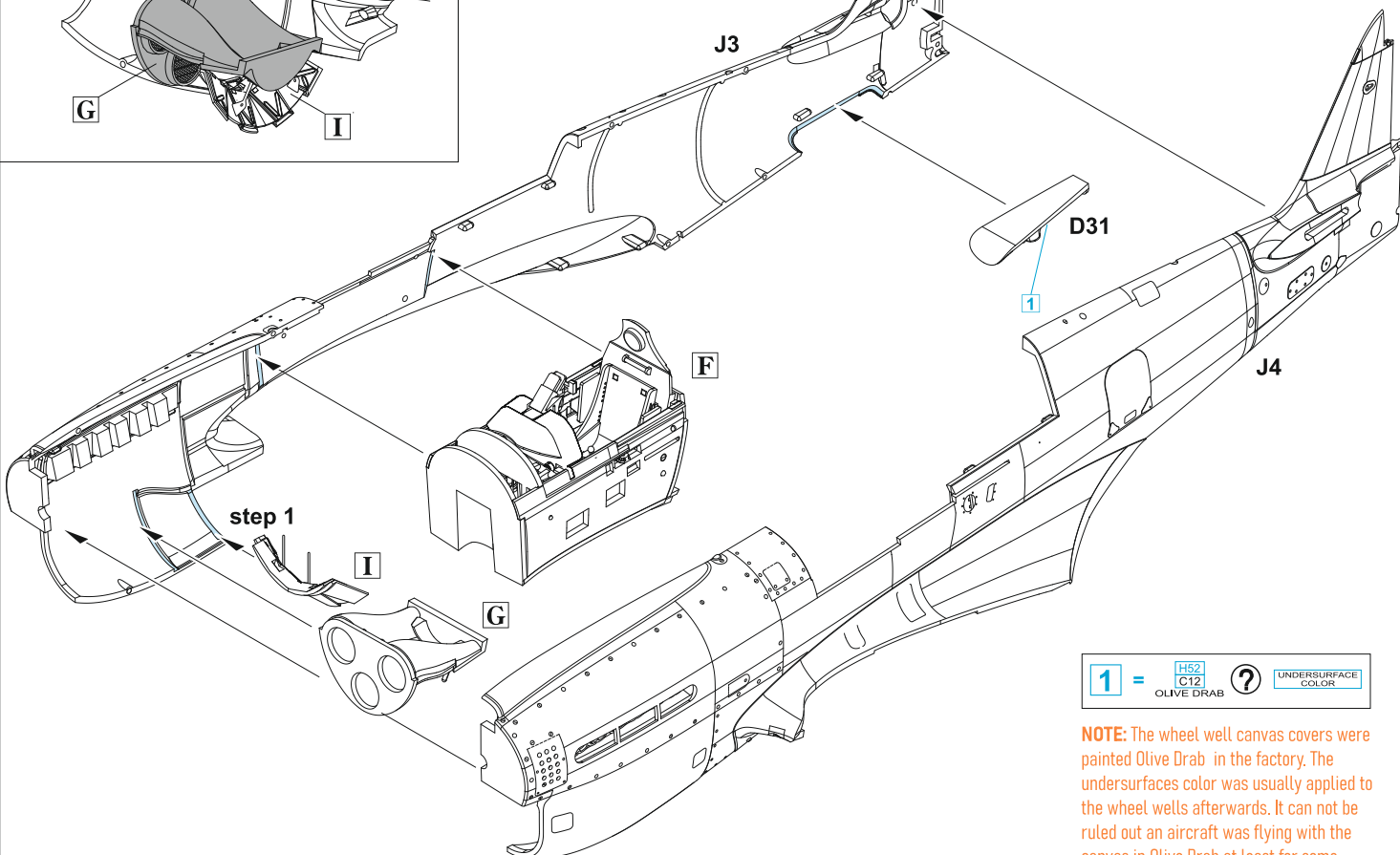
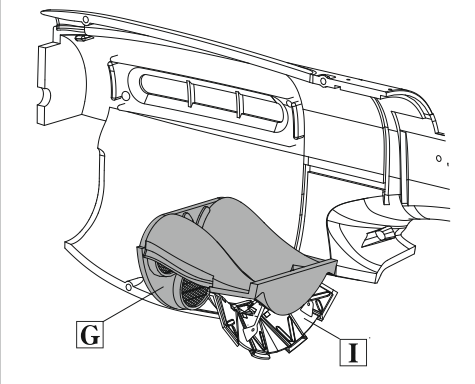
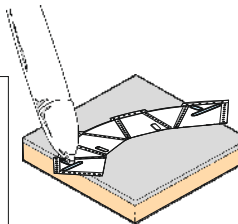
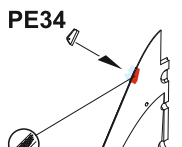

1 = H52 C12 OLIVE DRAB **?** = UNDERSURFACE COLOR

NOTE: The wheel well canvas covers were painted Olive Drab in the factory. The undersurfaces color was usually applied to the wheel wells afterwards. It can not be ruled out an aircraft was flying with the canvas in Olive Drab at least for some period of time.

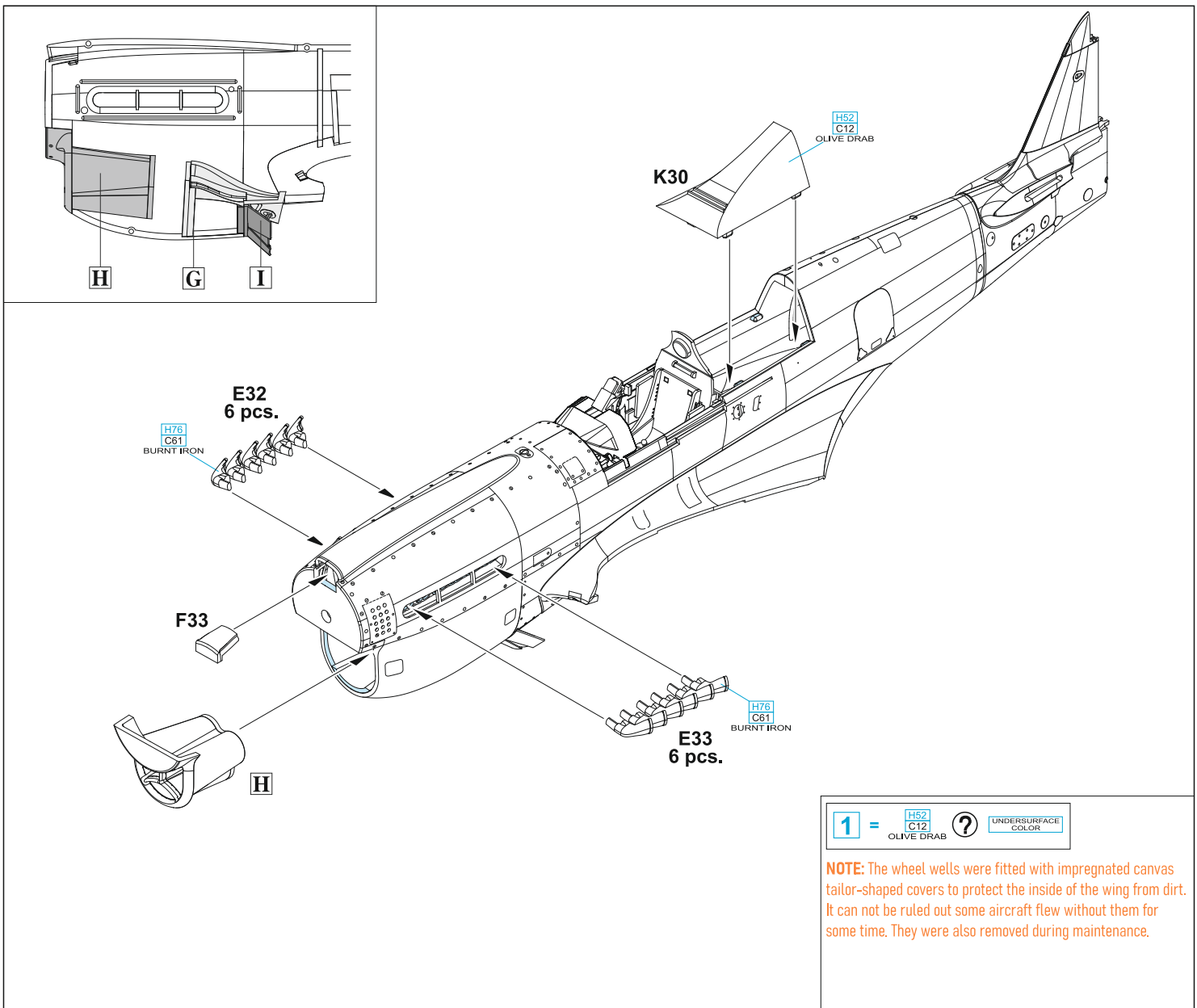

1 = H52
C12
OLIVE DRAB ? UNDERSURFACE
COLOR

NOTE: The wheel wells were fitted with impregnated canvas tailor-shaped covers to protect the inside of the wing from dirt. It can not be ruled out some aircraft flew without them for some time. They were also removed during maintenance.

J wheel wells without canvas covers

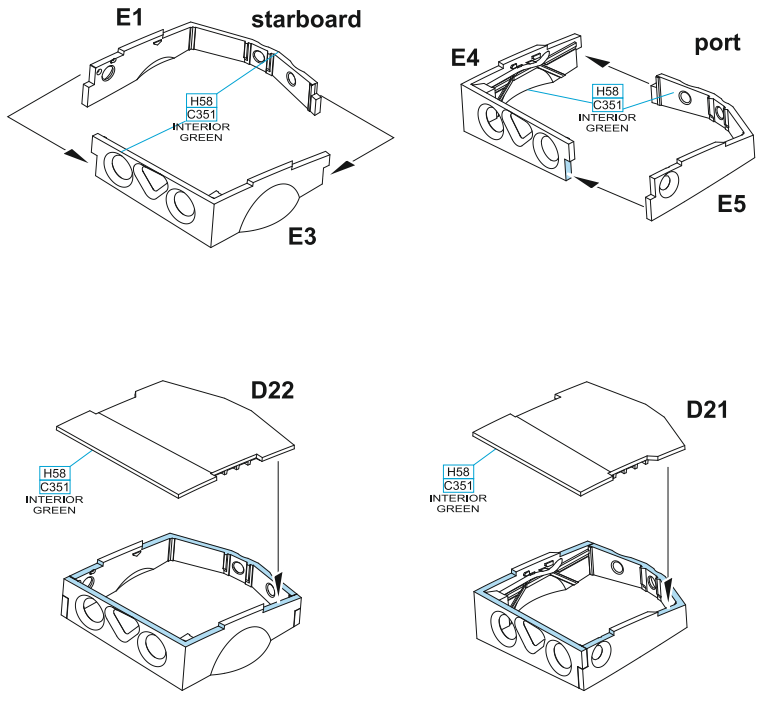

canvas covered wheel wells

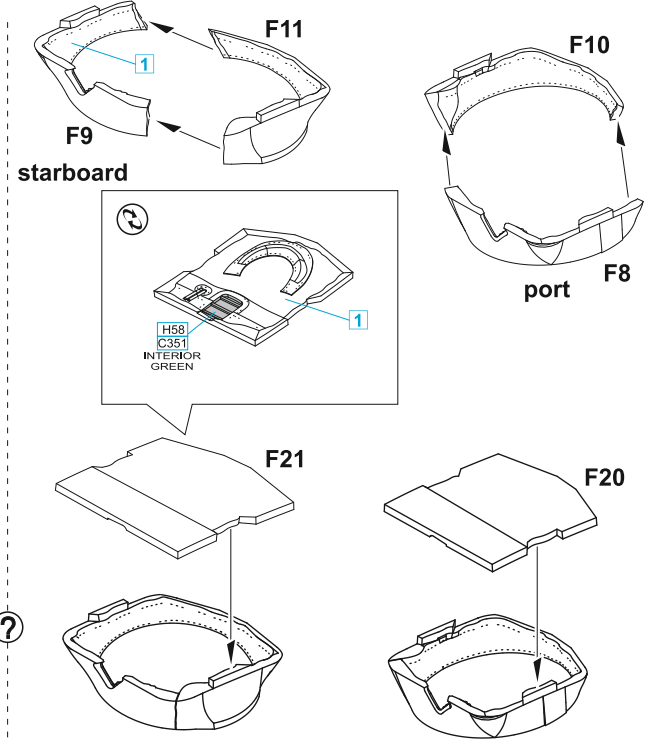

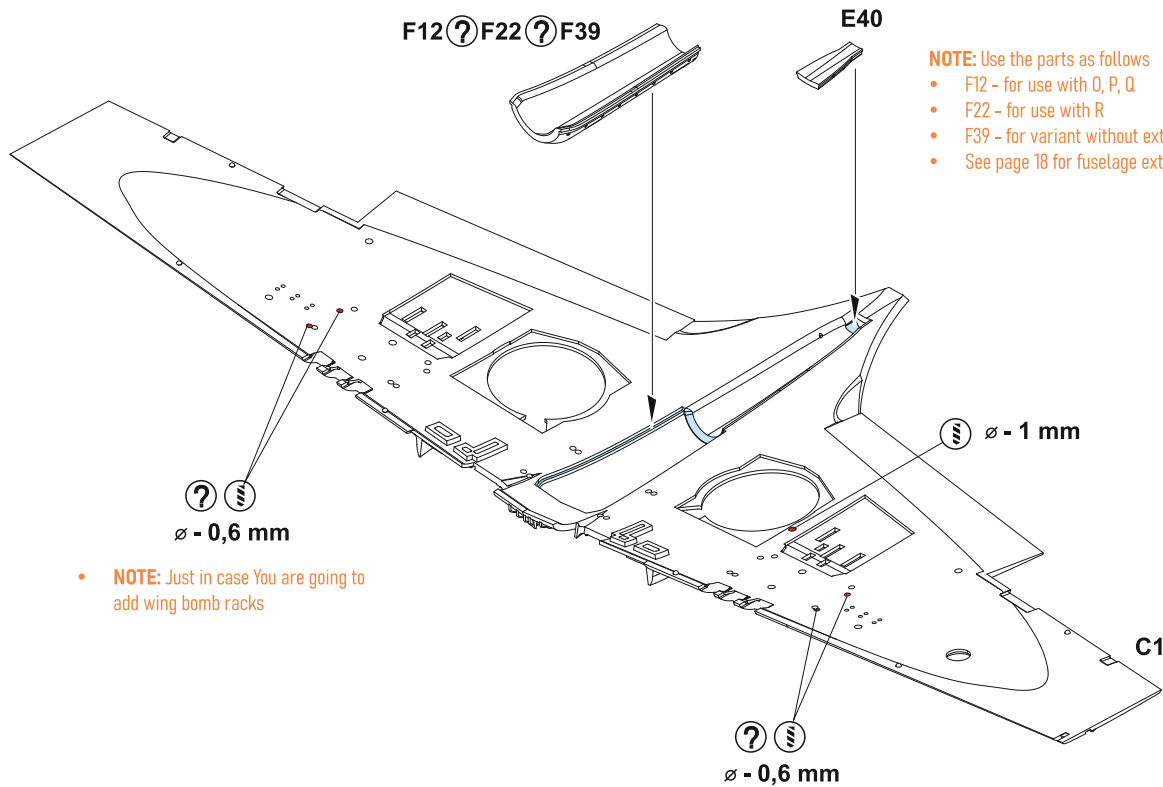

• NOTE: Just in case You are going to add wing bomb racks

• NOTE: Just in case You are going to add wing bomb racks

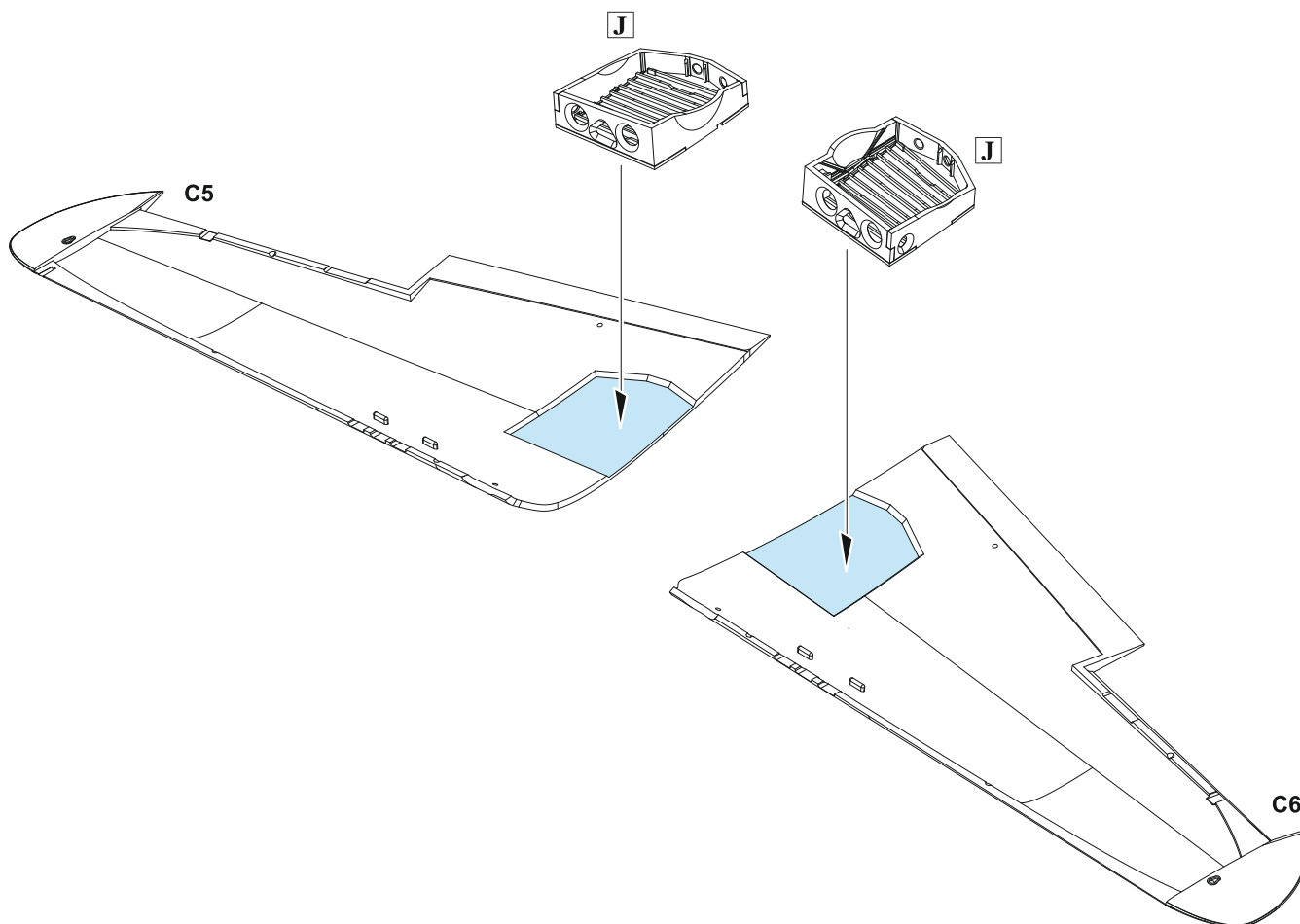

NOTE: Glue parts F14 and F15 into the upper halves of the wing (parts C5 and C6). Check with lower part of the wing (part C1) to align with it perfectly.

Alternatively You can glue the parts F14 and F15 after completing the wing. Check the fit of both parts during the process.

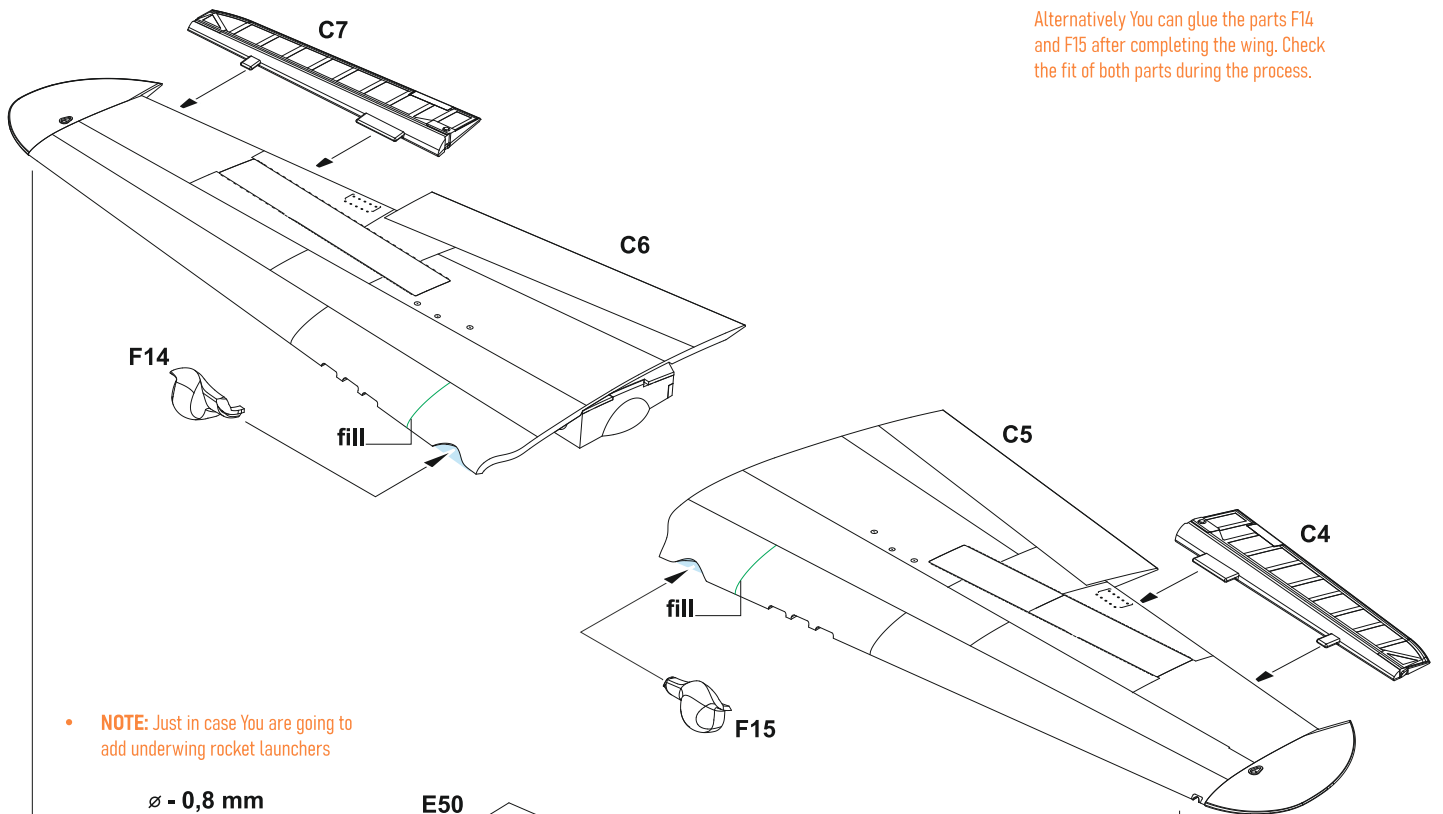

• **NOTE:** Just in case You are going to add underwing rocket launchers

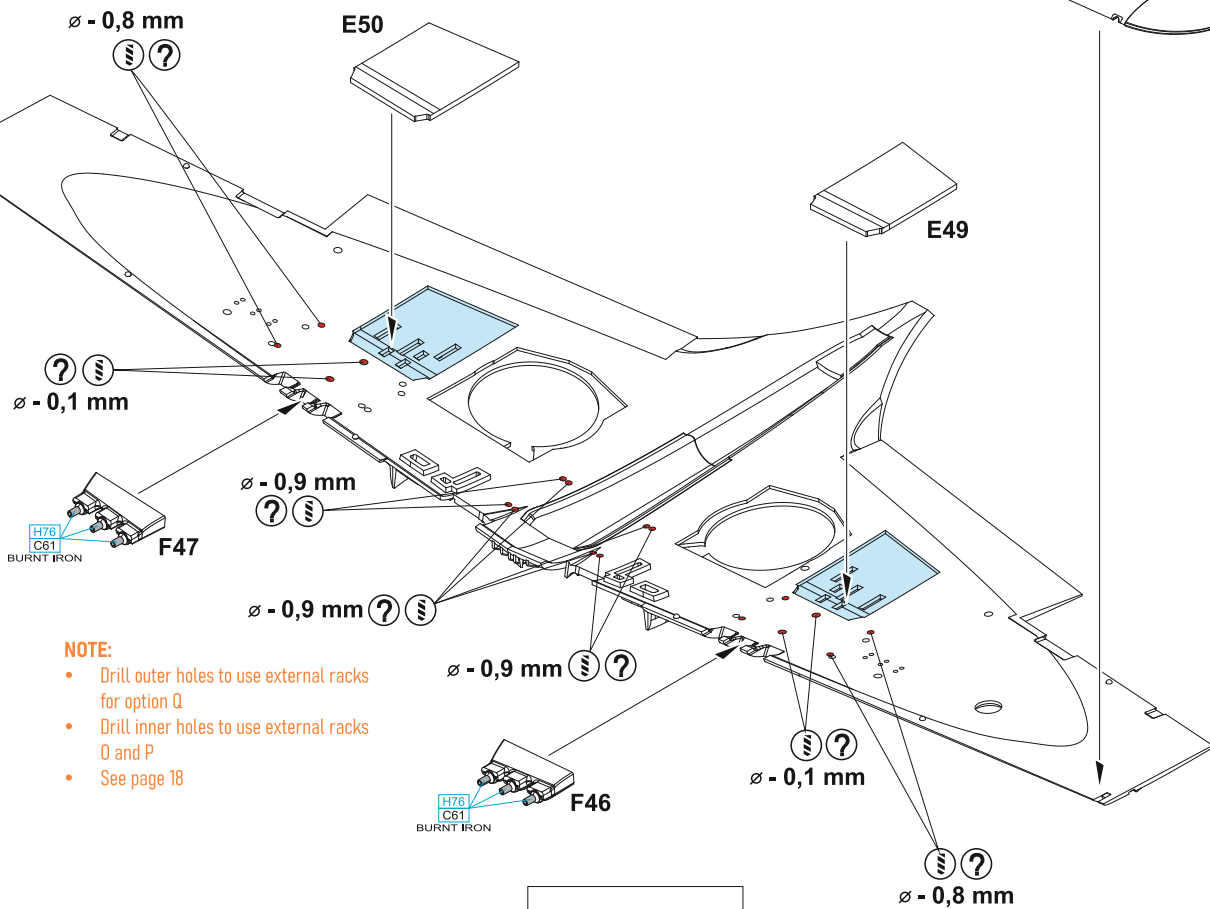

NOTE:

- Drill outer holes to use external racks for option Q
- Drill inner holes to use external racks O and P
- See page 18

• **NOTE:** Just in case You are going to add underwing rocket launchers

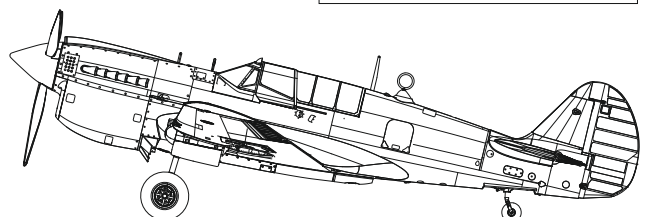
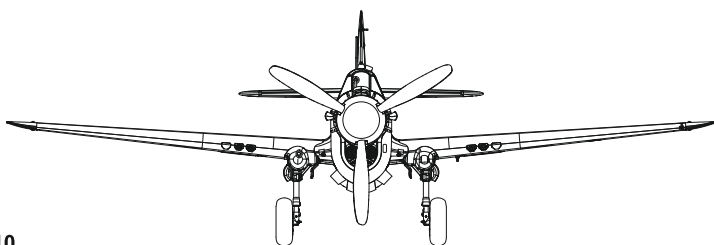
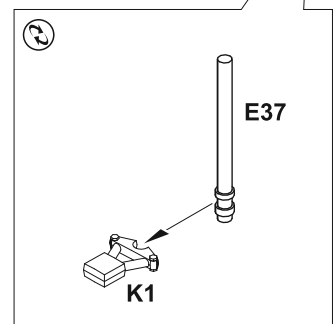
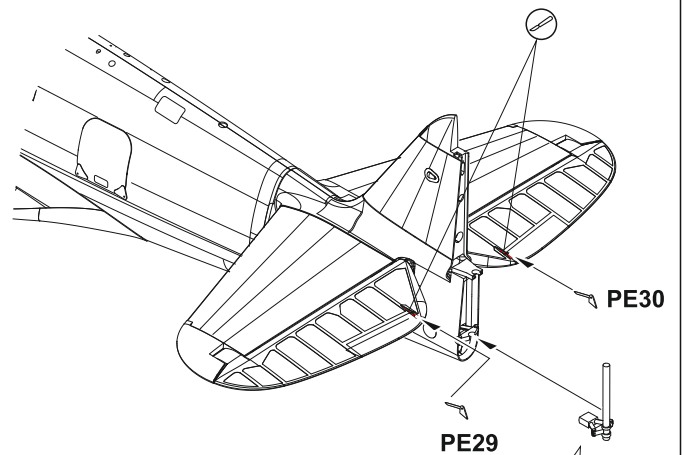
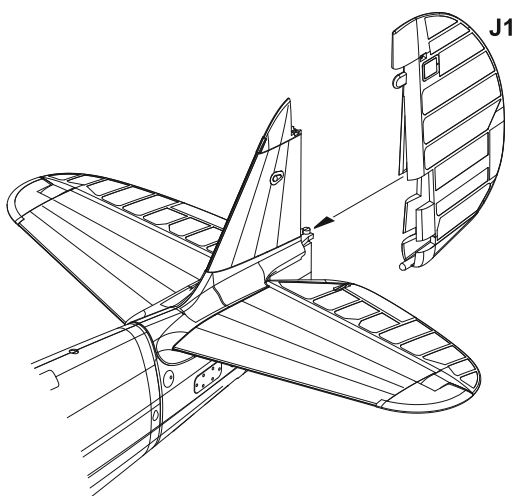
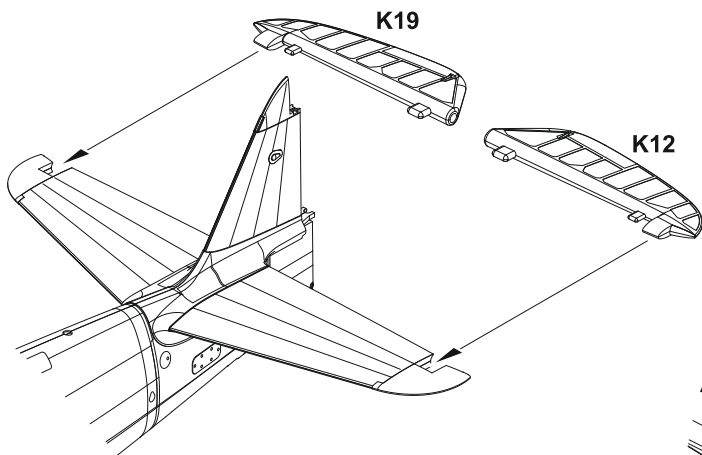
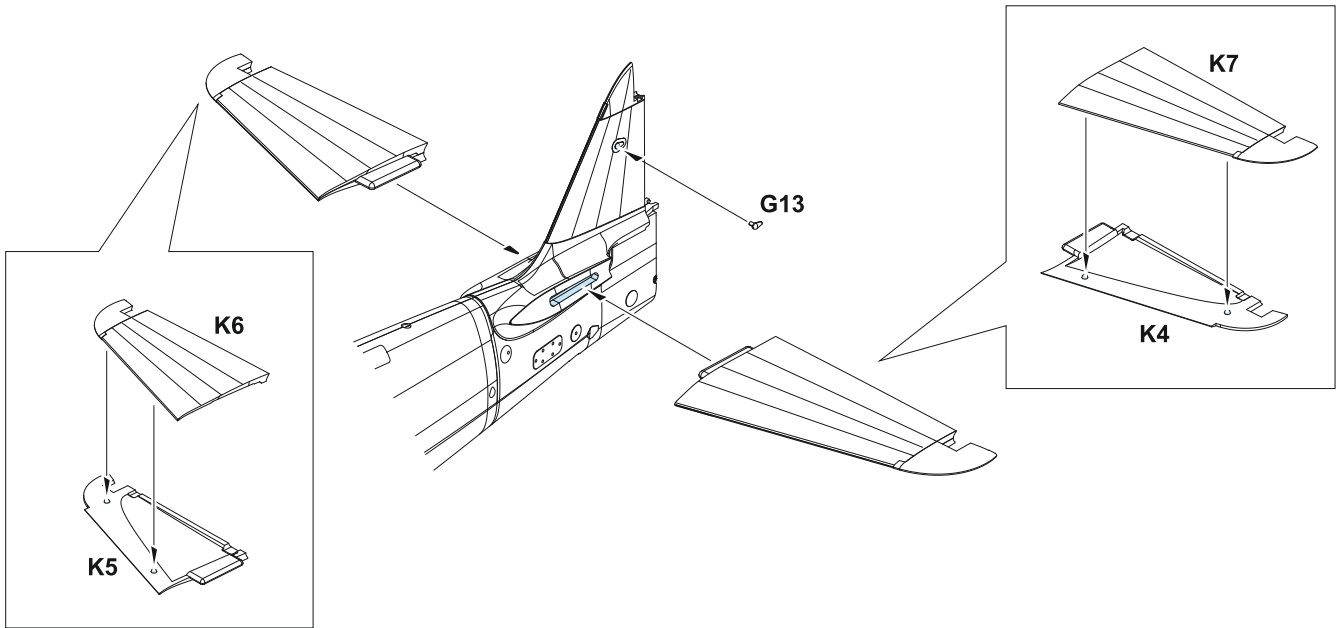

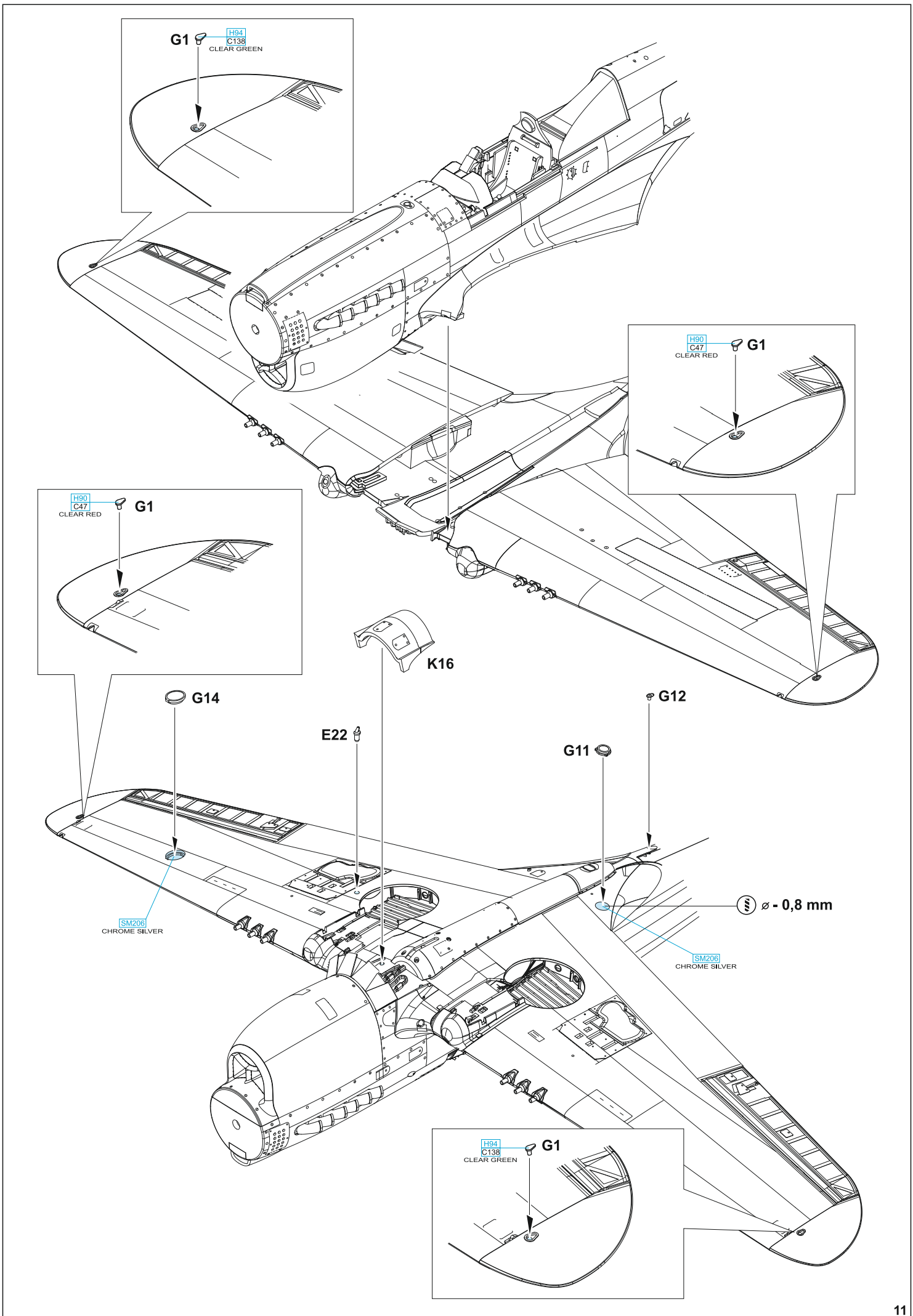

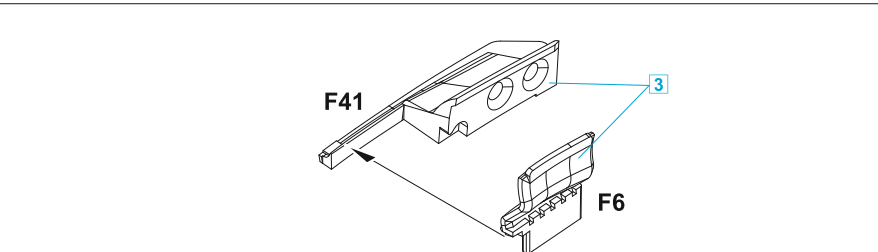
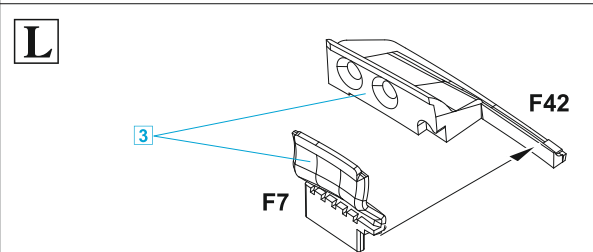
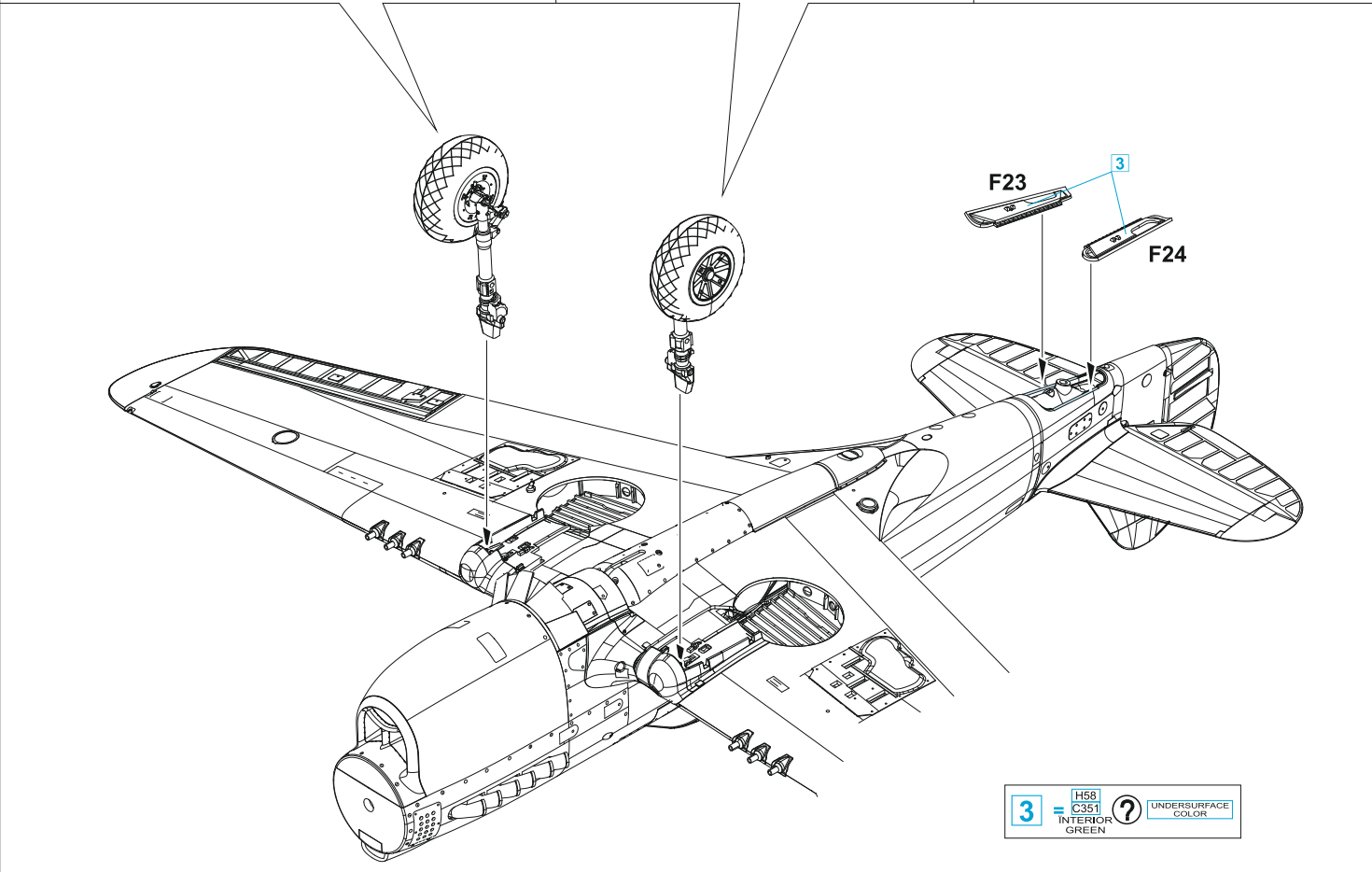
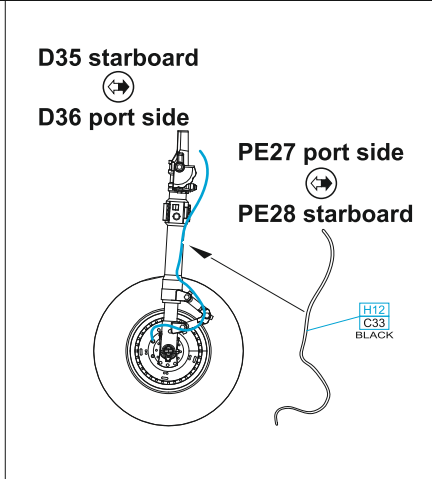
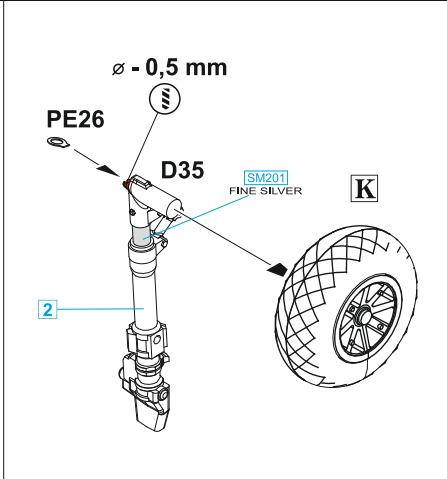
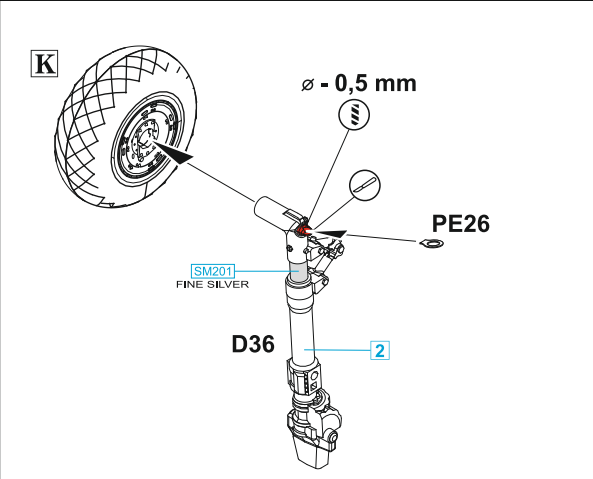
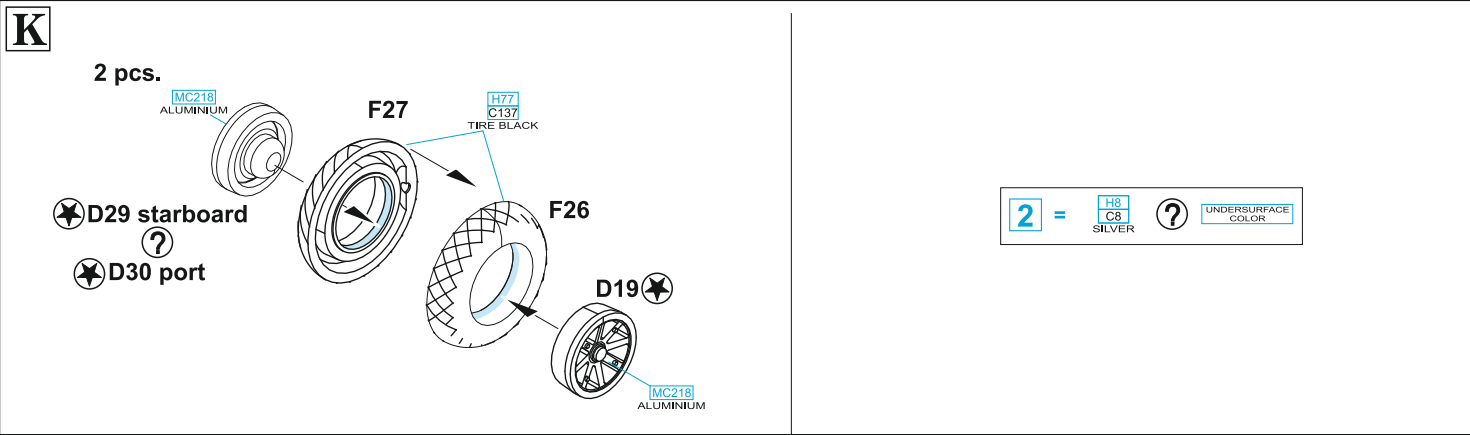

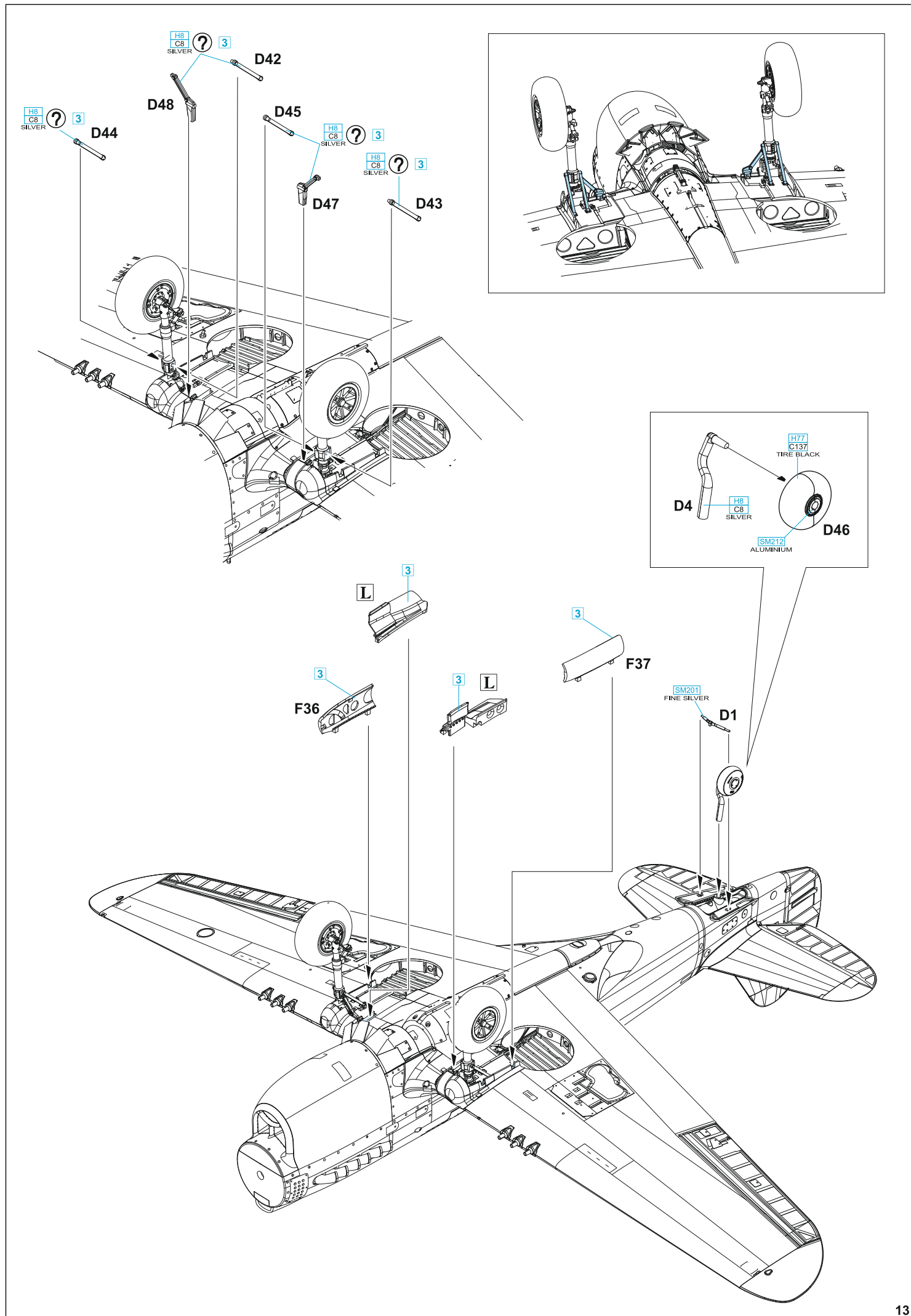

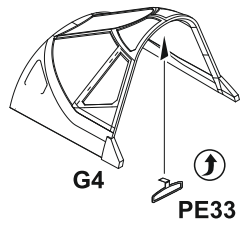
M

closed canopy

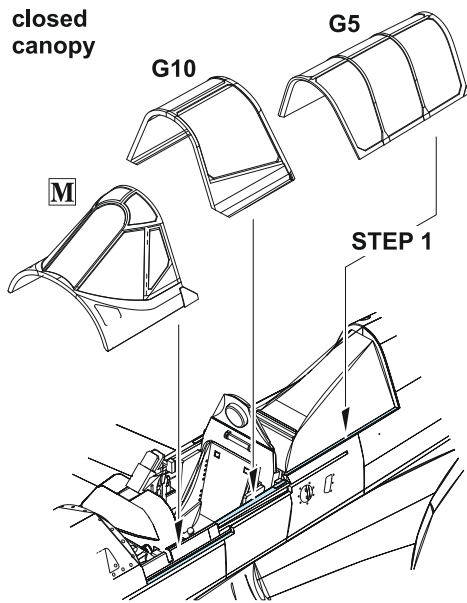

open canopy

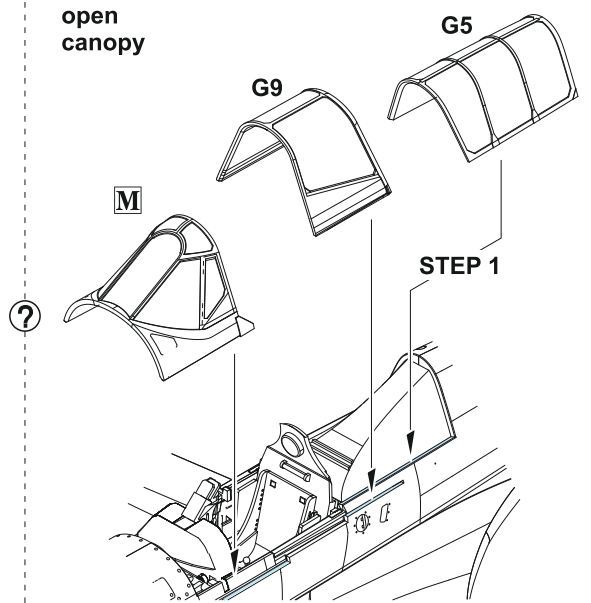
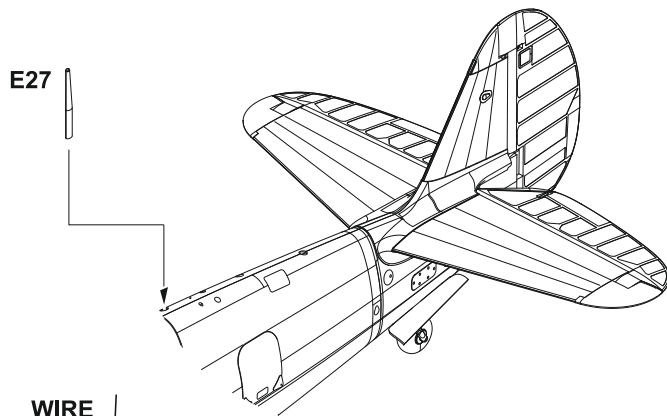
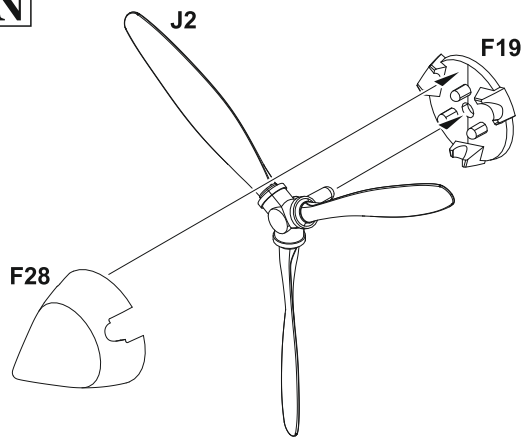
**N**

WIRE
 ∅ 0,2 mm
 L 6 mm

WIRE
 ∅ 0,15 mm

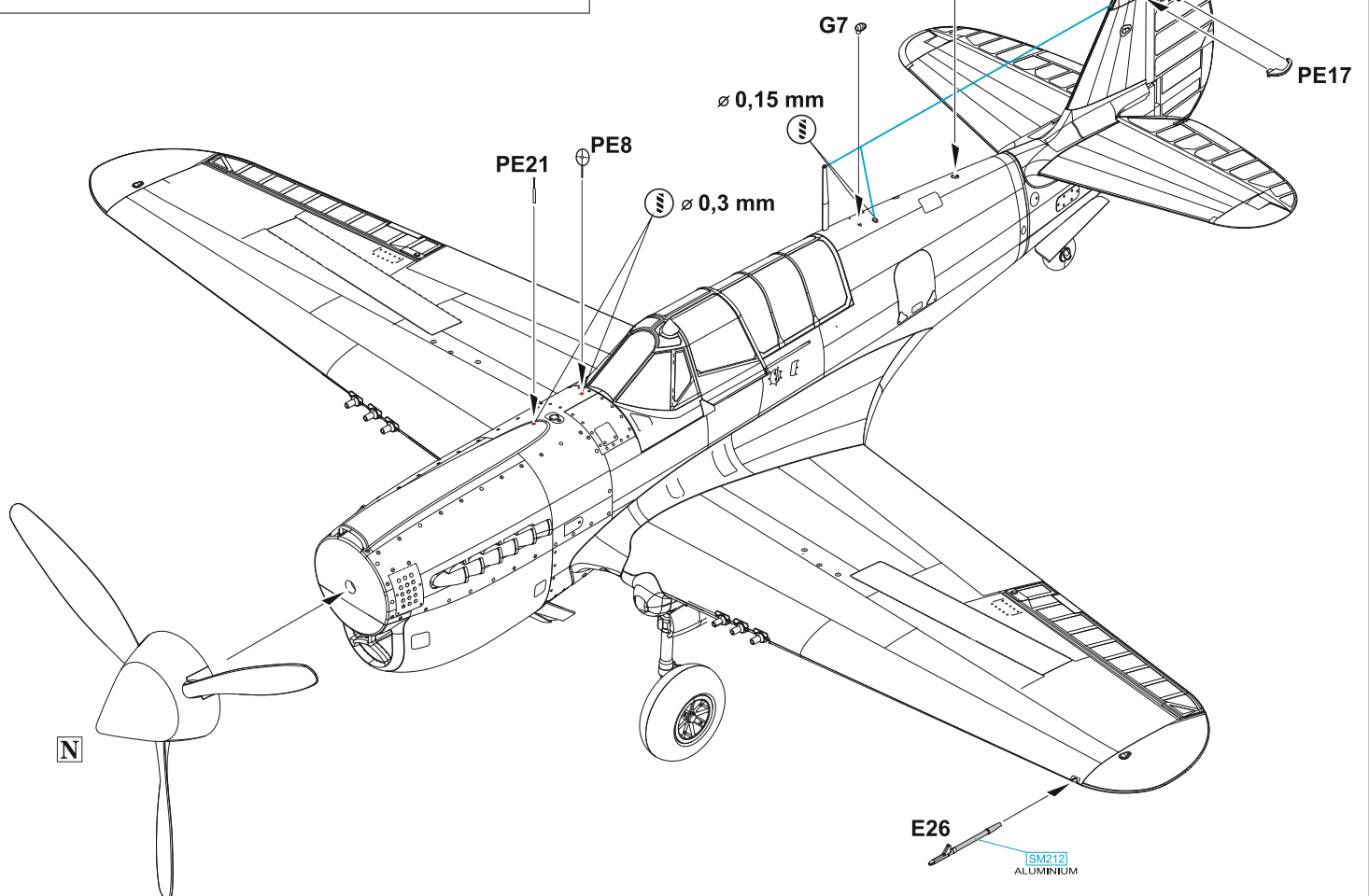

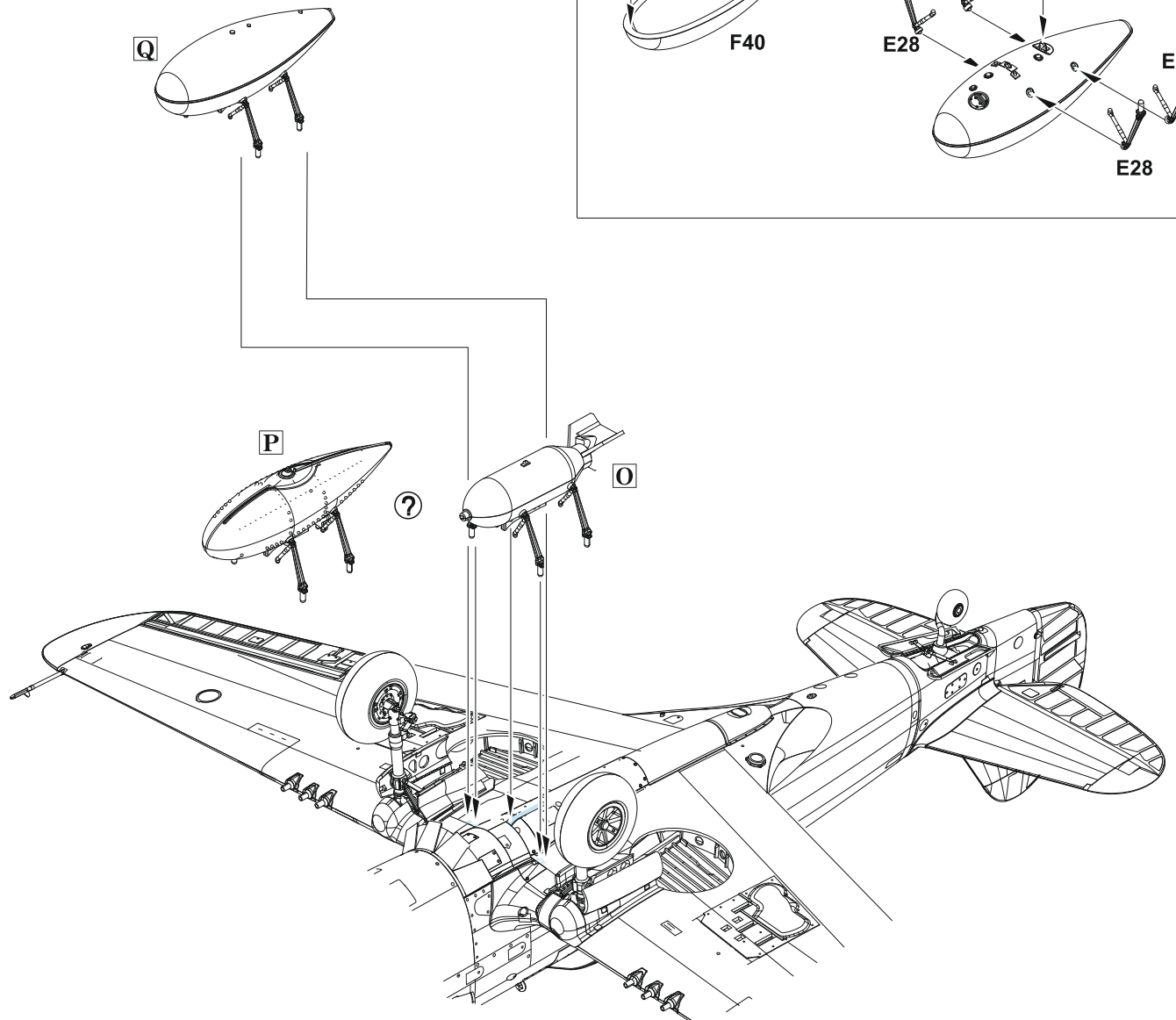
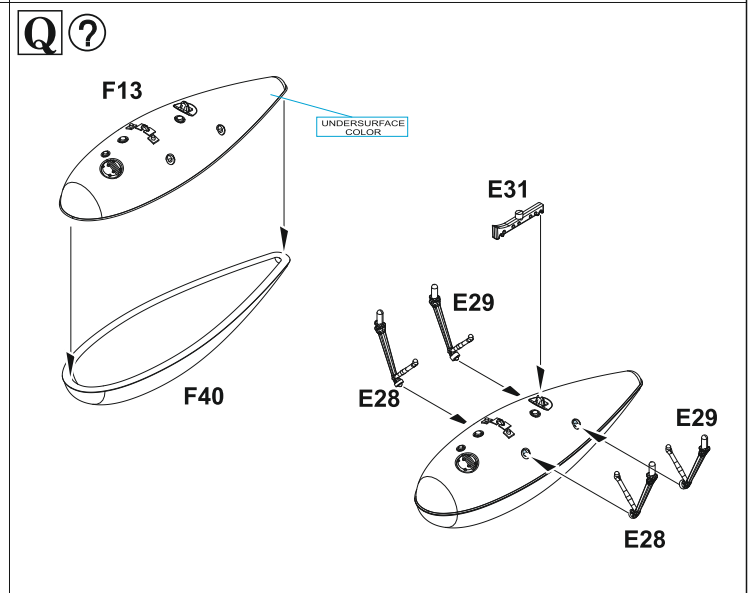
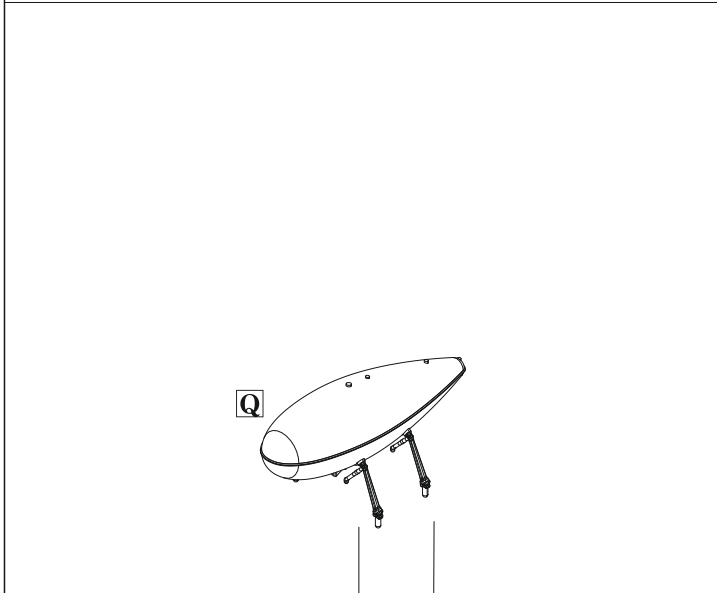
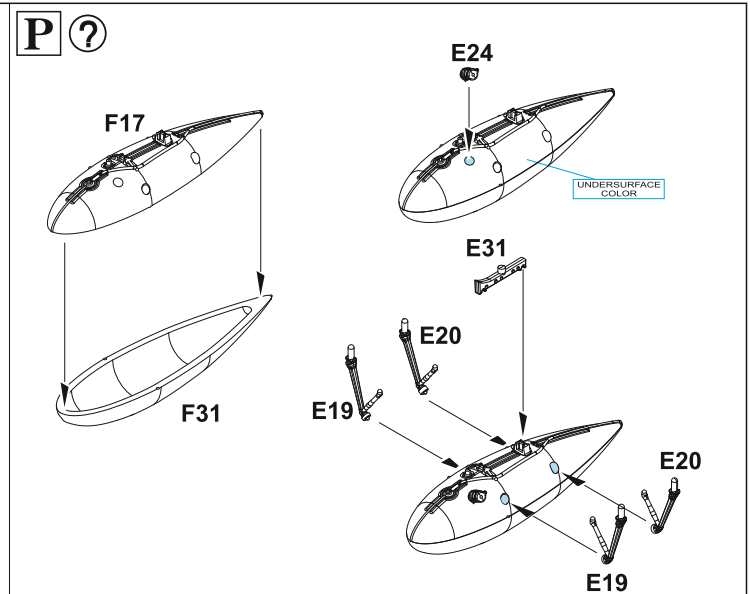
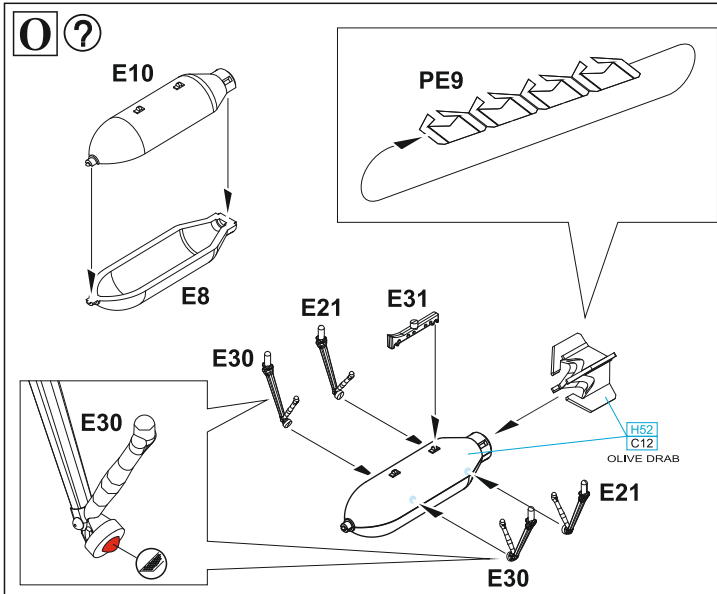

R 2 pcs.

MARKING **B** ONLY ?

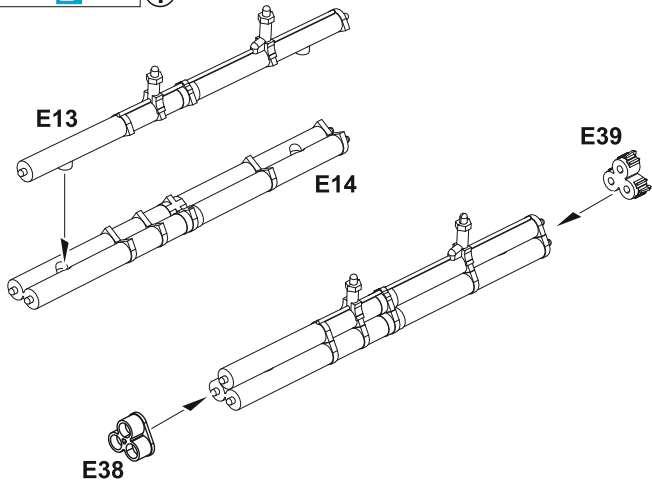

S 2 pcs.

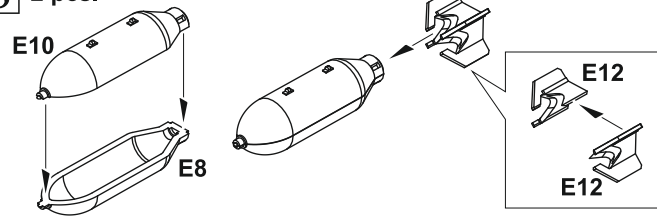

Starboard wing

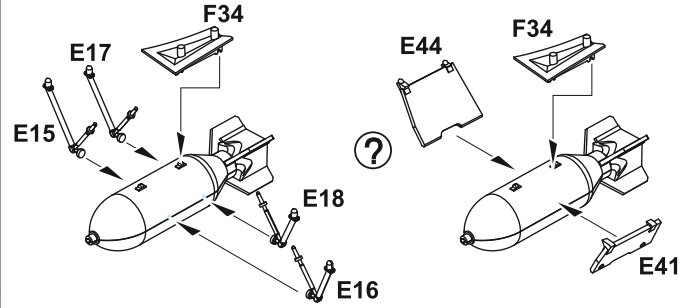

Port wing

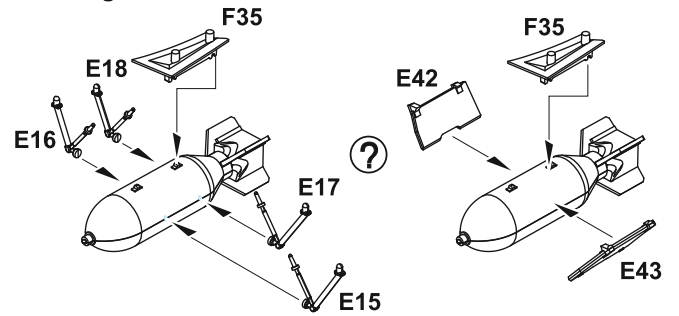

- **NOTE:**
- For marking A You can opt for no ordnance or three bombs arrangement (see paint scheme for painting).
- For marking B it is not known to us which ordnance the plane was carrying on missions during WWII. It is up to modeller to choose according to his knowledge or preferences.

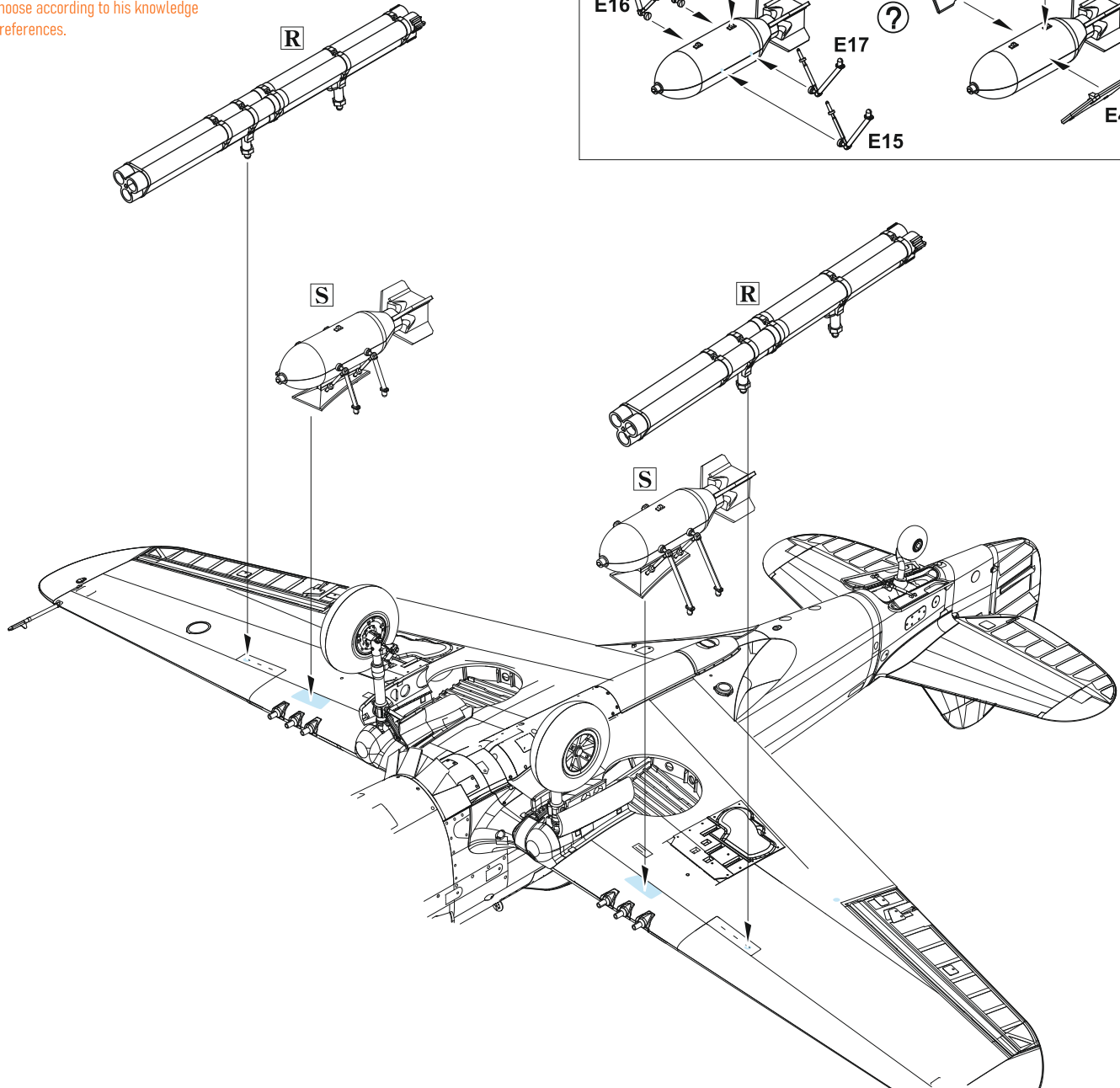

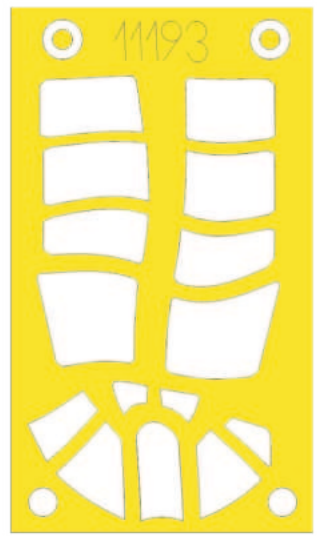

D46

G14

G4



LIQUID MASK



G5

G9 ? G10

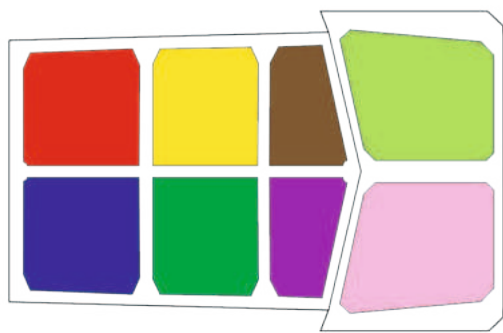

A 15.000th Curtiss aircraft delivered to customers worldwide, Buffalo, NY, USA, November 1944

The Curtiss company celebrated its 15,000th fighter aircraft delivered to its customers worldwide by special commemorative marking with all the national insignias of the countries of its customers placed all around the aircraft surface. The serial number of the plane which was used for the commemorative marking is not known.



ČESKOU VERZI TEXTU NALEZNETE NA
www.eduard.com
 POD KATALGOVÝM ČÍSLEM 11193



OLIVE DRAB H52 NEUTRAL GRAY H53 RED H327 FLAT WHITE H11 BLUE H328
 C12 C13 C327 C62 C328

eduard

B Capt. Philip E. Colman, 26th FS, 5th FG, Ankang, China, 1944

Philipp Eddy Colman enlisted in the USAAC in 1941 after graduation from Jefferson Senior High School and was accepted for flight training. He graduated as Flying Sergeant at Spence Field and his first assignment was towing targets for the gunnery school at Eglin Field, Florida. Later he served as a test pilot, flying not only US types, but also captured German Bf 109 or Japanese Oscar fighters. He survived the sinking of HMT Rohna which was sailing him to his first combat assignment. The hit by German guided flying bomb killed 1,149 out of 2,000 on board. Colman's next combat assignment was as a pilot with the Chinese-American Composite Wing where he flew 86 combat missions in the P-40 and shot down five Japanese Zero fighters with two probable victories and five damaged enemy planes. After the war he joined the 158th Fighter Squadron, 116th Fighter Group of the Georgia Air National Guard. He was assigned to the 335th FIS in 1952 and added four MiG-15s to his fighter tally during the Korean War. In 1983, he retired as a lieutenant colonel. As there are no known photos of his P-40N, the paint scheme reflects the aircraft displayed in the Museum of Flight, Seattle, Washington.

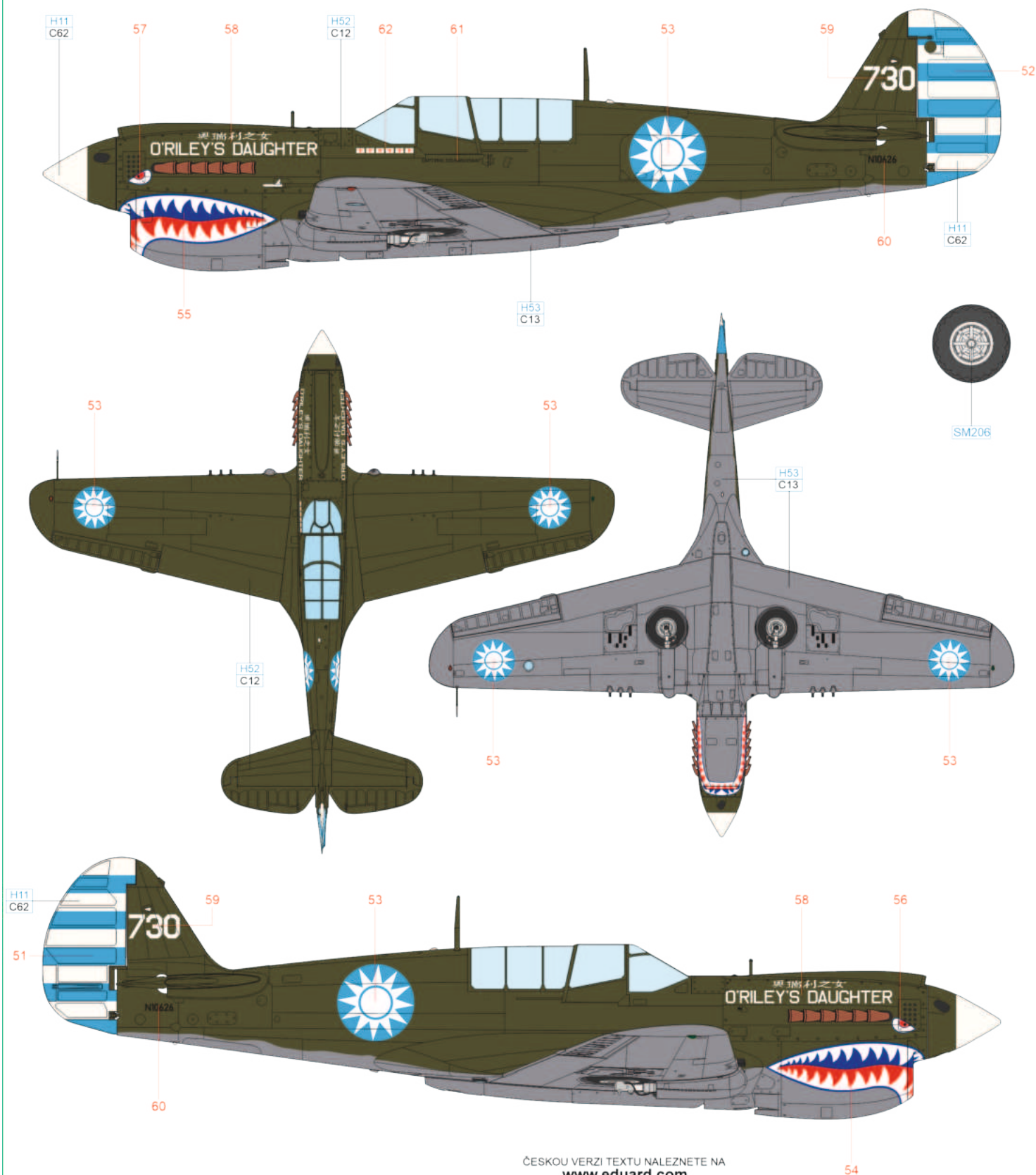

ČESKOU VERZI TEXTU NALEZNETE NA
www.eduard.com
 POD KATALOGOVÝM ČÍSLEM 11193

OLIVE DRAB H52 C12 NEUTRAL GRAY H53 C13 FLAT WHITE H11 C62 SUPER CHROME SILVER 2 SM206



eduard

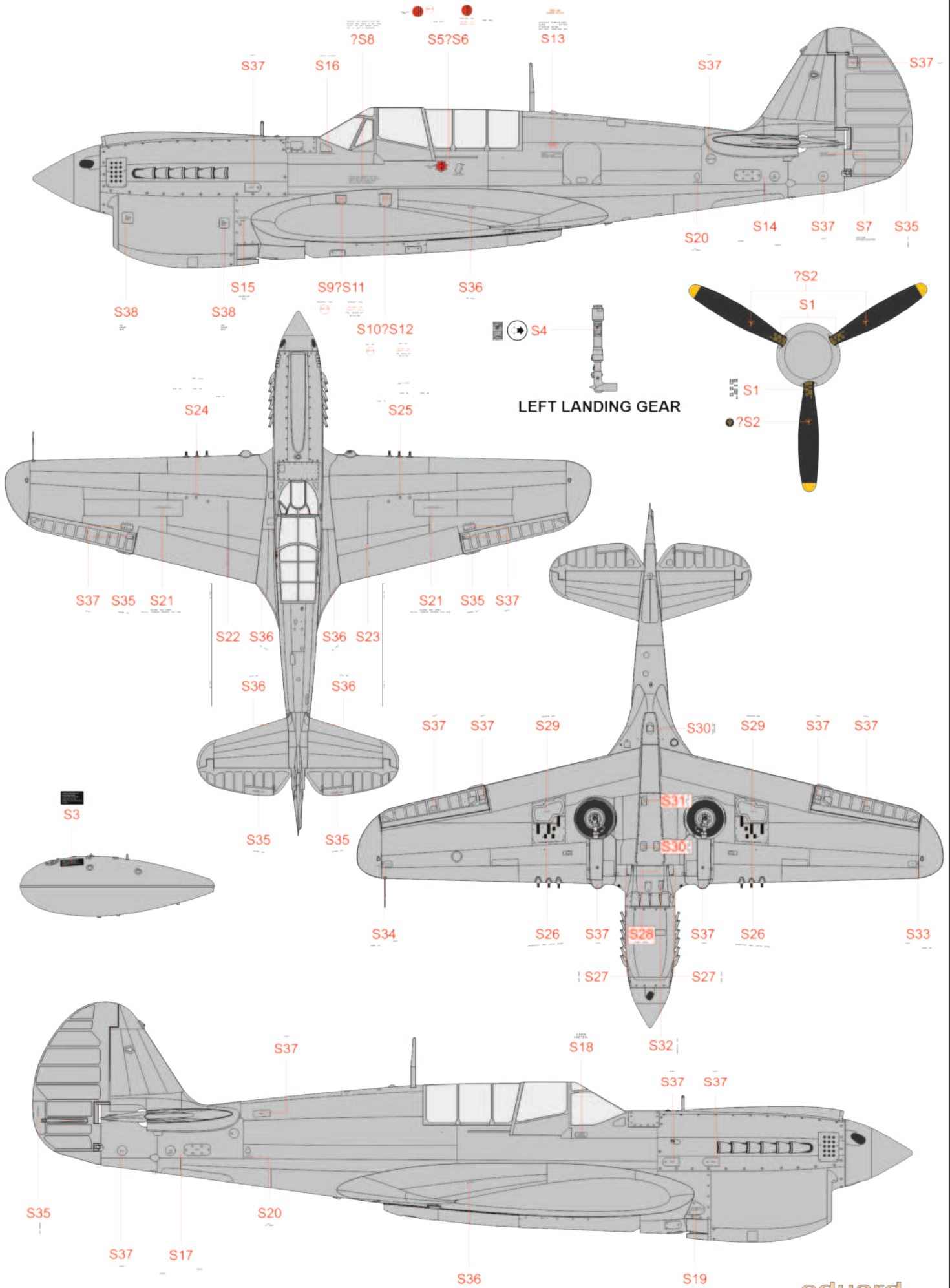

LEFT LANDING GEAR