

ITEM NO.02411

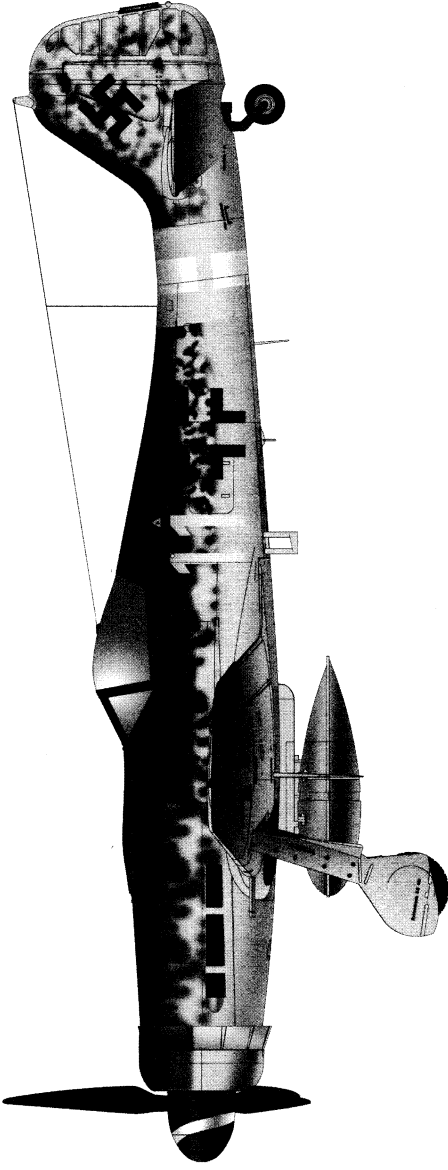

# Focke-wulf Fw 190 D-9

## 1:24 Scale

### 德国 Fw 190 D-9 型

#### READ BEFORE ASSEMBLY

- Study and understand these instructions thoroughly before beginning assembly. Make sure all parts are included by comparing them to those shown on pages 2 & 3 of these instructions.
- Remove parts from sprues as needed, and trim excess with a hobby knife. Be careful not to lose small parts.
- Remove photo-etch parts from sprue as needed using a hobby knife or photo etch cutter.
- Apply cement to photo etch parts as shown on instructions. Applying too much cement will restrict the operation of these

- movable parts. Apply cement carefully! Removed photo etch parts can have sharp edges. Take care when handling these to avoid injury.
- Apply decals to necessary parts prior to assembly.
- Additional tools recommended(not included):Sprue cutter, Long nose pliers, hobby knife, file, tweezers, pin vise, scissors, cement, sandpaper, soft cloth, glue and paint.
- Keep all parts out of reach of children, as they pose a choking hazard. Discard all unnecessary bags and sprues when model is completed to avoid accidental injury.

#### 装配之前仔细阅读

- 小心用模型锉刀锉平所有零件表面的注射浇口。
- 小心用刀片切下蚀刻片零件，不要遗失小零件。
- 用强力快干胶水粘合蚀刻片零件和金属轴。过量的快干胶水使用可能导致零件会粘住，小心涂胶。
- 取蚀刻片时应特别注意安全，防止利边划伤手指。
- 某些零件表面需贴上水贴纸，请选择在装配的同时进行。
- 推荐模型工具(自备)：胶水，水口剪刀，长咀钳，刀片，锉刀，镊子钳，钻，剪刀，瞬间快干胶。
- 软布同砂纸同时也应该是必备工具。
- 请使用塑料胶水和油漆，模型内不含。
- 谨防小孩吸吮塑料零件，或者将塑料袋套在头上，制作时应将套材远离小孩接触。

#### 水贴纸的使用:

1. 从水贴纸上剪下印花;
2. 将印花放入温水中浸10秒, 然后放在干净布上。
3. 拿着印花纸板将印花移到模型上;
4. 手指蘸水将印花移到适当的位置;
5. 用软布轻压印花直至水干, 气泡消失。

#### DECAL APPLICATION

1. Cut off decal from sheet.
2. Dip the decal in tepid water 40° C for about 10 sec. and place on a clean cloth.
3. Hold the backing sheet edge and slide decal onto the model.
4. Move decal into position by wetting decal with finger.
5. Press decal gently down with a soft cloth until excess water and air bubbles are gone.



cyanacrylate glue  
使用强力胶



option  
选择



weight  
配重



decal  
贴纸



make hole  
钻孔



bend  
弯曲



cut / remove  
切除



file / sand  
锉平

# 部品图 Parts

A

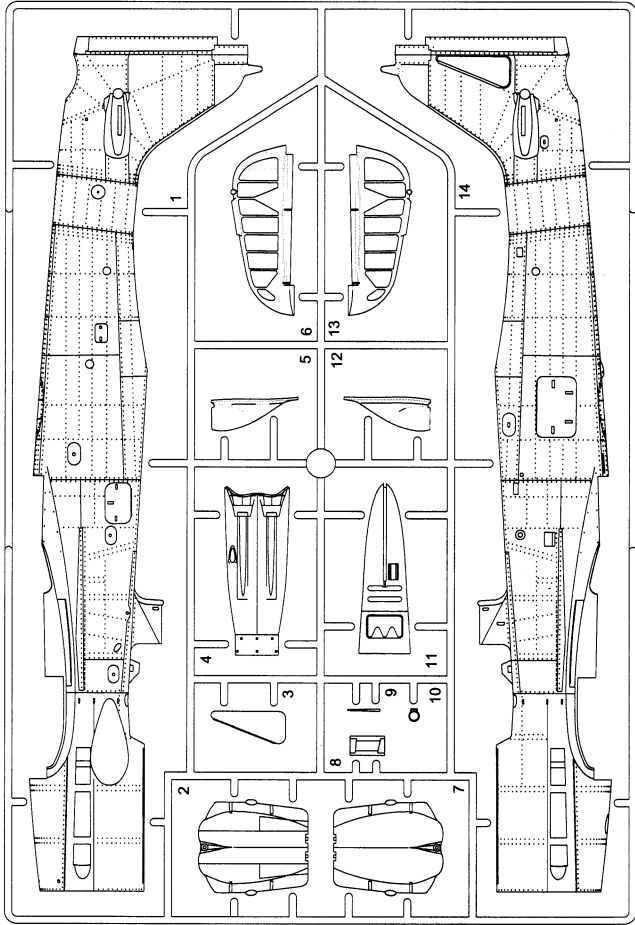

B

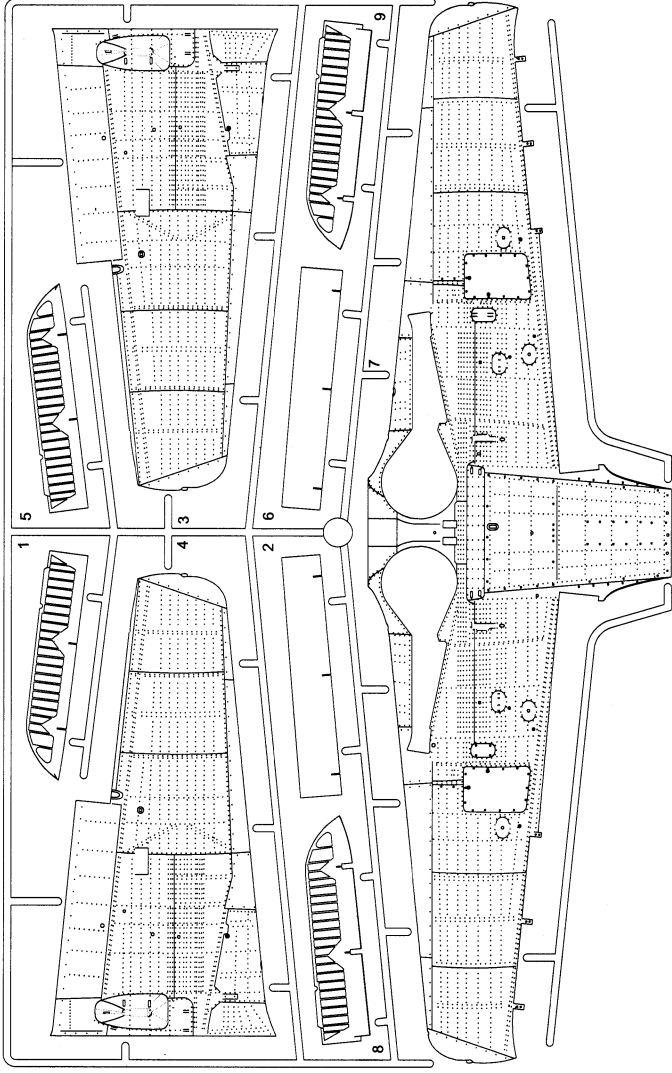

D

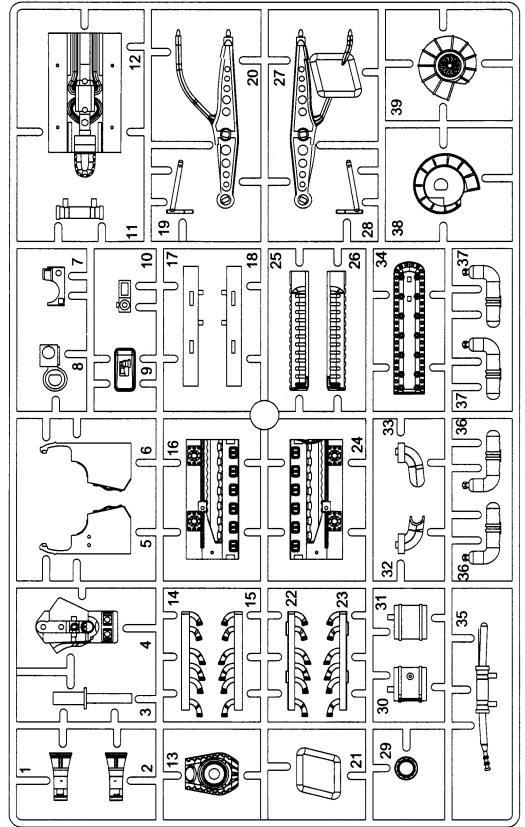

F

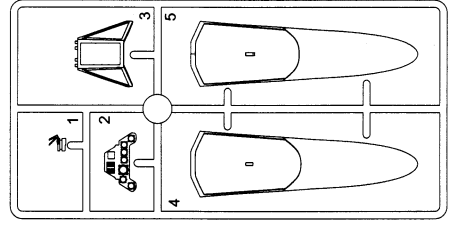

G

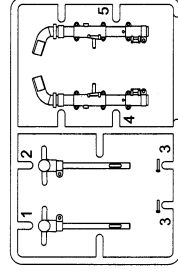

C

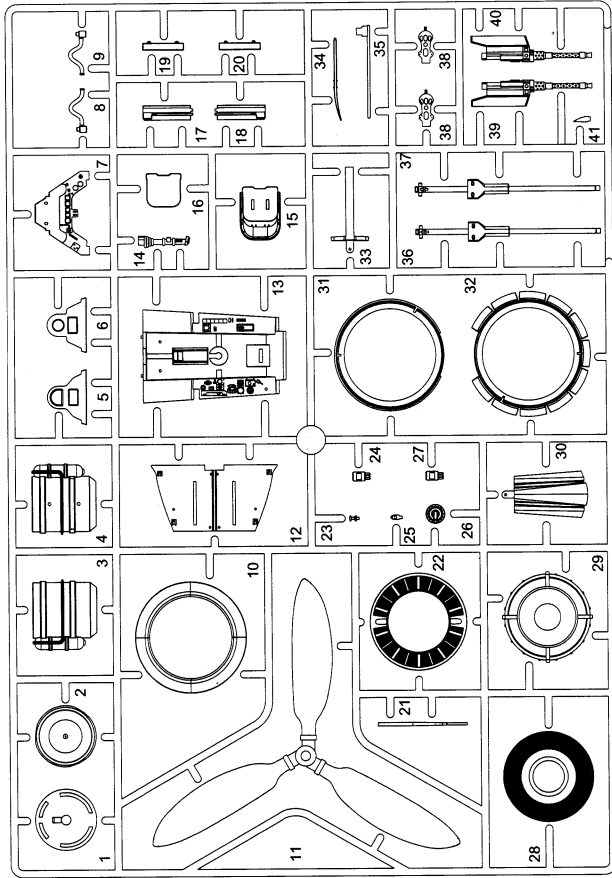

蚀刻片  
Photo etch part(PE)

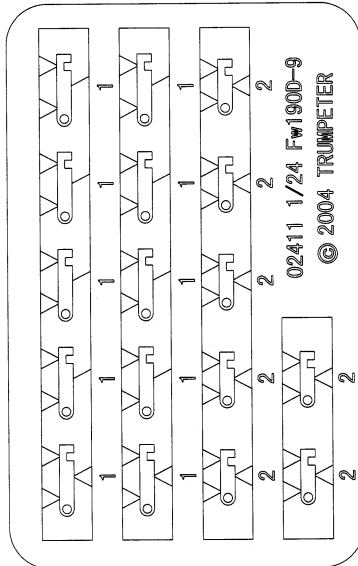

非林片  
Film

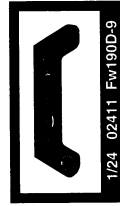

水贴纸  
Decal

轴  $\phi 1.0 \times 49\text{mm}$   
Shaft  $\phi 1.0 \times 49\text{mm}$

轴  $\phi 1.0 \times 20\text{mm}$   
Shaft  $\phi 1.0 \times 20\text{mm}$

弹簧  $\phi 0.3 \times \phi 2.5 \times 15 \times 18$ 圈  
Spring  
2pcs

1pcs

7pcs

2pcs

2pcs

3

E

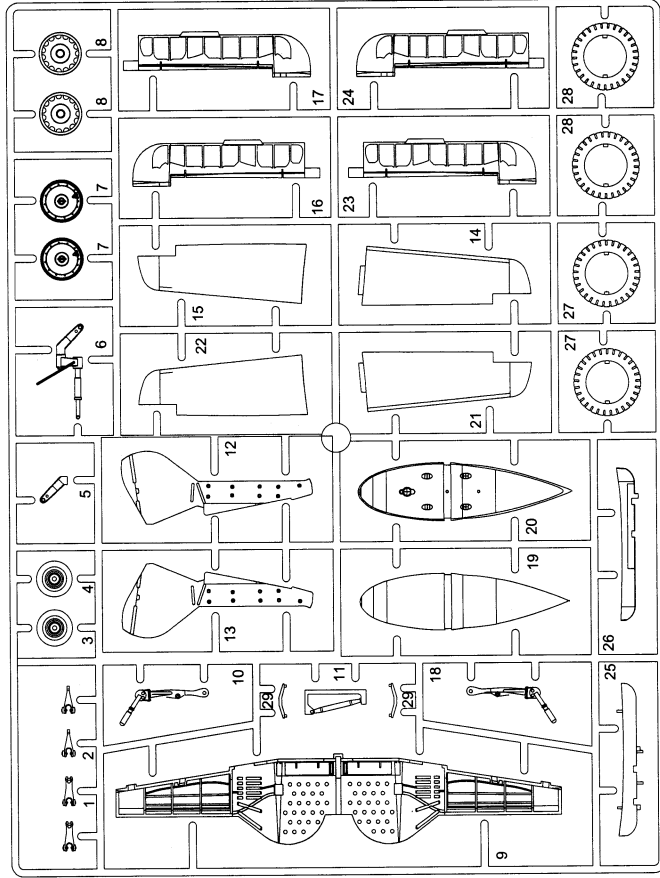

颜色指示  
Color

H 1 1	白色	White	H 116	德国灰	German gray
H 4 4	黄色	Yellow	H 117	浅兰色	Light blue
H 8 8	银色	Silver	H 70	墨绿色	Dark green
H 12 33	消光黑	Flat black	H 47 41	红棕色	Red brown
H 28 78	黑铁色	Metal black	H 90 47	透明红	Clear red
H 76 61	烧铁色	Burnt iron	H 91 48	透明黄	Clear yellow
H 70 60	灰绿色	RLM 02 Gray	H 93 50	透明蓝	Clear blue

02411

**1** 发动机的组装  
Engine assembly

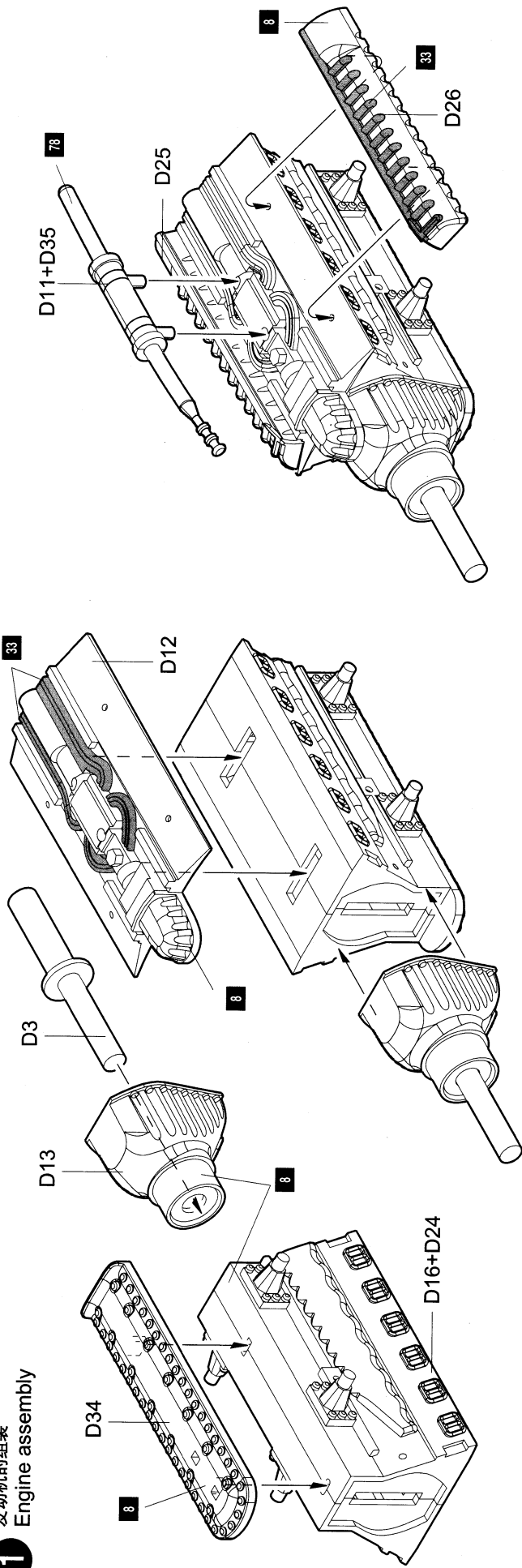

**2** 发动机的组装  
Engine assembly

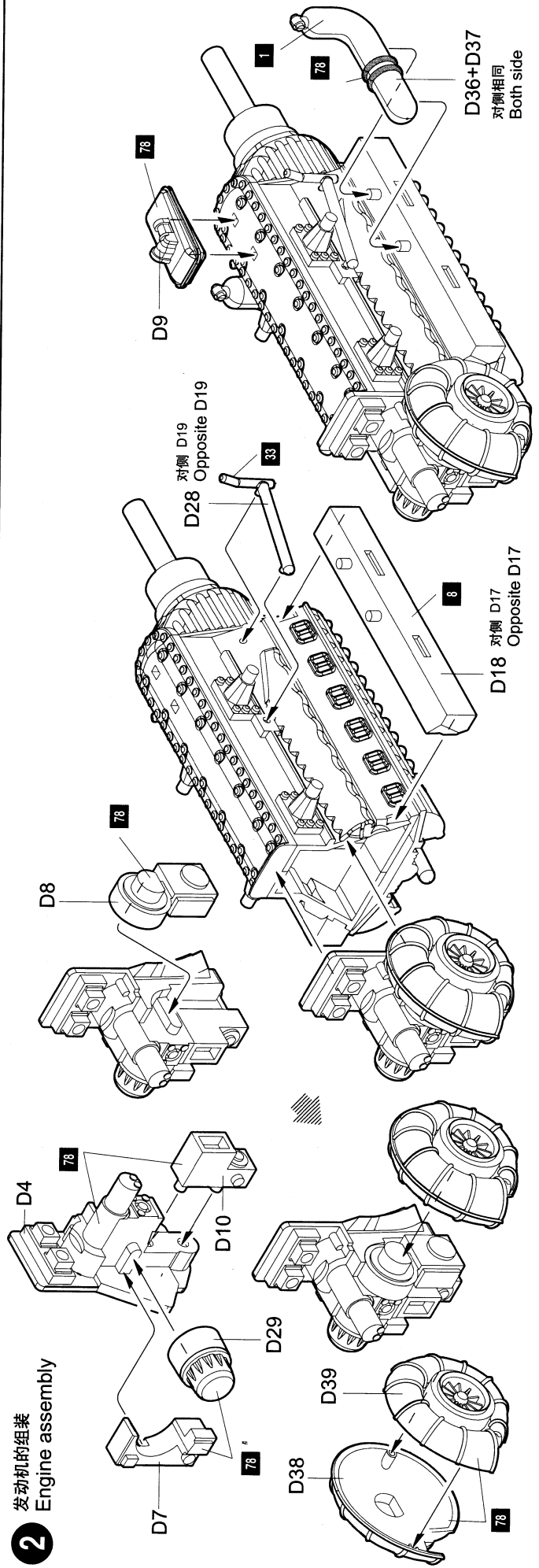



5 发动机的安装  
Engine installation

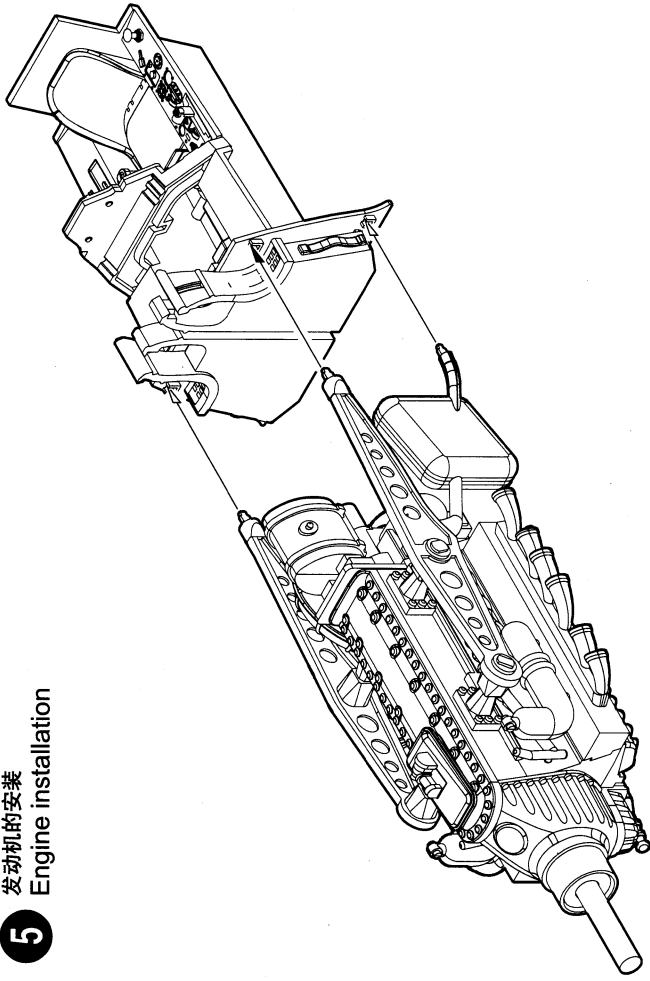

6 左侧机枪的组装  
Left machine gun assembly

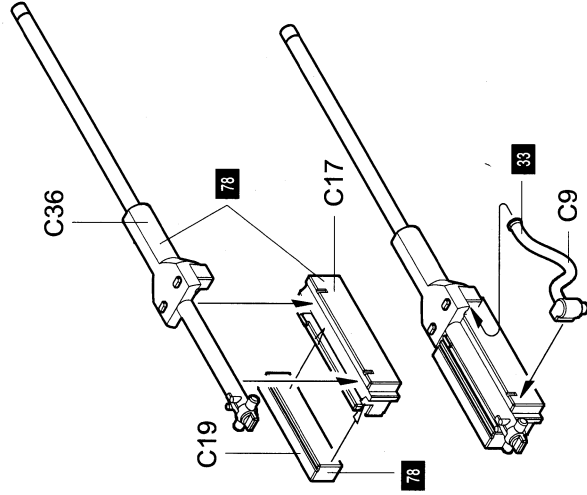

7 右侧机枪的组装  
Right machine gun assembly

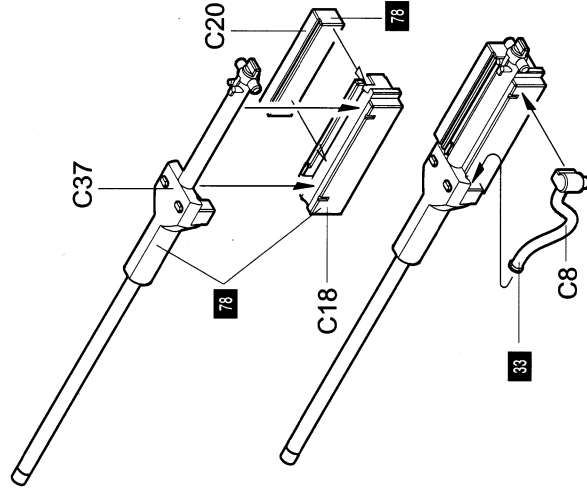

8 左侧机身的组装  
Left fuselage assembly

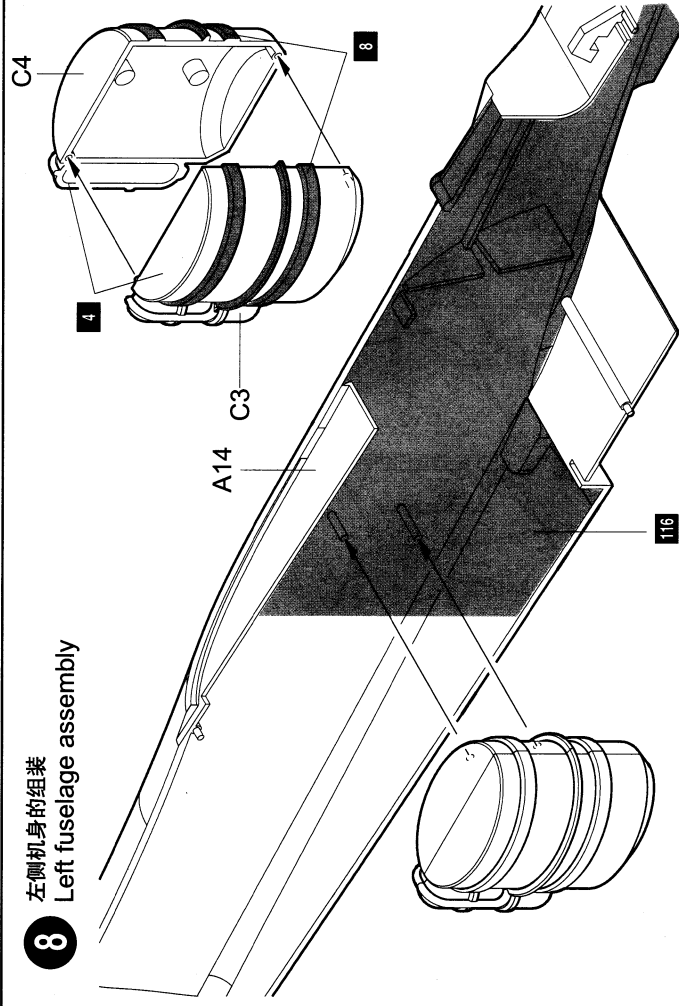

9 右侧机身的组装  
Right fuselage assembly

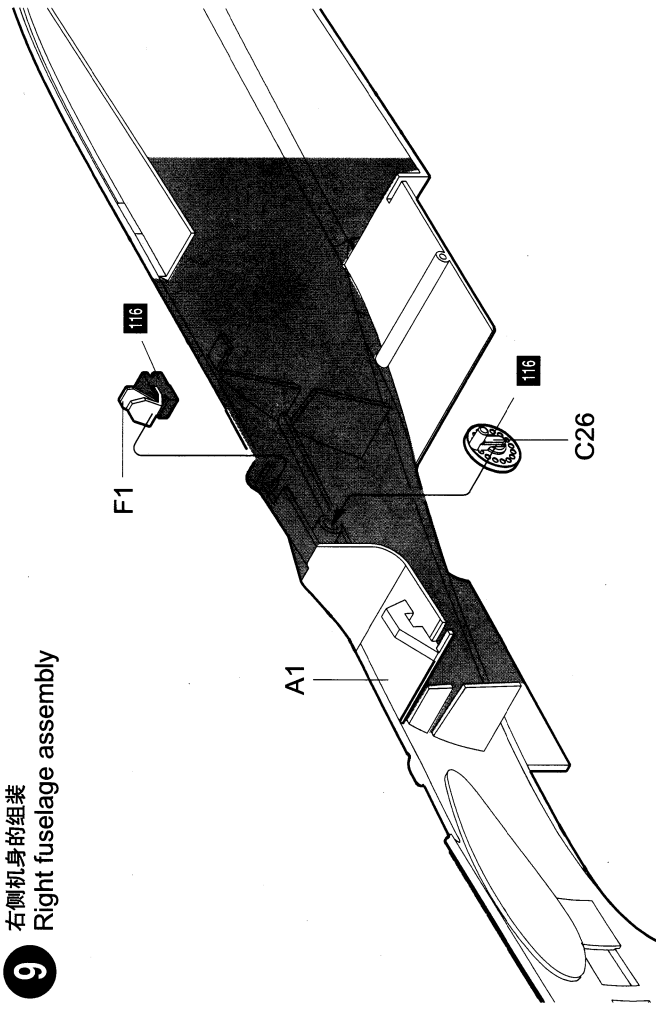

**10** 尾轮的组装  
Tail gear assembly

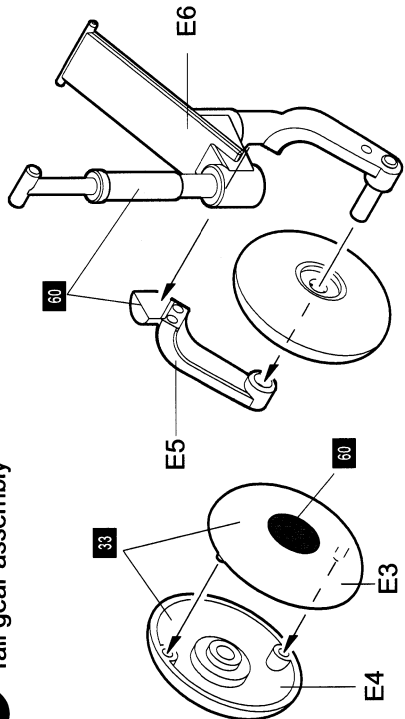

**11** 机身的组装  
Fuselage assembly

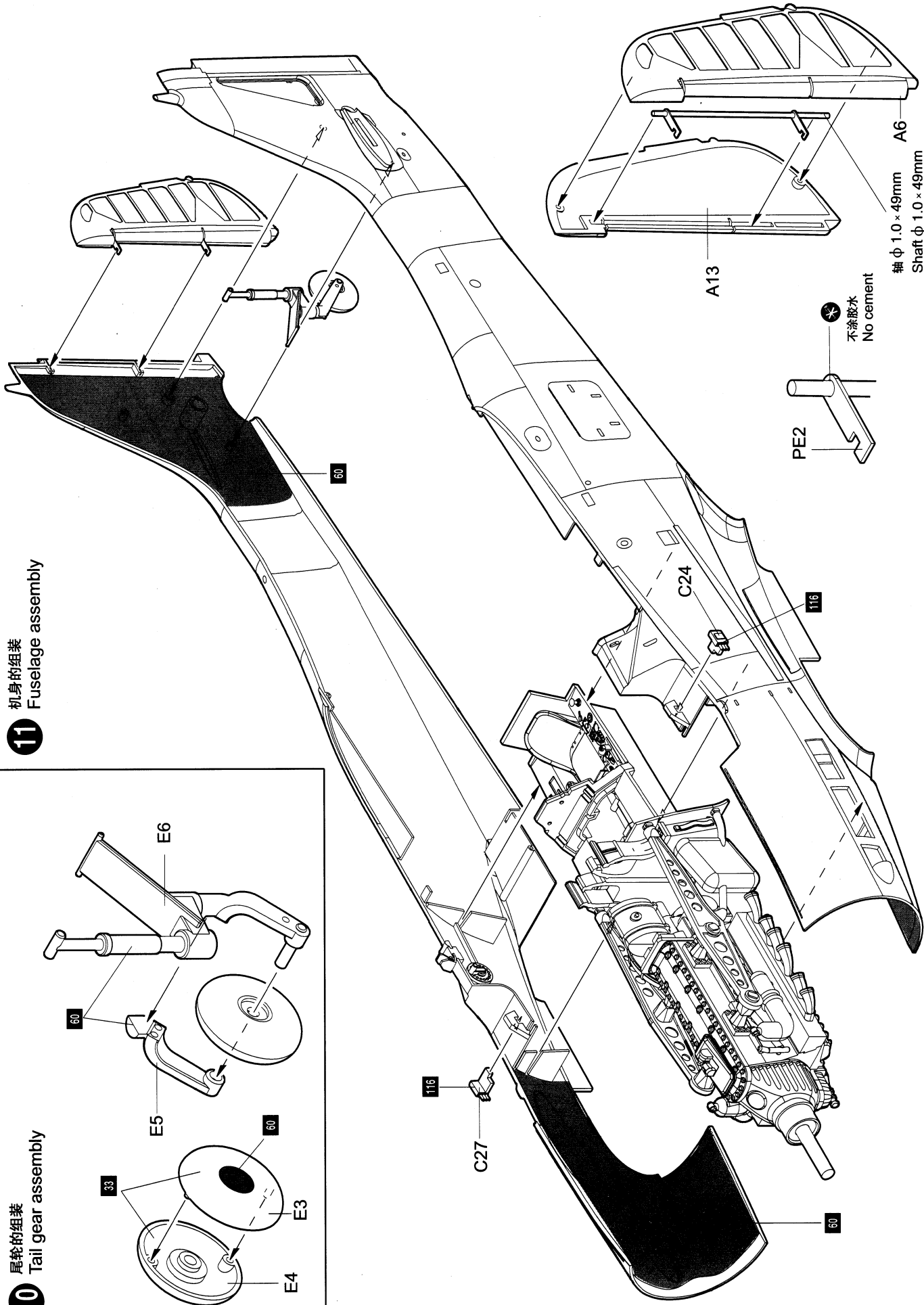

不涂胶水  
No cement

轴  $\phi 1.0 \times 49\text{mm}$   
Shaft  $\phi 1.0 \times 49\text{mm}$

**12** 机枪的组裝  
Machine gun assembly

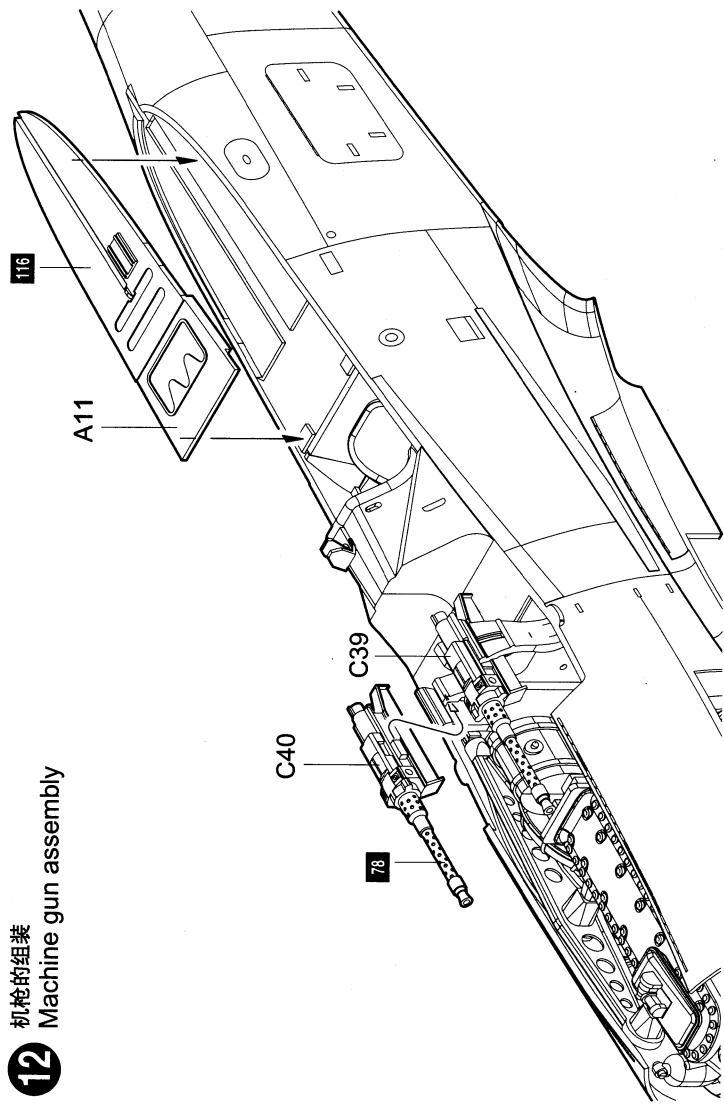

**15** 左侧水平尾翼的组裝  
Left horizontal stabilizer assembly

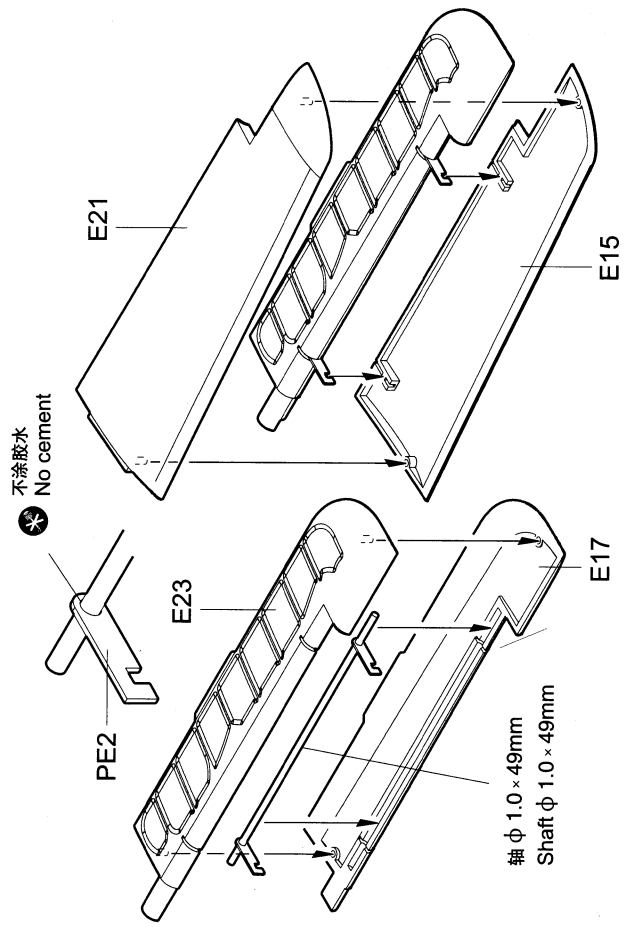

**13** 左侧副翼的组裝  
Left flap assembly

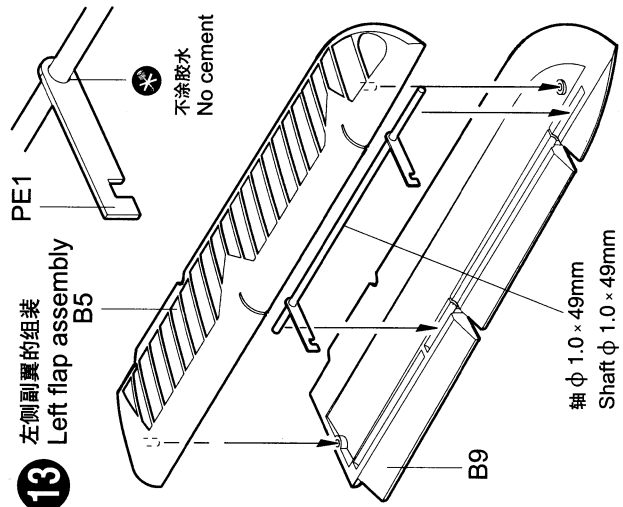

**14** 右侧副翼的组裝  
Right flap assembly

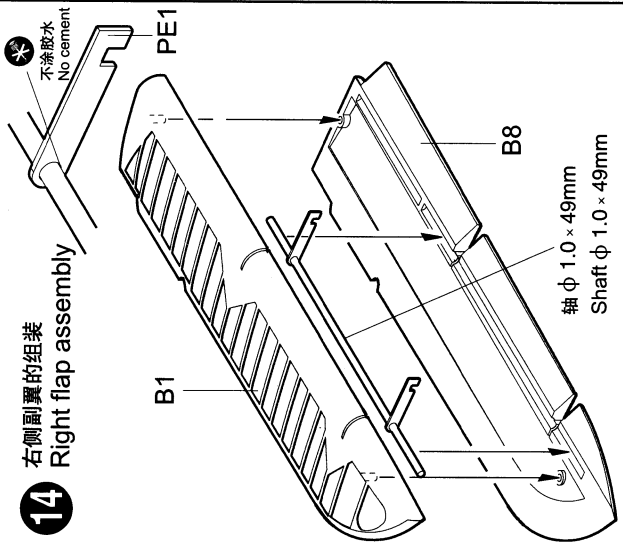

**16** 右侧水平尾翼的组裝  
Right horizontal stabilizer assembly

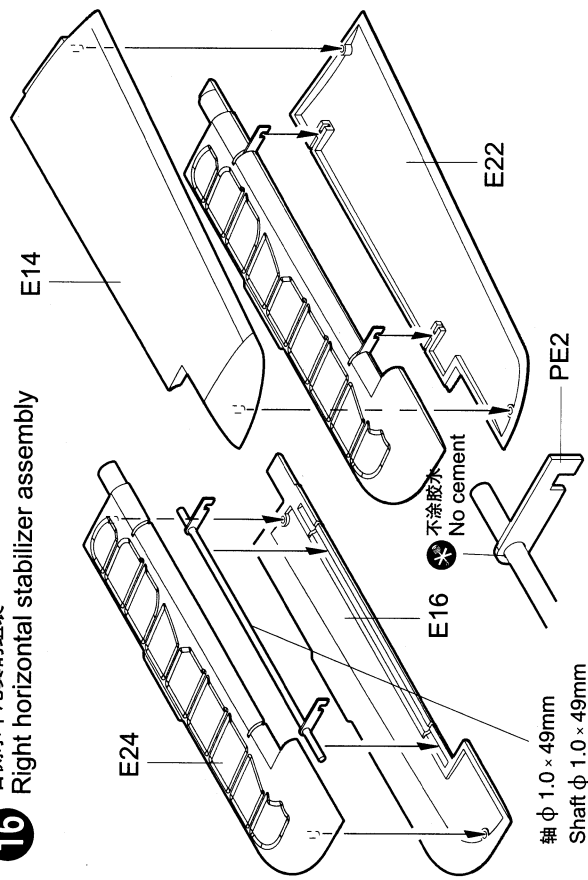

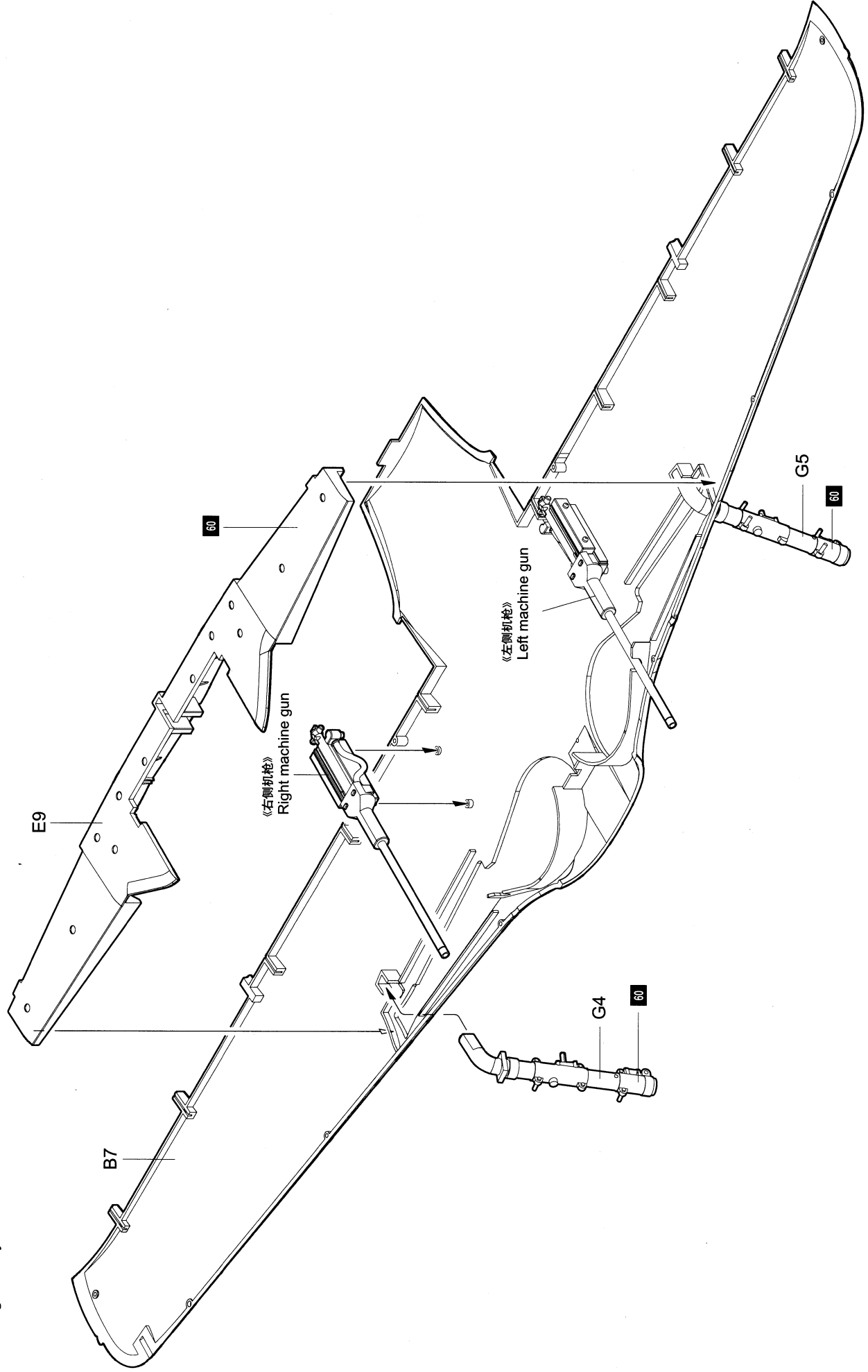

**18** 机翼的组装  
Wings assembly

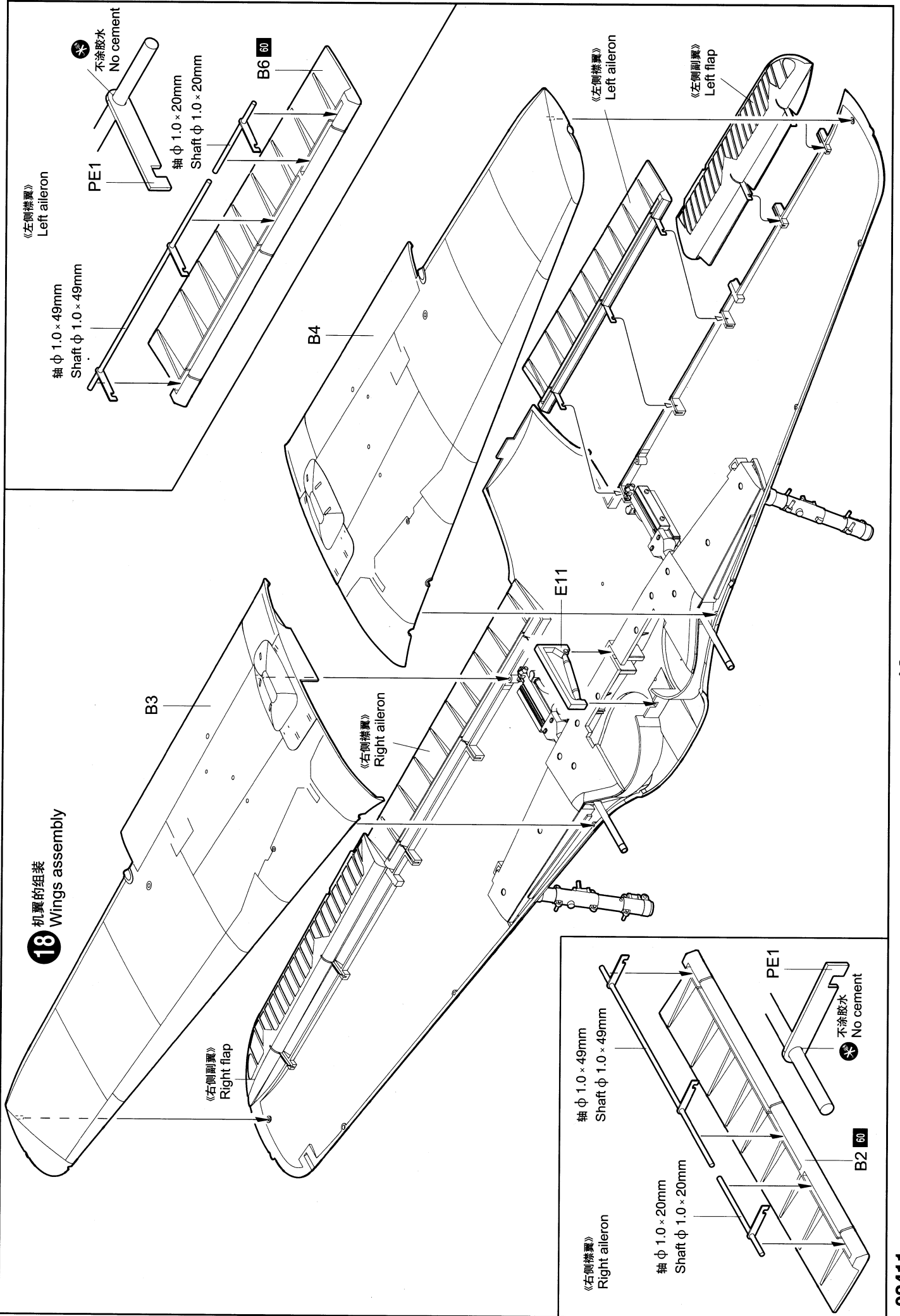

**19** 机翼的安装  
Wings Installation

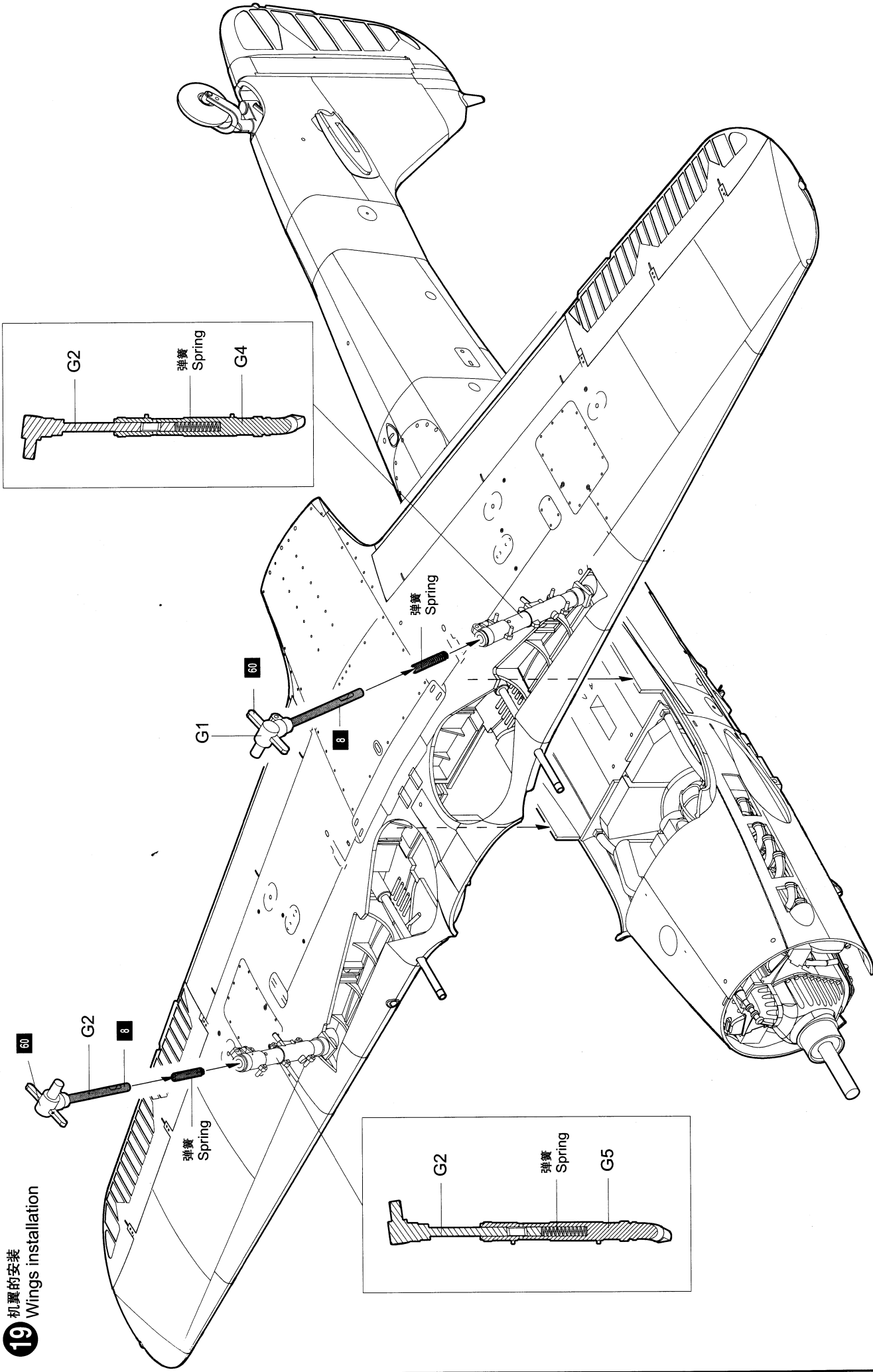

**20** 主起落架的组装  
Main undercarriage assembly

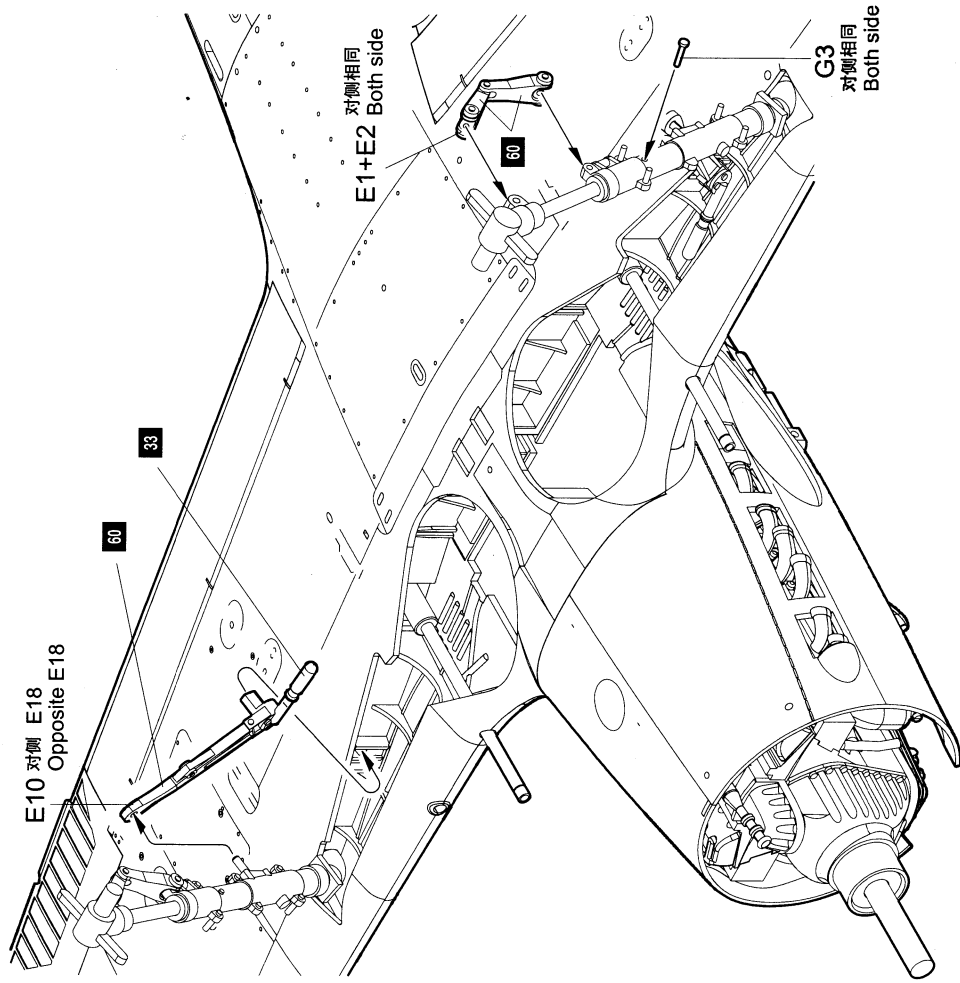

**22** 副油箱的组装  
Fuel tank assembly

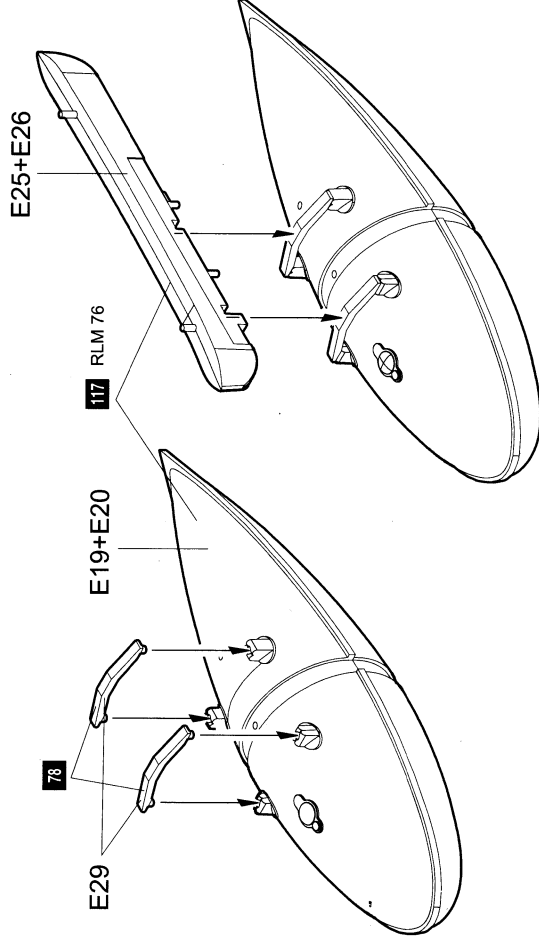

**23** 引擎罩的组装  
Cowling assembly

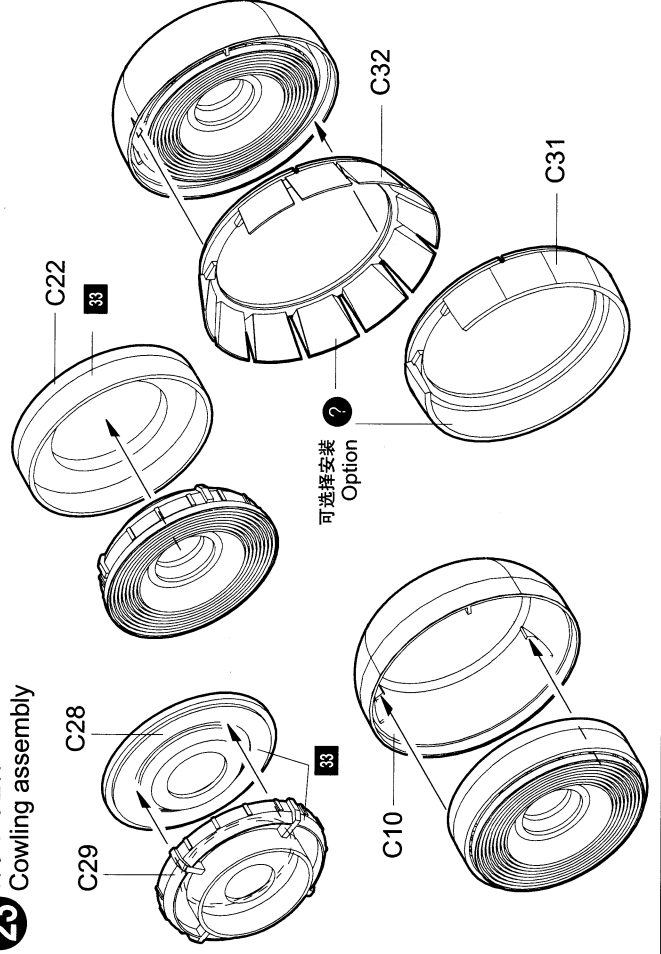

**21** 轮胎的组装  
Tire assembly

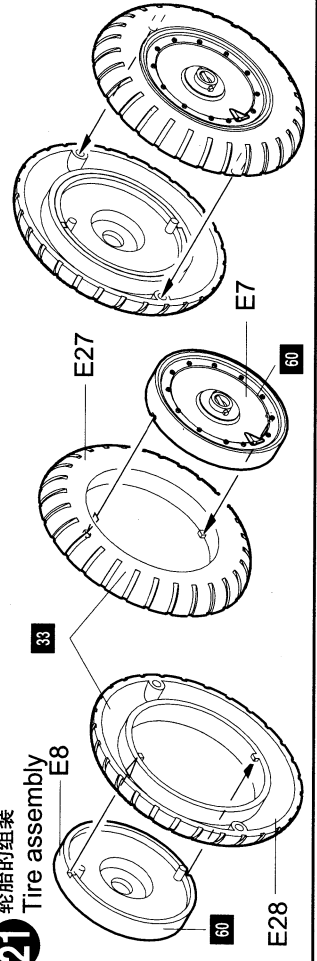

**24** 副油箱的安装  
Fuel tank installation

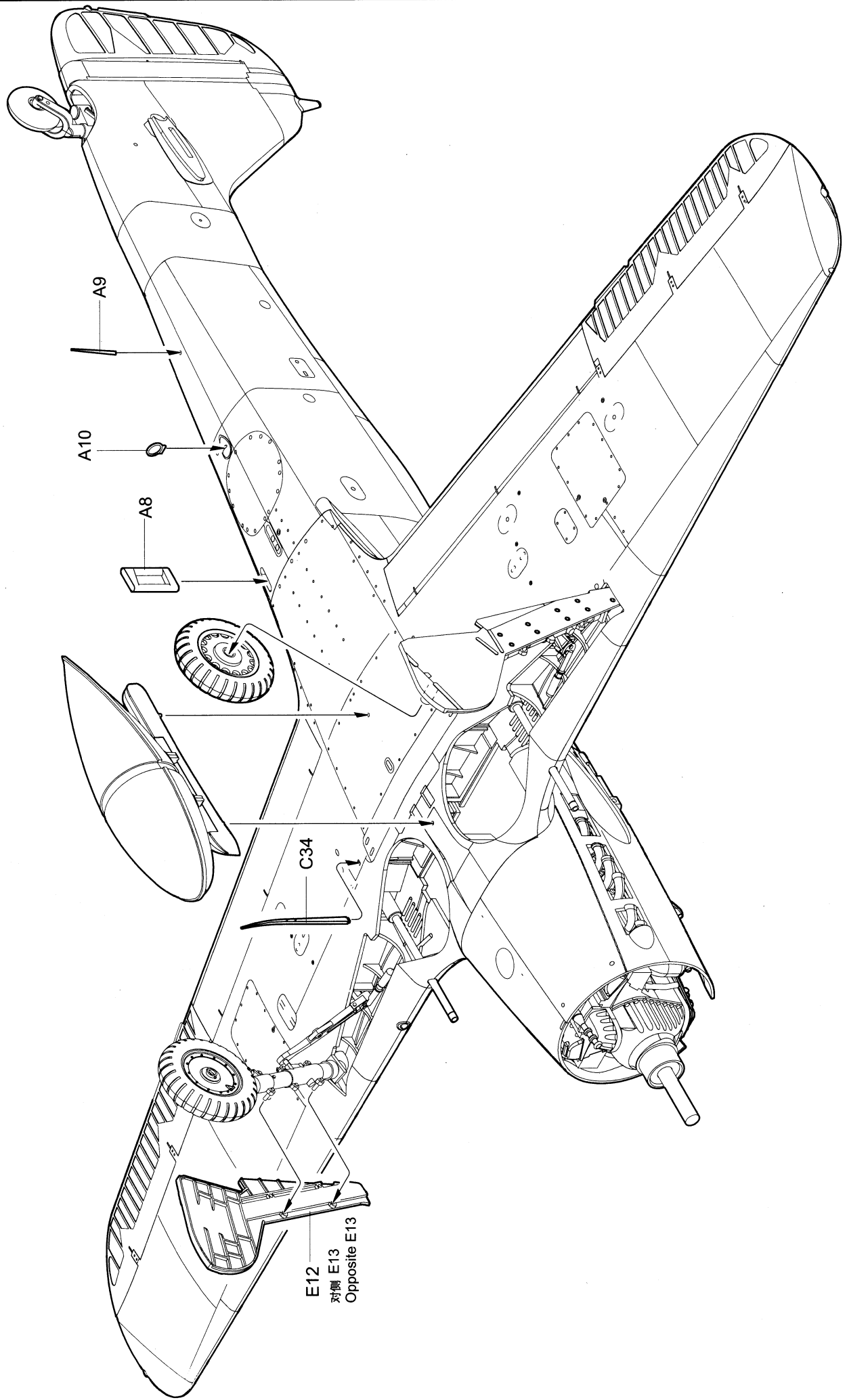

E12  
对侧 E13  
Opposite E13

A2 or A7 ? 选择 Option

60 内侧 Inside

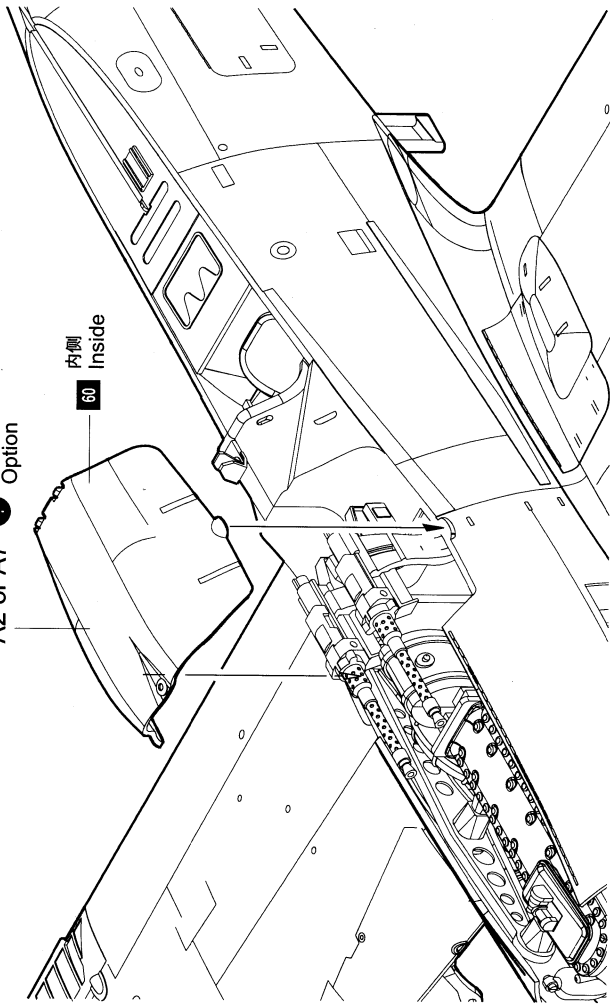

25 座舱罩的组装 (早期)  
Canopy assembly (Early)

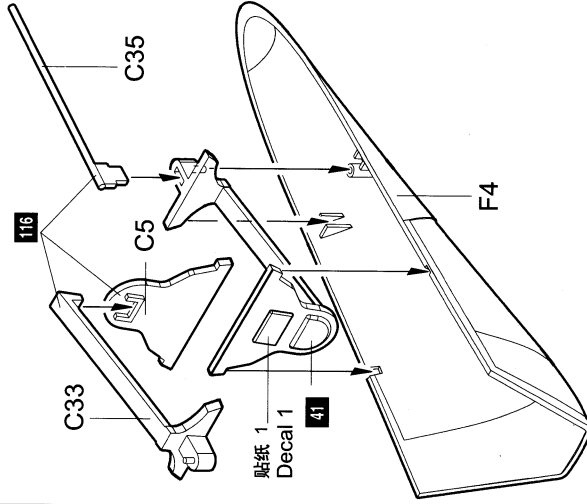

26 座舱罩的组装 (后期型)  
Canopy assembly (Later)

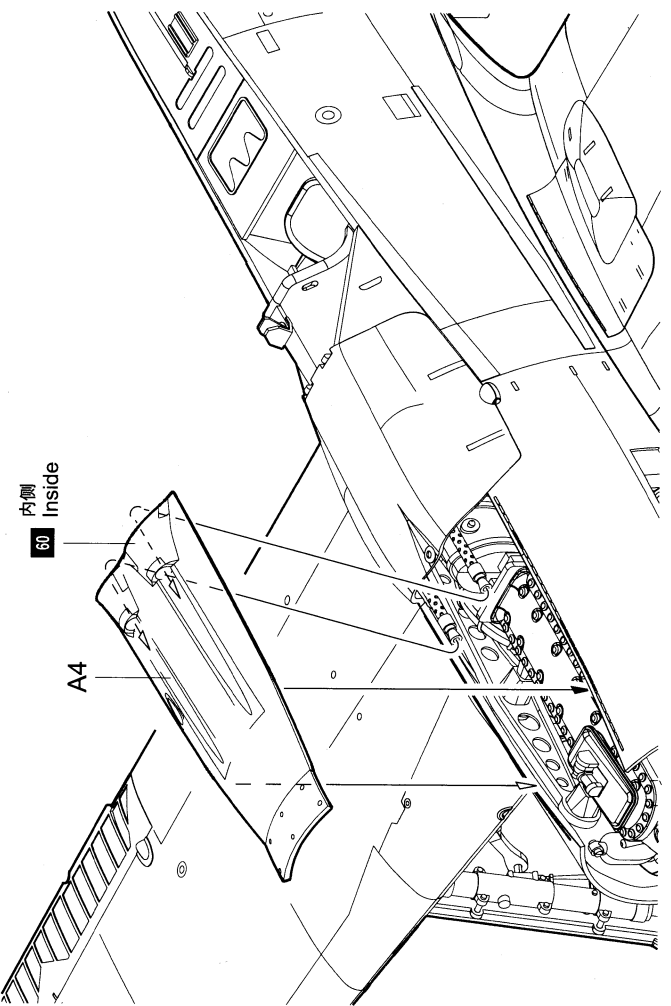
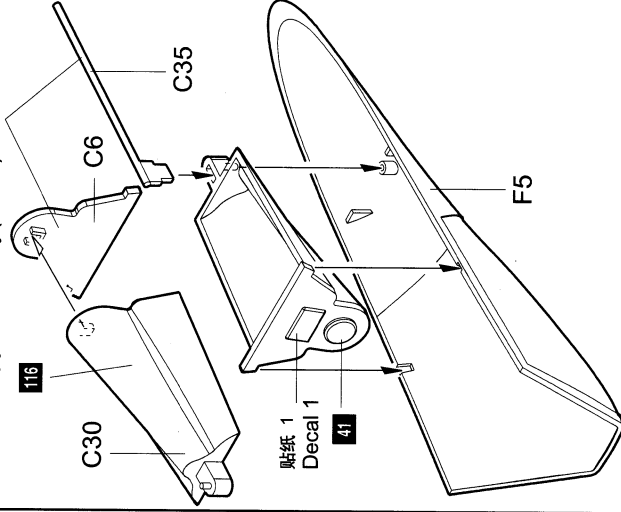

27 螺旋桨的组装  
Propeller assembly

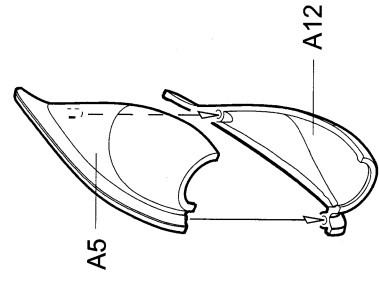
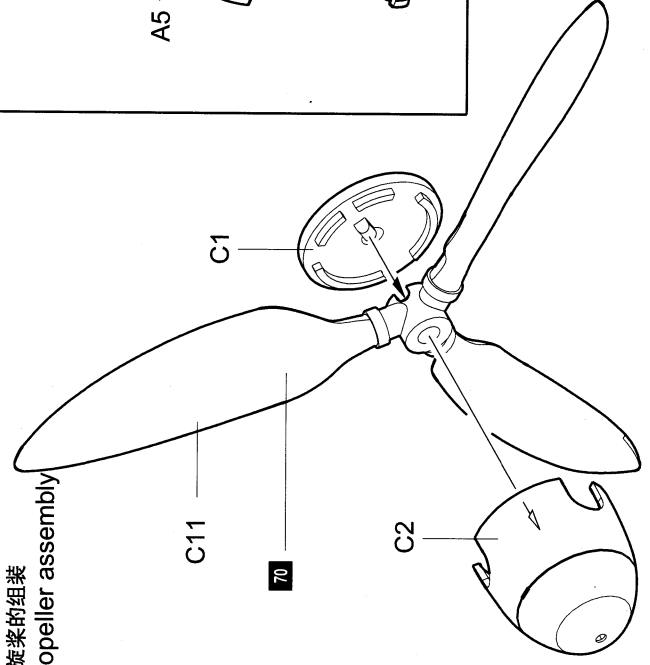

**28** 引擎罩的安装  
Cowling installation

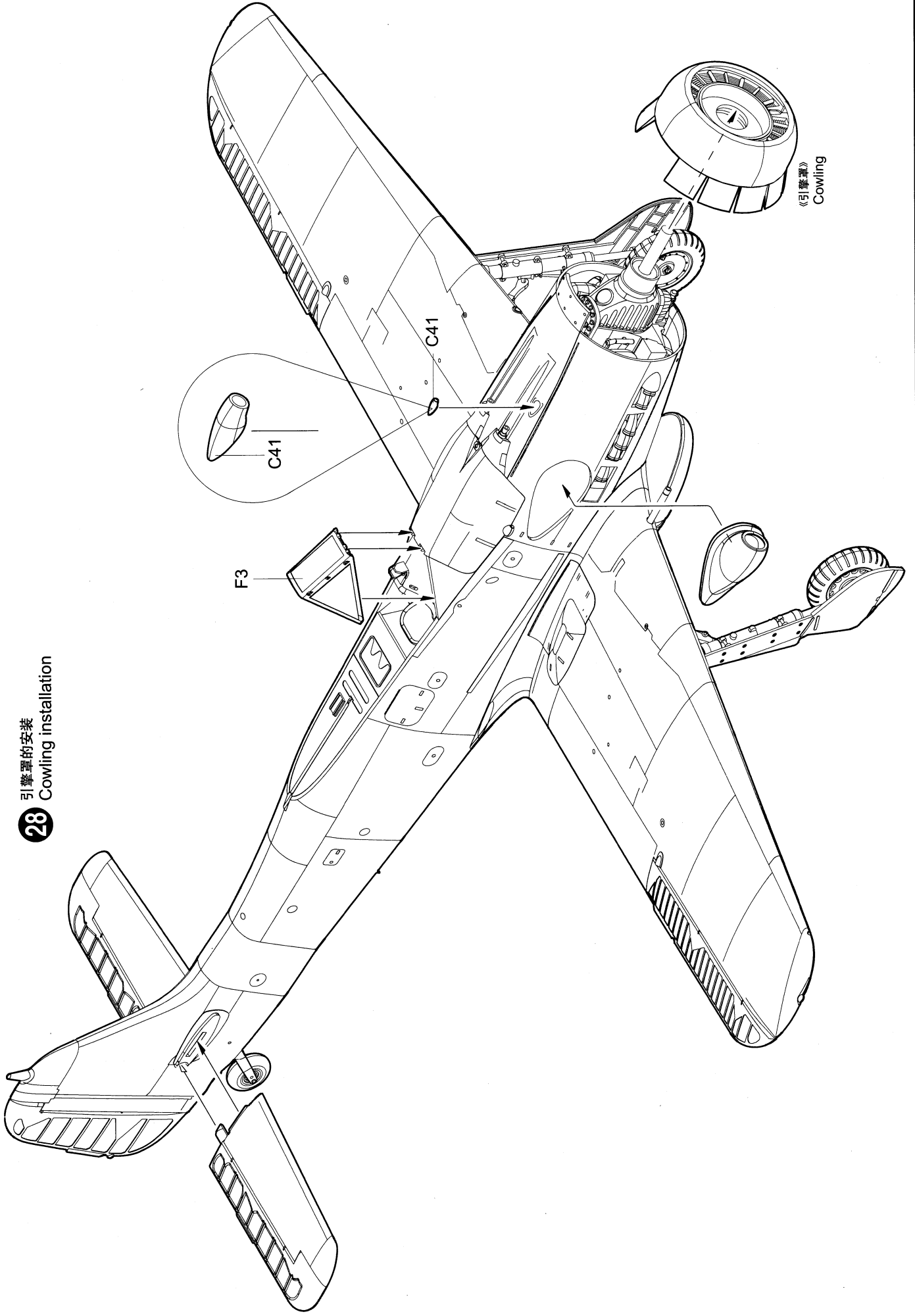

**29** 螺旋桨的安装  
Propeller installation

