

1:35 SCALE British Challenger 2 MBT KFOR in action at Kosovo

英国挑战者2型主战坦克南斯拉夫战争科索沃



READ BEFORE ASSEMBLY

- Study and understand this instructions thoroughly before beginning assembly.
- Remove all injection pins carefull using a modeling file.
- Cut off the photo-etched parts carefully using a modeling knife. Be sure not to lose small parts.
- Apply instant cement to photo etched parts and shafts. Apply too much instant cement will cause movable parts to stick. Apply cement carefully.
- Extra care should be taken to avoid personal injury when handling the photo etched parts.
- Some parts should depend on decals. Select piror to assembly.
- Tools recommended:(Not included in this kit)
- Cement;Side cutters;Long nose pliers;Modeling knife;Modeling file;Tweezers;Pin vise;Scissors;Instant cement.
- Soft cloth and sand paper will also assist in construction.
- Glue and paints are not in cluded in the kit. Use plastic cement or paints only.
- Keep out of reach of small children. Children must not be allowed to suck any part, or pull vingl bay over the head.

装配之前仔细阅读

- 小心用模型锉刀锉平所有零件表面的注射浇口。
- 小心用刀片切下蚀刻片零件，不要遗失小零件。
- 用强力快干胶水粘合蚀刻片零件和金属轴。过量的快干胶水使用可能导致可动零件会粘住，小心涂胶。
- 取蚀刻片时应特别注意安全，防止利边划伤手指。
- 某些零件表面需贴上水贴纸，请选择在装配的同时进行。
- 推荐模型工具(自备)：胶水，水口剪刀，长咀钳，刀片，锉刀，镊子钳，钻，剪刀，瞬间快干胶。
- 软布同砂纸同时也应该是必备工具。
- 请使用塑料胶水和油漆，模型内不含。
- 谨防小孩吮吸塑料零件，或者将塑料袋套在头上，制作时应将套材远离小孩接触。



cyanoacrylate glue
使用强力胶



weight
配重



make hole
钻孔



cut / remove
切除



bend
弯曲



file / sand
锉平



option
选择



no cement
不涂胶水



decal
贴纸

水贴纸的使用:

1. 从水贴纸上剪下印花;
2. 将印花放入温水中浸10秒，然后放在干净布上。
3. 拿着印花纸板将印花移到模型上;
4. 手指蘸水将印花移到适当的位置;
5. 用软布轻压印花直至水干，气泡消失。

DECAL APPLICATION

1. Cut off decal from sheet.
2. Dip the decal in tepid water 40° C for about 10 sec. and place on a clean cloth.
3. Hold the backing sheet edge and slide decal onto the model.
4. Move decal into position by wetting decal with finger.
5. Press decal gently down with a soft cloth until excess water and air bubbles are gone.

部品图 Parts

A × 2

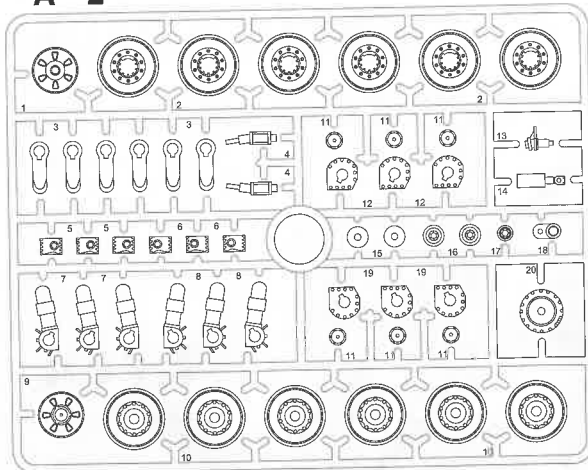

C

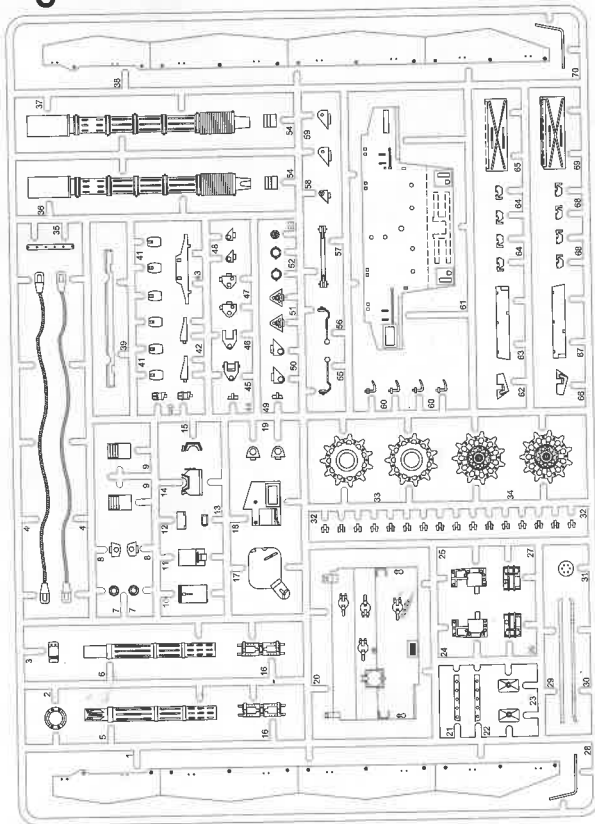

《炮塔底》
Lower turret

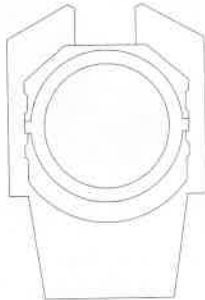

《炮塔》
Turret

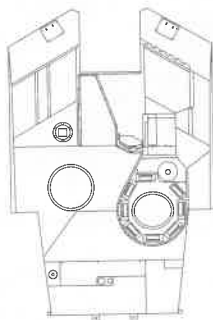

D

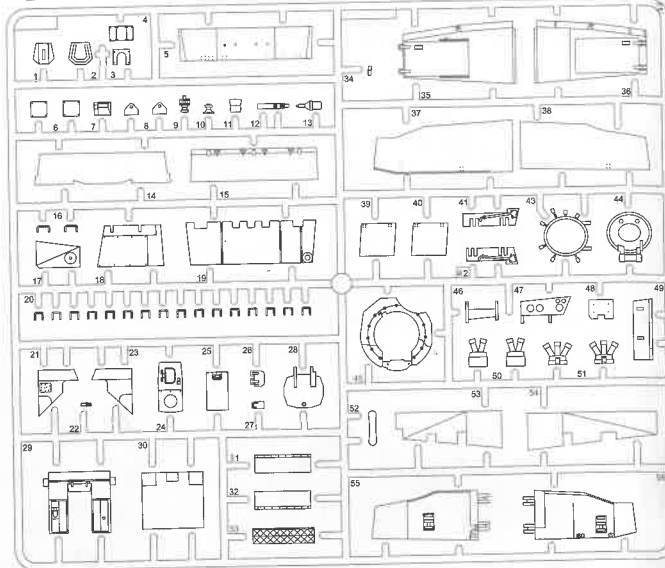

G

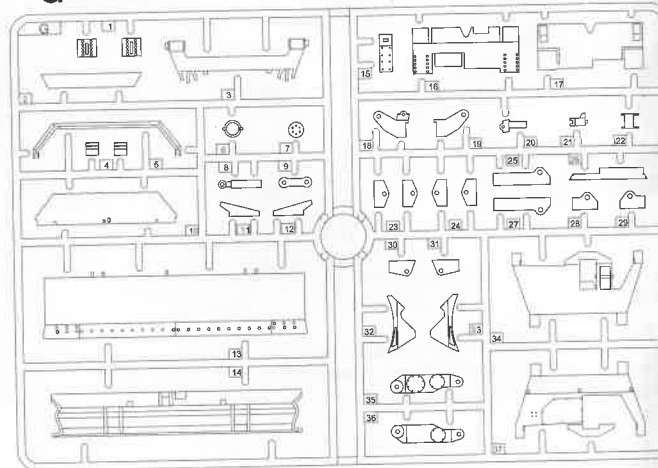

H

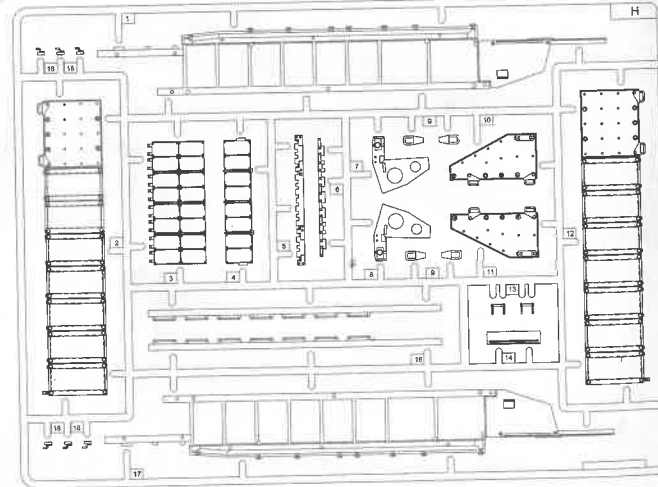

《聚乙烯套》
Poly Cap



《棉线》
Cotton thread



《水贴纸》
Decal

E

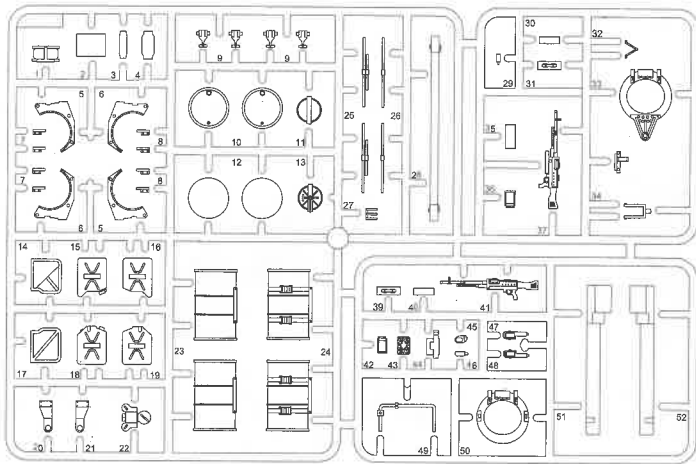

《履带》× 2
Track × 2

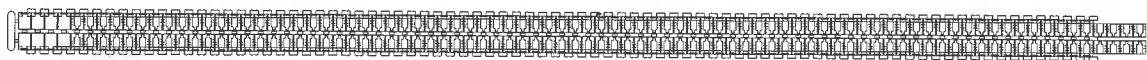

《车底》
Lower hull

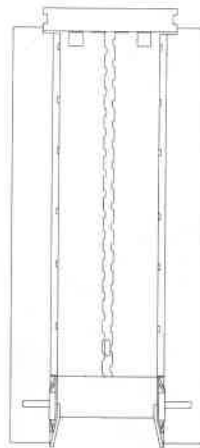

《车面》
Upper hull

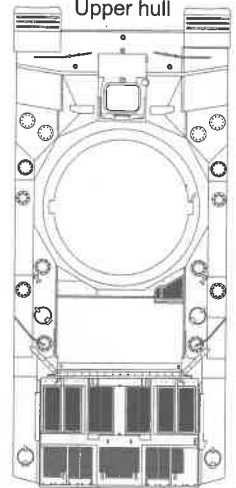

组装之前，请前依自己喜好参考第15.16两页涂装，选择A,B,C,D其中一种
Selet either one making for you to use refer to Page 15 and 16, before assembly

《天线制作》 How to make antenna

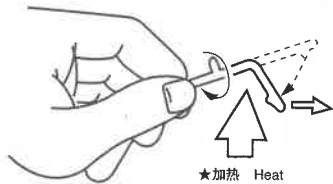

★加热浇口，拉线冷却，冷却后切成所需长度。
Heat sprue as shown,remove from flame and streth allow to cool and cut to required length.

1 履带联接 Track construction

根据实际要求选择履带尺寸；
用热铁钉软化接头，用手指压下接头。
若履带断裂，用细丝线固定。
Melt pin heads carefully with a heated nail etc.
Immediately press pin heads with your finger.
If track is broken strengthen with staples or thread.

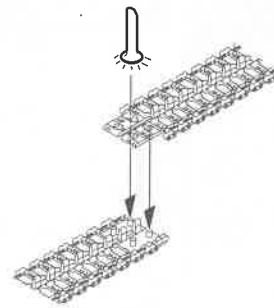

2 车轮组装 Wheels assembly

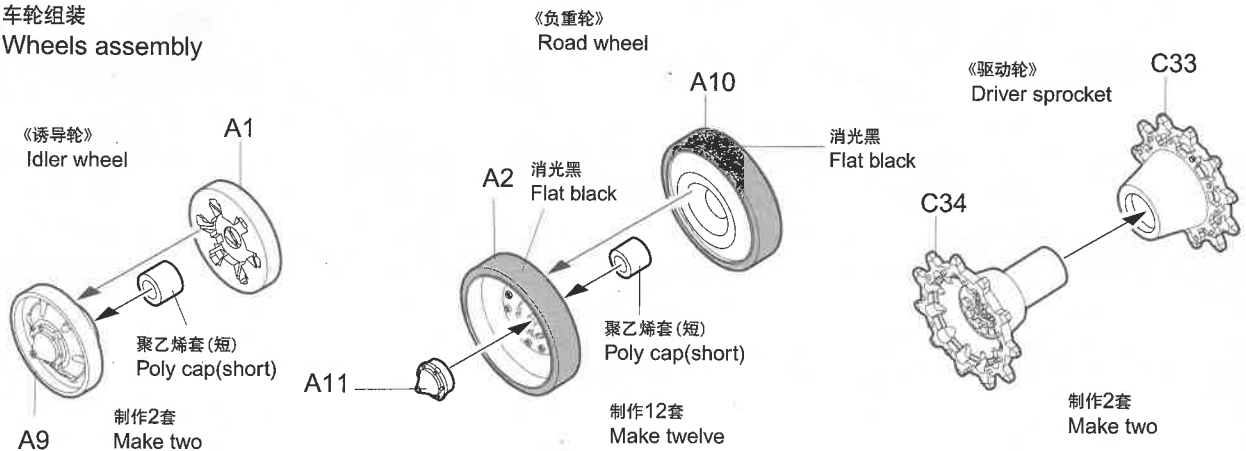

5 车轮安装 Attaching wheels

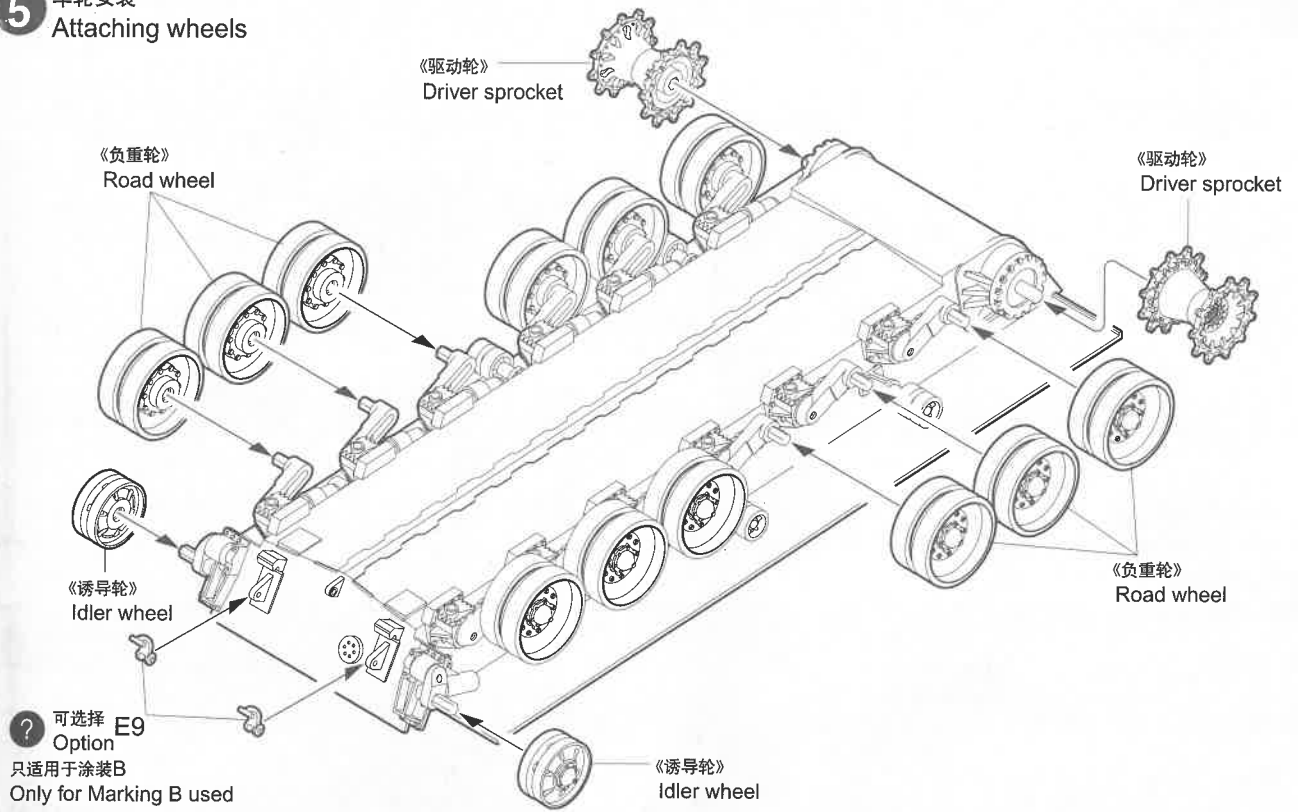

6 后板组装 Rear panel assembly

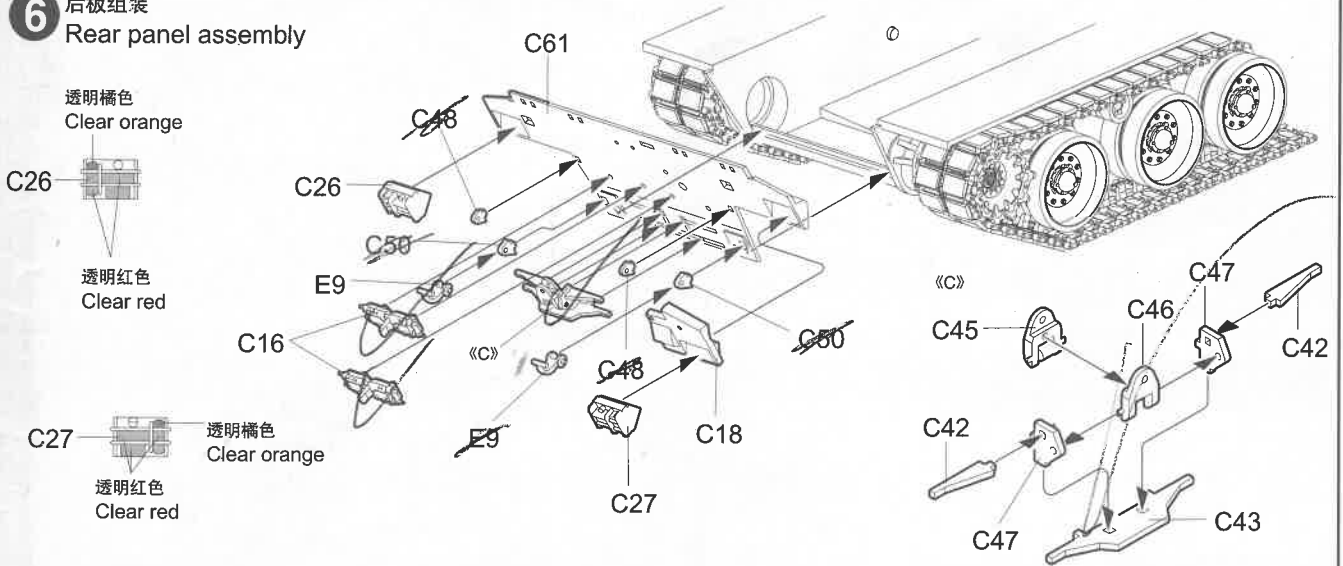

7 油壶组装 Jerry can

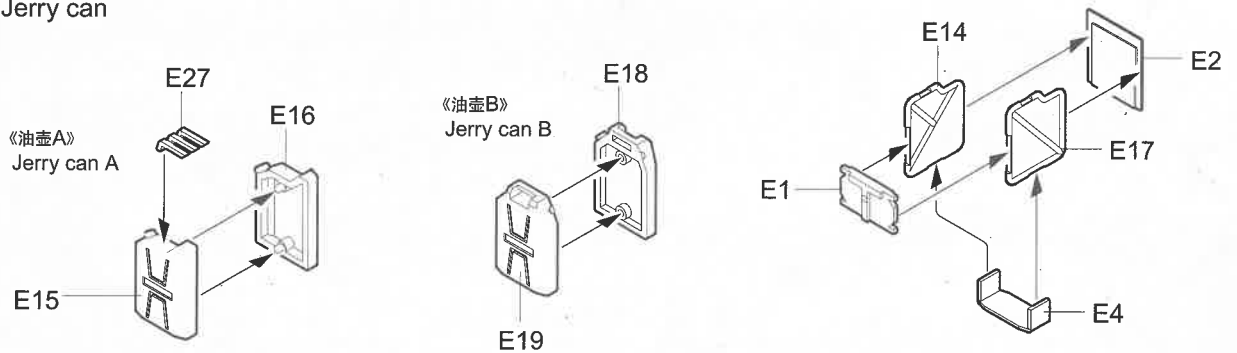

8 后板组装
Rear panel assembly

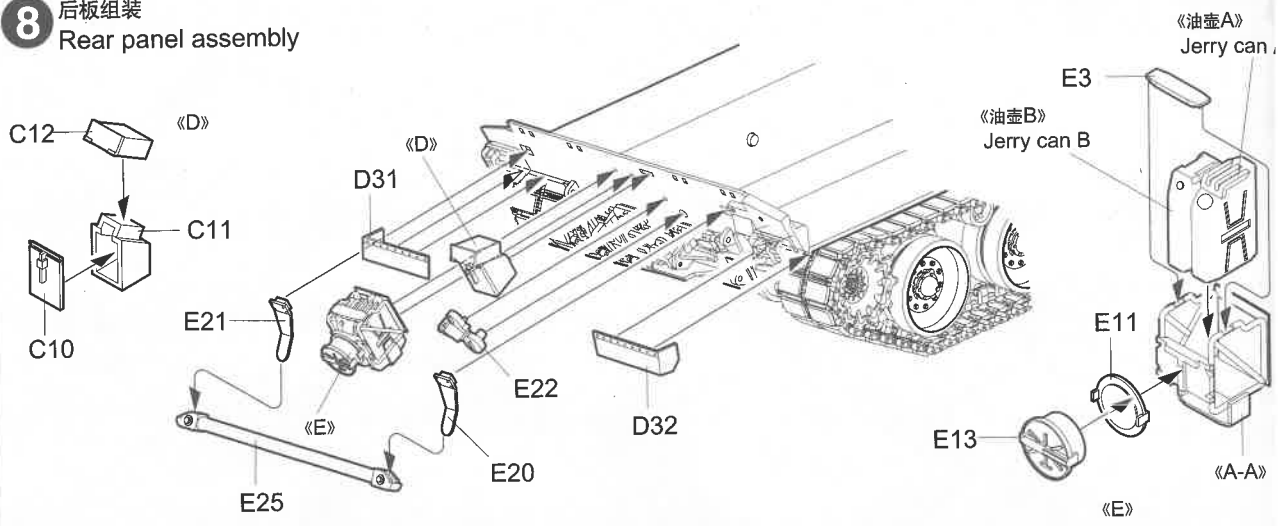

9 后板组装
Rear panel assembly

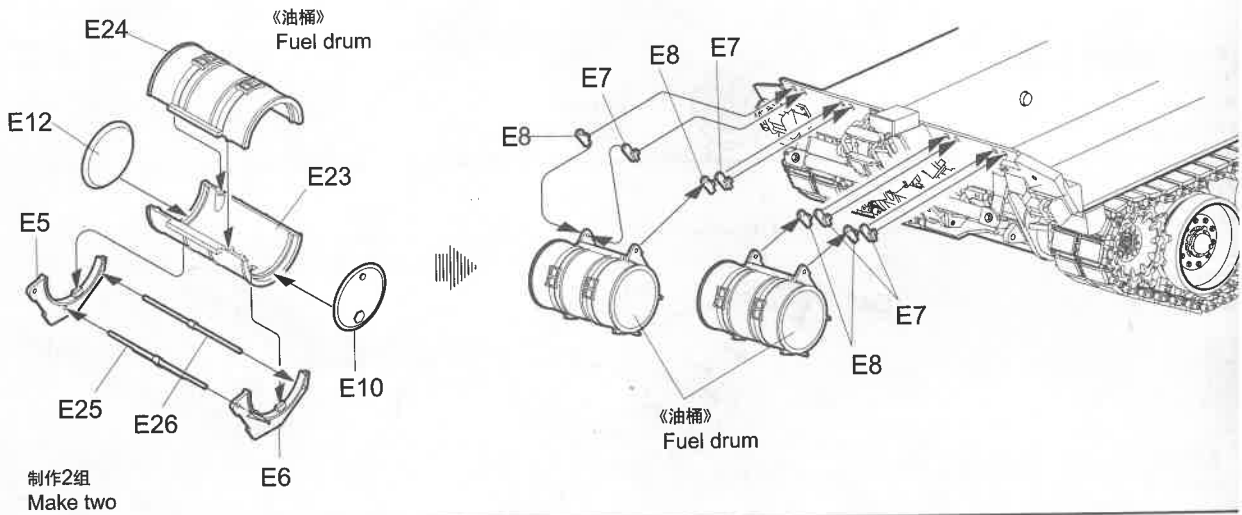

10 车体上部组装
Upper hull assembly

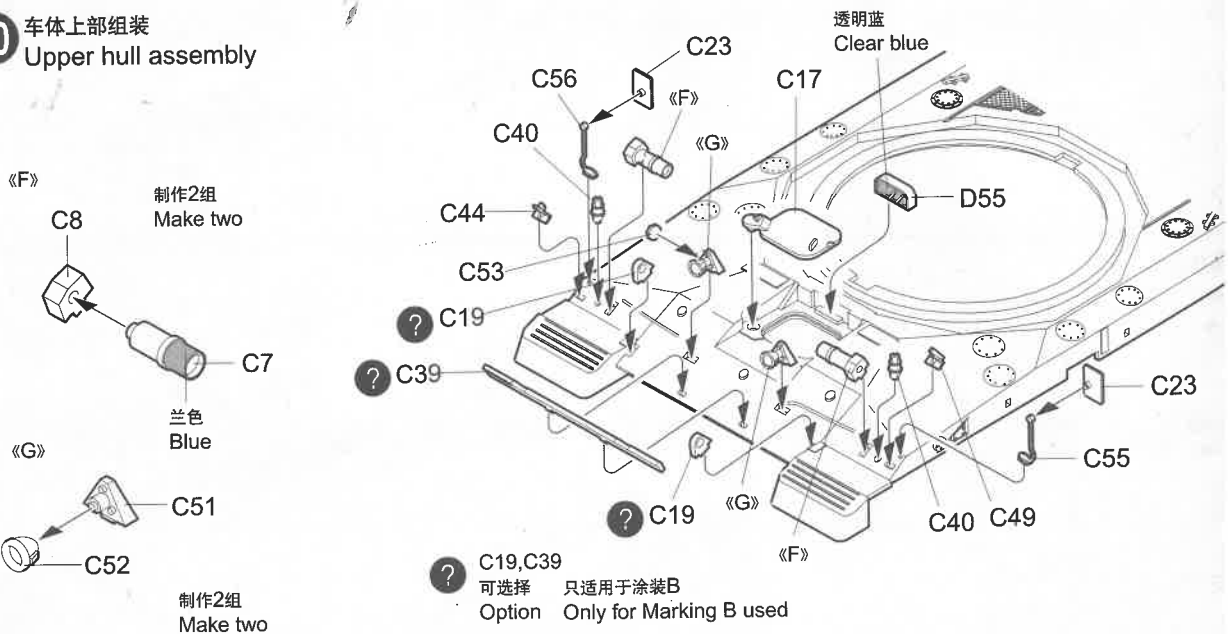

11 车体上部组装
Upper hull assembly

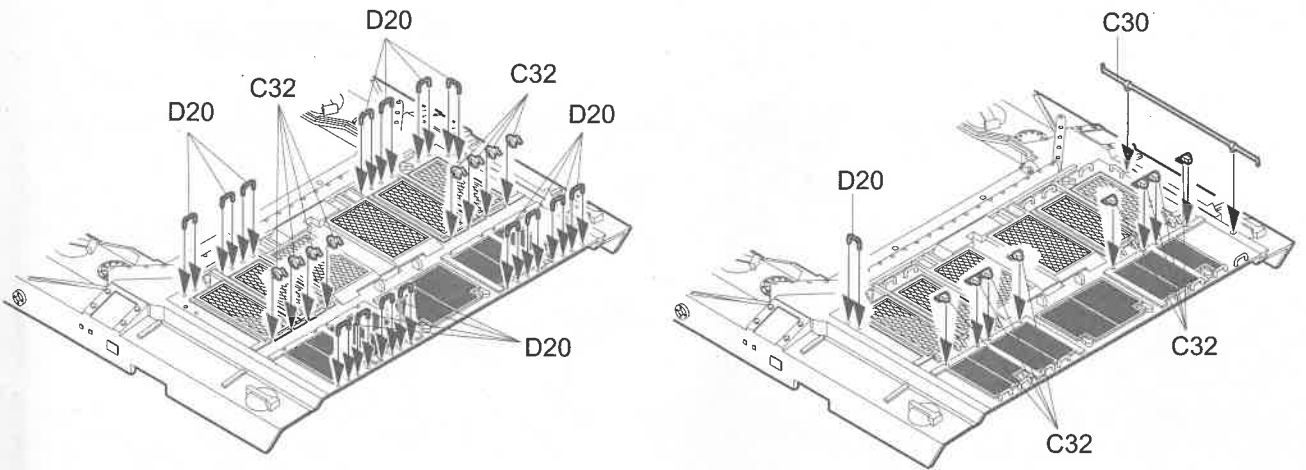

12 车体上部组装
Upper hull assembly

《右工具箱》
Tool box right

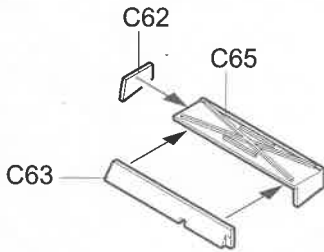

《左工具箱》
Tool box left

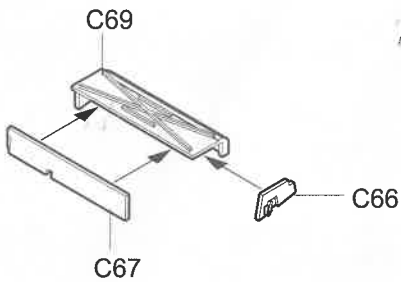

《H》

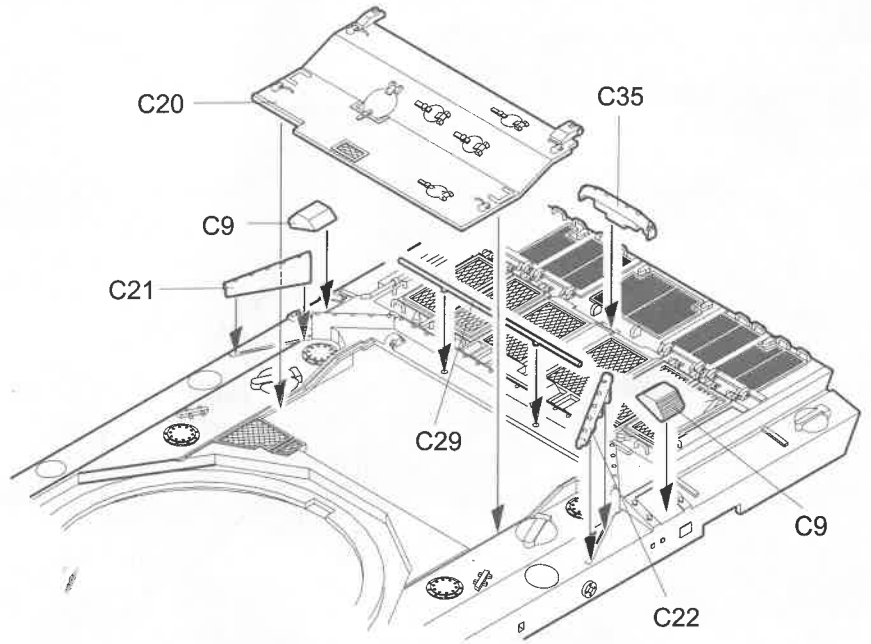
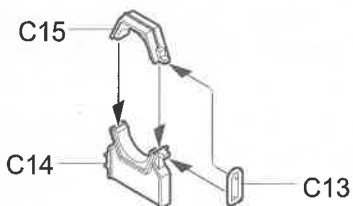

《右工具箱》
Tool box right

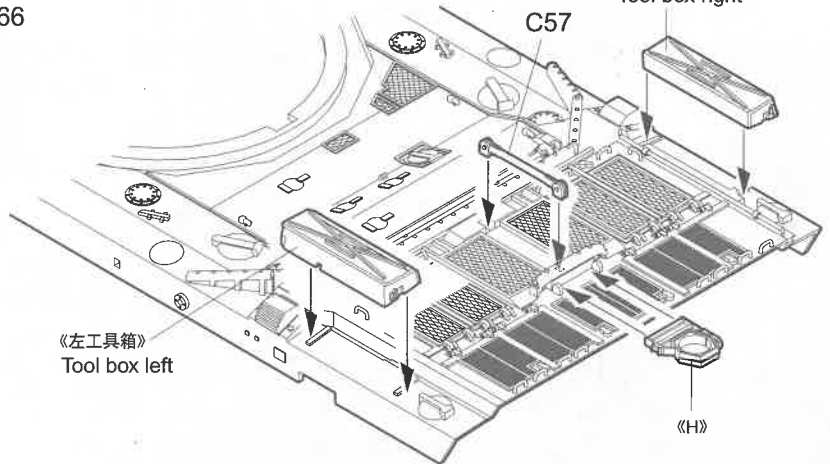

《左工具箱》
Tool box left

《H》

13 推土铲组装 Bucket assembly

② 可选择组装(只适用于涂装A,D)
Option (For Marking A&D used)

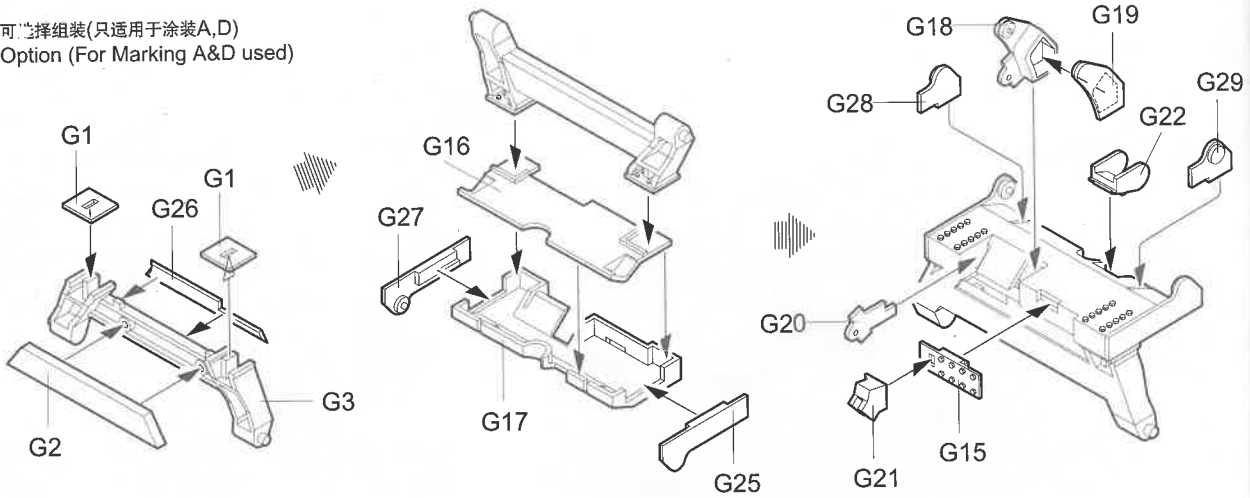

14 推土铲组装 Dozer blade kit assembly

② 可选择组装(只适用于涂装A,D)
Option (For Marking A&D used)

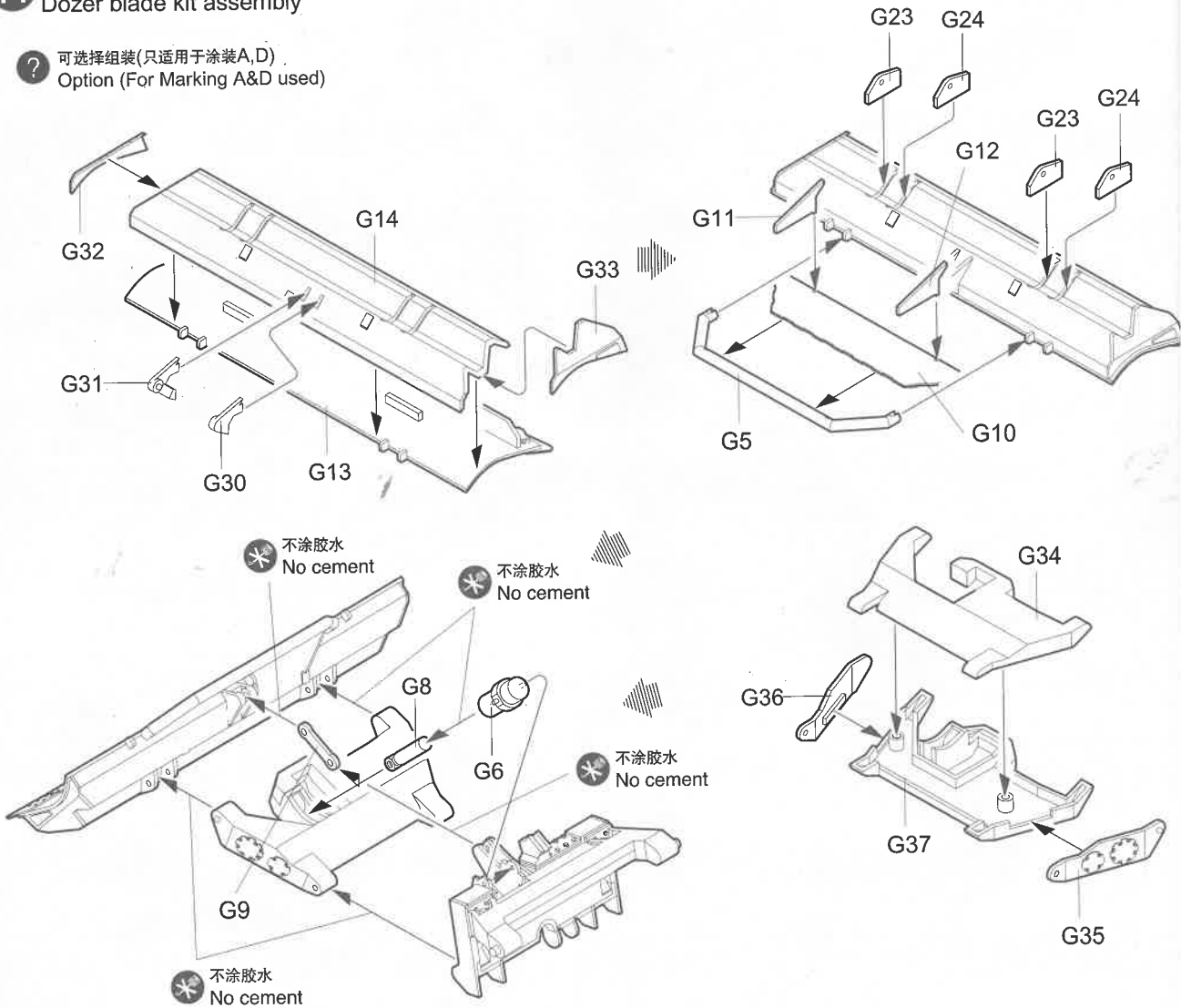

15 侧装甲组装
Side armor assembly

? 可选择组装 (只适用于涂装B,C,D)
Option (For Marking B,C,D used)

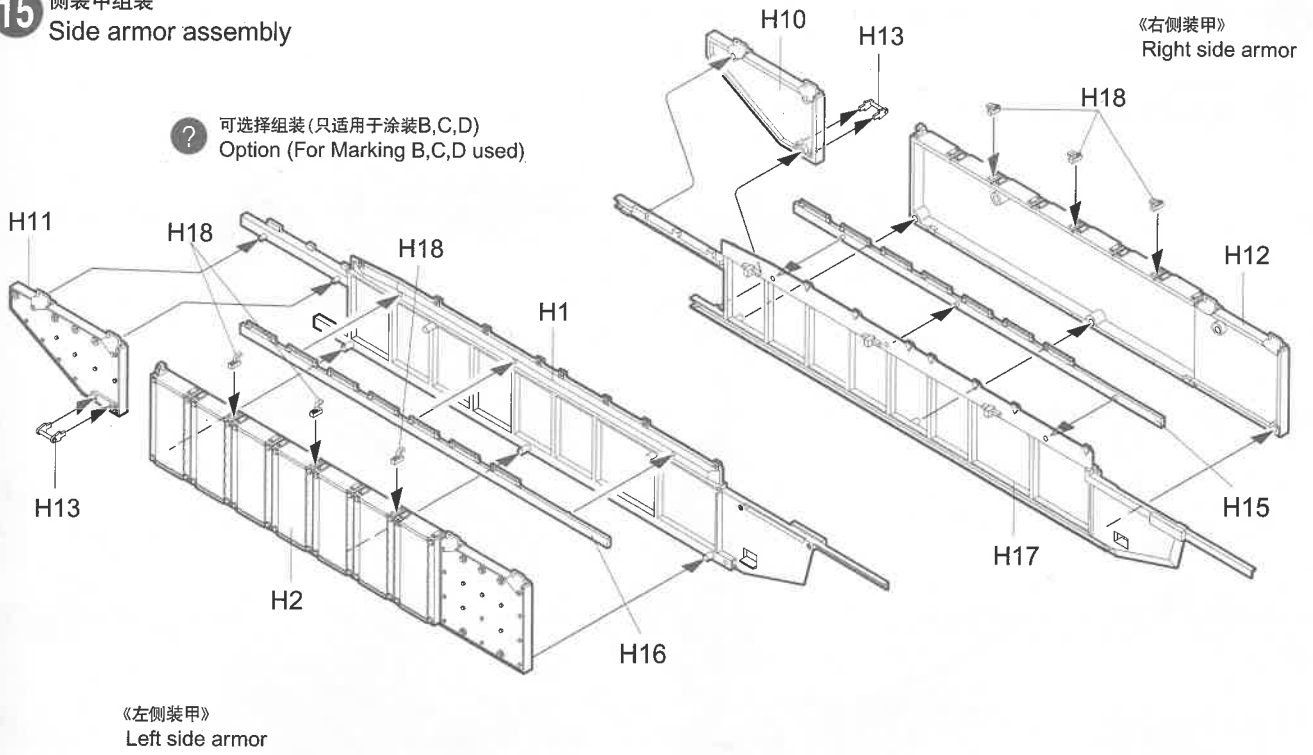

16 车体上部安装
Attaching upper hull

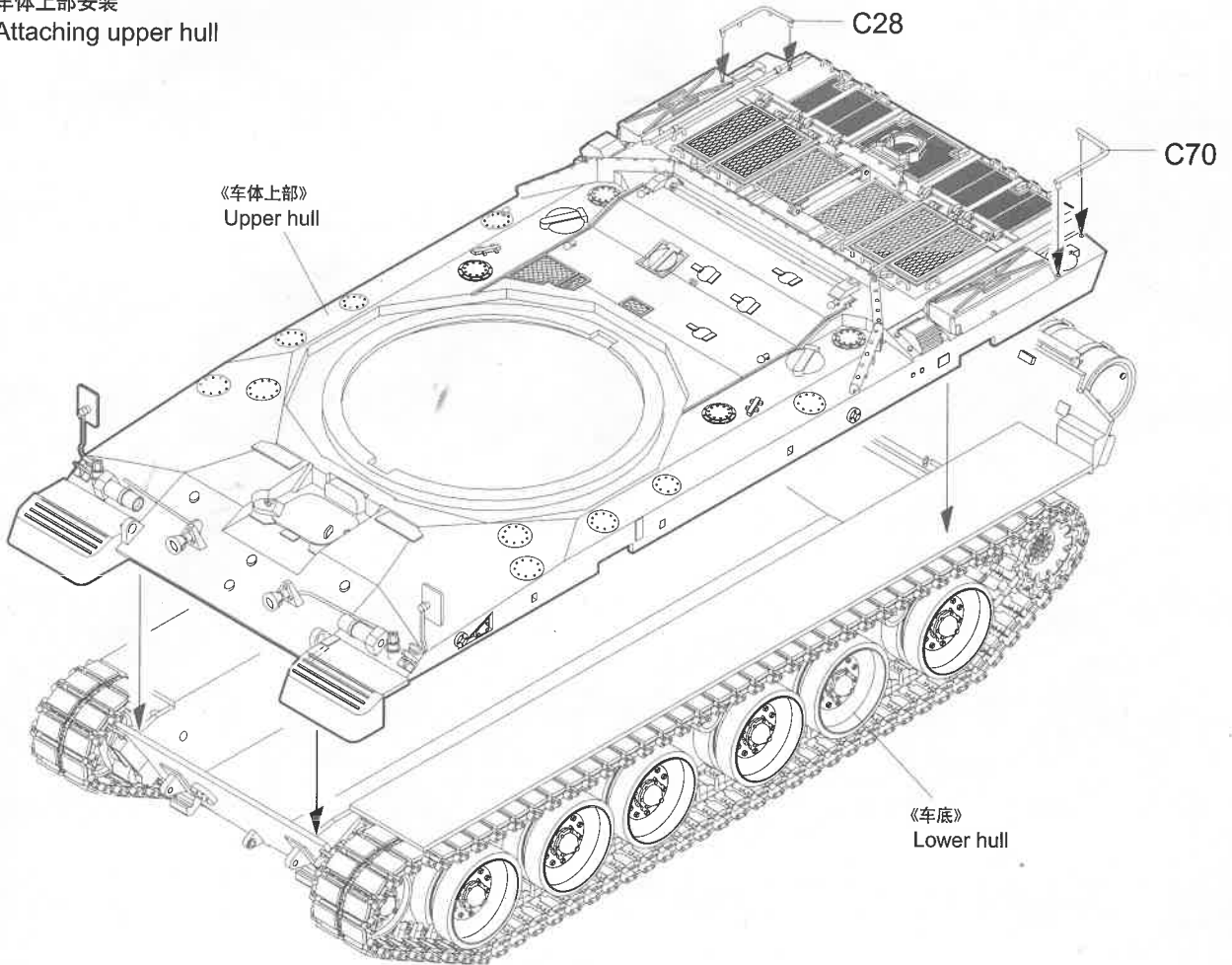

17 车体安装
Attaching upper hull

② 可选择组装 (只适用于涂装A)
Option (Only for Marking A used)

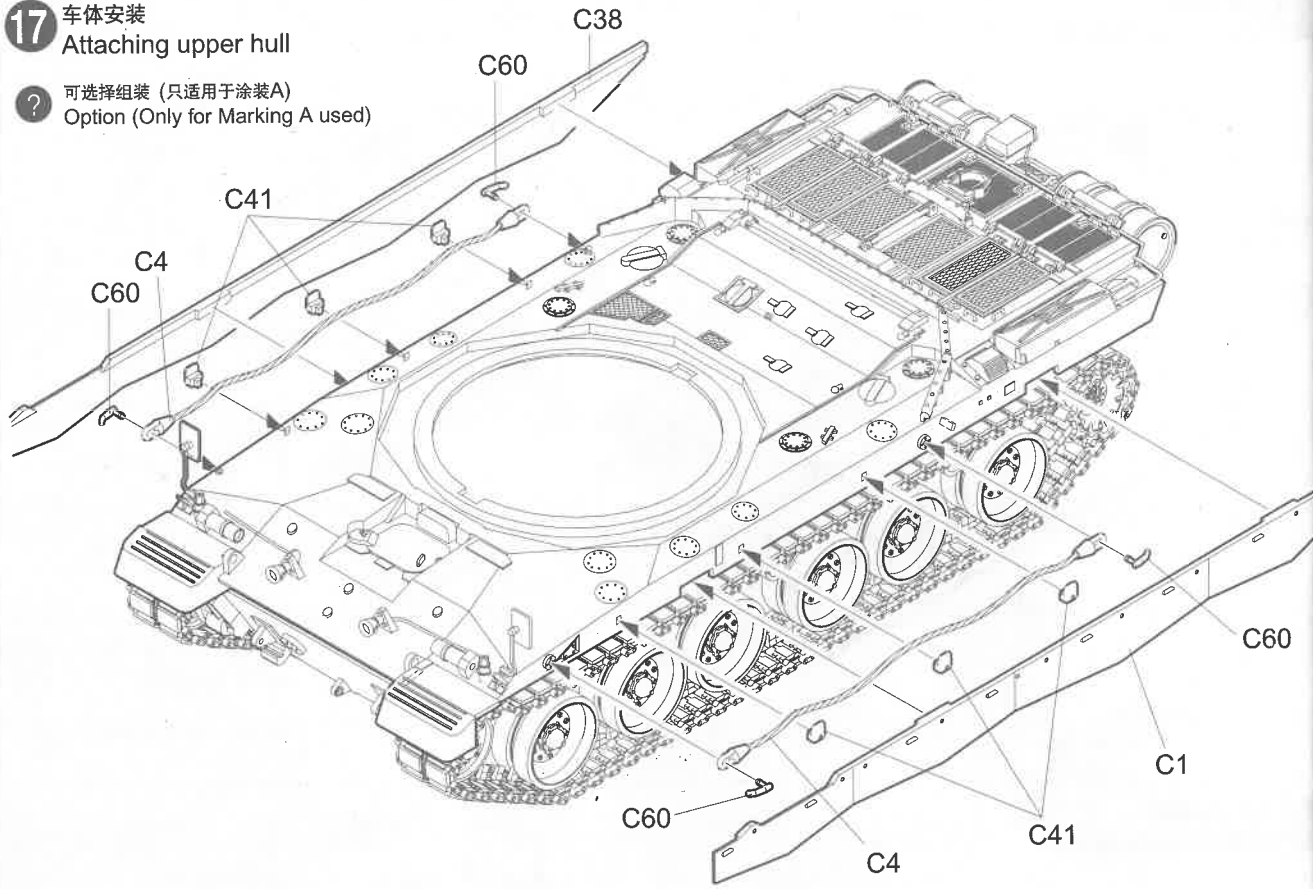

18 侧装甲安装
Side armor attaching

④ 不涂胶水
No cement

《推土铲》 可选择组装 (只适用于涂装A,D)
Bucket Option (For Marking A&D used)

④ 不涂胶水
No cement

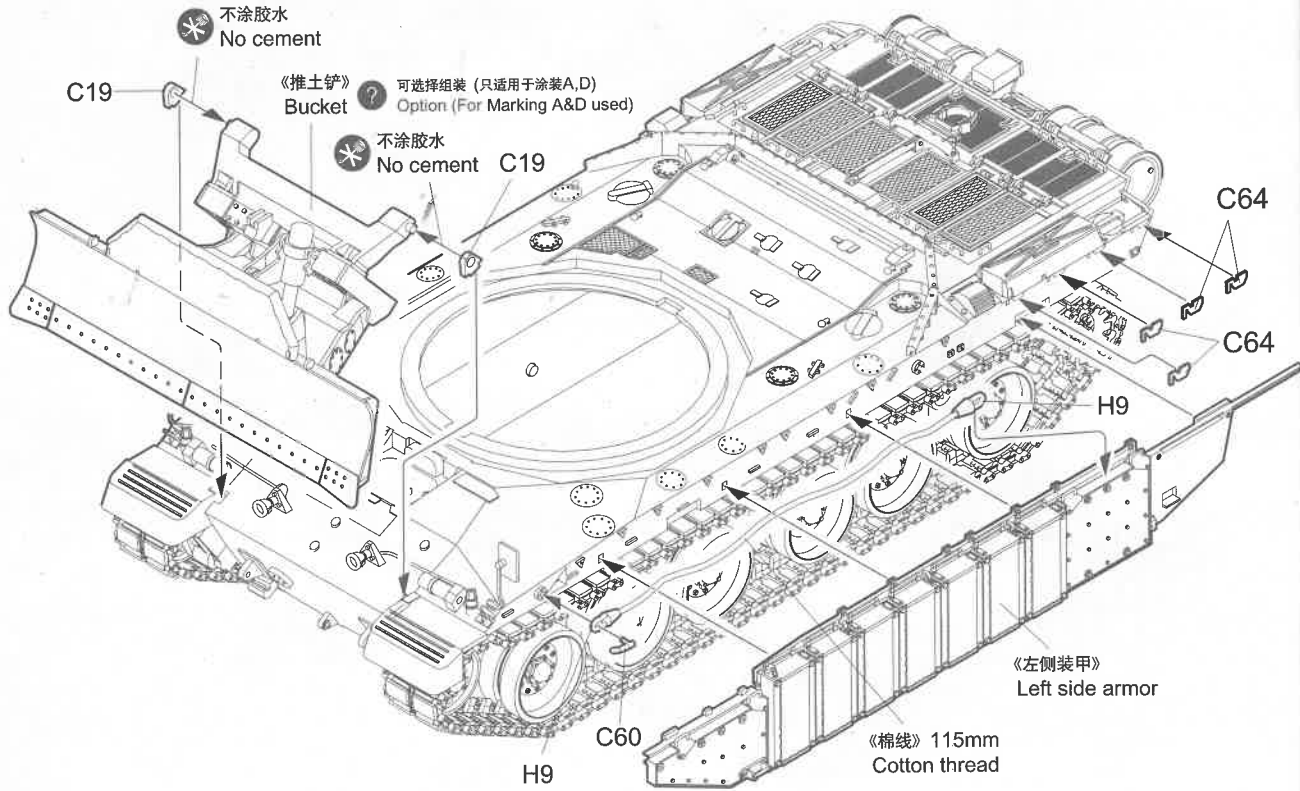

19 侧装甲安装
Side armor attaching

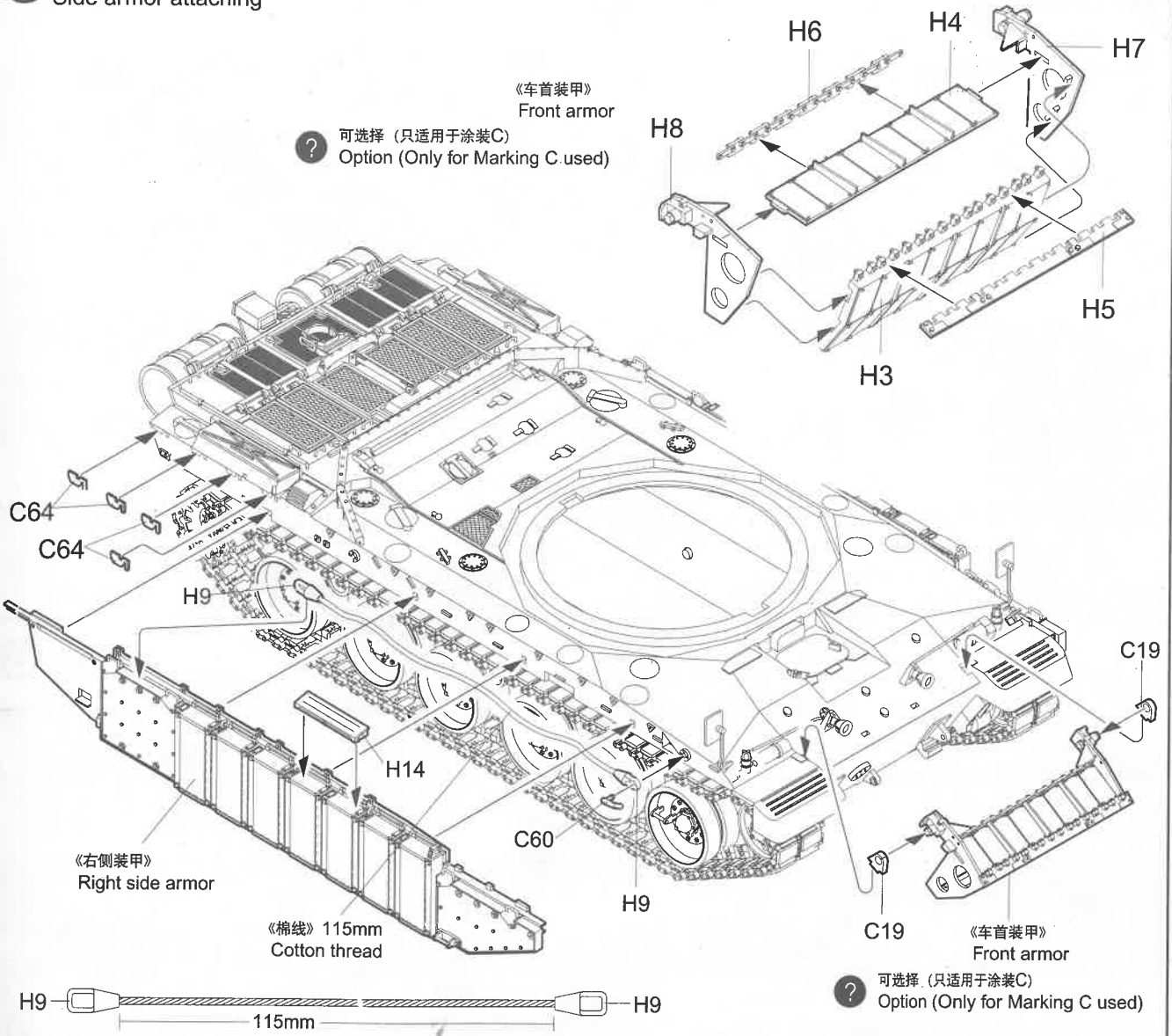

20 主炮组装
Main gun

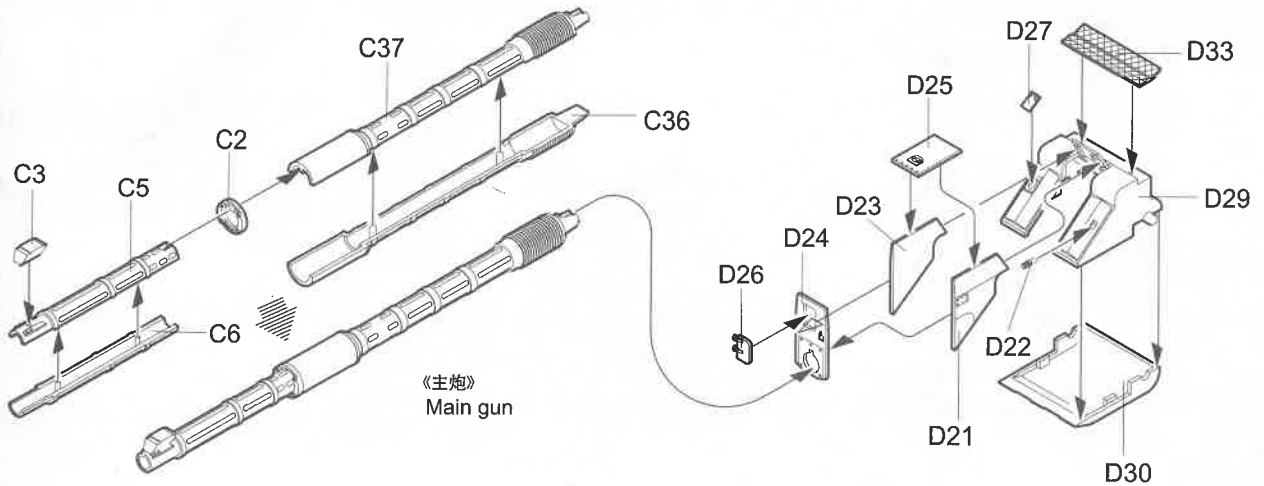

24 炮塔组装 II
Turret assembly II

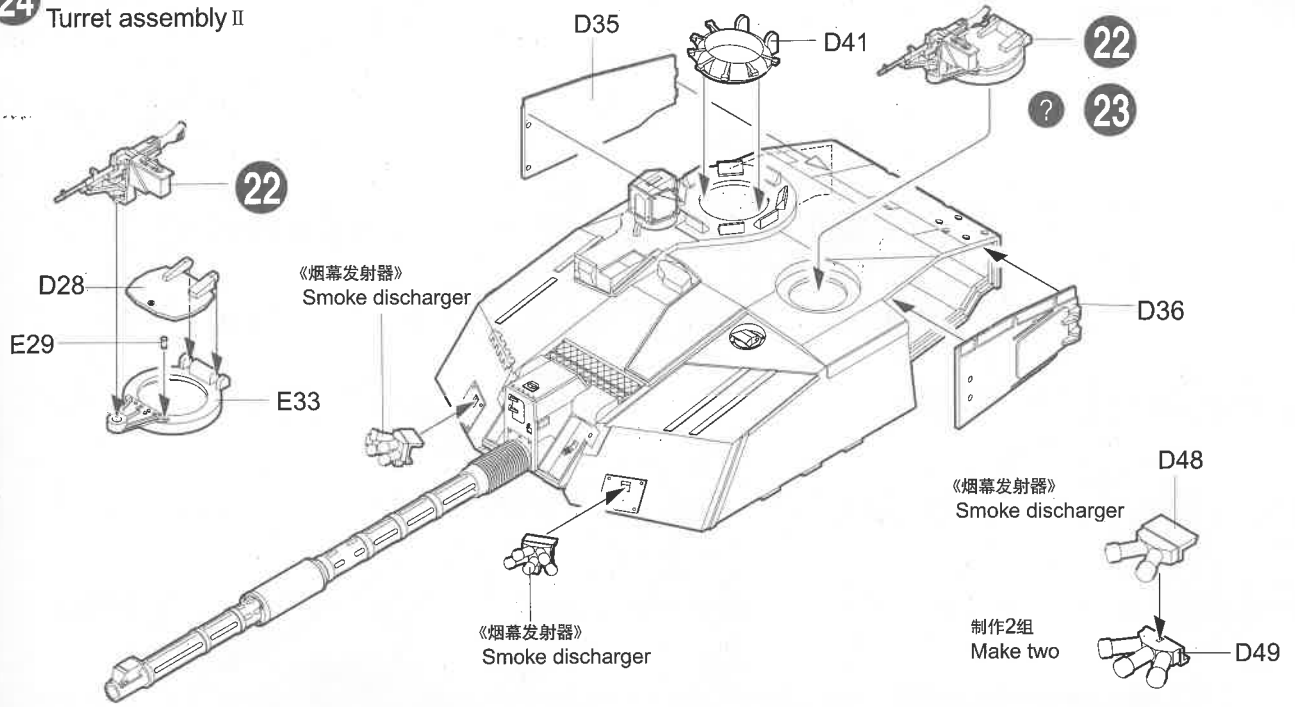

25 炮塔组装 III
Turret assembly III

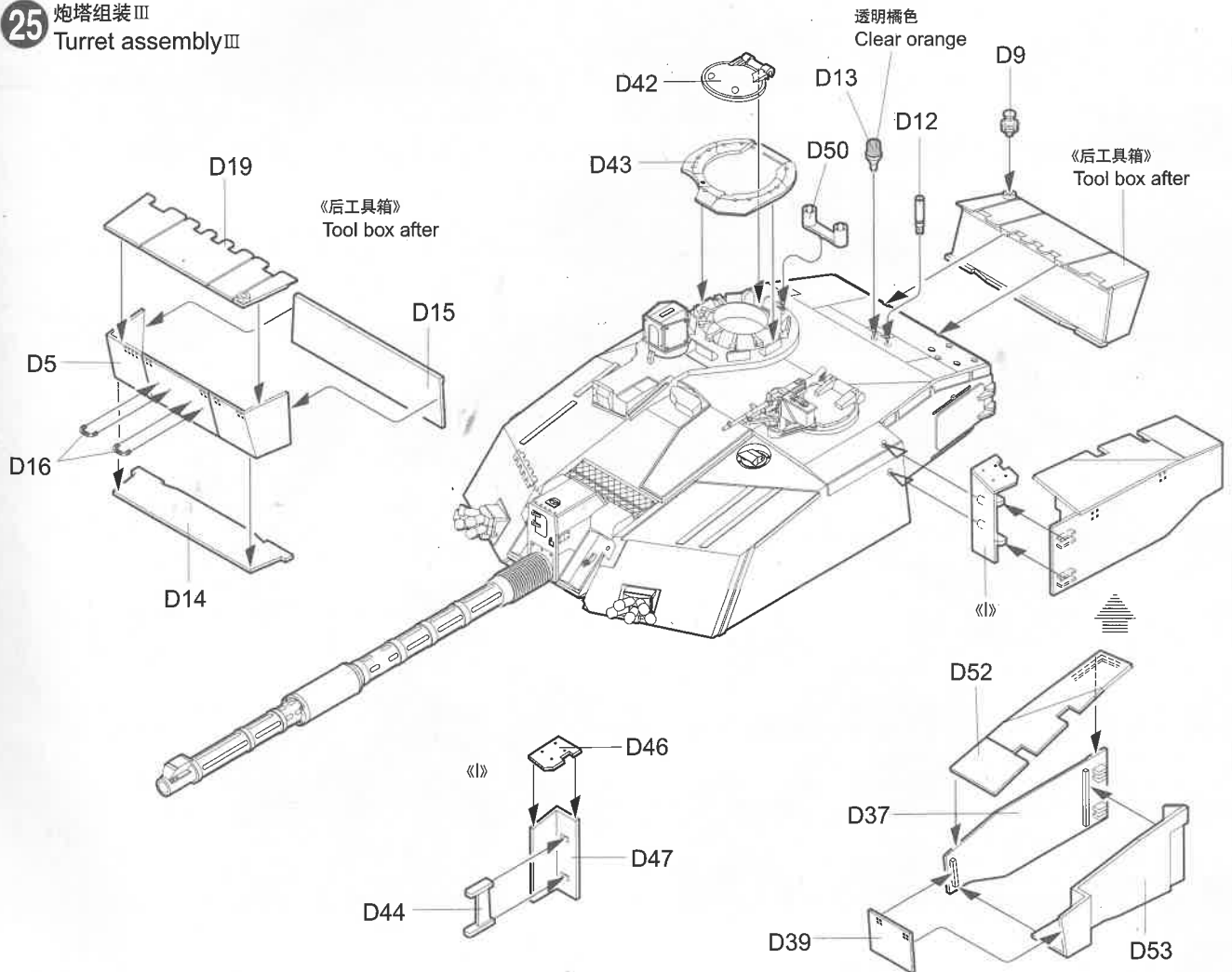

26 炮塔组装IV
Turret assembly IV.

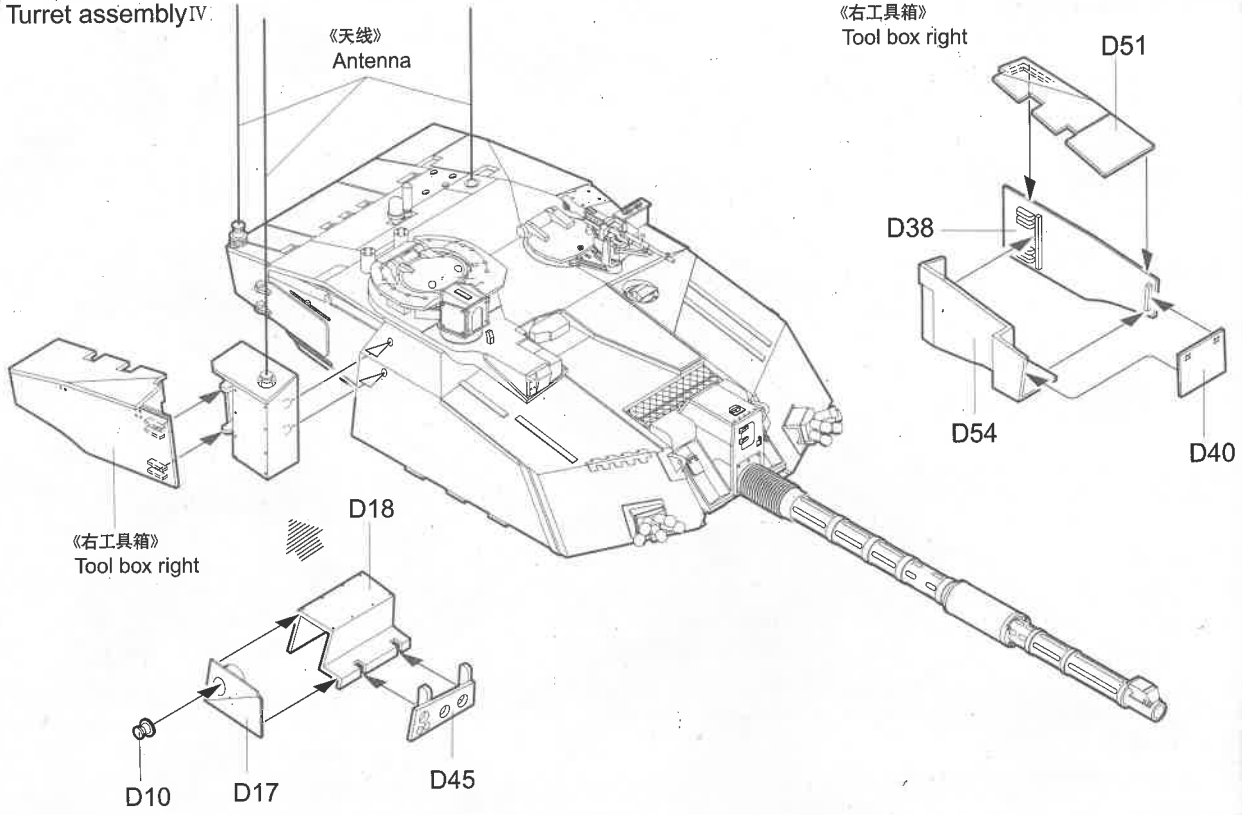

27 炮塔安装
Attaching turret

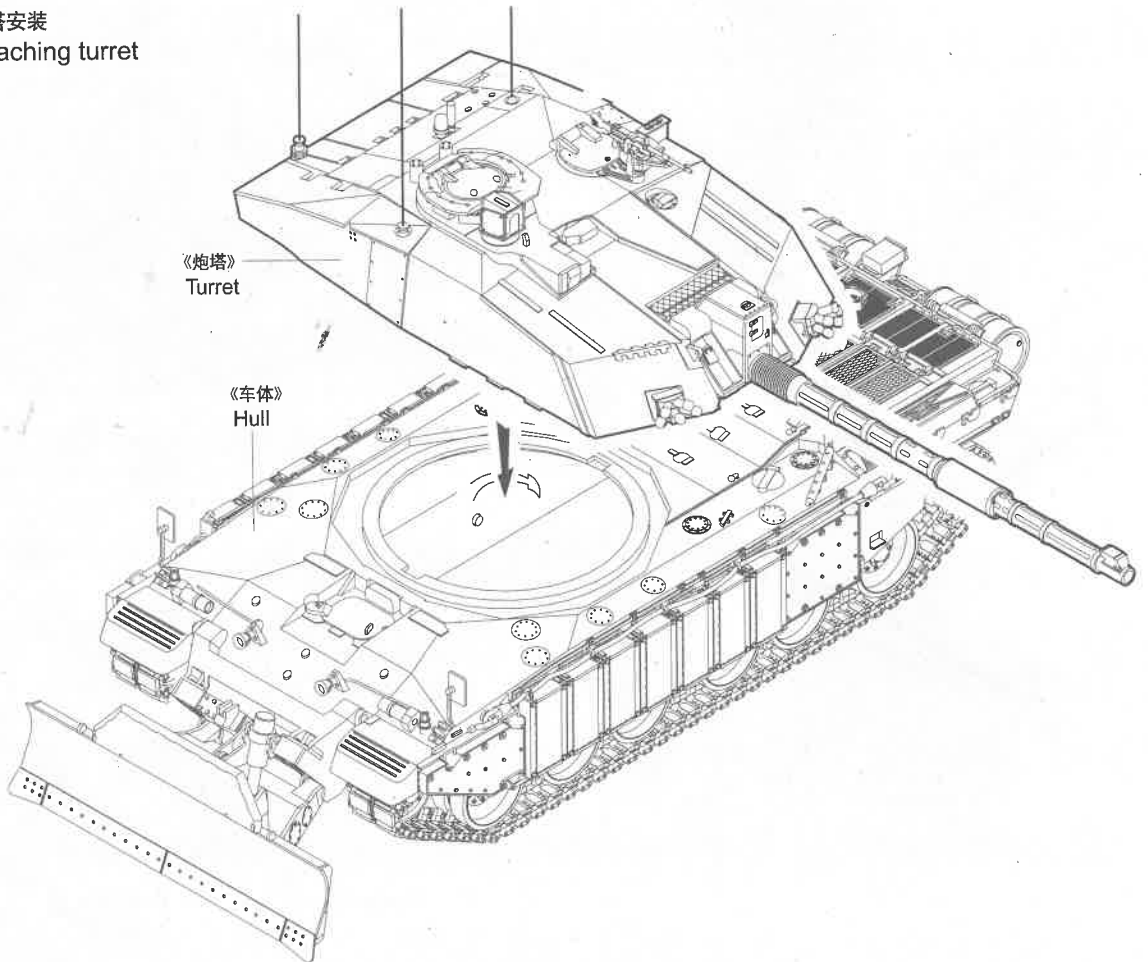

涂装同标贴指示
Painting & Marking guide

郡仕色使用

Gunze Mr. color used

A

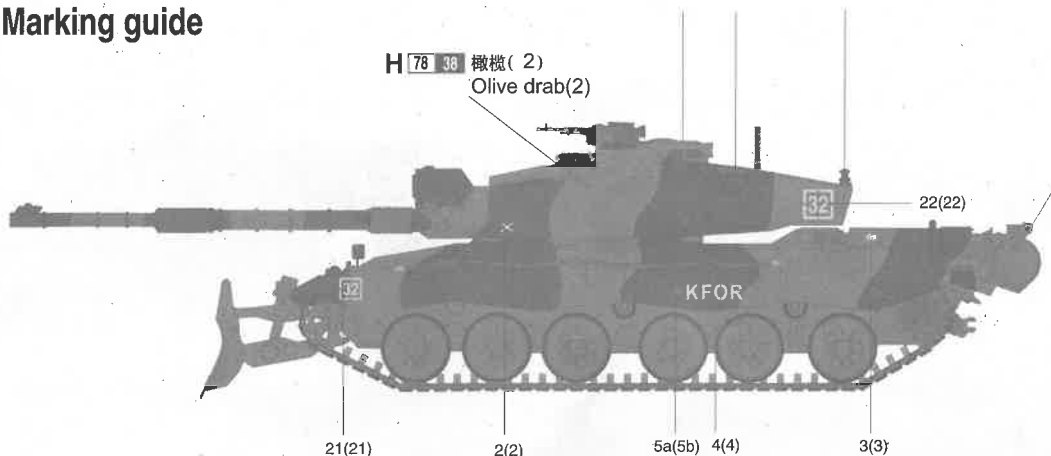

H 12 33 消光黑 80% + H 78 38 橄欖 (2) 20%
Flat black 80% Olive drab(2) 20%

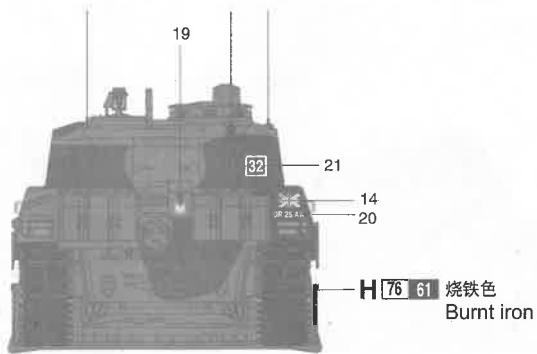
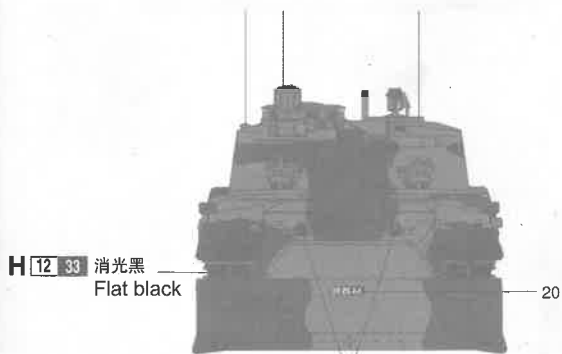
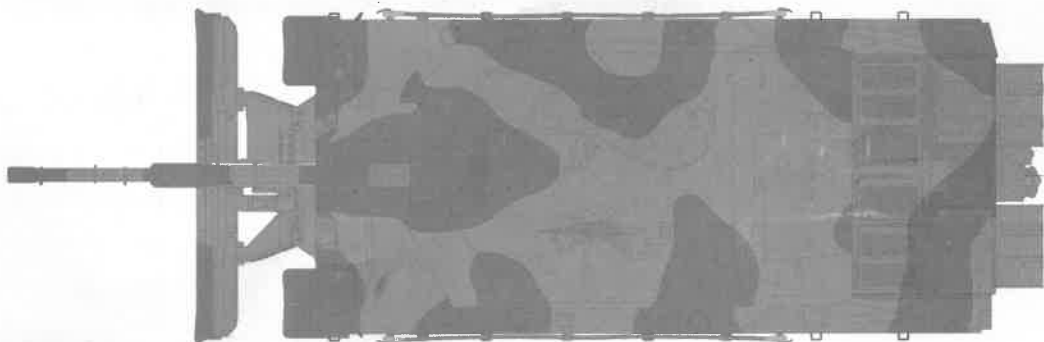

涂装同标贴指示
Painting & Marking guide

郡仕色使用

Gunze Mr. color used

B

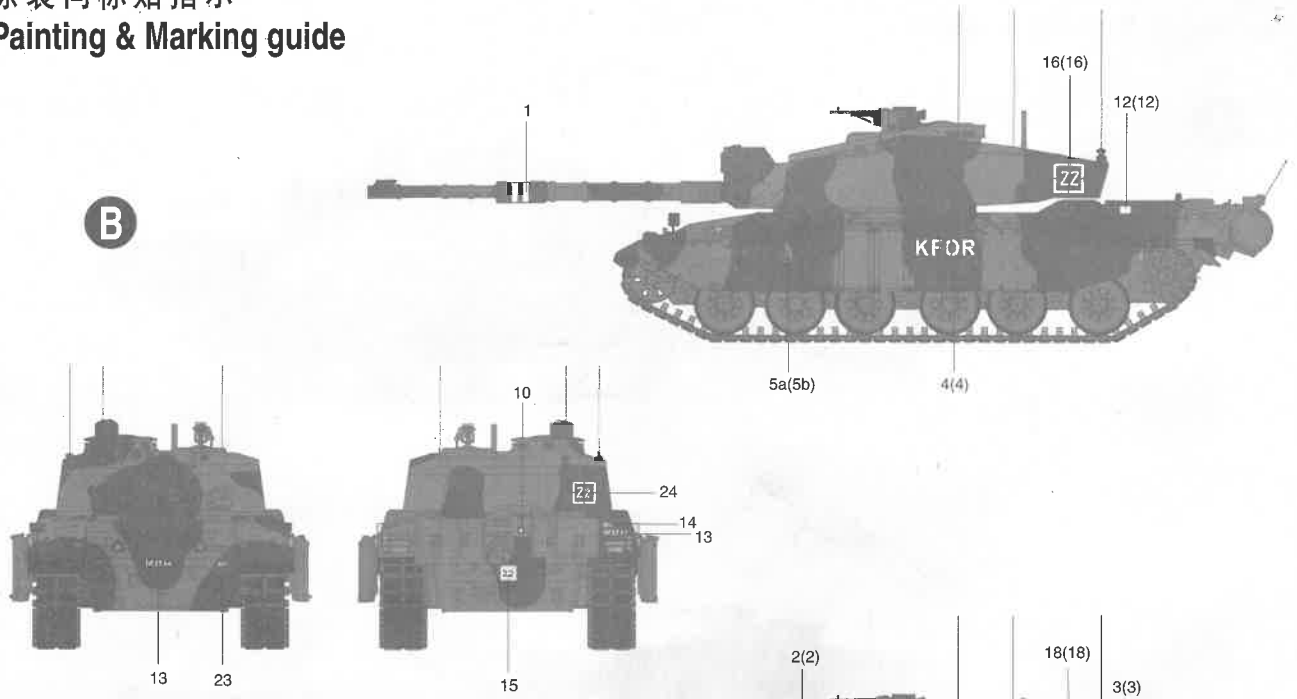

C

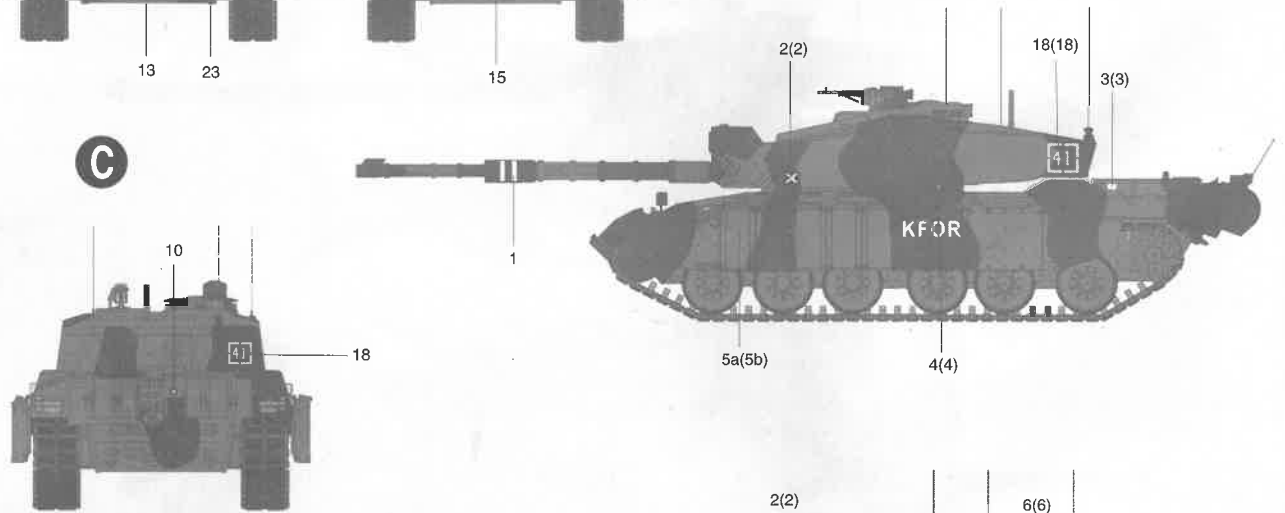

D

