

**1:32 SCALE**

**ITEM NO.: 03206**

# EA-18G GROWLER

EA-18G “咆哮者” 电子战机

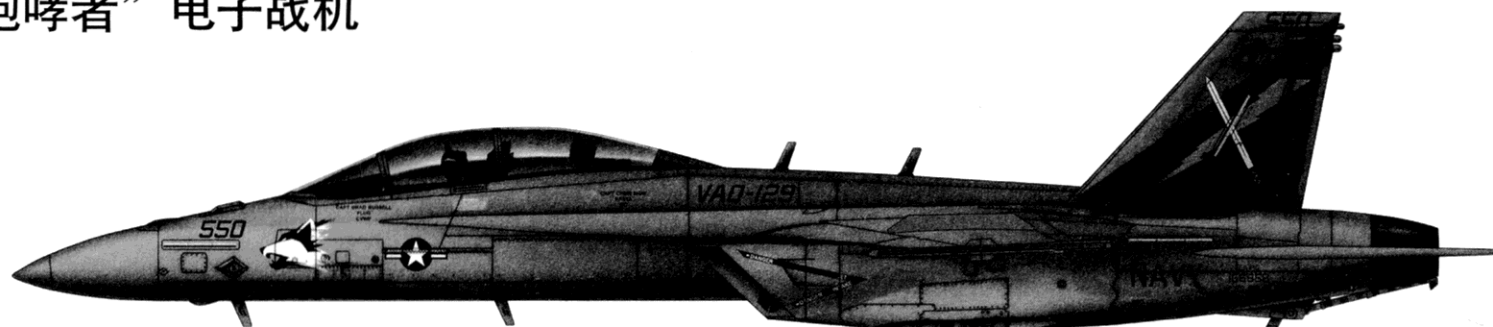

## READ BEFORE ASSEMBLY:

- Study and understand these instructions thoroughly before beginning assembly
- When needed, remove photo-etch parts carefully using a modeling knife or photo etch sprue cutter, being careful not to damage or lose small parts.
- Take extra care in handling photo etch parts in order to avoid injury
- Apply instant cement sparingly to photo etch parts where instructed

- Tools recommended(not included in kit):Plastic and instant cements,sprue cutters,long nose pliers,modeling knife, small files, tweezers, pin vise & scissors. Soft cloth and sandpaper will also assist in construction
- Glue and paint are not included in the kit. Use plastic cement and hobby paints only. Color guide for purchasing paint is included in the kit.

## 装配之前仔细阅读

- 小心用模型锉刀锉平所有零件表面的注射浇口。
- 小心用刀片切下蚀刻片零件，不要遗失小零件。
- 用强力快干胶水粘合蚀刻片零件和金属轴。过量快干胶水使用可能导致可动零件会粘住，小心涂胶。
- 取蚀刻片时应特别注意安全，防止利边划伤手指。
- 某些零件表面需贴水上贴纸，请选择在装配的同时进行。
- 推荐模型工具(自备)：胶水，水口剪刀，长咀钳，刀片，锉刀，镊子，钳，钻，剪刀，瞬间快干胶。
- 软布同砂纸同时也应该是必备工具。
- 请使用塑料胶水和油漆，模型内不含。

## 水贴纸的使用:

1. 从水贴上剪下印花;
2. 将印花放入温水中浸10秒，然后放在干净布上。
3. 拿着印花纸板将印花移到模型上;
4. 手指蘸水将印花移到适当的位置;
5. 用软布轻压印花直至水干，气泡消失。

## DECAL APPLICATION:

1. Cut decals from sheet as needed
2. Dip the decal in warm water for about 10 seconds and then place on soft clean cloth.
3. Hold the decal backing sheet edge and gently slide the decal onto the model in its proper position.

4. While still wet, decal can be adjusted for better fit on model by dampening it gently with your finger.
5. When placed in the proper position, gently press decal down with a soft cloth until excess water and air bubbles are gone.
6. Allow decal to dry completely before handling model



cyanoacrylate glue  
使用强力胶



weight  
配重



make hole  
钻孔



cut / remove  
切除



option  
选择



no cement  
不涂胶水



decal  
贴纸



bend  
弯曲



file / sand  
锉平

部品图  
Parts

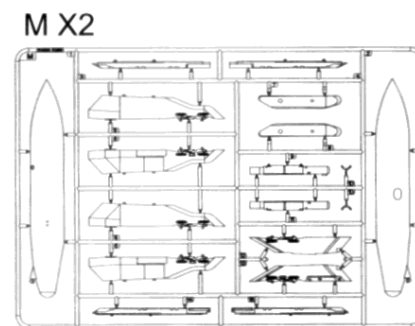
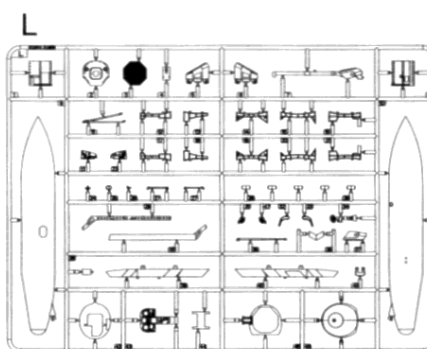
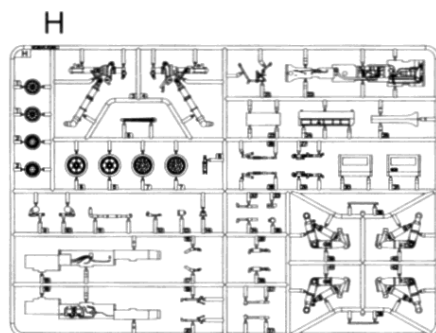
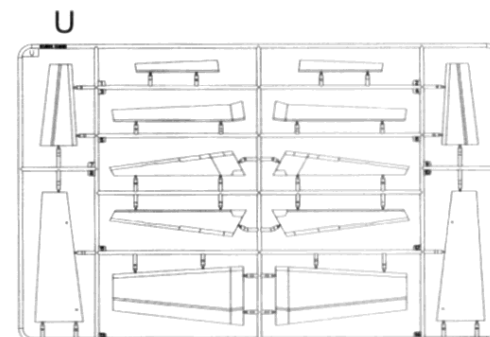
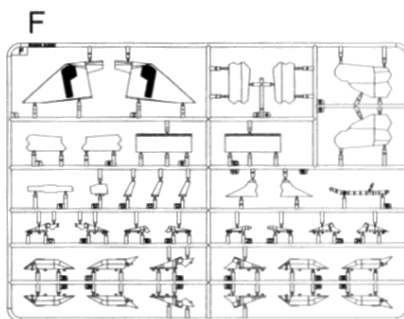
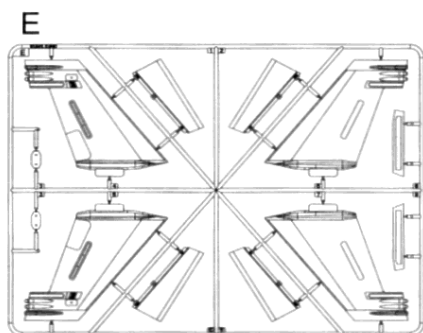
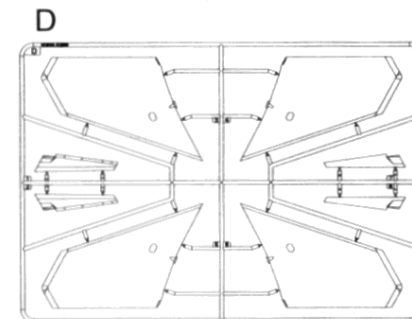
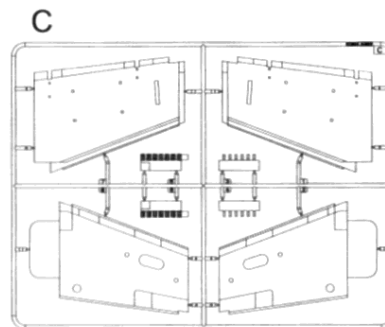
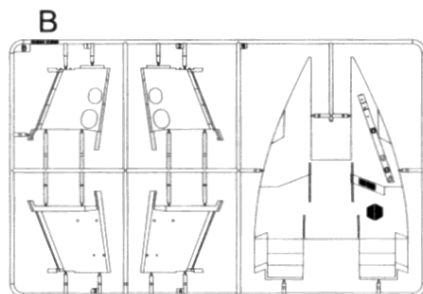
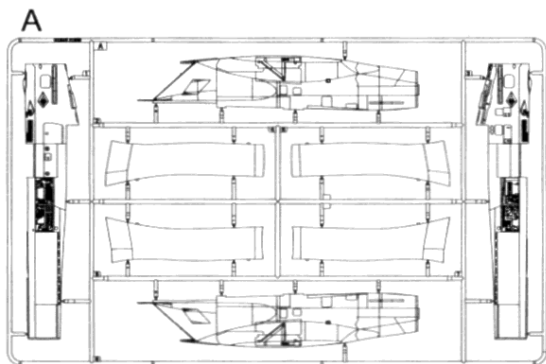

# 部品图 Parts

《上部机身》  
Top Fuselage

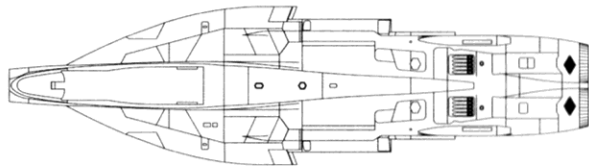

《下部机身》  
Lower Fuselage

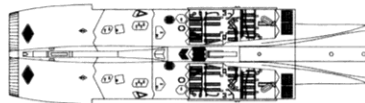

N X2

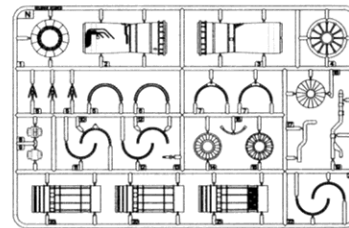

K

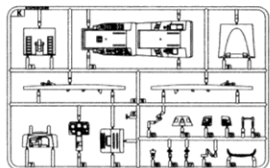

WD X2

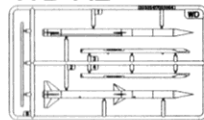

P X2

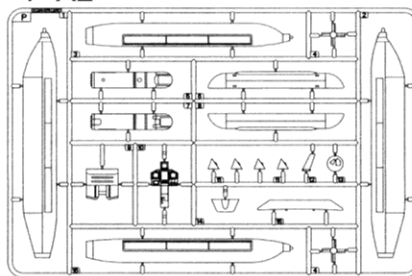

G X2

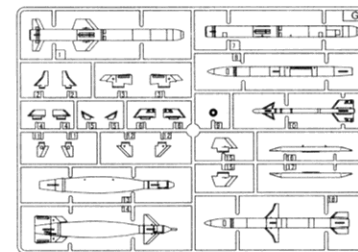

WE X2

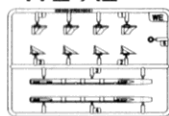

《水贴》  
Decal A



《水贴》  
Decal B



Q X2

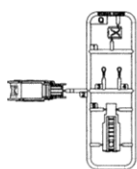

R

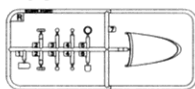

《蚀刻片》X2  
Photo etched part (PE)



《前轮胎》X2  
Nose tyre



《主轮胎》X2  
Main tyre



《金属部件》  
Metal parts



T

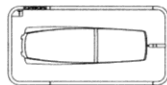

《水贴》  
Decal C



不用的部件: M7 M8 M14 M15 K8 K9 K11 K14  
Unused parts WD3 WD4 P5 P7 P13 G1 G3 G5  
G6 G7 G9 G10 G11 G12 G13 G14  
G15 G16 G17



3

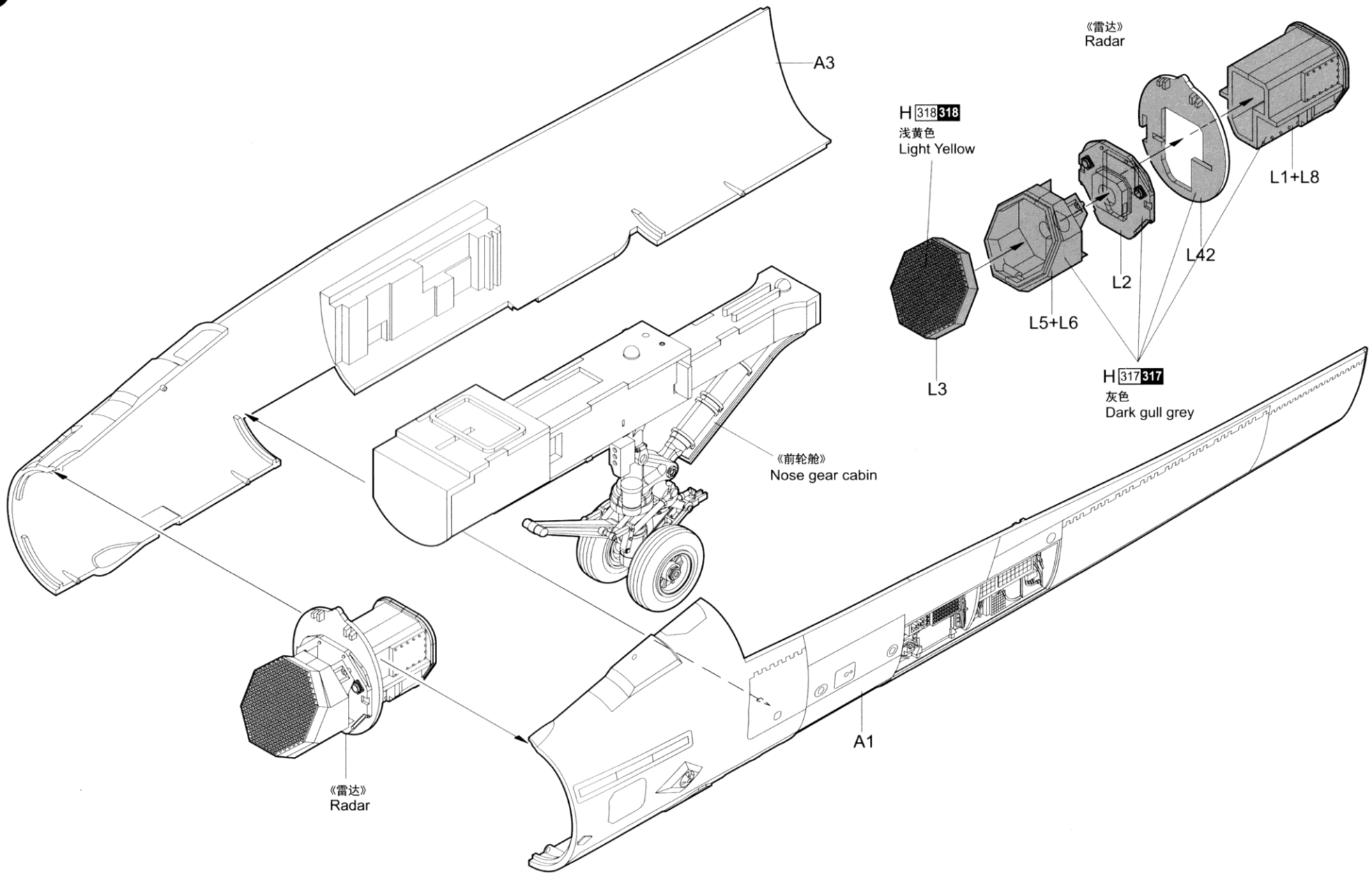

4

《发动机》  
Engine

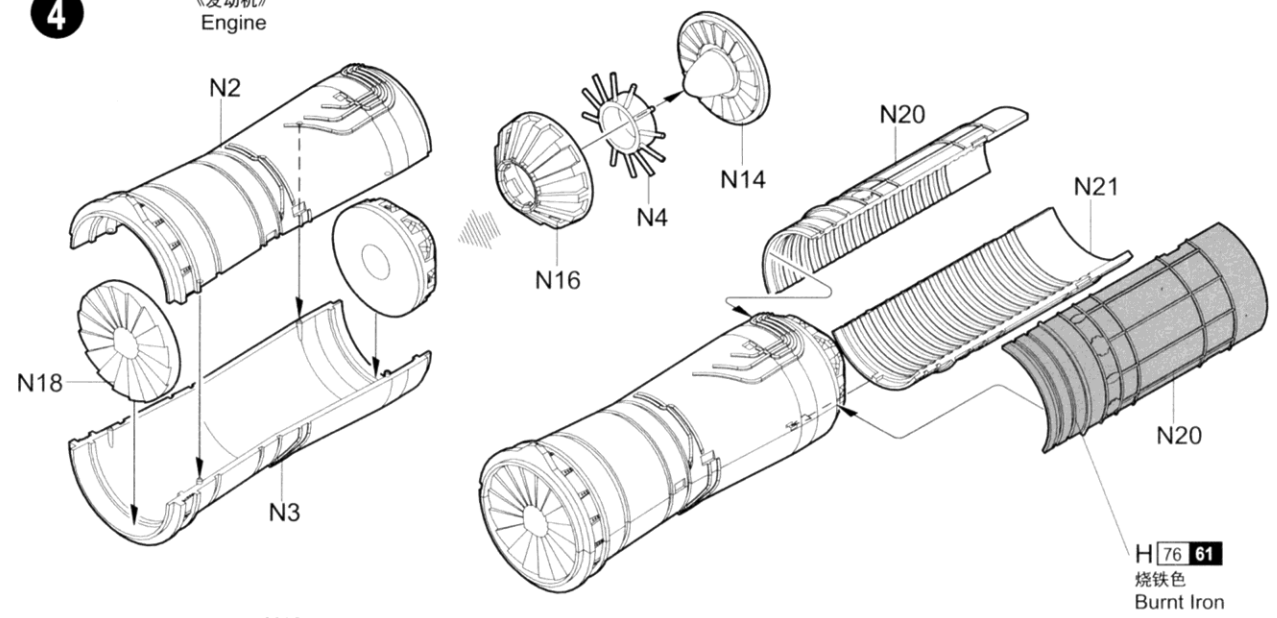

制作两组  
Make two

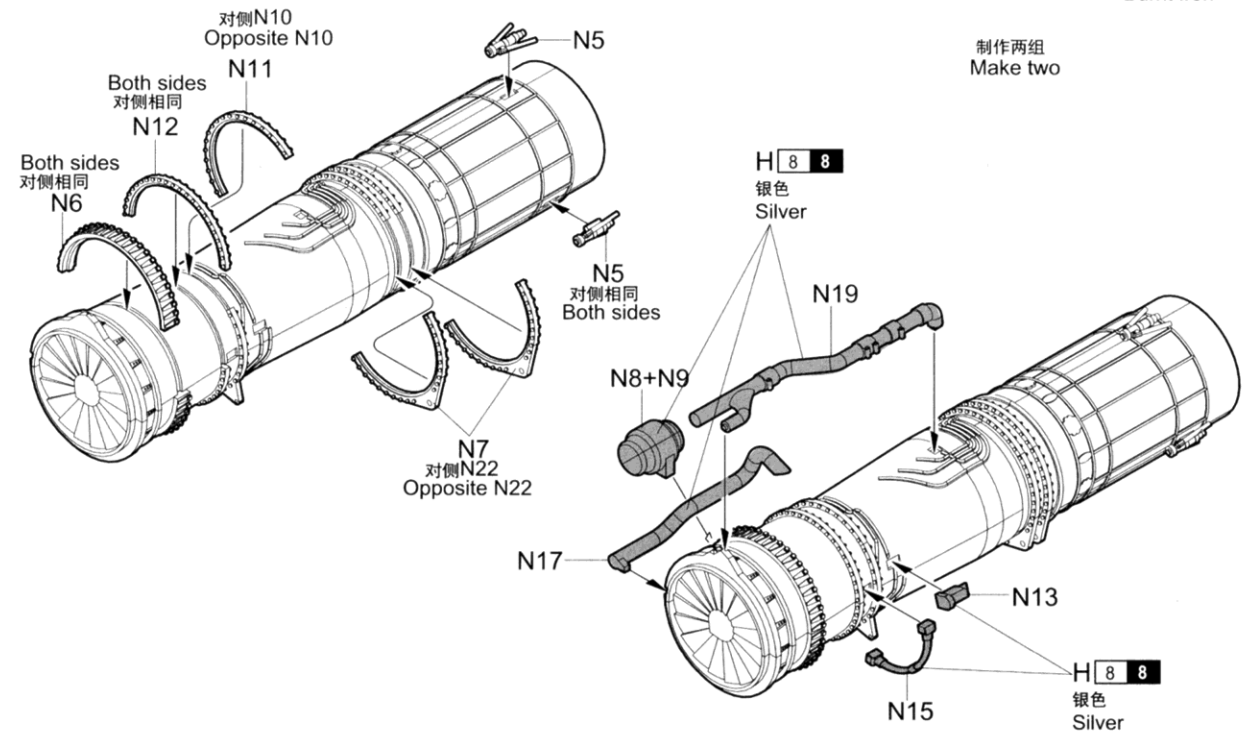

5

《左侧起落架》  
Left undercarriage

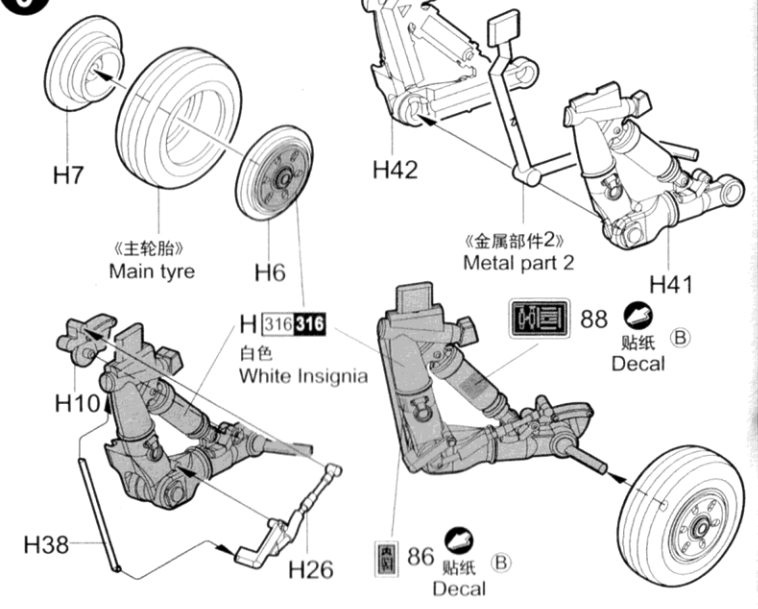

6

《右侧起落架》  
Right undercarriage



7

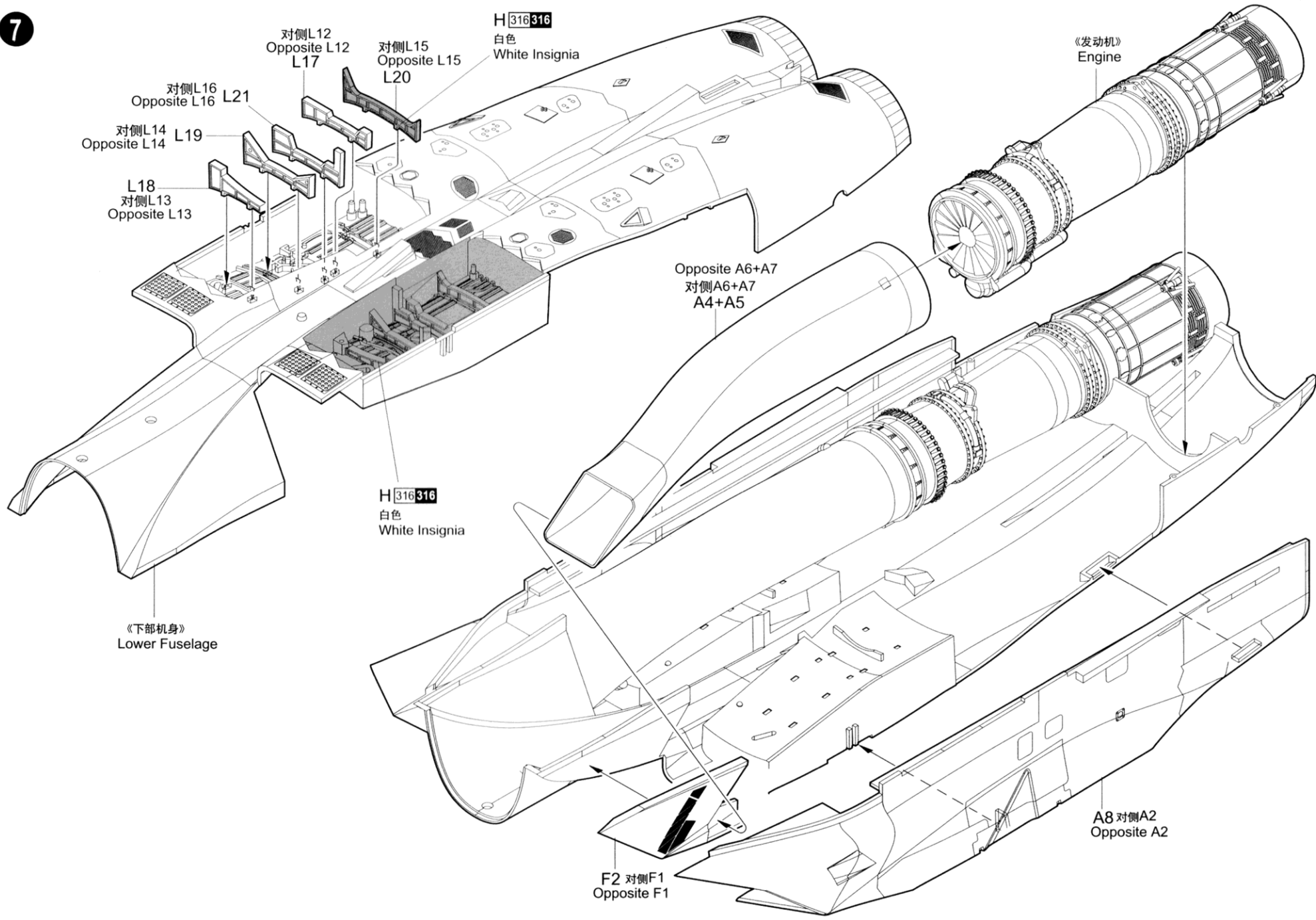

8

《左侧机翼》  
Left wing

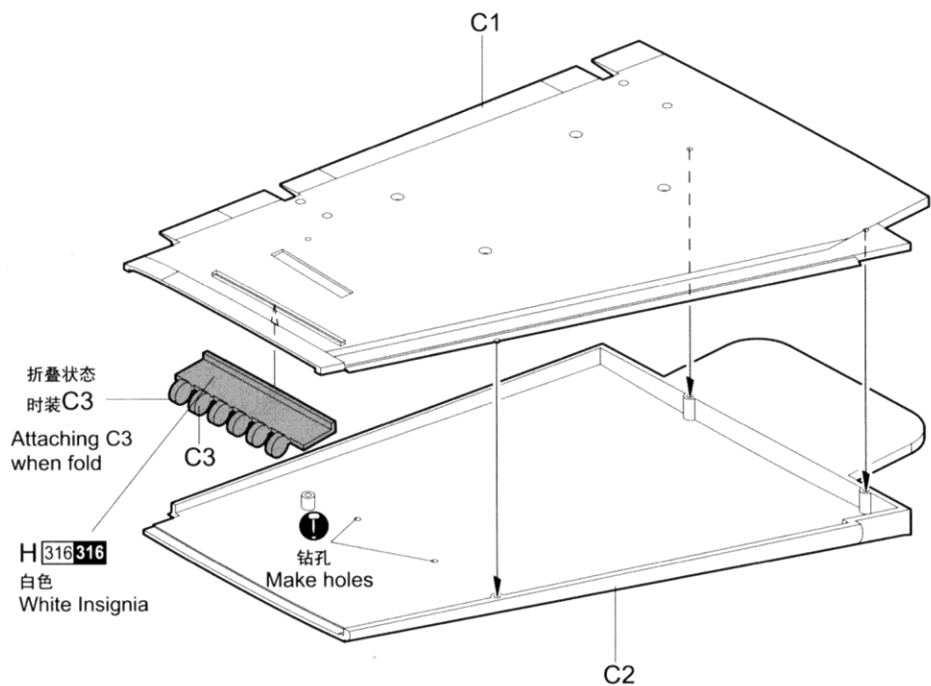
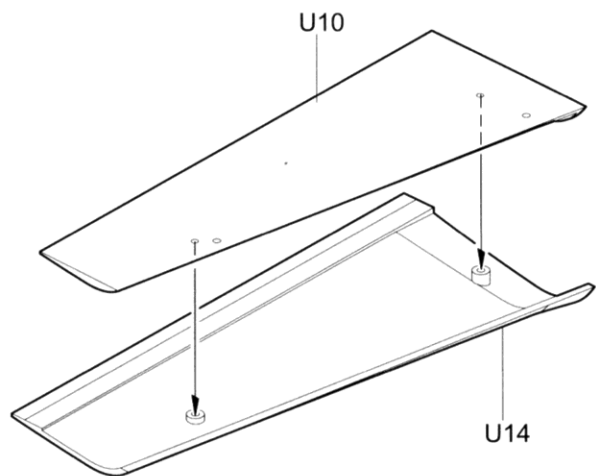

9

《展开状态》  
Expanding

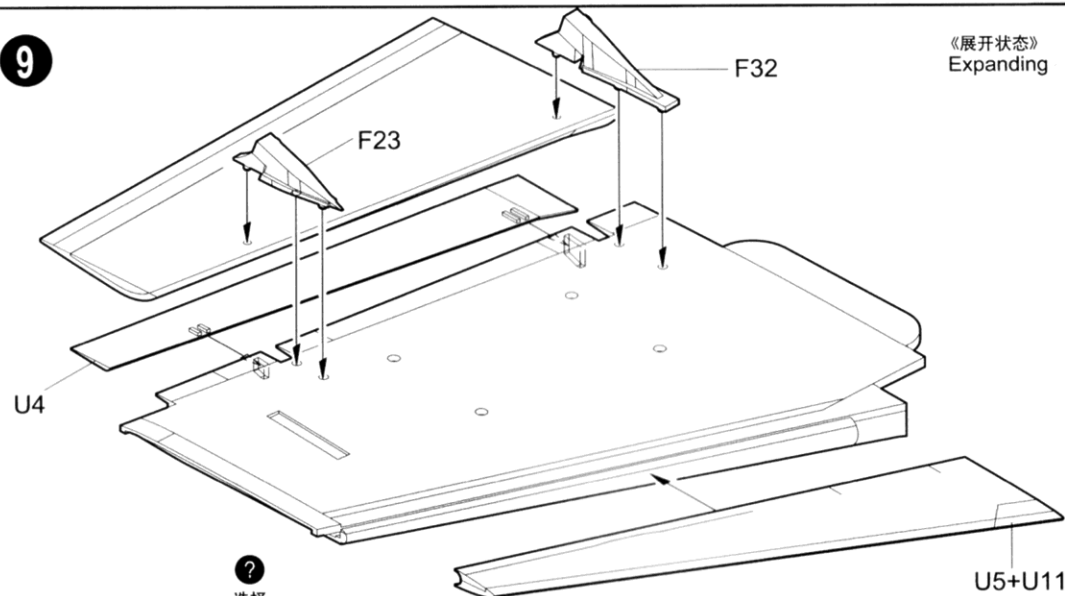

选择  
Option

《折叠状态》  
Folding

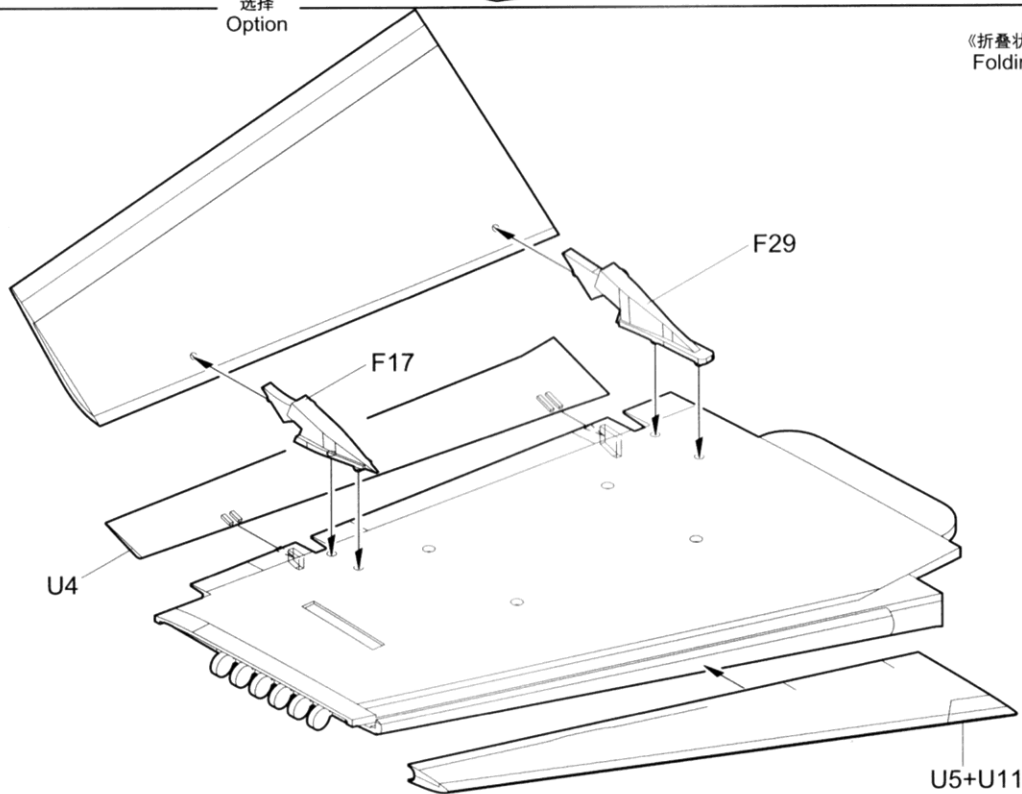

10

《左侧机翼》  
Left wing

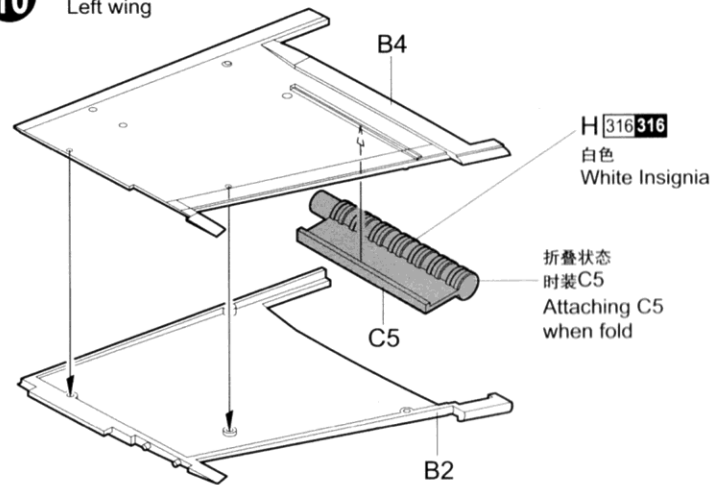

《AN/ALQ-218(2)V》

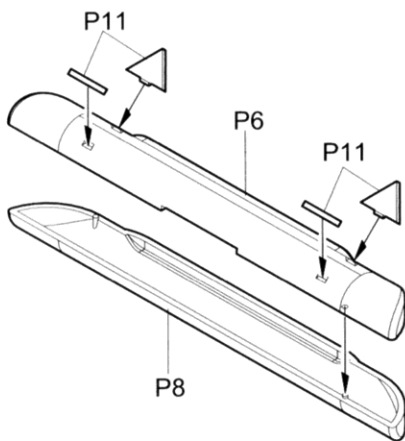

《AIM-9X》

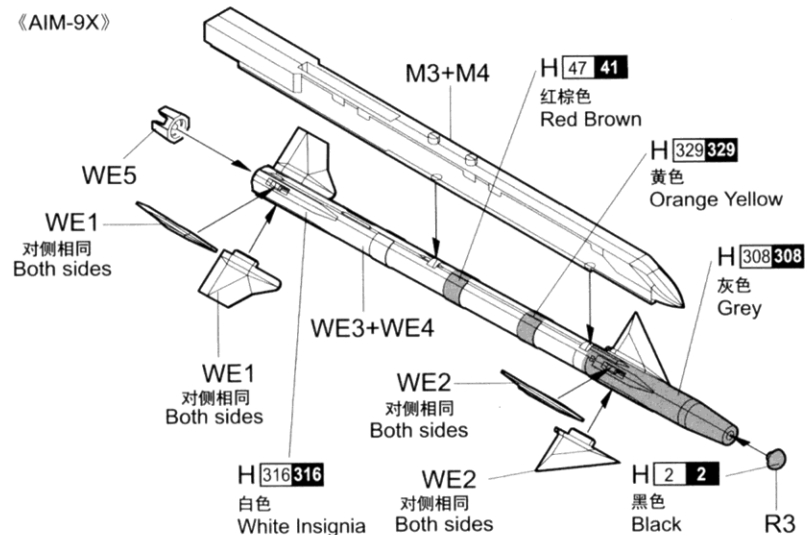

11

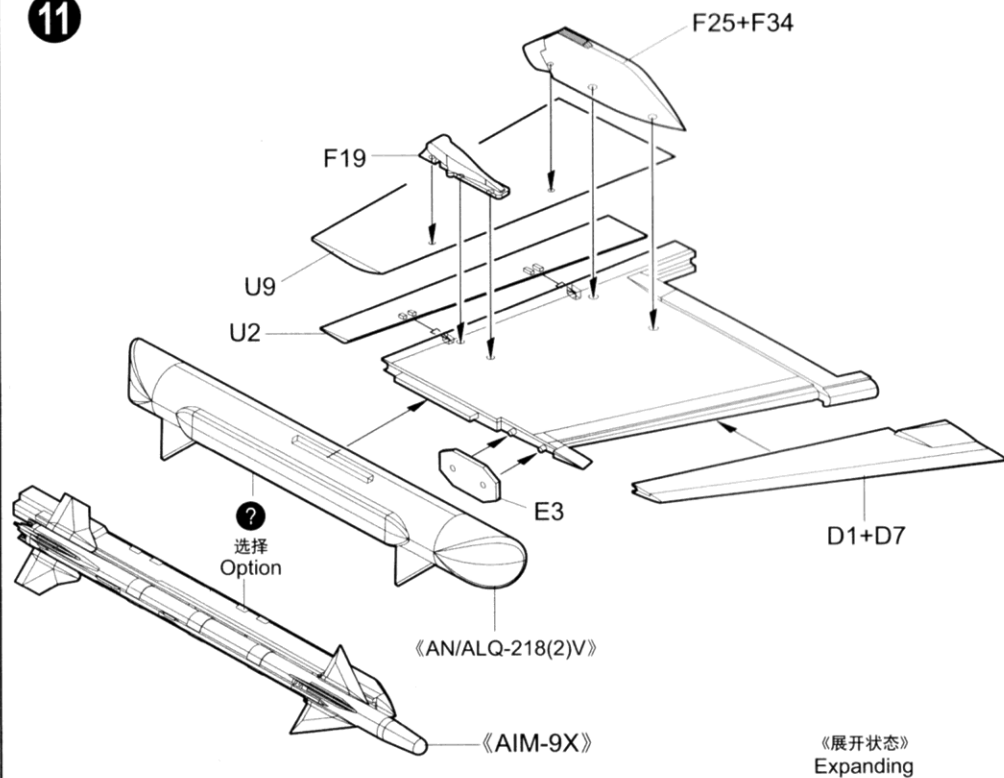

选择  
Option

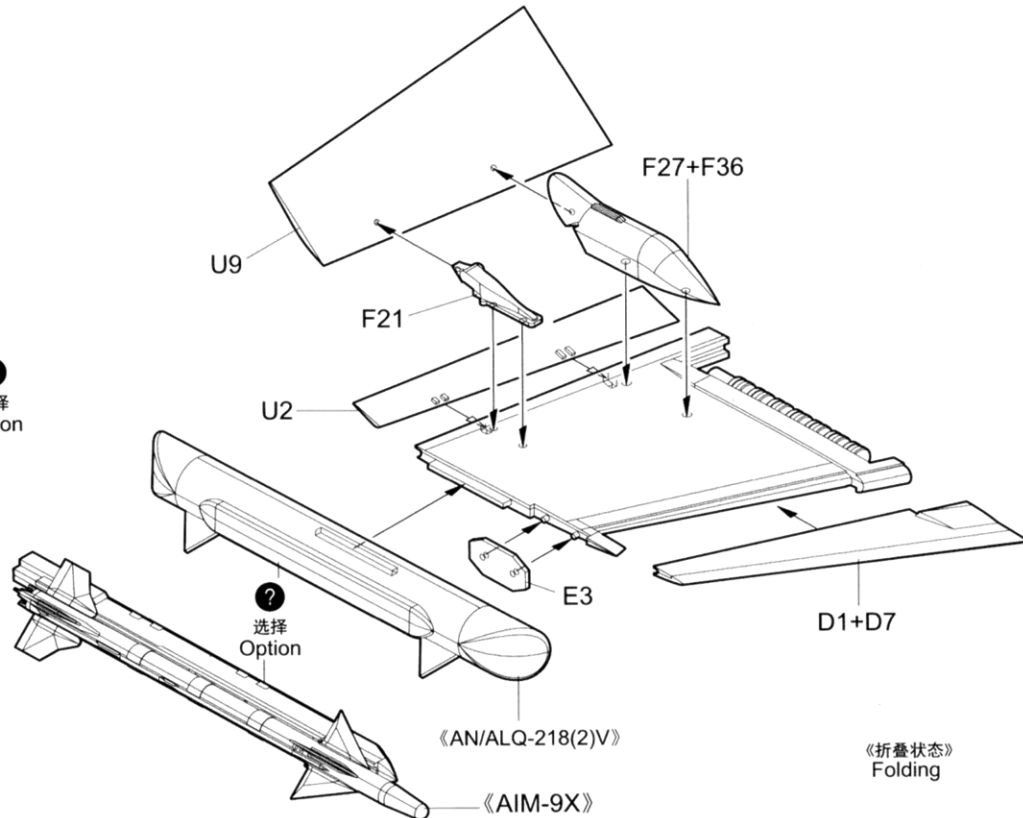

12

《左侧机翼》  
Left wing

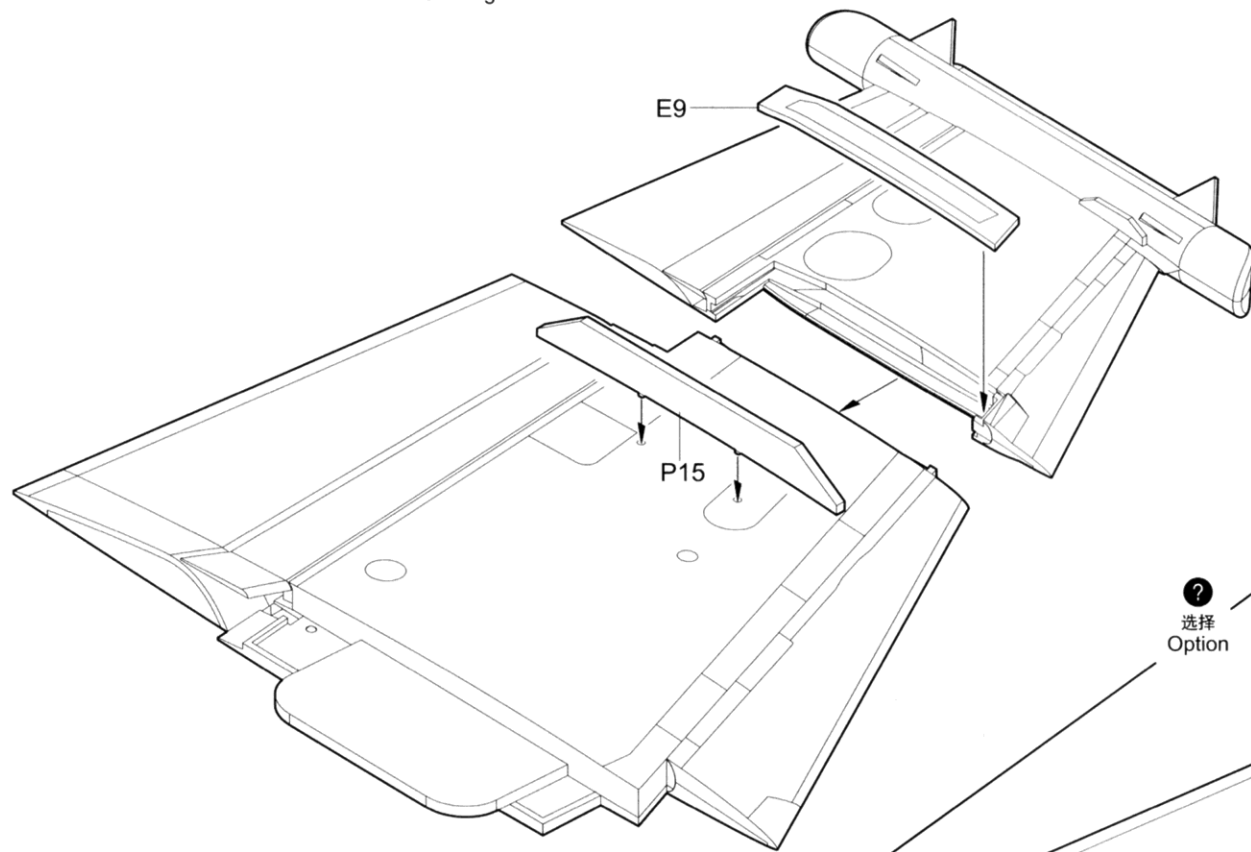

《展开状态》  
Expanding

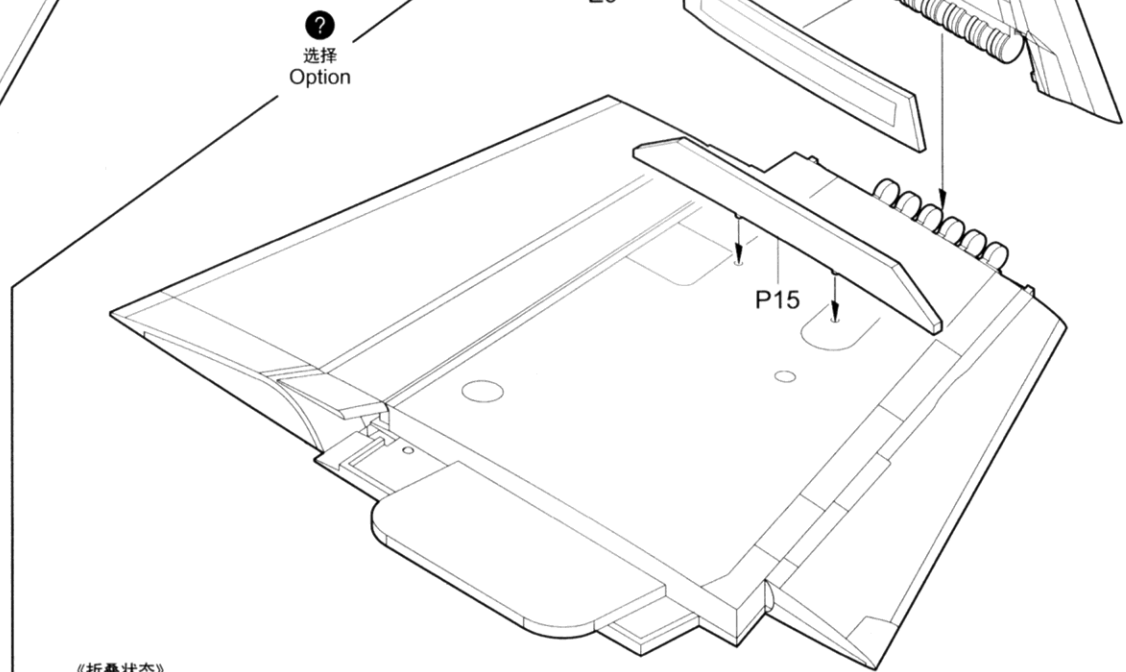

《折叠状态》  
Folding

**13** 《右侧机翼》  
Right wing

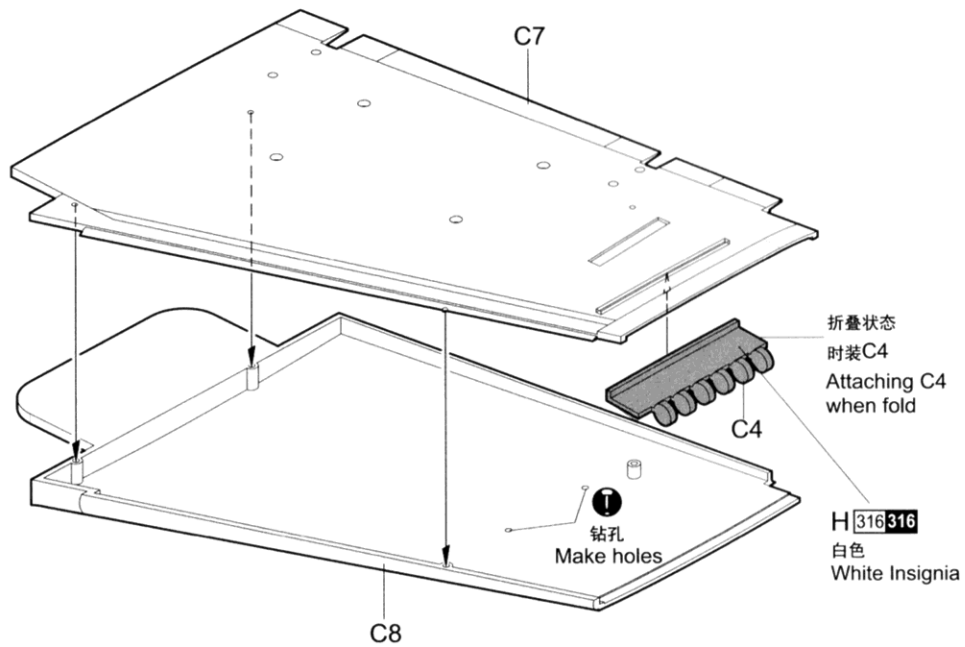
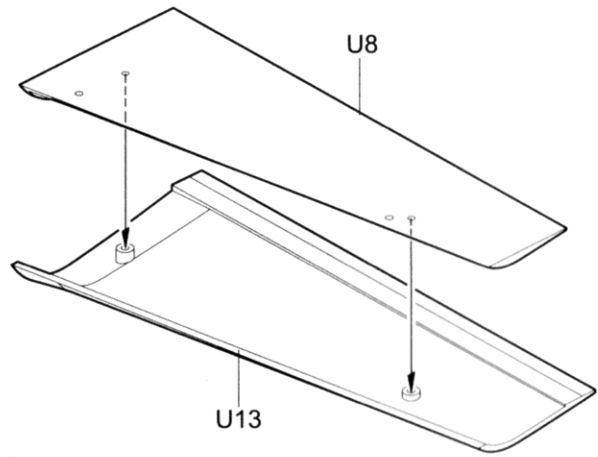

**14** 《展开状态》  
Expanding

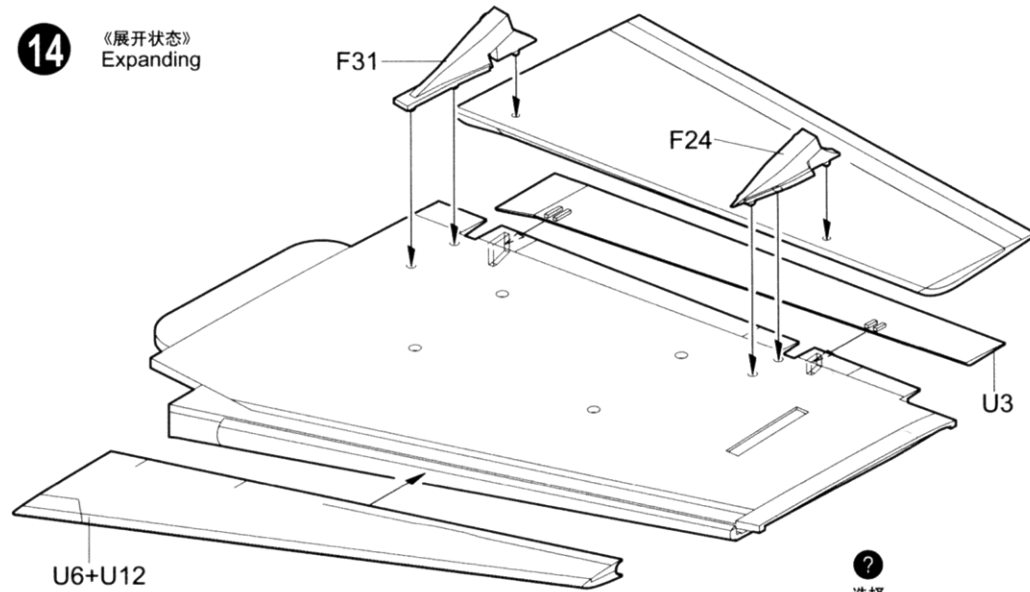

选择  
Option

《折叠状态》  
Folding

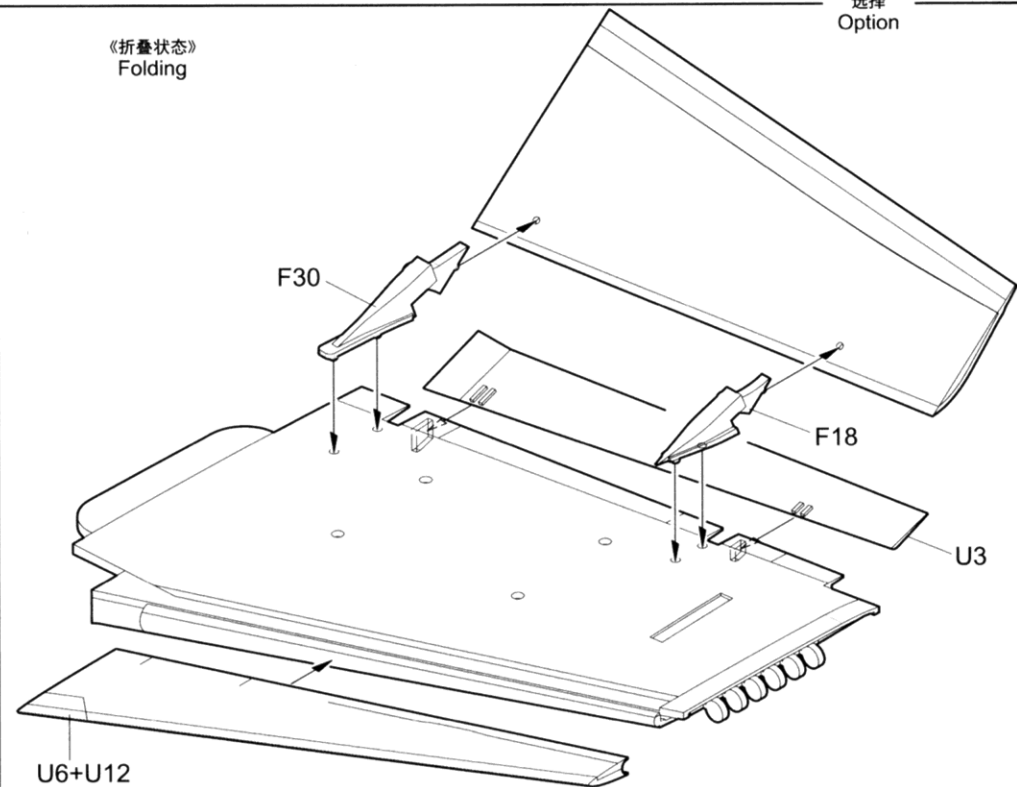

15

《右侧机翼》  
Right wing

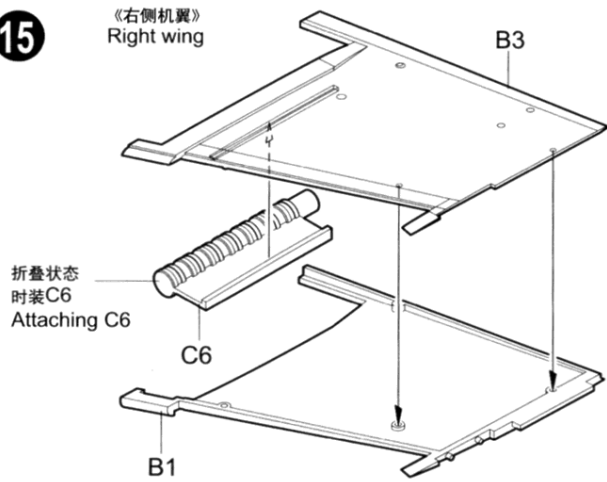

《AN/ALQ-218(2)V》

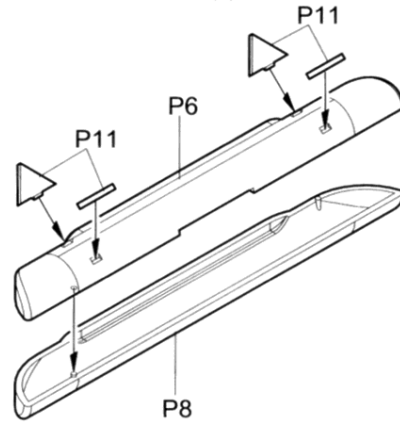

《AIM-9X》

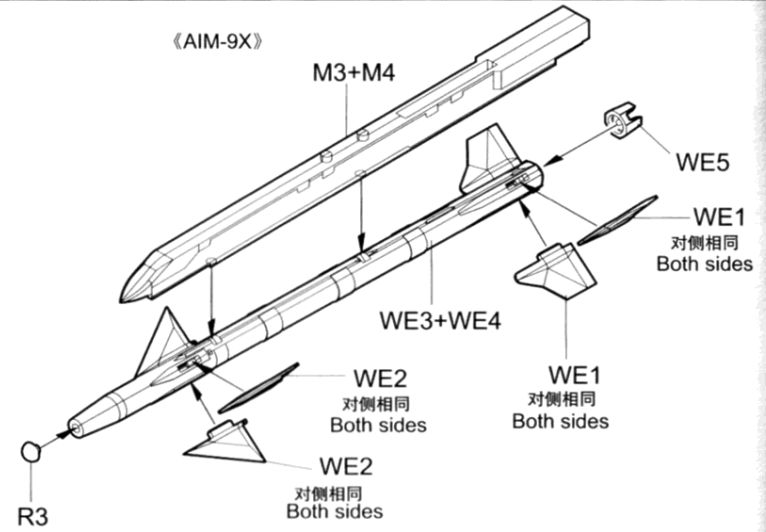

16

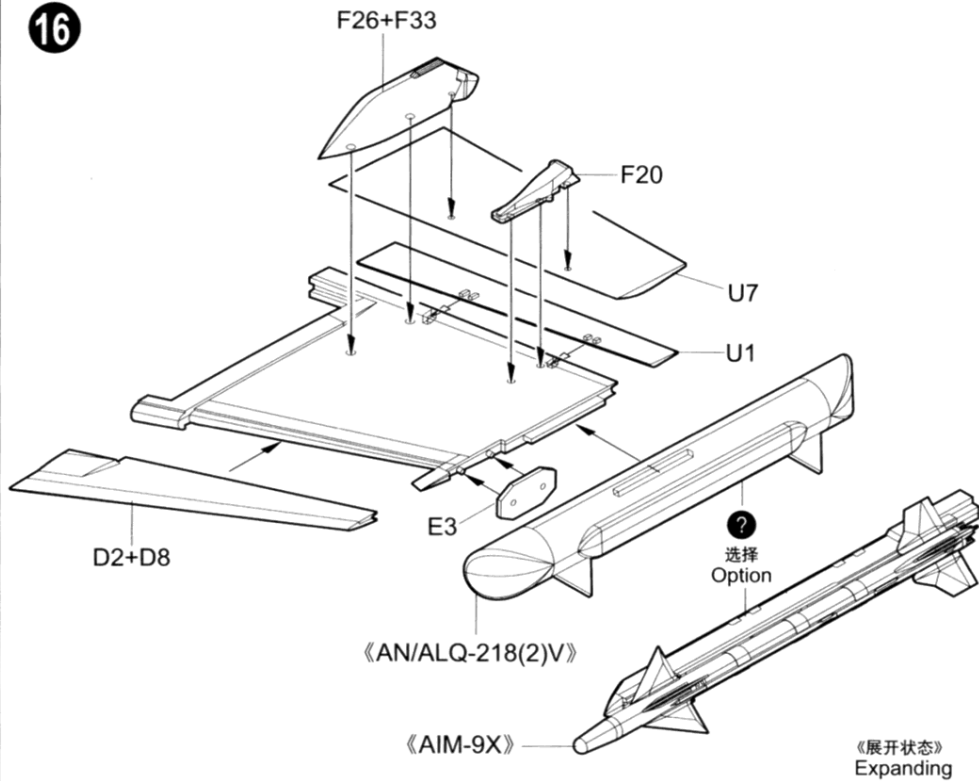

选择  
Option

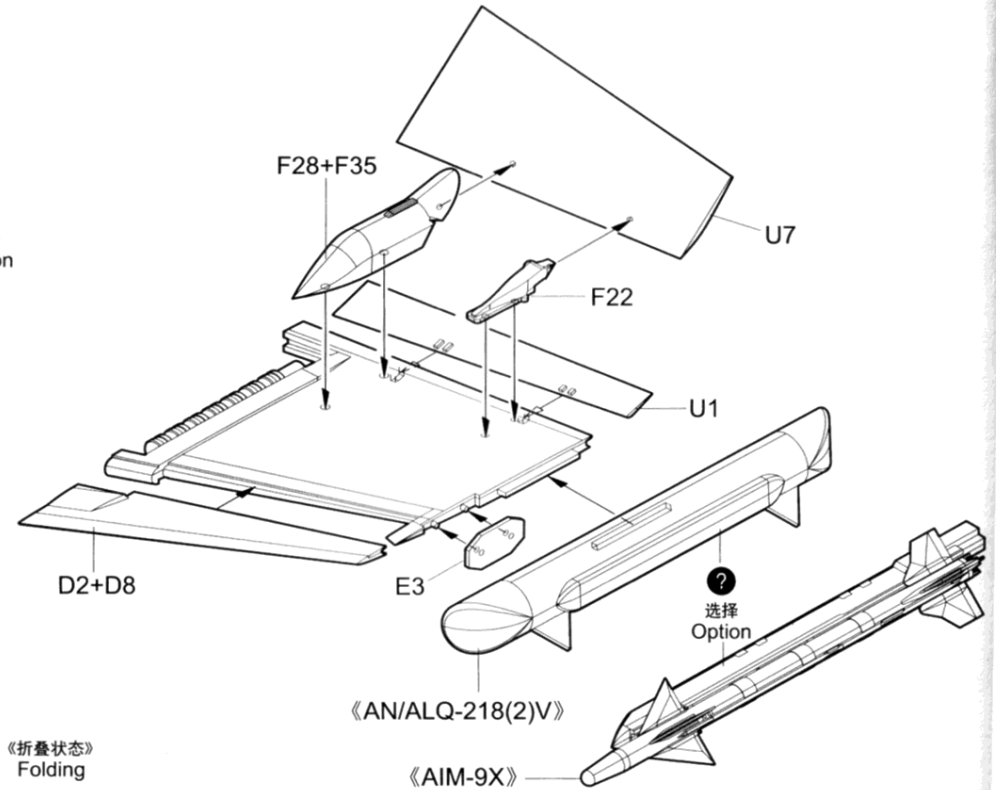

选择  
Option

17

《右侧机翼》  
Right wing

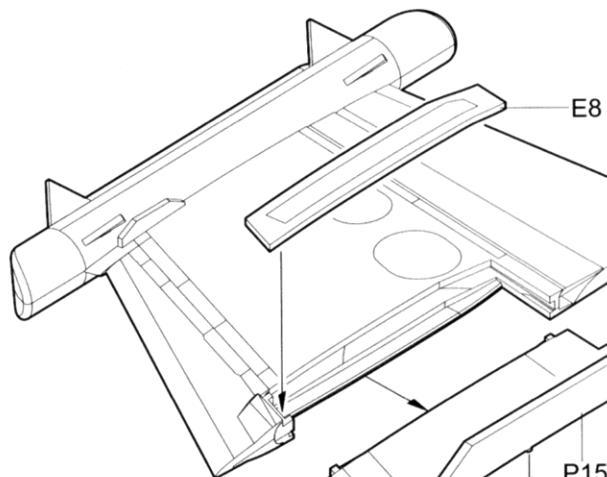
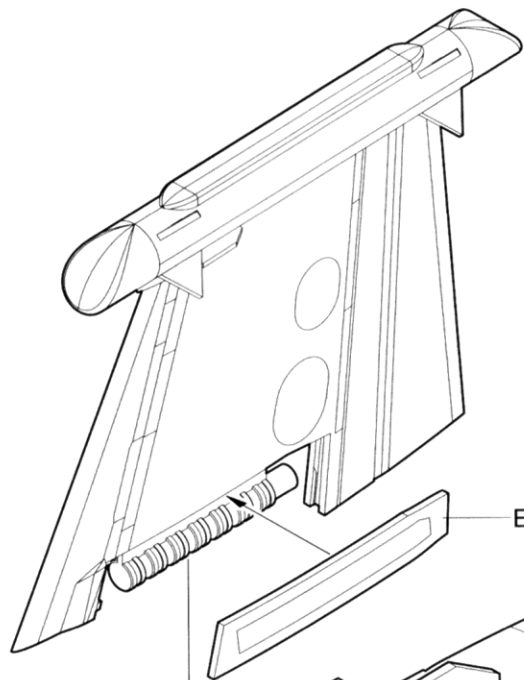

Ⓛ  
选择  
Option

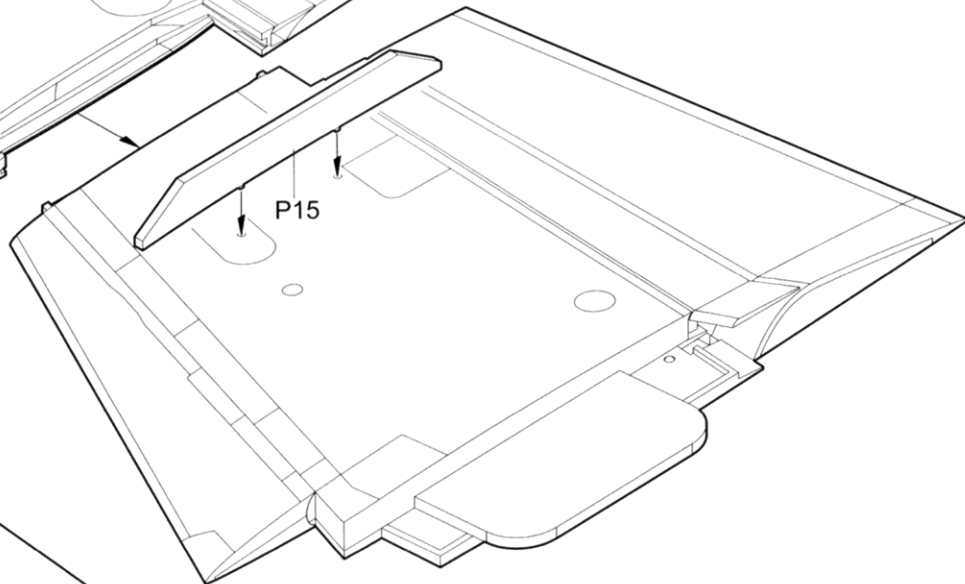
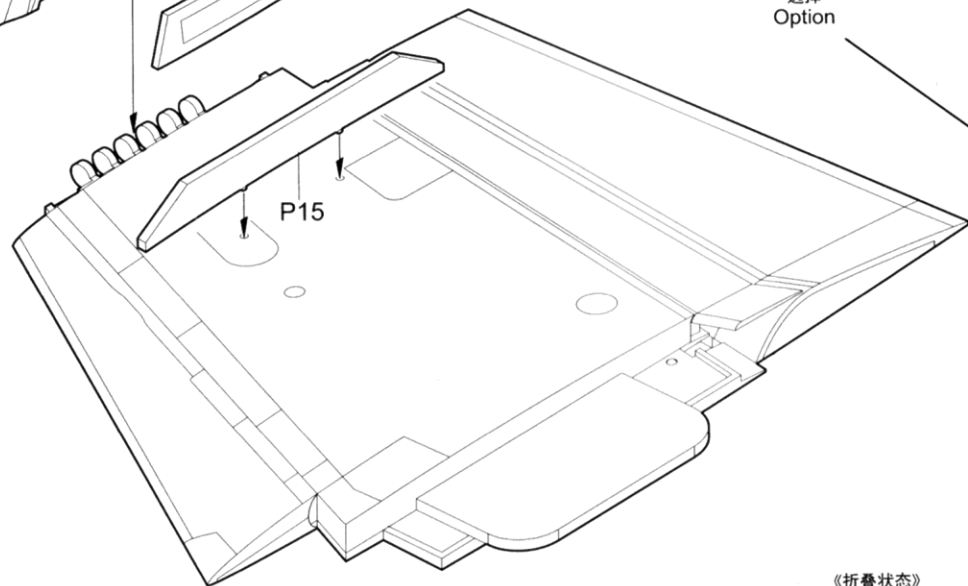

18

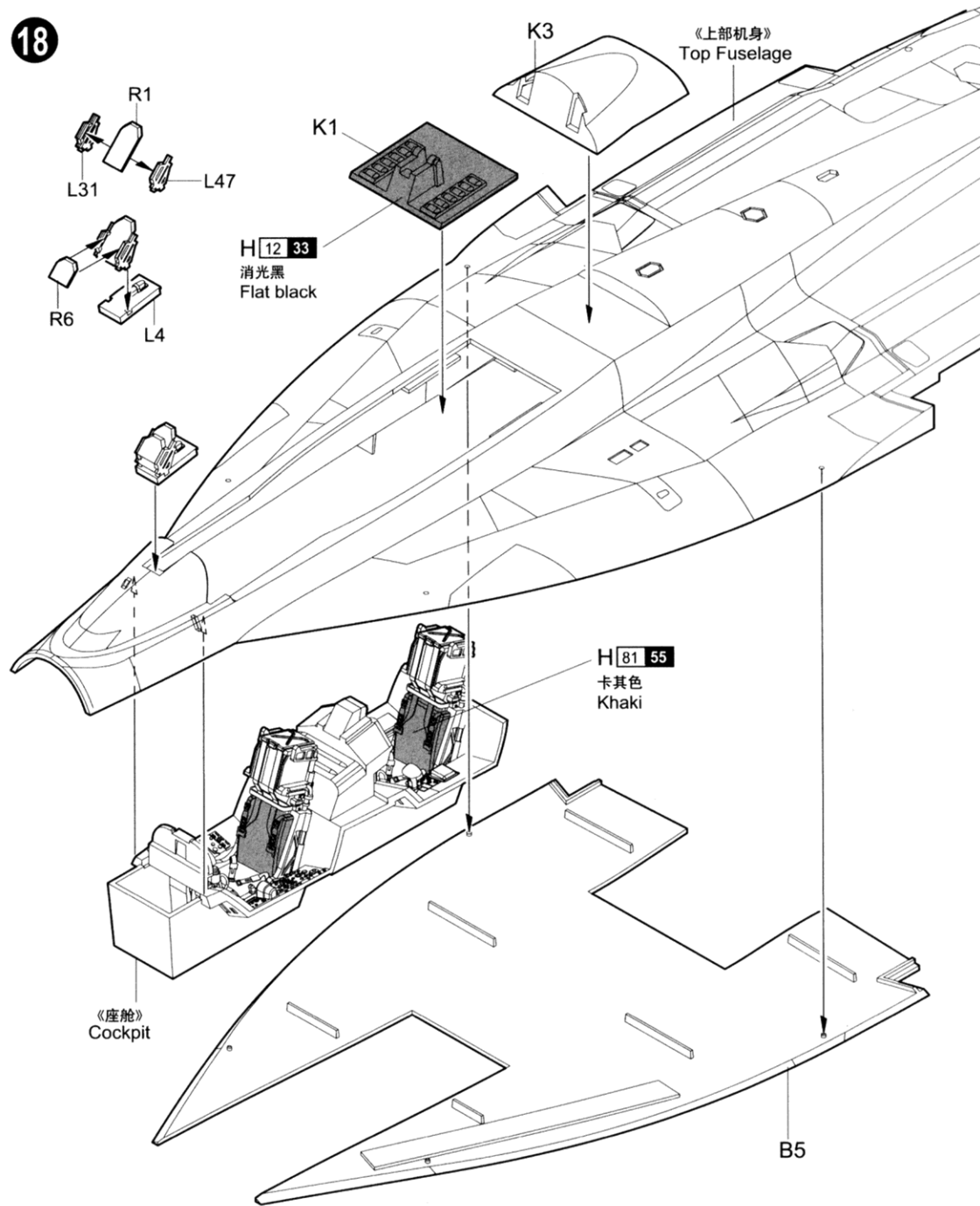

19

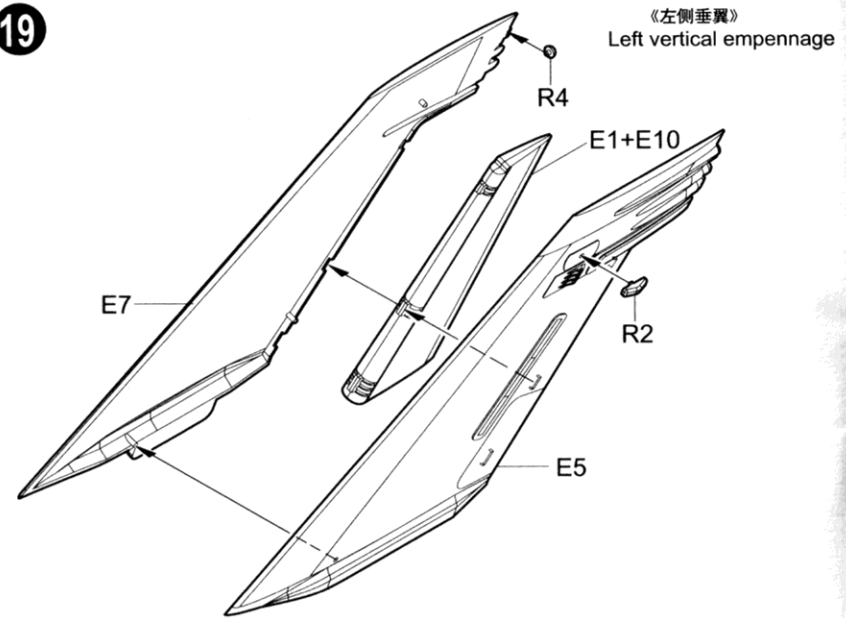

20

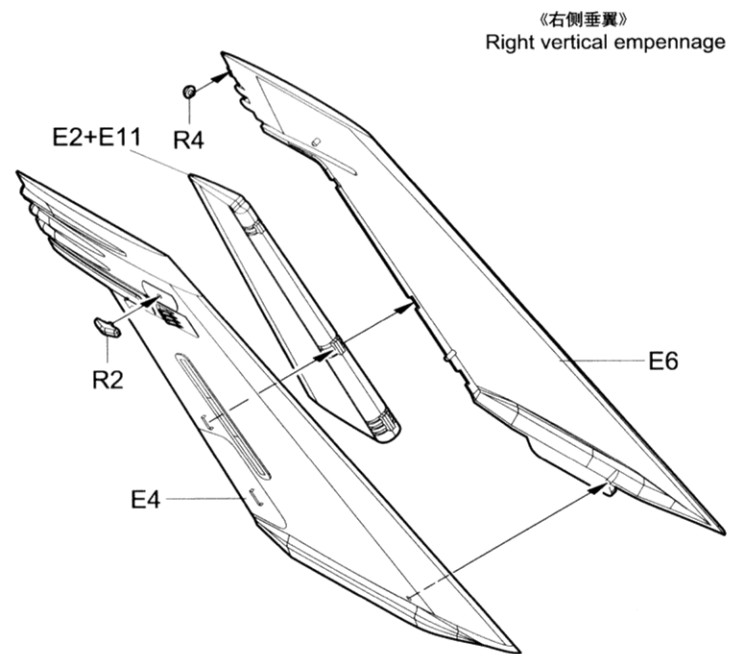

21

《闭合状态》  
Close

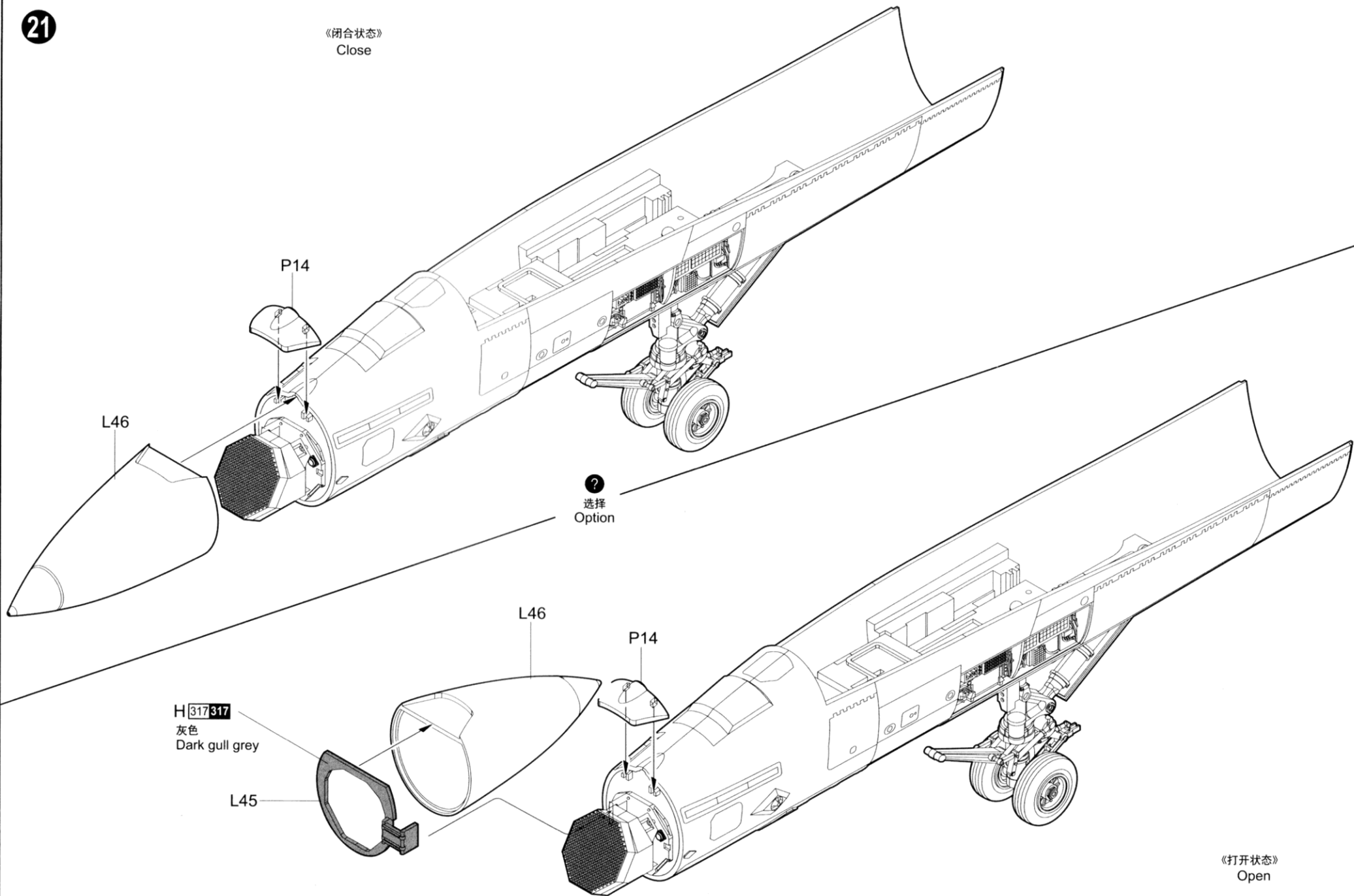

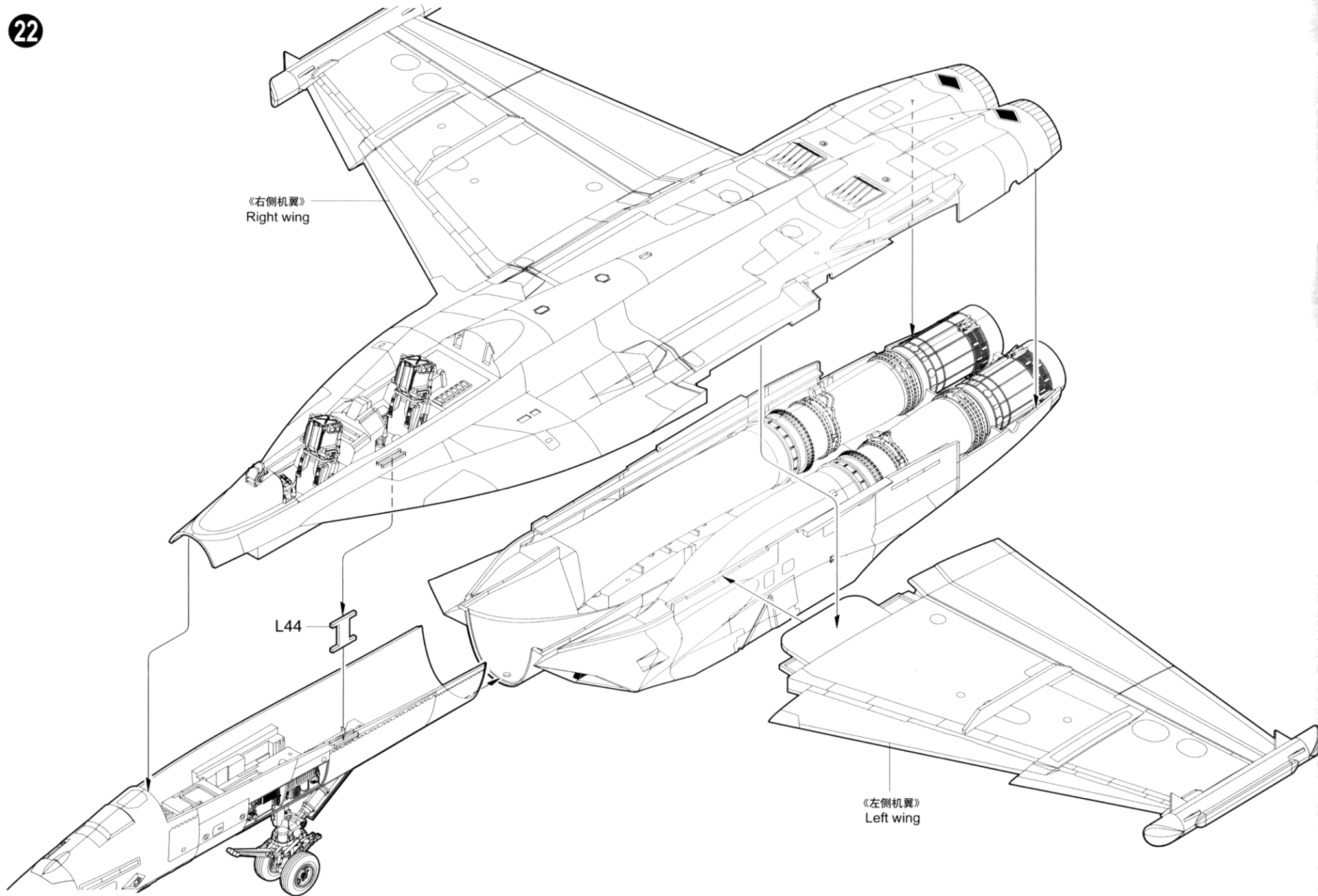

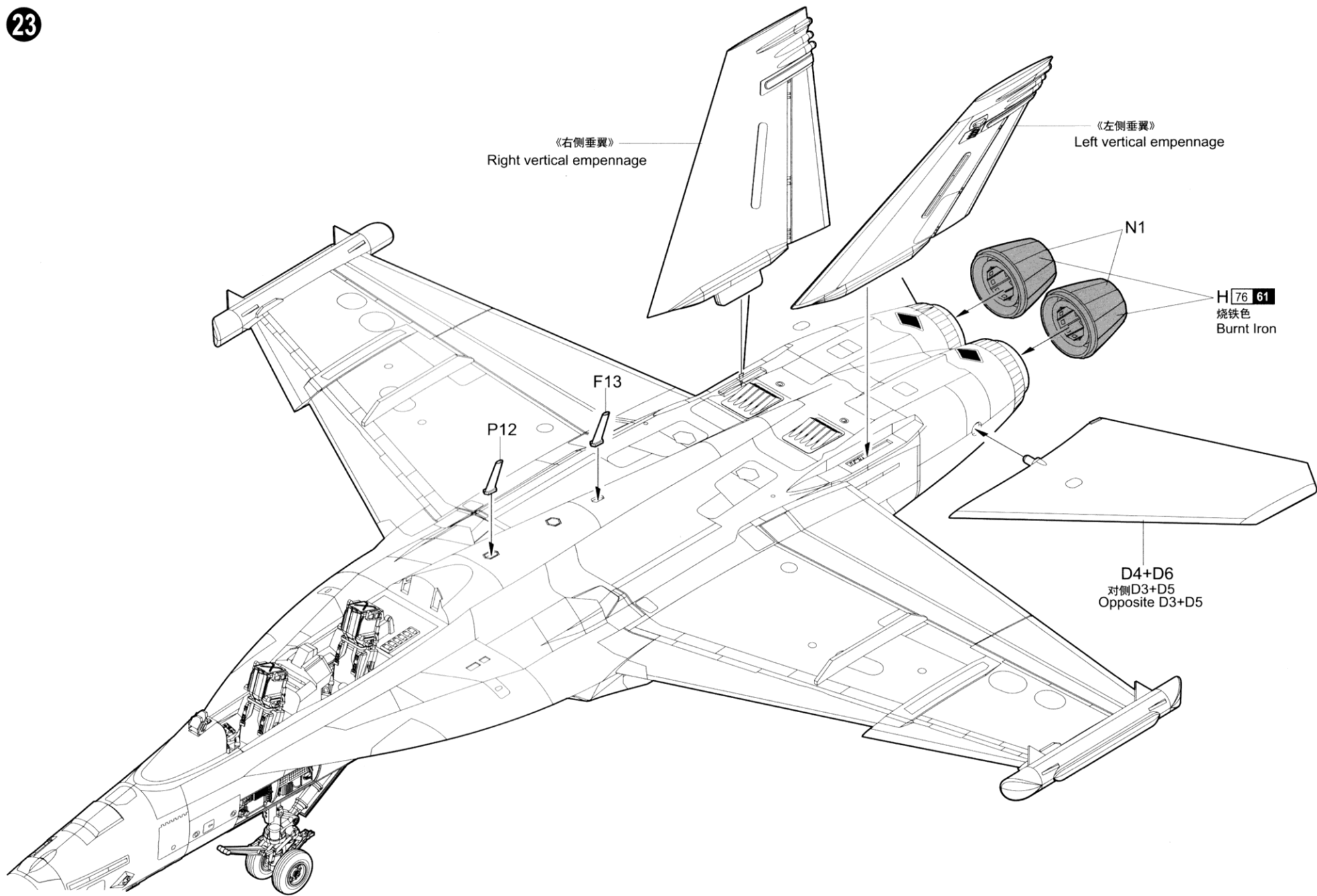

24

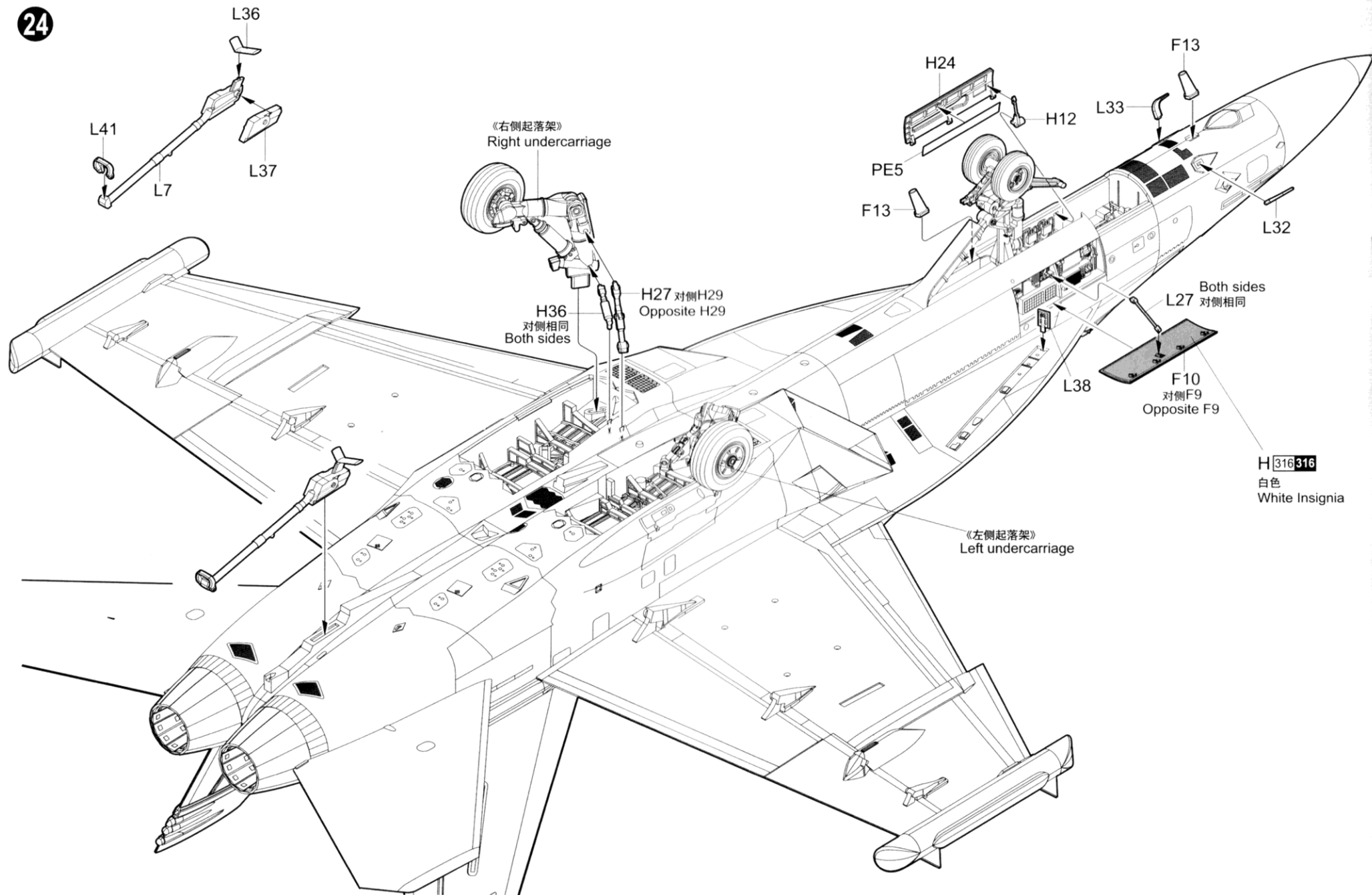

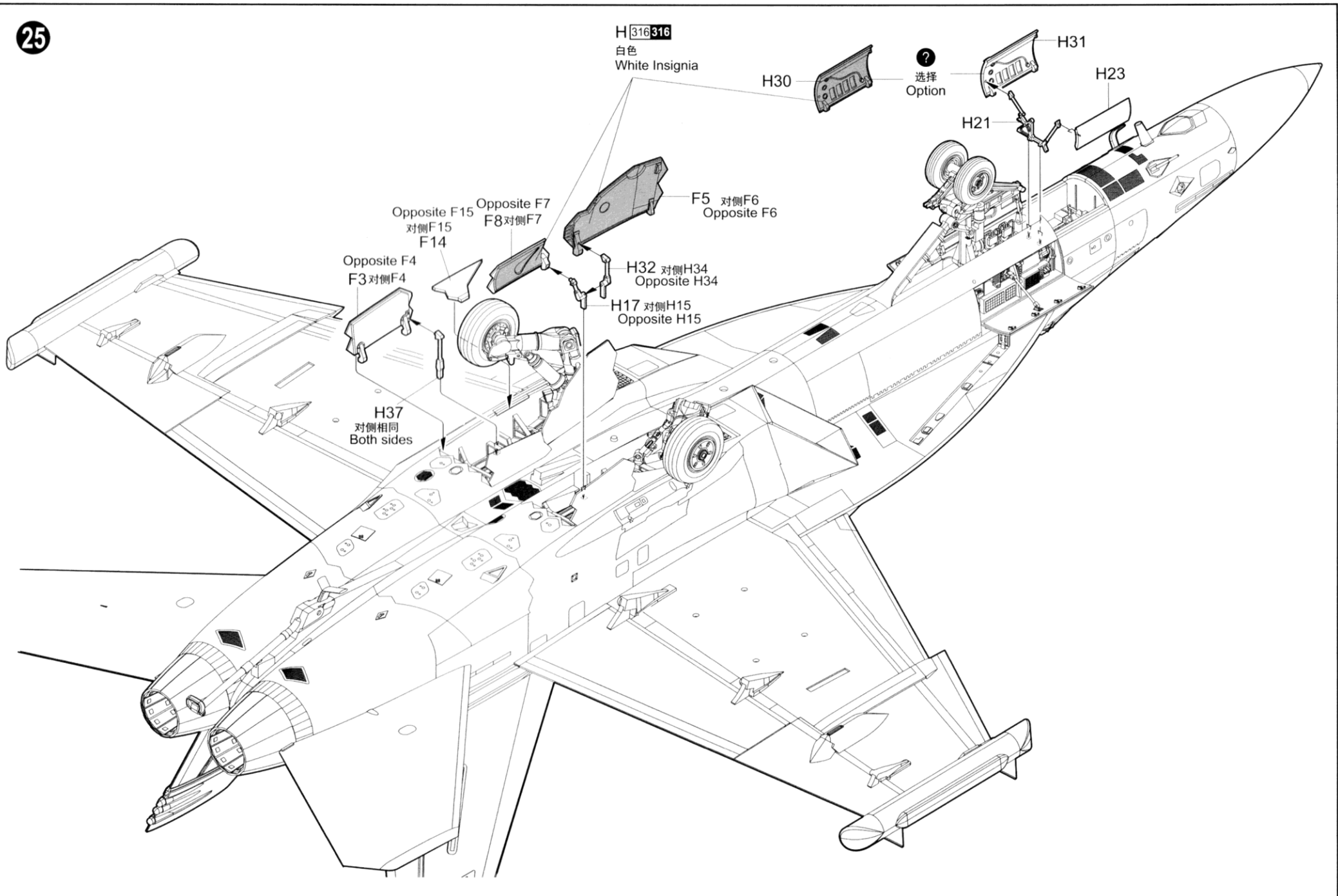

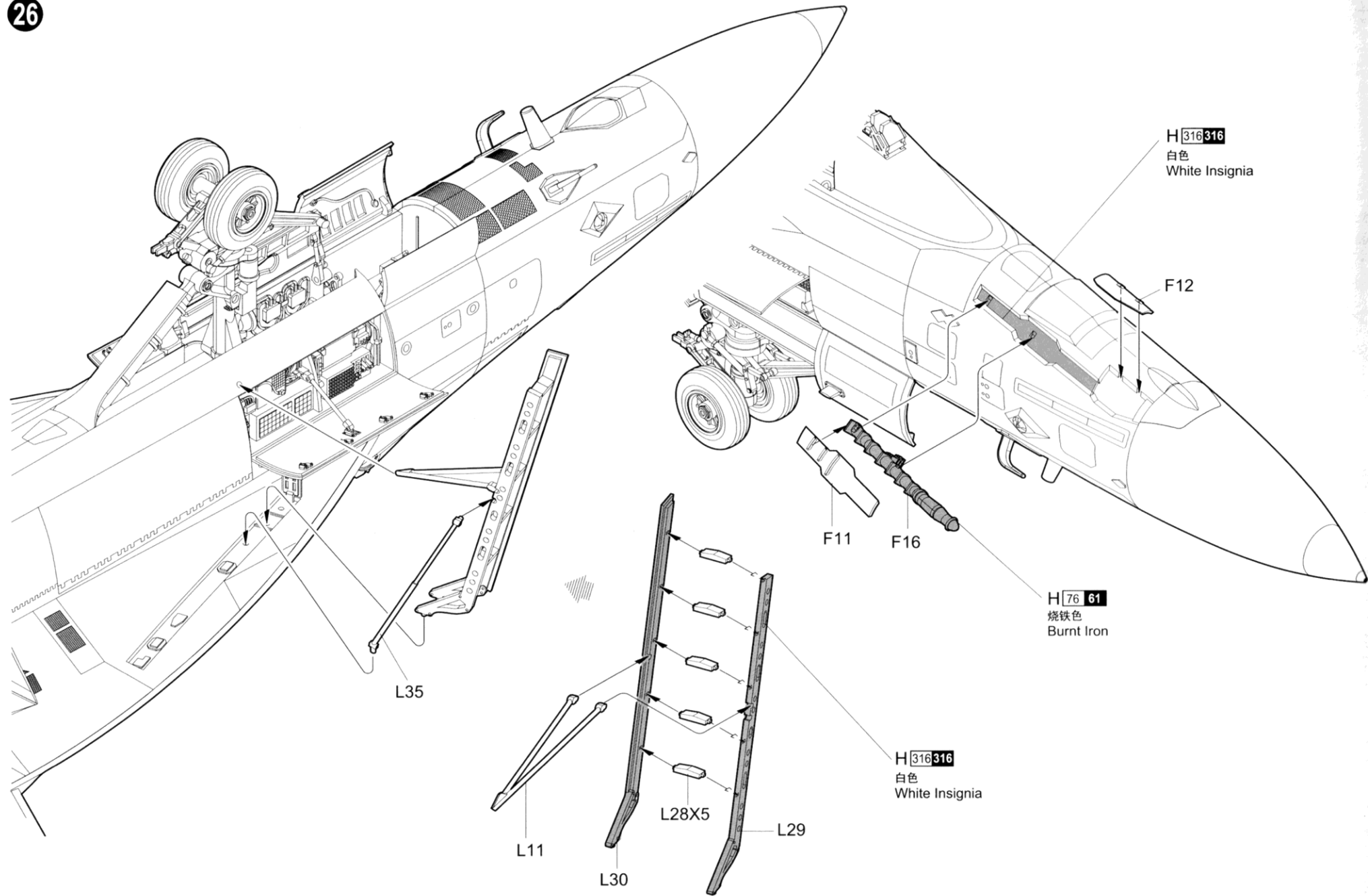

27

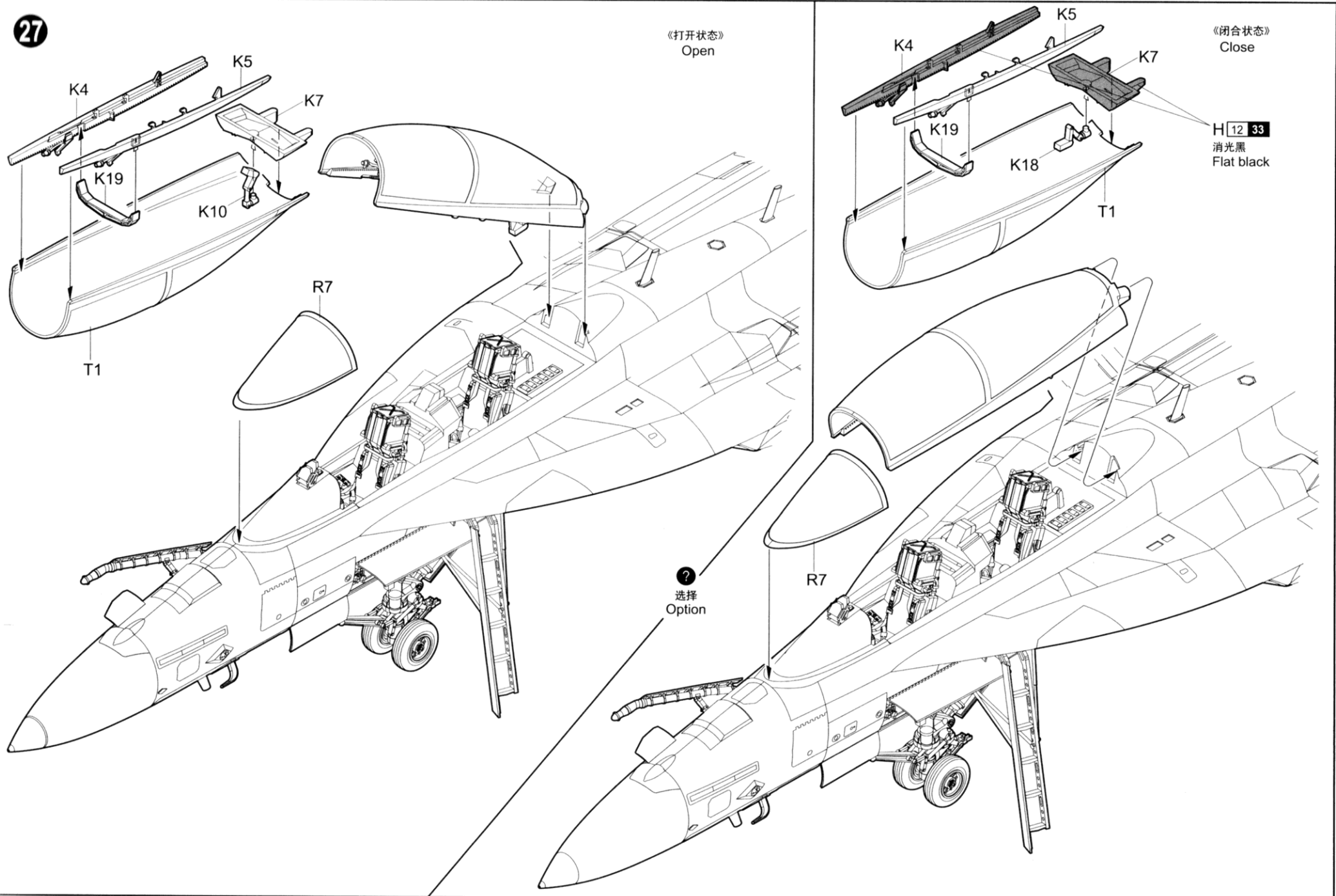

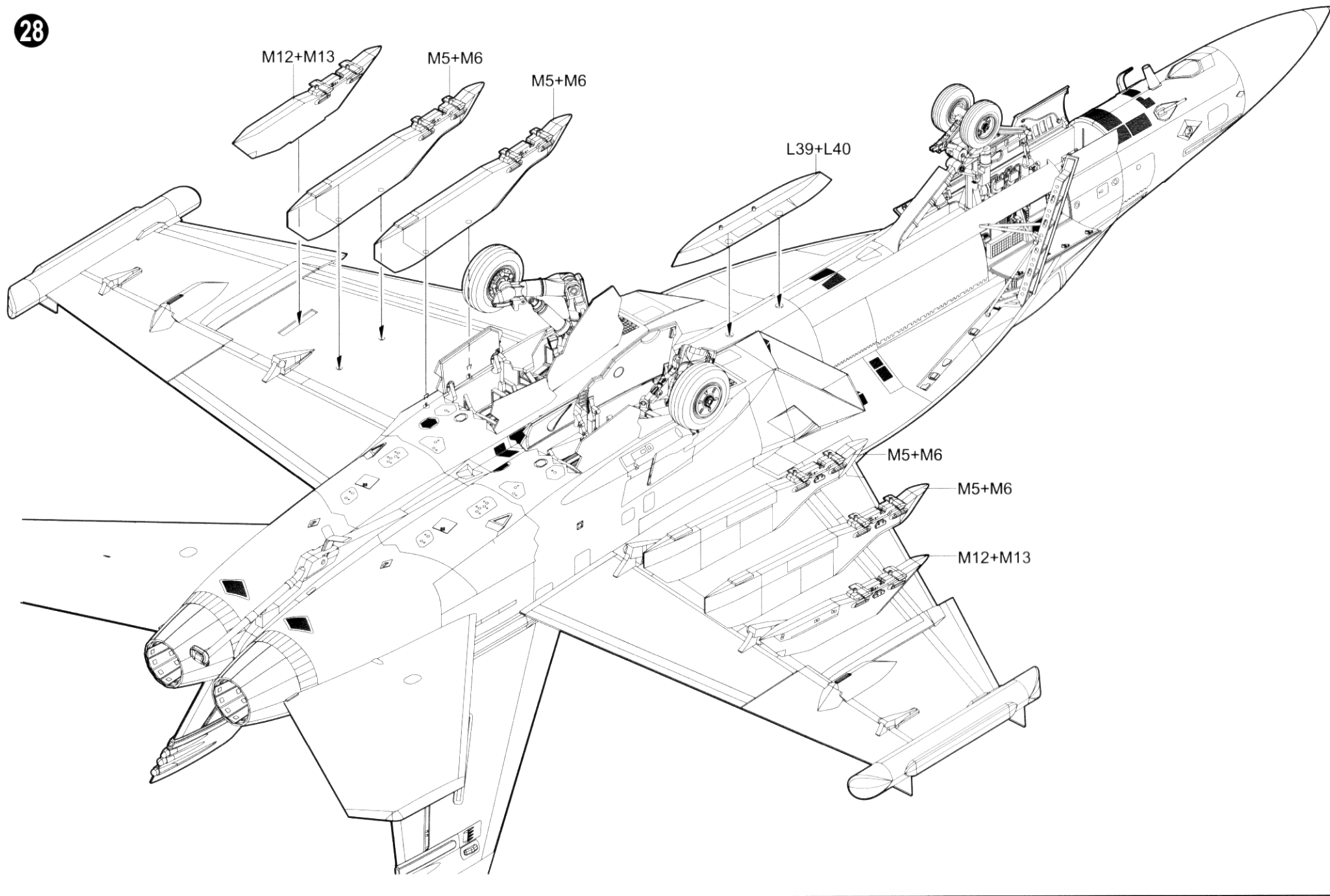

29

《AIM-120C》

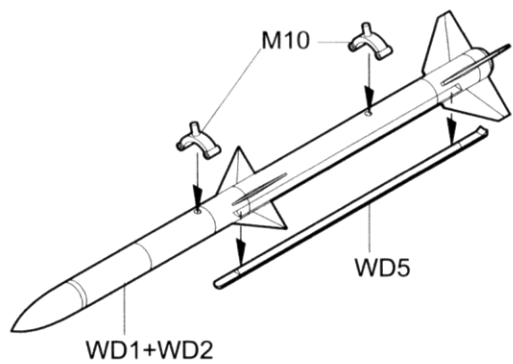

WD1+WD2

WD5

M10

制作两组  
Make two

30

《AGM-88》

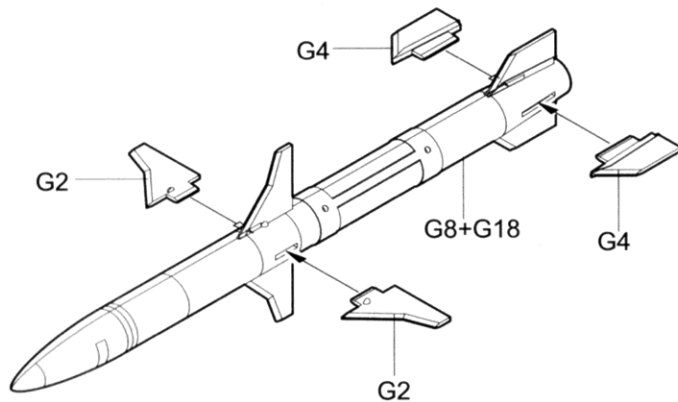

G2

G4

G8+G18

G4

G2

制作两组  
Make two

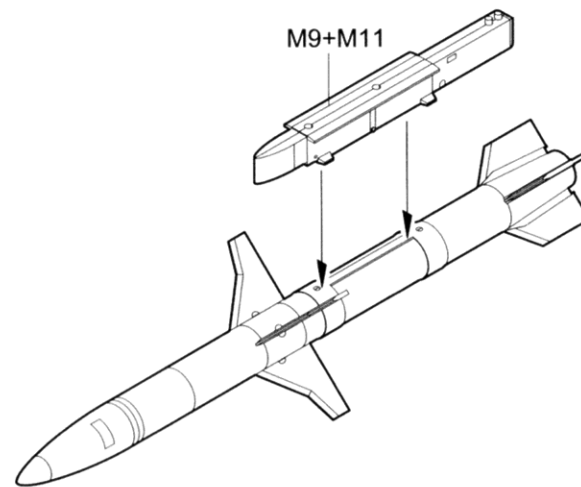

M9+M11

31

《AN/ALQ-99》-A

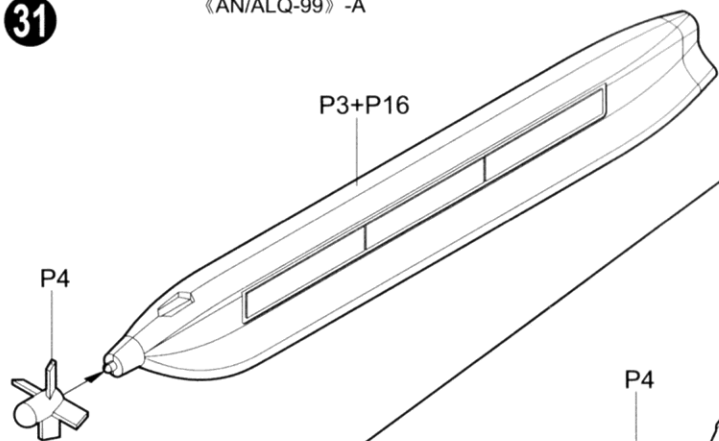

P4

P3+P16

P4

制作两组  
Make two

32

《AN/ALQ-99》-B

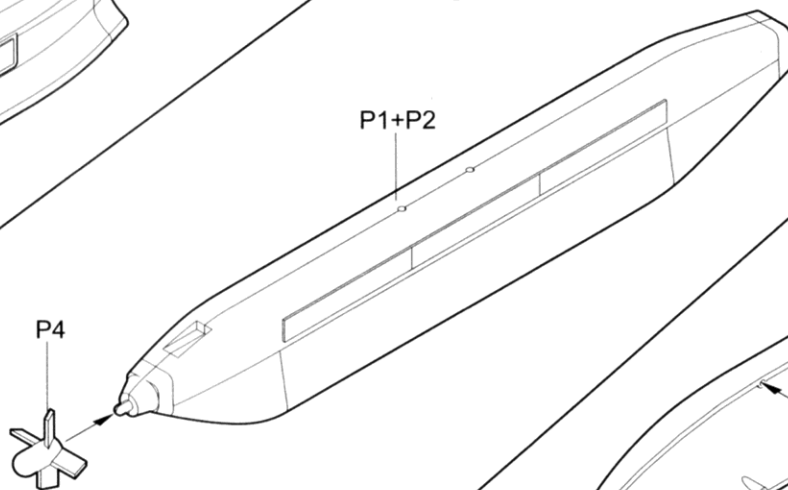

P1+P2

P4

制作两组  
Make two

33

《Fuel Tank》

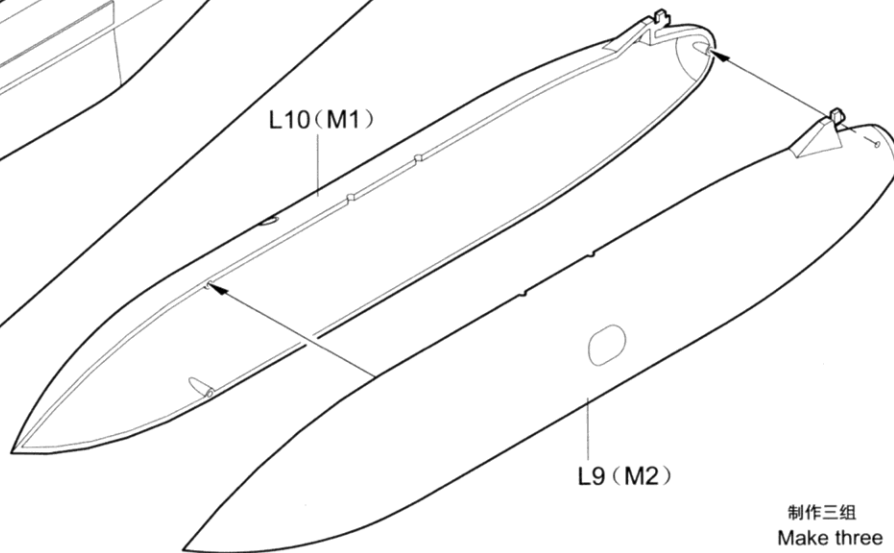

L10 (M1)

L9 (M2)

制作三组  
Make three

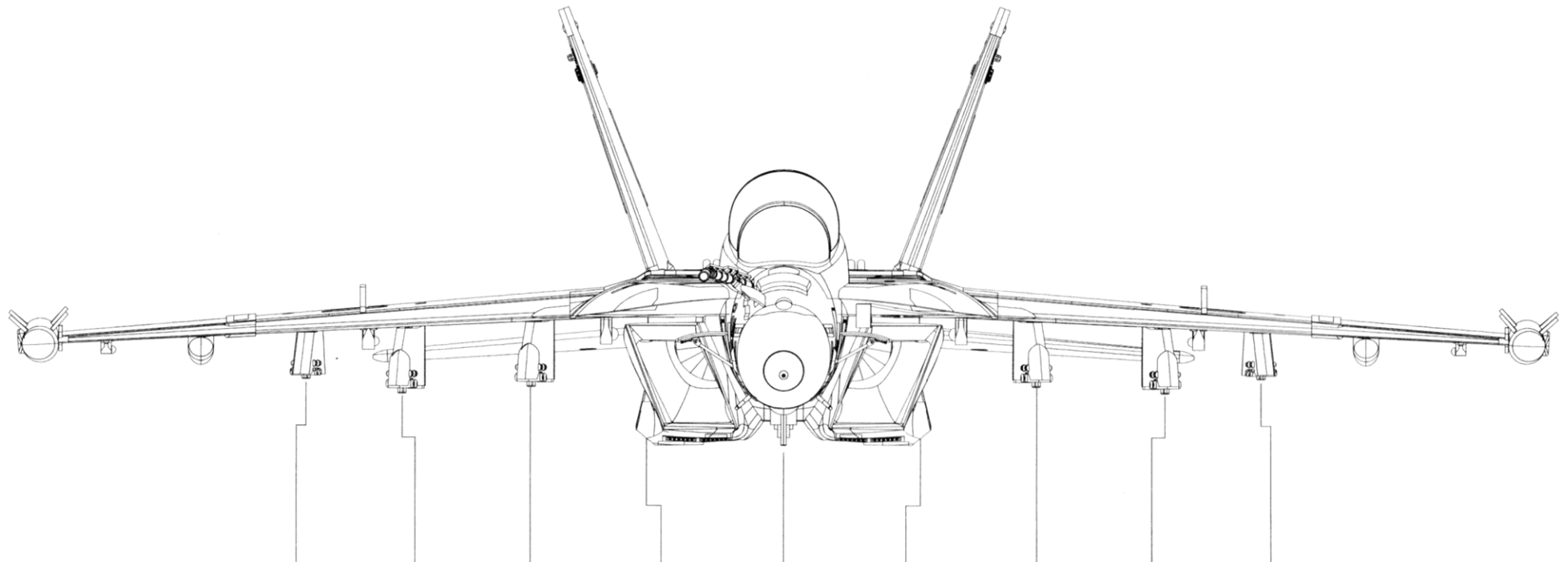

Sta.No.	1	2	3	4	5	6	7	8	9
Missile/Tank									
《AIM-120C》				●		●			
《AGM-88》	●								●
《AN/ALQ-99》 -A					●				
《AN/ALQ-99》 -B		●	●				●	●	
《Fuel Tank》		●	●		●		●	●	

# 涂装同标贴指示 Painting & Marking guide

**A** EA-18G Growler VAQ-129, NJ-550/166858

Color	Mr.Hobby	Vallejo	Model Master
银色 Silver	H 8 8	997	154
消光黑 Flat Black	H 12 33	950	174
烧铁色 Burnt Iron	H 76 61	863	179
哑光白 Flat White	H 11 62	951	176

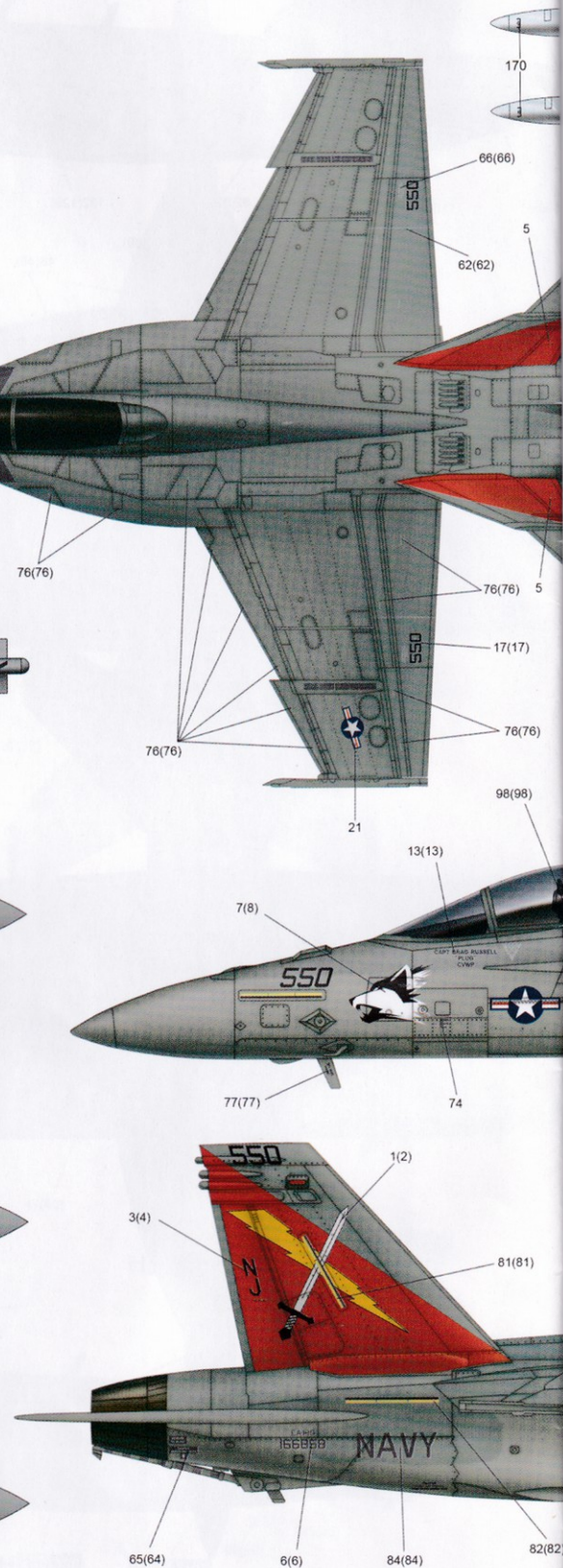
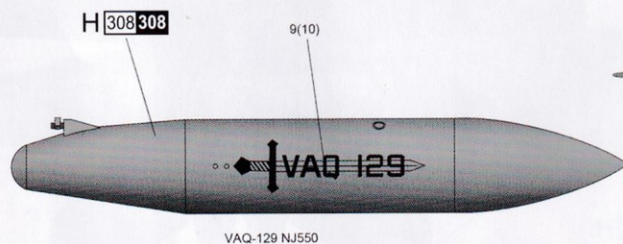
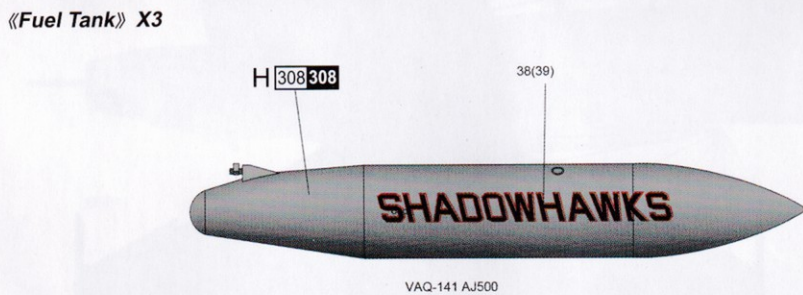
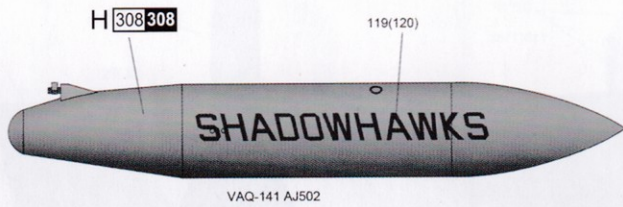
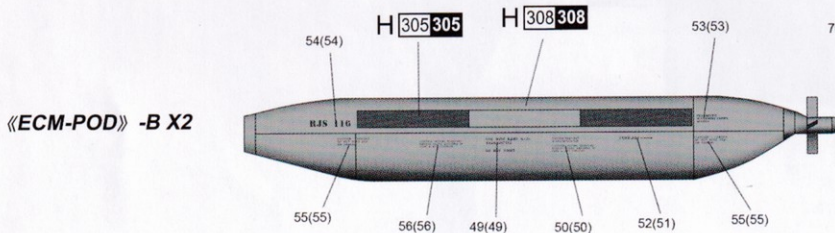
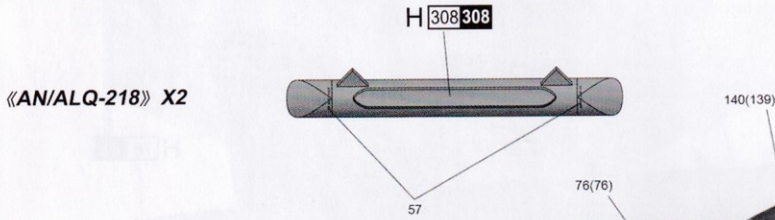
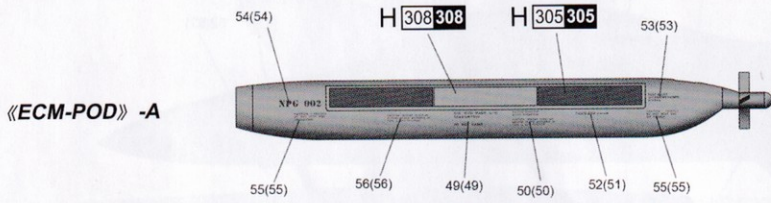

	Tamiya	Humbrol
	X11	11
	XF1	33
	X10	53
	XF2	34

Color	Mr.Hobby	Vallejo	Model Master	Tamiya	Humbrol
白色 White Insignia	H 316 316	991	1745	X2	22
灰色 Grey	H 307 307	-	1741	XF22	128
灰色 Grey	H 308 308	990	1728	XF19	127

Color	Mr.Hobby	Vallejo	Model Master	Tamiya	Humbrol
黑色 Black	H 2 2	861	1747	X1	21
深灰色 Medium Gunship Grey	H 305 305	868	1723	XF58	125
红色 Insignia Red	H 327 327	957	1705	XF7	153





**C** EA-18G Growler VAQ-141, AJ-502/166930, USS GEORGE H W BUSH

