

**eduard**

**LIMITED**  
EDITION



# AFRIKA

**INSTRUCTION SHEET**

**1/72**

2112-NAV 1



Carefully read instruction sheet before assembling. When you use glue or paint, do not use near open flame and use in well ventilated room. Keep out of reach of small children. Children must not be allowed to suck any part, or pull vinyl bag over the head.



Před započítím stavby si pečlivě prostudujte stavební návod. Při používání barev a lepidel pracujte v dobře větrané místnosti. Lepidla ani barvy nepoužívejte v blízkosti otevřeného ohně. Model není určen malým dětem, mohlo by dojít k požití drobných dílů.

INSTRUCTION SIGNS \* INSTR. SYMBOLS \* INSTRUKTION SINNBILDEN \* SYMBOLES \* 記号の説明

-   
 OPTIONAL  
VOLBA
-   
 BEND  
OHNOUT
-   
 SAND  
BROUSIT
-   
 OPEN HOLE  
VYVRTAT OTVOR
-   
 SYMETRICAL ASSEMBLY  
SYMETRICKÁ MONTÁŽ
-   
 REMOVE  
ODRÍZNOUT
-   
 REVERSE SIDE  
OTOČIT
-   
 APPLY EDUARD MASK  
AND PAINT  
POUŽIT EDUARD MASK  
NABARVIT

**PLEASE CHECK THE LATEST VERSION OF THE INSTRUCTIONS ON [www.eduard.com](http://www.eduard.com)**

PARTS \* DÍLY \* TEILE \* PIÈCES \* 部品

# Bf 109F-4

## PLASTIC PARTS

**L>**

70150 L

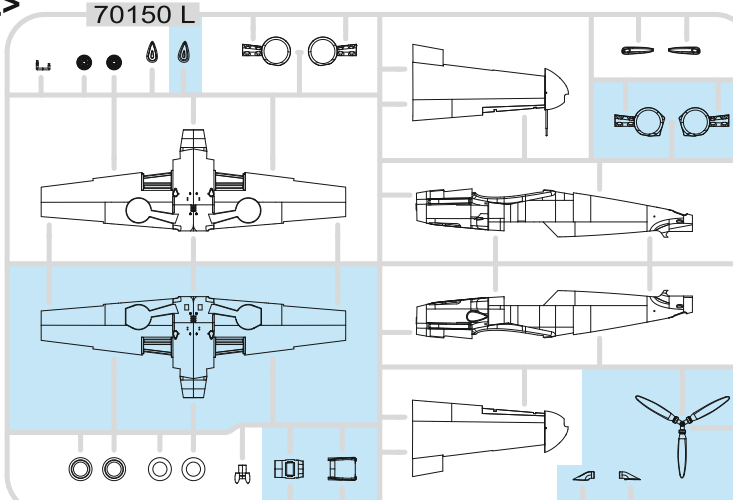

**H>**

70150 H

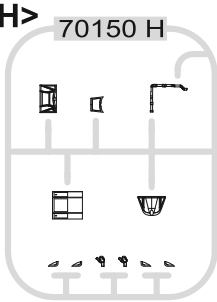

**U>**

70150 U

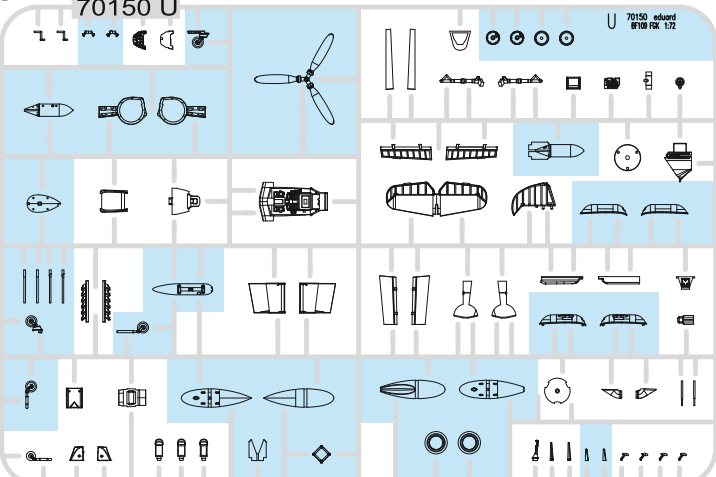

**W>**

70150 W

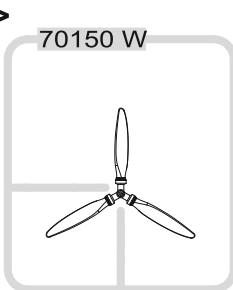

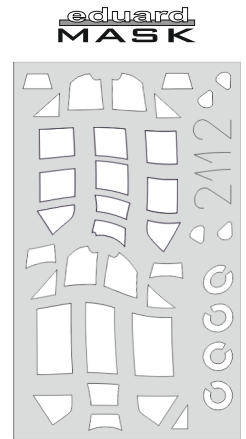

## PE - PHOTO ETCHED DETAIL PARTS

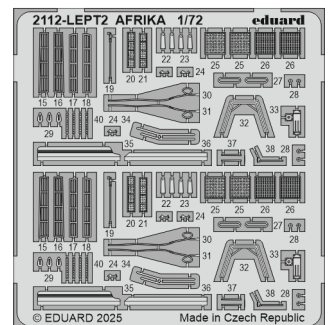
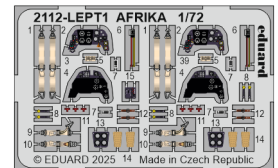

  -Parts not for use. -Teile werden nicht verwendet. -Pièces à ne pas utiliser. -Tyto díly nepoužívejte při stavbě. - 使用しない部品

COLOURS \* BARVY \* FARBEN \* PEINTURE \* 色

GSI Creos (GUNZE)		
AQUEOUS	Mr.COLOR	
H2	C2	BLACK
H11	C62	FLAT WHITE
H12	C33	FLAT BLACK
H33	C81	RUSSET
H47	C41	RED BROWN
H65	C18	RLM70 BLACK GREEN
H66	C119	RLM79 SAND YELLOW
H70	C60	RLM02 GRAY
H76	C61	BURNT IRON
H77	C137	TIRE BLACK
H90	C47	CLEAR RED
H94	C138	CLEAR GREEN

GSI Creos (GUNZE)		
AQUEOUS	Mr.COLOR	
H413	C113	RLM04 YELLOW
H414	C114	RLM23 RED
H416	C116	RLM66 BLACK GRAY
H418	C118	RLM78 LIGHT BLUE
Mr.COLOR SUPER METALLIC		
SM201		SUPER FINE SILVER
SM202		SUPER GOLD
SM203		SUPER IRON
SM204		SUPER STAINLESS
Mr.COLOR GX		
GX05		SUSIE BLUE

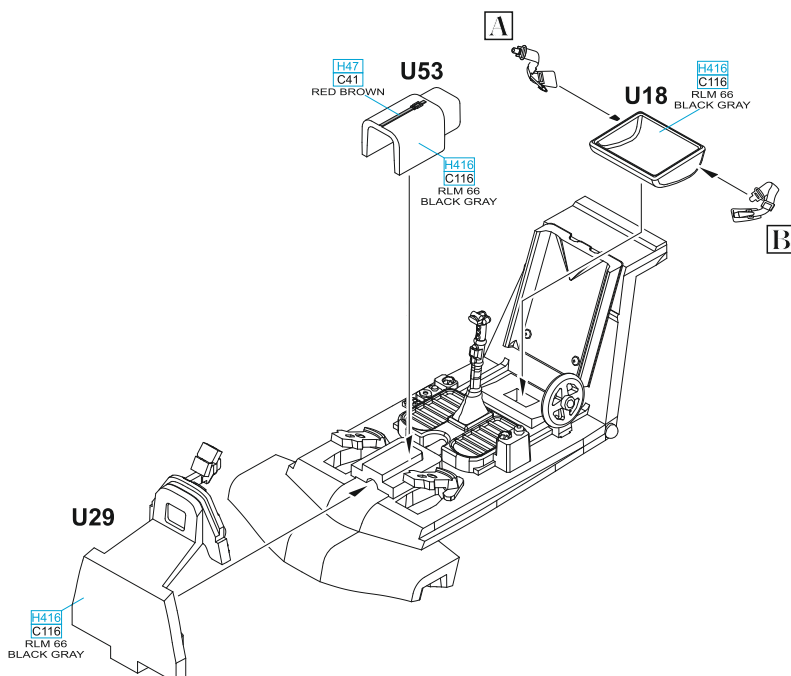
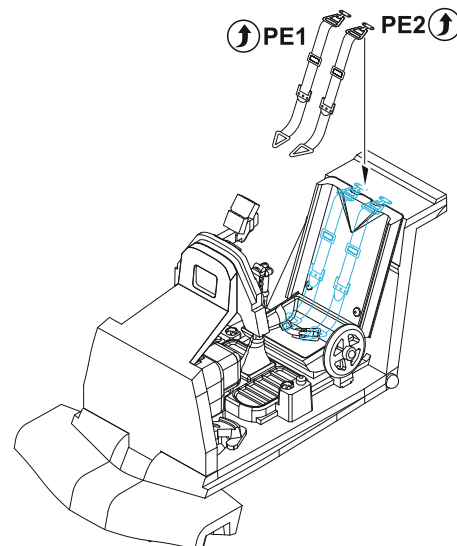
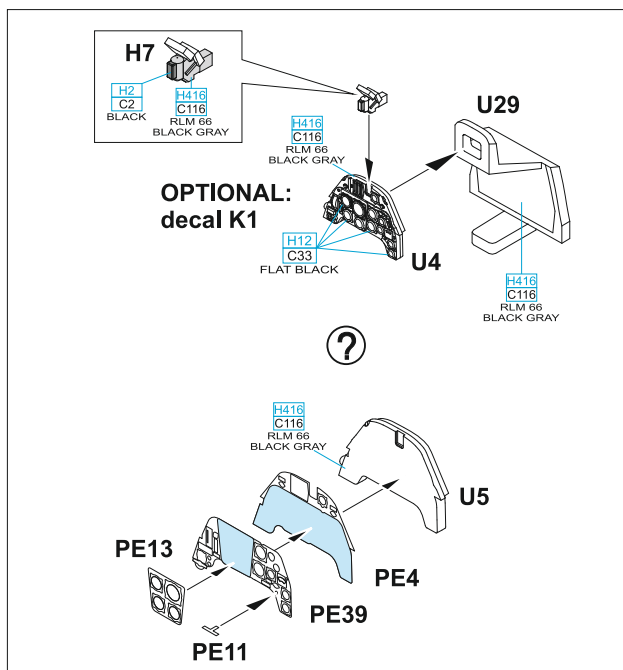
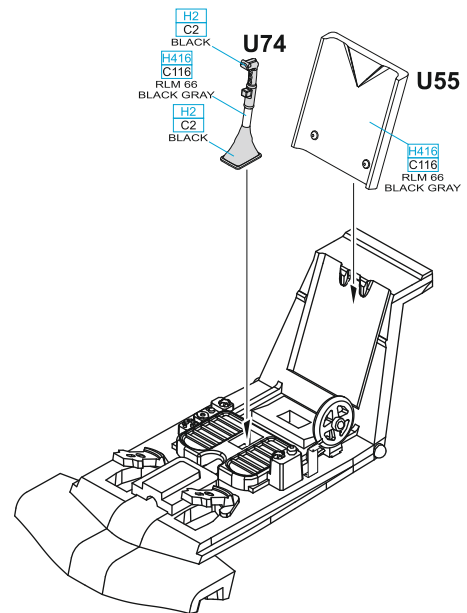
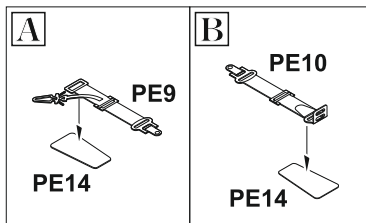
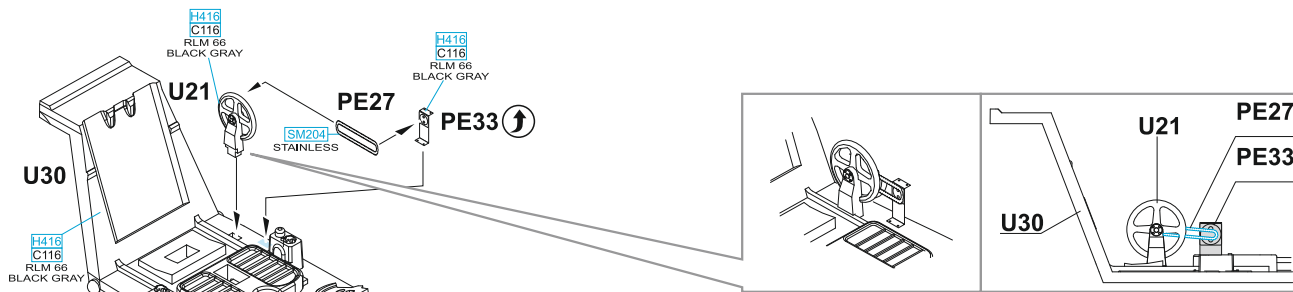

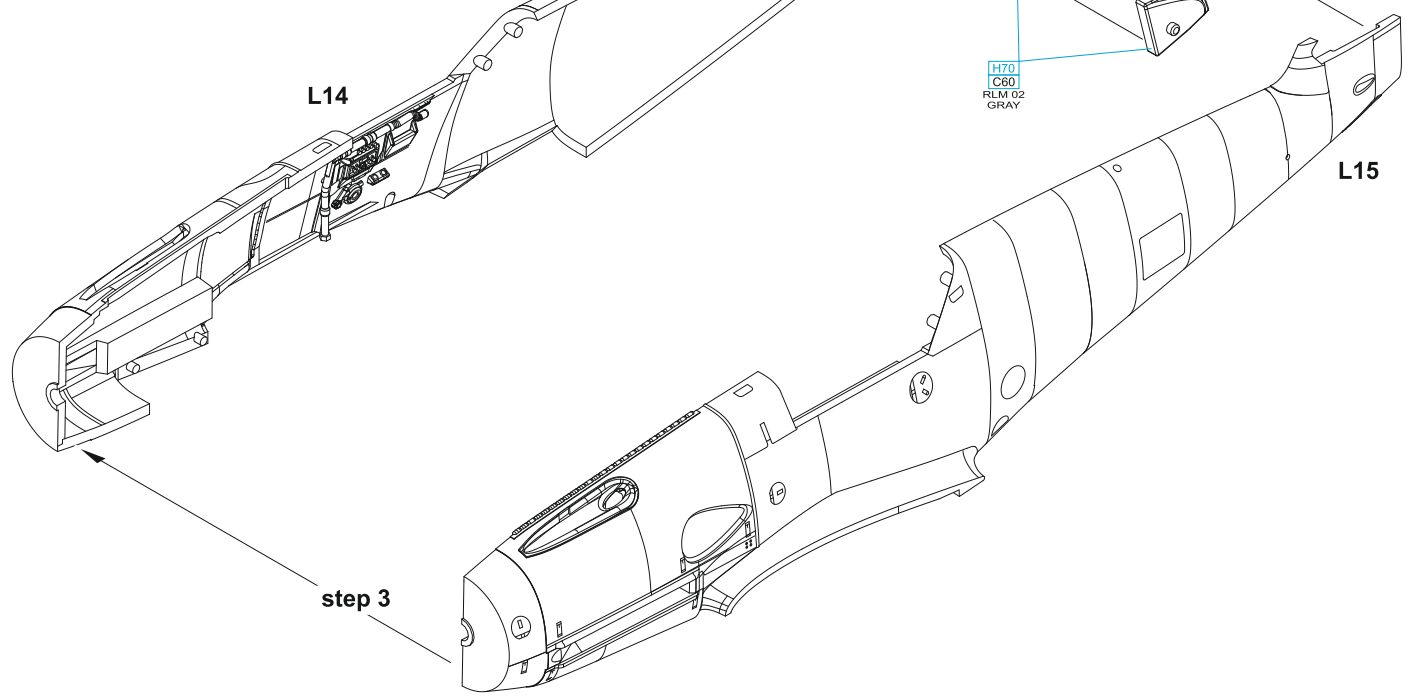
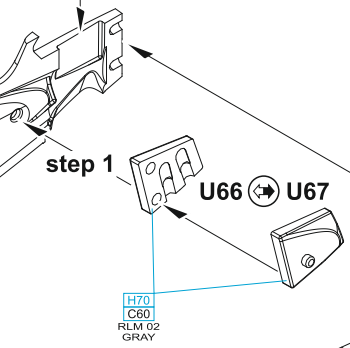
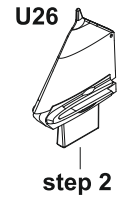
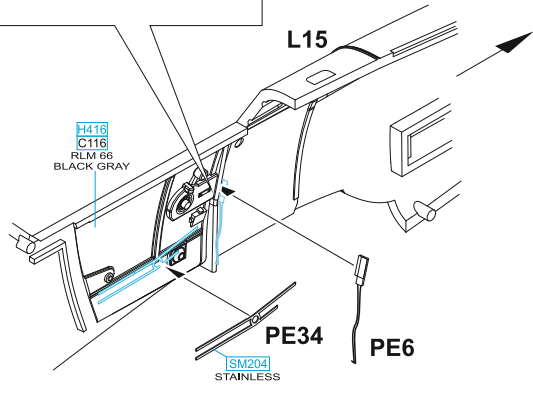
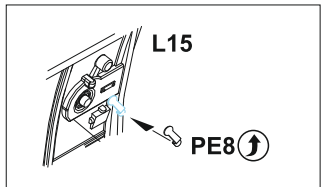
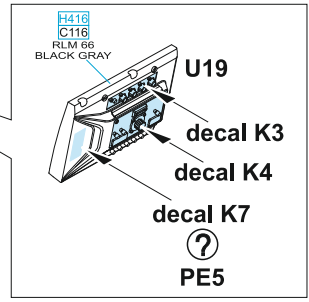
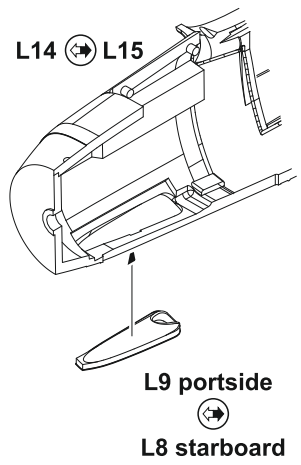
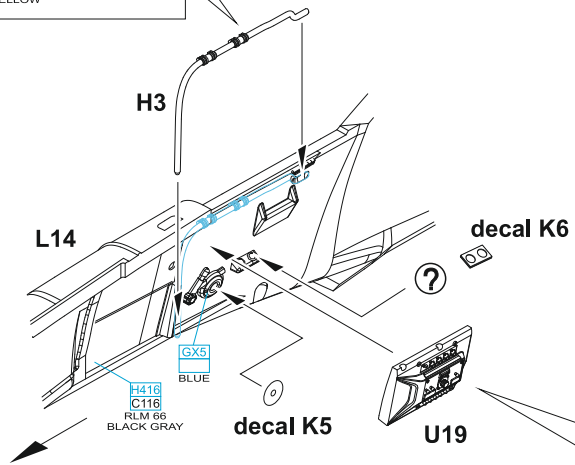
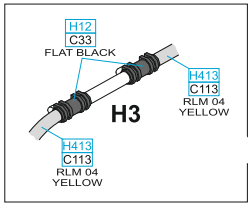

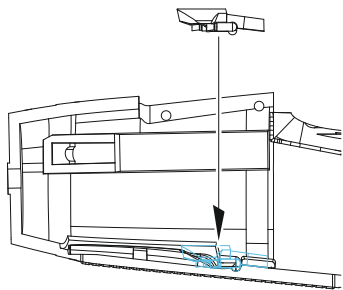
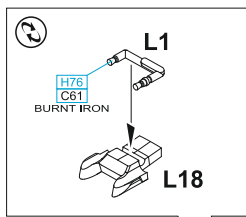

∅ - 0,2 mm

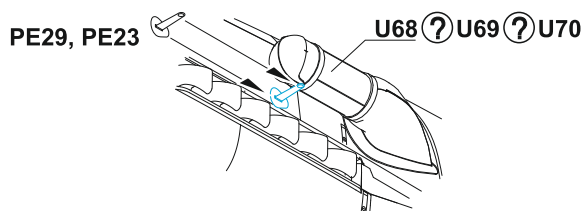
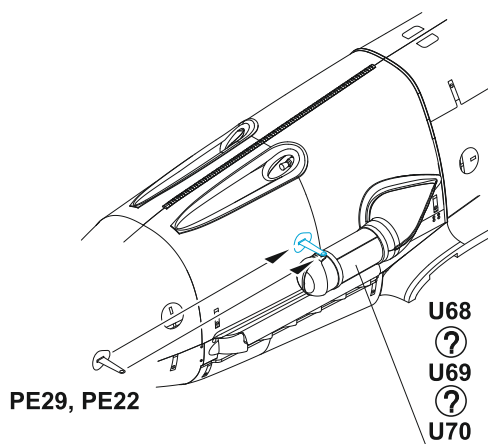
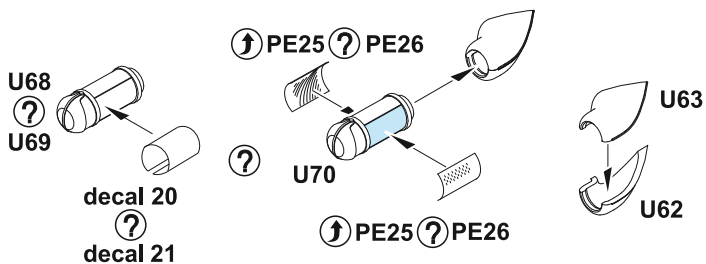
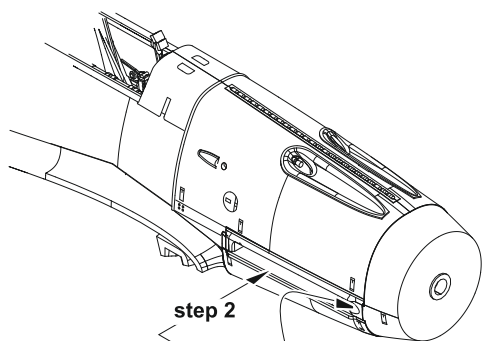
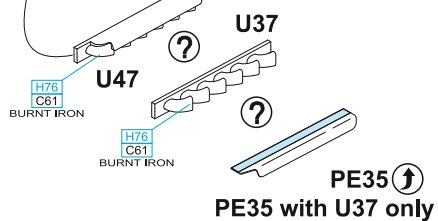
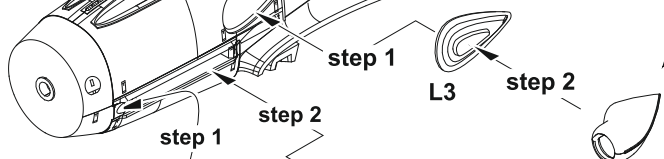
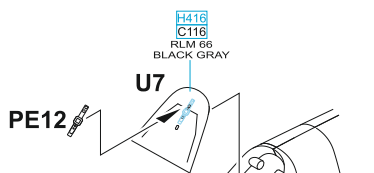
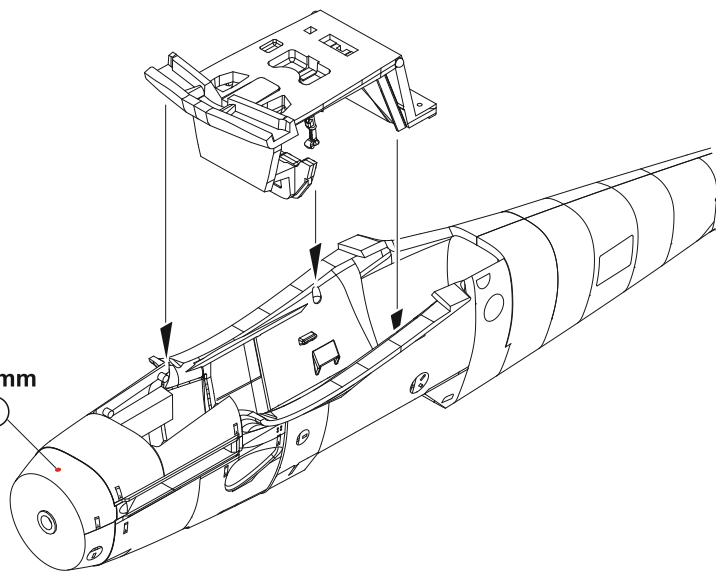

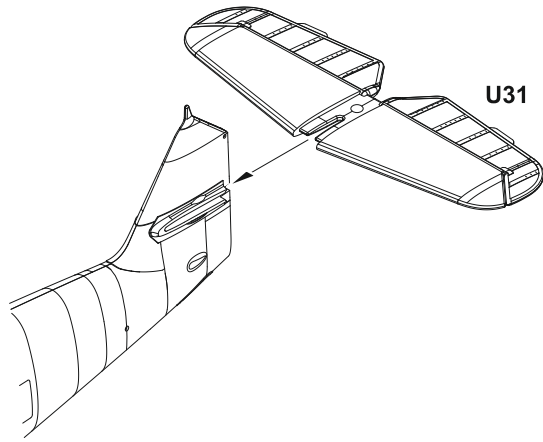

PE40 - MARKING C ONLY

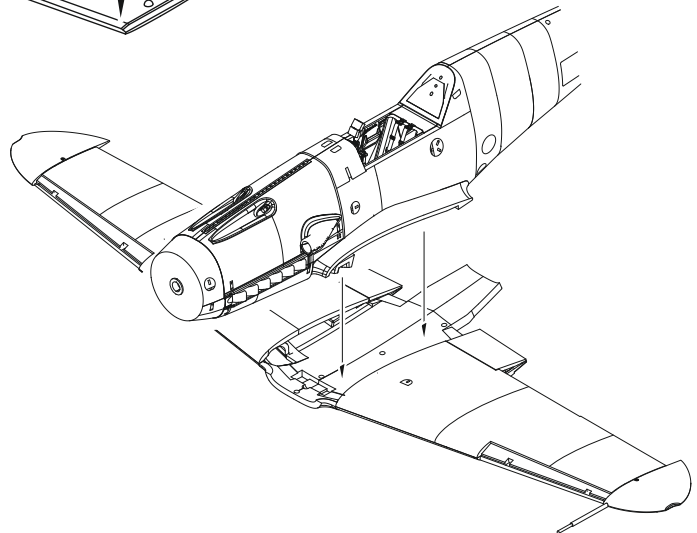
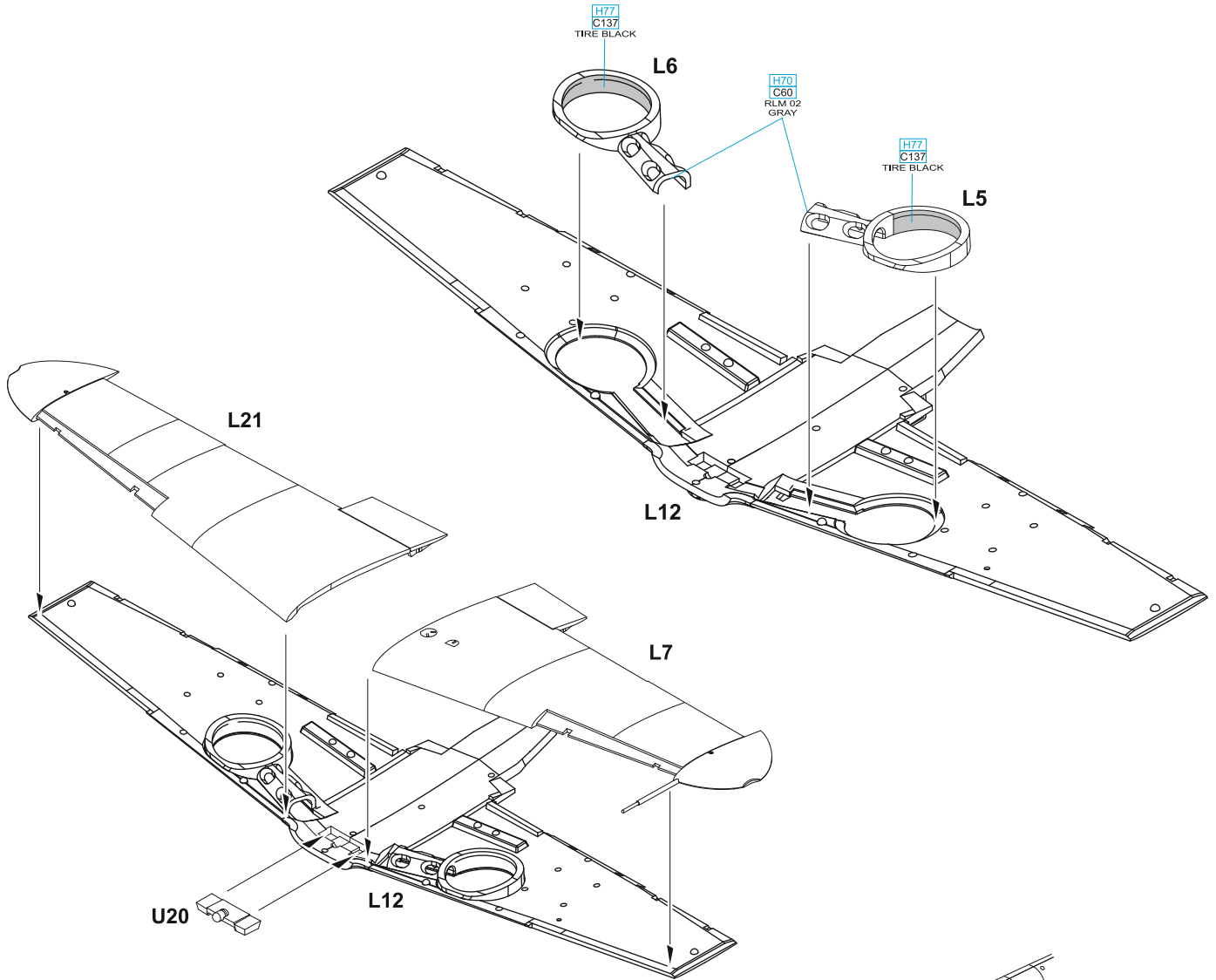
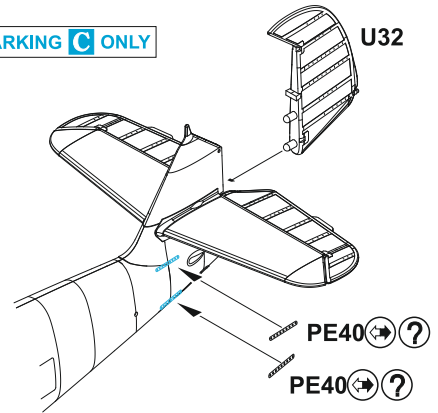

# CLOSED

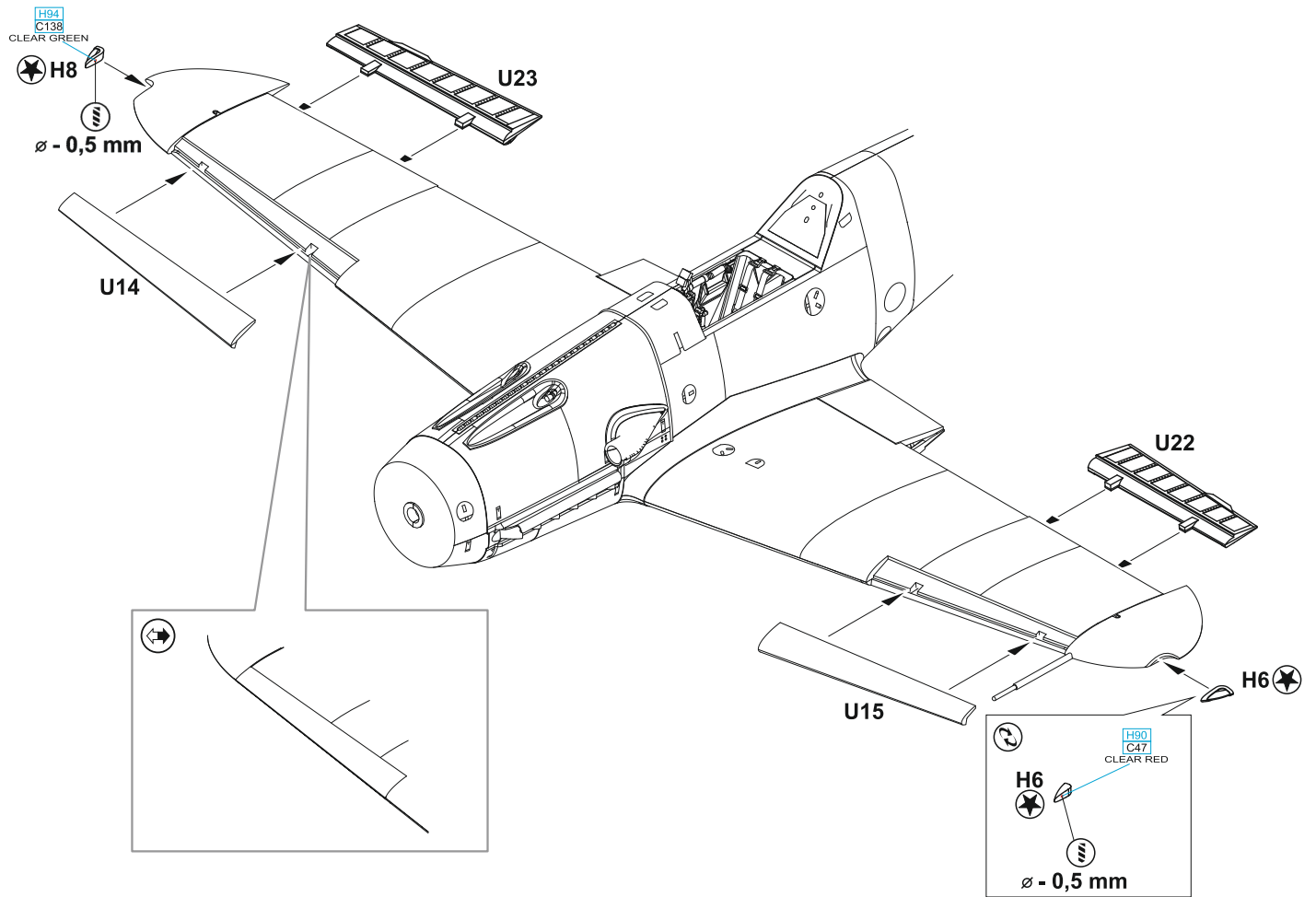

# OPEN

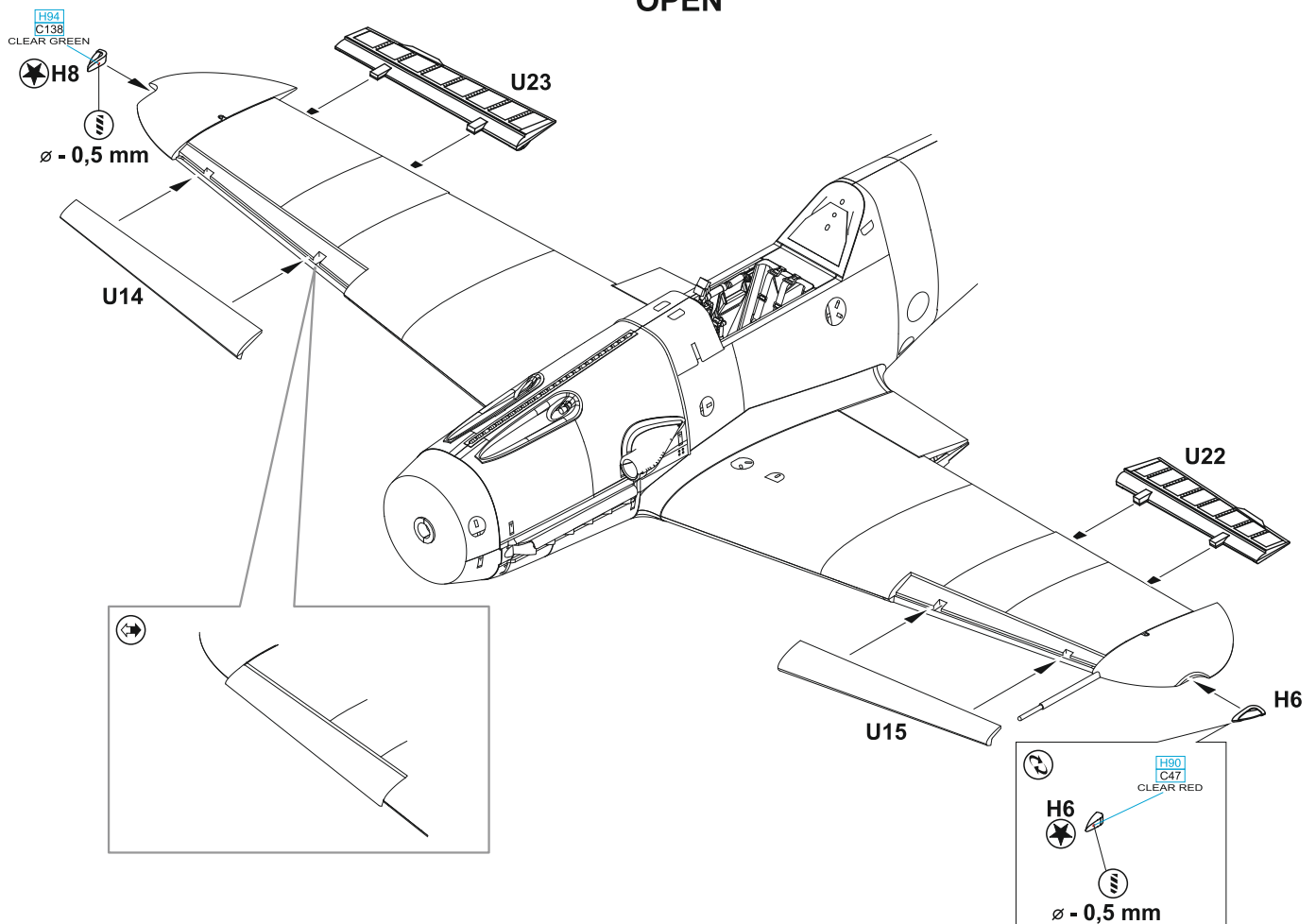

FRONT VIEW

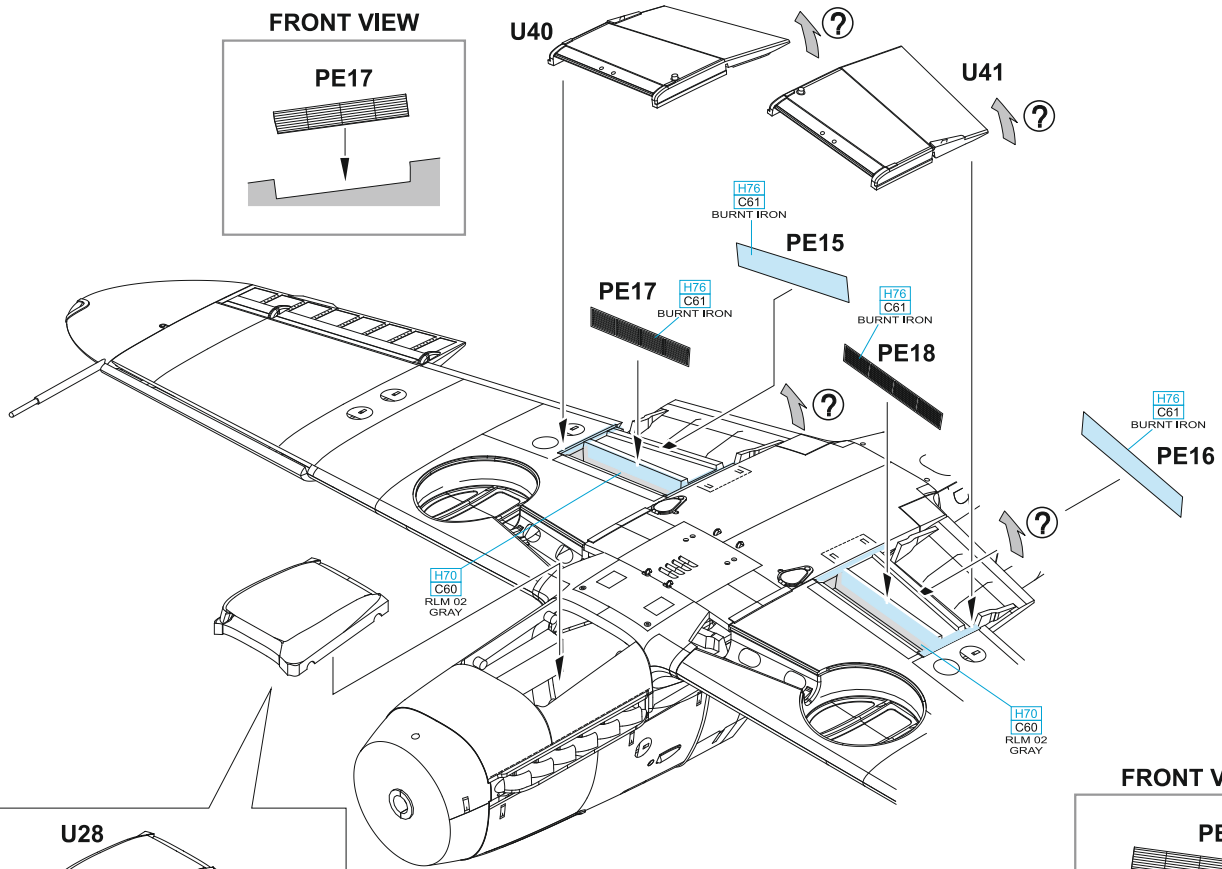
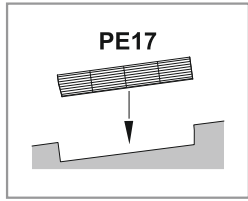

FRONT VIEW

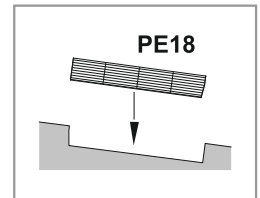

U28

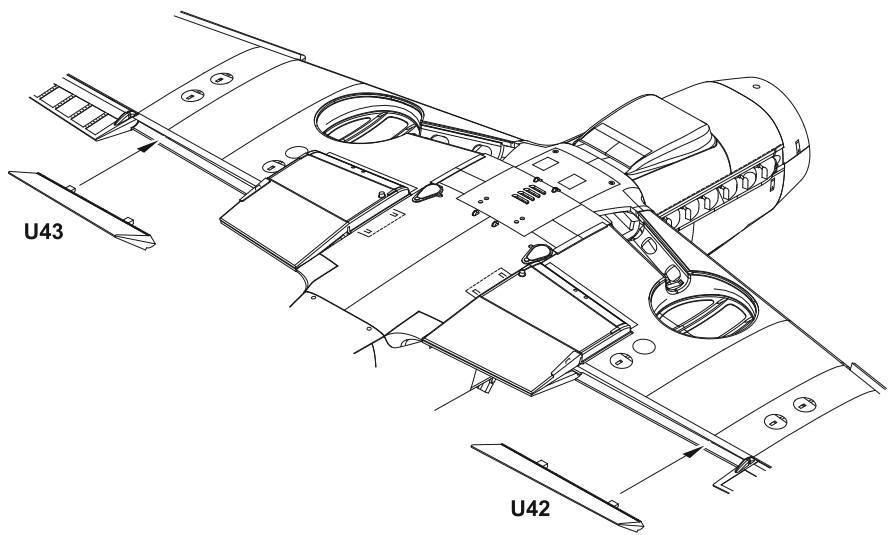
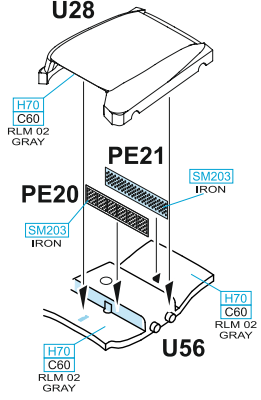

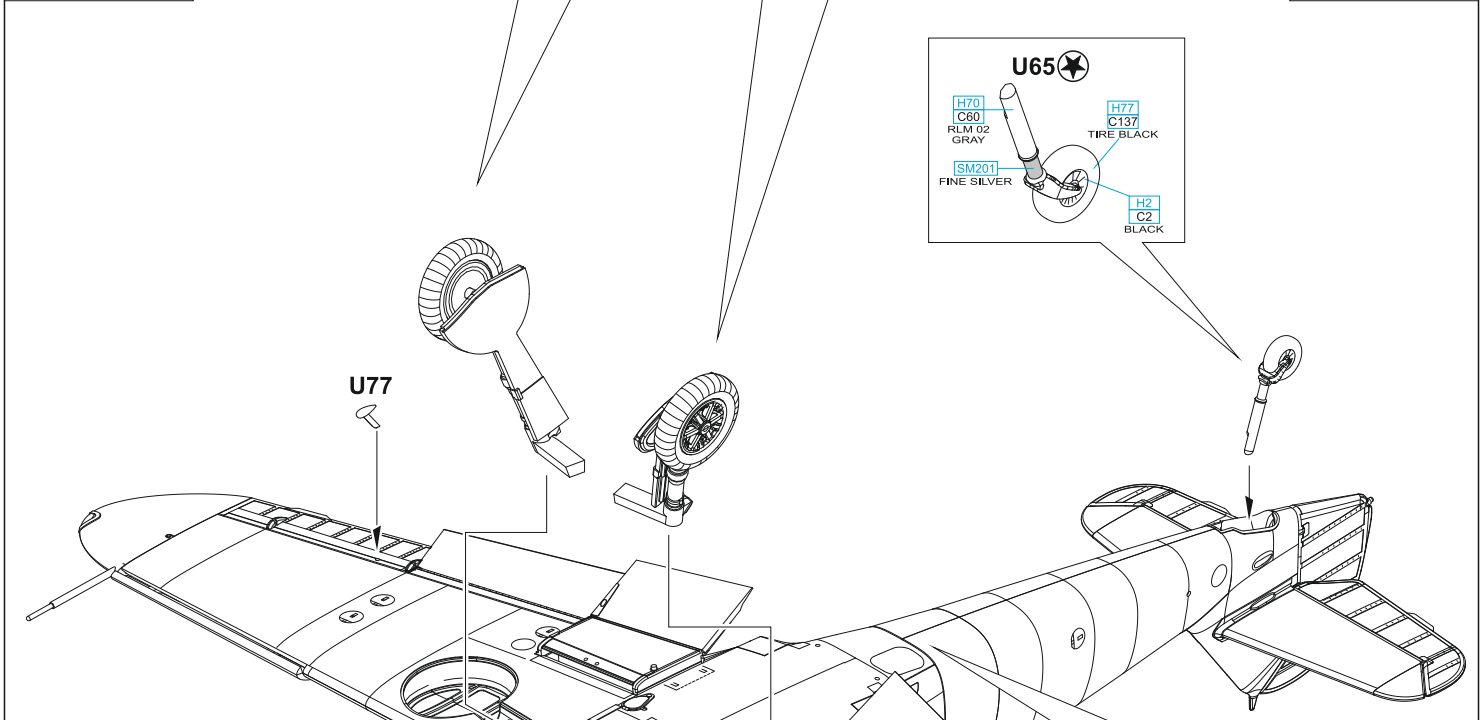
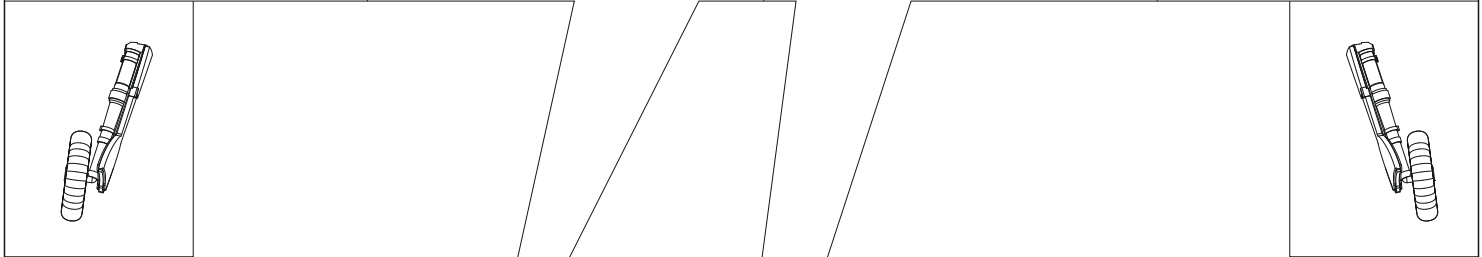
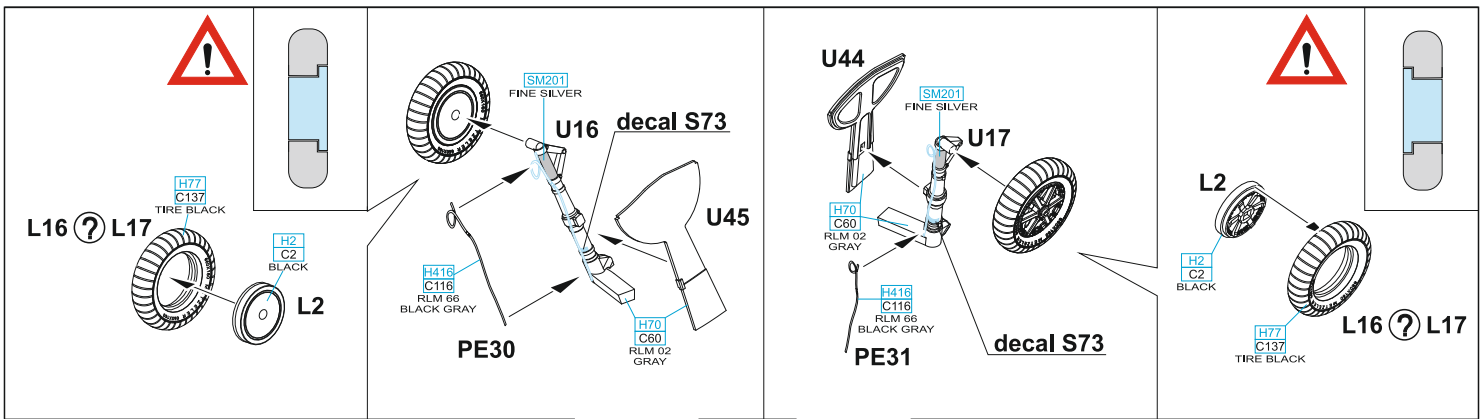

MARKINGS B, D ONLY

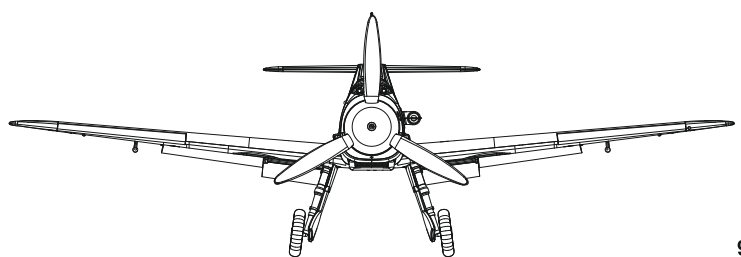
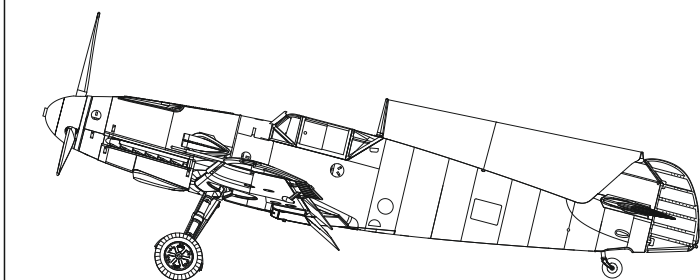
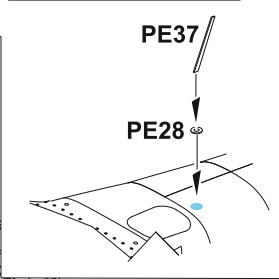

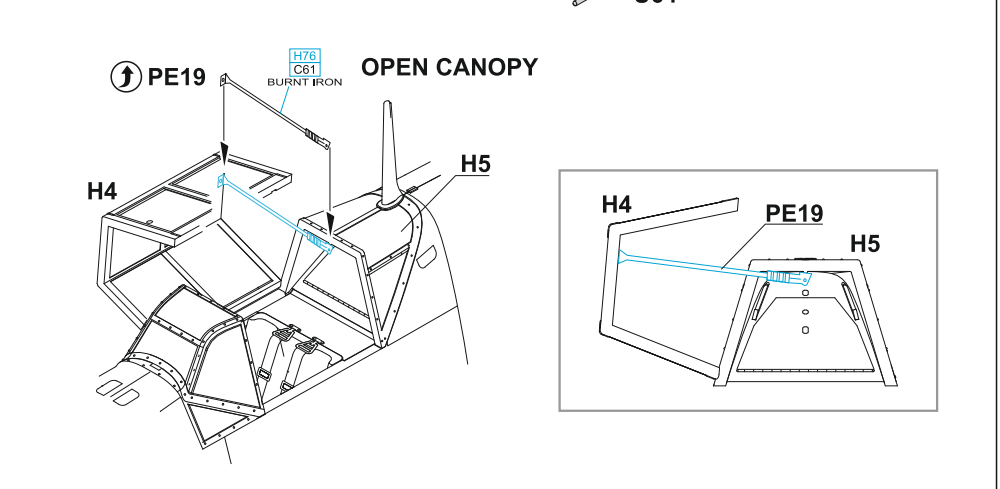
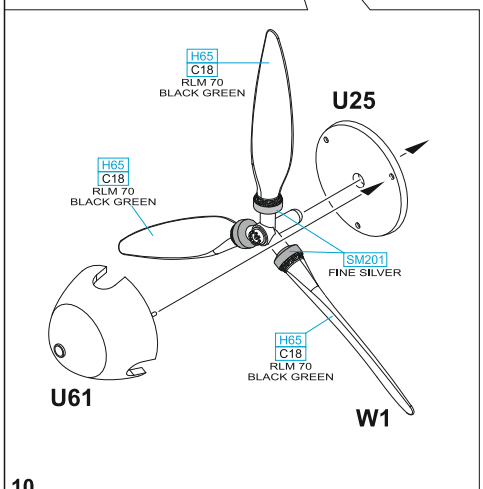
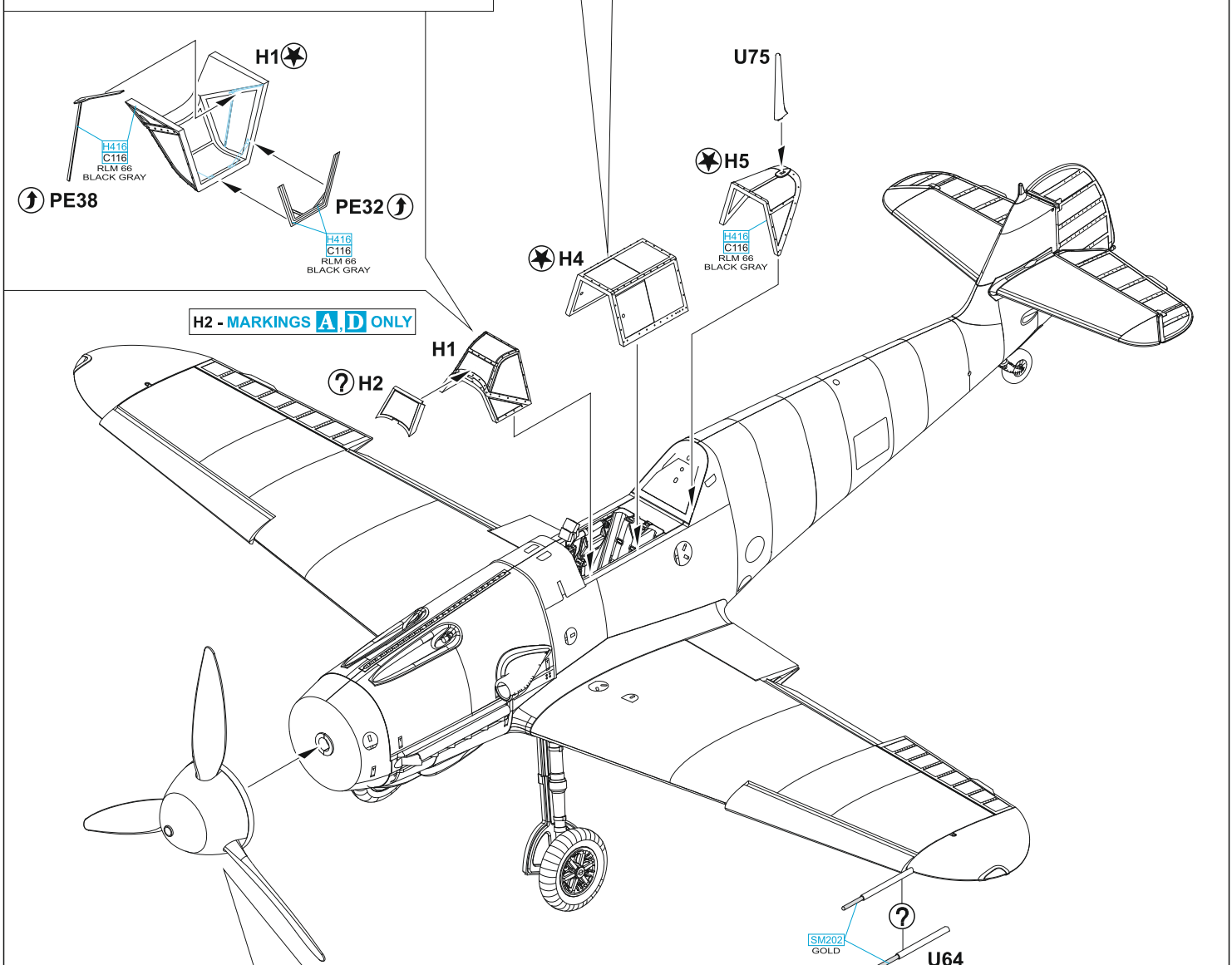
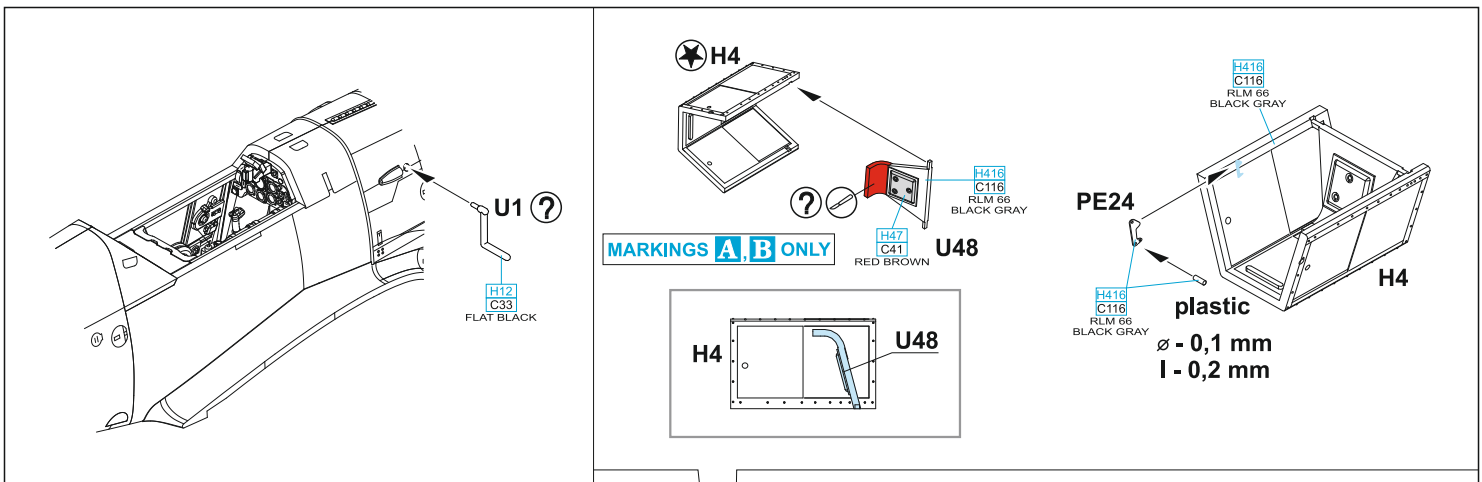

eduard  
MASK

2112

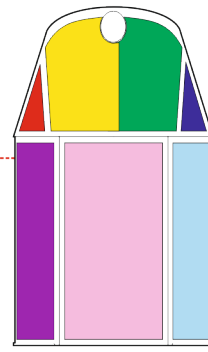
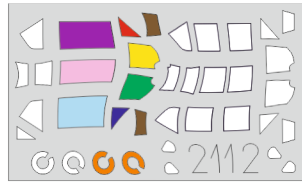
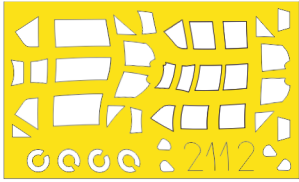

H5

H2



U65



H4

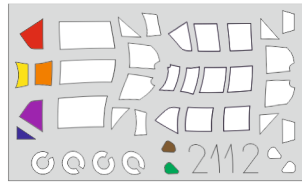

H1

H8



H6

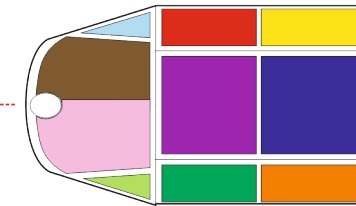
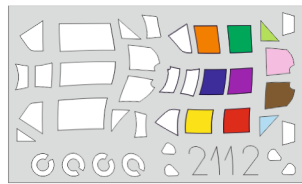

J9

J6

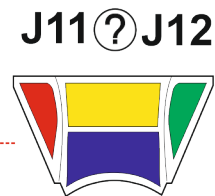

J11 ? J12

U65

U54

U6

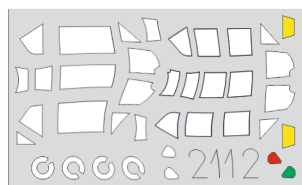
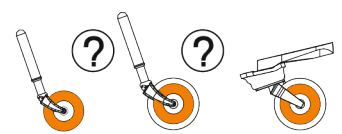

J20



J16



J18

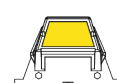

ATTENTION



UPOZORNĚNÍ



ACHTUNG



ATTENTION



注意



Carefully read instruction sheet before assembling. When you use glue or paint, do not use near open flame and use in well ventilated room. Keep out of reach of small children. Children must not be allowed to suck any part, or pull vinyl bag over the head.



Před započítím stavby si pečlivě prostudujte stavební návod. Při používání barev a lepidel pracujte v dobře větrané místnosti. Lepidla ani barvy nepoužívejte v blízkosti otevřeného ohně. Model není určen malým dětem, mohlo by dojít k požití drobných dílů.

INSTRUCTION SIGNS \* INSTR. SYMBOL \* INSTRUKTION SINNBILDEN \* SYMBOLES \* 記号の説明

OPTIONAL  
VOLBABEND  
OHNOUTSAND  
BROUSITOPEN HOLE  
VYVRTAT OTVORSYMETRICAL ASSEMBLY  
SYMETRICKÁ MONTÁŽREMOVE  
ODRÍZNOUTREVERSE SIDE  
OTOČITAPPLY EDUARD MASK  
AND PAINT  
POUŽÍT EDUARD MASK  
NABARVIT**PLEASE, CHECK THE LATEST VERSION OF THE INSTRUCTIONS ON [www.eduard.com](http://www.eduard.com)**

PARTS



DÍLY



TEILE



PIÈCES



部品

**Bf 109G-2/4**

## PLASTIC PARTS

M&gt;

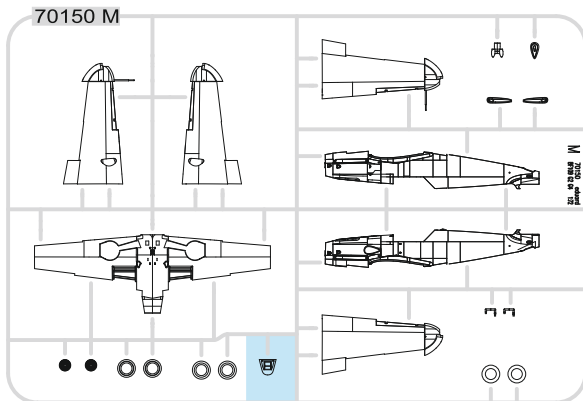

U&gt;

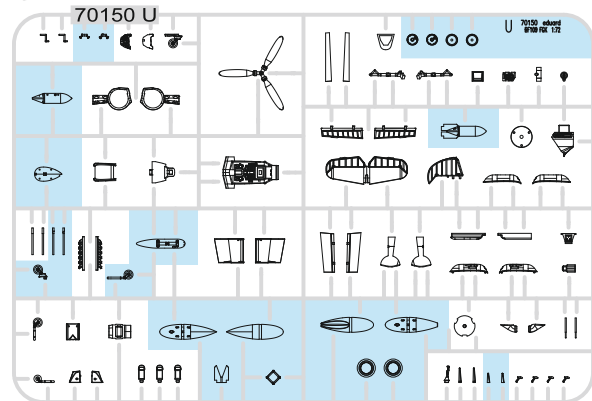

J&gt;

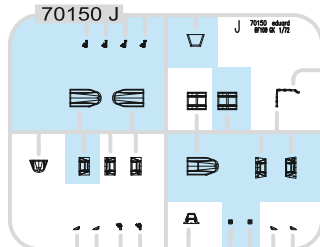
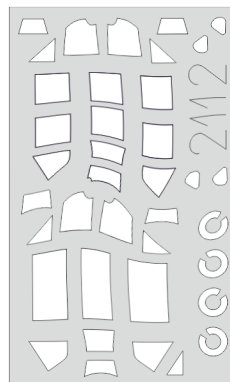
eduard  
MASK

## PE - PHOTO ETCHED DETAIL PARTS

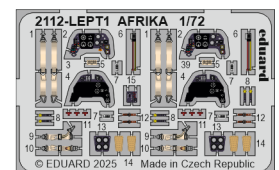
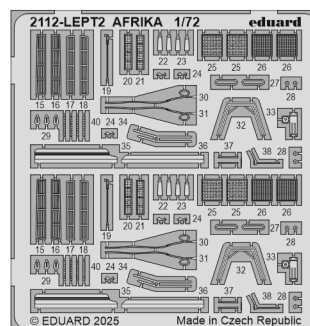

-Parts not for use. -Teile werden nicht verwendet. -Pièces à ne pas utiliser. -Tyto díly nepoužívejte při stavbě. - 使用しない部品

COLOURS



BARVY



FARBEN



PEINTURE



色

GSi Creos (GUNZE)		
AQUEOUS	Mr.COLOR	
H2	C2	BLACK
H11	C62	FLAT WHITE
H12	C33	FLAT BLACK
H47	C41	RED BROWN
H65	C18	RLM70 BLACK GREEN
H66	C119	RLM79 SAND YELLOW
H68	C36	RLM74 DARK GRAY
H69	C37	RLM75 GRAY
H70	C60	RLM02 GRAY
H76	C61	BURNT IRON
H77	C137	TIRE BLACK
H90	C47	CLEAR RED
H94	C138	CLEAR GREEN
H413	C113	RLM04 YELLOW

GSi Creos (GUNZE)		
AQUEOUS	Mr.COLOR	
H414	C114	RLM23 RED
H416	C116	RLM66 BLACK GRAY
H417	C117	RLM76 LIGHT BLUE
H418	C118	RLM78 LIGHT BLUE
H420	C120	RLM80 OLIVE GREEN
Mr.COLOR SUPER METALLIC		
	SM201	SUPER FINE SILVER
	SM202	SUPER GOLD
	SM203	SUPER IRON
	SM204	SUPER STAINLESS
Mr.COLOR GX		
	GX05	SUSIE BLUE

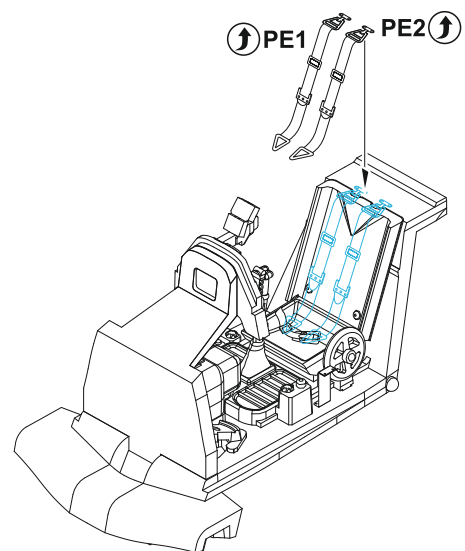
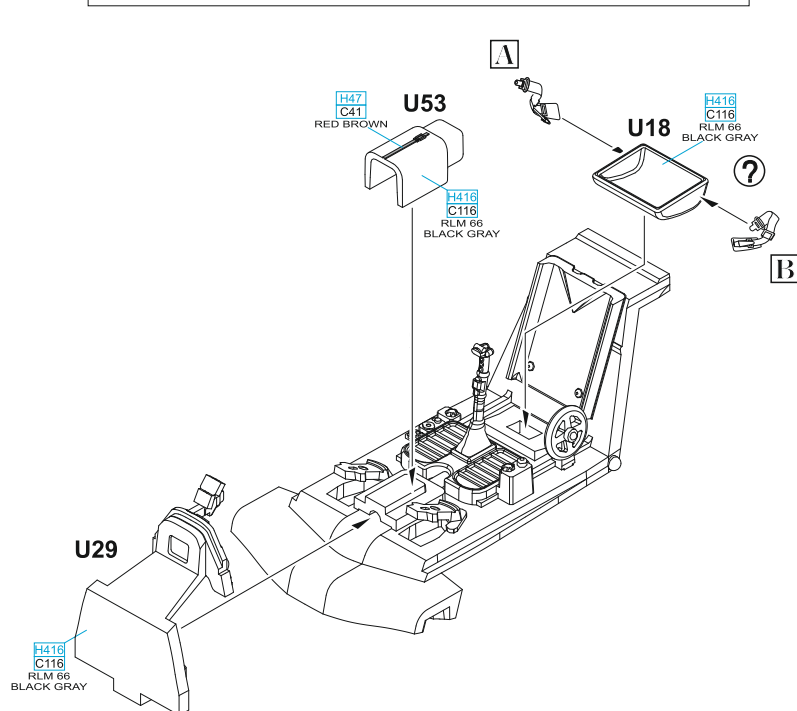
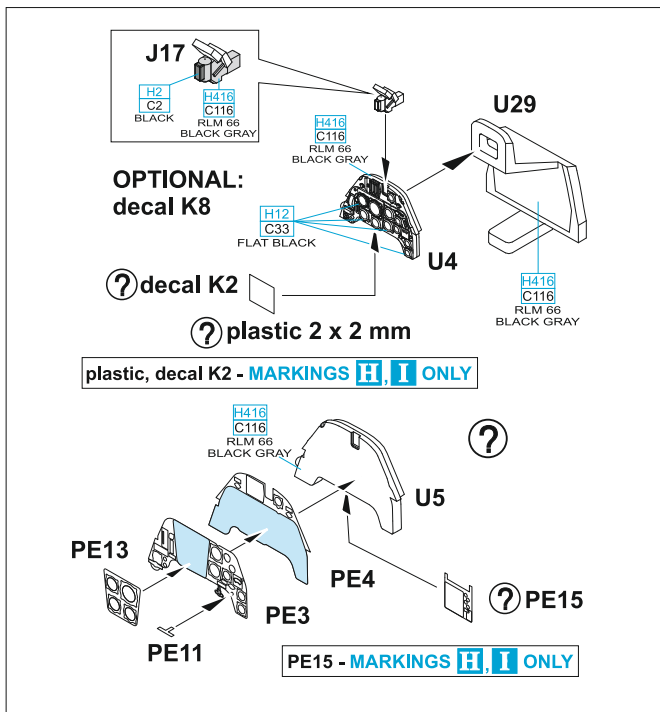
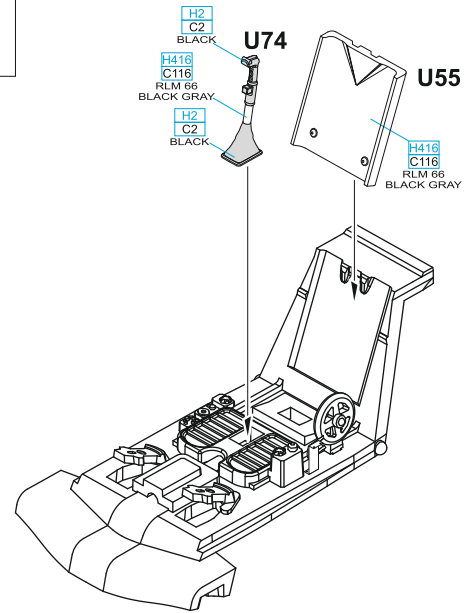
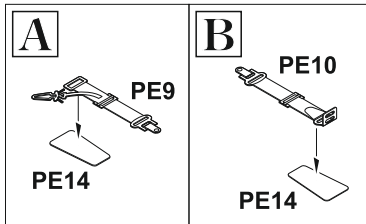
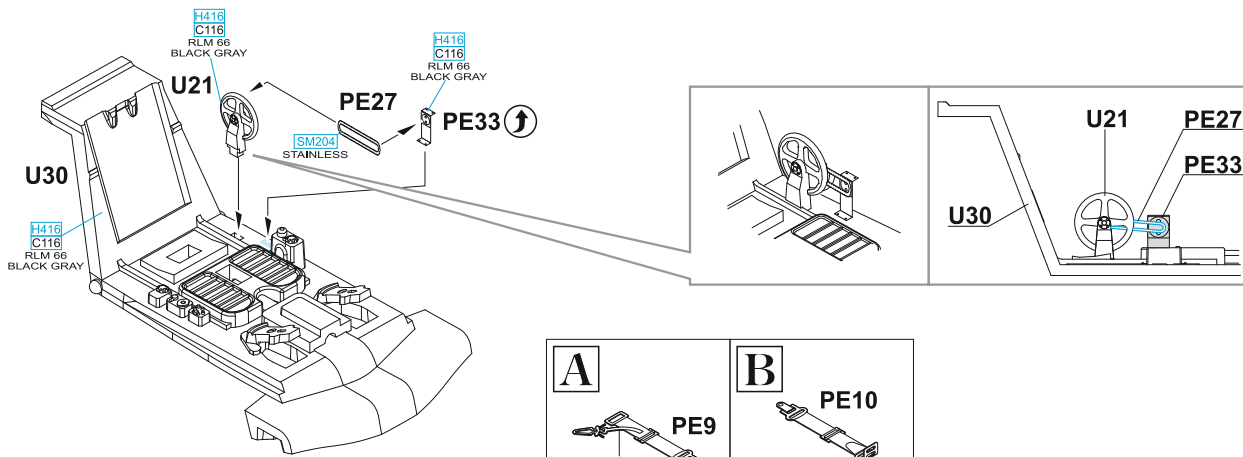

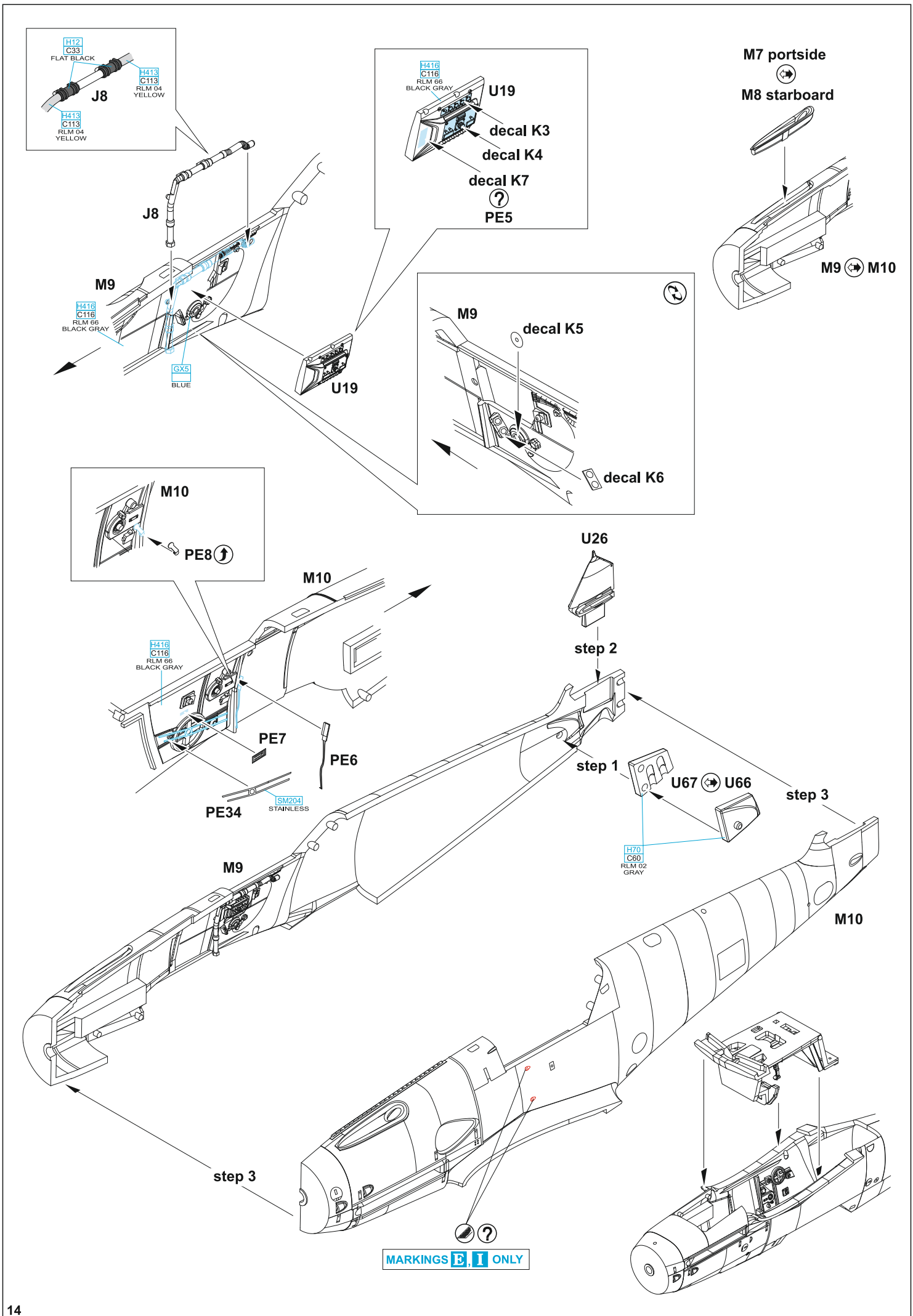

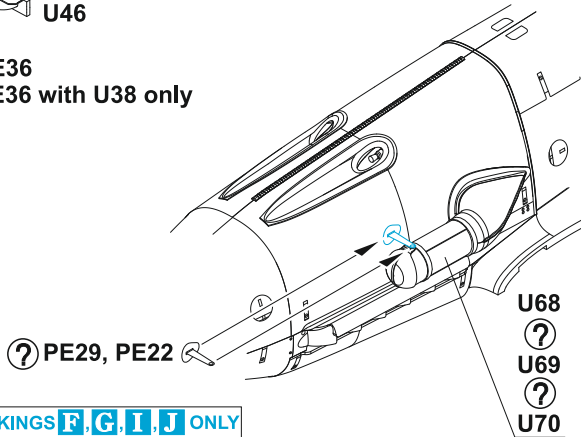
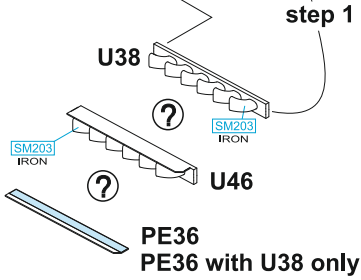
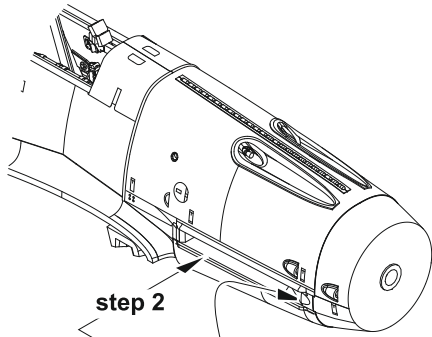
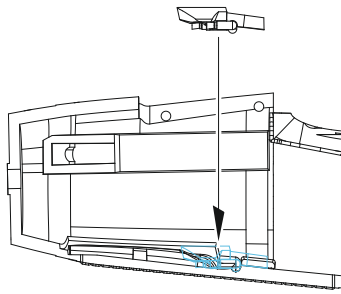
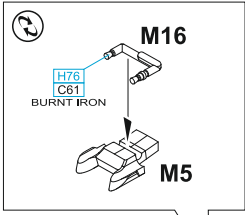

PE22, PE29 - MARKINGS F, G, I, J ONLY

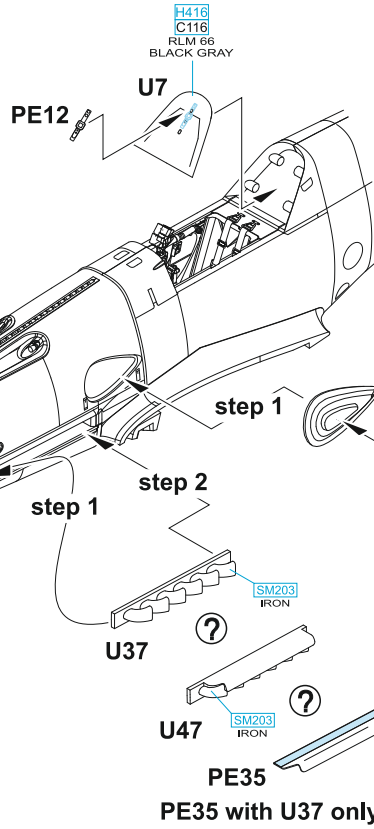

MARKINGS F, G, I, J ONLY

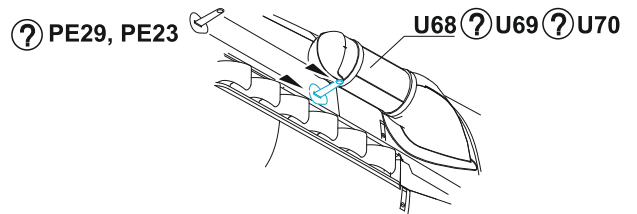
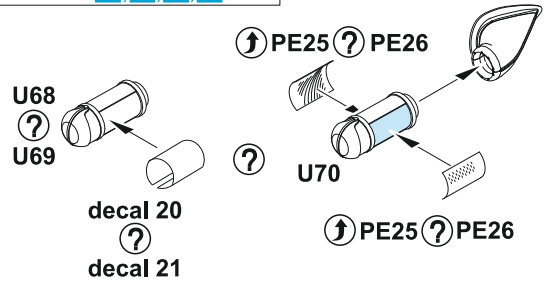

PE23, PE29 - MARKINGS F, G, I, J ONLY

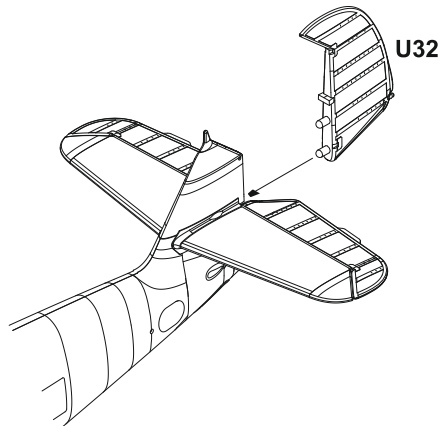
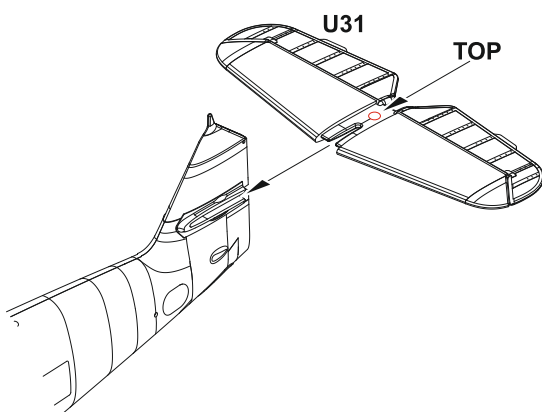

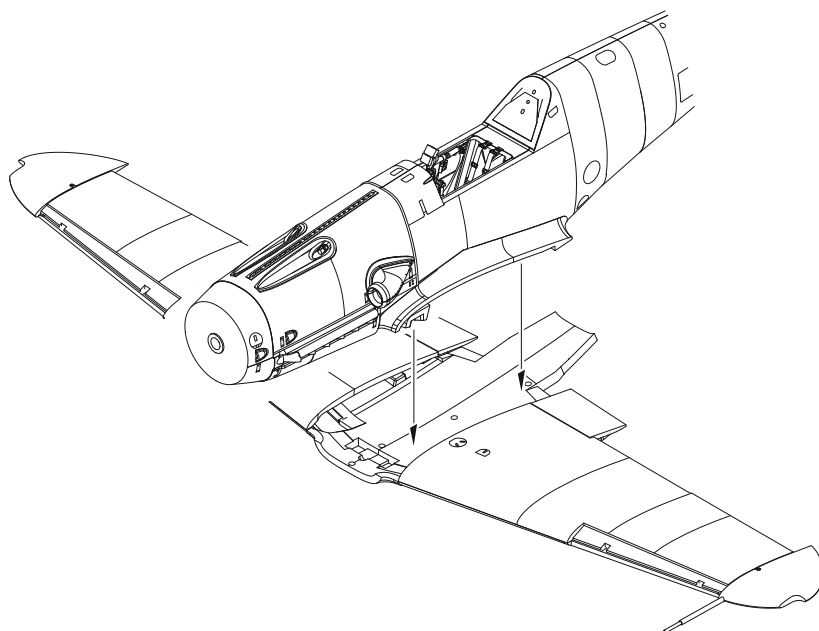
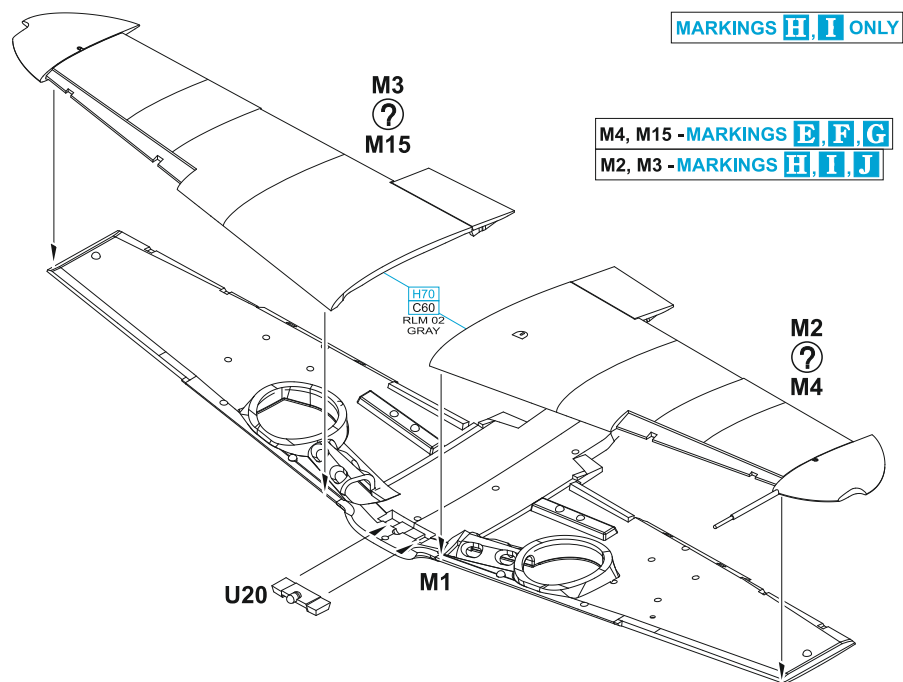
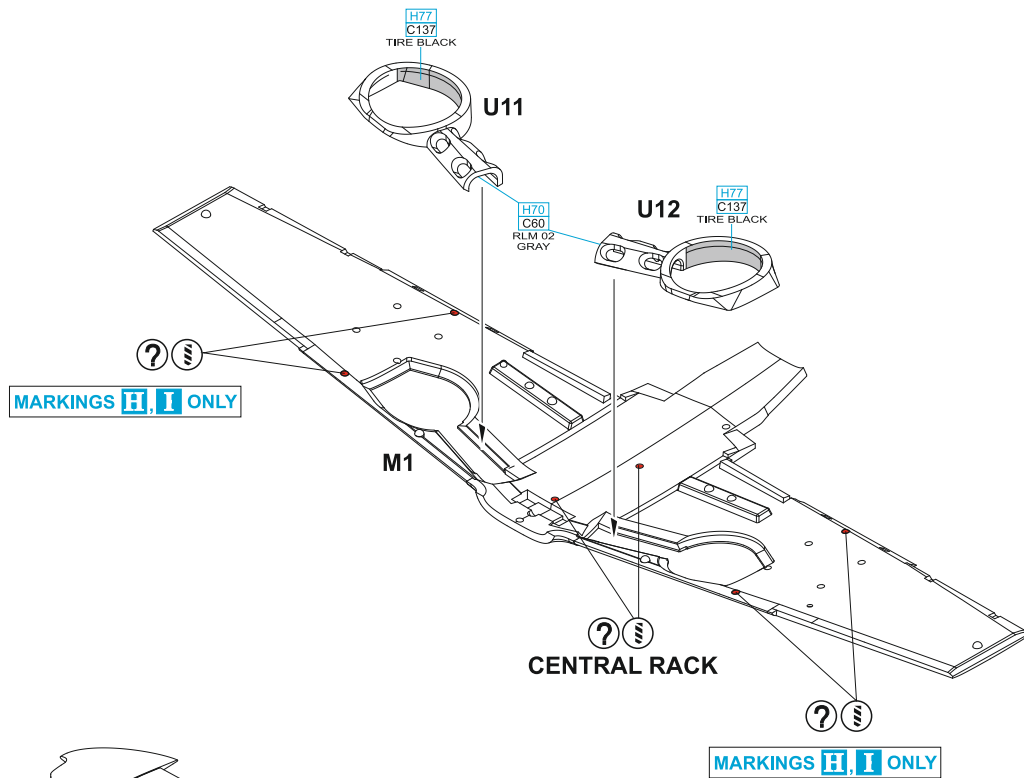

# CLOSED

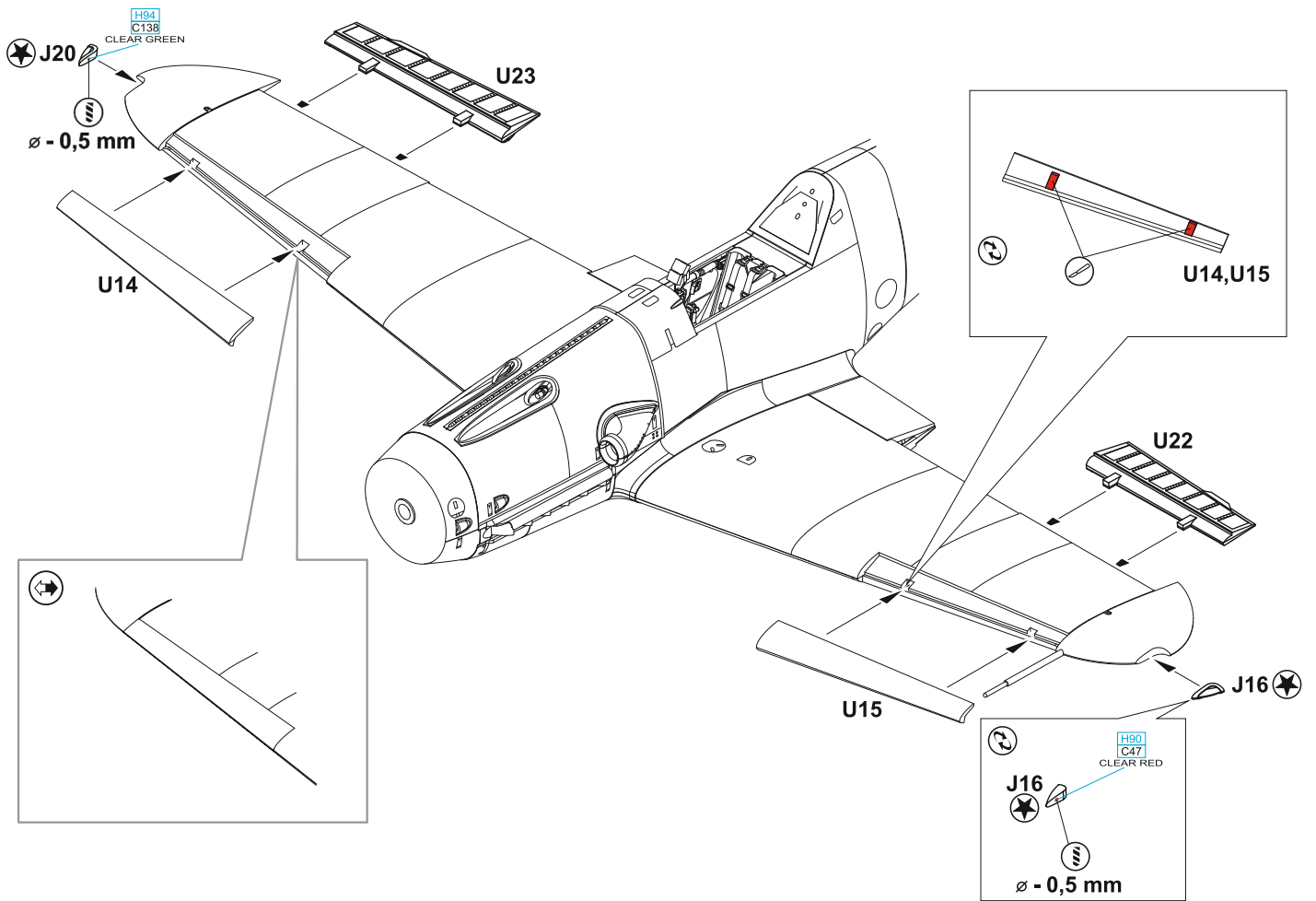

# OPEN

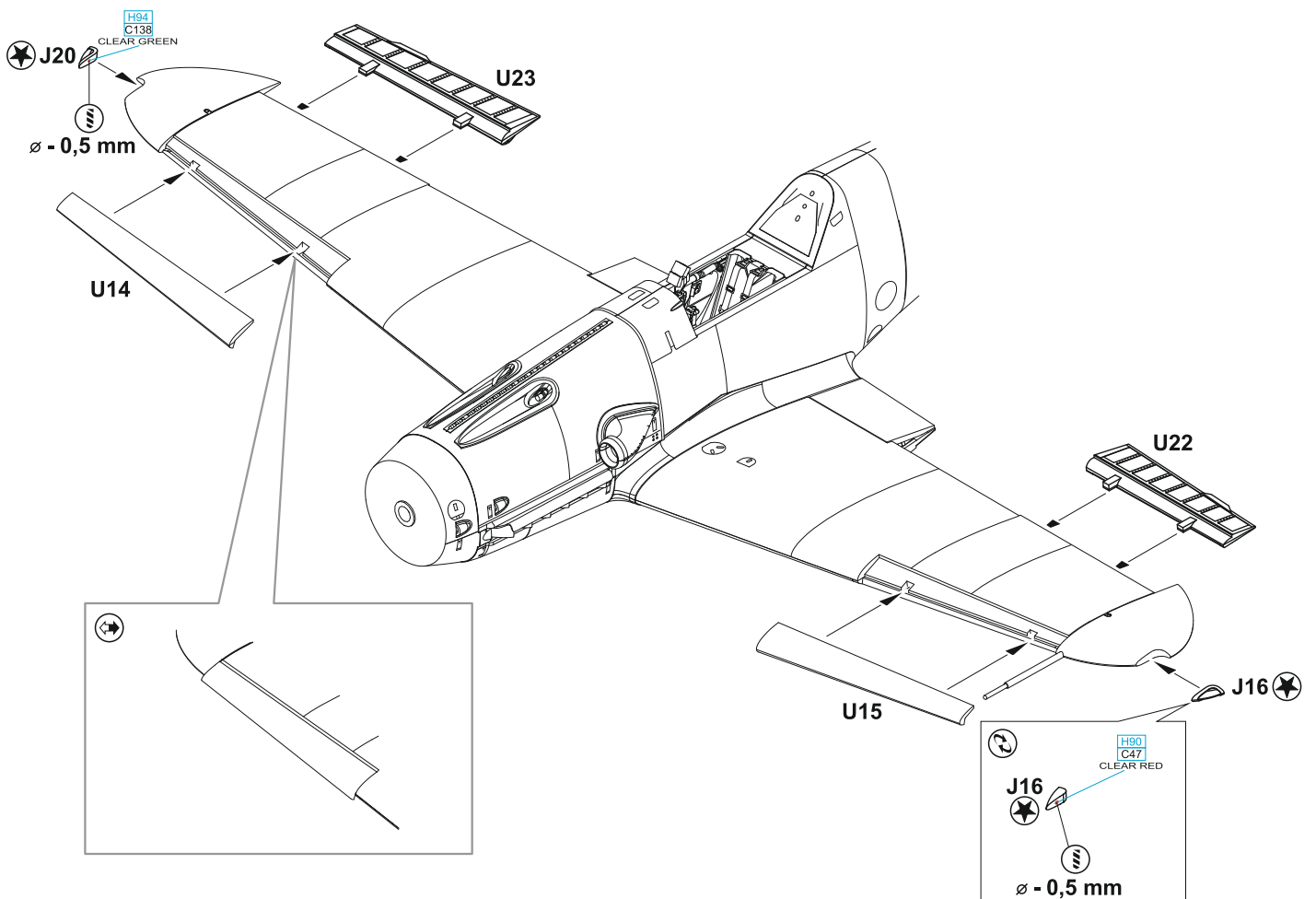

**FRONT VIEW**

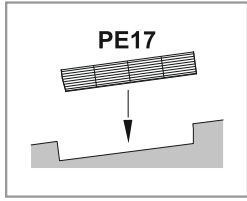

U40

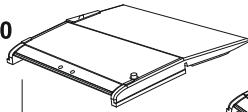

?

U41

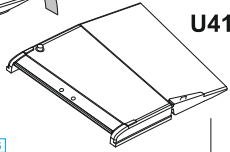

?

H76  
C61  
BURNT IRON

PE15

PE17

H76  
C61  
BURNT IRON

PE18

H76  
C61  
BURNT IRON

H76  
C61  
BURNT IRON

PE16

**FRONT VIEW**

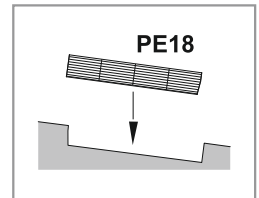

H70  
C60  
RLM 02  
GRAY

H70  
C60  
RLM 02  
GRAY

U28

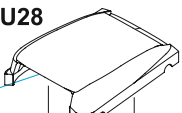

H70  
C60  
RLM 02  
GRAY

PE21

H76  
C61  
BURNT IRON

PE20

H76  
C61  
BURNT IRON

U56

H70  
C60  
RLM 02  
GRAY

U43

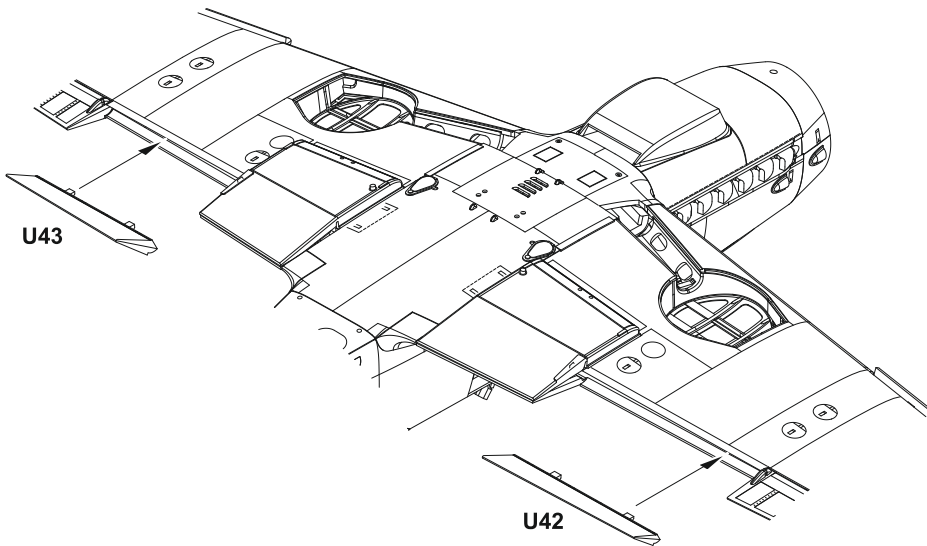

U42

MARKINGS **E, F, G** ONLY

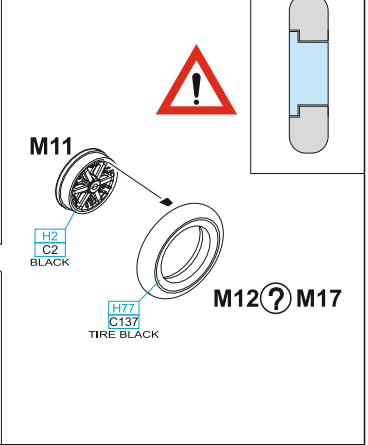
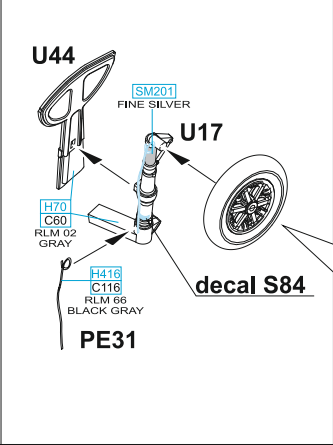
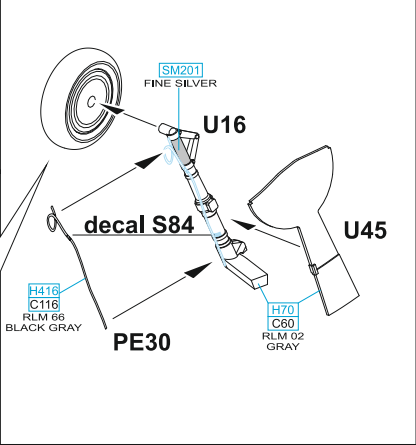
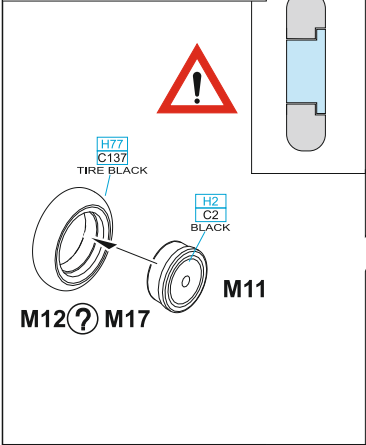

MARKINGS **H, I, J** ONLY

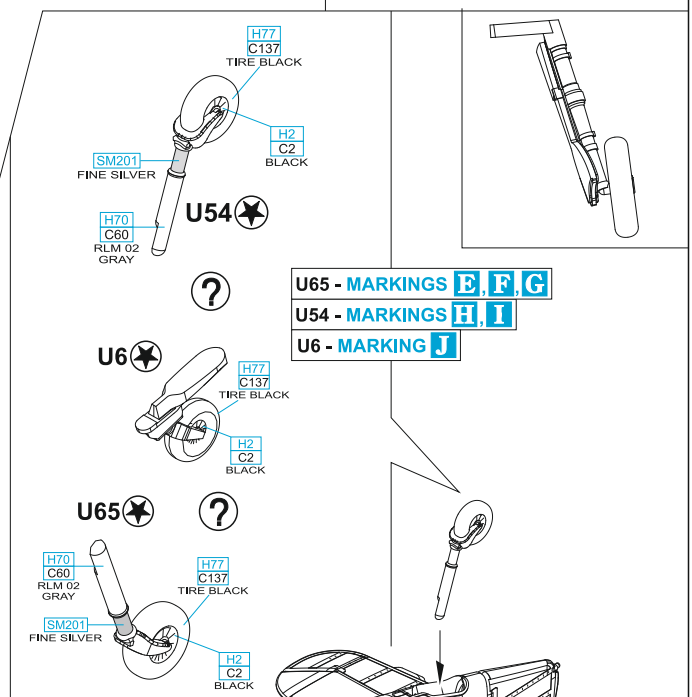
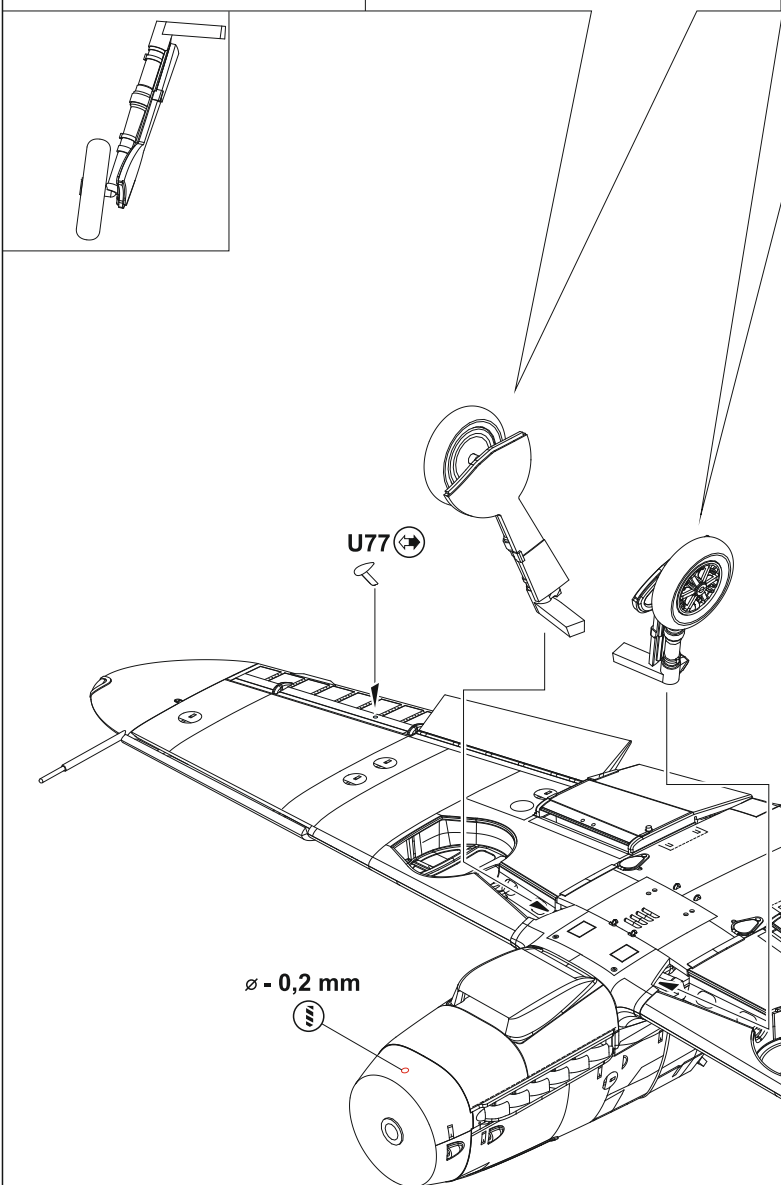
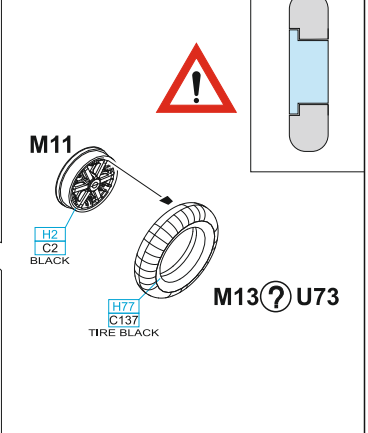
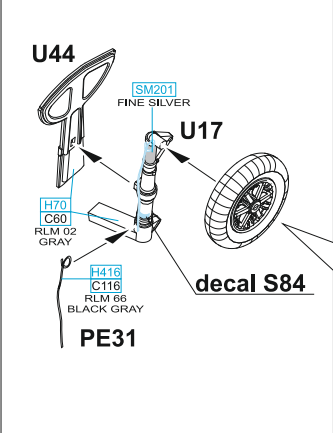
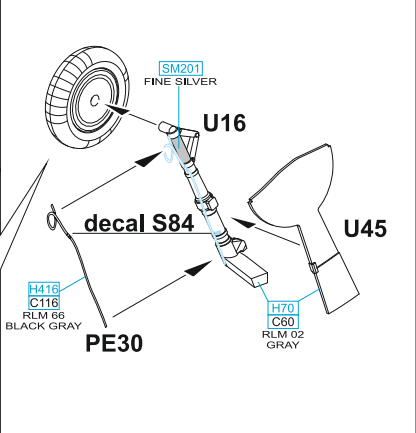
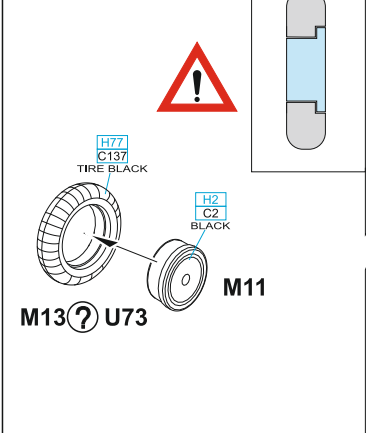

**MARKING E**

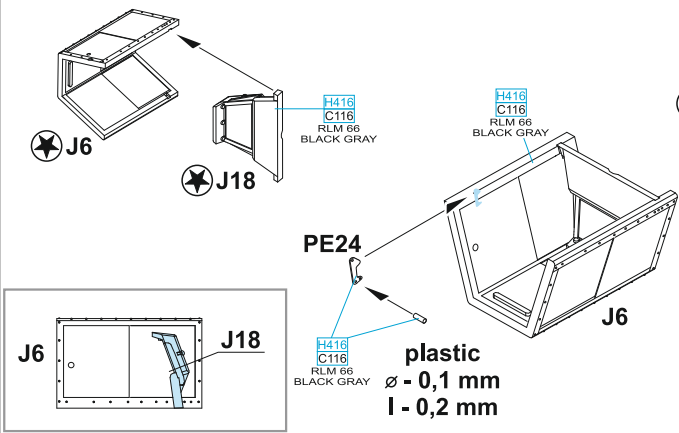

**MARKINGS F, G, H, I, J**

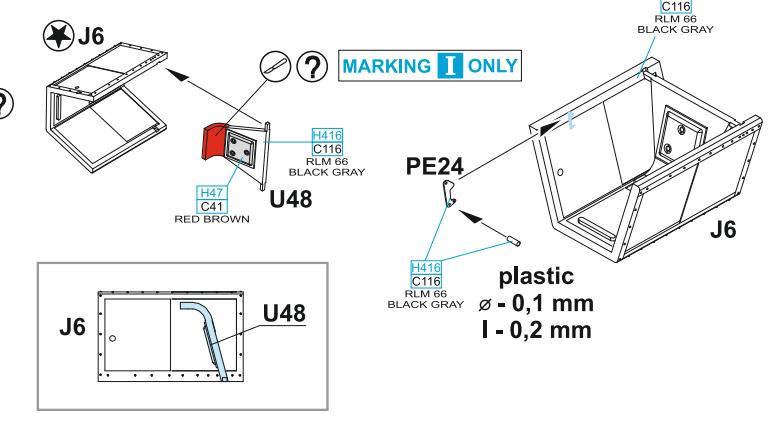

**J11 - MARKINGS F, G, H, I, J**

**J12 - MARKING E**

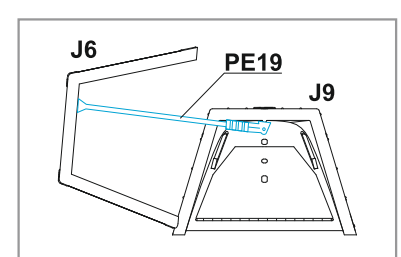
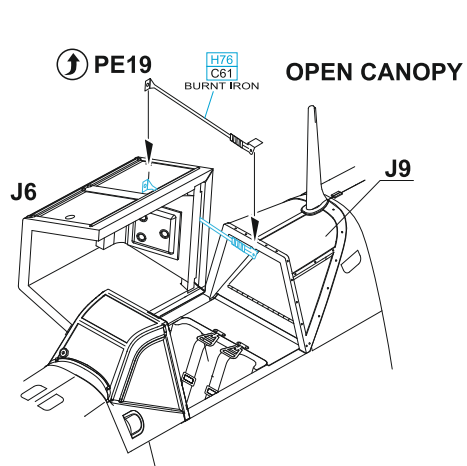
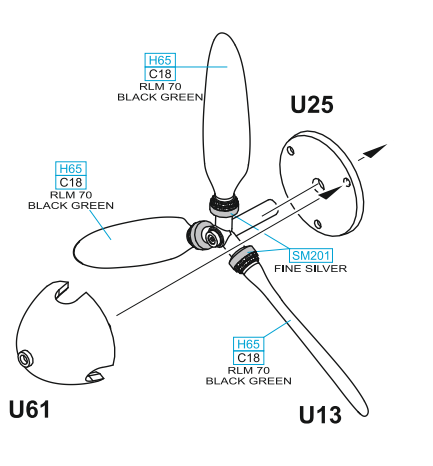
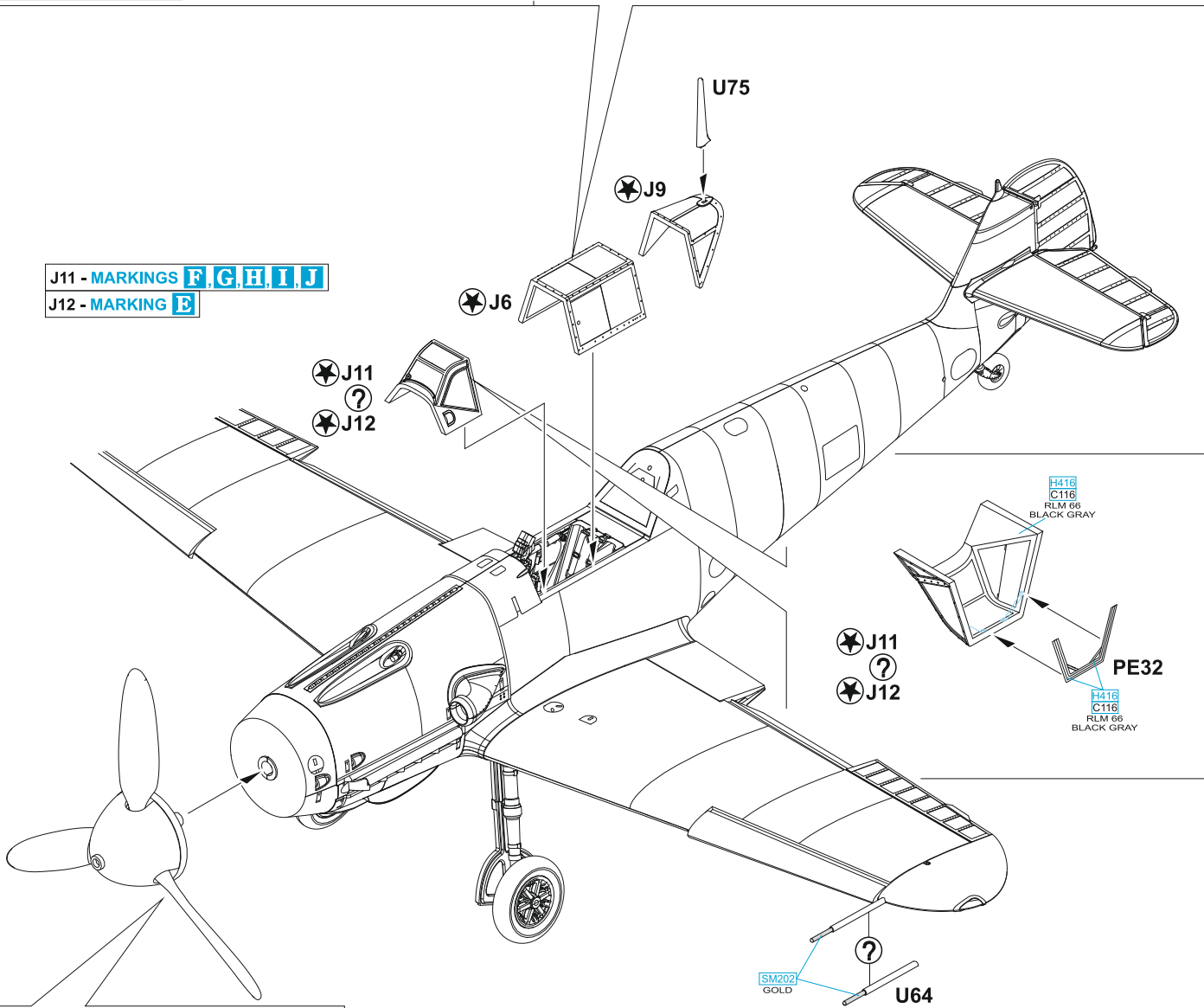

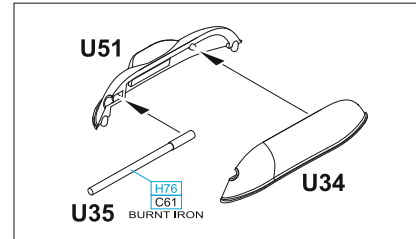
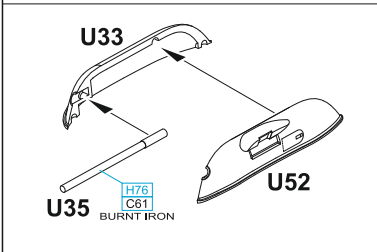
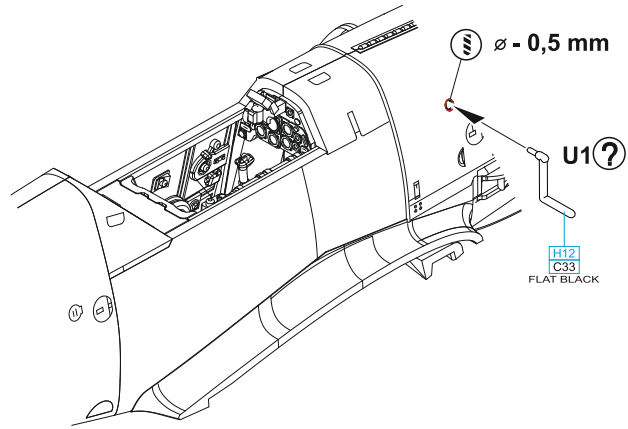

MARKINGS ONLY

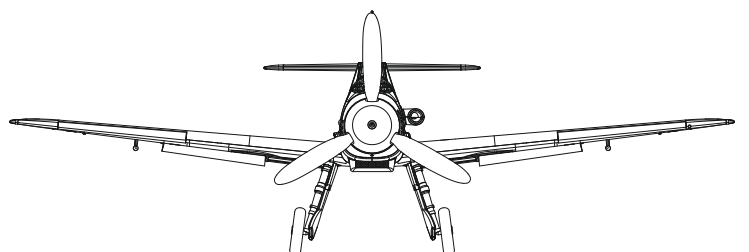
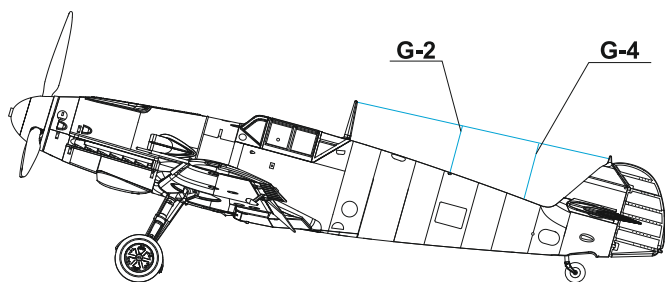
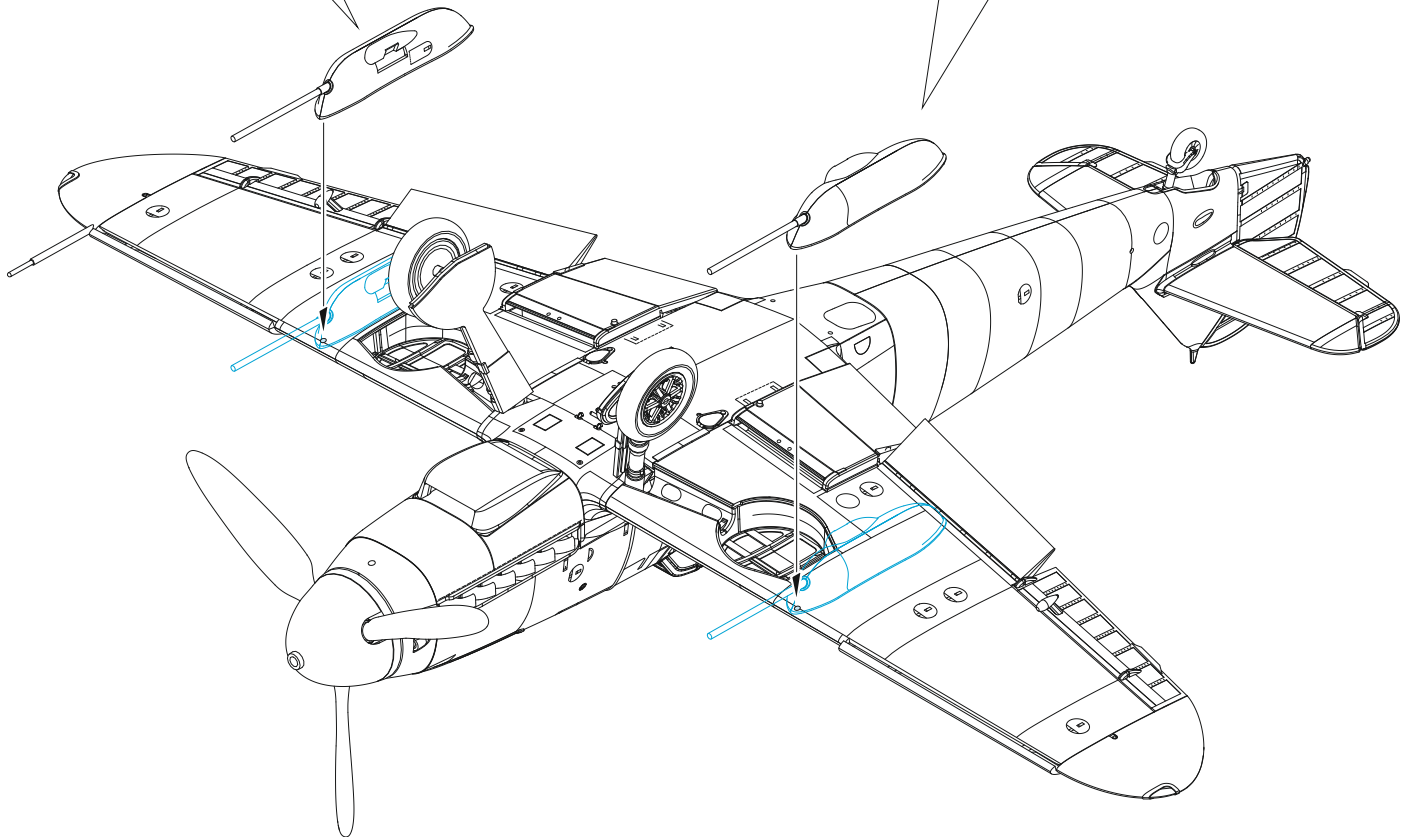

eduard  
MASK

2112

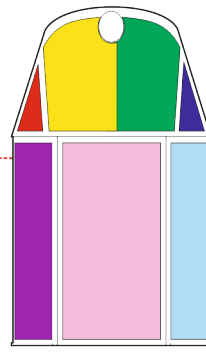
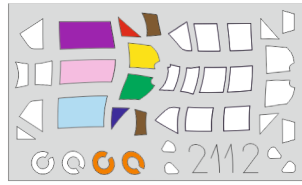
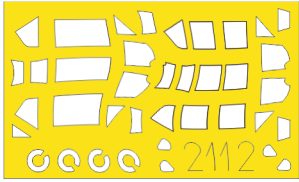

H5

H2



U65

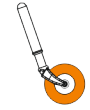

H4

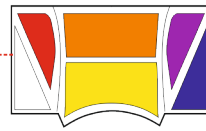
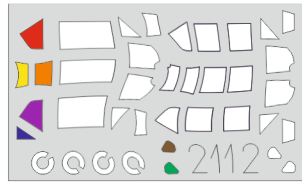

H1

H8



H6

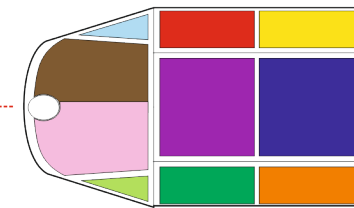
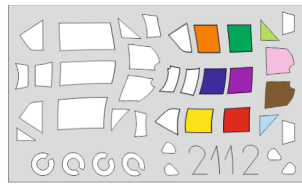

J9

J6

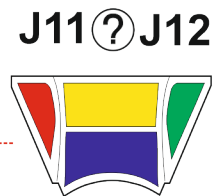

J11? J12

U65

U54

U6

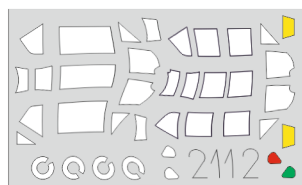
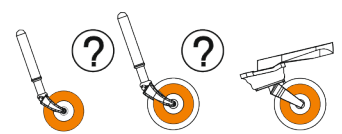

J20



J16



J18

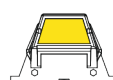



# B Bf 109F-4/Trop, W.Nr. 8693, Lt. Hans-Joachim Marseille, 3./JG 27, Martuba, Libya, February 1942

This aircraft was flown by Lt. Hans-Joachim Marseille, a fighter ace with 158 kills to his credit. Marseille was awarded the Knight's Cross with Swords, Oak Leaves and Diamonds as the recognition of his remarkable success. He kept a rapid rate of enemy aircraft shot down with many multiple victories combat sorties. The German propaganda used it to make Marseille a war-hero star. The tale ended with Marseille's death. He was killed in a bailing accident on September 30, 1942. The camouflage of his aircraft consisted of RLM 79 Sandgelb on the upper surfaces and RLM 78 Himmelblau on the lower ones. The rudder was adorned with fifty kill marks (Abschussmarken) and appears to be oversprayed with a red-brown primer. Marseille achieved his 49<sup>th</sup> and 50<sup>th</sup> kills on February 21, 1942. His victims were two Kittyhawks. The white-painted wingtips and fuselage band were Luftwaffe markings used on the aircraft flown in the Mediterranean theatre.

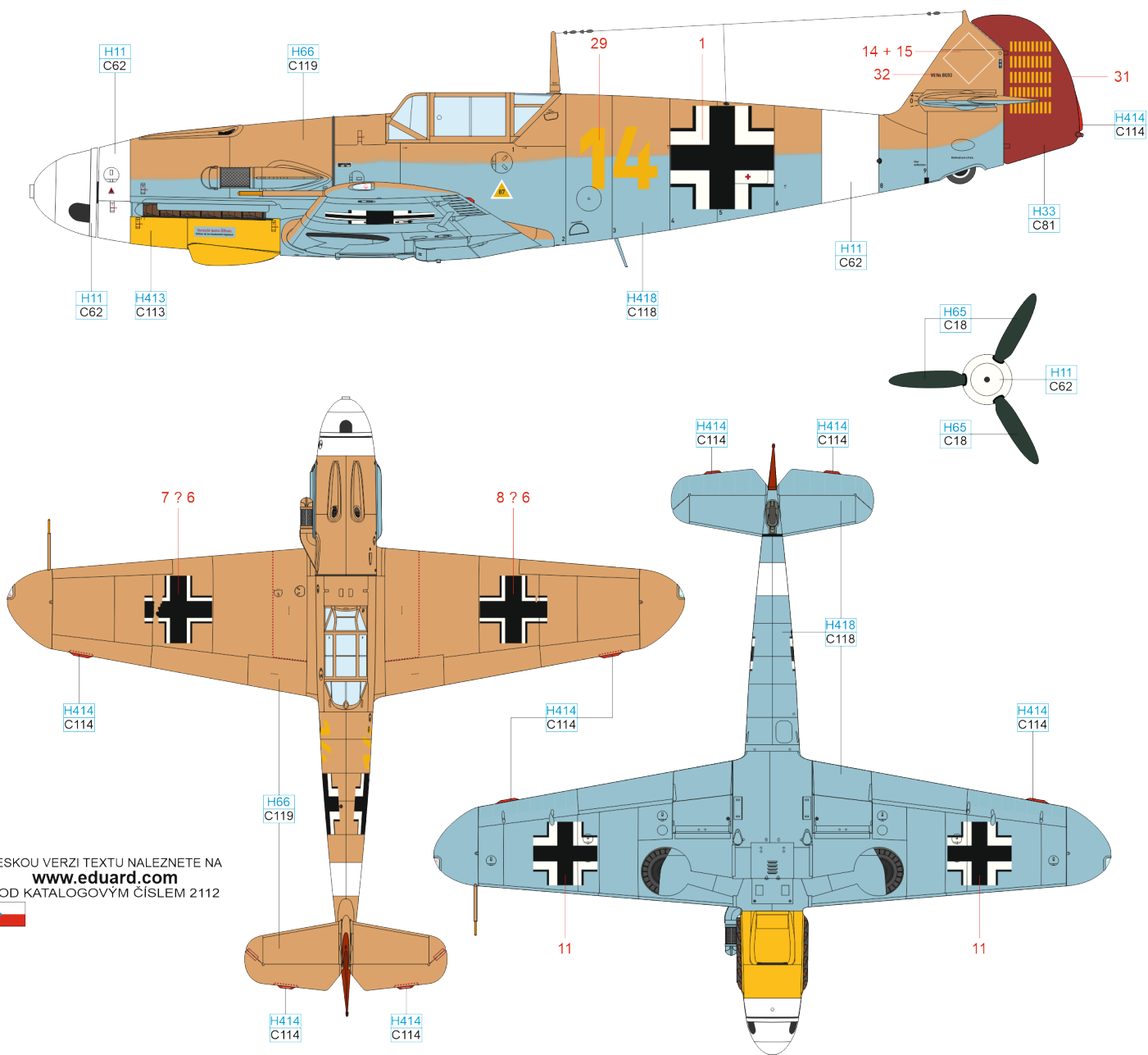

ČESKOU VERZI TEXTU NALEZNETE NA  
[www.eduard.com](http://www.eduard.com)  
 POD KATALOGOVÝM ČÍSLEM 2112



FLAT WHITE	H11 C62	RLM 04	H413 C113	RLM 23	H414 C114	RLM 70	H65 C18	RLM 78	H418 C118	RLM 79	H66 C119	RED	H33 C81
------------	---------	--------	-----------	--------	-----------	--------	---------	--------	-----------	--------	----------	-----	---------

# C Bf 109F-4/Trop, Obfw. Karl-Heinz Bendert, Stab II./JG 27, Derna, Libya, December 1941

Karl-Heinz Bendert was born on September 9, 1914, in Schwiebus, Brandenburg, now western Poland. He joined the Luftwaffe in 1937. After completing his fighter pilot training in 1940, he was assigned to 4./JG 27. He achieved his first kill on May 12, 1940, north of Rotterdam and scored six kills in the Battle of Britain. The II. Gruppe also operated in the campaign to Greece and was briefly deployed to the USSR. On July 24, 1941, it was withdrawn to Döberitz and rearmed with Bf 109F-4. The unit was subsequently sent to North Africa in September 1941, at the Ain el Gazala airfield. Here Bendert became involved with several other pilots in falsely inflating kills in combat reports. In September 1942, however, he achieved his 40<sup>th</sup> kill. In November 1942, he was transferred to a training unit at Salon-de-Provence as an instructor for combat against USAAF bombers. On December 1, 1943, he was appointed Staffelkapitän of 5./JG 27. By the end of the war, he was fighting in the defense of the Reich against USAAF pilots. He survived the war with a total of 50 kills. He died on July 16, 1983, in Oldenburg.

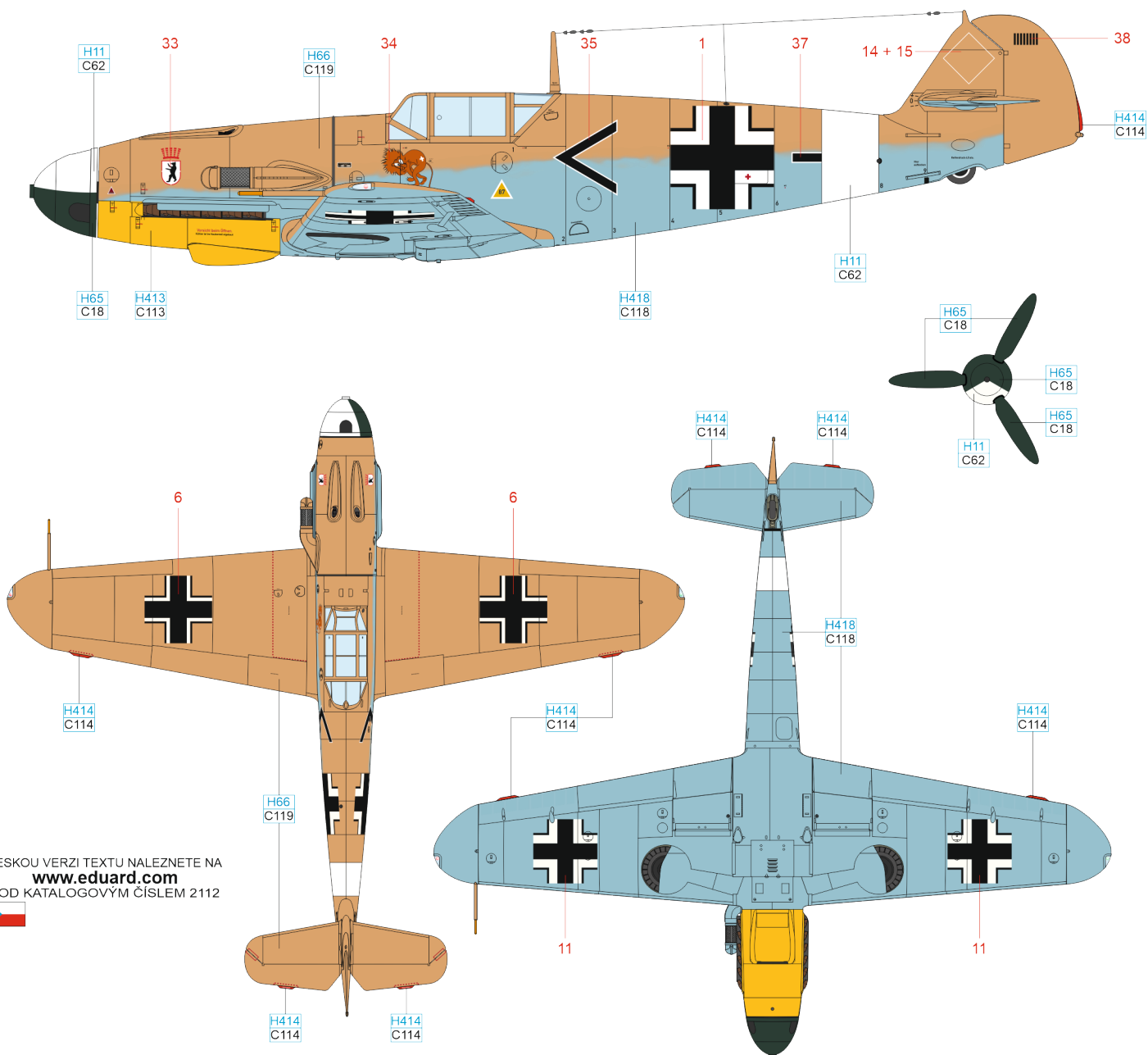

ČESKOU VERZI TEXTU NALEZNETE NA  
[www.eduard.com](http://www.eduard.com)  
 POD KATALOGOVÝM ČÍSLEM 2112



FLAT WHITE	H11 C62	RLM 04	H413 C113	RLM 23	H414 C114	RLM 70	H65 C18	RLM 78	H418 C118	RLM 79	H66 C119
------------	---------	--------	-----------	--------	-----------	--------	---------	--------	-----------	--------	----------

# D Bf 109F-4/Trop, W.Nr. 8596, Obfw. Erwin Sawallisch, 4./JG 27, Martuba, Libya, August 1942

Erwin Sawallisch participated in Spanish Civil War where he shot down three Republican aircraft. At the beginning of World War II, he was member of the Jagdgeschwader 77 but was transferred to JG 27 mid 1941. Firstly he flew as a staff pilot within the unit and then he was transferred to 4./JG 27, where he was taken for an expert, along with Ofw. Bendert, Ofw. Stiegler and Oblt. Vögl ("die Experten"). These four pilots supposedly achieved a large number of aerial victories during the course of August, though their achievements are debatable at least, and there were objections coming from pilots of other Staffeln (squadrons). The commander of the II. Gruppe (4./JG 27 belonged to this Gruppe) then transferred these four pilots to several different Staffeln. On August 19, 1942, the aircraft of Ofw. Sawallisch did not return from a test flight above the Mediterranean... This aircraft had the entire sides up to the lower edge of the fuselage sprayed with RLM 79. The lower surfaces were camouflaged with RLM 78. The camouflage was complemented by the markings of the aircraft from the Southern Front – white wingtips, white spinner and a same color band on the aft fuselage. The engine cowling bore the II. Gruppe JG 27 emblem on both sides.

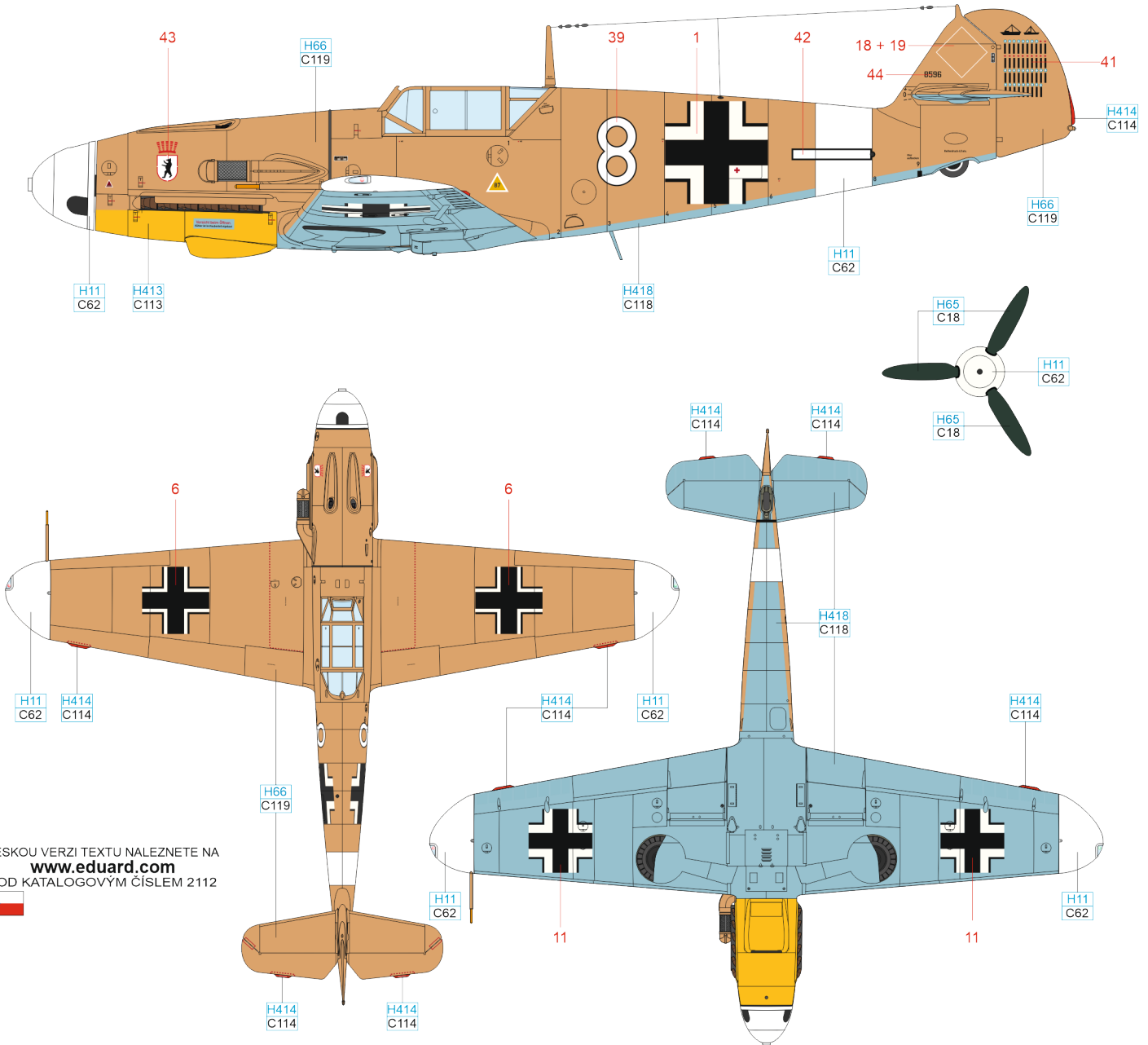

ČESKOU VERZI TEXTU NALEZNETE NA  
[www.eduard.com](http://www.eduard.com)  
 POD KATALOGOVÝM ČÍSLEM 2112



FLAT WHITE	H11 C62	RLM 04	H413 C113	RLM 23	H414 C114	RLM 70	H65 C18	RLM 78	H418 C118	RLM 79	H66 C119
------------	---------	--------	-----------	--------	-----------	--------	---------	--------	-----------	--------	----------









# Bf 109G-4/R6/Trop, Obfw. Stephan Litjens, 4./JG 53, La Marsa, Tunisia, April 1943

Stephan "Steff" Litjens was born on October 13, 1913, in Hasselt-Kleve. In August 1937 he completed his fighter pilot training and joined 4./JG 53 in October 1939. He scored two kills during the French campaign and four more in the Battle of Britain. On the Eastern Front he managed to achieve five kills in one day on August 25, 1941. On September 11, 1941, he was forced to bail out after a dogfight with VVS fighters. Although he achieved his 23<sup>rd</sup> kill during this engagement, he suffered a serious injury to his right eye, which he eventually lost. Despite this, he returned to 4./JG 53 in October 1942, the unit was then stationed in Italy and flew missions over Malta. In November 1942, 4./JG 53 moved to Tunisia, where Litjens scored eight victories over Allied pilots by April 1943. He then went on a long leave and did not return to flying with 4./JG 53 until November. At the time, the unit was a part of the defense of the Reich system. On March 23, 1944, Litjens shot down two B-17s but was himself hit by return fire and made an emergency landing. He was wounded in his left eye, which meant the end of flying for him. He flew a total of 444 combat sorties and scored 38 kills, 17 in the east and 21 in the west. In five cases, his victims were four-engine bombers. Stephan Litjens died on February 25, 2002, in Kalkar-Hasselt.

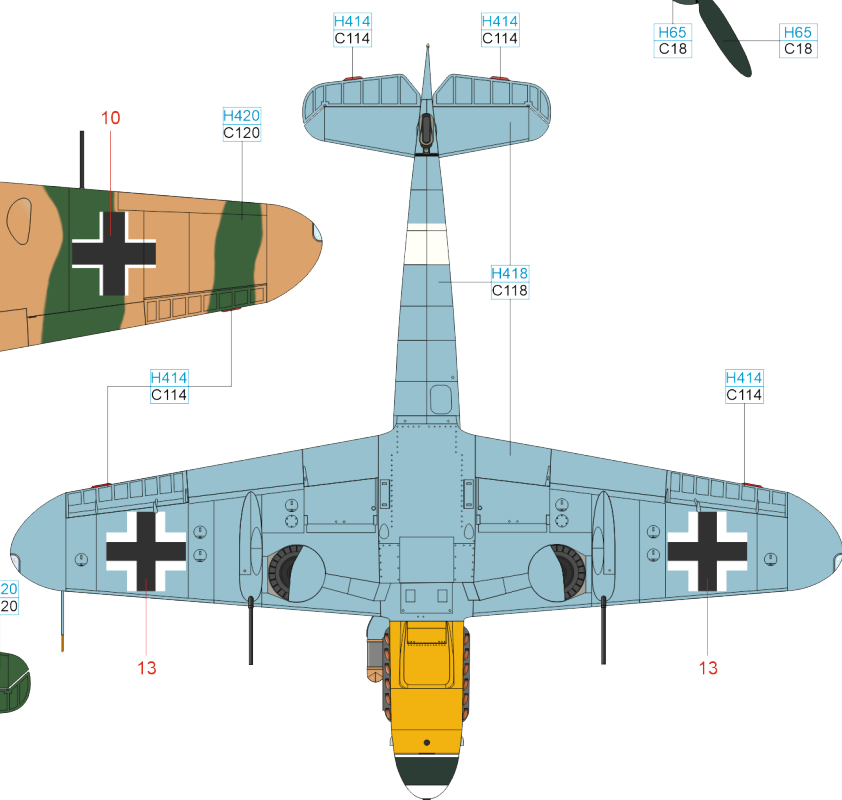
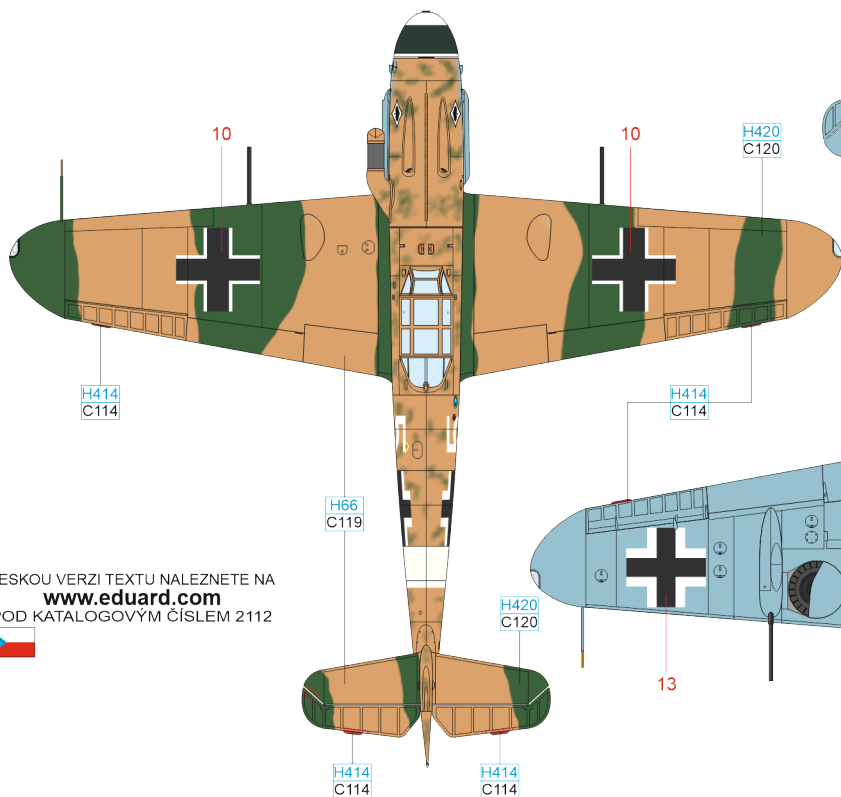
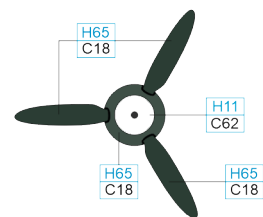
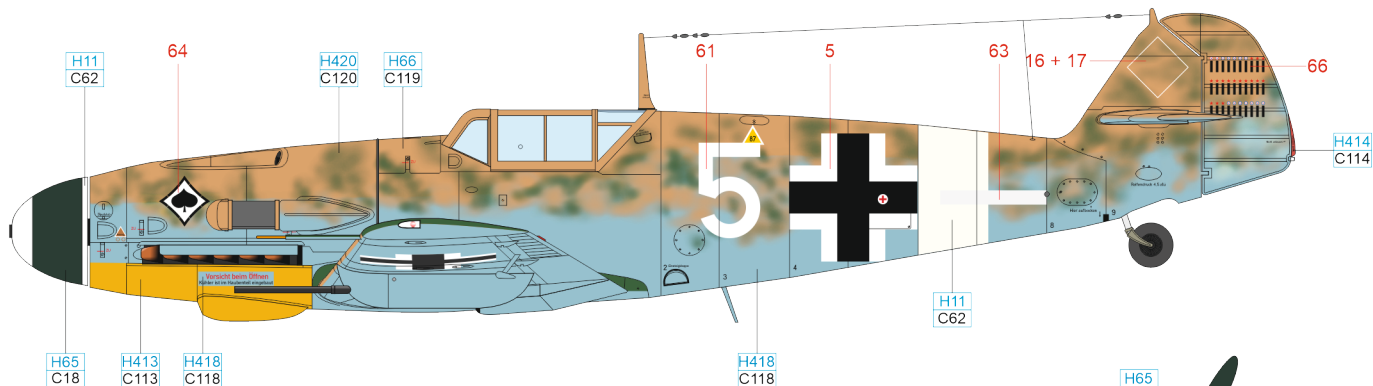

ČESKOU VERZI TEXTU NALEZNETE NA [www.eduard.com](http://www.eduard.com) POD KATALOGOVÝM ČÍSLEM 2112

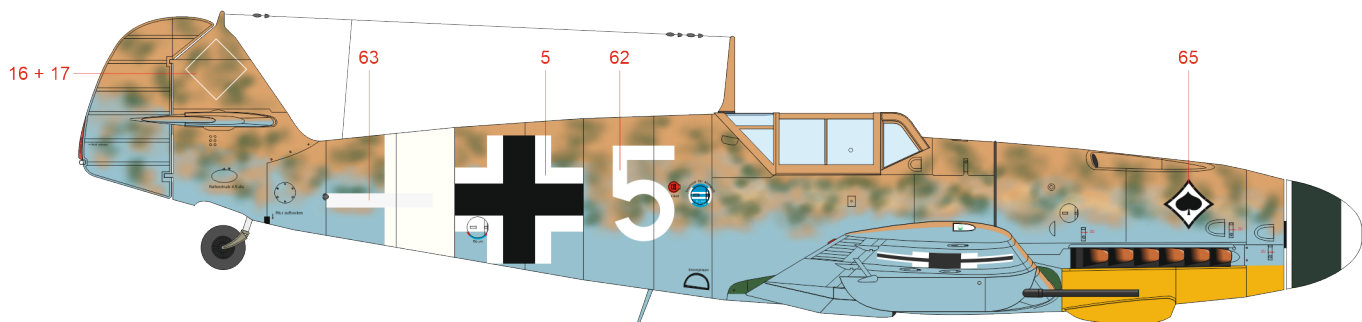

FLAT WHITE	H11 C62	RLM 04	H413 C113	RLM 23	H414 C114	RLM 70	H65 C18	RLM 78	H418 C118	RLM 79	H66 C119	RLM 80	H420 C120
------------	---------	--------	-----------	--------	-----------	--------	---------	--------	-----------	--------	----------	--------	-----------

# J Bf 109G-4/R3/Trop, Oblt. Jürgen Harder, 7./JG 53, Bizerta, Tunisia, February 1943

Jürgen Harder was born on June 13, 1918, in Swinemünde (currently the town of Świnoujście in Poland). He joined Luftwaffe in 1939 and served in III./JG 53 after his fighter pilot training. With this unit he went through the initial phase of the invasion of the Soviet Union. In May 1942 the III. Gruppe moved from south of Italy to North Africa. From February 5, 1943, Oblt. Harder was the commander of 7./JG 53 and on February 15, 1944, he was in command of the whole III. Gruppe of JG 53. On February 1, 1945, as commander of JG 11, he was awarded Knight's Cross of the Iron Cross with Oak Leaves. On February 17, 1945, flying the Messerschmitt Bf 109G-14, he crashed near the town of Strausberg due to a damaged engine. During the WWII operations he achieved 64 victories. The aircraft of Jürgen Harder from the time he was operating in the Southern Front were painted in a standard camouflage of RLM 78/79 and spots of RLM 80. The additional markings were white wingtips, white propeller spinner and white band on the aft fuselage. The rudder bore symbols of aerial victories, under the cockpit there was a HARRO inscription to commemorate Harder's brother, who was shot down above the English Channel on August 12, 1940. The resources state that he was shot down by P/O David Crook of No. 609 Squadron RAF.

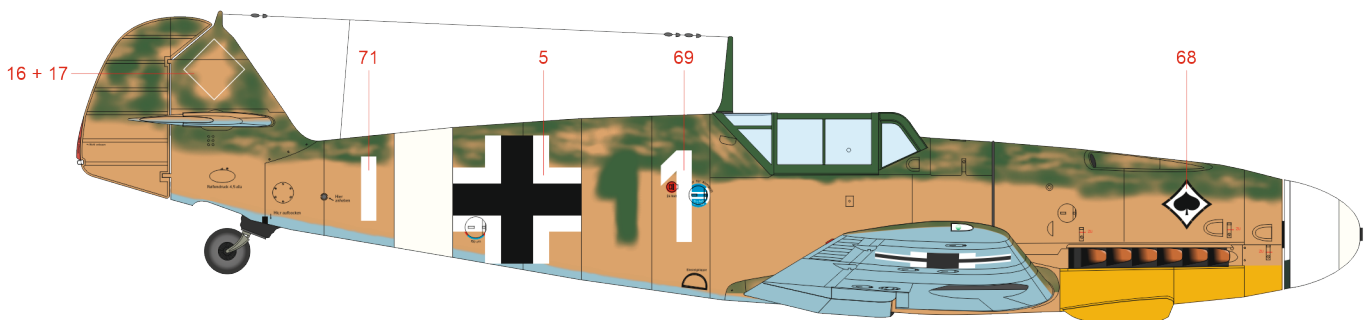
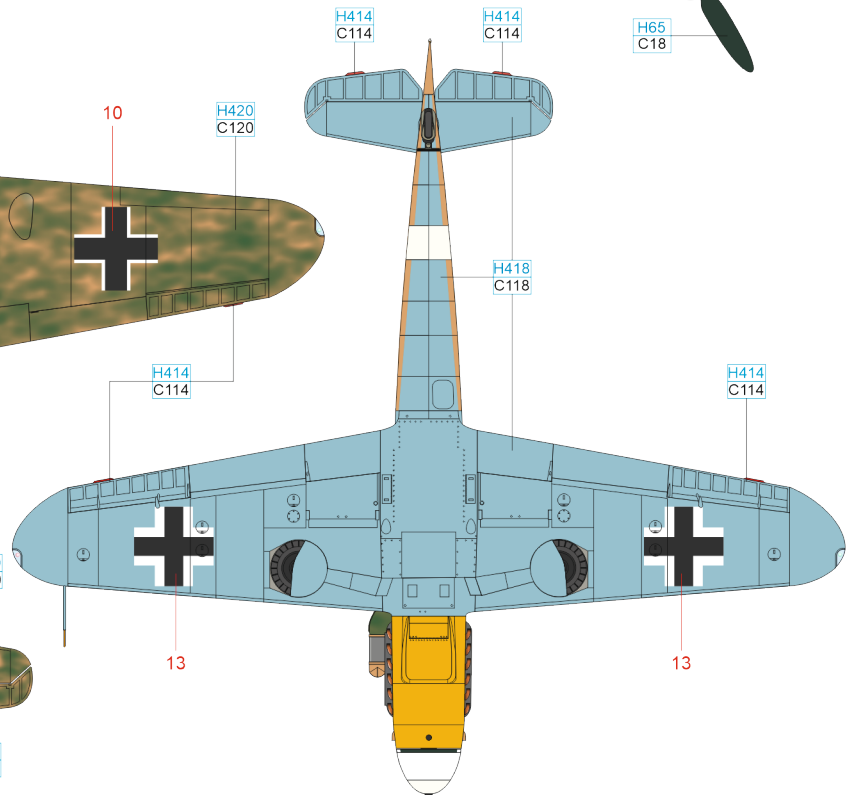
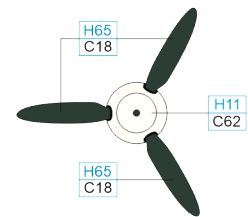
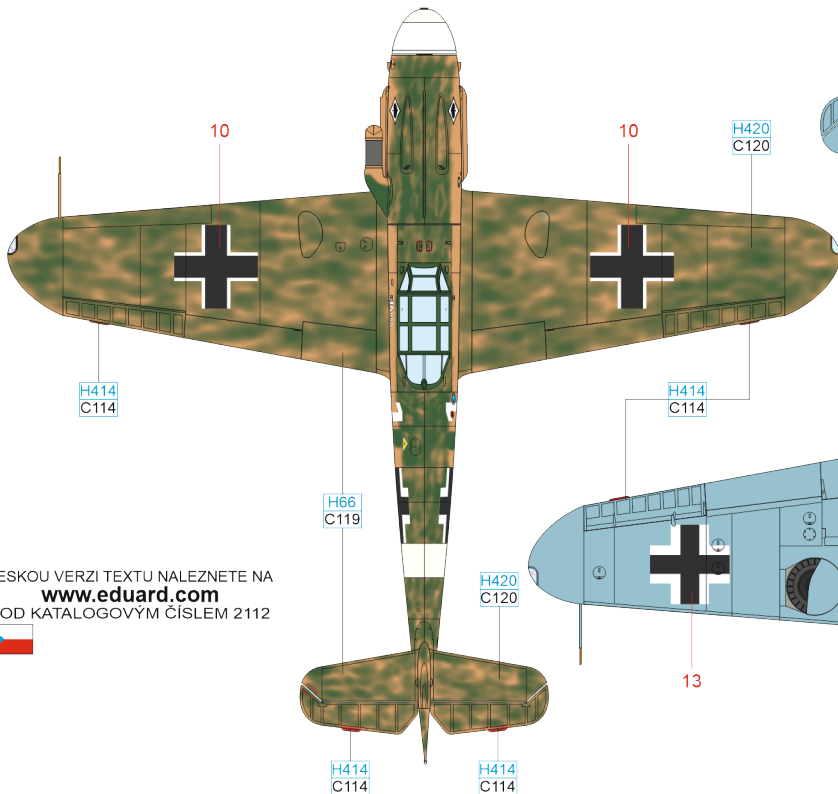
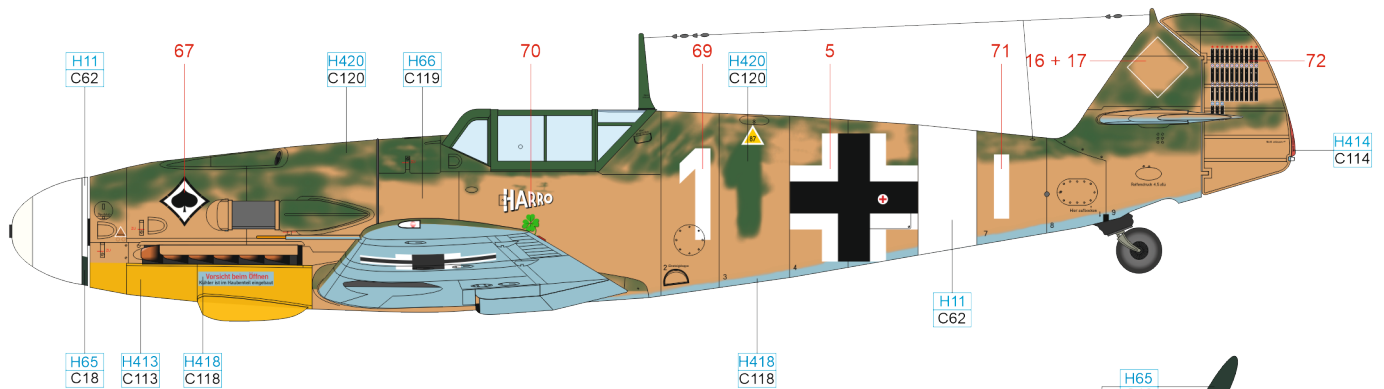

FLAT WHITE H11 C62 RLM 04 H413 C113 RLM 23 H414 C114 RLM 70 H65 C18 RLM 78 H418 C118 RLM 79 H66 C119 RLM 80 H420 C120

eduard

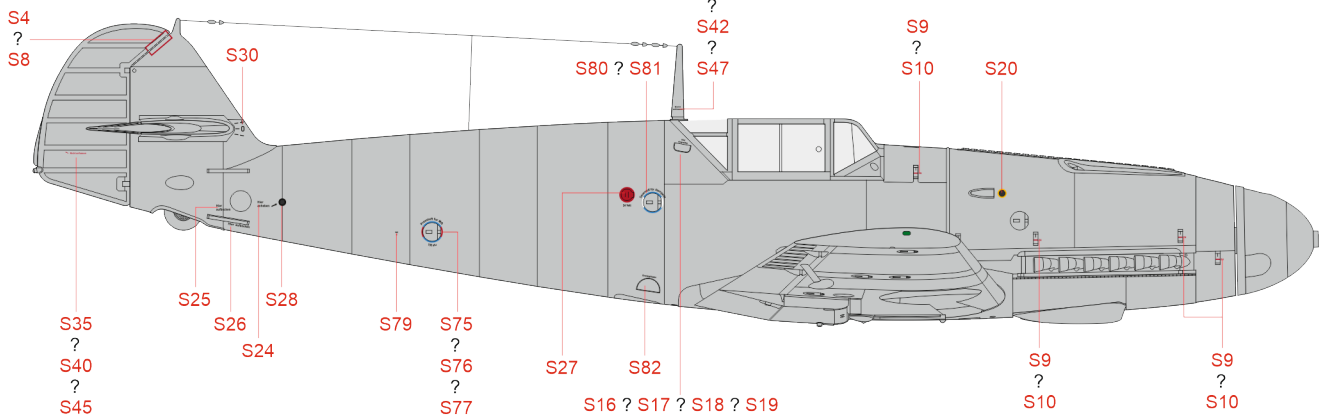
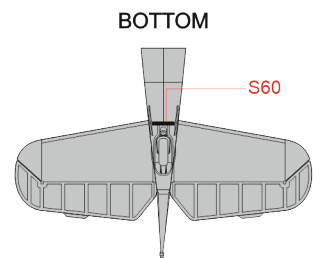
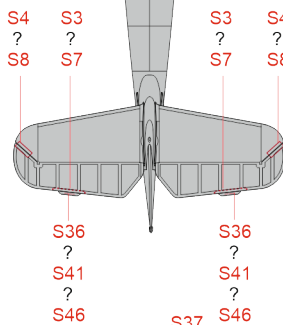
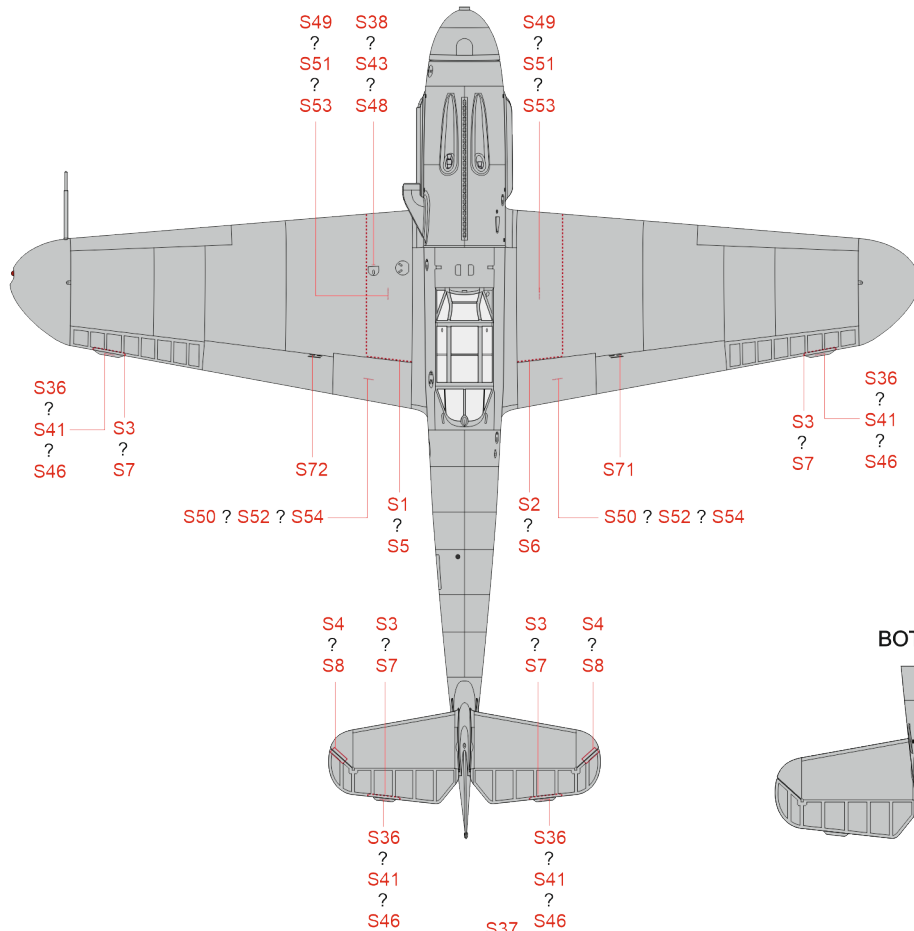
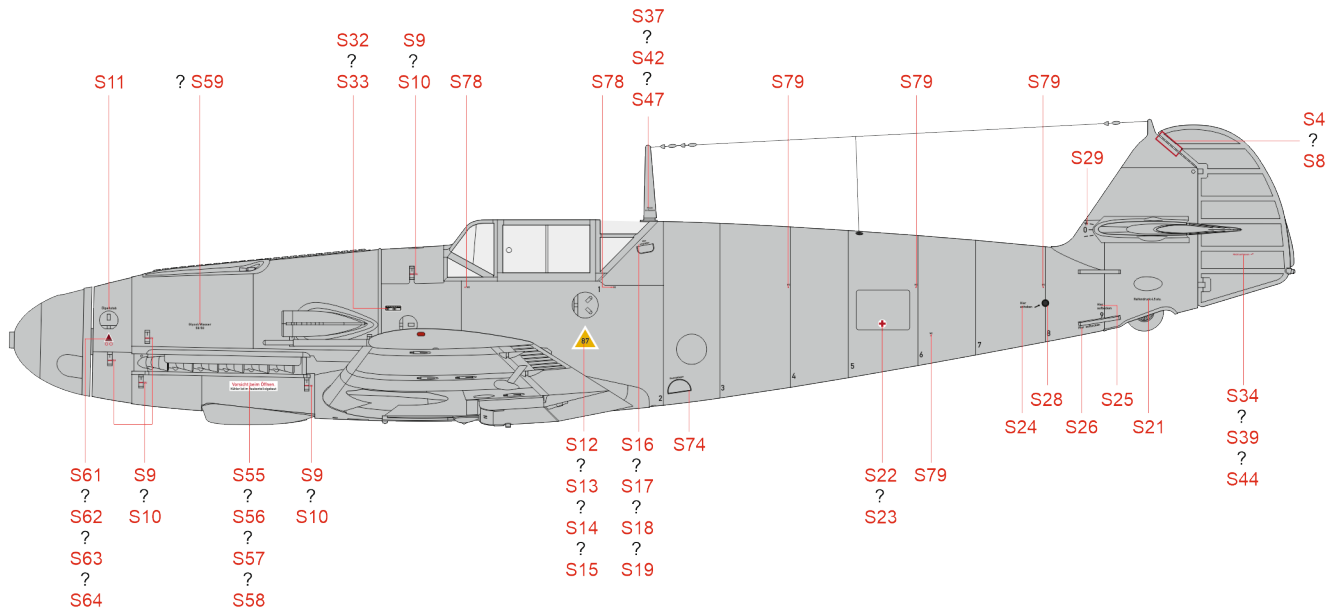

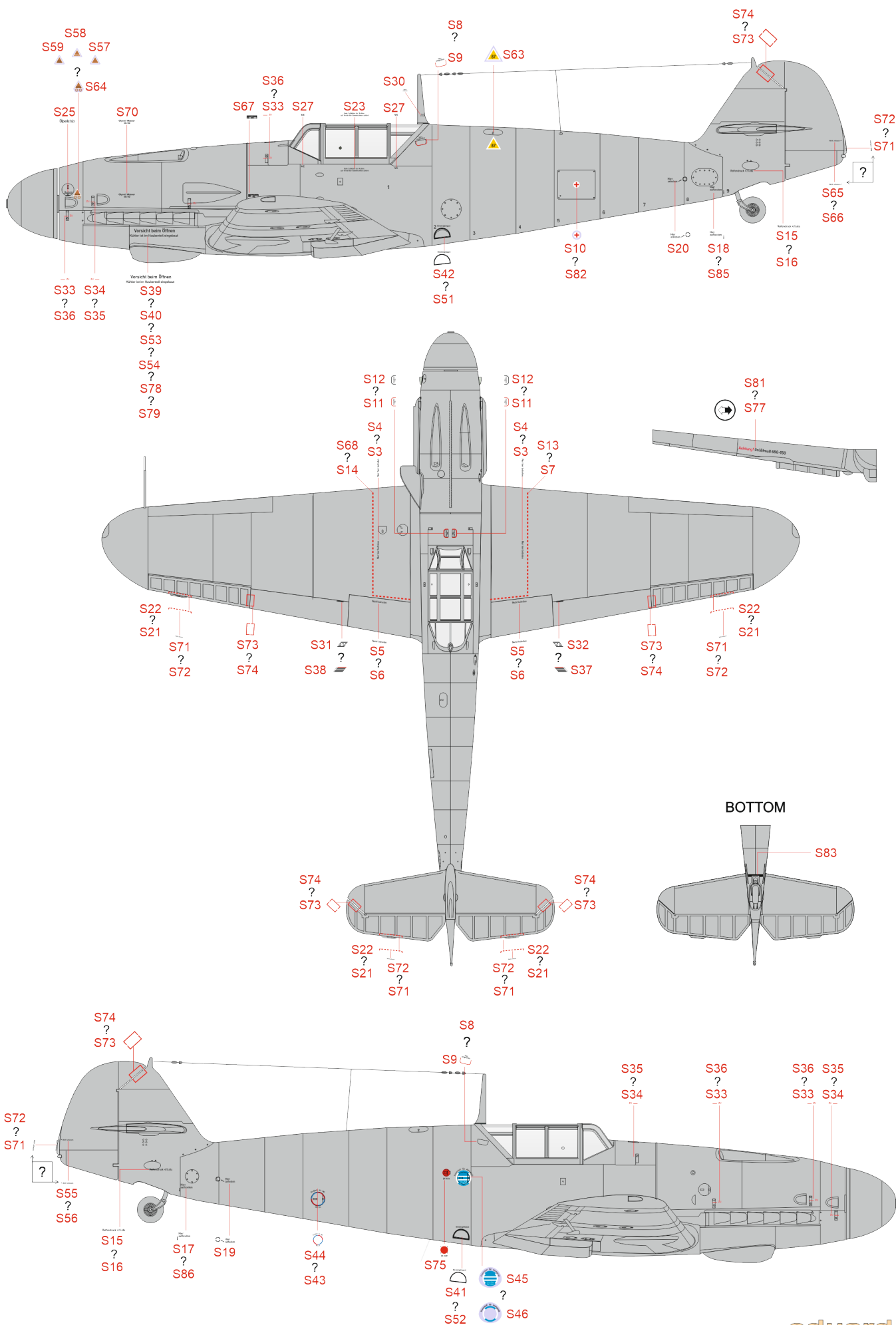

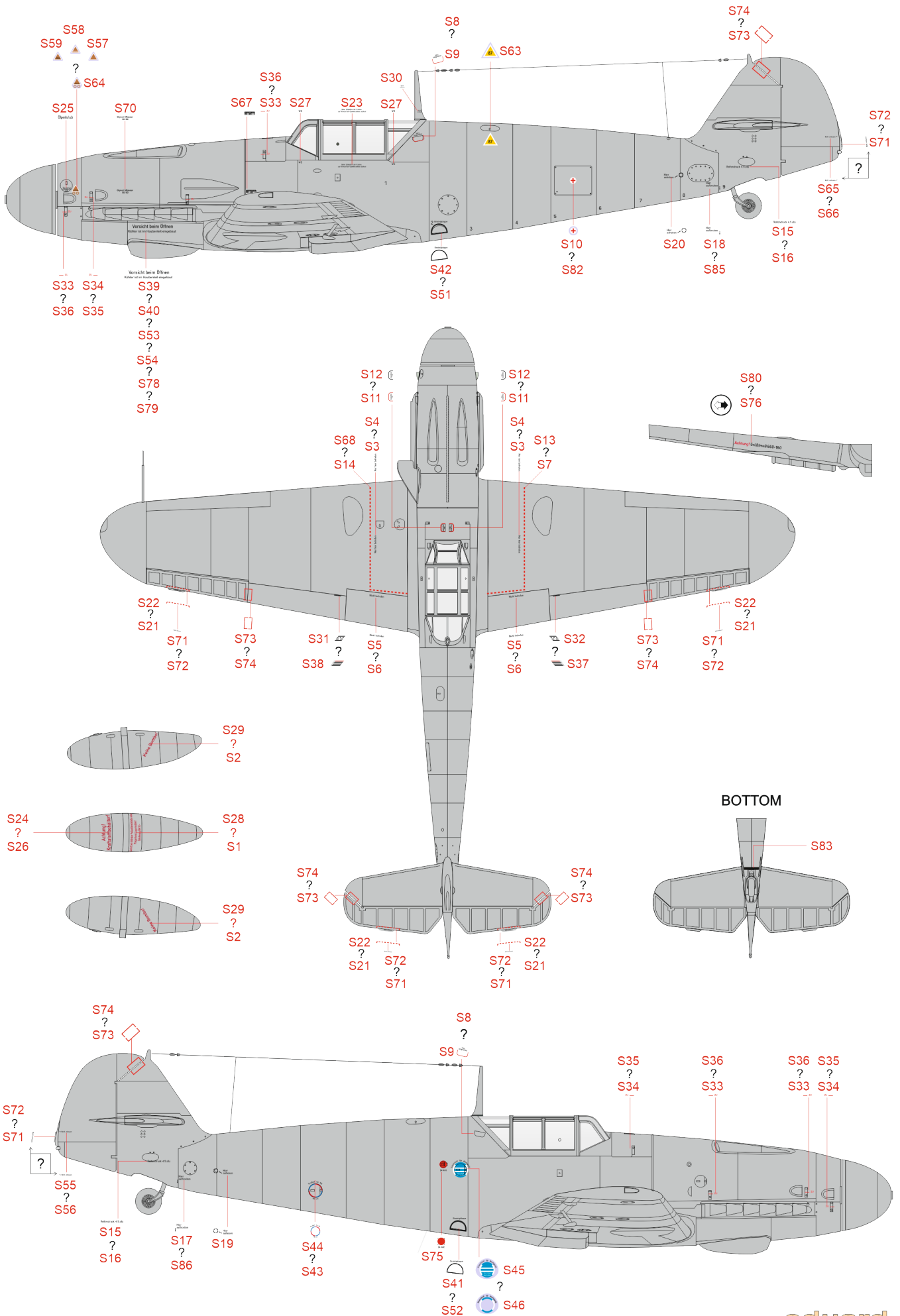

- 674004 Bf 109G-2 LööK (Brassin)
- 674005 Bf 109G-4 LööK (Brassin)
- 674007 Bf 109F LööK (Brassin)
- 674011 Bf 109F LööKplus (Brassin)
- 672313 Bf 109F propeller early PRINT (Brassin)
- 672314 Bf 109F propeller late PRINT (Brassin)
- 672315 Bf 109F gun barrels PRINT (Brassin)
- 672316 Bf 109F wheels PRINT (Brassin)
- 672317 Bf 109F undercarriage legs BRONZE (Brassin)
- 672318 Bf 109F radio compartment PRINT (Brassin)
- 672321 Bf 109F/G external fuel tanks (Brassin)
- 672322 Bf 109F wheel bays rounded PRINT (Brassin)
- 672323 Bf 109F/G wheel bays angular PRINT (Brassin)
- 672325 Bf 109F/G exhaust stacks PRINT (Brassin)
- 672326 Bf 109F/G/K gun pods PRINT (Brassin)
- 672327 Bf 109F cockpit PRINT (Brassin)
- 672328 Bf 109F cockpit w/ early seat PRINT (Brassin)
- 672338 Bf 109G undercarriage legs BRONZE (Brassin)
- 672339 Bf 109G-2/G-4 gun barrels PRINT (Brassin)
- 672340 Bf 109G-2/G-4 wheels for plain wings PRINT (Brassin)
- 672341 Bf 109G-2/G-4 wheels for bulged wings PRINT (Brassin)
- 672342 Bf 109G-2 cockpit PRINT (Brassin)
- 672343 Bf 109G-4 cockpit PRINT (Brassin)
- 672344 Bf 109G radio compartment PRINT (Brassin)
- 672346 Bf 109G propeller PRINT (Brassin)
- 672350 Bf 109F engine PRINT (Brassin)
- 672353 Bf 109G-2/G-4 engine PRINT (Brassin)
- SIN67221 Bf 109F (Brassin)
- 3DL72018 Bf 109F SPACE (3D Decal Set)
- D72045 Bf 109F stencils (Decal Set)

# 674011



# 674005

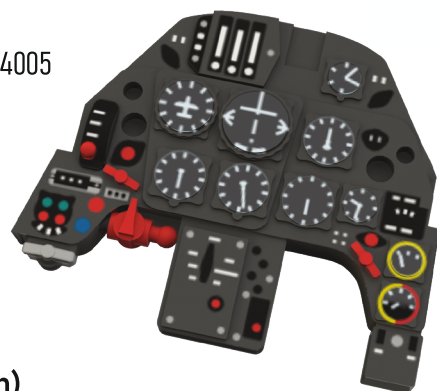

# 672344

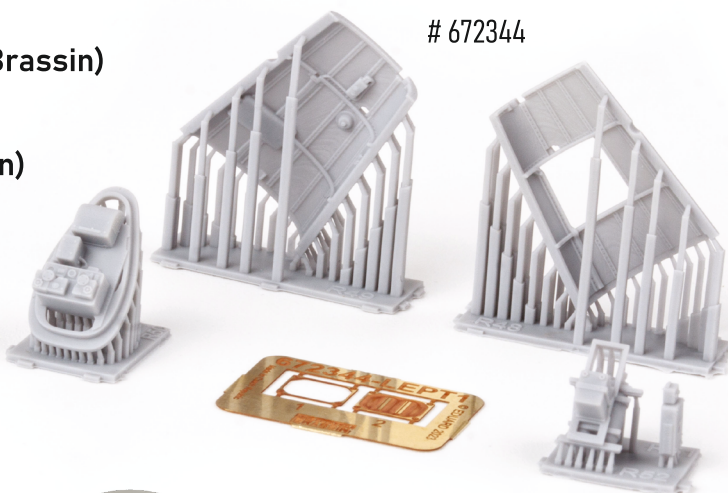

# 672322



# 672353

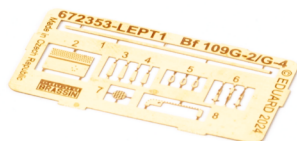

# 672342

