

# BEDFORD QL Refueller

Cat. no. 35062

Scale 1/35



3D Design & Artwork: Jarosław Leoniec  
Research: IBG crew

Przed montażem przeczytać instrukcję. Przestrzegać kolejności montażu podanego w instrukcji! Klej i farby nie wchodzi w skład zestawu.  
Please read instruction before assembly. Obey sequence of assembly like in instruction. Glue and paints not included.



- Element złożony we wcześniejszym etapie  
*Element assembled in previous step*
- Element po złożeniu w aktualnym etapie  
*Element after assembly in actual step*
- Wersja do wyboru  
*Version to choose*
- Kalkomania  
*Decal*
- Kolor farby  
*Paint colour*
- Część nie do użycia  
*Part not for use*
- Zegnij część fototrawioną  
*Bend photoetched part*
- Po gięciu  
*After bending*

		Vallejo Model Air	Hataka	Mr Hobby H	Mr Hobby C	Lifecolor	AK Interactive
Black		71.057	HTK-A159	H002	C002	LC02	AK719
Light Gray		71.050	HTK-A050	H324	C097	UA34	AK2231
RAF Blue Grey		71.115	HTK-A145	H042	C328	UA044	AK2162
Golden Yellow		71.078	HTK-A275	H004	C004	UA140	AK11041
White		71.001	HTK-A049	H011	C062	LC01	RC004
Tire Black		71.315	HTK-A041	H077	C137	UA733	AK11027
Rust		71.129	HTK-A132	H047	C041	LC32	AK707

## Kalkomania / Decal

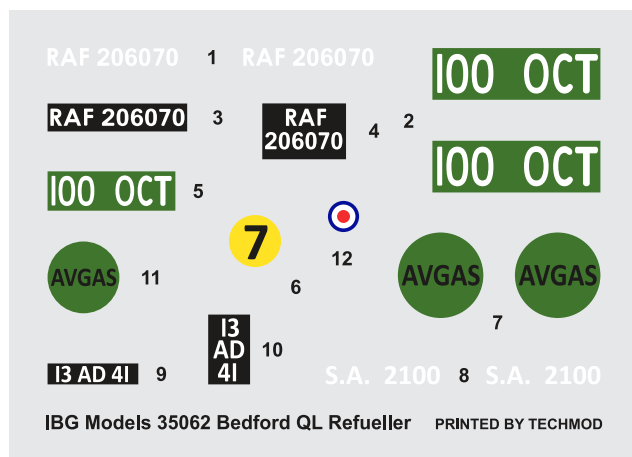

## Części fototrawione / Photoetched parts

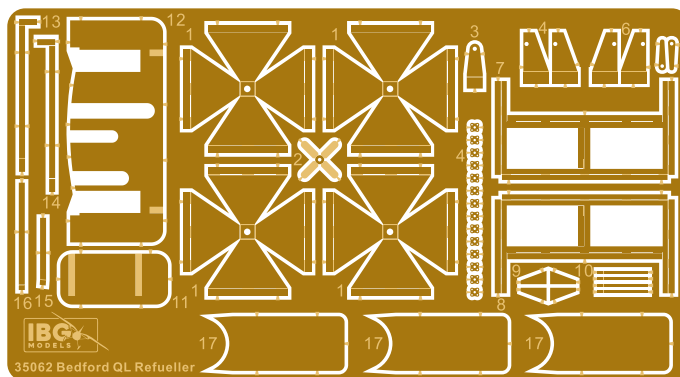

International Business Group  
ul. Benedykta Hertza 2  
04-603 Warszawa  
Poland

tel +48 22 8159150  
fax +48 22 8159151  
ibgsc@ibg.com.pl  
www.ibg.com.pl

**Ramka A / Frame A**

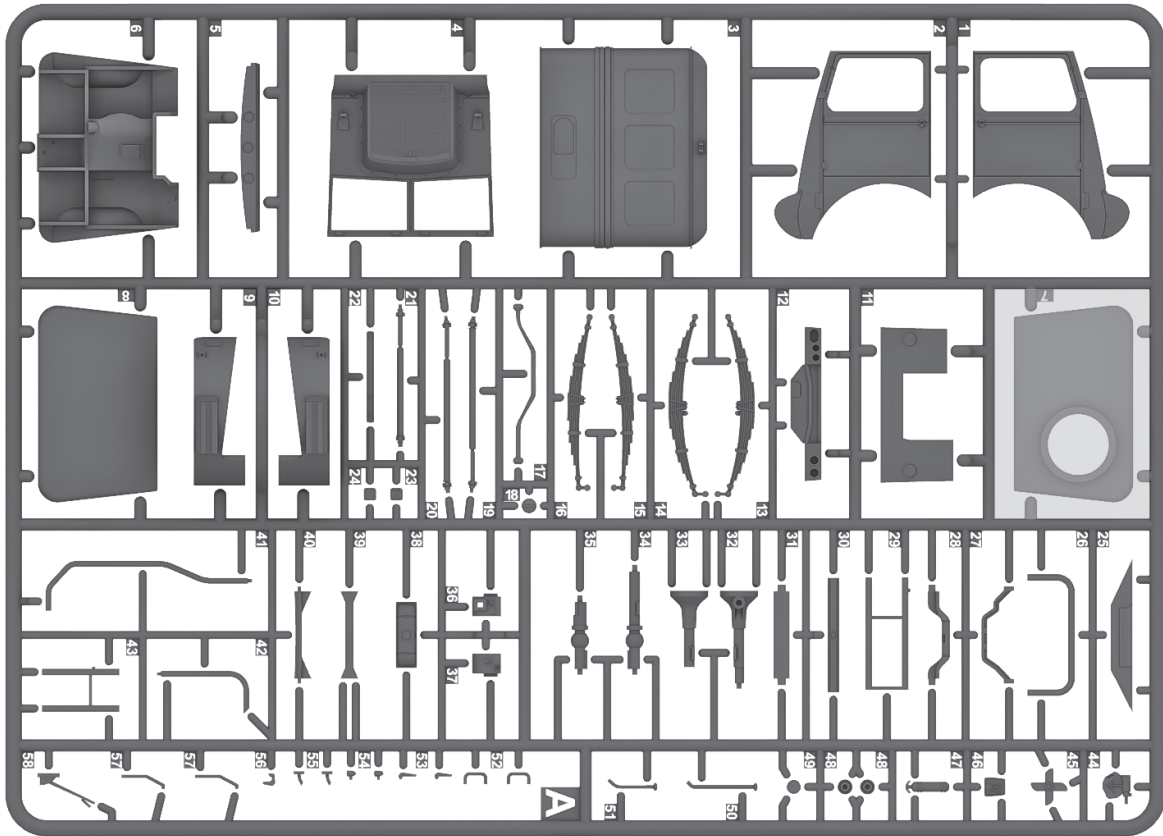

**Ramka B / Frame B**

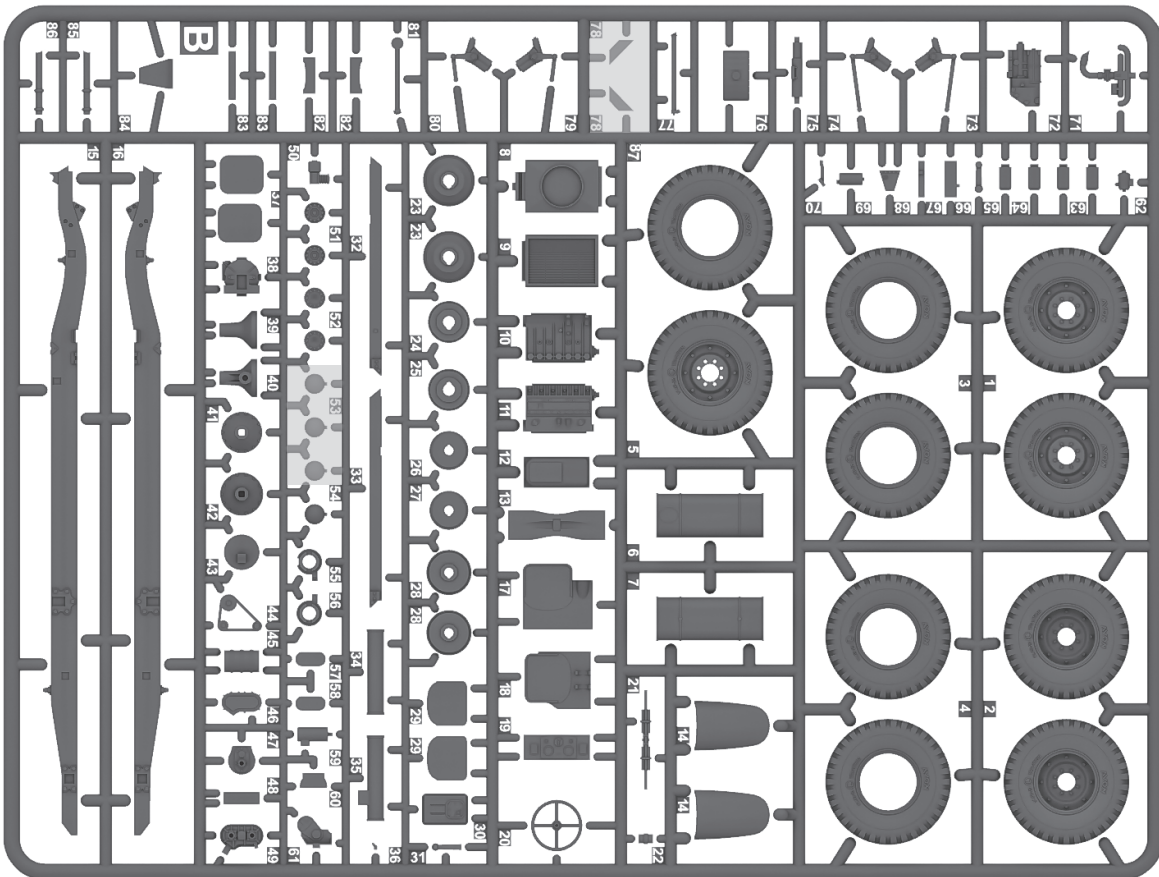

Ramka D / Frame D

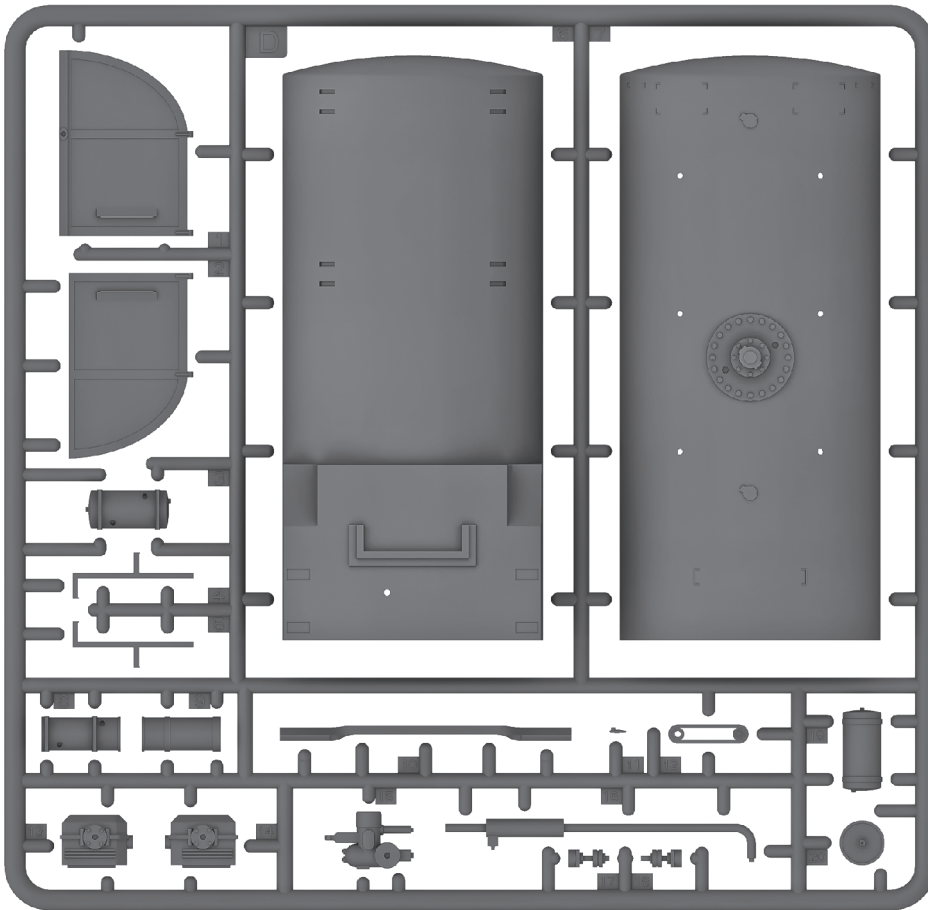

Ramka J / Frame J

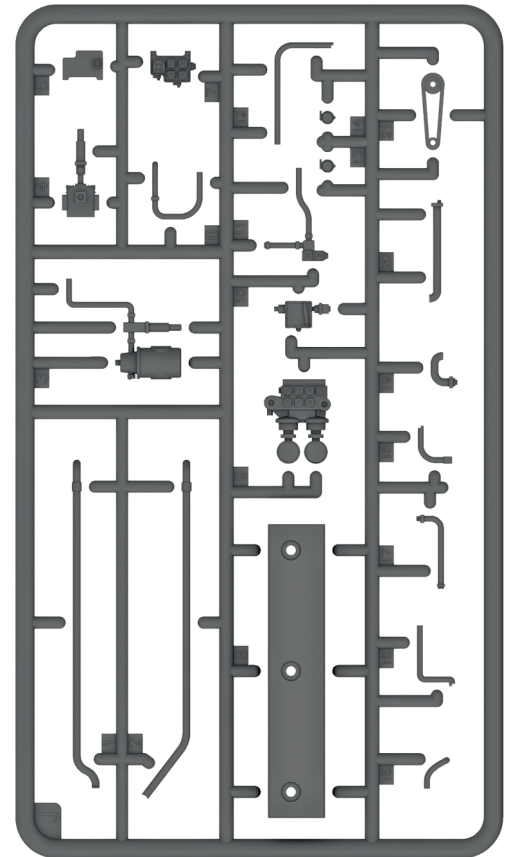

Ramka I / Frame I

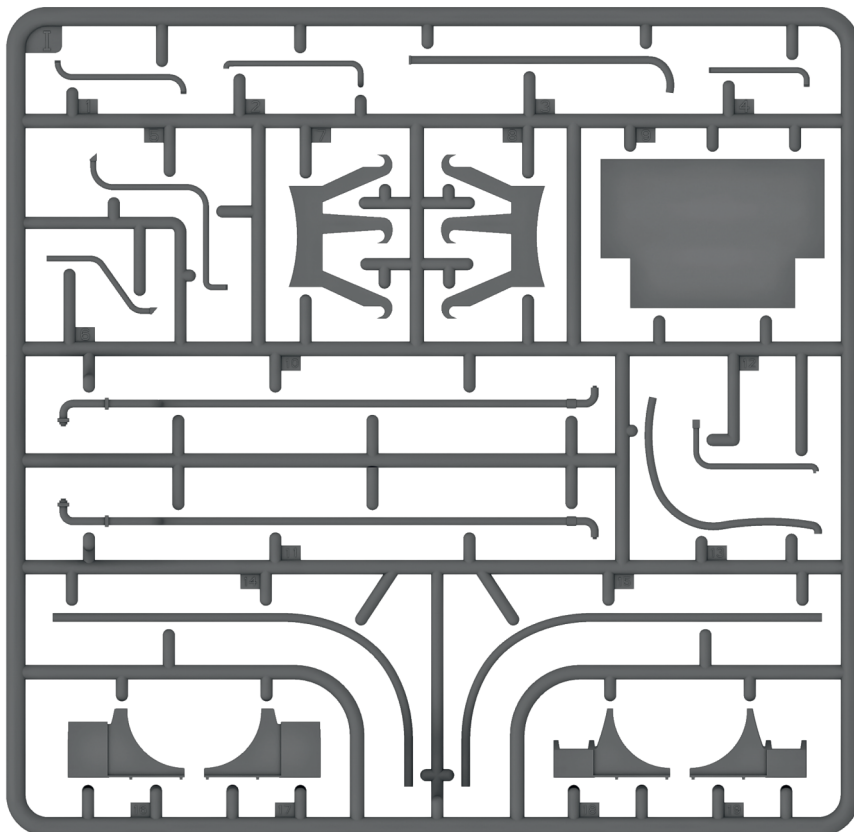

Ramka E / Frame E

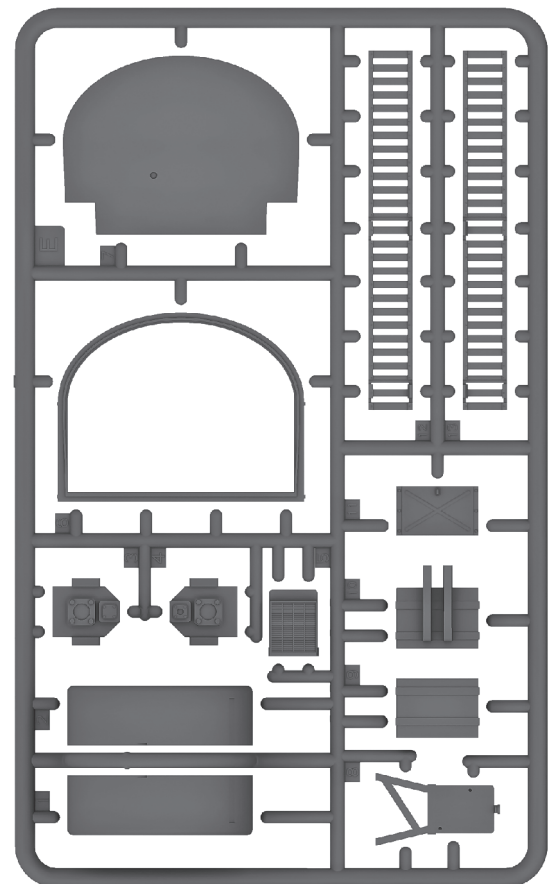

**Ramka C - 3 szt / Frame C - 3 pcs**

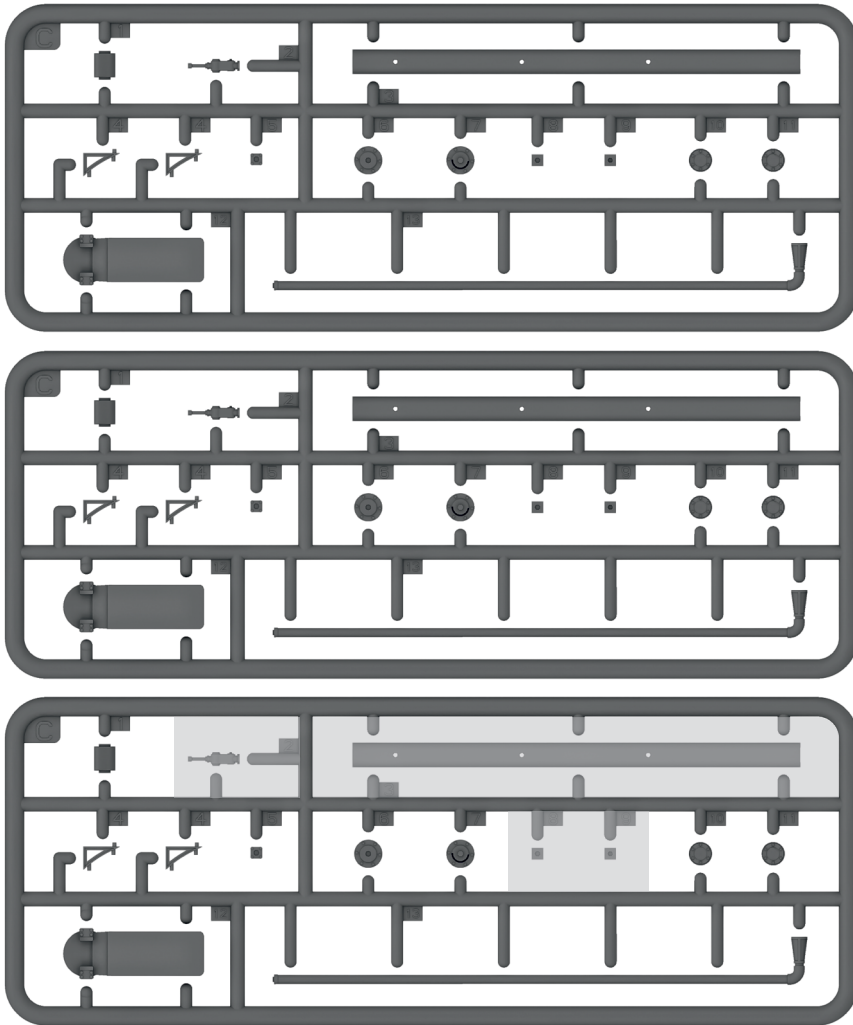

**Ramka przezroczysta / Frame clear**

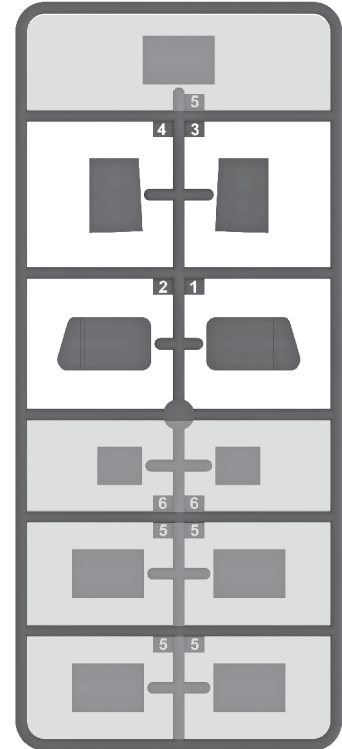

**Ramka F - 2 szt / Frame F - 2 pcs**

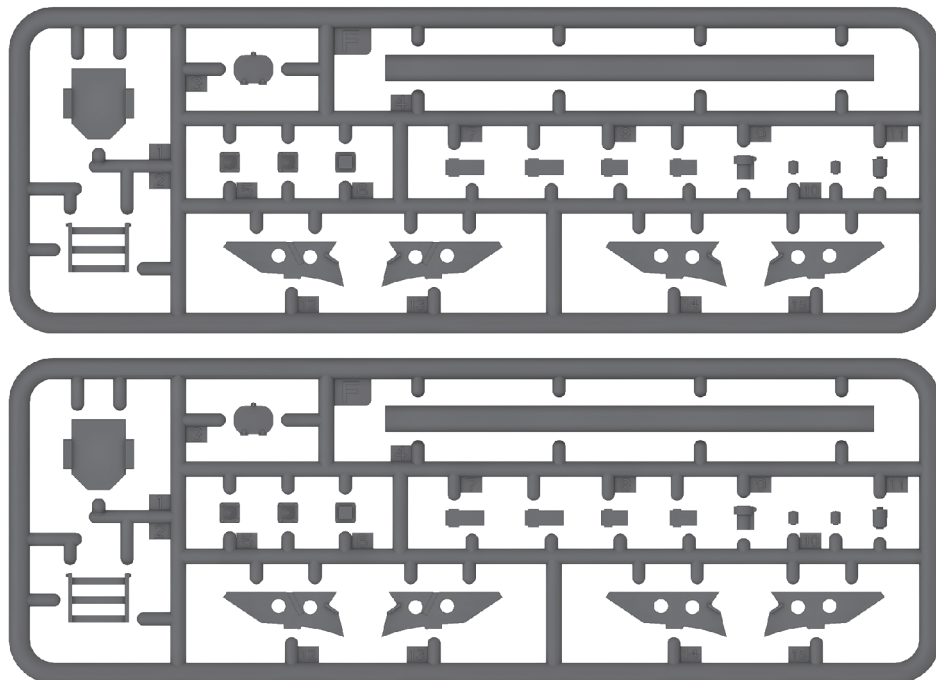

**ETAP 1  
STEP 1**

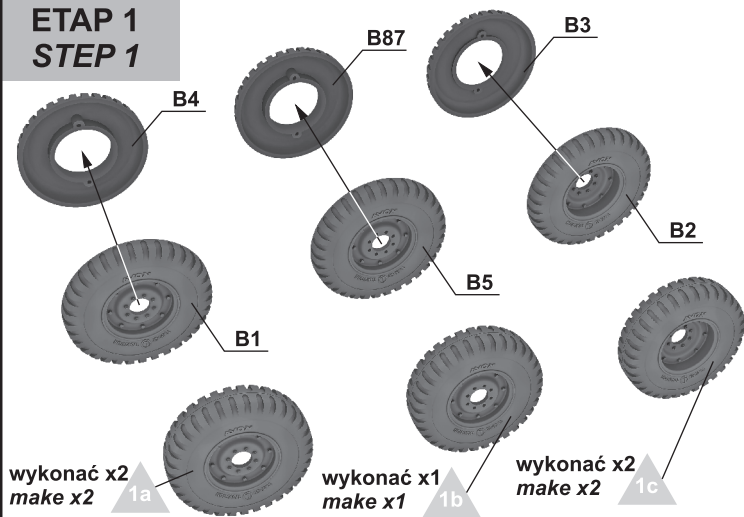

**ETAP 2  
STEP 2**

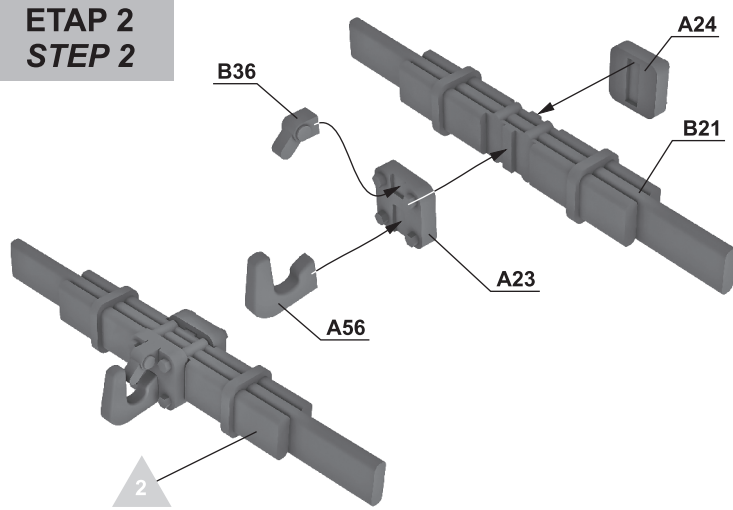

**ETAP 3  
STEP 3**

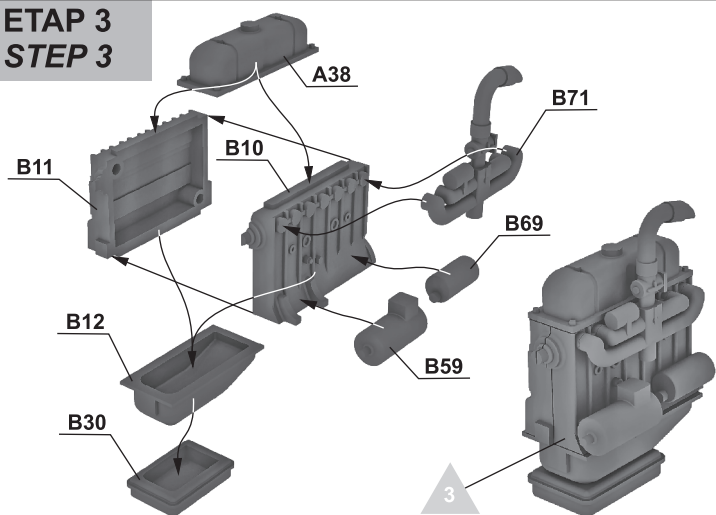

**ETAP 4  
STEP 4**

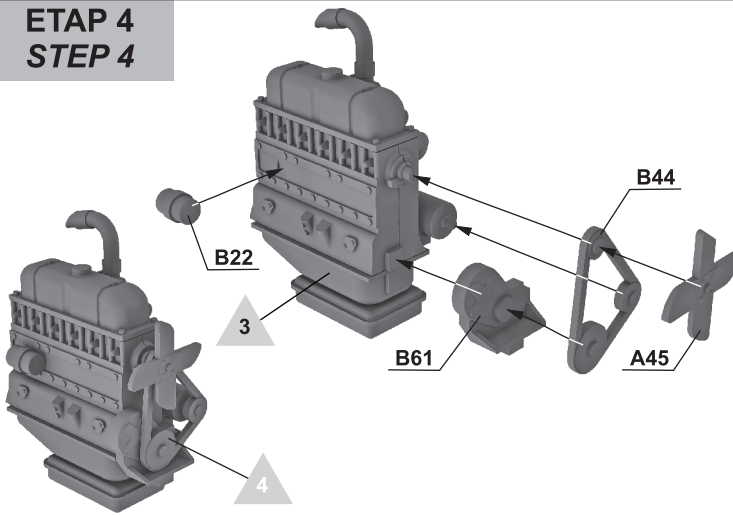

**ETAP 5  
STEP 5**

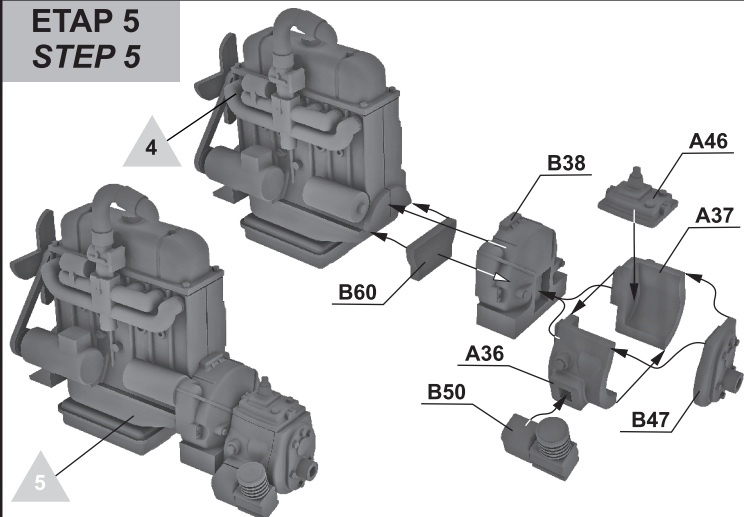

**ETAP 6  
STEP 6**

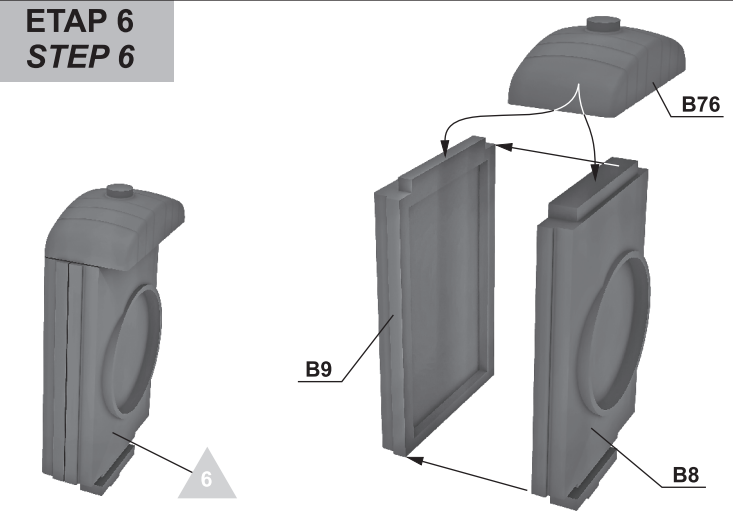

**ETAP 7  
STEP 7**

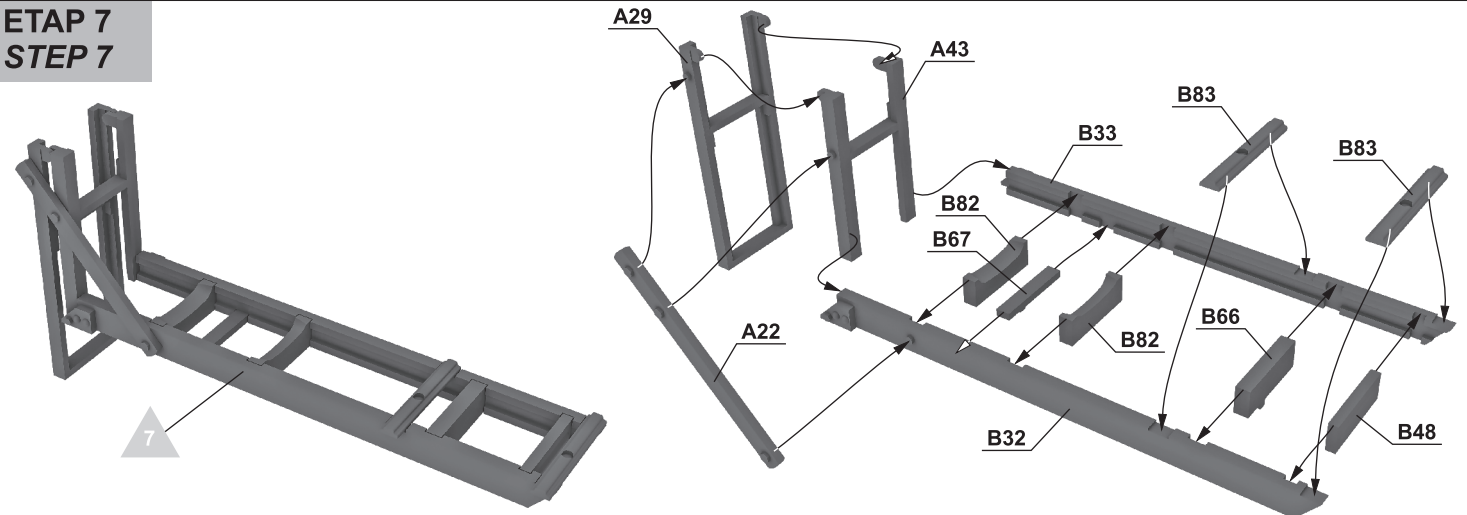

**ETAP 8  
STEP 8**

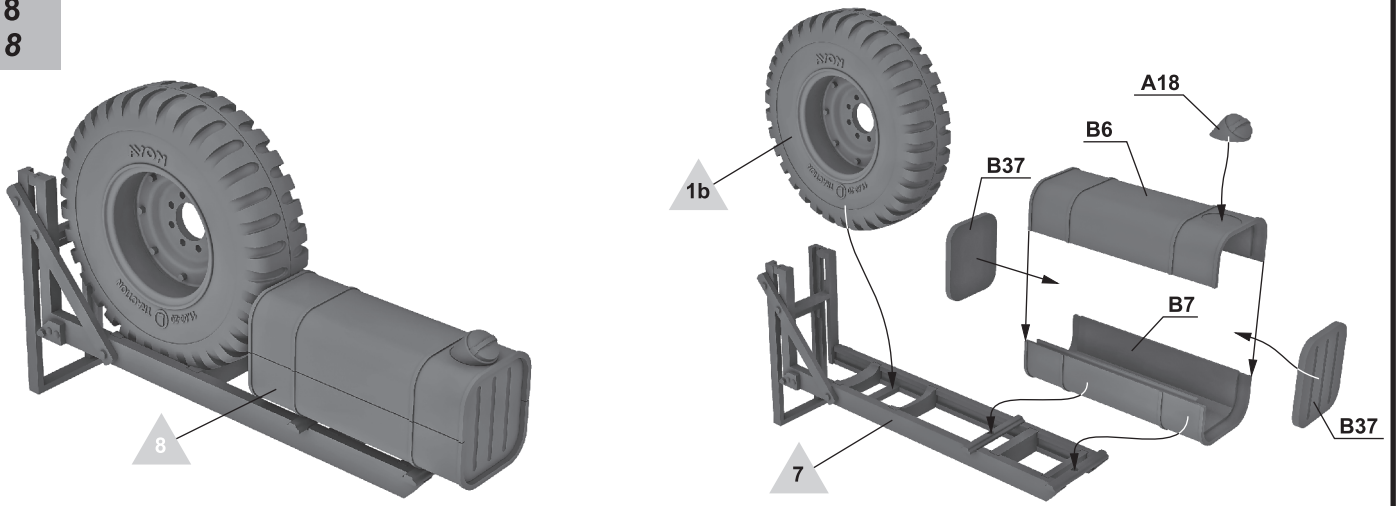

**ETAP 9  
STEP 9**

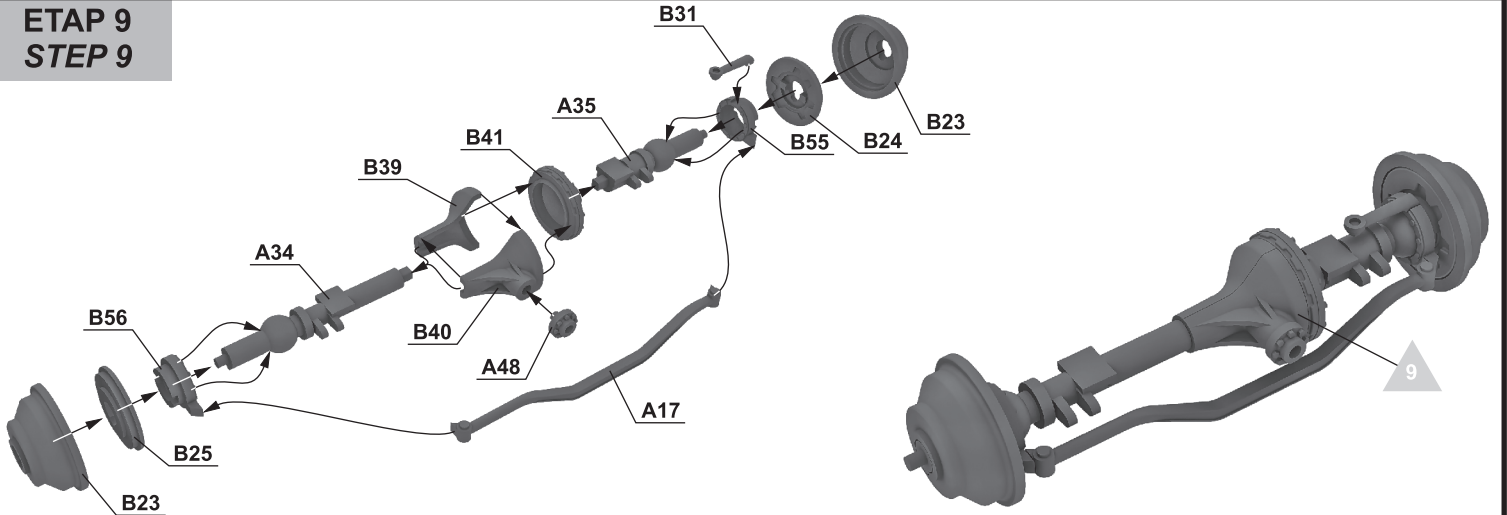

**ETAP 10  
STEP 10**

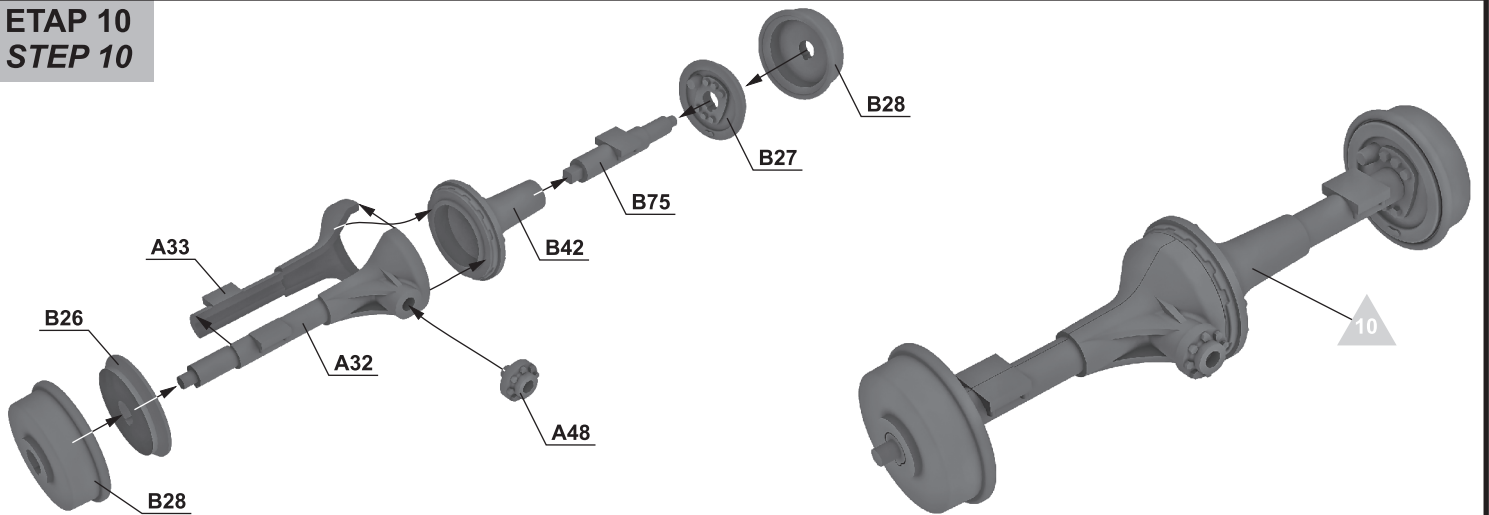

**ETAP 11  
STEP 11**

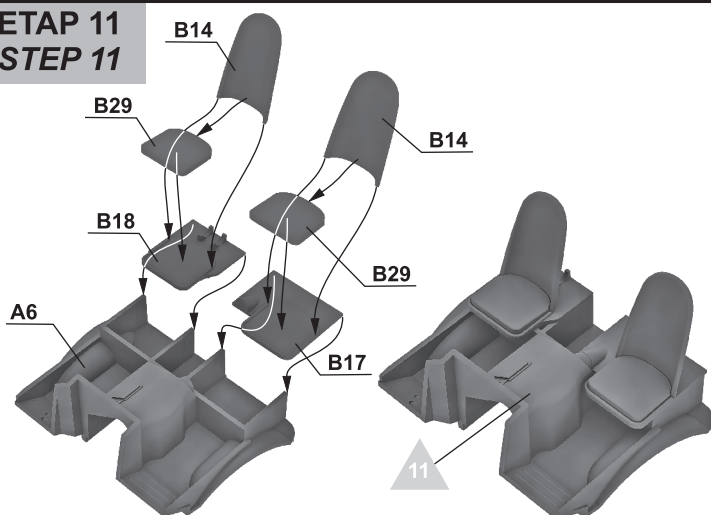

**ETAP 12  
STEP 12**

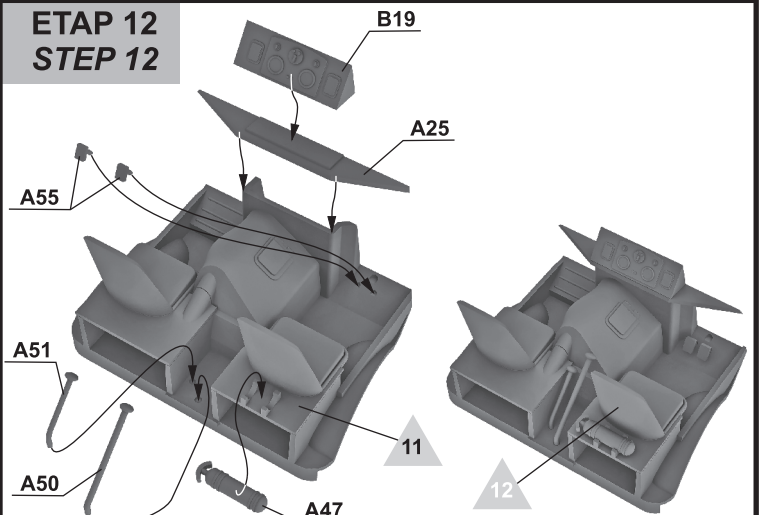

**ETAP 13  
STEP 13**

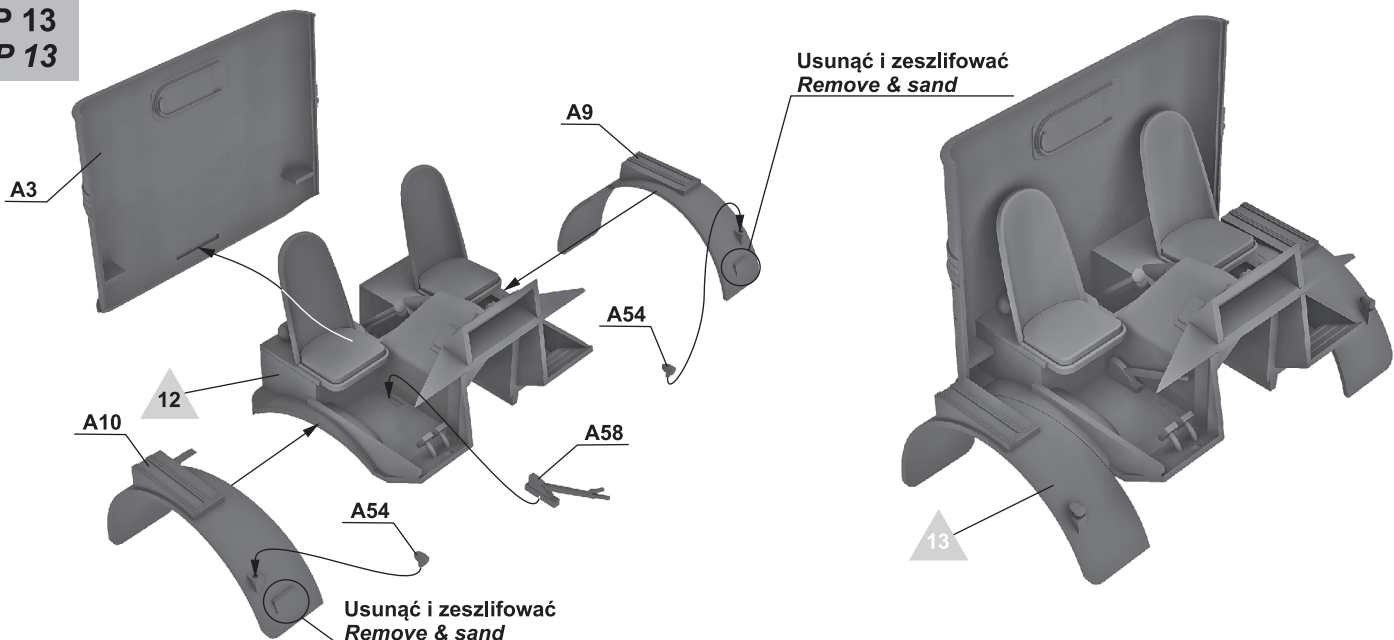

**ETAP 14  
STEP 14**

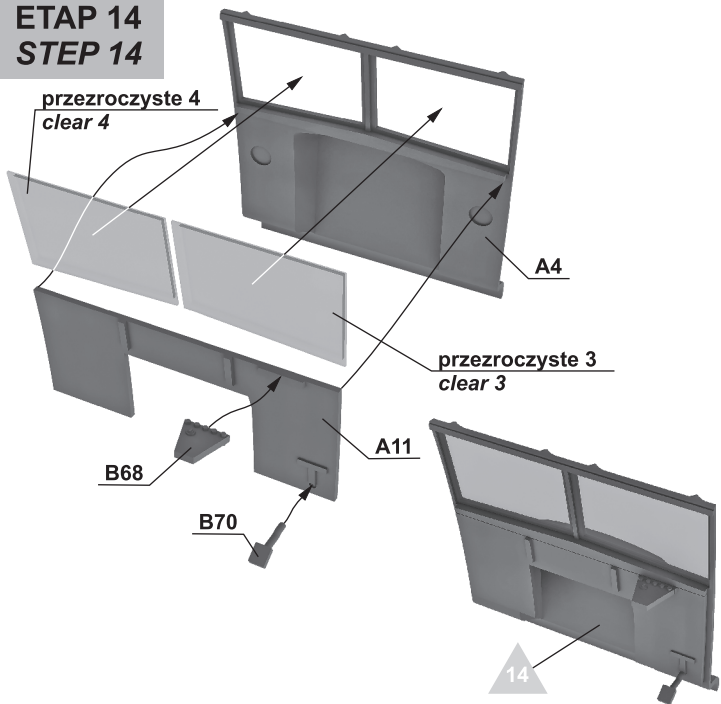

**ETAP 15  
STEP 15**

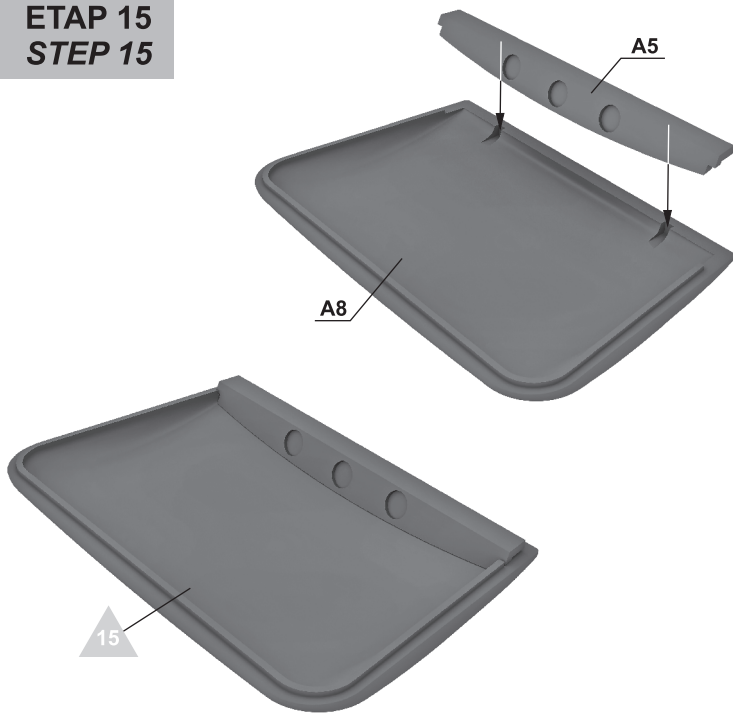

**ETAP 16  
STEP 16**

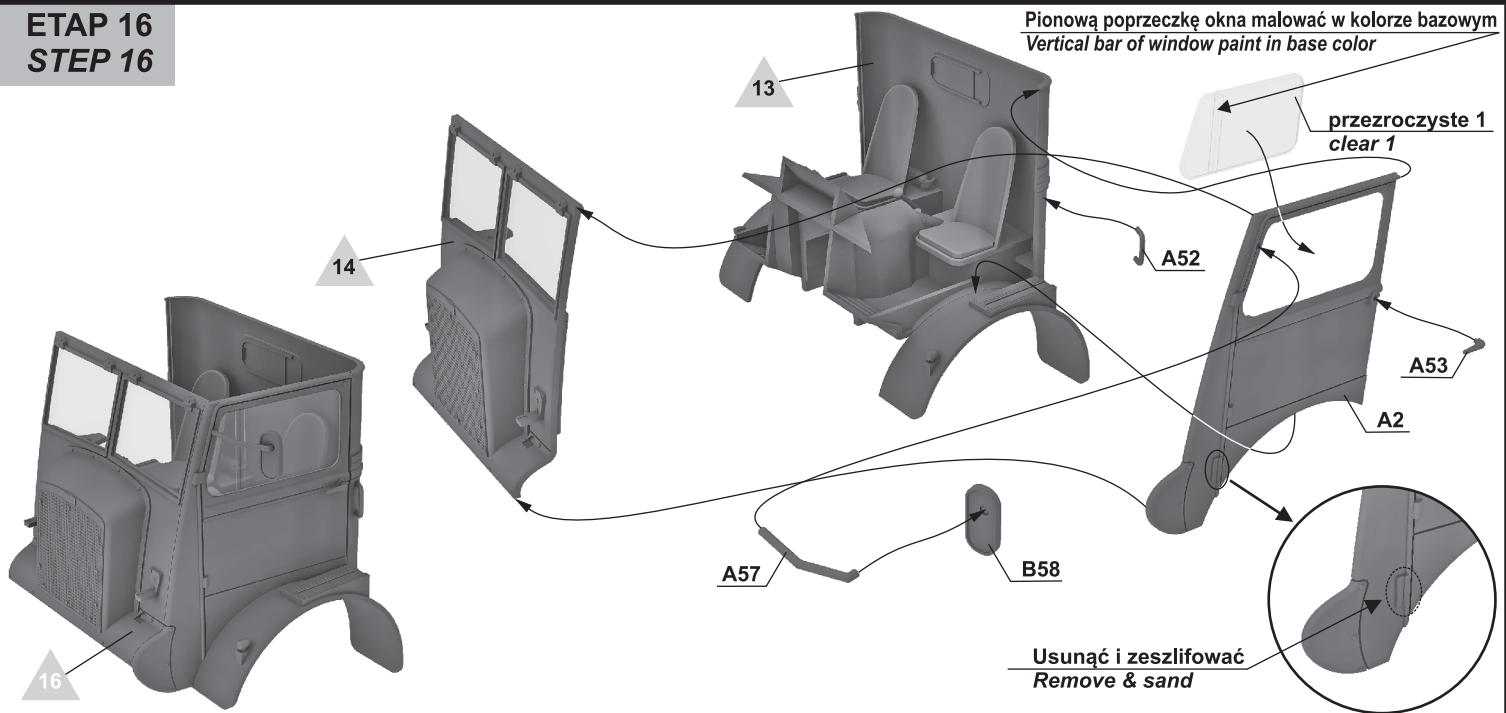

**ETAP 17**  
**STEP 17**

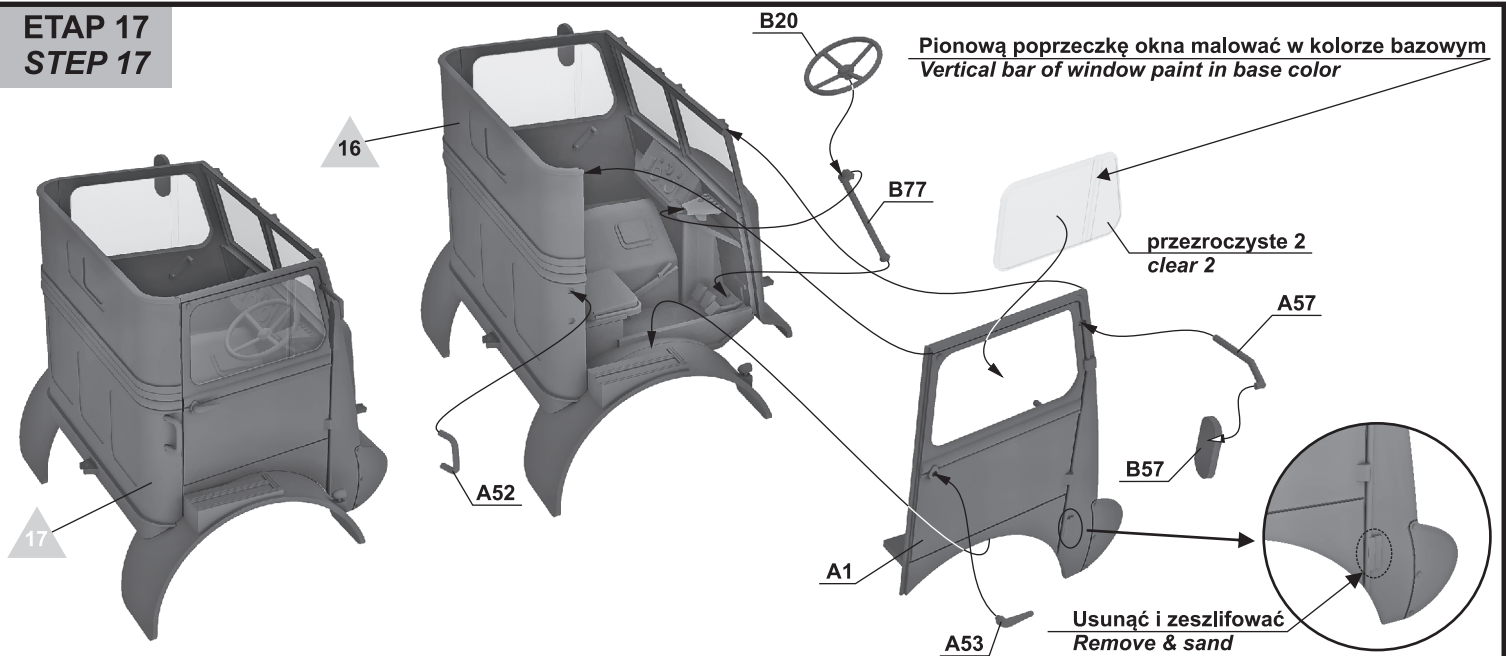

**ETAP 18**  
**STEP 18**

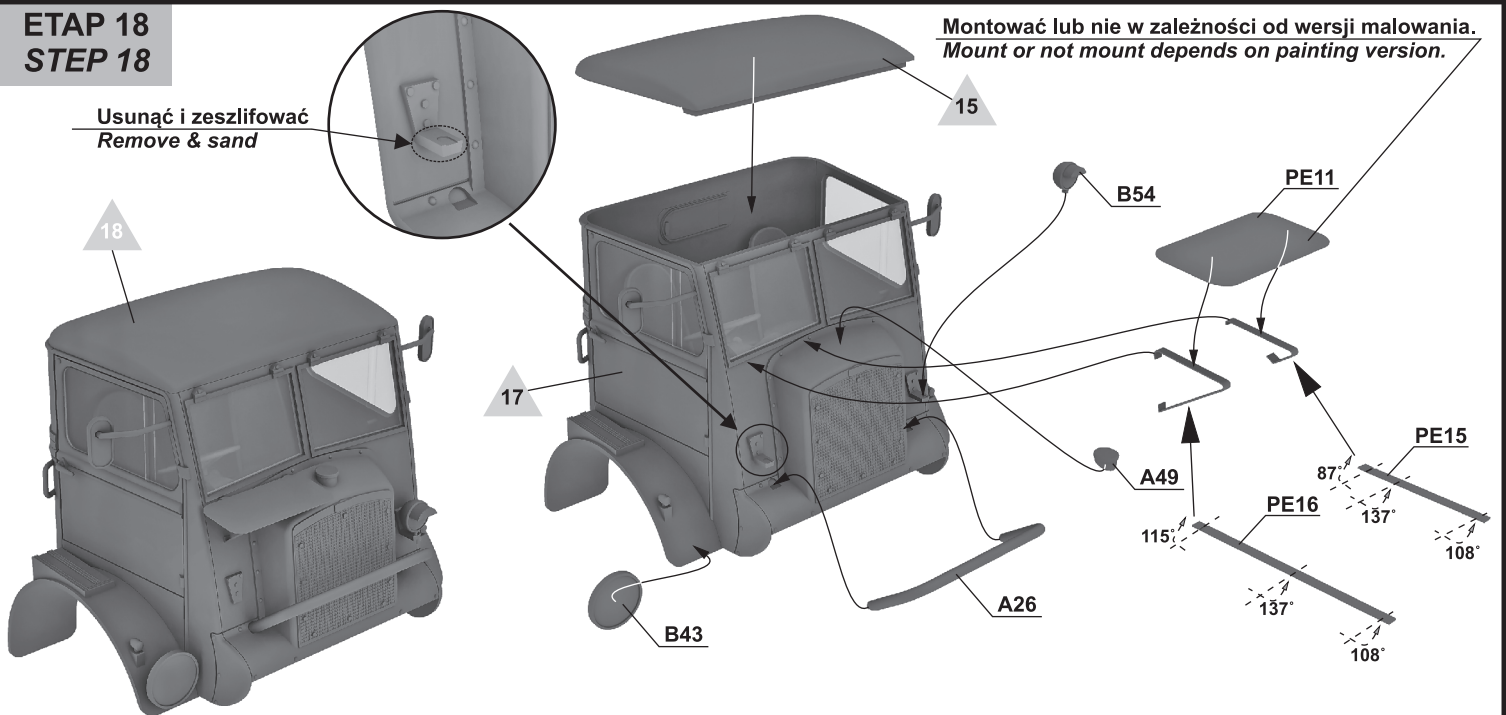

**ETAP 19**  
**STEP 19**

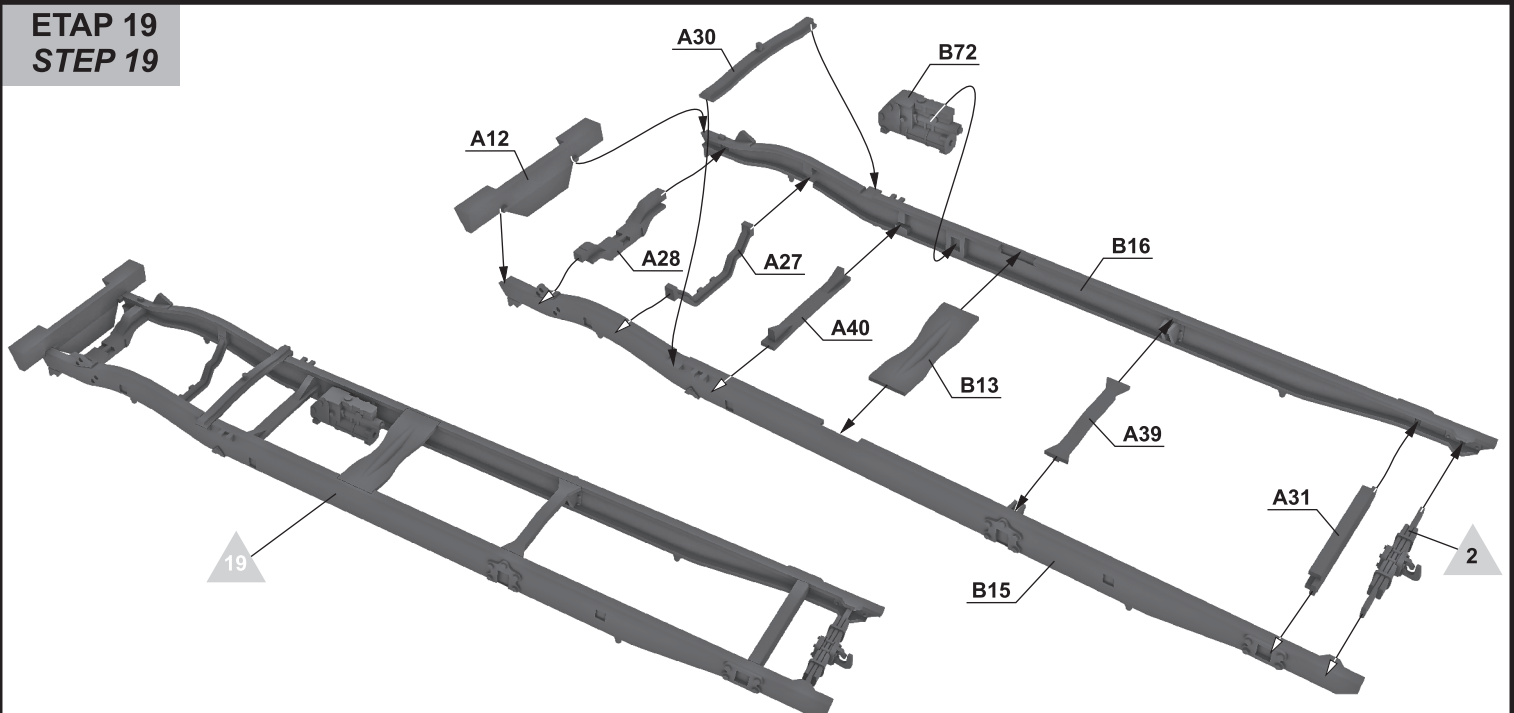

**ETAP 20**  
**STEP 20**

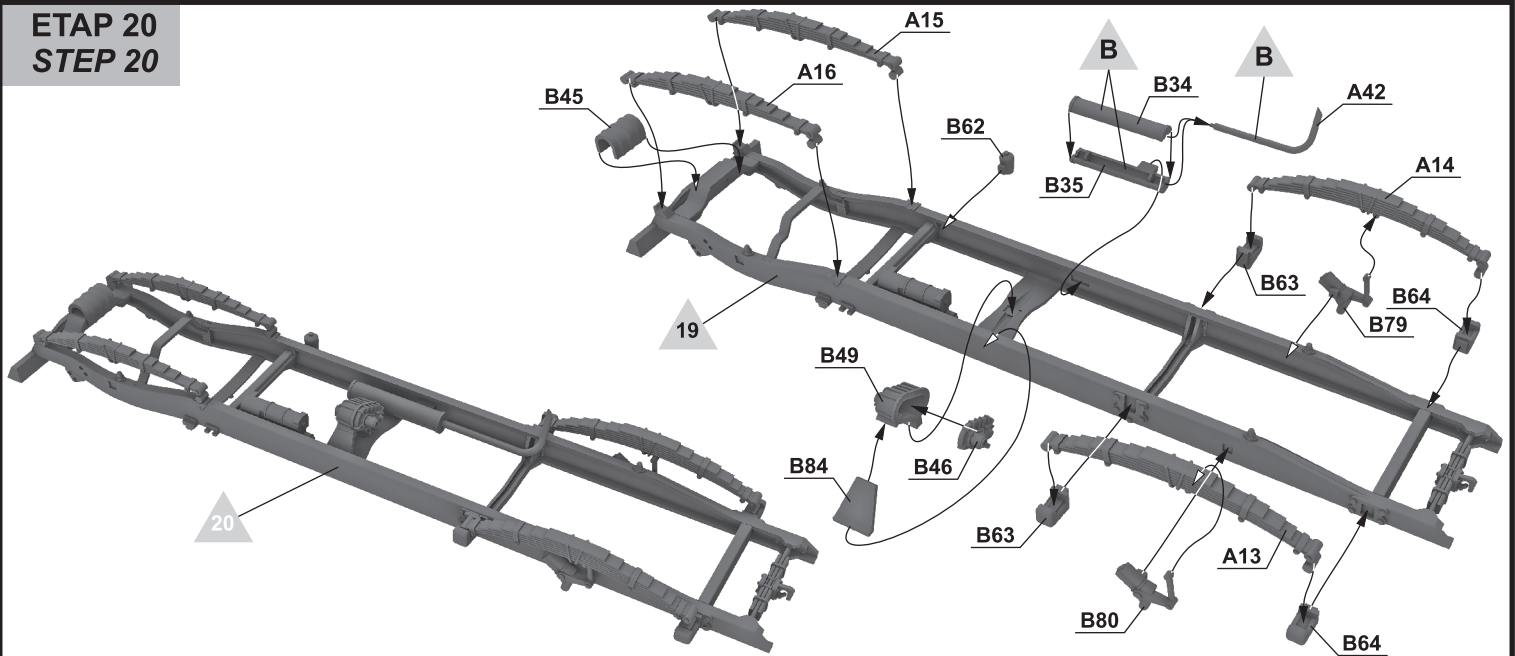

**ETAP 21**  
**STEP 21**

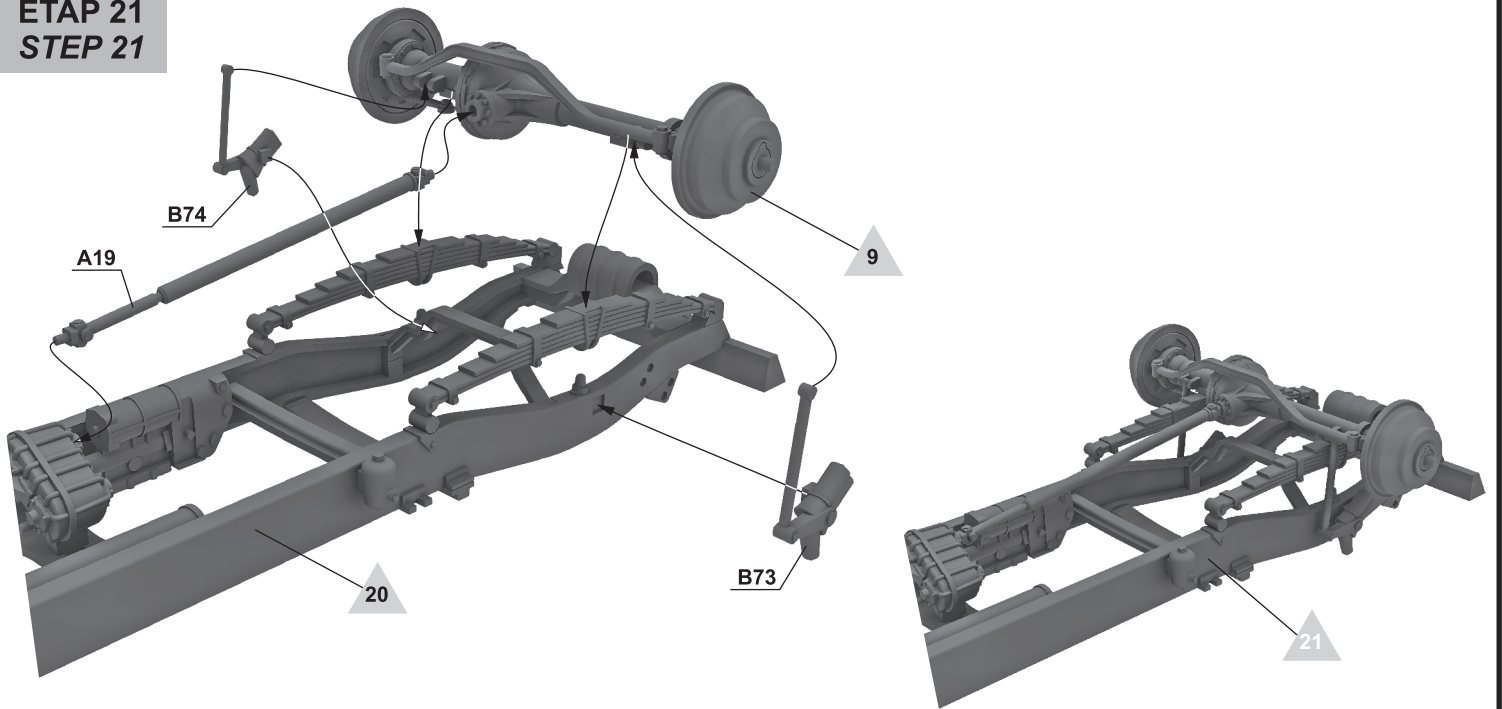

**ETAP 22**  
**STEP 22**

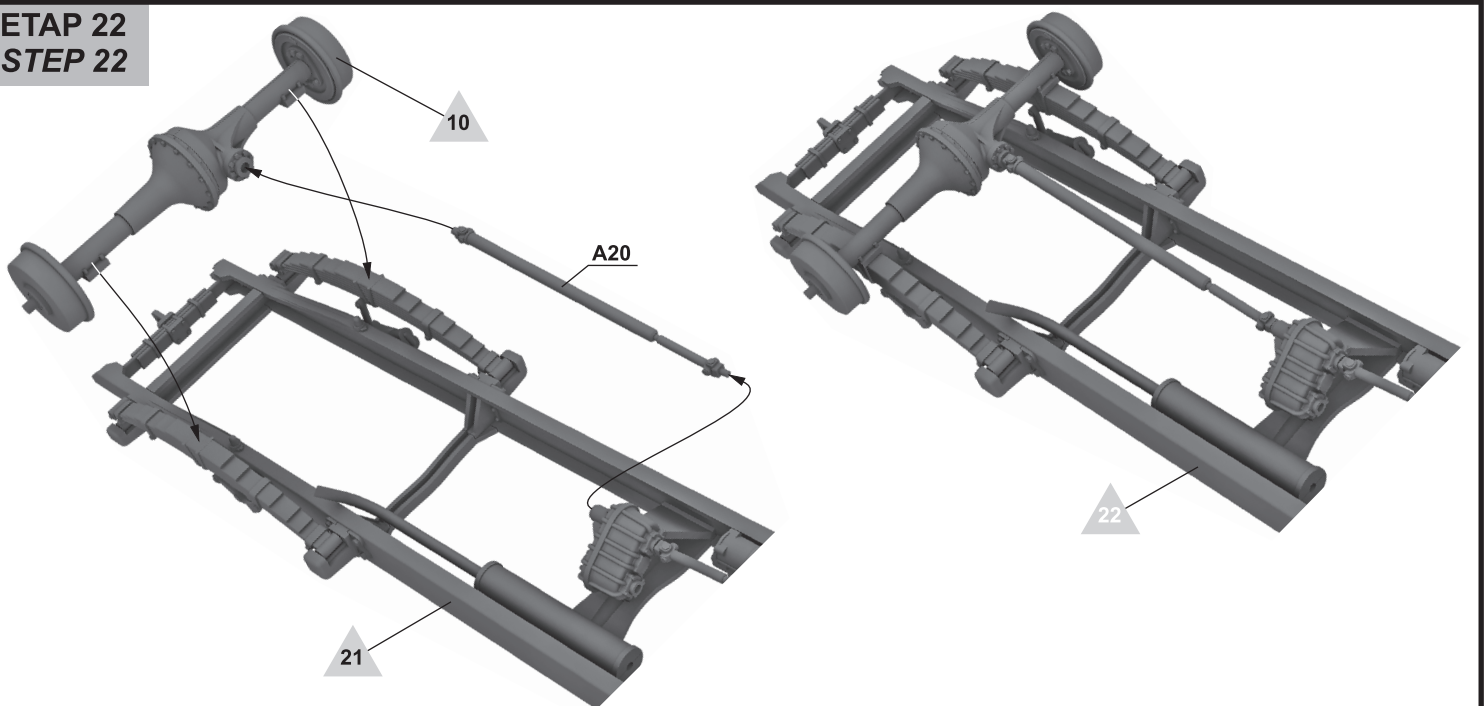

**ETAP 23**  
**STEP 23**

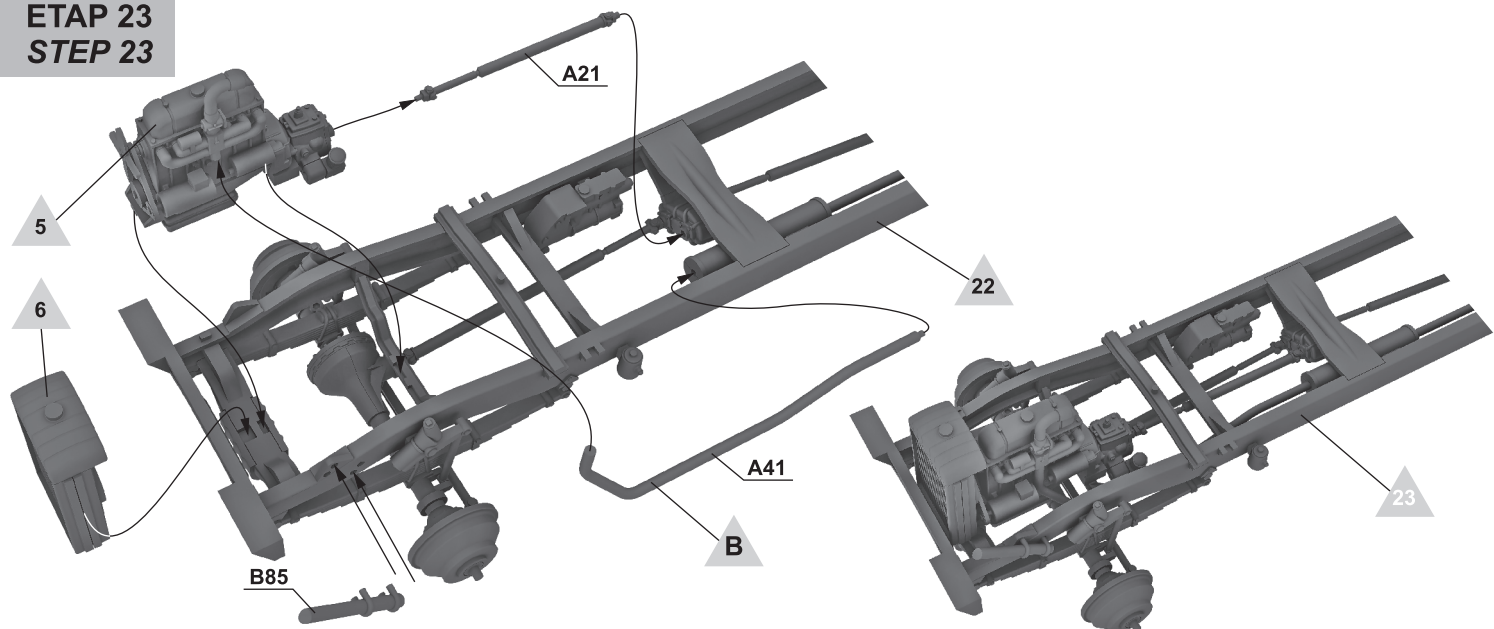

**ETAP 24**  
**STEP 24**

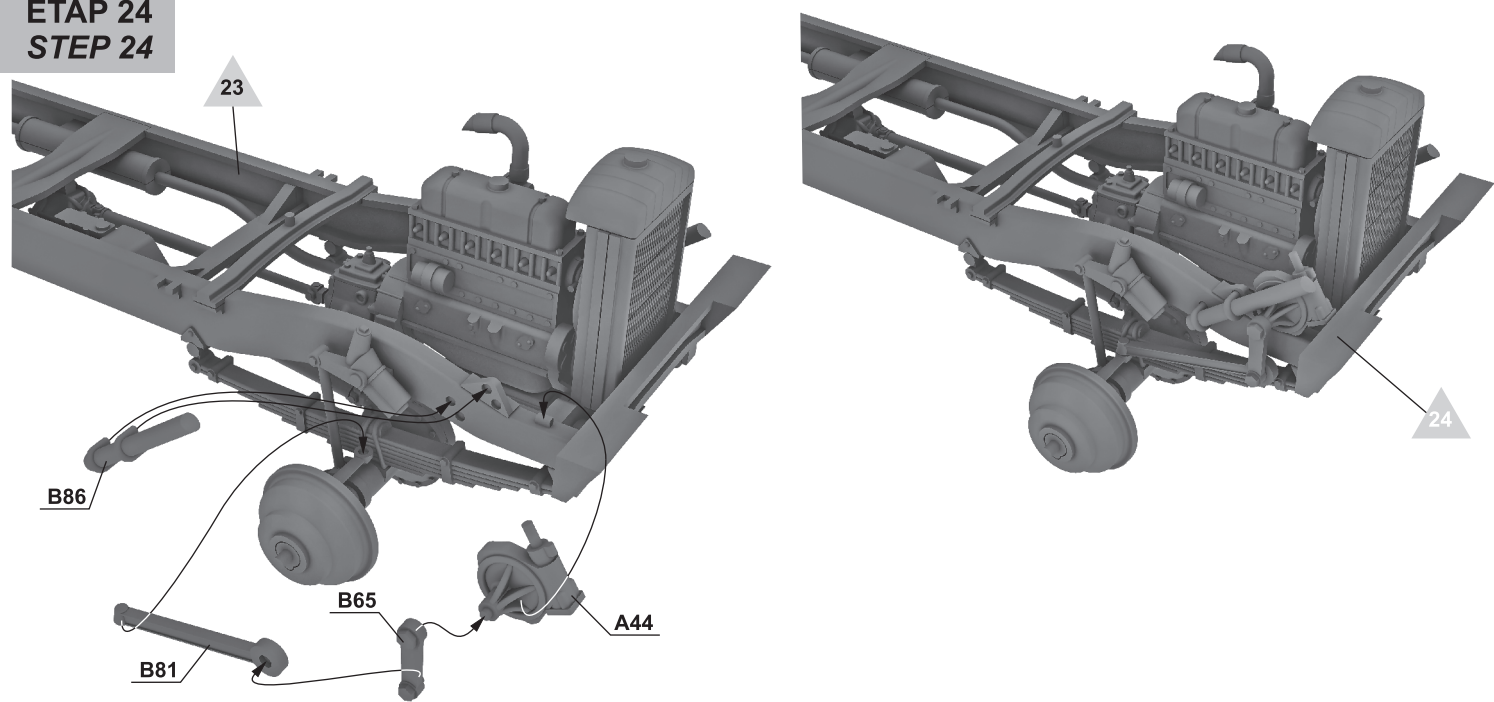

**ETAP 25**  
**STEP 25**

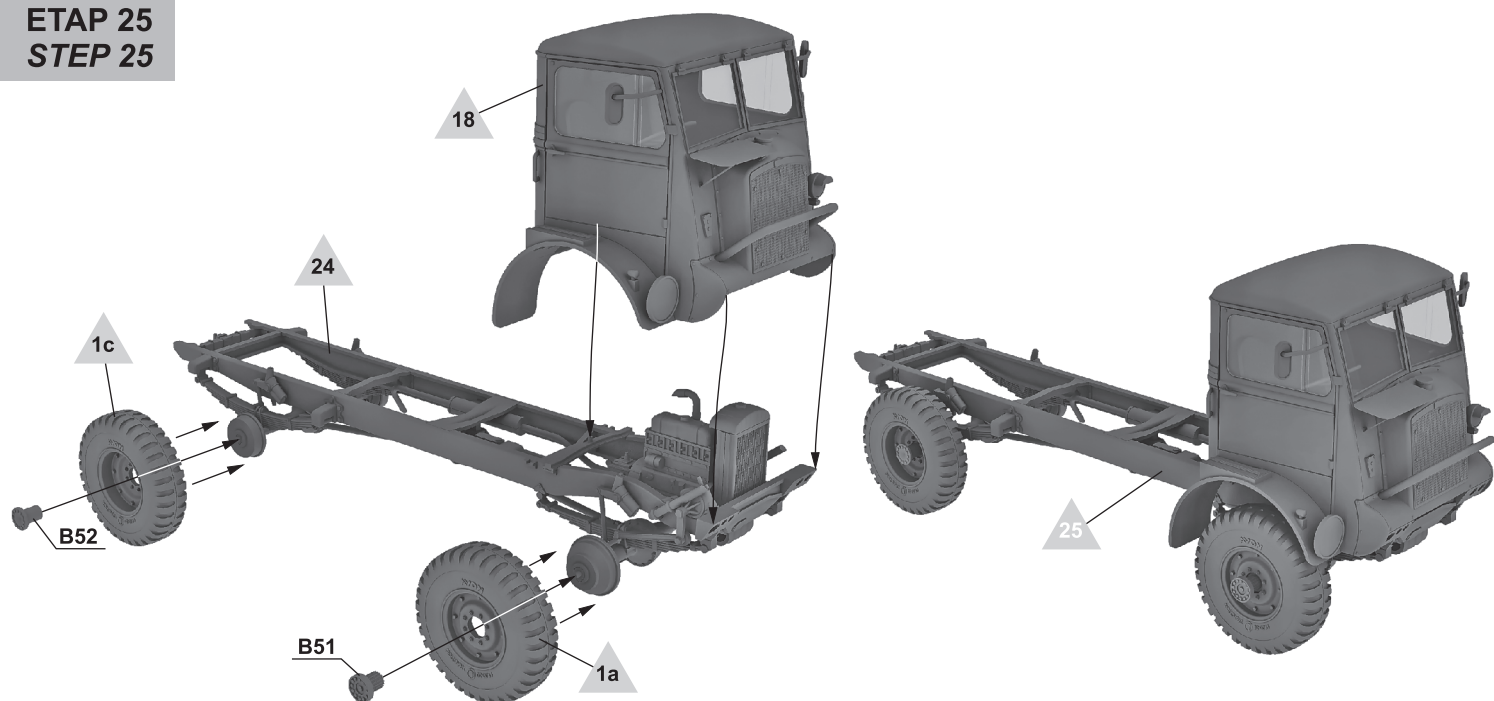

**ETAP 26**  
**STEP 26**

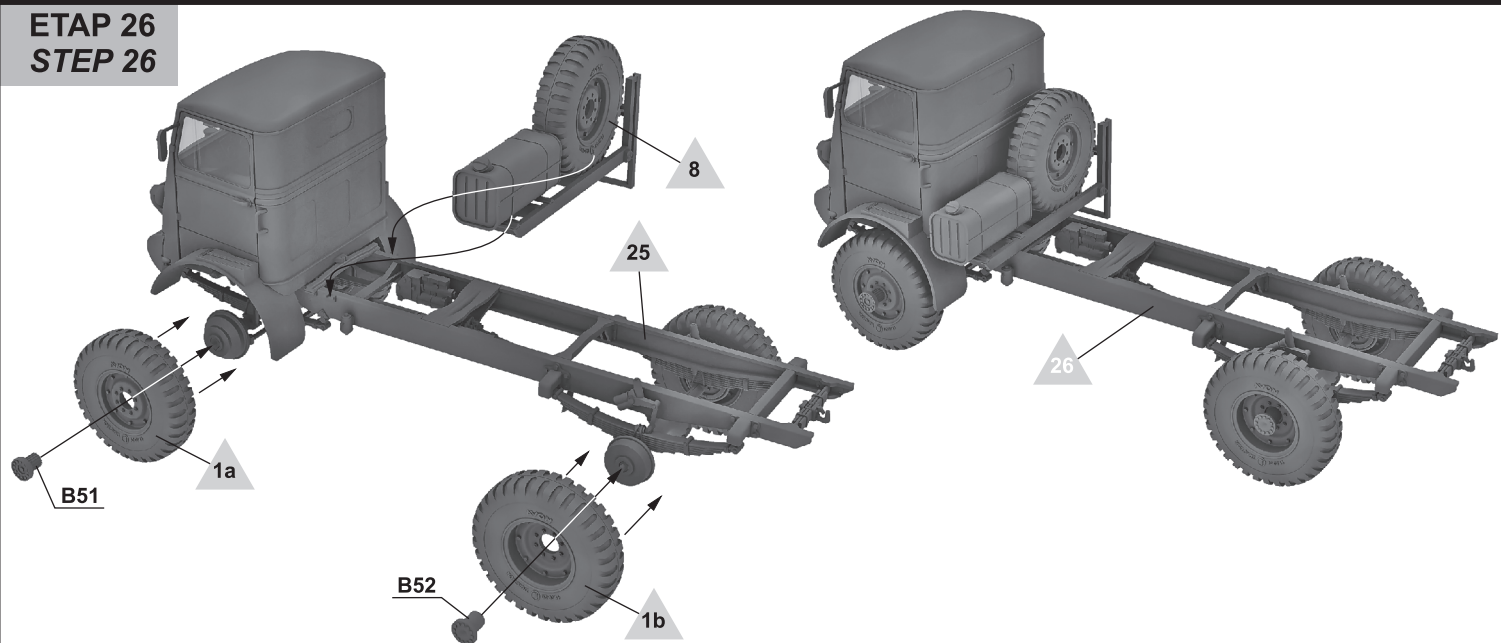

**ETAP 27**  
**STEP 27**

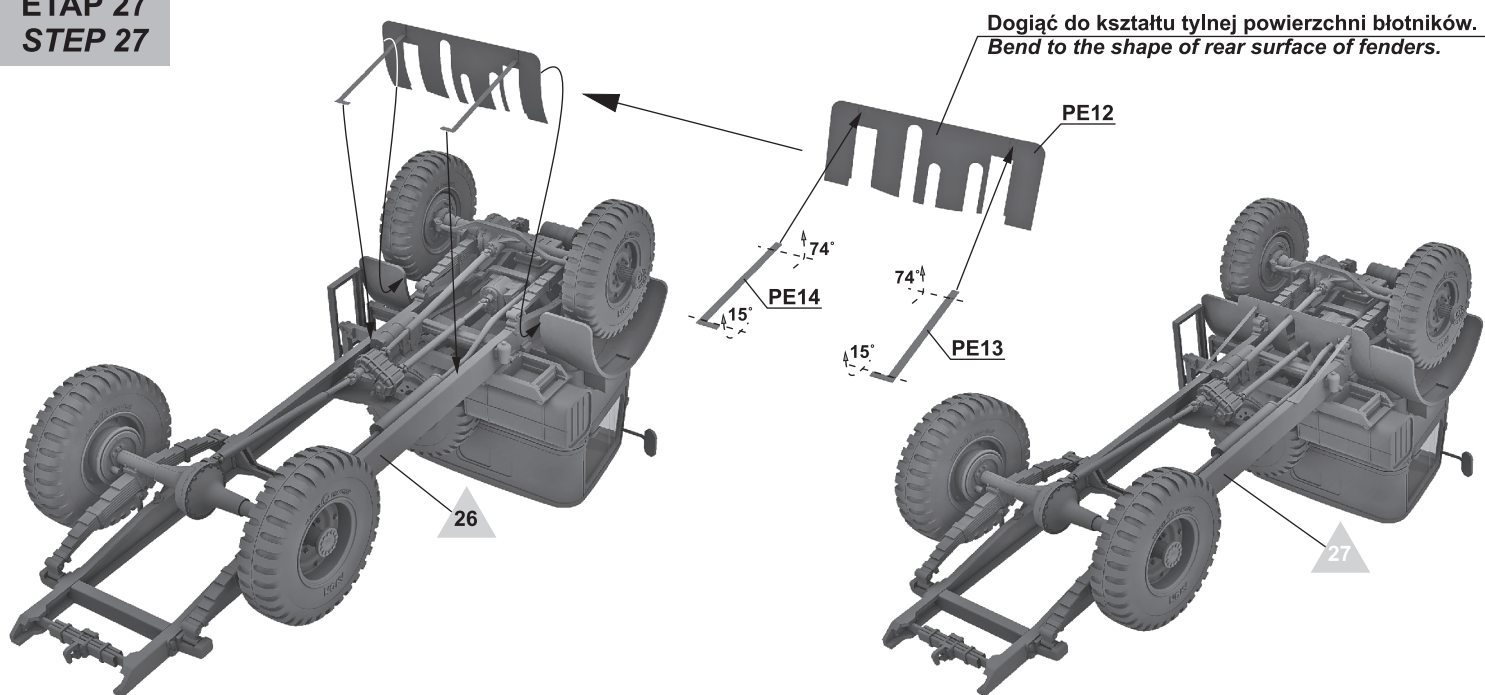

**ETAP 28**  
**STEP 28**

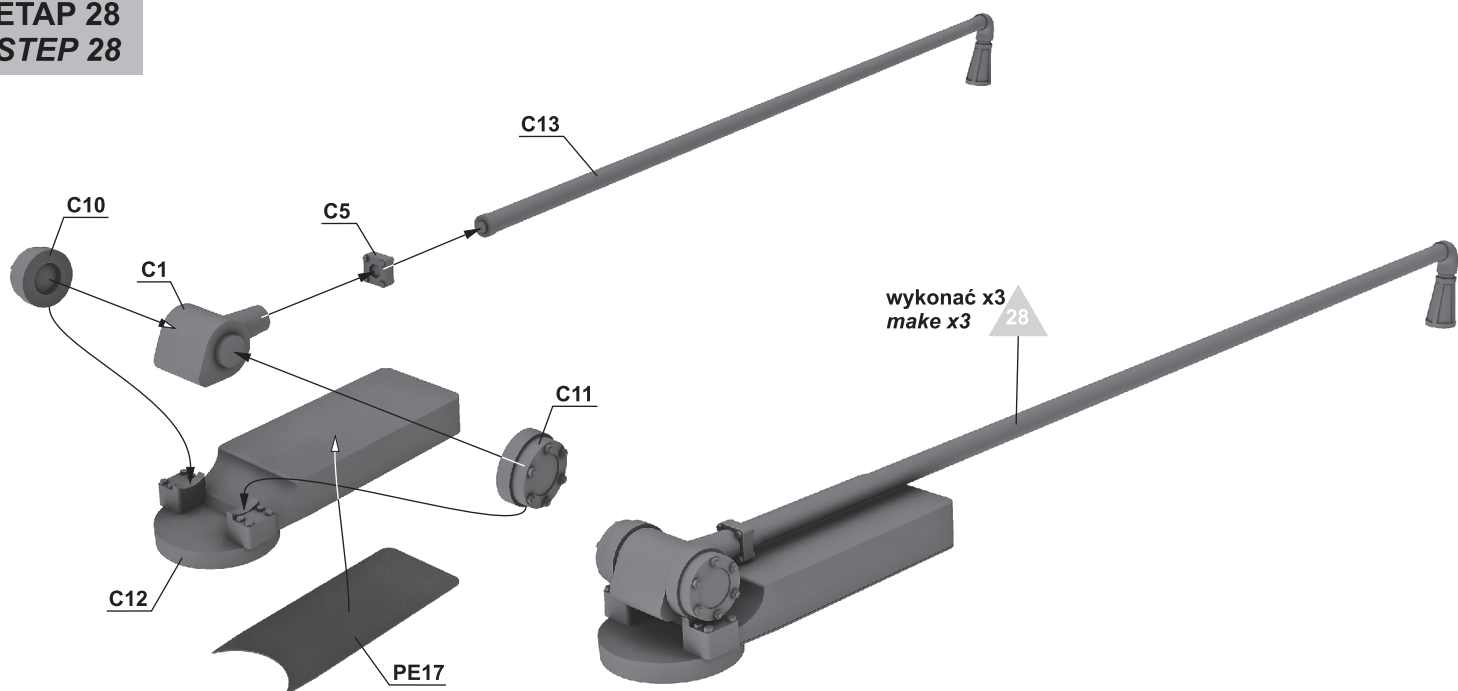

**ETAP 29**  
**STEP 29**

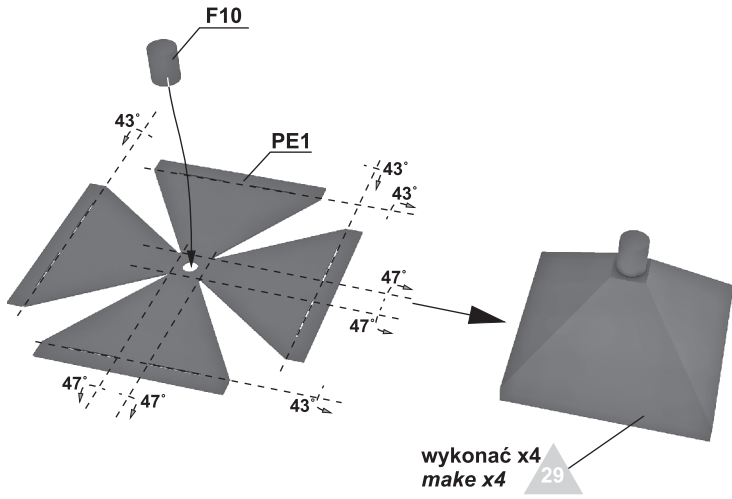

**ETAP 30**  
**STEP 30**

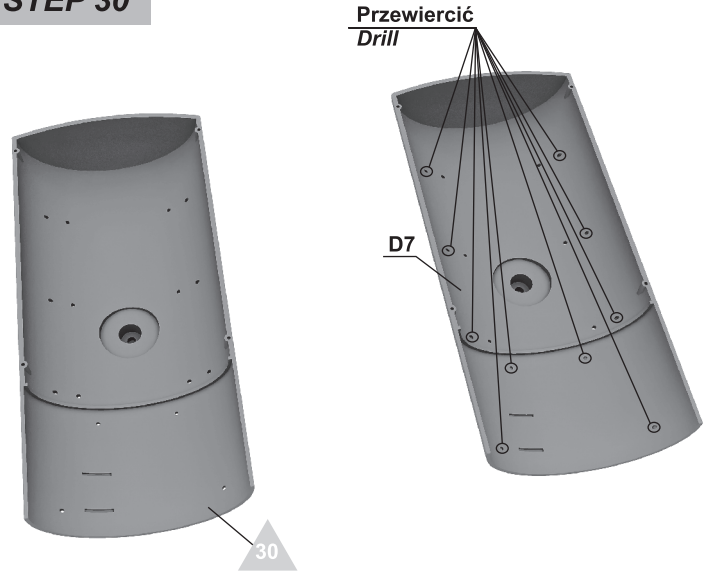

**ETAP 31**  
**STEP 31**

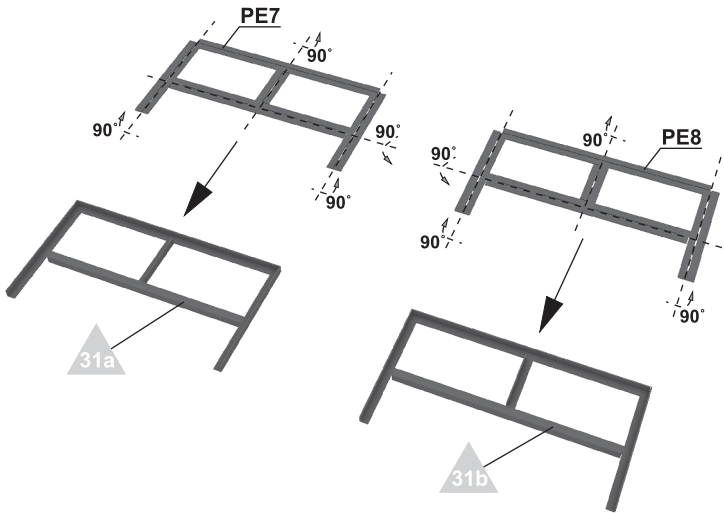

**ETAP 32**  
**STEP 32**

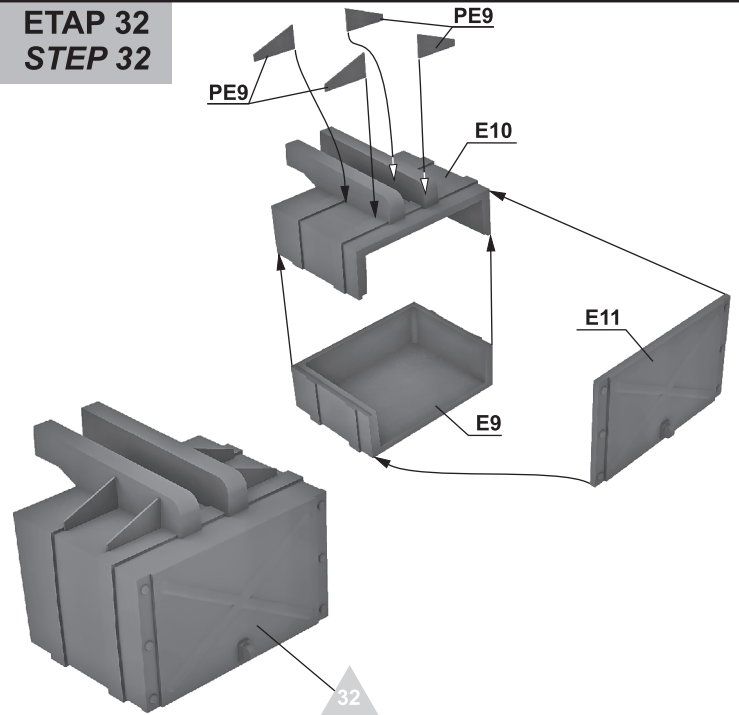

**ETAP 33**  
**STEP 33**

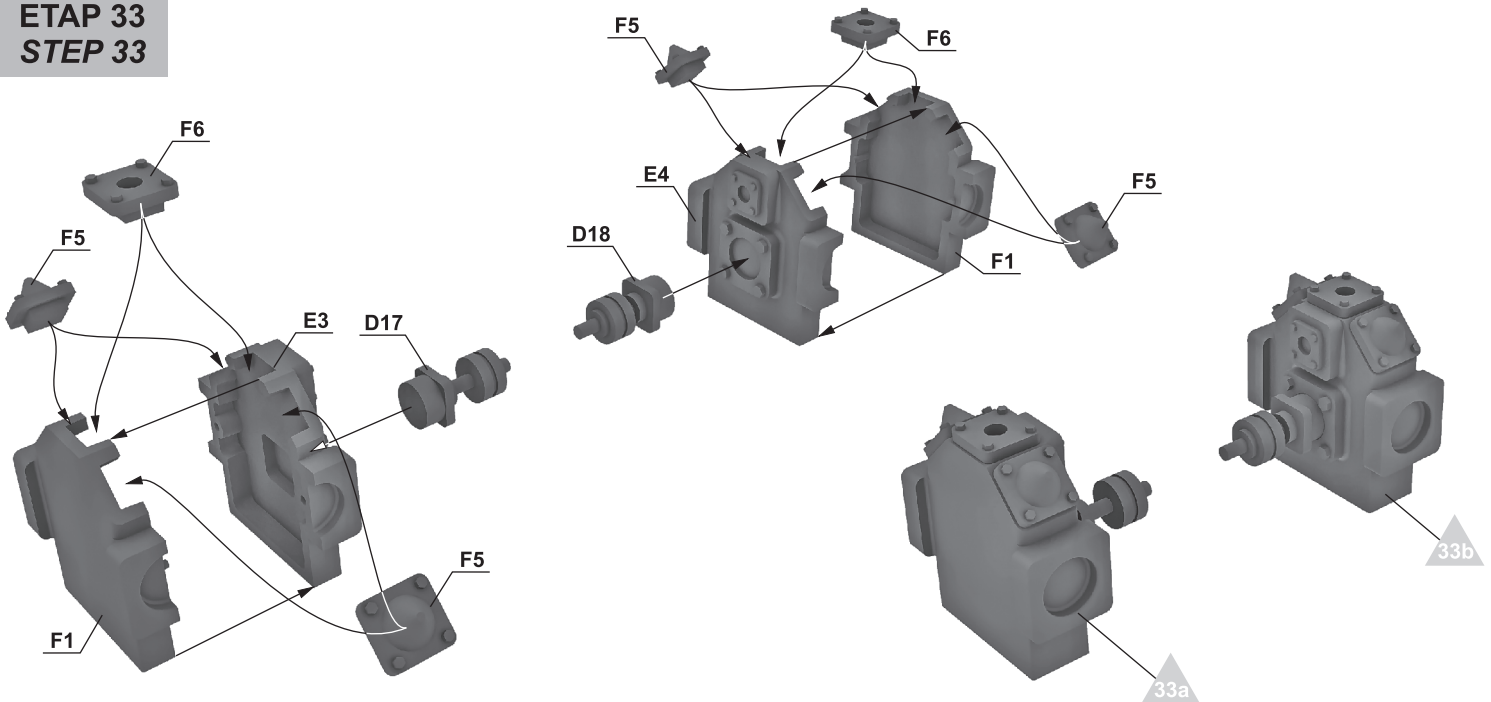

**ETAP 34**  
**STEP 34**

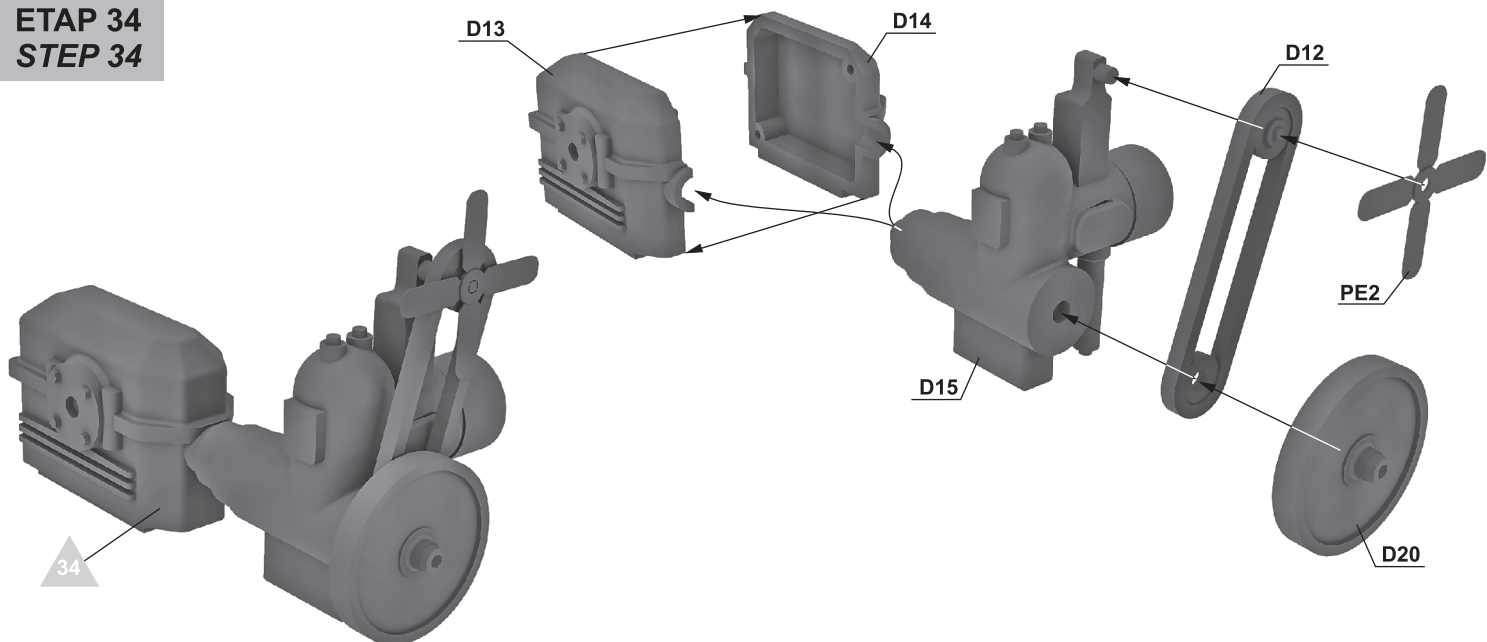

**ETAP 35**  
**STEP 35**

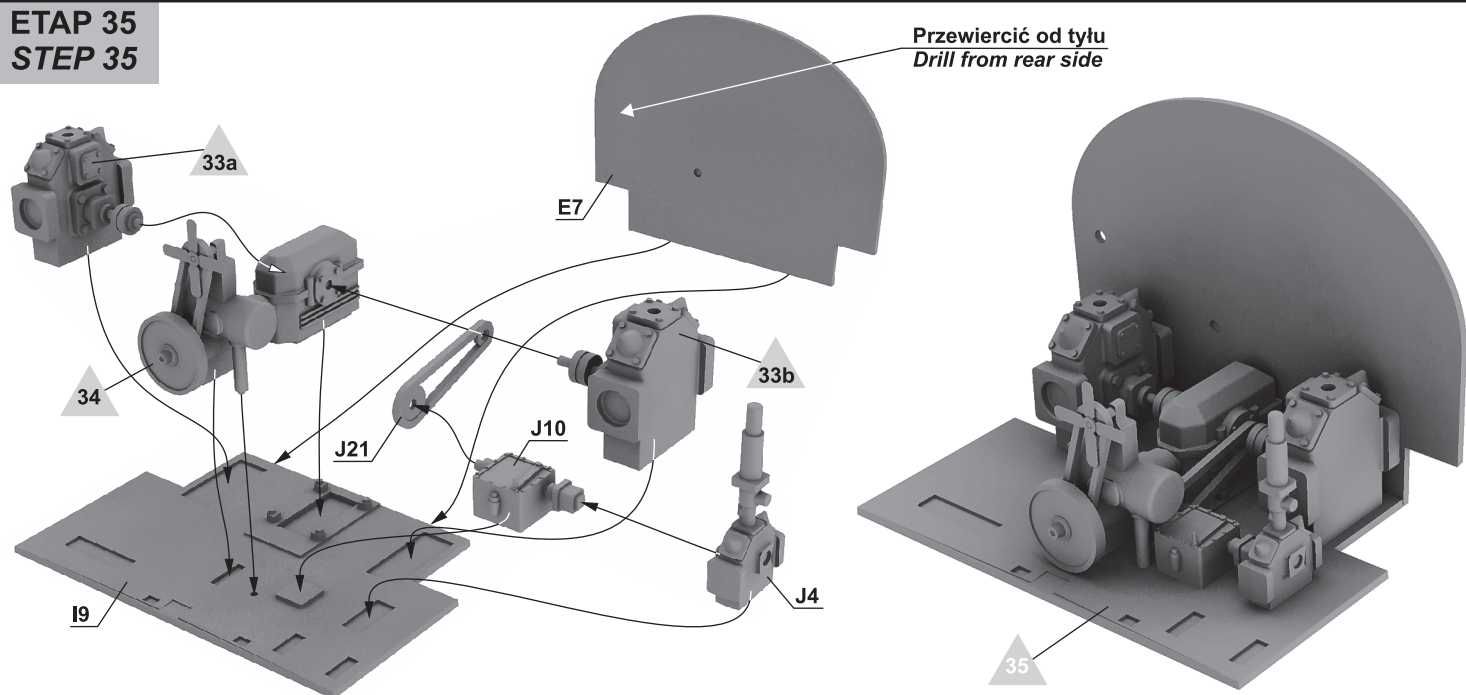

**ETAP 36**  
**STEP 36**

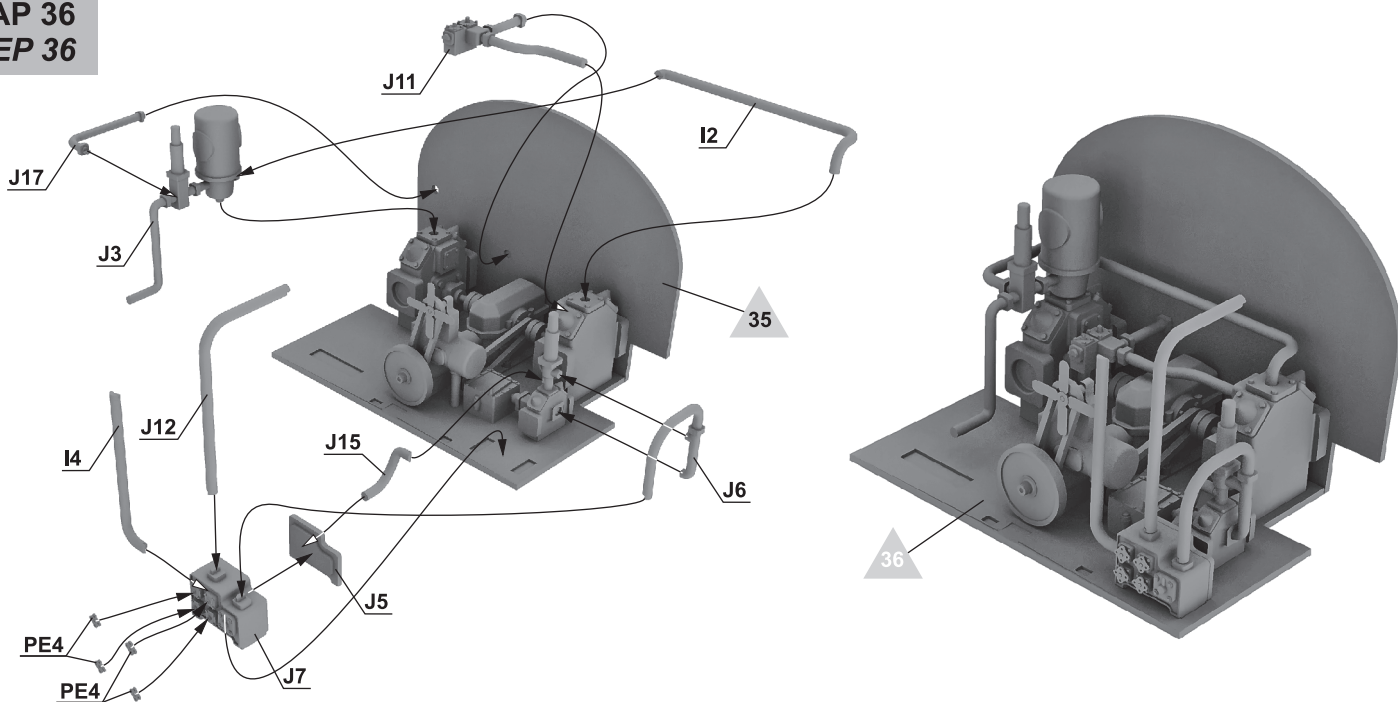

**ETAP 37**  
**STEP 37**

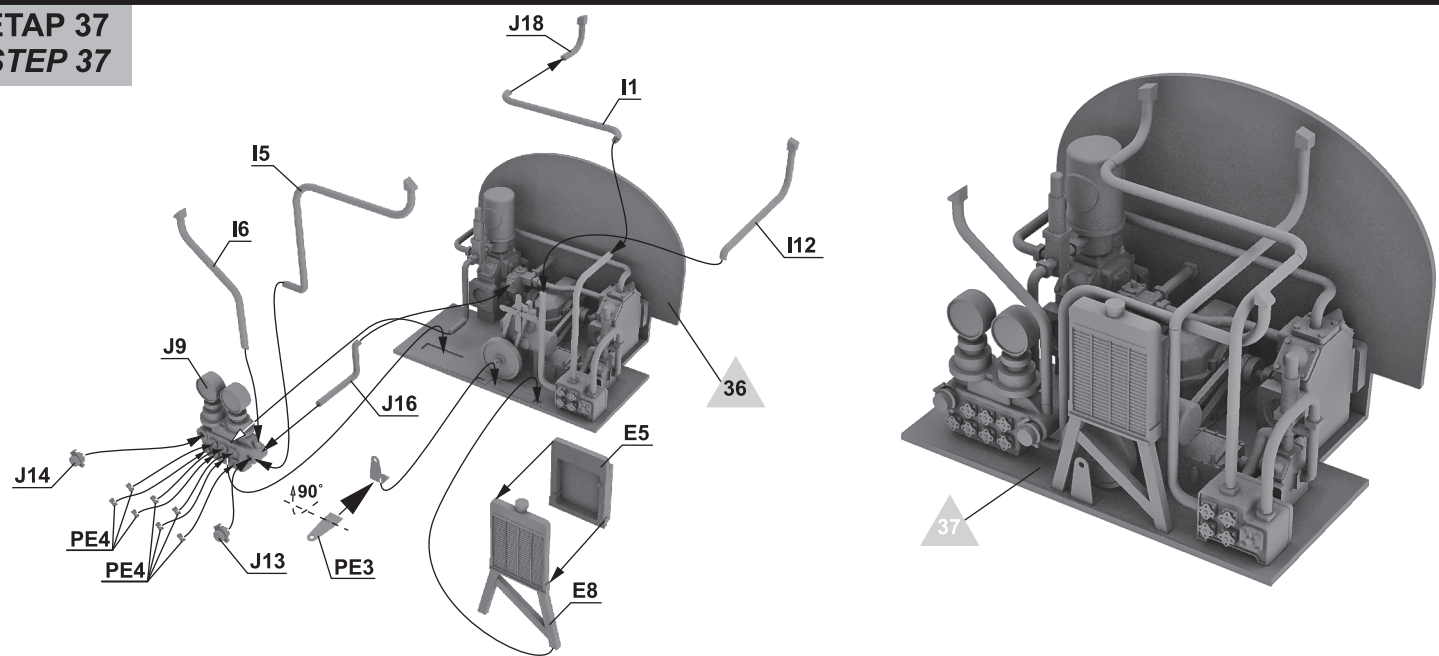

**ETAP 38**  
**STEP 38**

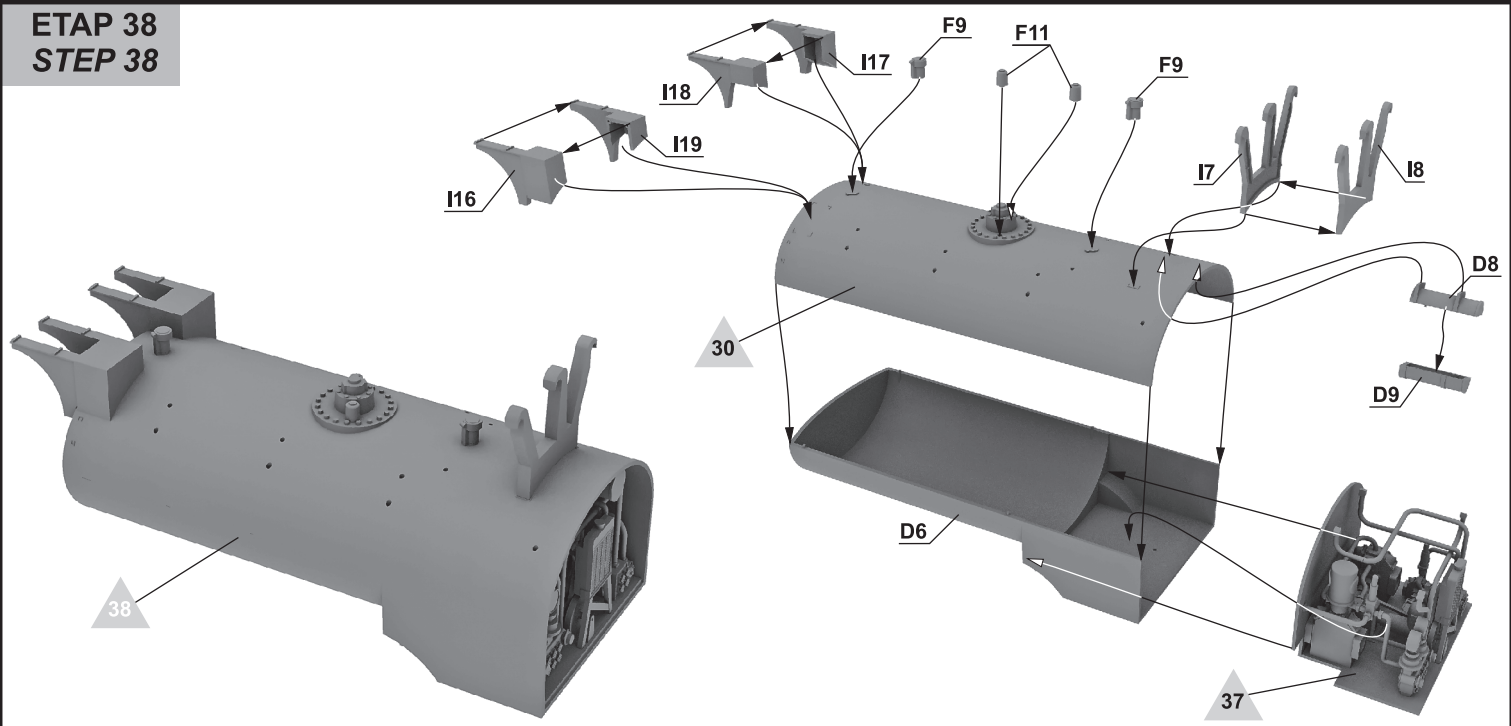

**ETAP 39**  
**STEP 39**

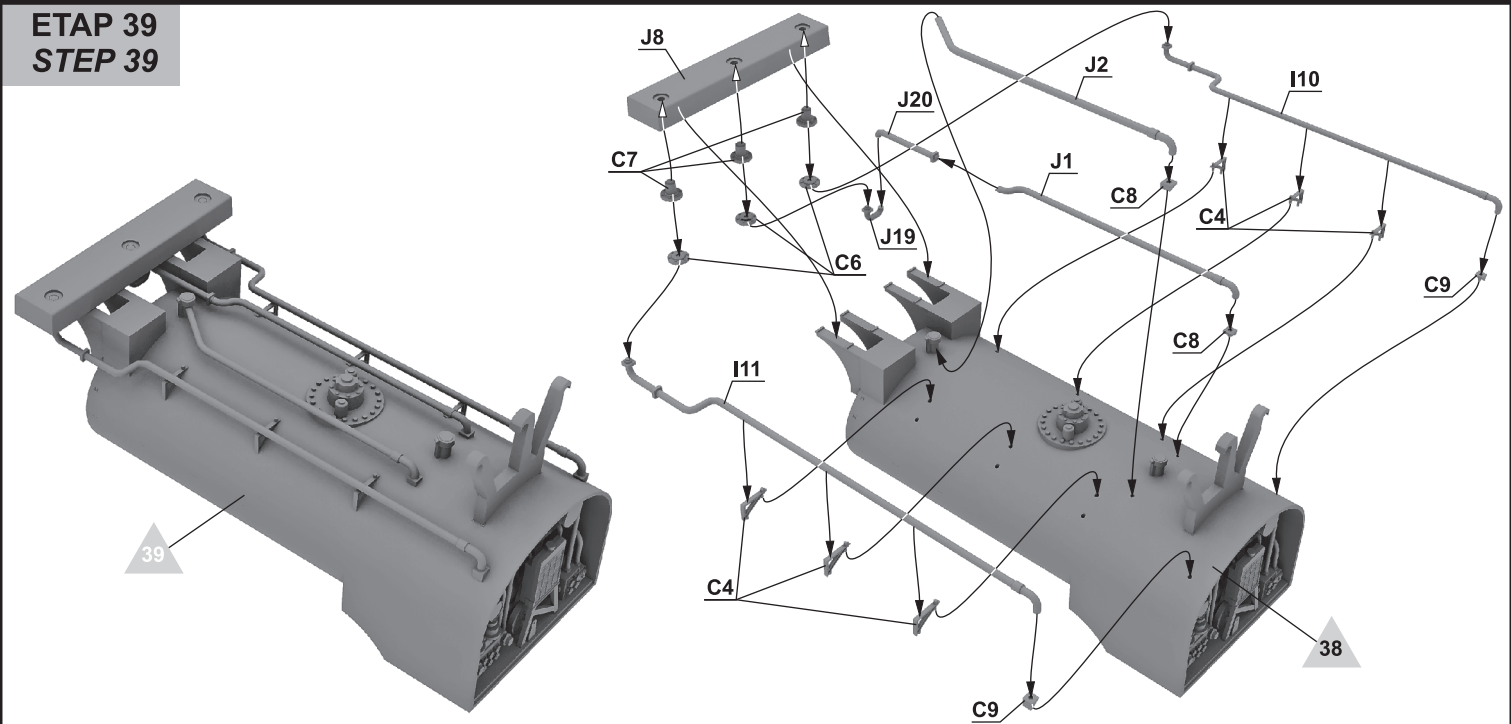

**ETAP 40  
STEP 40**

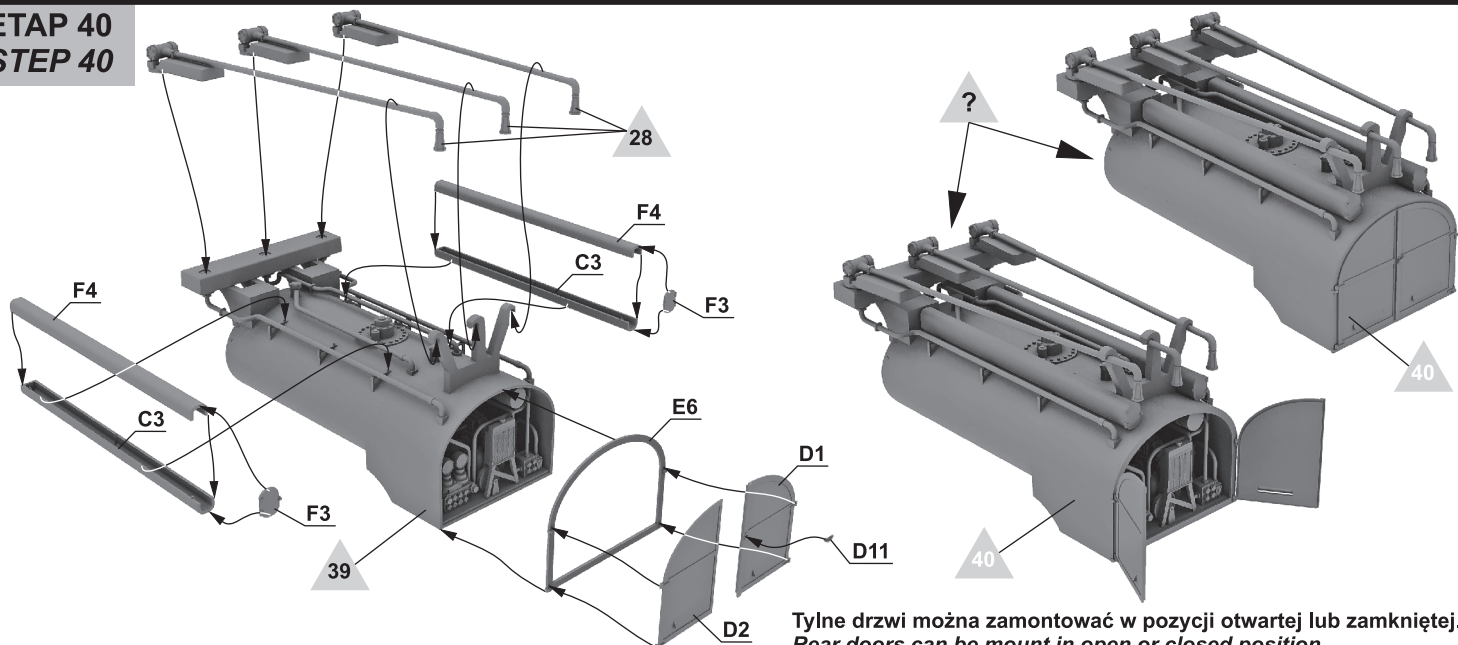

Tylne drzwi można zamontować w pozycji otwartej lub zamkniętej.  
Rear doors can be mount in open or closed position.

**ETAP 41  
STEP 41**

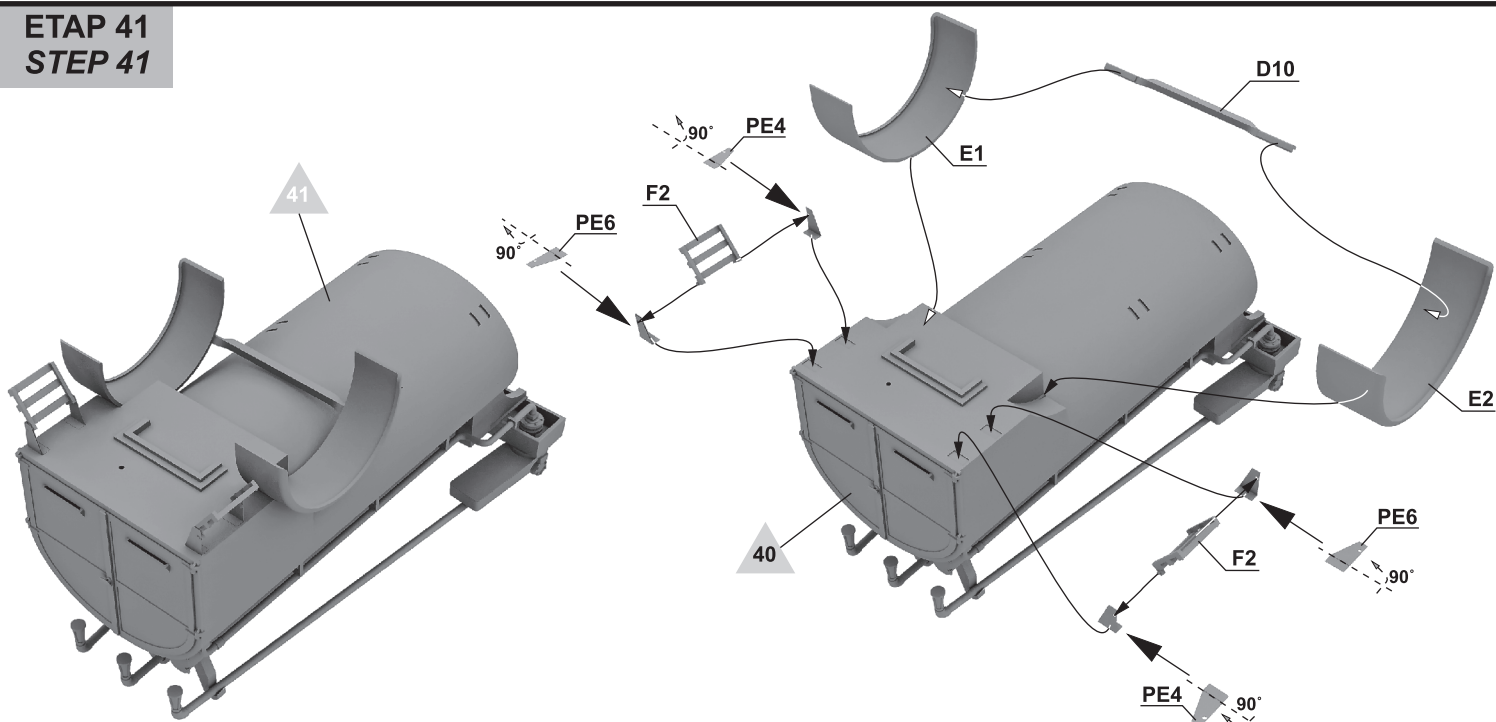

**ETAP 42  
STEP 42**

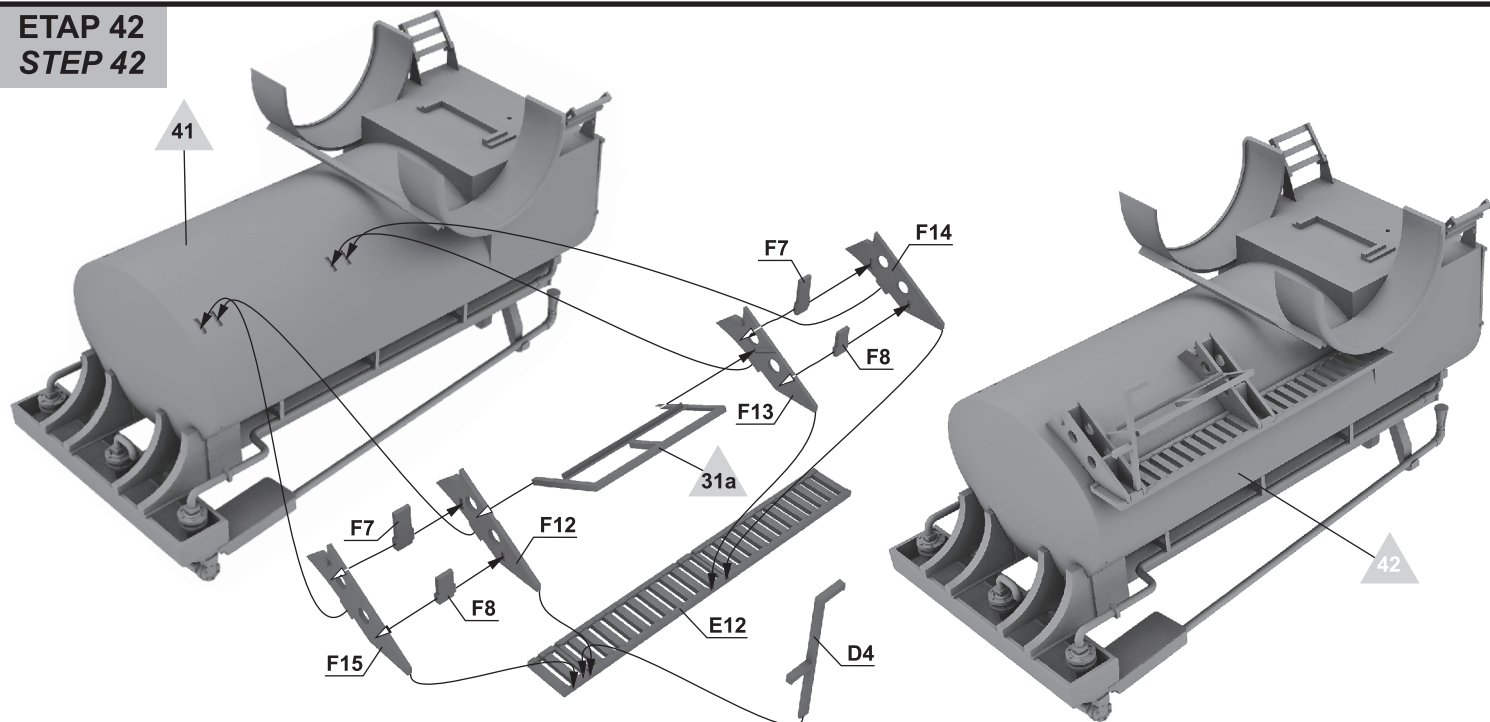

**ETAP 43**  
**STEP 43**

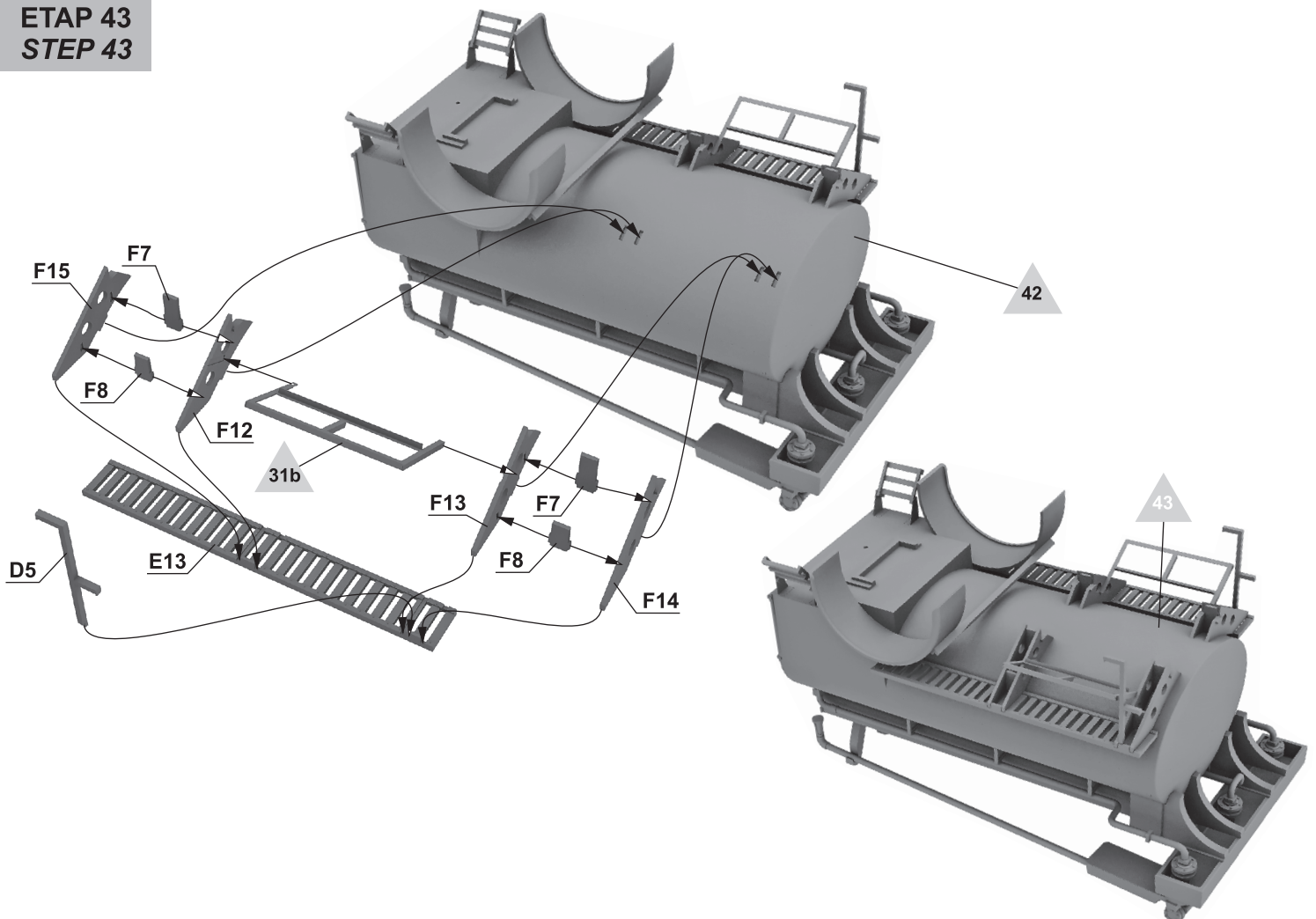

**ETAP 44**  
**STEP 44**

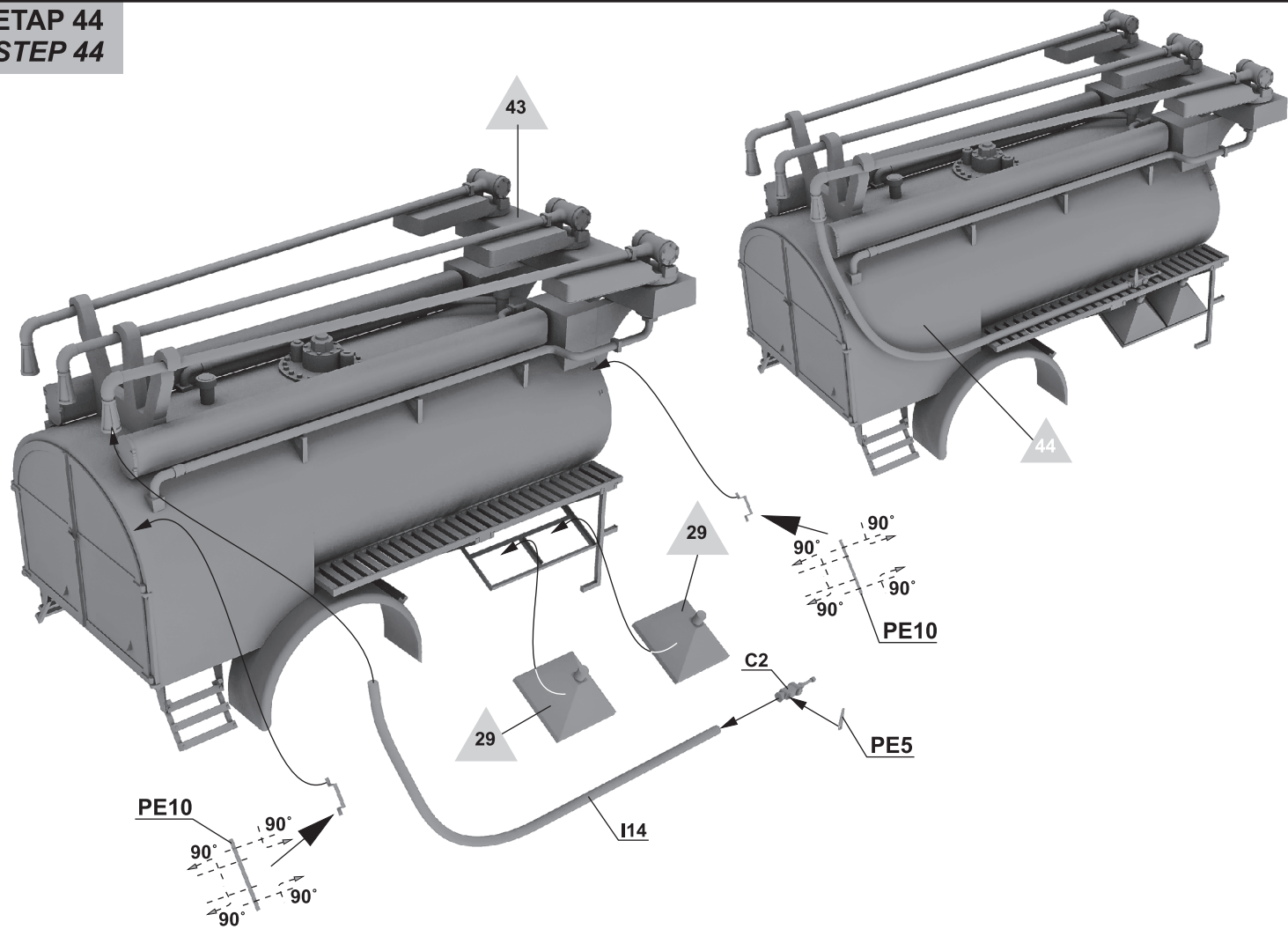

**ETAP 45**  
**STEP 45**

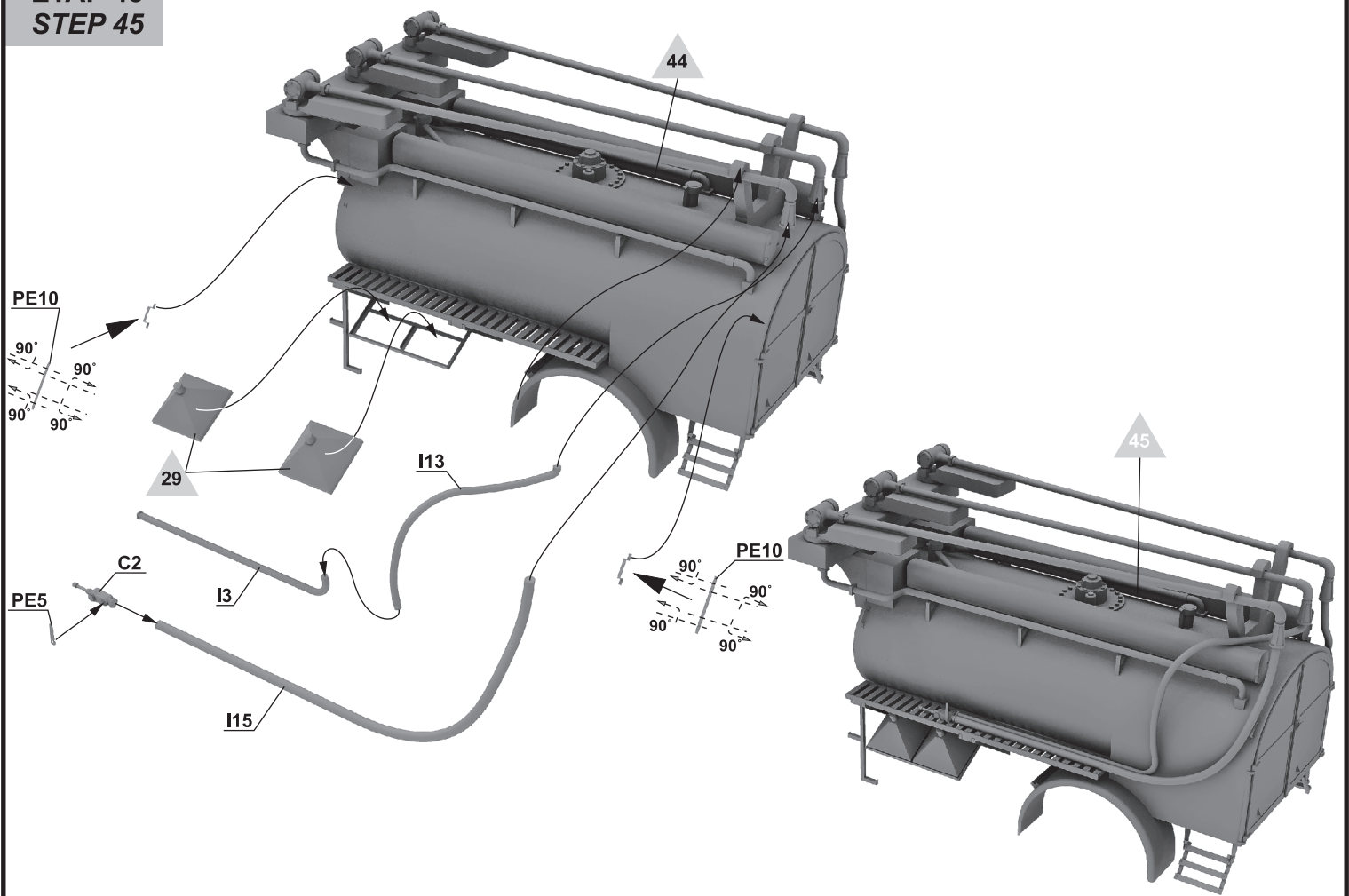

**ETAP 46**  
**STEP 46**

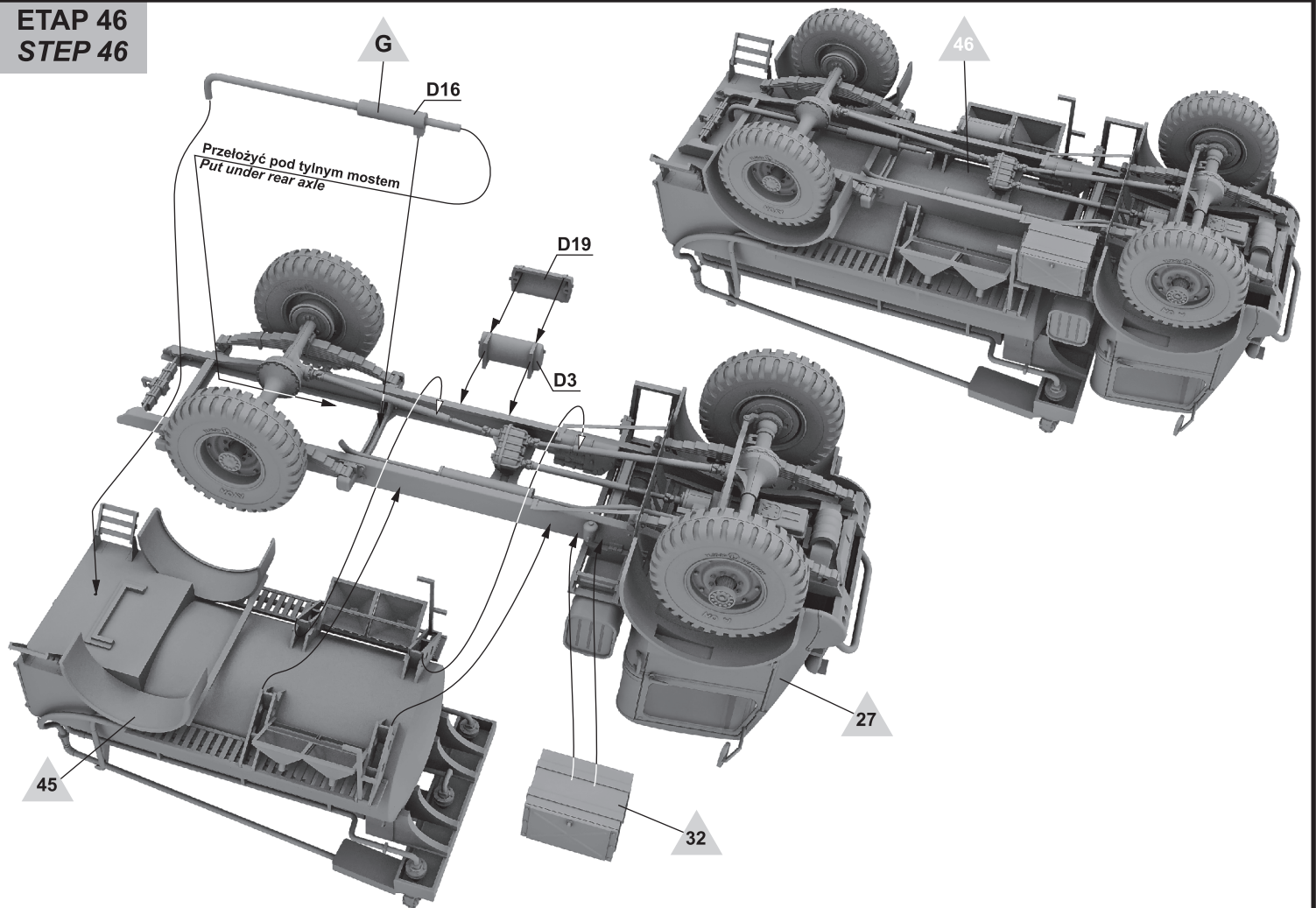

**WYKONANY MODEL**  
**FINISHED MODEL**

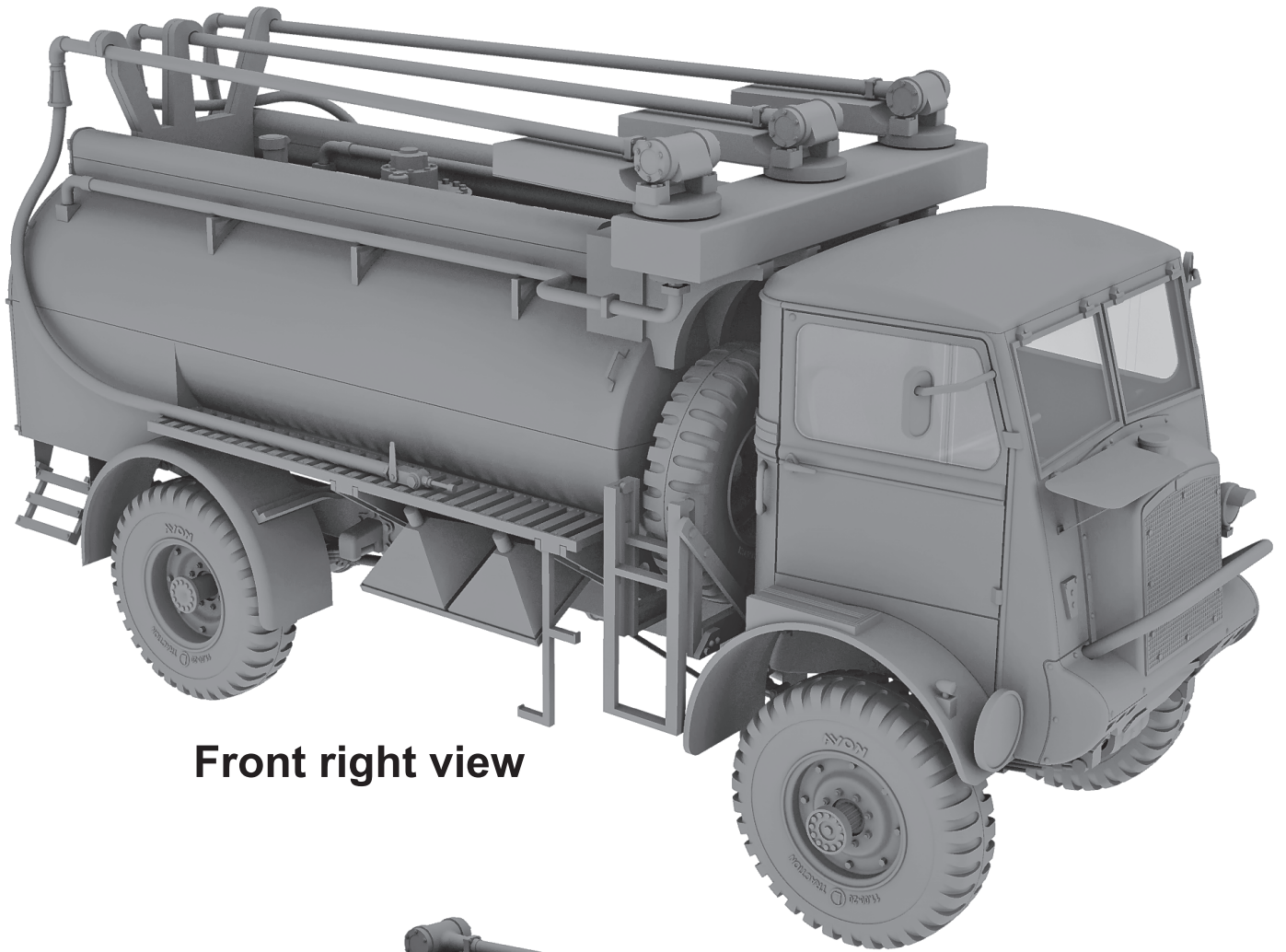

**Front right view**

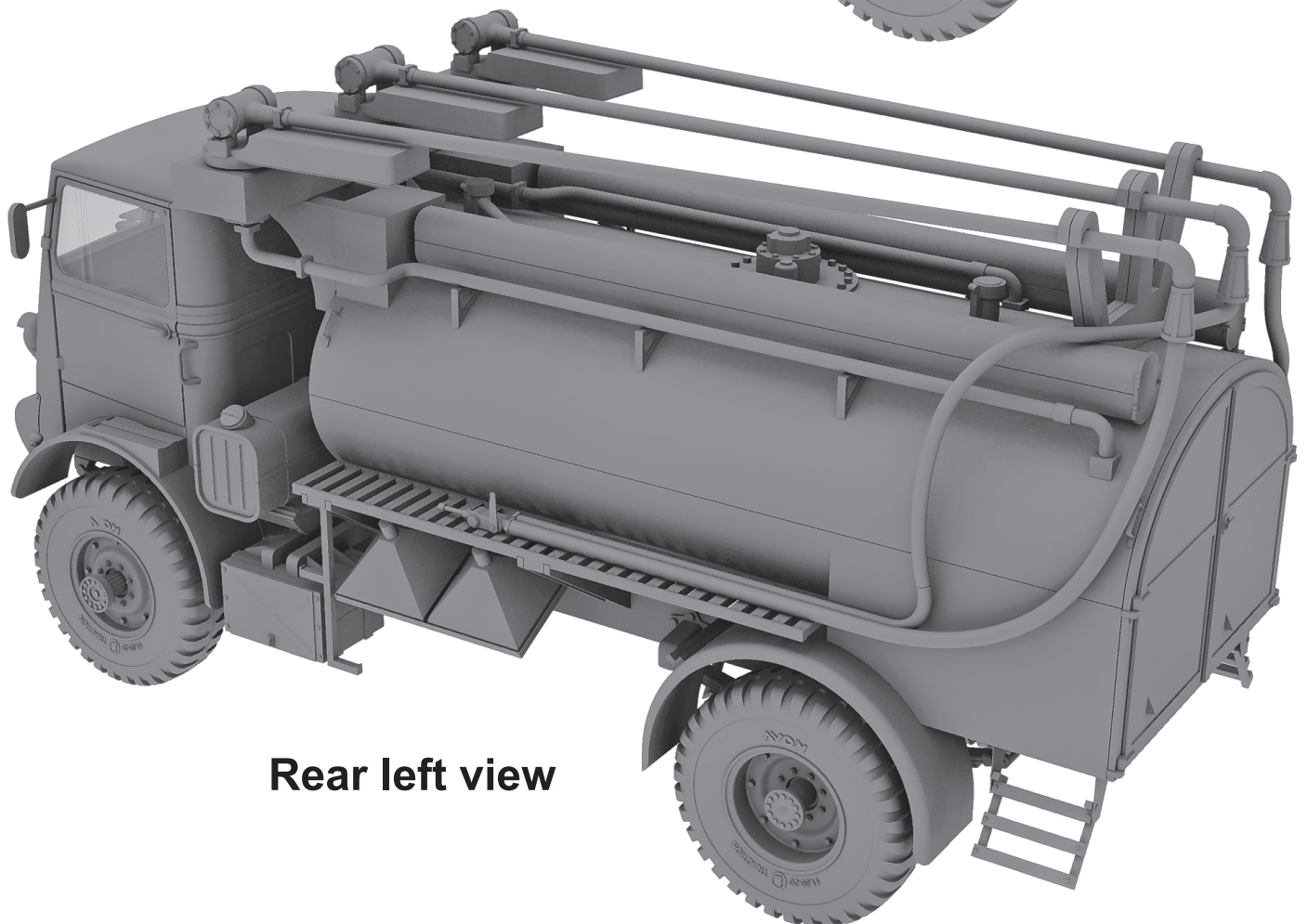

**Rear left view**

**MALOWANIE I KALKOMANIE**  
**COLOURS AND DECALS**

RAF Bedford QL Refueller powojenny, późna wersja z bomami  
17 Dywizjon Royal Air Force  
Wielka Brytania, baza RAF w Chivenor, 1949  
*RAF Bedford QL Post-War Refueller, late version with booms*  
*17 Squadron Royal Air Force*  
*Great Britain, RAF base Chivenor, 1949*

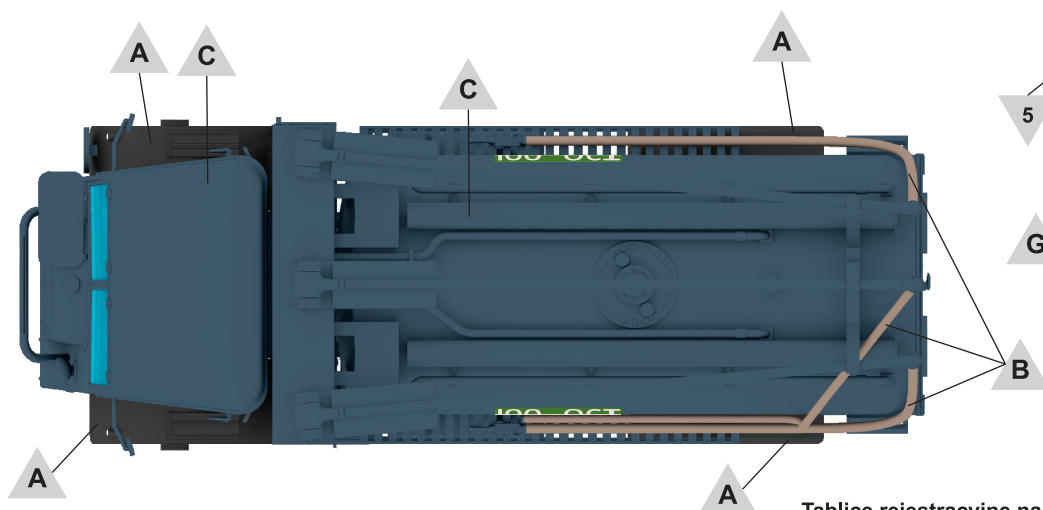
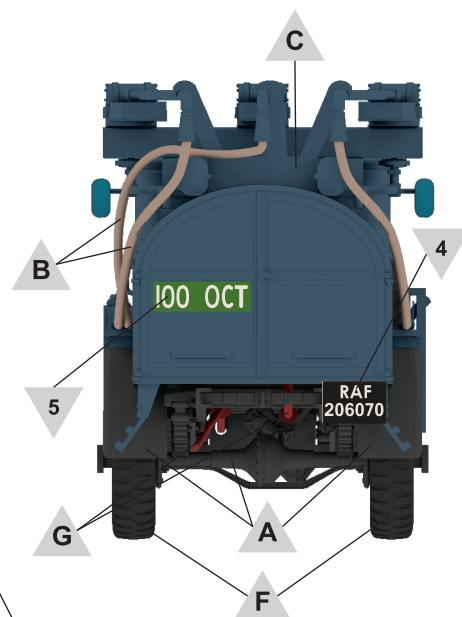
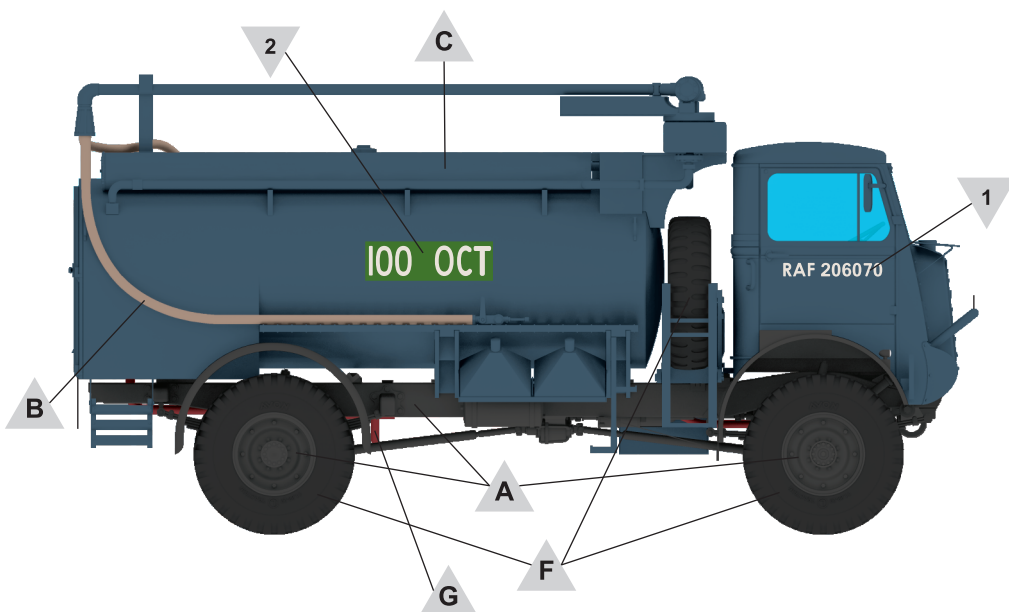
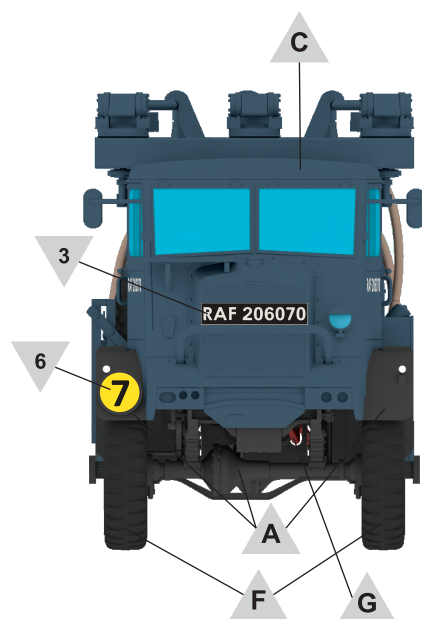
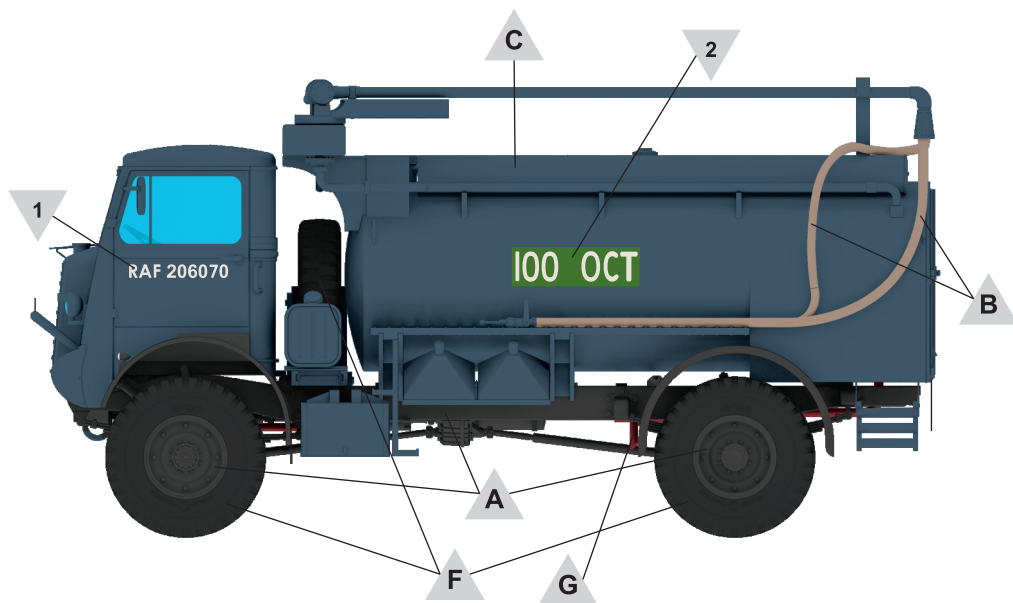

Tablice rejestracyjne nałożyć na przygotowane wcześniej płytki  
o wymiarach 20x4 mm i 12x8 mm.  
*Registration plates please apply on earlier prepared sheets*  
*with dimensions 20x4 mm & 12x8 mm.*

**MALOWANIE I KALKOMANIE  
COLOURS AND DECALS**

RAF Bedford QL Refueller powojenny, późna wersja z bomami  
Niezidentyfikowana zamorska jednostka RAF, lata  
pięćdziesiąte

*RAF Bedford QL Post-War Refueller, late version with booms  
Unidentified RAF overseas unit, 1950's*

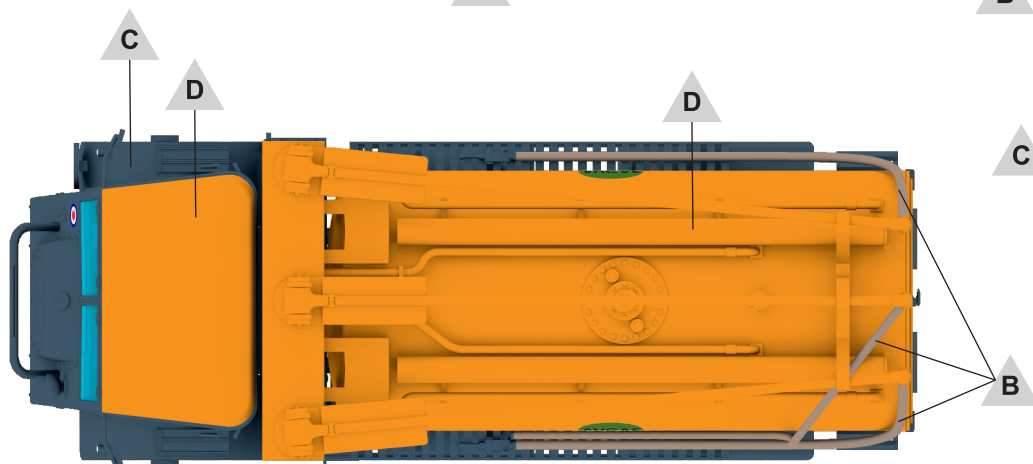
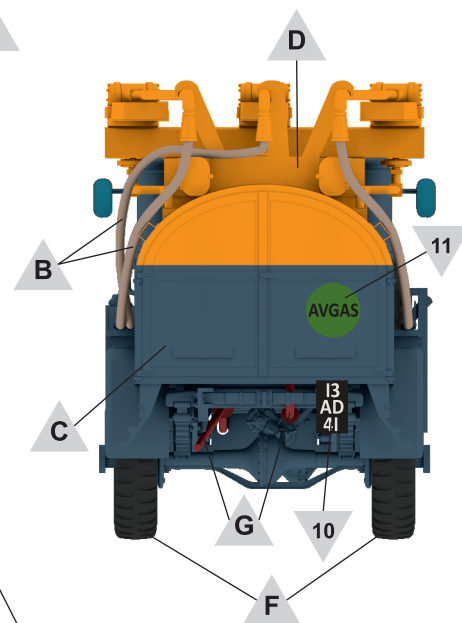
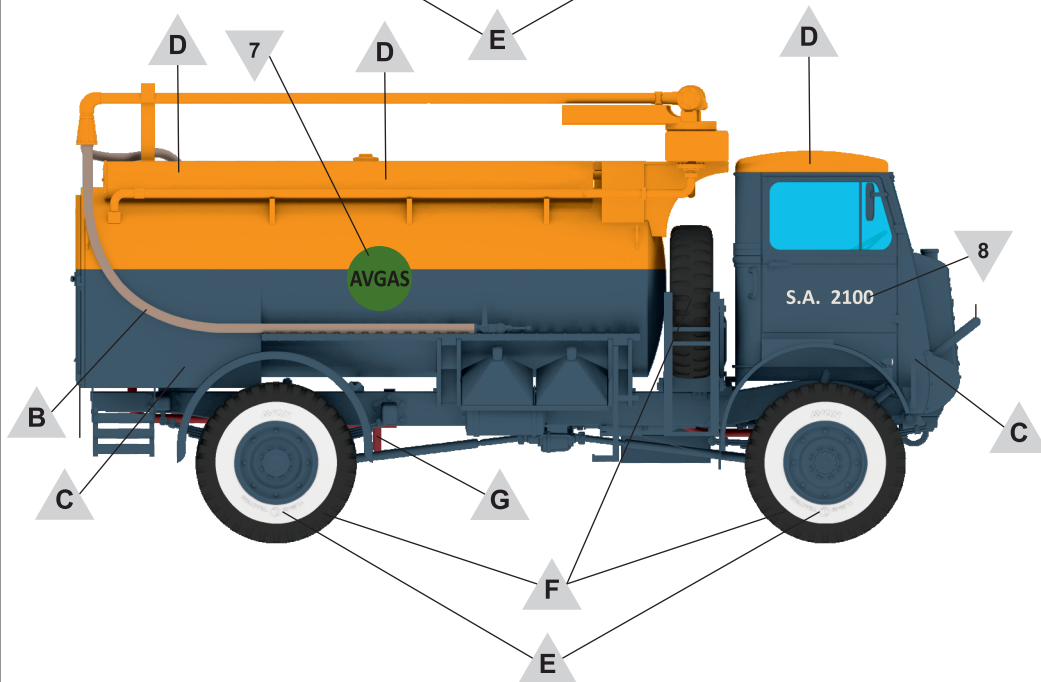
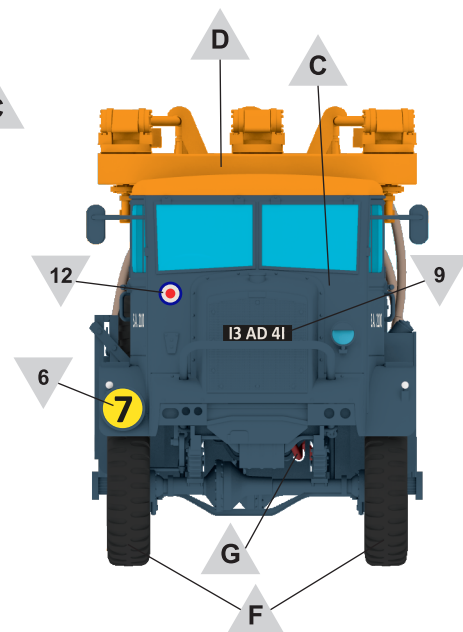
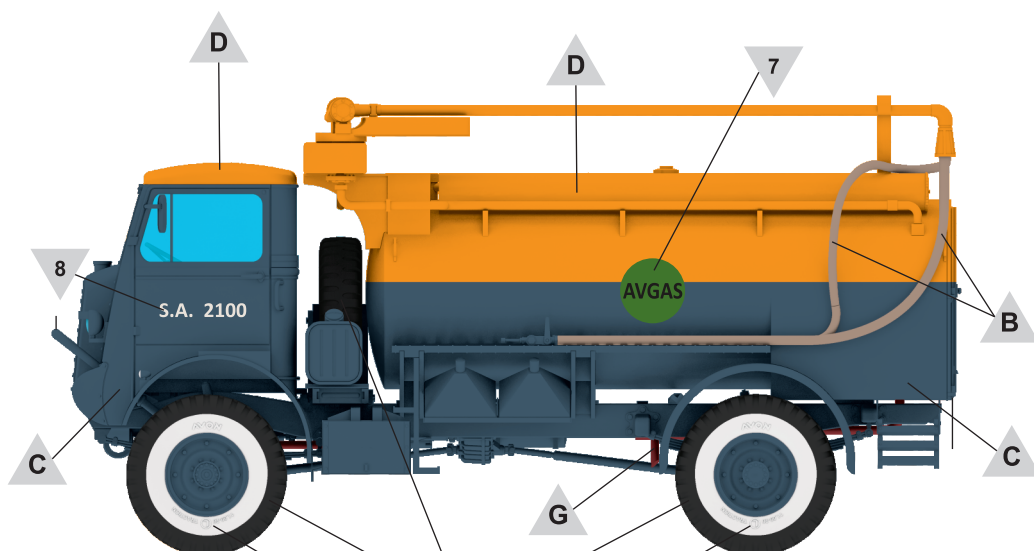

Tablice rejestracyjne należyć na przygotowane wcześniej płytki  
o wymiarach 13x3 mm i 6x10 mm.  
*Registration plates please apply on earlier prepared sheets  
with dimensions 13x3 mm & 6x10 mm.*