

KV-II Russian Heavy Tank

KV-II GIGANT

1/35 MILITARY MINIATURE SERIES

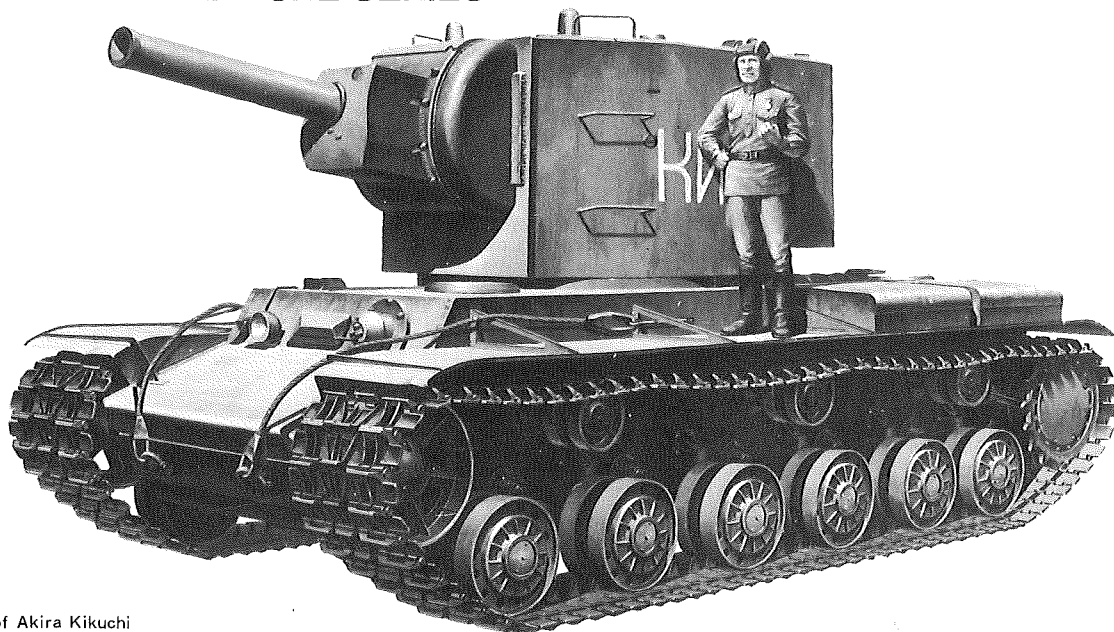

By courtesy of Akira Kikuchi

RUSSIAN KV-II

The narrow strip of land which lies between the Gulf of Finland and Lake Ladoga and in the northwest of Leningrad, former capital of the Russian Empire, is called the Karelian Isthmus. It originally belonged to Finland. In February 1940, a severe war was raging in the Karelian Isthmus dimmed by snow and fog even in the short daytime. The German invasion of Poland in September 1939 had been the fuse which set ablaze the world war. About four weeks later, Poland disappeared from the map of Europe and her territory was annexed to Germany and the Soviet Union. Then, the Soviet Union adroitly absorbed the three Baltic state, Estonia, Latvia and Lithuania. It was under these circumstances that the Soviet Union laid her hands on the Karelian Isthmus which was an eyesore to Leningrad. The Finns offered resistance to the Russians and the Soviet-Finnish War broke out in November 1939.

The Russians could not advance satisfactorily because of snow, forests and the cold. Russian infantry corps came to a standstill at the Finnish Mannerheim Line, field fortifications which the Finns built by using the terrain to the best advantage. Realizing that the Finns would not easily surrender, the Russians immediately organized full-scale attacking troops and sent them to the Karelian Isthmus. These troops formed the Army Group Northwest under the command of General Timoshenko. It was a huge force consisting of the Thirteenth Army with nine divisions, the Seventh Army with twelve divisions, and auxiliary independent units including five independent tank brigades. Now the collapse of the Finnish Mannerheim Line was only a question of time.

The day dawned on 12th February, 1940. It was still foggy but the snowstorm which raged the previous day already blew over. On the Russian front, tanks ready for sortie were producing engine noises. Russian soldiers enveloped in a dense fog were waiting for their tanks. Soon light tanks came one after another. First the silhouette of their turret and gun came in

sight and then their whole body emerged from behind the fog. There were ten tanks of a light tank company. The soldiers watched them in silence. At the sight of huge tanks which appeared next, however, they set up shouts of alarm at the same time. They could not believe their eyes. The tanks nearly four metres high were huge beyond all imagination. The soldiers walked up to the tanks and tapped on their armour as if they had been asking a superman to share his might with them.

This exciting scene took place in the first campaign of the Russian heavy tank KV-II. Unfortunately, the KV-II was to be never received with cheers again. In subsequent campaigns against the invading German troops, this assault gun with a huge turret was used not for its intended purpose of supporting infantry but in counterattacks in vain and revealed its sluggish performance. Like the German heavy tank destroyer "Elephant" which took part in the Battle of Kursk in the summer of 1943, the Russian heavy tank KV-II had the misfortune to find no opportunity of exercising its own power to the full because of tactical error.

The Russians conceived the idea of large support tanks equipped with a powerful howitzer about the time when they decided to develop the heavy tank KV-I. The development of a turret for the 152 mm howitzer started at the same time that engineer Kotin's KV tank design team set to work in February 1939. The 152 mm howitzer (M-1938/40) just completed was a field howitzer with cartridge-type screw breech-block. Since the howitzer used separate-loading ammunition, in which the projectile and propellant were loaded separately, at least four men including the commander were necessary for firing it. In addition, projectiles and propellants occupied much space. Therefore it was natural that the howitzer required a huge turret. Since the turret ring, like that of the KV-I, was limited to about 1.8 metres in diameter in view of the vehicle width, however, it was impossible for the turret to accommodate both the four men and carriage. Thus the original turret had to be replaced with a tall one of the platform

type which looked like an additional compartment mounted on the body of the vehicle. On the basis of the elaborated original idea, the tank was protected with heavy armour—frontal armour was 110 mm in thickness and side armour was 75 mm. As a result, the vehicle weight reached no less than 52 tons.

A prototype of the KV-II was completed in November 1939, by which time that of the KV-I had already appeared, and immediately put to tests. As a result, it proved to have a serious disadvantage because its turret was too heavy. Weighing several tons, the turret did not revolve well when the tank was on slopes whether it was running or not. It was unfortunate for the KV-II that the Soviet-Finnish War broke out in that month. The Russian military authorities regarded the KV-II as the tank best suited for attacking fortified positions. Thus the KV-II entered production without undergoing substantial improvements in the turret which did not always revolve well.

The correctness of the Russian military authorities' judgement was proved by the fact that the KV-II contributed much to the successful breakthrough of the Finnish Mannerheim Line on 16th February, 1940. Full General G. I. Antonov wrote about the activity of the KV-II as follows:

"It was several KV-II tanks armed with the 152 mm howitzer that enabled us to bring about a decisive change in the aspect of the war i.e. the breakthrough of the fortified line. They overwhelmed enemy fire arms in shelter trenches and gave our engineers a chance to destroy enemy positions and barriers. Thus our artillery could turn their efforts to the bombardment of enemy positions farther in the rear in order to check Finnish counterattacks." This turned out to be the only distinguished service of the KV-II which in other operations could not exercise its own power to the full because of tactical error. The Russian idea of support tanks, however, was never scrapped and several years later gave birth to the tank destroyer SU-152.

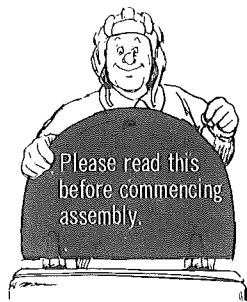

- ★ Study the instructions and photographs before commencing assembly.
- ★ You will need a sharp knife, a screw-driver, a pair of pliers, and a file.
- ★ Do not break parts away from sprue, but cut off carefully with a sharp knife or a pair of pliers.
- ★ Use glue sparingly. Use only enough to make a good bond. Apply cement to both parts to be joined.

 This mark denotes numbers for Tamiya Paint Colors.

1 (Construction of Wheels)

Each Wheel has a Poly Cap. Never put cement on Poly Caps.

2 (Fixing of Lower Hull Parts)

Each Drive Sprocket and Idler Wheel should be just fitted in place. Do not cement them. For B1 and B2, see the figure below.

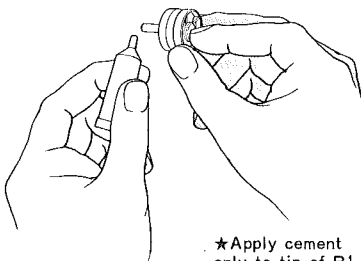

★ Apply cement only to tip of B1.

(Construction and Fixing of Figure)
The model figure should be either fixed in the Lower Hull or Turret, or stood outside the model tank. If you hope to fix it in the Lower Hull or Turret, mount only its upper half on the base.

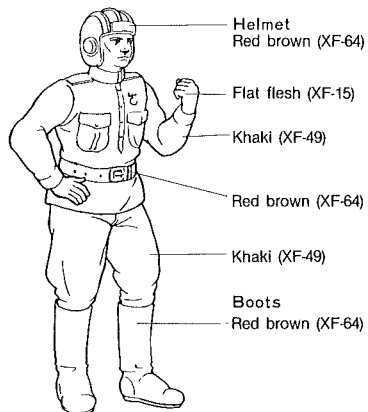

★ When you fix Figure to Upper Hull, do not use Lower Half.

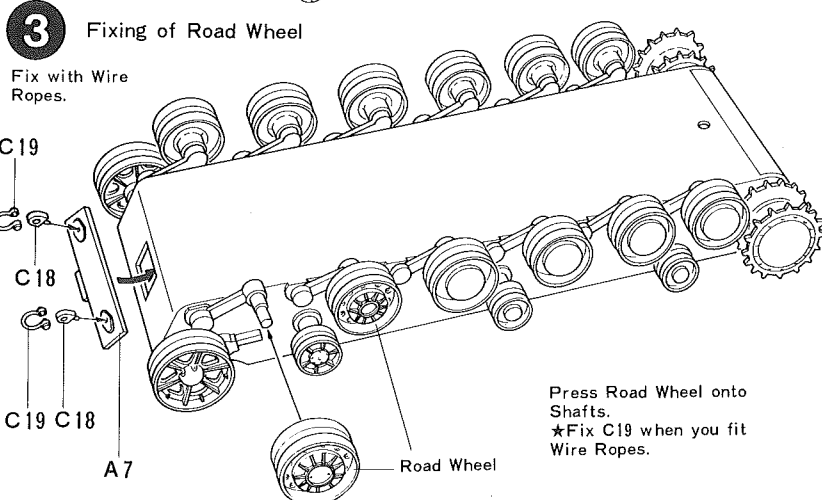
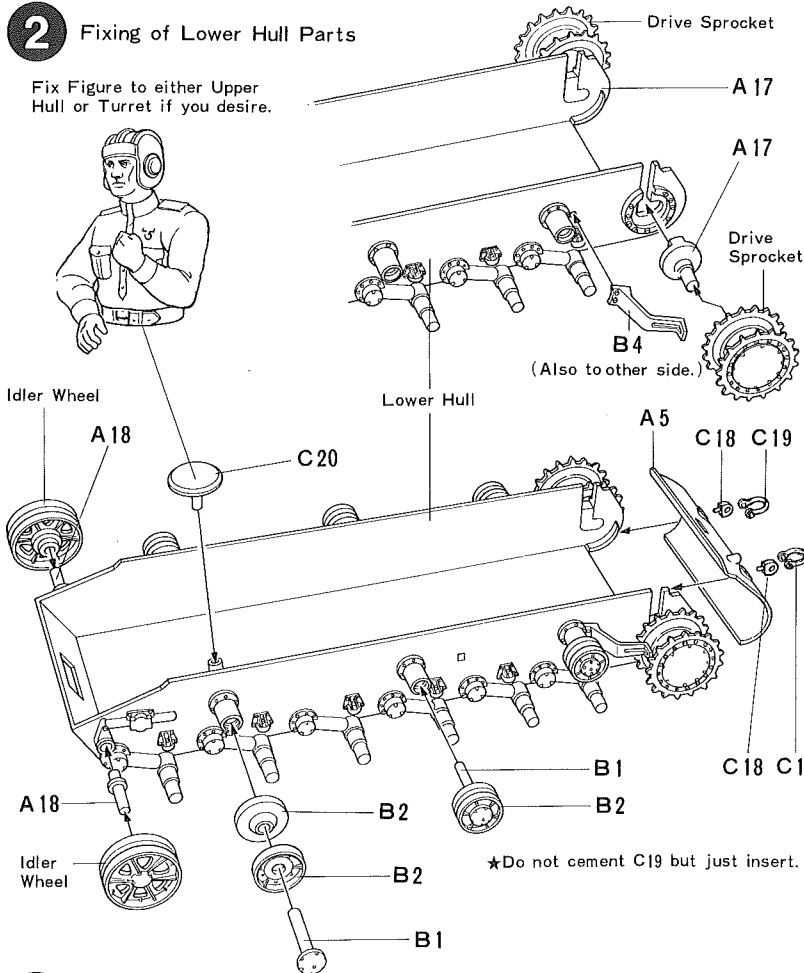
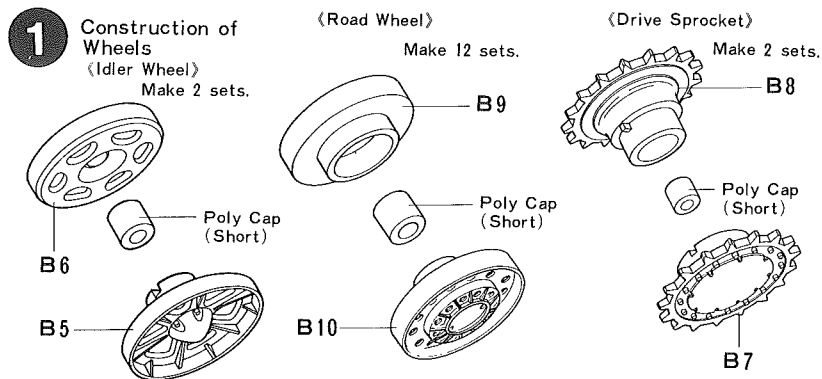

4 (Construction of Upper Hull)

Driver's Hatch can be opened and closed. C14 must not be cemented. This should be fixed to the Upper Hull by means of C13 and C15. A4 and A14, which hold the Upper Hull and Lower Hull together, should be firmly cemented in place.

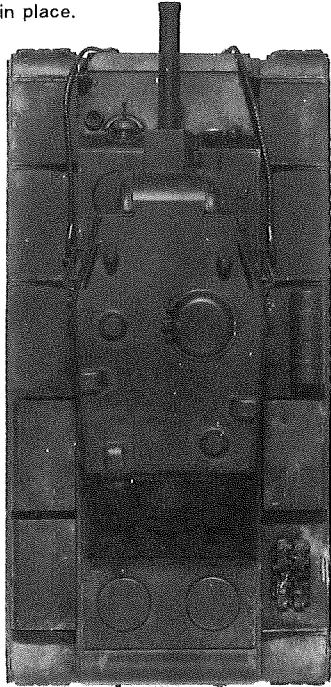

4 Construction of Upper Hull
(Driver's Hatch)

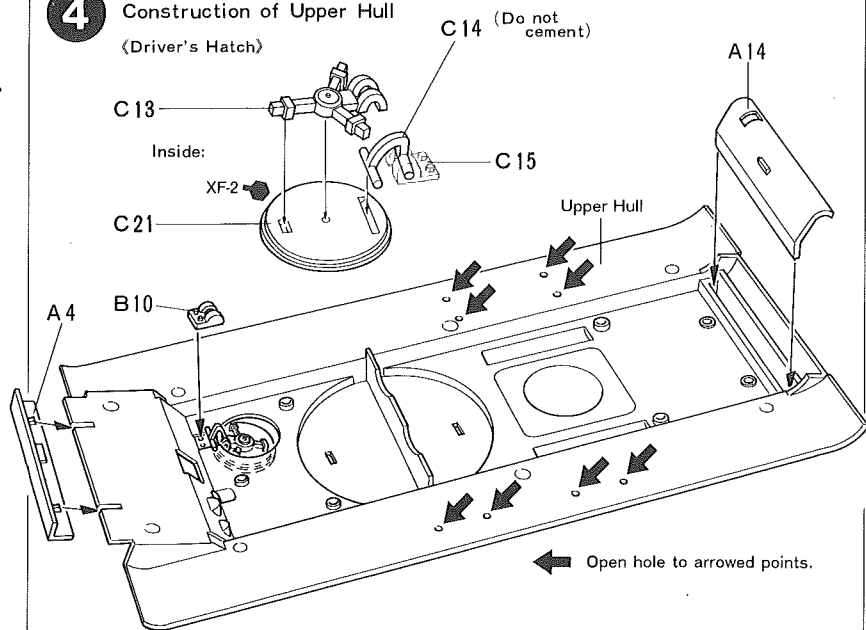

5 Construction of Upper Hull Parts
(Spare Tank) Make 2.

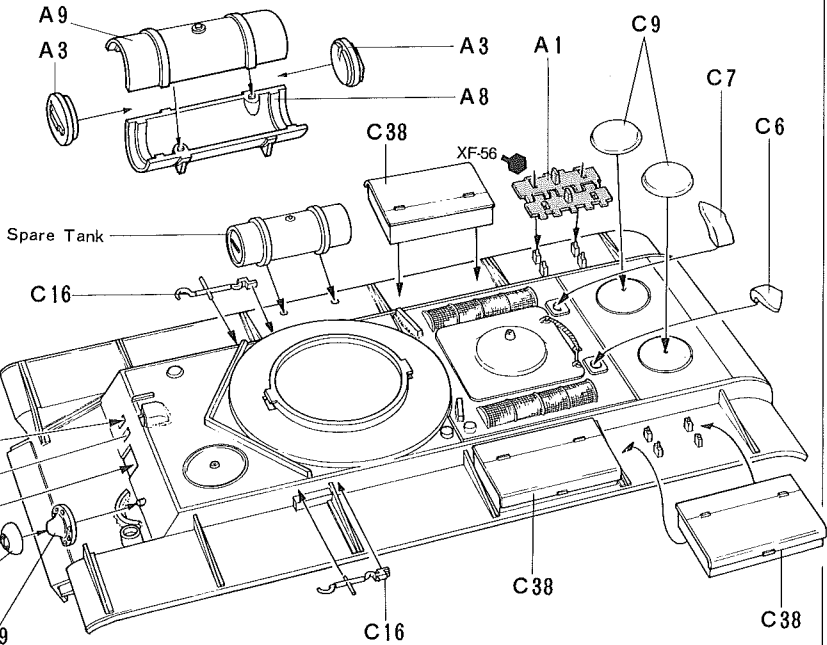

5 (Construction of Upper Hull Parts)

Construct and fix various parts as shown. Use only one Spare Tank.

6 (Construction of Turret Top Plate)

Commander's Hatch Hinge C2 must not be cemented. This should be fixed to the Turret Top Plate by means of C3 and C4.



6 Construction of Turret Top Plate
(Commander's Hatch)

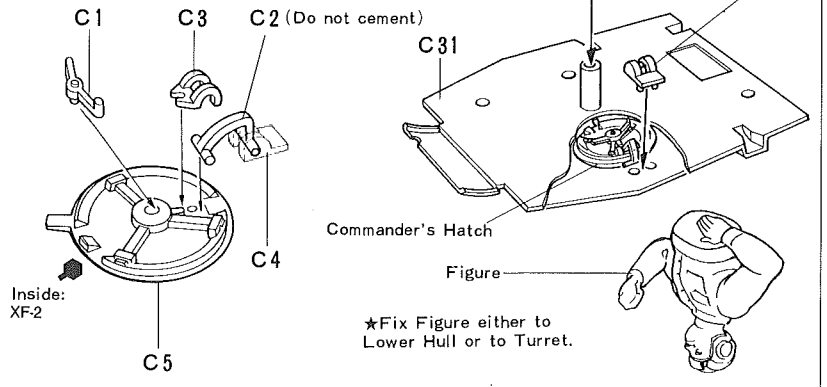

7 (Construction of Turret)

Barrel assembly is designed to move up and down. This should be put between Turret Sides C11 and C17.

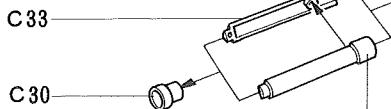

(Construction of Tracks)

★① Firstly, fasten one end of track onto a desk with tape and insert pins into respective holes. Then, lightly warm the pinheads with either a nail head or the end of a screwdriver that has been previously heated.

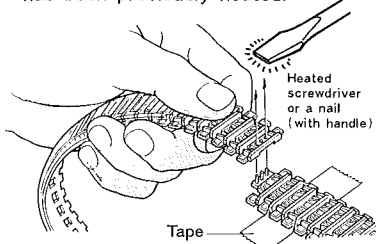

★② Flatten the pinheads immediately with your finger to connect track.

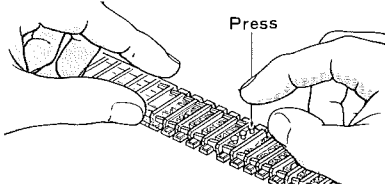

★ In case track break or is unfastened due to ineffective flattening, re-fix it with sewing using a black thread or with a stapler as shown in the figure.

(How to Make Antenna)

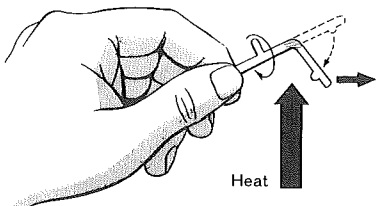

When the runner hangs down, as shown in the figure, take it away from the heating device. Then, slowly stretch it both ways until it becomes long and slender. Keep it still for about 15 seconds to cool. Lastly, cut it to a piece of 7 cm.

(Fixing Wire Ropes)

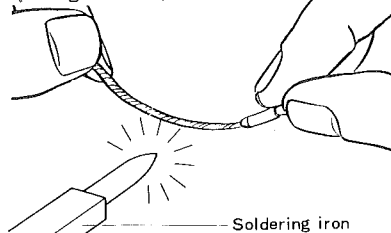

★ When fixing Ropes, bend them by the soldering iron or the like.

★ In so doing, take good care of the fire.

7 Construction of Turret

(Barrel)

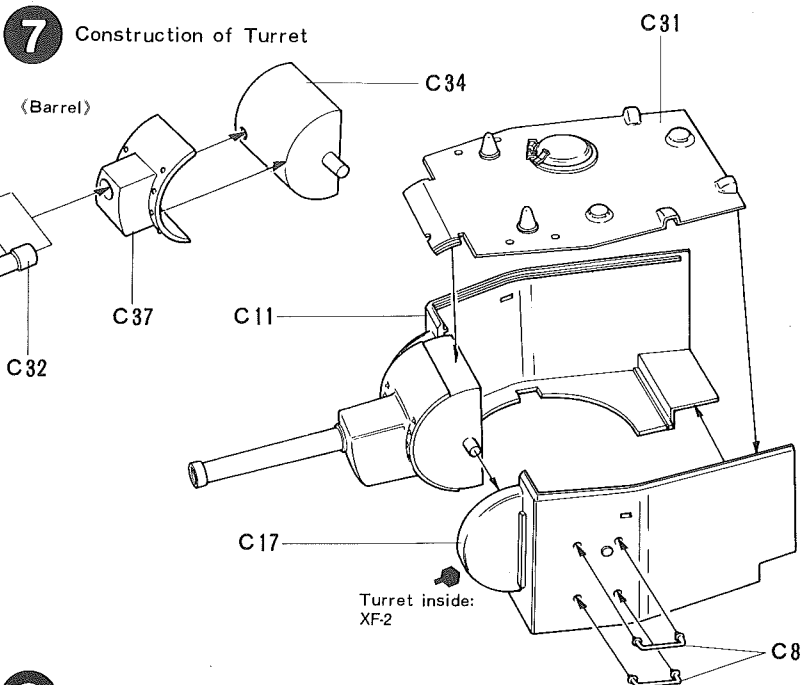

8 Fixing of Turret Parts

(Rear Turret MG)

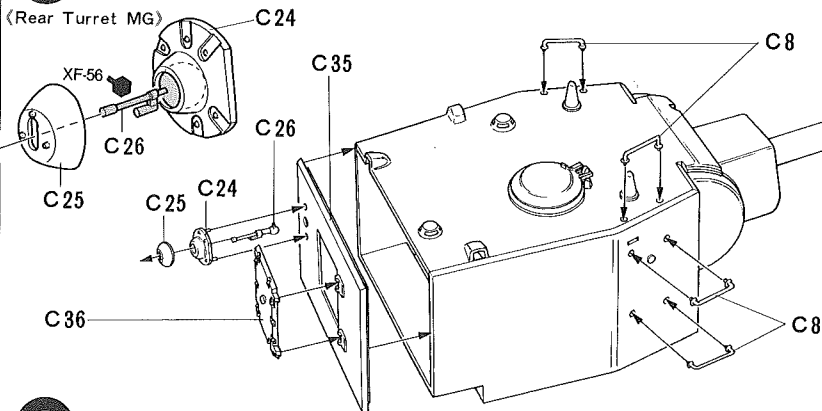

9 Completion of KV- II

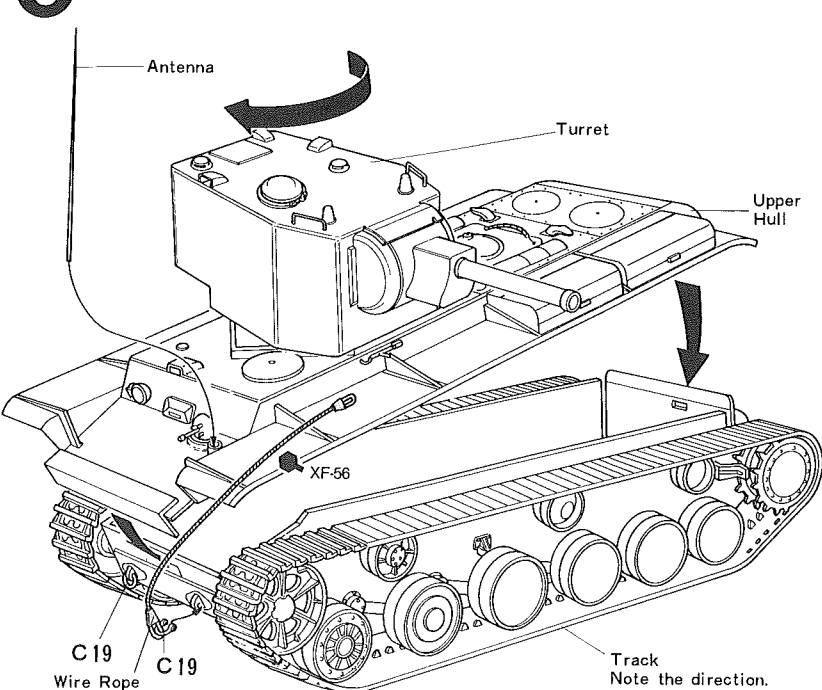

PAINTING



APPLYING DECALS

《Painting of the KV-II》

The Russians accepted overall spray painting in dark green as their standard painting but KV-II tanks seem to have been painted in a considerably light shade of green. KV-II tanks appeared to carry no camouflage painting, but in winter wore camouflage by water paint on light green body.

COLORS REQUIRED

Tamiya Spray Colors

TS-2 Dark green

Tamiya Bottle Paints

X-10 Gun metal

X-11 Chrome silver

XF-2 Flat white

XF-15 Flat flesh

XF-49 Khaki

XF-56 Metallic grey

XF-61 Dark green

XF-64 Red brown

What we call "Weathering" is a good way to lend additional realism to your model tank. It may be interesting to represent the following:

- ★ Bullet marks on the tank made in actual fighting.
- ★ Dirt which stuck to the tank in a desert, swamp, etc.
- ★ Soot on the exhaust pipe.
- ★ Shine on the worn-out teeth of sprocket wheels.
- ★ Dirt on tools, such as axe and shovel, used in the imaginary field.

《Painting of KV-II》

Winter Camouflage

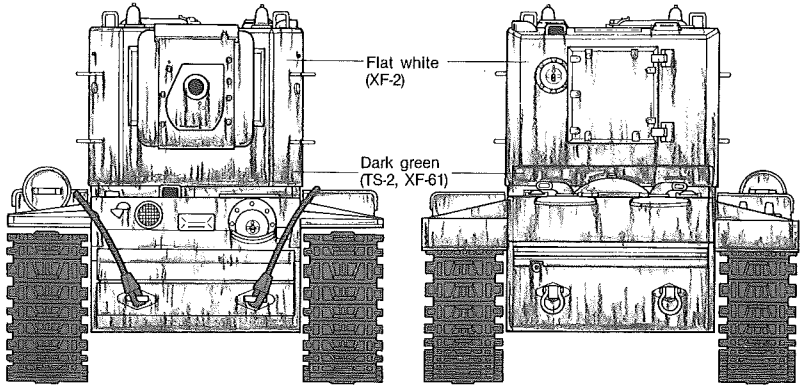
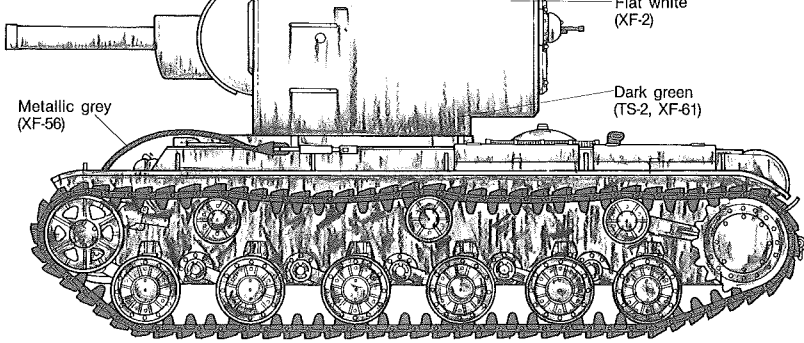

《Where to Apply Marks》

"For Fatherland"



"For Stalin"

★ Slogans such as "For Fatherland" and "For Stalin" were often seen in the first half of the war.

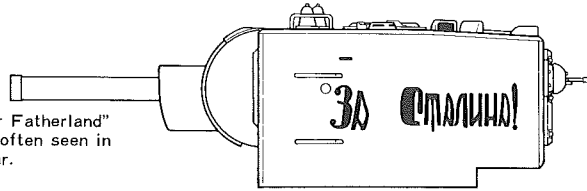

"For Motherland Russia"

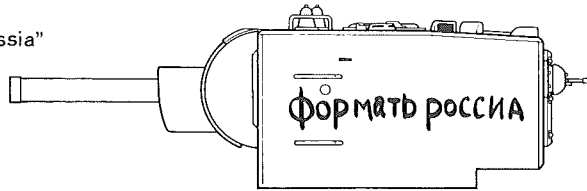

"Kirov Plant"

★ This seems to have been painted in praise of the plant.

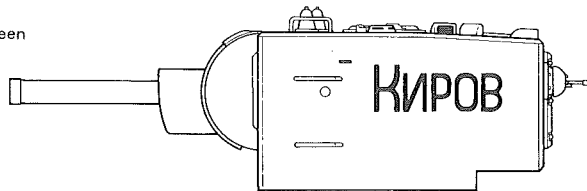

《Marking》

Russian tanks including the KV-II were excellent in performance but did not wear such geometrical unit marks as used by the Germans, etc. In the initial stage of the war, none of them wore unit marks and many of KV-II tanks had no marks at all.

Russian tanksmen sometimes painted slogans on the turret of their tank in utter disregard of camouflage effect. This seems to show that they firmly believed in the performance of their tank. They painted patriotic slogans, such as "For Fatherland" and "For Stalin", in white on green ground or in black on white winter camouflage ground.

PARTS

A PARTS

- 1. Spare Track Links 2. Wire Ropes
- 3. Spare Tanks A 4. Armour Plate A
- 5. Rear Panel 7. Armour Plate B
- 8. Spare Tanks B 9. Spare Tanks C
- 12. Unnecessary 13. Unnecessary
- 14. Air Deflector Plate
- 17. Rear Shafts 18. Front Shafts

B PARTS (Two sheets included)

- 1. Upper Roller Shafts
- 2. Upper Rollers 3. Unnecessary
- 4. Mudguards 5. Idler Wheel A
- 6. Idler Wheel B
- 7. Drive Sprocket A
- 8. Drive Sprocket B
- 9. Road Wheel A 10. Road Wheel B

C PARTS

- 1. Commander's Hatch Lever
- 2. Commander's Hatch Arm
- 3. Commander's Hatch Hinge A
- 4. Commander's Hatch Hinge B
- 5. Commander's Hatch
- 6. Exhaust Pipe (Left)
- 7. Exhaust Pipe (Right)
- 8. Turret Hinges 9. Ventilators
- 10. Front Hatch 11. Turret (Right)
- 12. Driver's Hatch
- 13. Driver's Hatch Hinge A
- 14. Driver's Hatch Arm
- 15. Driver's Hatch Hinge B
- 16. Wire Rope Hooks 17. Turret (Left)
- 18. Hook Holders 19. Hooks
- 20. Driver's Base
- 21. Commander's Base 22. Light Lens
- 23. Light
- 24. Rear MG Mount A
- 25. Rear MG Mount B 26. Rear MG Barrel
- 27. Front MG Mount B
- 28. Front MG Barrel 29. Horn
- 30. Barrel Tip
- 31. Turret Top Plate 32. Barrel A
- 33. Barrel B 34. Cannon Drum
- 35. Turret Rear Panel 36. Rear Hatch
- 37. Gun Shield 38. Tool Boxes
- 39. Front MG Mount A

Poly Caps

- (Short) Wheel Stoppers
- (Long) Unnecessary

A PARTS

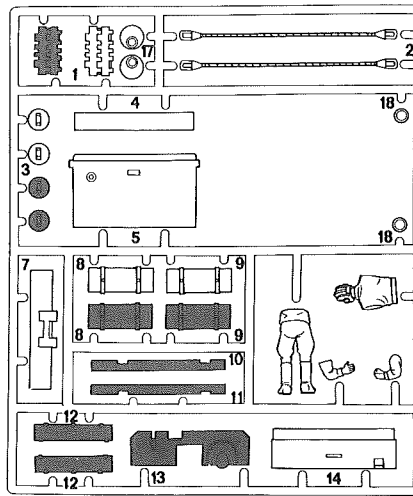

B PARTS (Two sheets included)

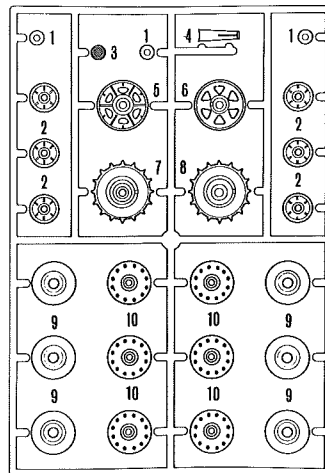

《Poly Cap》

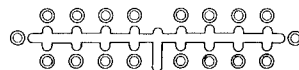

C PARTS

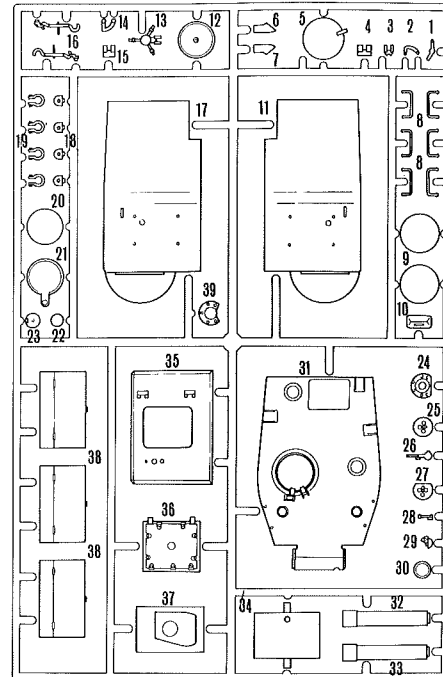

TAMIYA ACRYLIC PAINTS

Need precise color matching? Try the new Tamiya acrylic paints. Engineered by modelers for modeler's use. The final cover for the finest models. Insist on Tamiya for perfect results.



TAMIYA COLOR CATALOGUE

The latest in cars, boats, tanks and ships. Motorized, radio controlled and museum quality models are all shown in full color in Tamiya's latest catalogue. English, German, French and Japanese versions available.

