

-Parts not for use. -Teile werden nicht verwendet. -Pièces à ne pas utiliser. -Tyto díly nepoužívejte při stavbě. - 使用しない部品

ATTENTION * UPOZORNĚNÍ * ACHTUNG * ATTENTION

- (GB)** Carefully read instruction sheet before assembling. When you use glue or paint, do not use near open flame and use in well ventilated room. Keep out of reach of small children. Children must not be allowed to suck any part, or pull vinyl bag over the head.
- (CZ)** Před započatím stavby si pečlivě prostudujte stavební návod. Při používání barev a lepidel pracujte v dobře větrané místnosti. Lepidla ani barvy nepoužívejte v blízkosti otevřeného ohně. Model není určen malým dětem, mohlo by dojít k požití drobných dílů.
- (D)** Vor dem Zusammenbau die Bauanleitung gut durchlesen. Kleber und Farben nicht in der Nähe von offenem Feuer verwenden und für eine ausreichende Belüftung sorgen. Den Bausatz von kleinen Kindern fernhalten. Vermeiden Sie, dass Kinder Bauteile in den Mund nehmen oder sich Plastiktüten über den Kopf ziehen.
- (F)** lire soigneusement la fiche d'instructions avant d'assembler. Ne pas utiliser de colle ou de peinture à proximité d'une flamme nue, et aérer la pièce de temps en temps. Garder hors de portée des enfants en bas âge. Ne pas laisser les enfants mettre en bouche ou sucer les pièces, ou passer un sachet vinyl sur la tête.

INSTRUCTION SIGNS * INSTR. SYMBOLY * INSTRUKTION SINNBILDEN * SYMBOLES

- (?)** OPTIONAL VOLBA
- (↻)** BEND OHNOUT
- (⊘)** OPEN HOLE VYVRTAT OTVOR
- (↔)** SYMETRICAL ASSEMBLY SYMETRICKÁ MONTÁŽ
- (/)** REMOVE ODŘÍZNOUT
- (⊖)** REVERSE SIDE OTOČIT

OPTIONAL:

decal 26

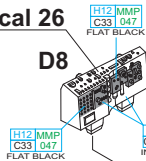

D8

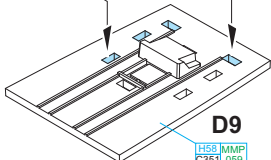

D9



decal 22

D23

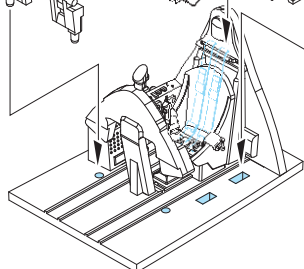
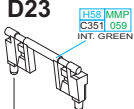

D41

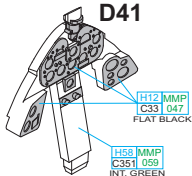

OPTIONAL:
decal 20, 21, 24, 25



decal 23



D19



D35

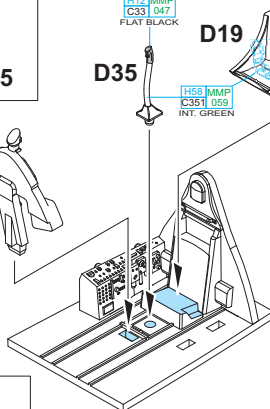

OPTIONAL:
decal 27

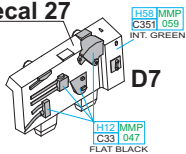

D7

D41

D7, D8



D27

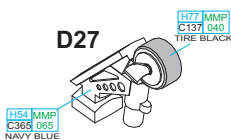

D27

E1 - MARKING A **E3 - MARKING B**

E1 ? E3

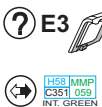

A7



D27

D34

**REMOVE FOR
EXTERNAL
FUEL TANK ONLY**

A6

E2 ? E4

E2 - MARKING A
E4 - MARKING B

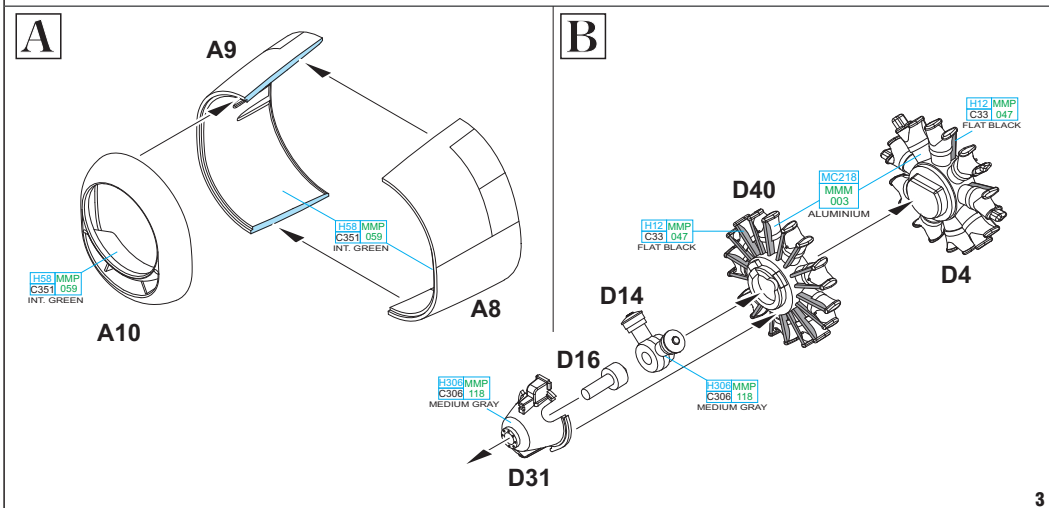
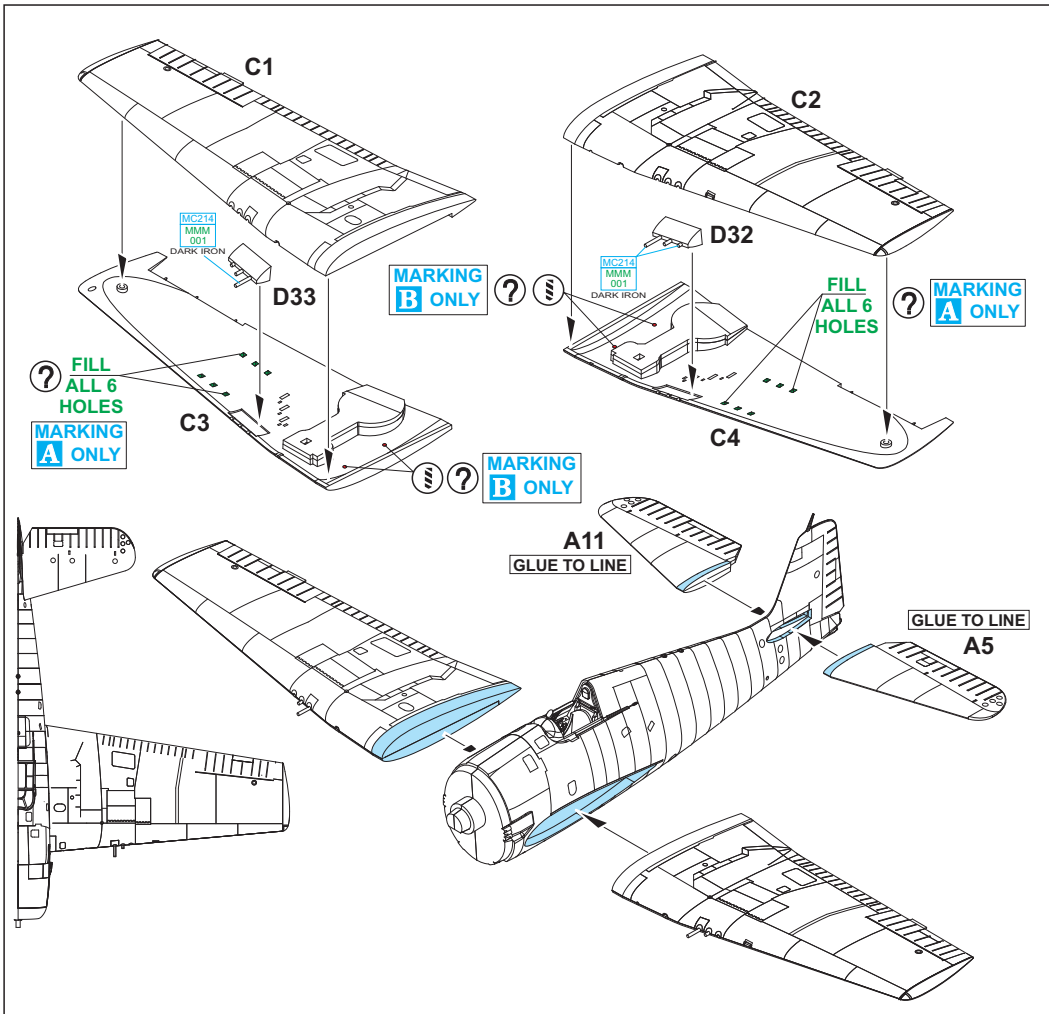

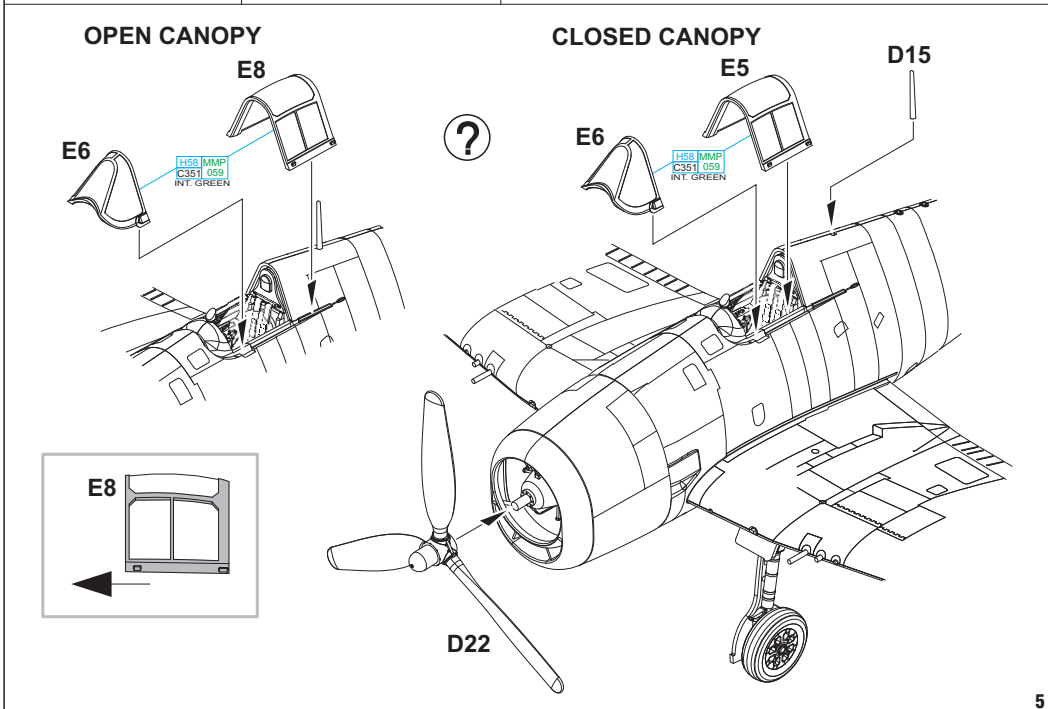
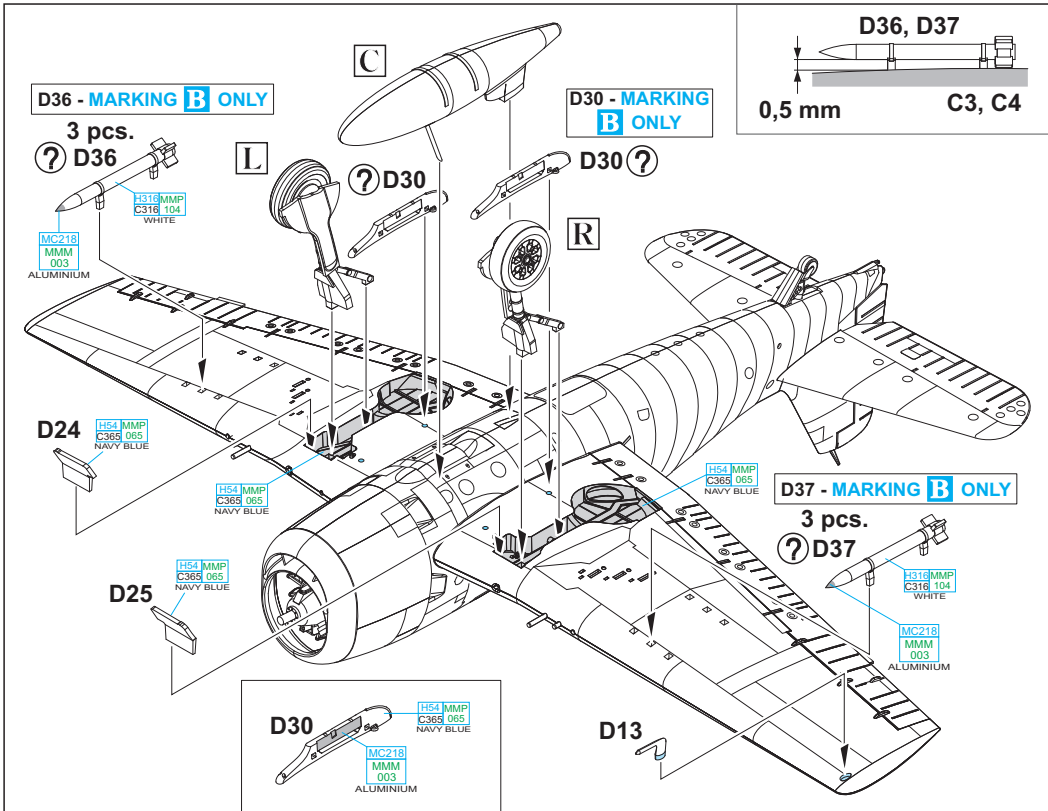

A BuNo. 42158, flown by Lt. Cornelius Nicholas Nooy, VF-31, USS Cabot, September 1944

Native of Smithtown, New York City suburbs, Cornelius Nooy was born on April 15th, 1921. In August 1942 he enlisted in the aviation cadets training and received his wings in January 1943. On May 1st, 1943 he was assigned to newly-formed VF-31. Between September 1943 and October 1944, Hellcats belonging to this unit operated from the deck of the USS Cabot (CVL-28). During this period Lt. Nooy claimed 15 Japanese planes shot down. VF-31 second tour of duty was conducted aboard the USS Belleau Wood (CVL-24) during which Lt. Nooy added another four Japanese aircraft kills to his score. As a result, he became the highest scoring Light Carrier (CVL) ace and fourth highest scoring ace in the US Navy. After finishing the first tour of duty many VF-31 pilots were photographed in the cockpit of Hellcat nr.12, Lt. C.N. Nooy among them. Number of Japanese kill markings changed according to the pilot sitting in the cockpit at the time. It is possible that killmarks, nickname and units badge were on the port side because of the photographs. The aircraft was camouflaged according to the order dated March 13th, 1944, which prescribed Glossy Sea Blue overall for all US Navy aircraft operating in the Pacific. Hellcats operating off the USS Cabot had the rudders painted white.

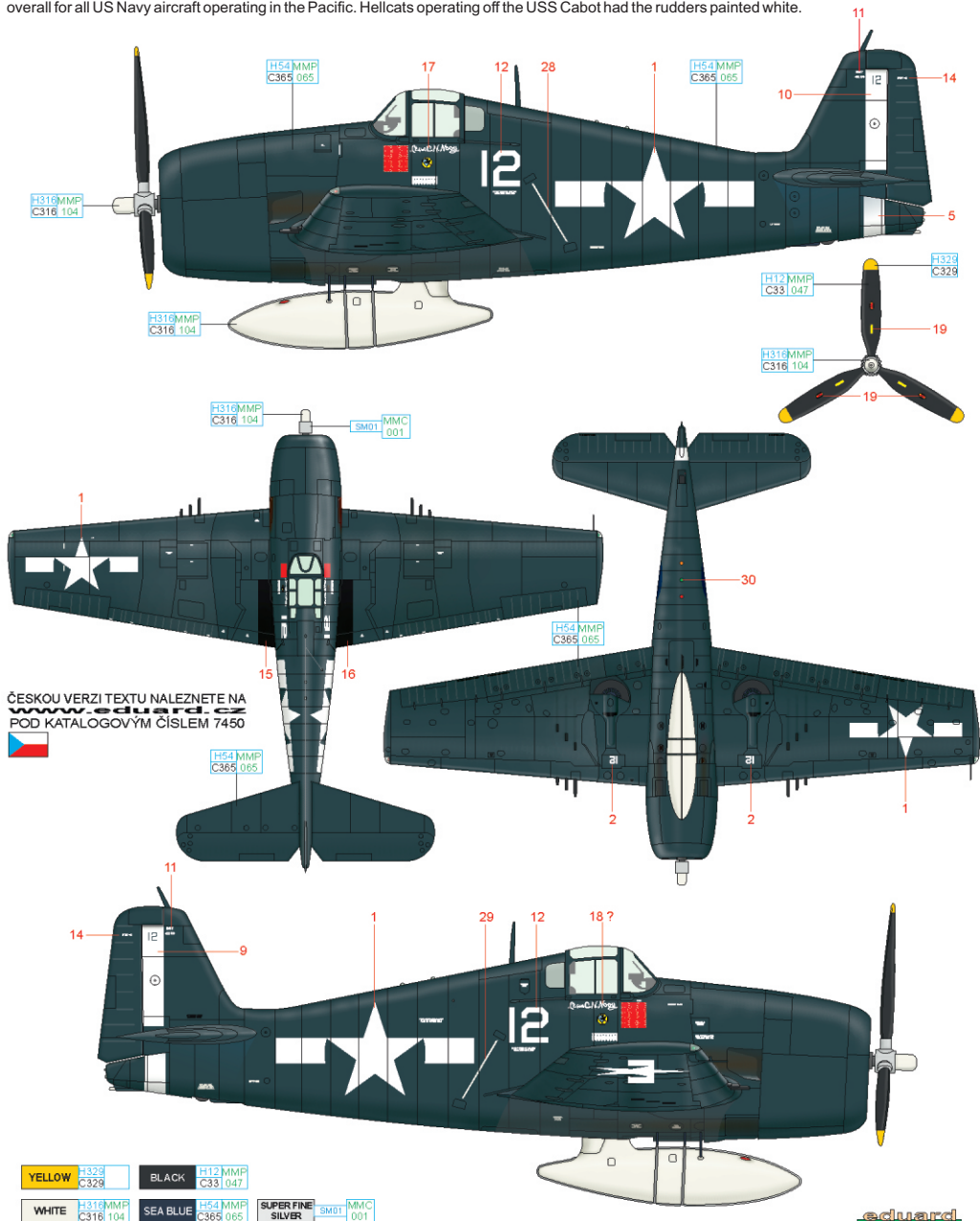

ČESKOU VERZI TEXTU NALEZNETE NA www.eduard.cz POD KATALOGOVÝM ČÍSLEM 7450



YELLOW	H329 C329	BLACK	H12 MMP C331 047
WHITE	H318 MMP C318 104	SEA BLUE	H54 MMP C365 065
		SUPER FINE SILVER	SM01
			MMC 001



B VF-83, USS Essex, March 1945

In the spring of 1945 the American carrier-based aircraft conducted the massive attacks against the Japanese Homeland Islands. They targeted the Japanese airfields which stationed the suicide formations, and which could be used for the attacks against the Allies landing on Okinawa. The aircraft - Hellcats and Corsairs - participating in these sorties off the carriers USS Essex (CV-9) and USS Bunker Hill (CV-17) had the front part of fuselage painted yellow or white. In the beginning of April this special marking was deleted. Geometrical symbol on the vertical tails surface and the wing indicated the planes operating off the Essex.

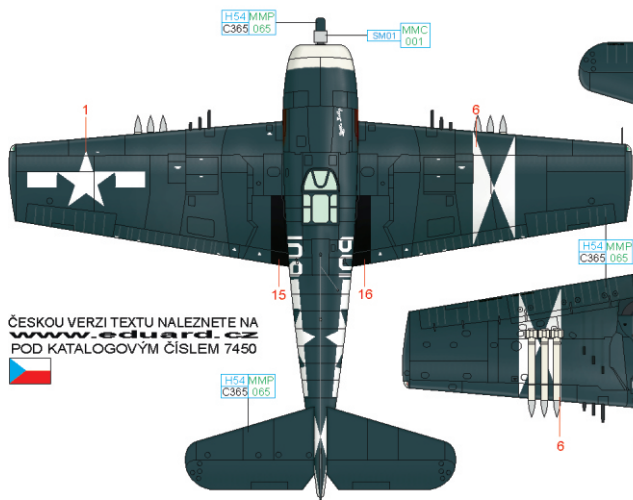
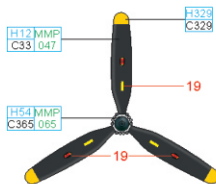
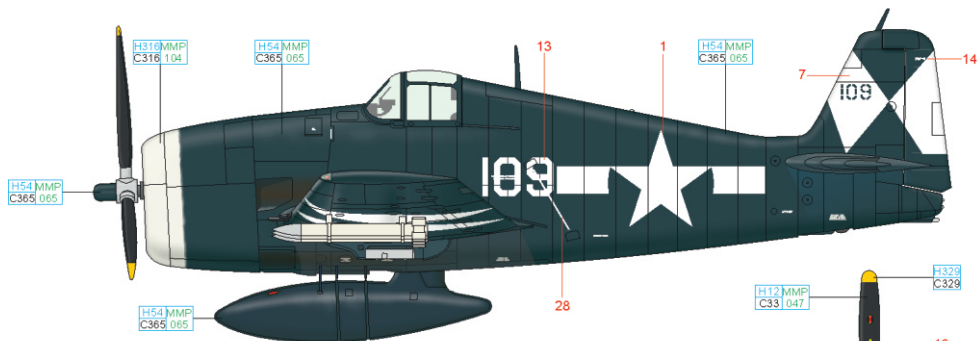

ČESKOU VERZI TEXTU NALEZNETE NA
www.eduard.cz
 POD KATALOGOVÝM ČÍSLEM 7450

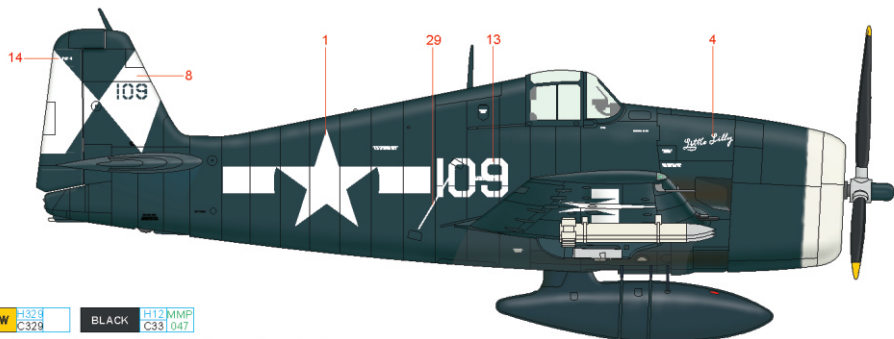
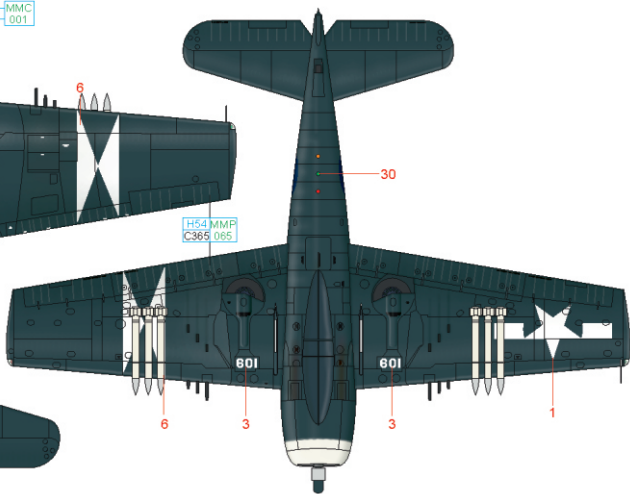

YELLOW H328 C328
 C329

BLACK H12 MMP C33 047

WHITE H318 MMP C316 104

SEA BLUE H54 MMP C365 065

SUPER FINE SILVER SM01 MMC 001

eduard

