

A6M2-K

eduard

1/48 Scale Plastic Model Kit

ProfiPACK
edition

The Mitsubishi Zero became a symbol of Japanese air power during World War II. Production of its trainer version did not begin until the second half of the war. Some of these aircraft were deployed in special attack operations of Kamikaze airmen during the defense of Okinawa.

During the 1920s and 1930s the Japanese aircraft industry was oriented towards the production of foreign license-built aircraft. However, the armed forces, especially the Navy with regard to the specifics of the Chinese and Pacific battlefields, came up with requirements that foreign aircraft designs did not offer. Hence, Mitsubishi Heavy Industries developed the Type 96 naval fighter aircraft, better known as the A5M Claude. The head of the design team was a young Japanese engineer, Jirō Horikoshi. With an engine that lacked sufficient power, he managed to design a light and fast fighter with a fixed landing gear, which had no comparison in the world regarding maximum speed. In October 1937, Mitsubishi and Nakajima were approached to develop prototype 12-shi Carrier-based Fighter. The requirements were so extreme, and in some cases contradictory, that the two design teams investigated whether they could be less stringent. Nakajima eventually withdrew from the project, while the criteria for the prototype were even raised based on experience on the Chinese battlefield. In the end, Horikoshi's team managed to meet the technical specifications not only thanks to the aerodynamic design and a new type of light alloy used for the aircraft's skin, but also thanks to the Nakajima Sakae 11 engine. During the flight tests, the wing surface suffered cracking during overload, and aileron control during high-speed maneuvers had also to be addressed. The new fighter had armament of two cannons and two machine guns, extremely long range (over 1,800 km) and excellent maneuverability. The new fighter reached top speed of 533 km/h at an altitude of 4,550 m. However, it lacked armor and other protective features and had a structural speed limit of 600 km/h.

The new aircraft entered service in 1940 with the 940 hp engine Sakae 12 and received the official designation Rei shiki Kanjō sentōki (Type 0 carrier fighter), with the "zero" being derived from the imperial year 2600 (1940). Japanese pilots usually abbreviated it as „Rei-Sen“. That was also the origin of the name Zero often used by Allied pilots instead of the official code name, derived from the male name Zeke. As part of the Navy's system, the new aircraft was given the type designation A6M, where A6 meant that it was the sixth type of carrier fighter to enter service, and M stood for the Mitsubishi company name.

The first combat deployed version was the A6M2 Type 11. It was a fighter aircraft designed for ground bases. Therefore, it did not have folding wingtips, an arresting hook, nor was it equipped with a DF antenna and associated radio equipment. Mitsubishi produced a total of 65 aircraft of this version between December 1939 and November 1940. Minor modifications were made during production partly based on the experience of the combat units. Three Type 11 examples were used for modifications related to the planned use of the Zeros for carrier service. The Zero Type 11 was successfully deployed on the Chinese battlefield from autumn 1940 till autumn 1941. The aircraft fundamentally changed the balance of power in the air war on the Chinese battlefield. But the Allies downplayed the news from China until December 7, 1941.

Additional modifications to design of Zero were made during 1941, creating the A6M2 Type 21. There were several changes, the most visible



item No. 82218

of them being arresting hook and folding wingtips for easier handling on the carrier decks. With the A6M2 Type 21 modified this way, Japan entered the war against the US and other Western nations. In carrier service, this early version of Zero lasted until mid-1944. After four years of war in the Pacific, the Type 21 faced far more modern enemy aircraft while keeping unchanged design from the time of the Pearl Harbor attack. Most Zeros, however, fought as ground-based aircraft from 1943 until the end of the war. Thus, the shortened wingspan (Type 32 and 52) or folding wingtips (Type 21 and 22) and landing hook were unnecessary.

The kit: A6M2-K

The design of the two-seat trainer aircraft based on the A6M2 Type 21 carrier-based fighter was undertaken by the 21st Naval Air Arsenal at the Ōmura base starting in 1942, and the prototype was completed in November 1942. The aircraft received the designation A6M2-K Type 11. To reduce weight, the cannons were removed from the wings. Some sources state that only the right machine gun was retained, while others claim the aircraft was equipped with two machine guns. The forward cockpit for the student pilot lacked canopy and had fold-down side panels. Two structural elements were added to the rear fuselage covering to improve stability. Production of the A6M2-K began at the 21st Naval Air Arsenal in January 1943 using components from Mitsubishi and especially Nakajima. A total of 218 were built there by July 1945. Production also took place at the Hitachi company, which delivered 279 units between May 1944 and July 1945.

According to regulations issued in September 1942, trainer aircraft were to be painted yellow-orange on all surfaces. For this reason, national insignia on the undersides received white outlines. In July 1943, a new regulation was issued, requiring that trainer aircraft deployed in combat or stationed in areas where the enemy operated were to be camouflaged like combat aircraft.

In practice, this led to a change in the coloring of already-produced A6M2-K trainers with the undersides usually left in yellow-orange paint. Toward the end of the war, aircraft have been documented with gray paint on the undersides or even left unpainted underneath.

During the production of two-seat Zeros, various improvisations occurred, and there are documented examples of A6M2-K aircraft fitted with wings from the A6M5 model. A6M2-Ks were not only used for advanced pilot training but also for towing aerial targets. The flight characteristics of the two-seat Zeros reportedly did not differ significantly from those of the single-seat versions.

In February 1945, Tsukuba Kōkūtai received an order to form Kamikaze units. The same order was given to other units equipped with two-seat Zeros, particularly Yatabe, Kasumigaura, and Genzan (II) Kōkūtai.

Toward the end of the war, production preparations began for a two-seat Zero based on the A6M5 fighter. The aircraft was designated A6M5-K Type 22, and Hitachi built prototypes and seven units before the end of the war.

ATTENTION



UPOZORNĚNÍ



ACHTUNG



ATTENTION



注意



Carefully read instruction sheet before assembling. When you use glue or paint, do not use near open flame and use in well ventilated room. Keep out of reach of small children. Children must not be allowed to suck any part, or pull vinyl bag over the head.



Před započítím stavby si pečlivě prostudujte stavební návod. Při používání barev a lepidel pracujte v dobře větrané místnosti. Lepidla ani barvy nepoužívejte v blízkosti otevřeného ohně. Model není určen malým dětem, mohlo by dojít k požití drobných dílů.

INSTRUCTION SIGNS * INSTR. SYMBOLS * INSTRUKTION SINNBILDEN * SYMBOLES * 記号の説明

OPTIONAL
VOLBABEND
OHNOUTSAND
BROUSITOPEN HOLE
VYVRTAT OTVORSYMETRICAL ASSEMBLY
SYMETRICKÁ MONTÁŽREMOVE
ODRÍZNOUTREVERSE SIDE
OTOČITAPPLY EDUARD MASK
AND PAINT
POUŽÍT EDUARD MASK
NABARVIT**PLEASE CHECK THE LATEST VERSION OF THE INSTRUCTIONS ON www.eduard.com**

PARTS



DÍLY



TEILE



PIÈCES



部品

PLASTIC PARTS

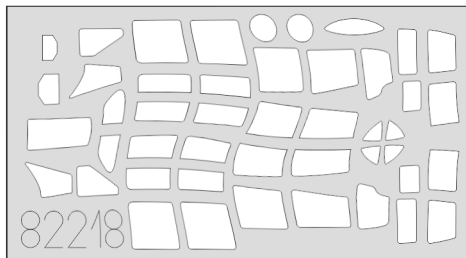
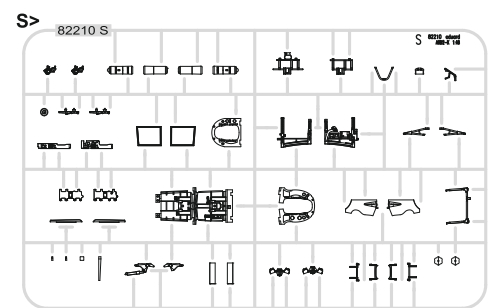
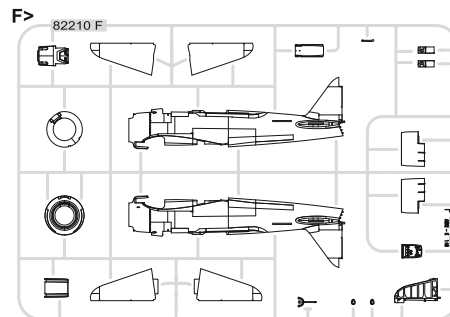
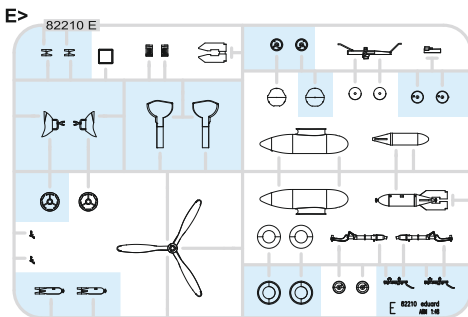
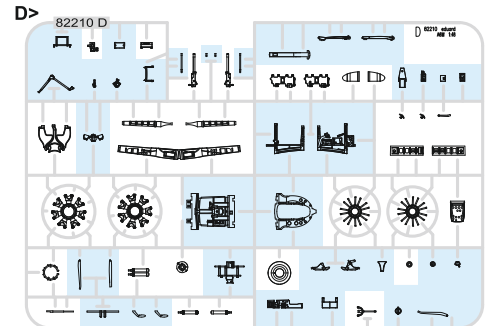
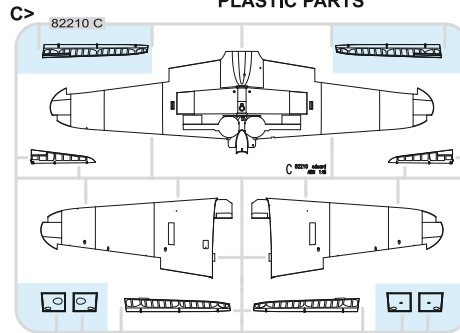
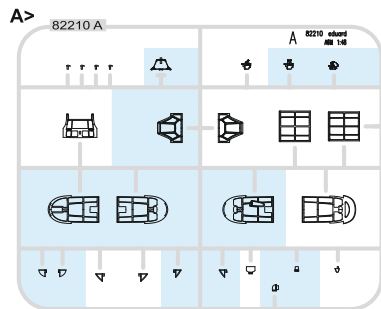
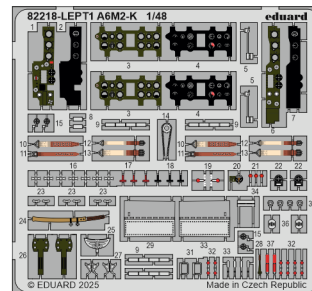
PE - PHOTO ETCHED DETAIL PARTS

-Parts not for use. -Teile werden nicht verwendet. -Pièces à ne pas utiliser. -Tyto díly nepoužívejte při stavbě. - 使用しない部品

COLOURS



BARVY



FARBEN



PEINTURE



色

GSI Creos (GUNZE)		
AQUEOUS	Mr.COLOR	
H1	C1	WHITE
H2	C2	BLACK
H6	C6	GREEN
H8	C8	SILVER
H11	C62	FLAT WHITE
H12	C33	FLAT BLACK
H24	C58	ORANGE YELLOW
H47	C41	RED BROWN
H63	C57	METALLIC BLUE GREEN
H76	C61	BURNT IRON
H77	C137	TIRE BLACK
H90	C47	CLEAR RED
H93	C50	CLEAR BLUE

GSI Creos (GUNZE)		
AQUEOUS	Mr.COLOR	
H324	C324	LIGHT GRAY
H413	C113	RLM04 YELLOW
H417	C117	LIGHT BLUE
	C15	DARK GREEN
	C35	GRAY
	C125	COWLING COLOR
	C128	GRAY GREEN
	C129	LIGHT GREEN
	C130	INTERIOR GREEN
	C131	RED BROWN
Mr.COLOR SUPER METALLIC		
	SM201	SUPER FINE SILVER
	SM212	ALUMINIUM

⑦ FOR OPEN DOORS ONLY

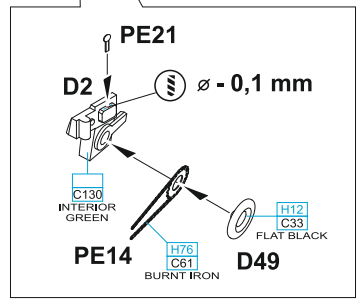
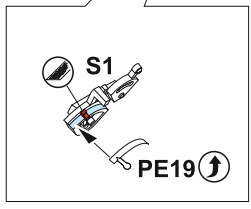
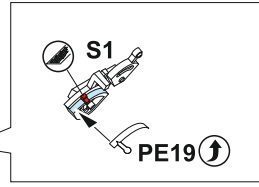
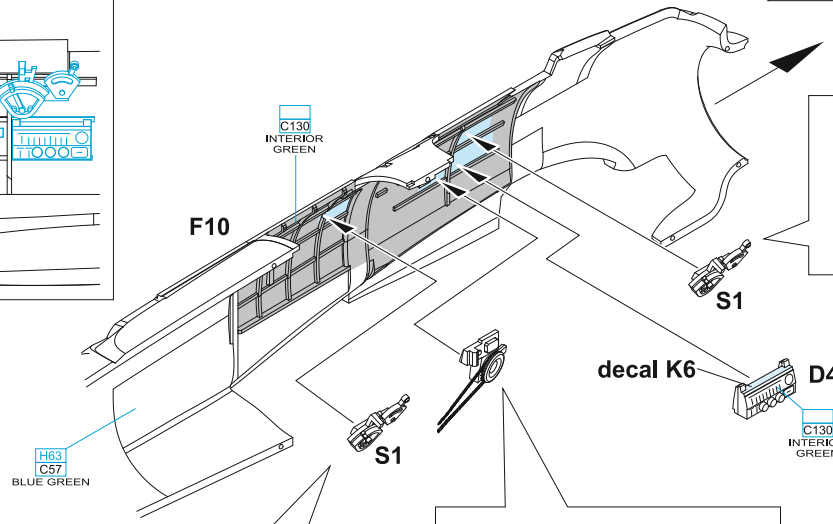
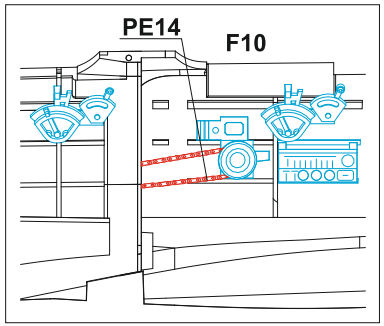
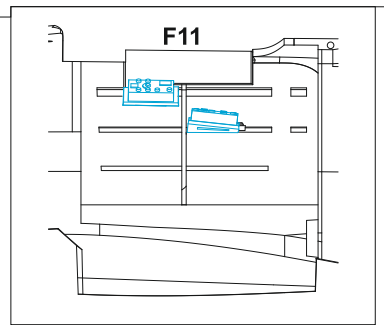
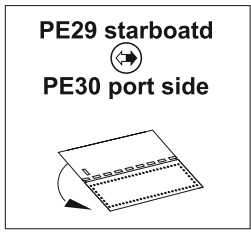
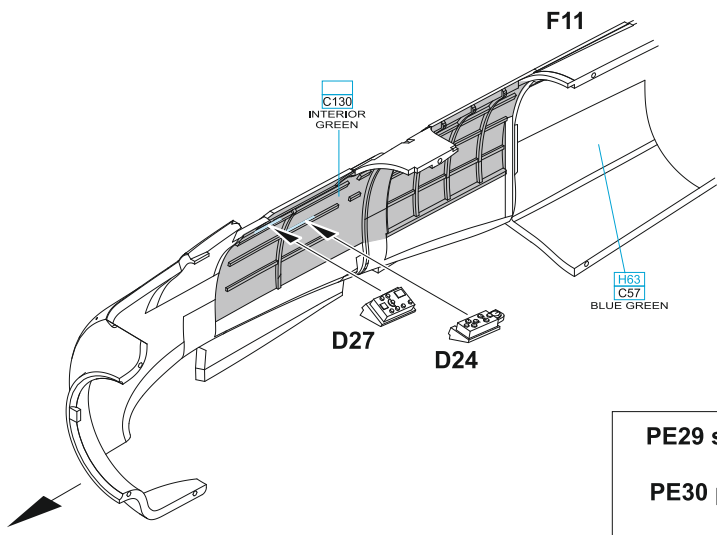
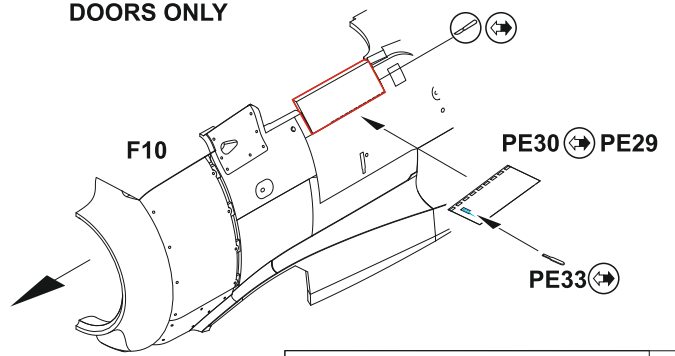

OPTIONAL:
 decal K9

A 2 pcs.

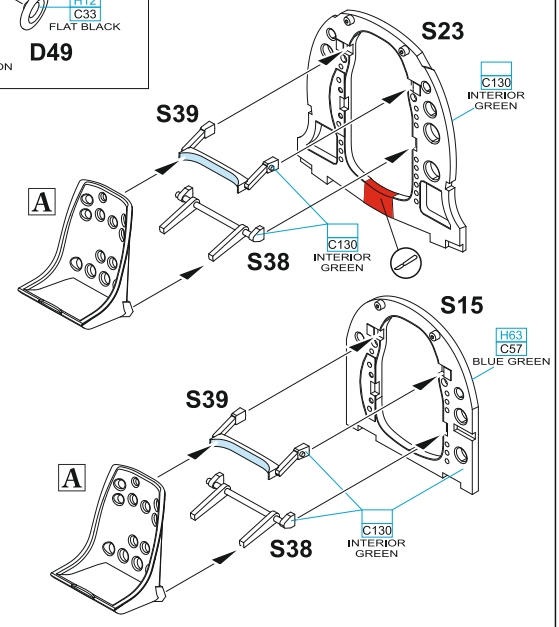
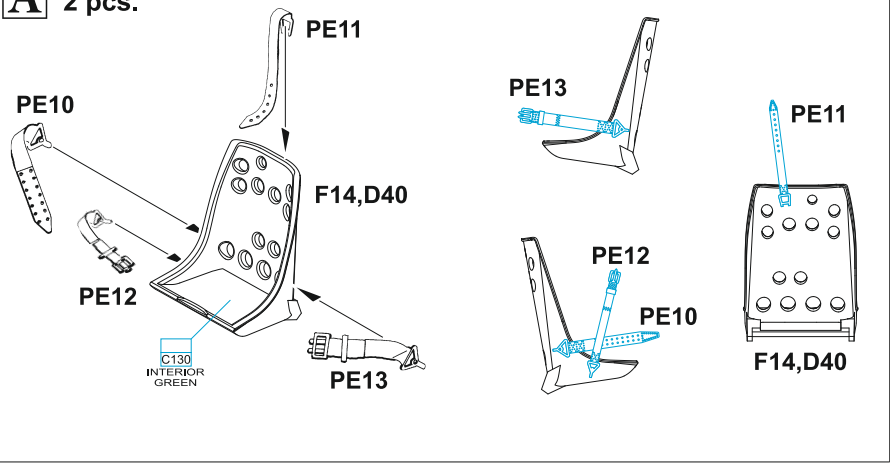

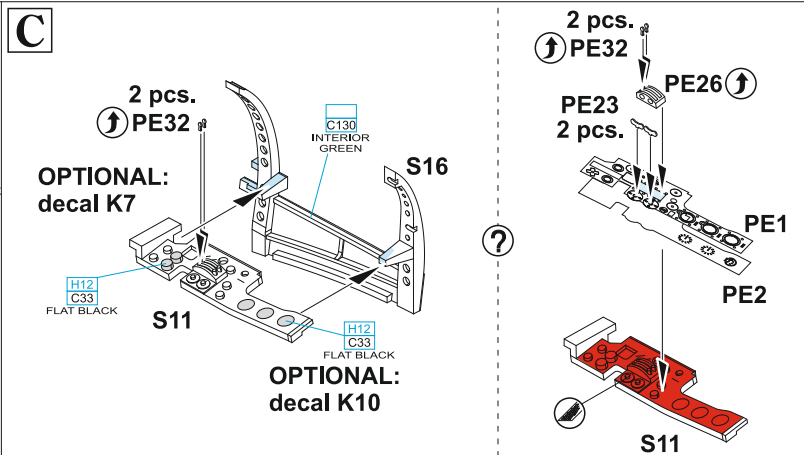
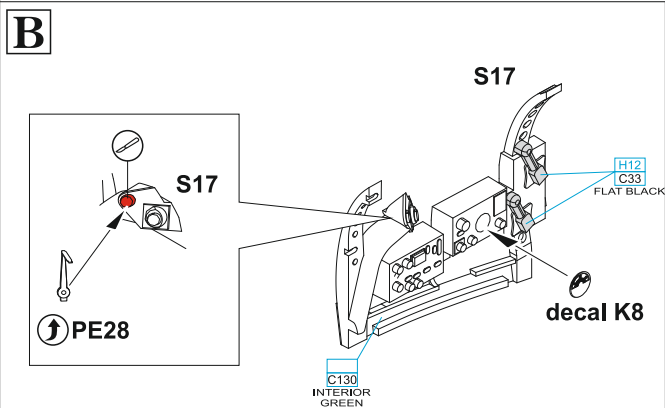
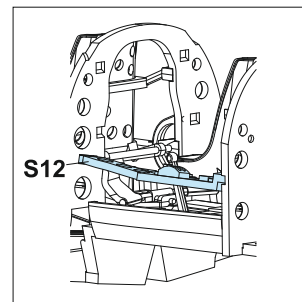
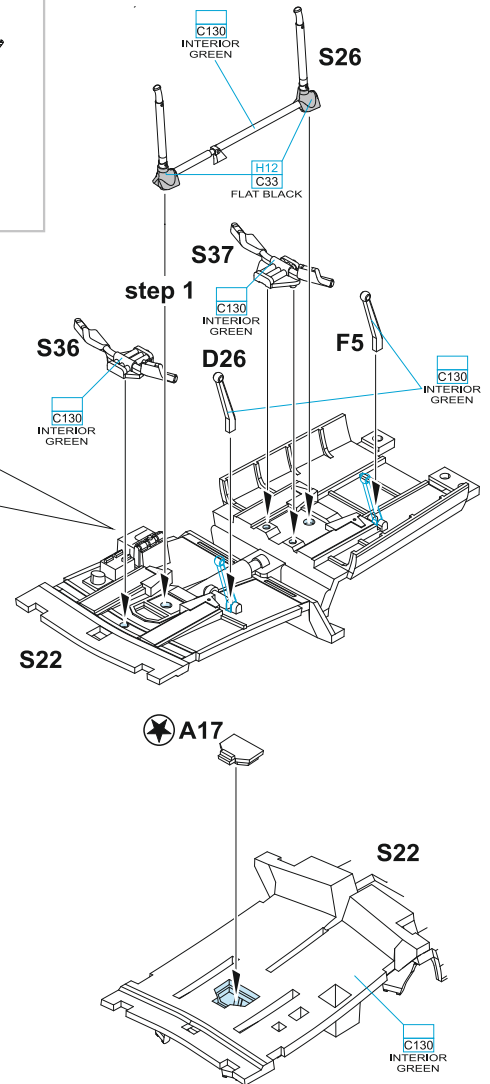
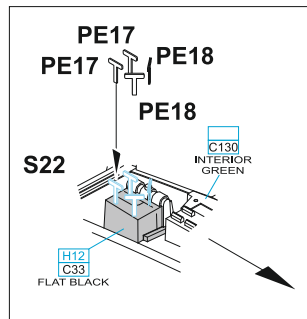
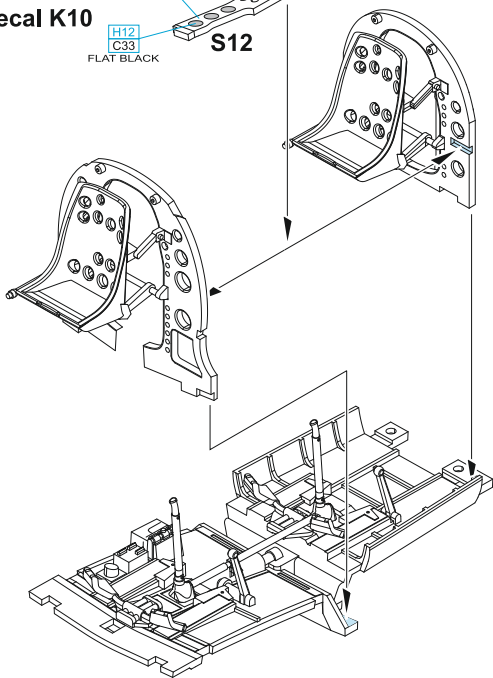
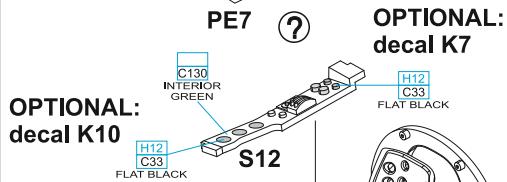
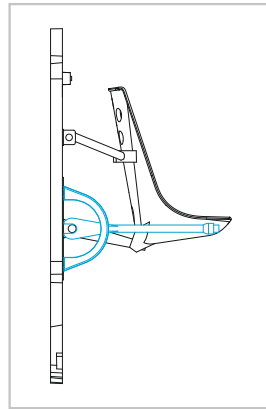
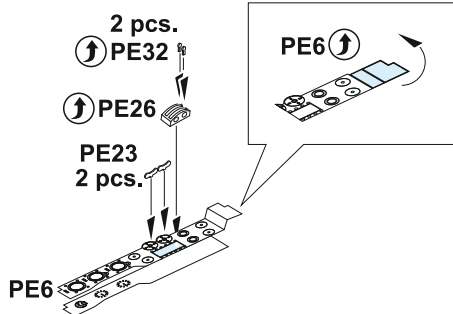
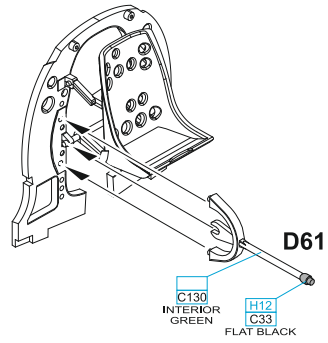
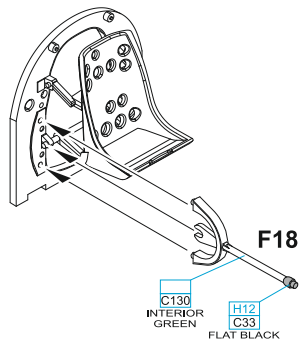

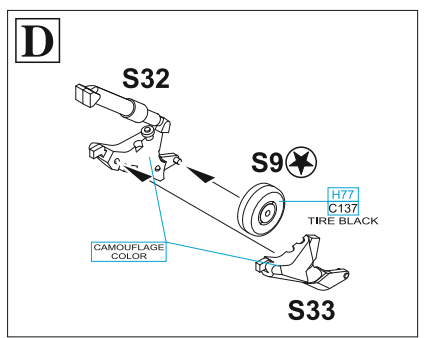
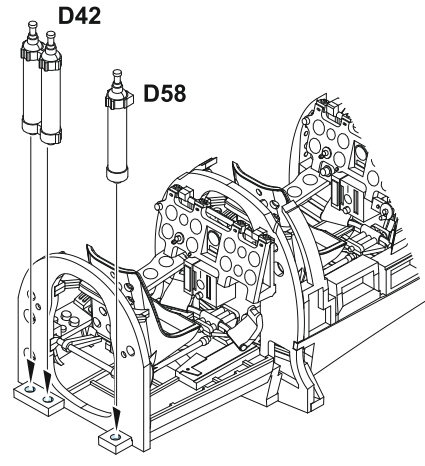
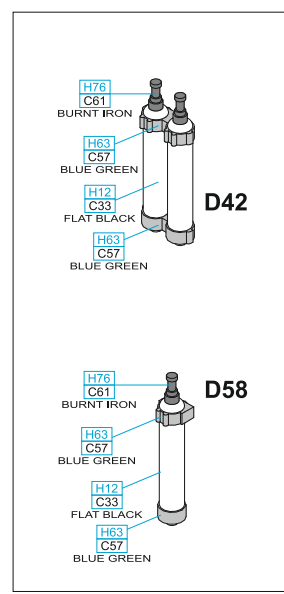
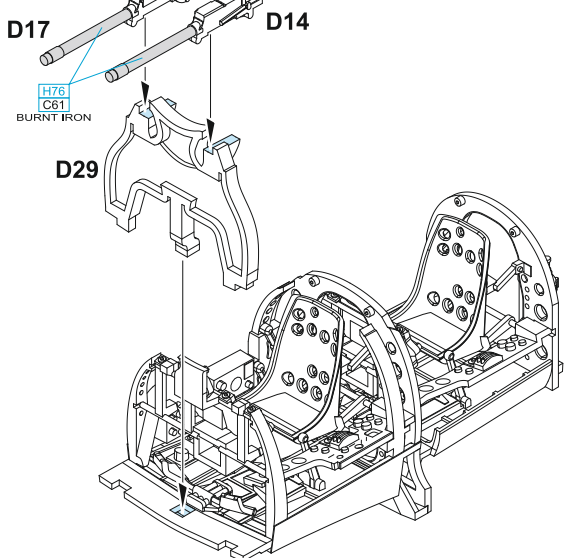
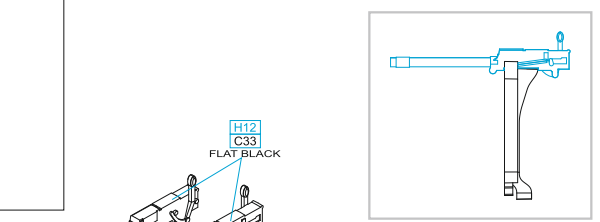
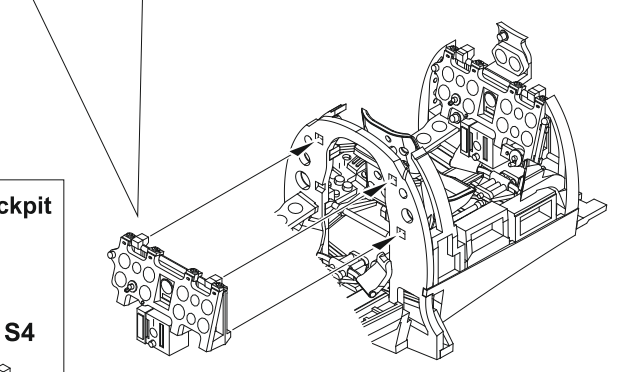
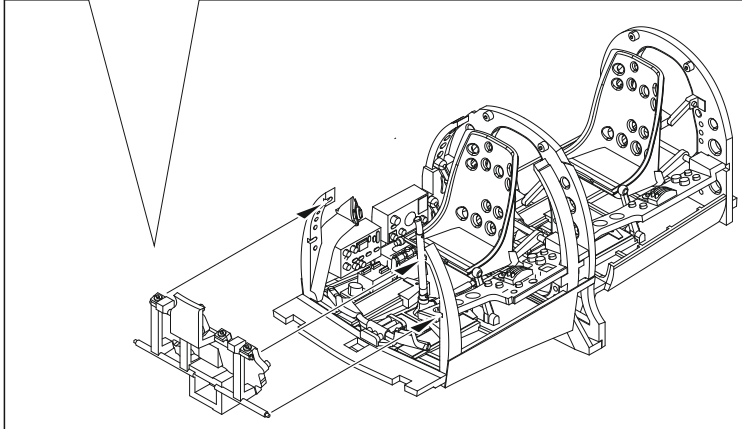
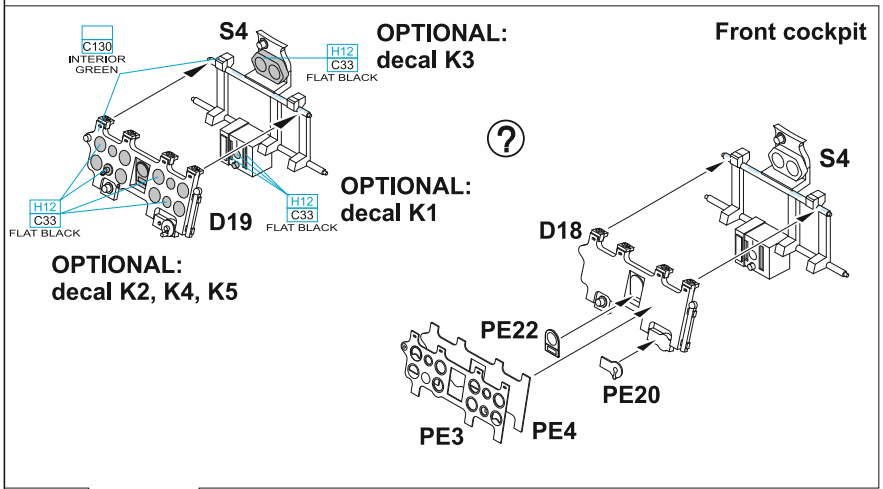
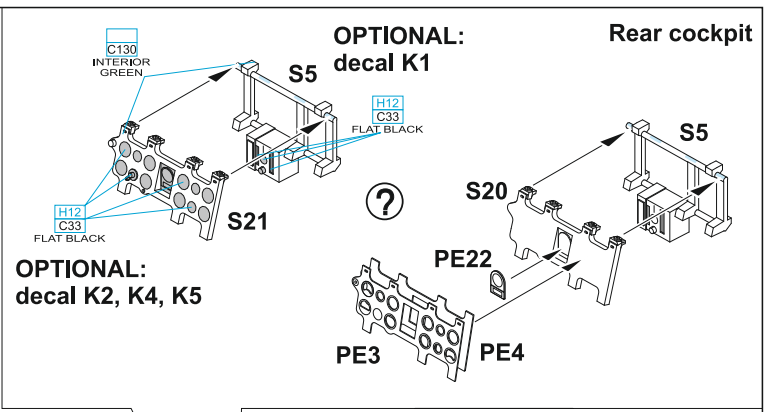
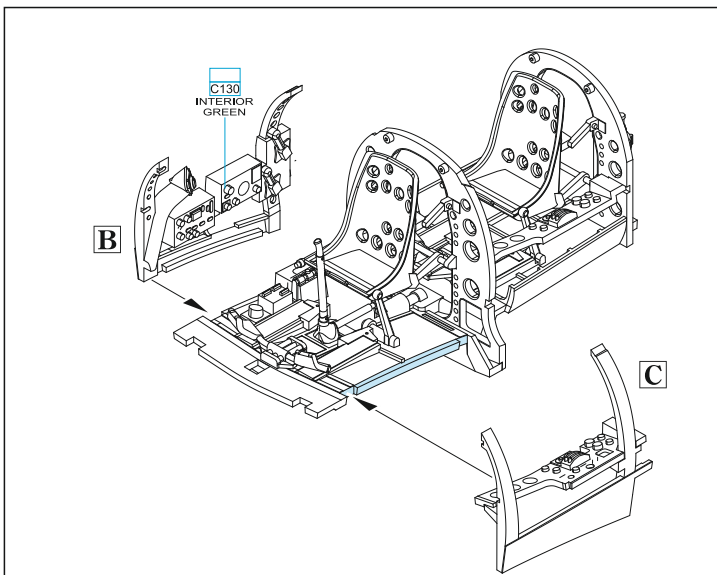

MARKINGS A, B, C, D ONLY

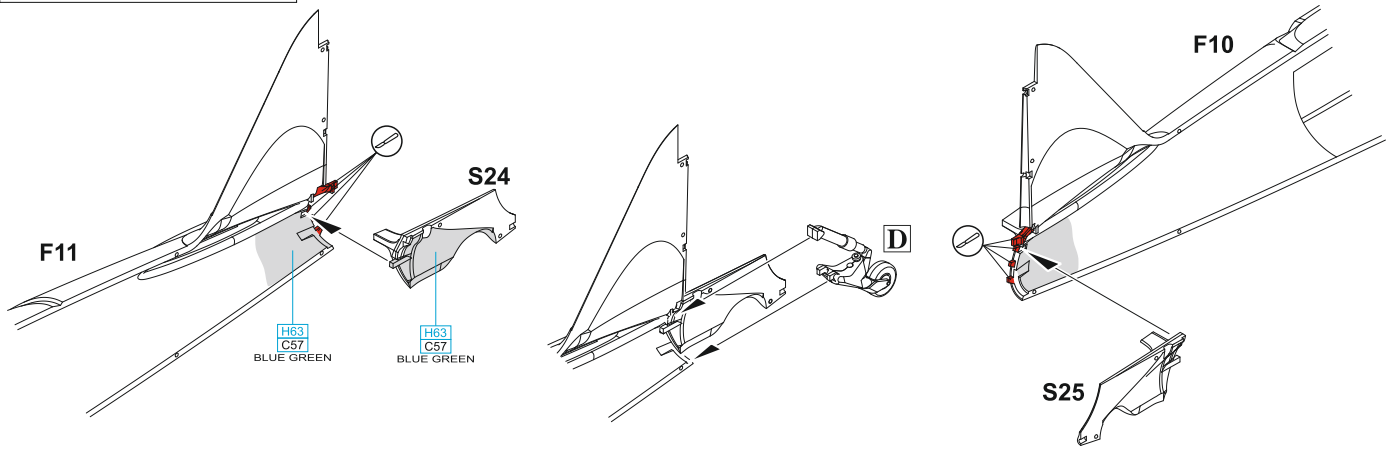

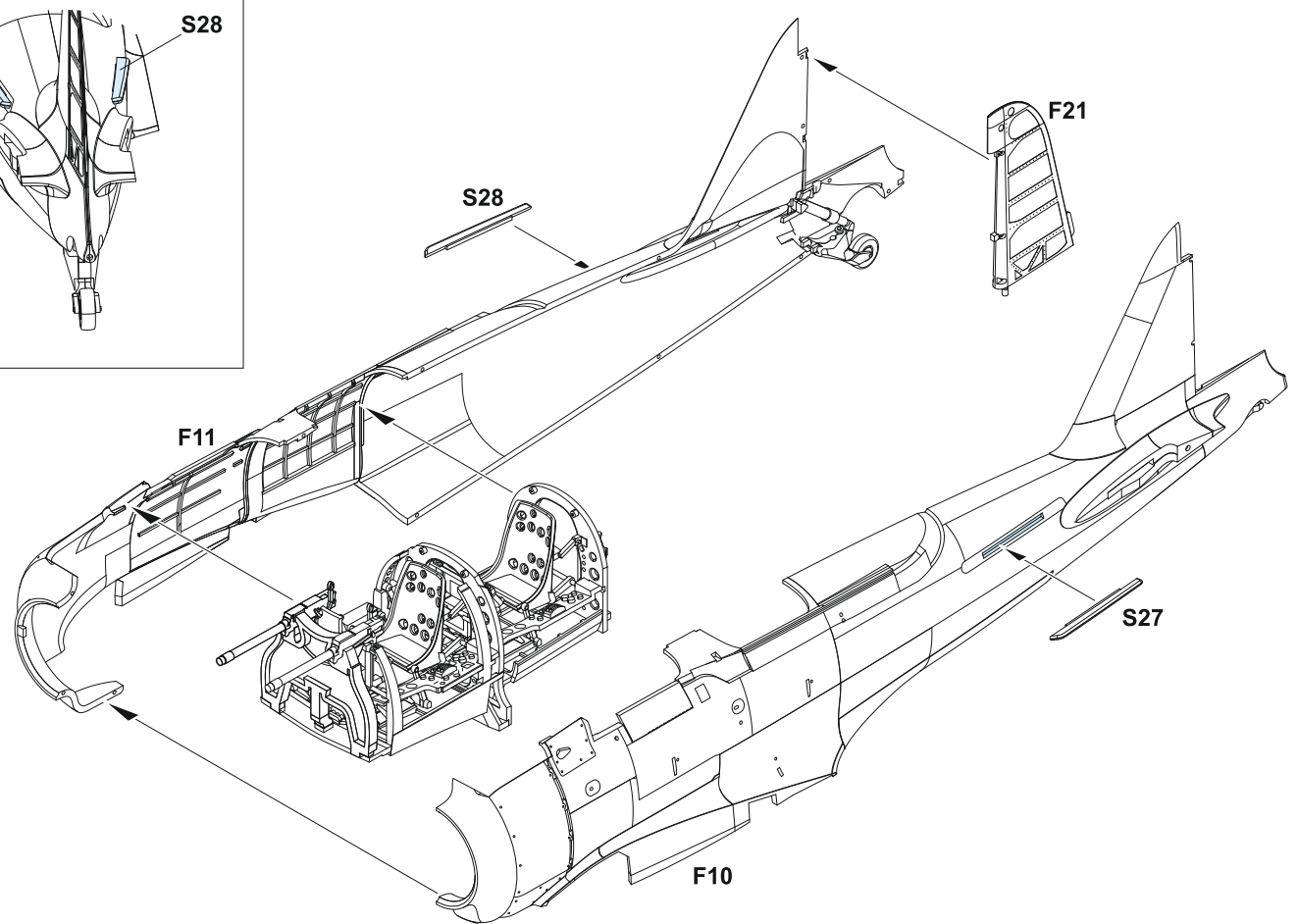
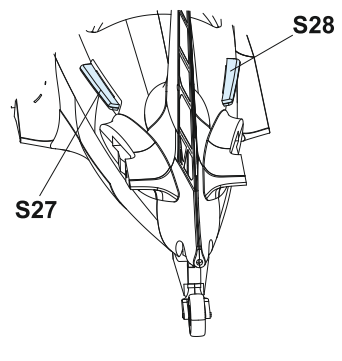
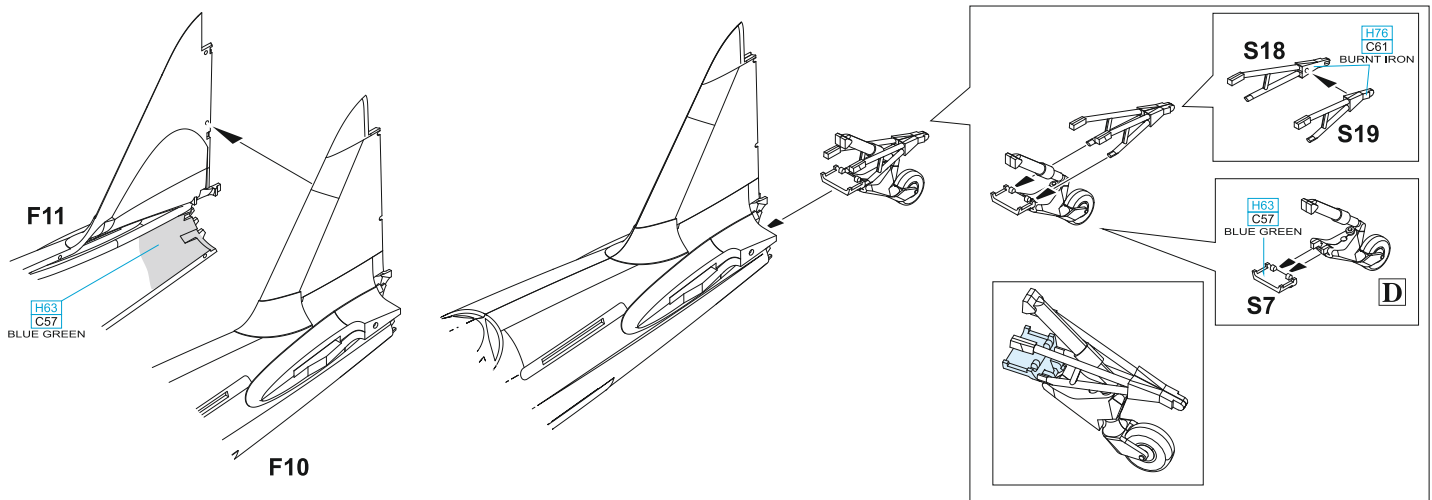

MARKING F ONLY

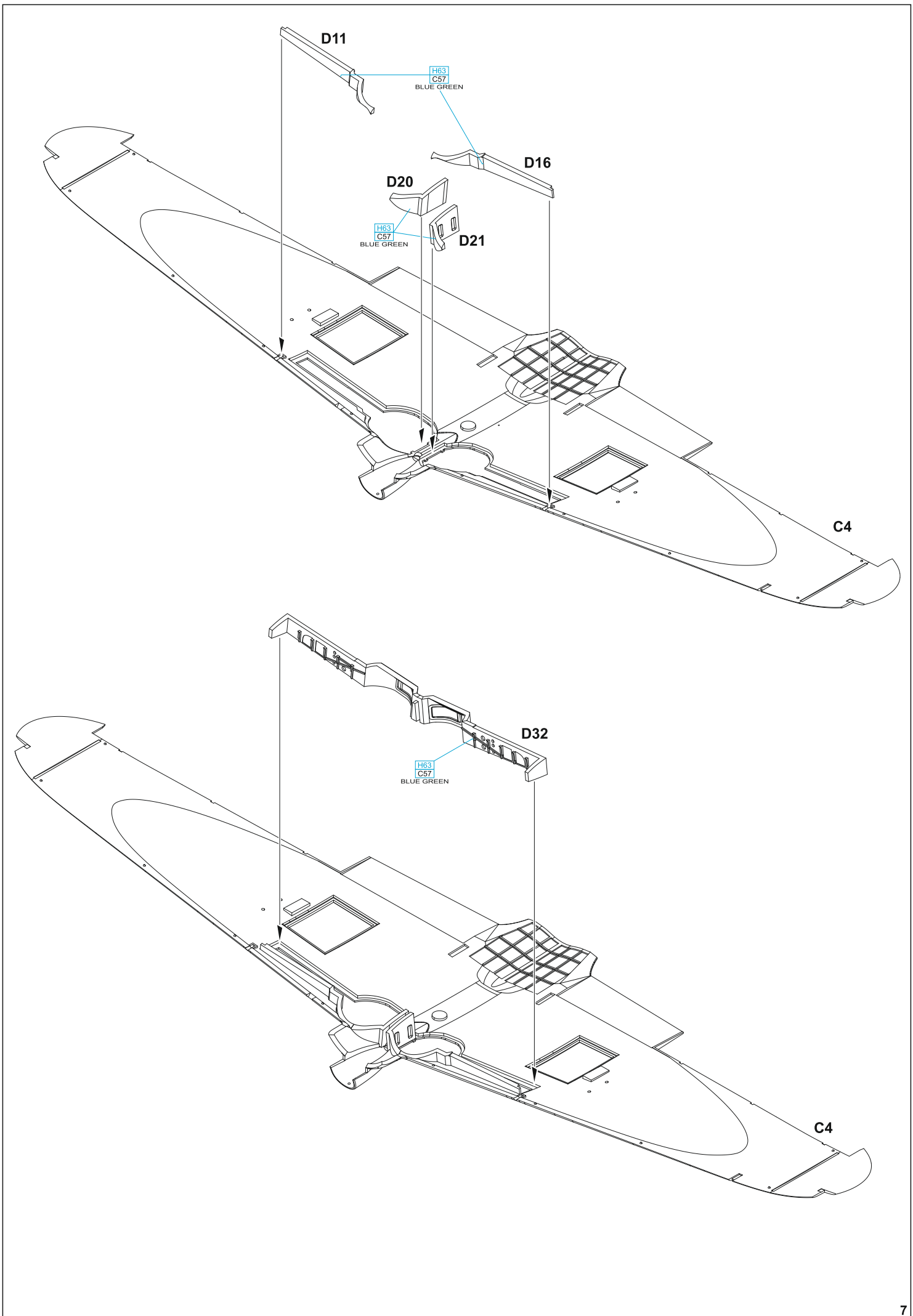

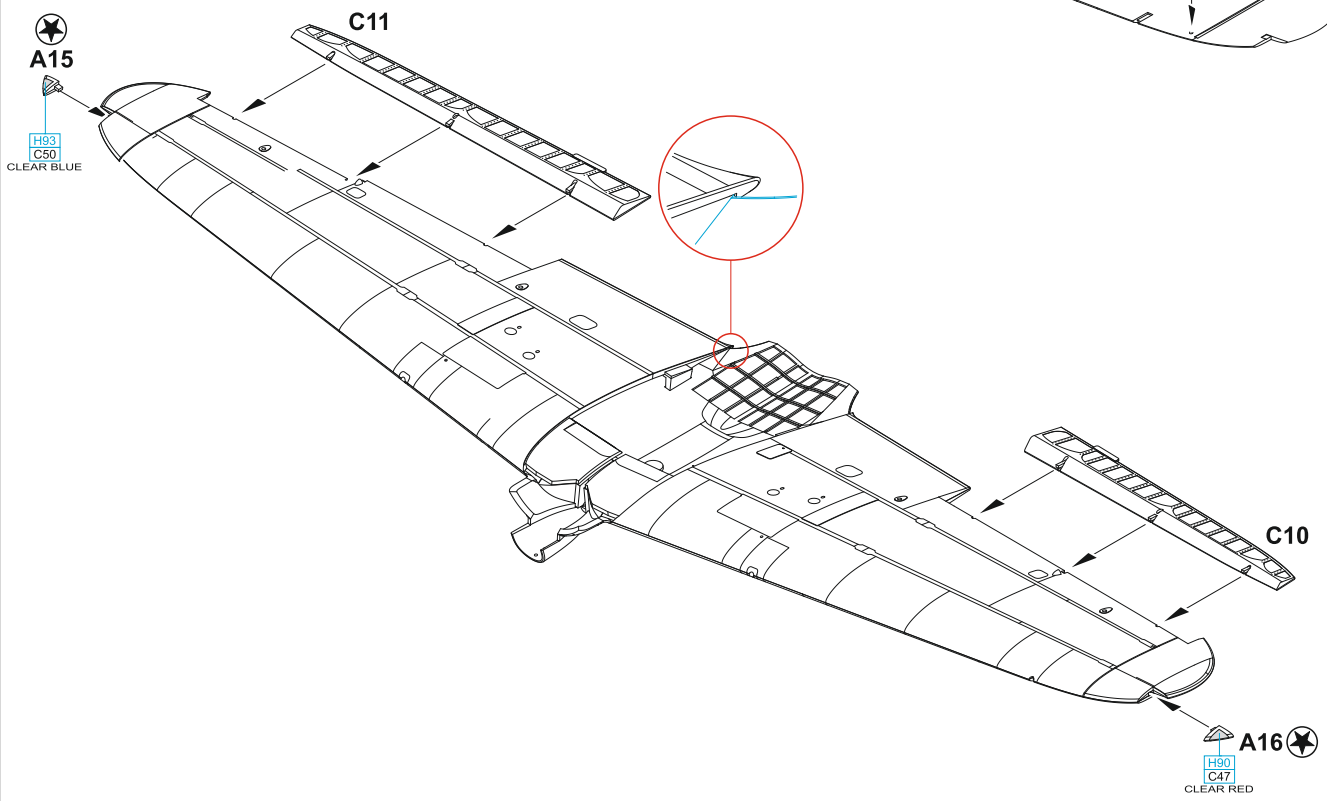
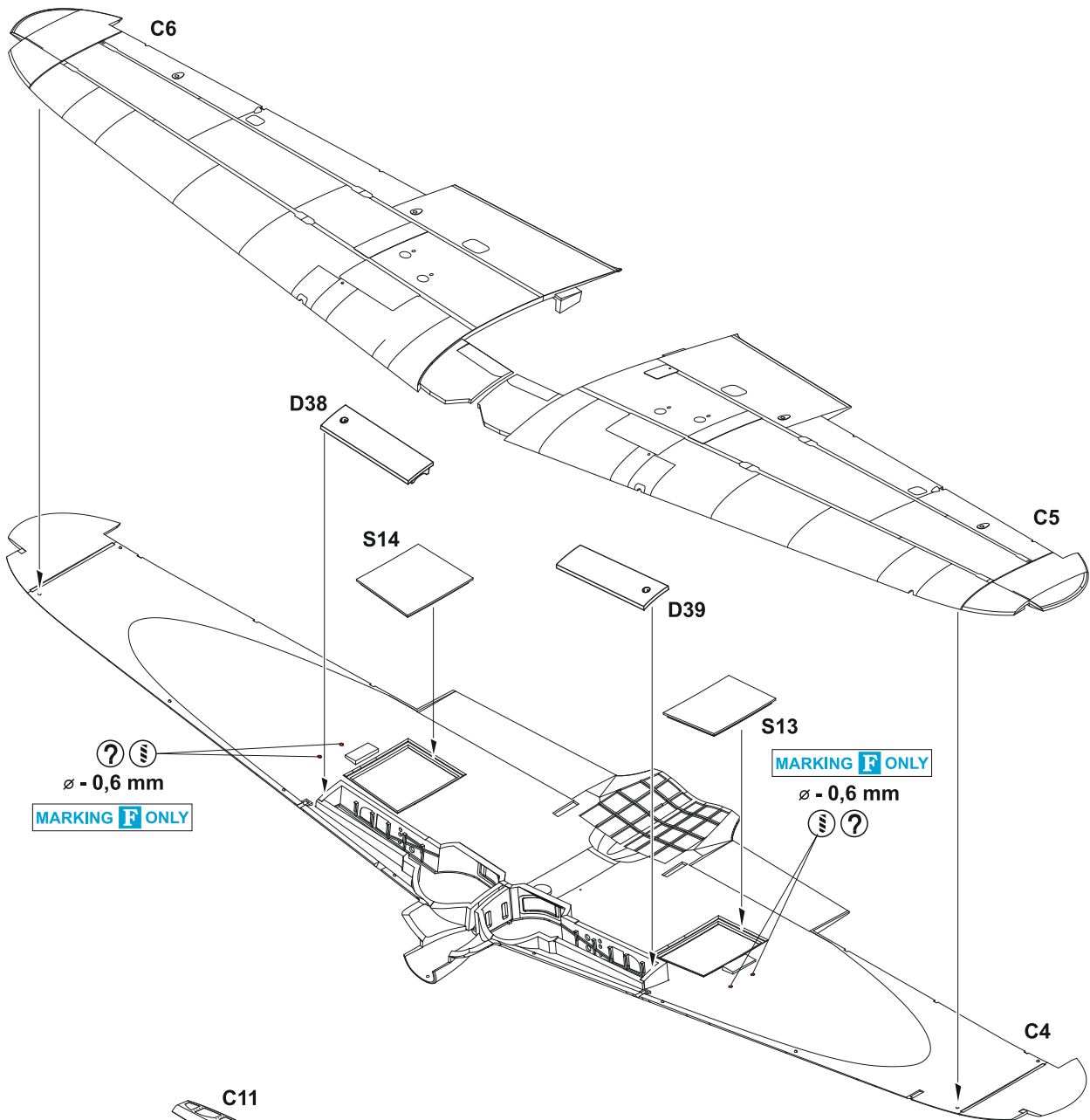

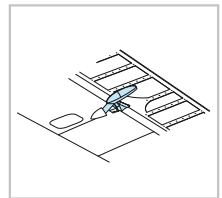
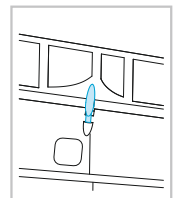
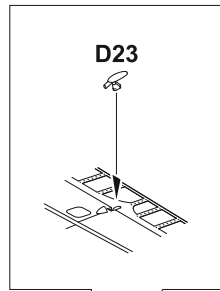
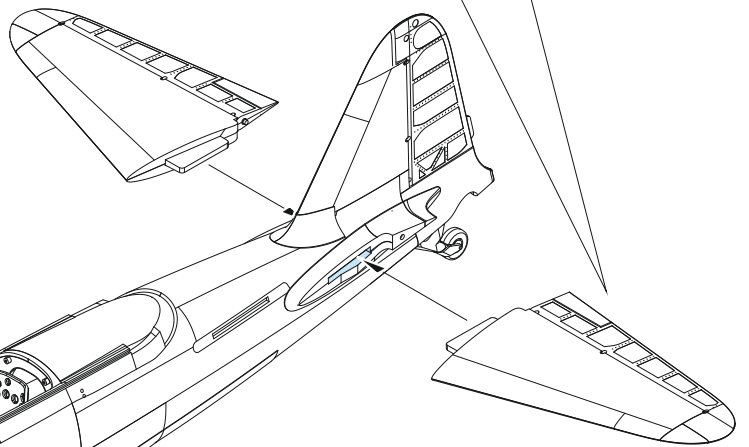
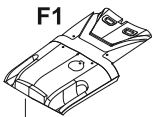
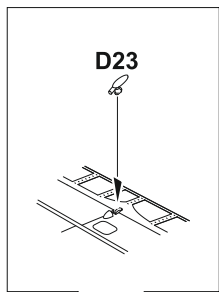
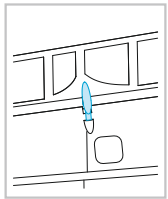
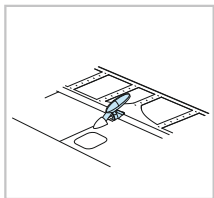
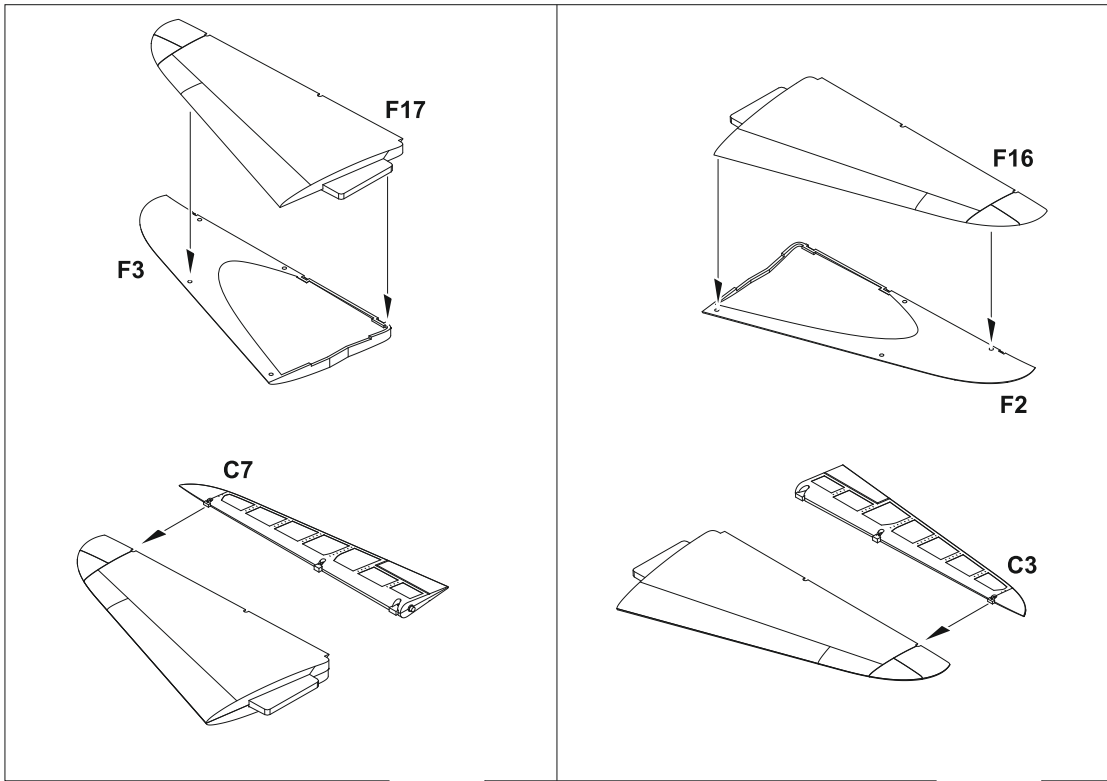

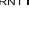

 **PE25**
 CAMOUFLAGE COLOR
 **H76**
 **G81**
 BURNT IRON

E

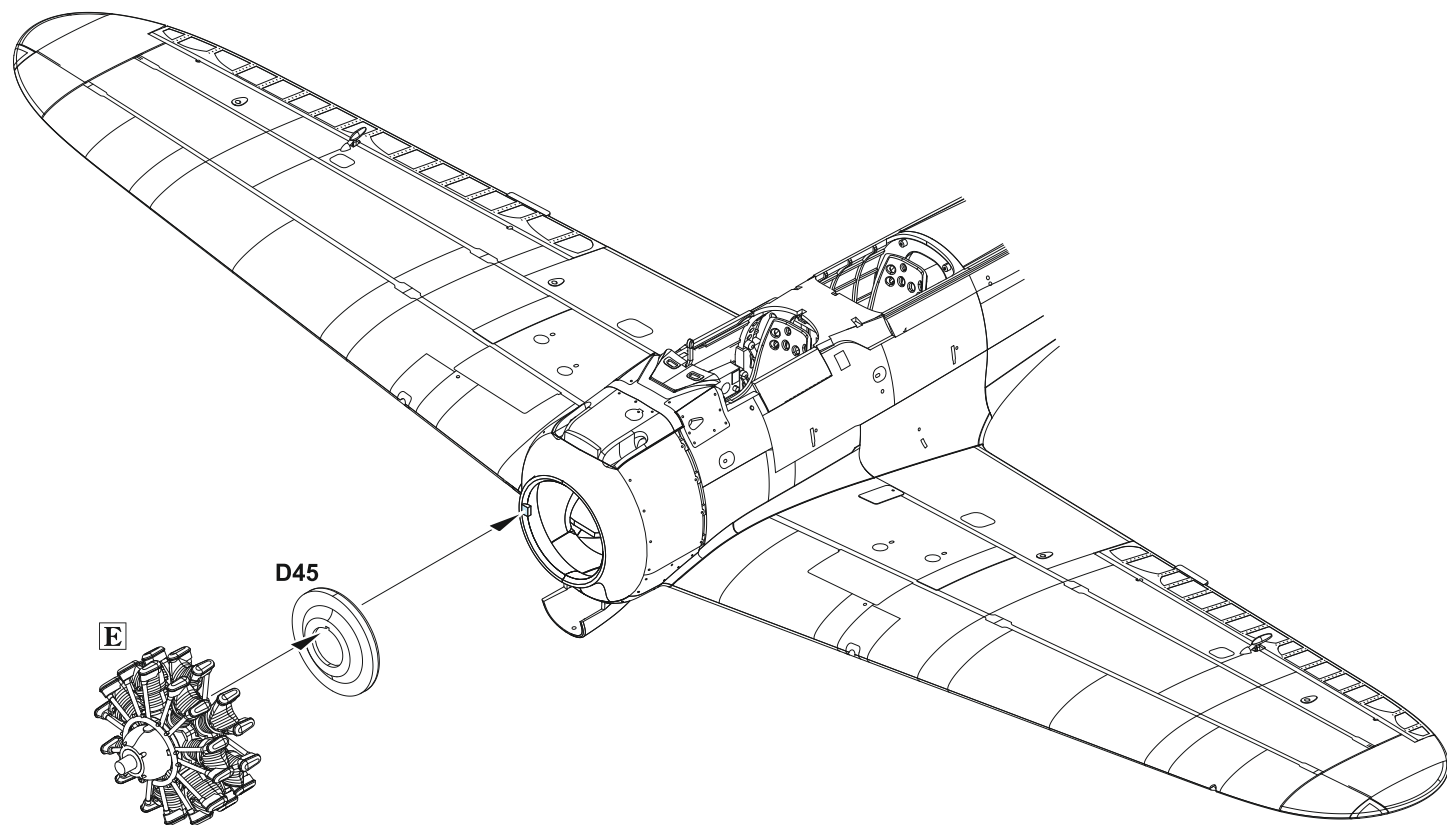
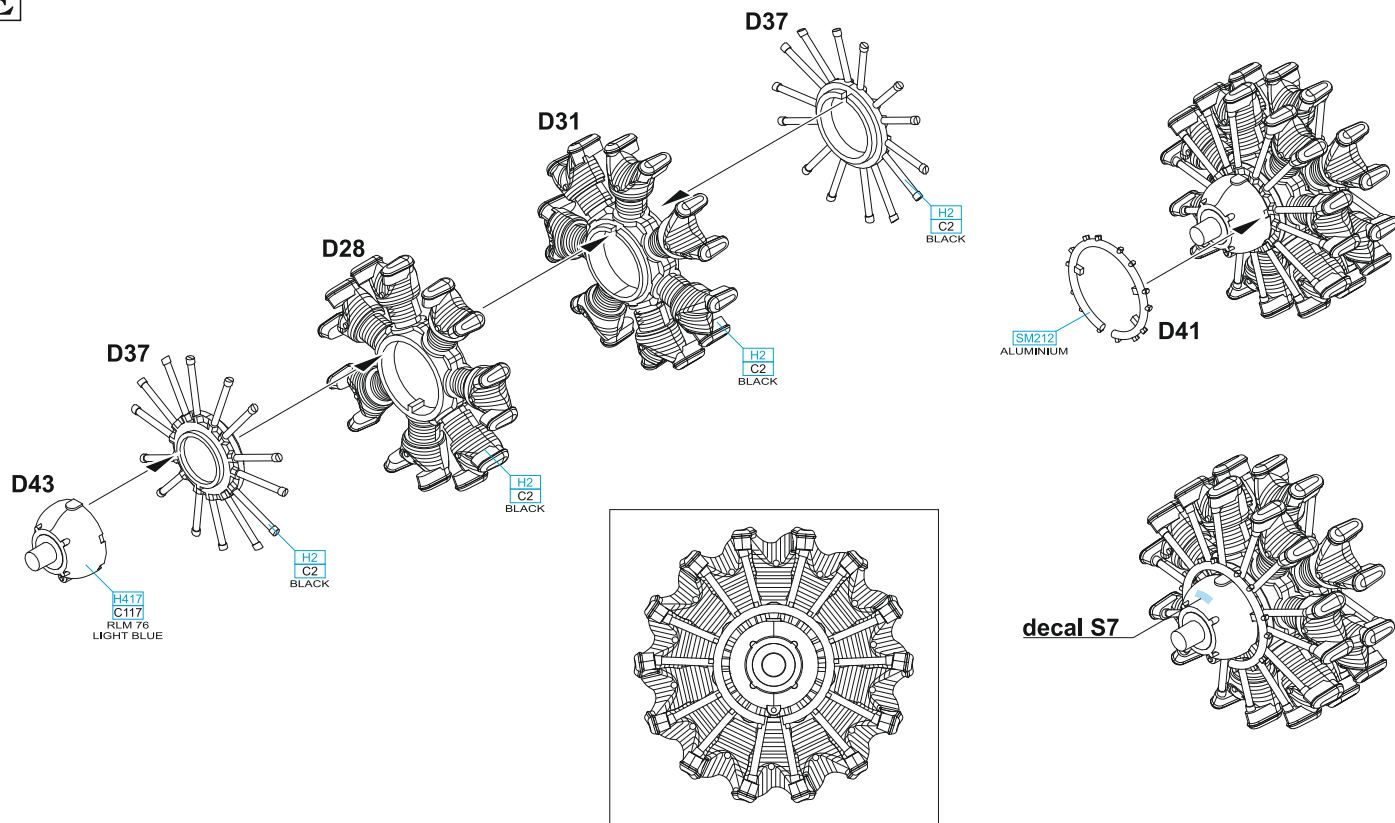

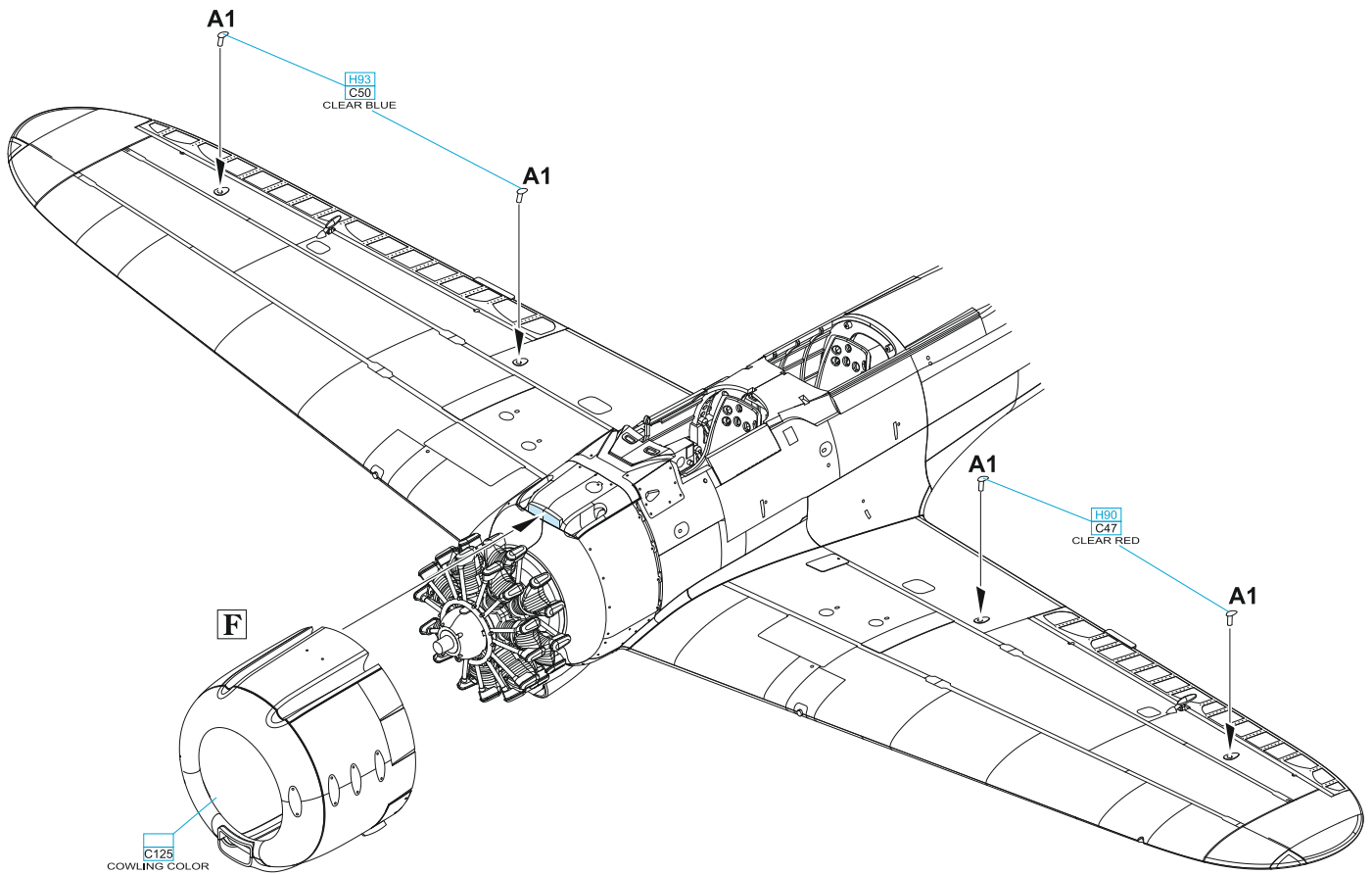
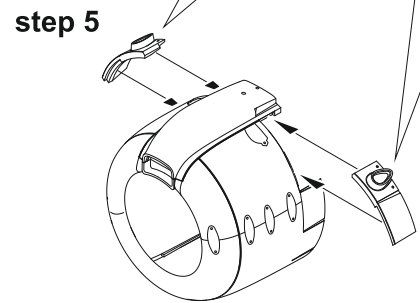
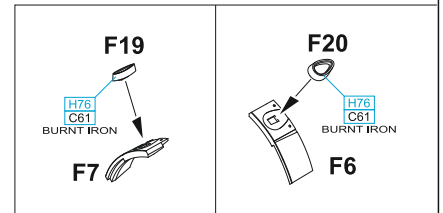
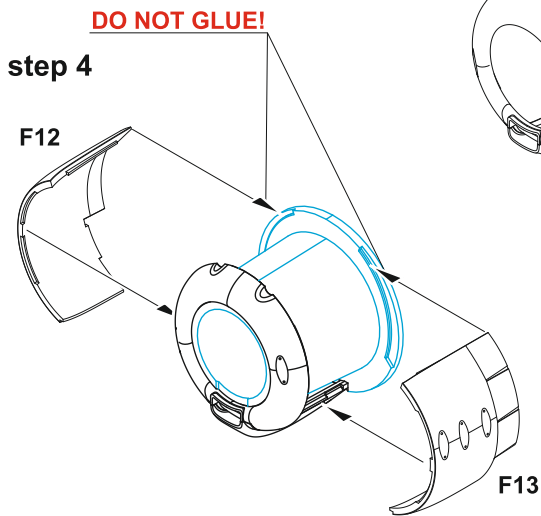
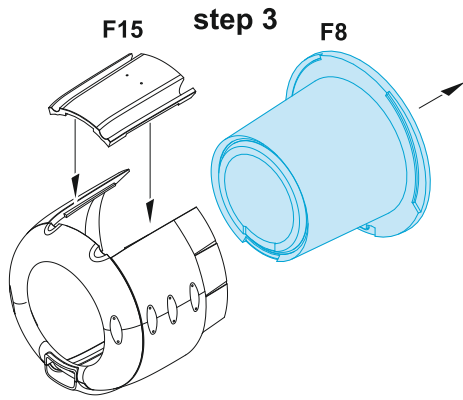
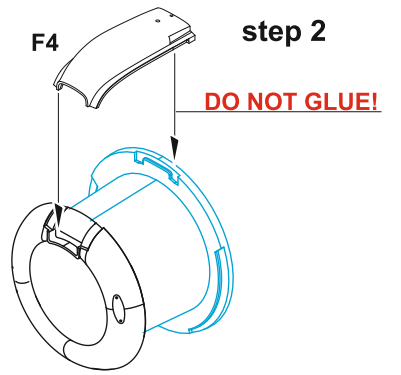
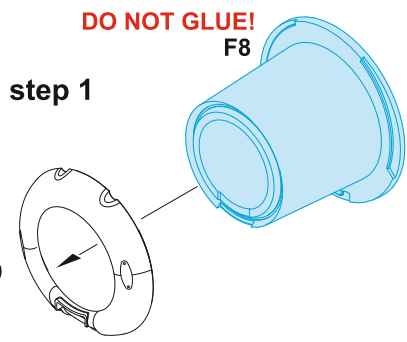
F

1 = H24
C58 - MARKINGS **D, E, F**
SM212 ALUMINIUM - MARKINGS **A, B, C**

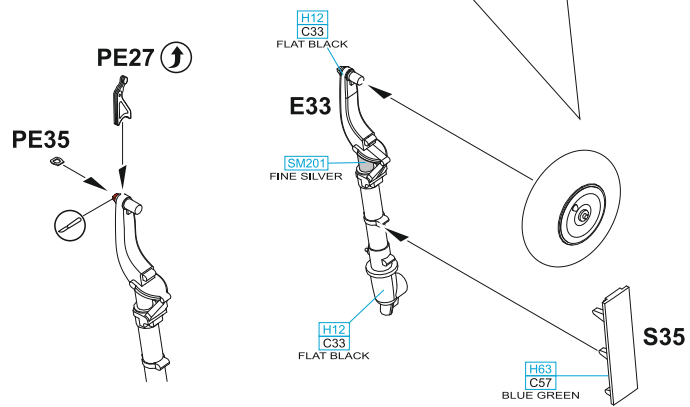
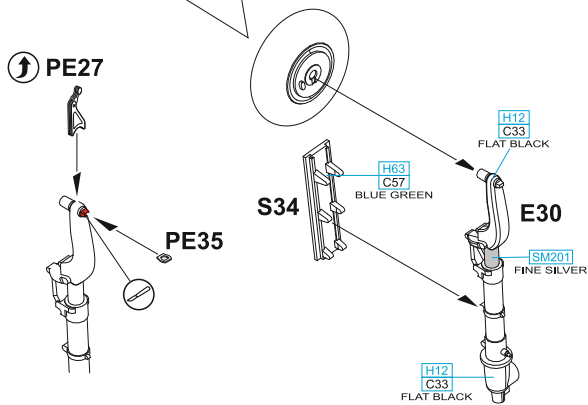
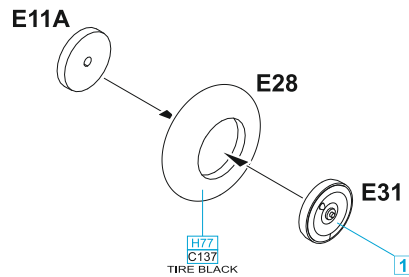
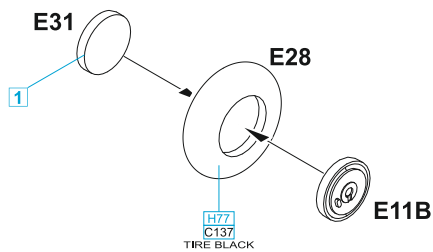

FRONT VIEW

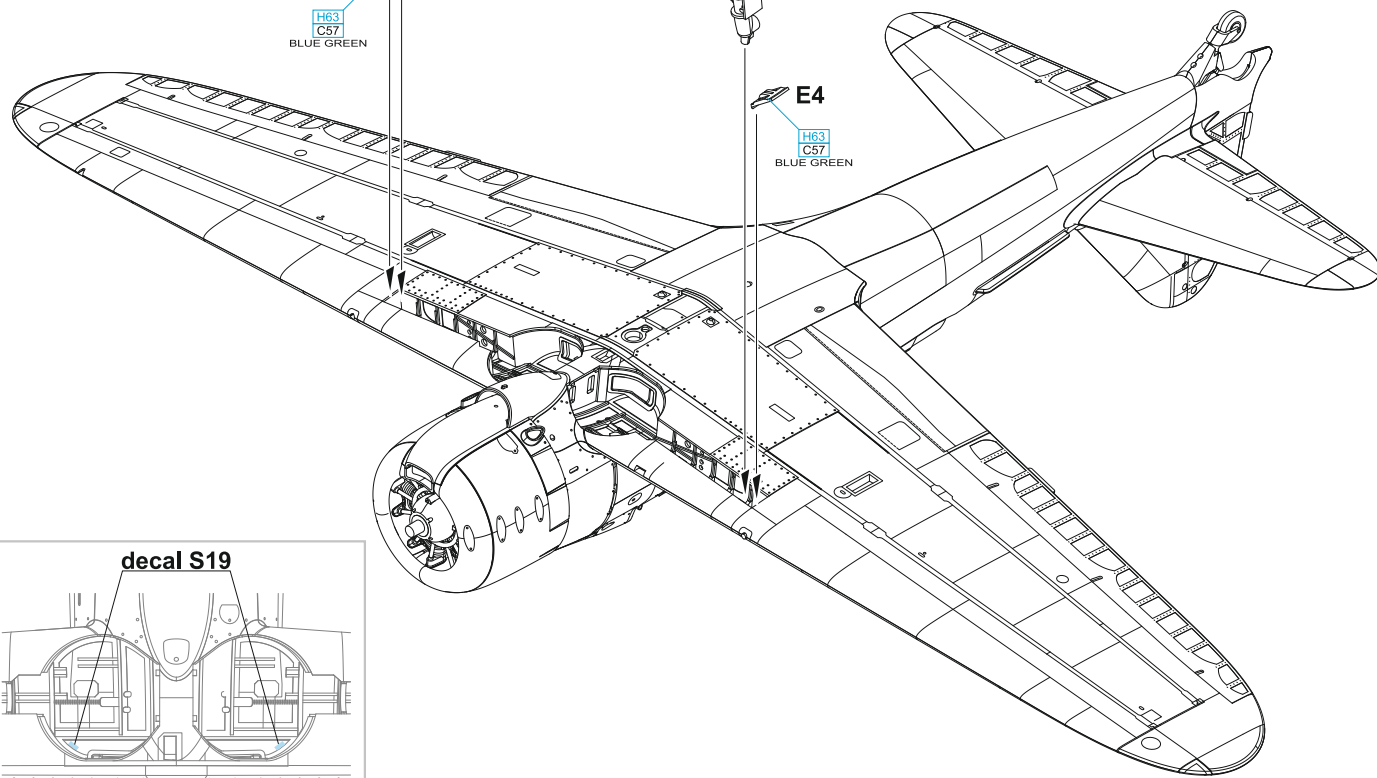
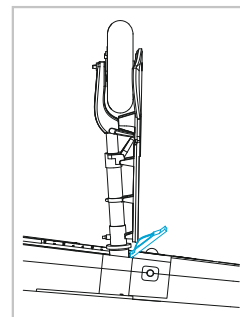
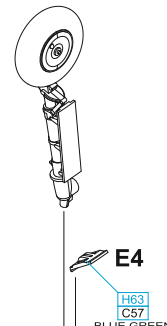
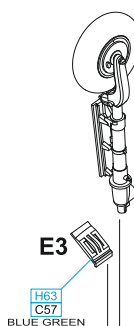
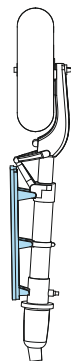

decal S19

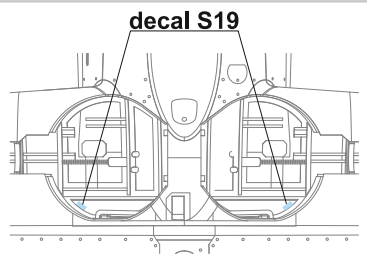

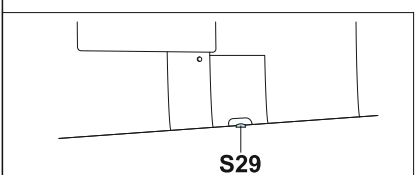
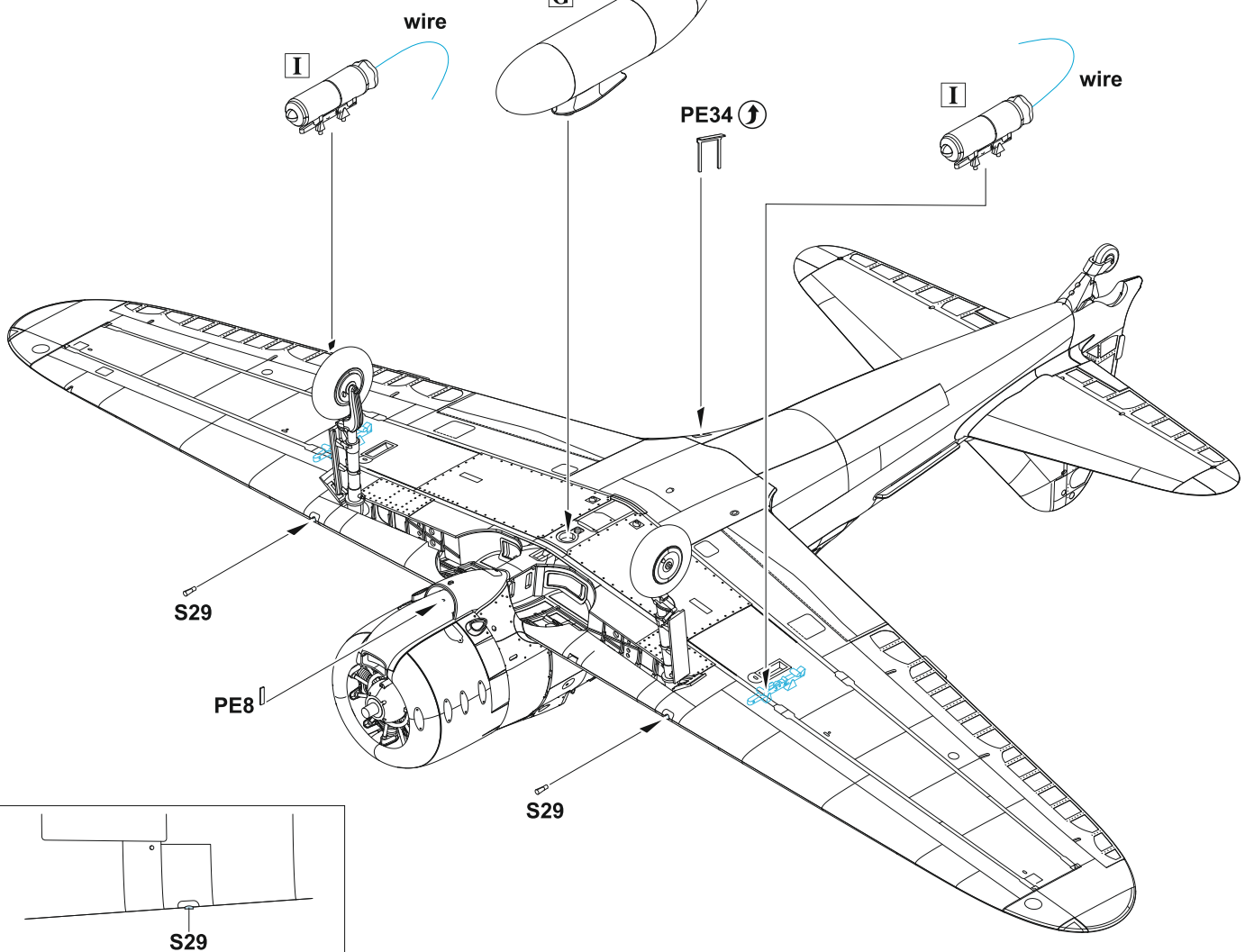
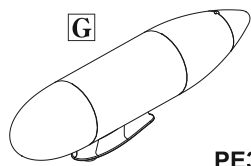
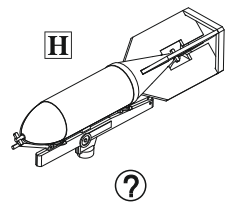
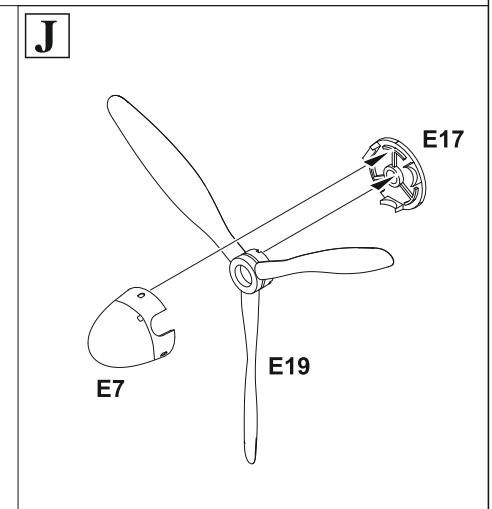
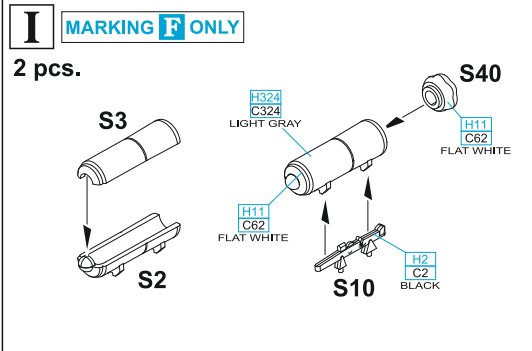
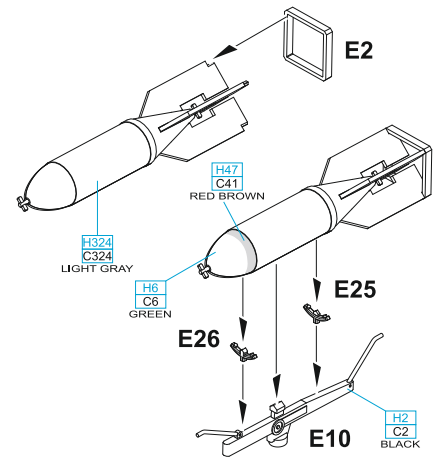
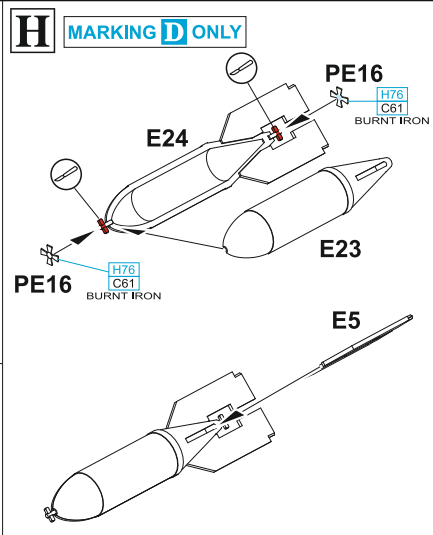
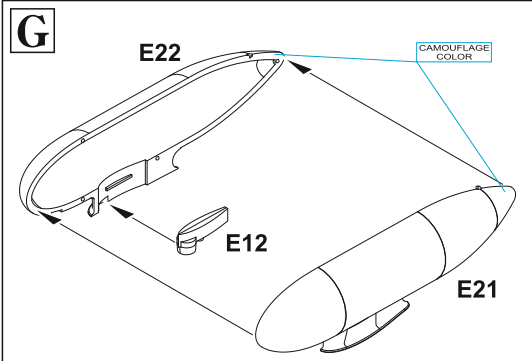

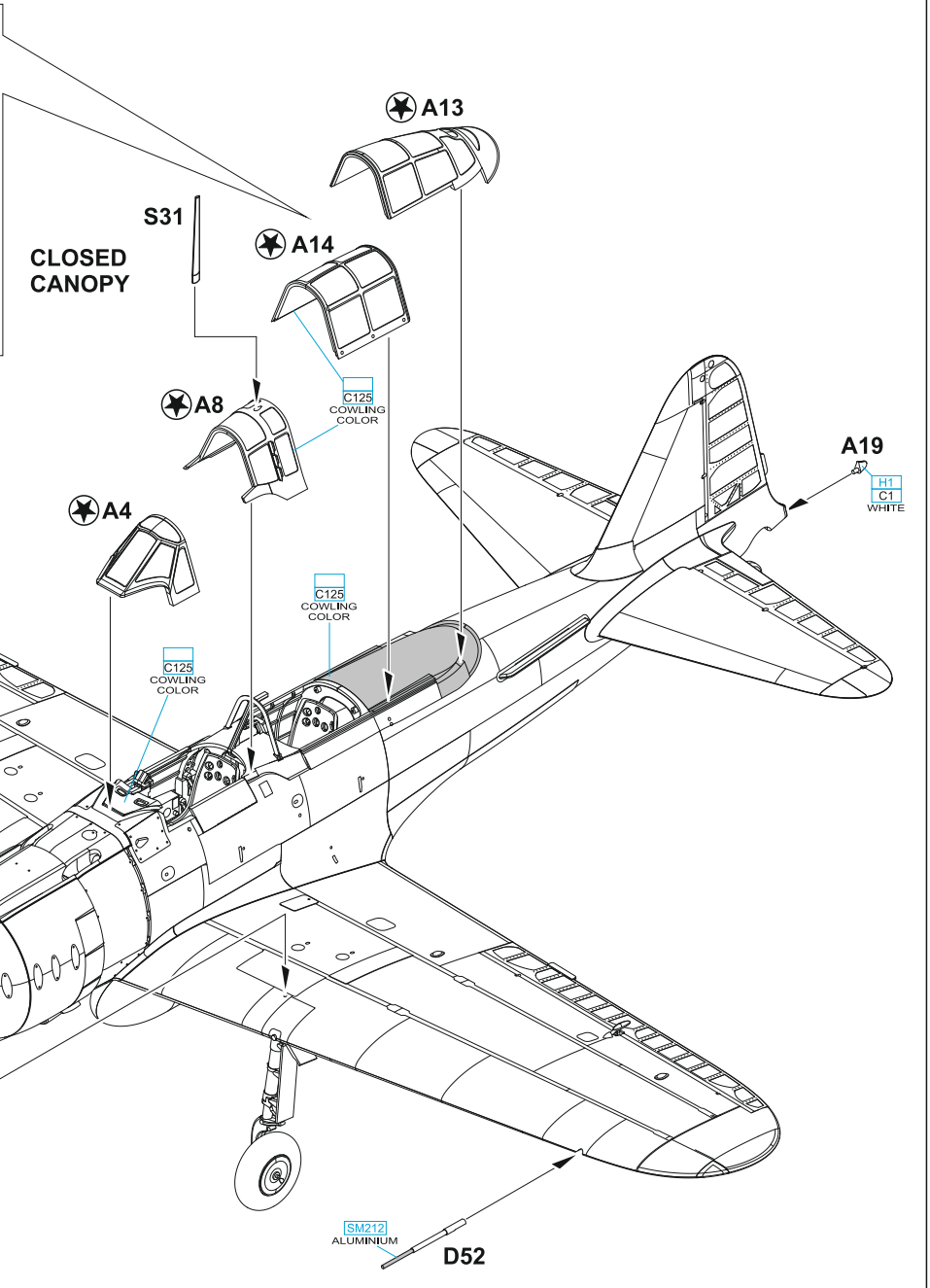
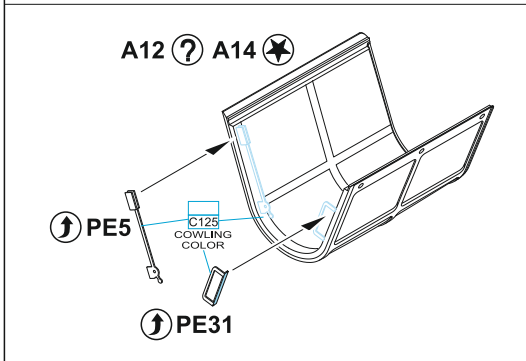
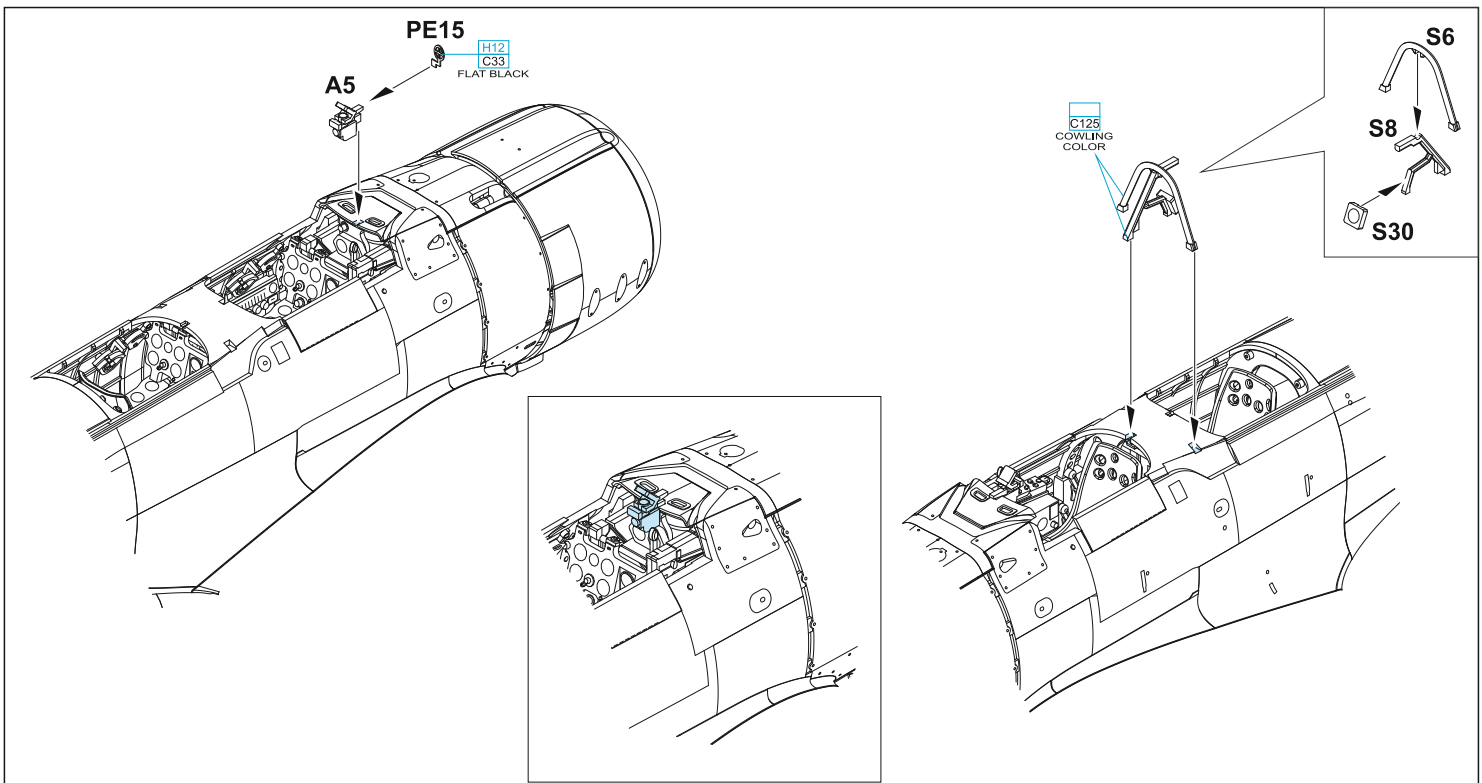

OPEN
CANOPY

A12 

WIRE

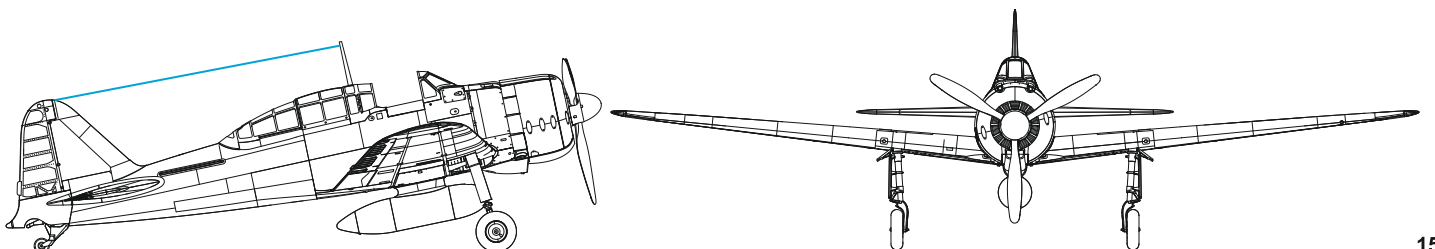
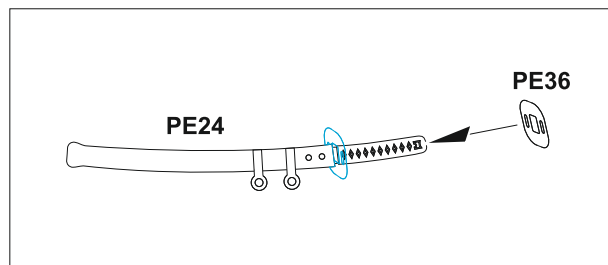
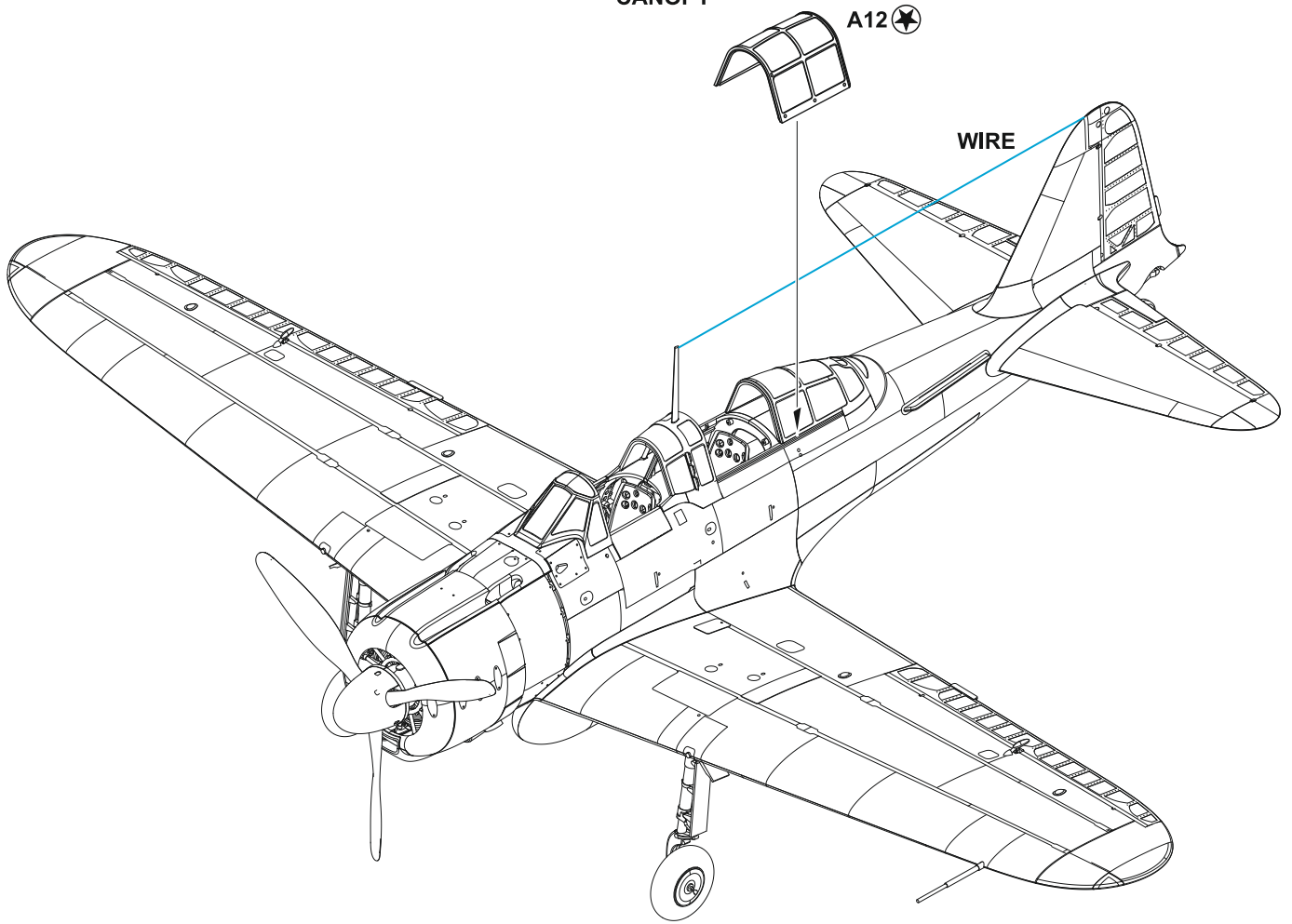

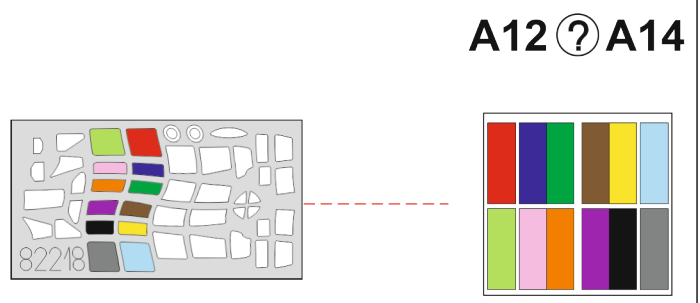
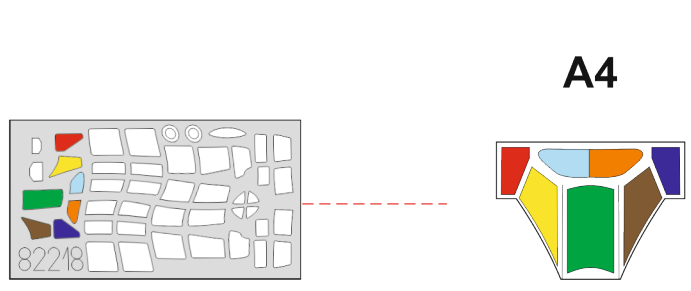
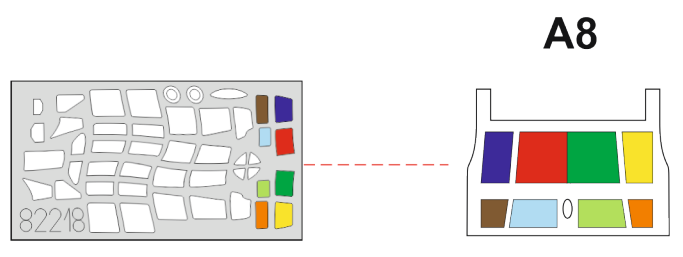
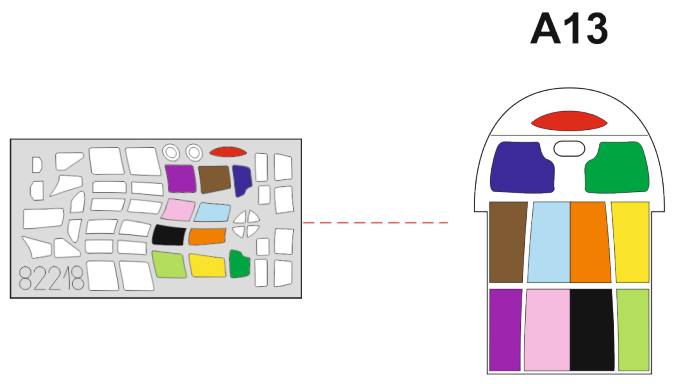
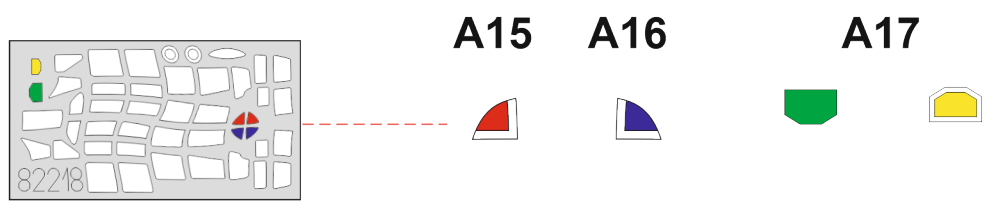
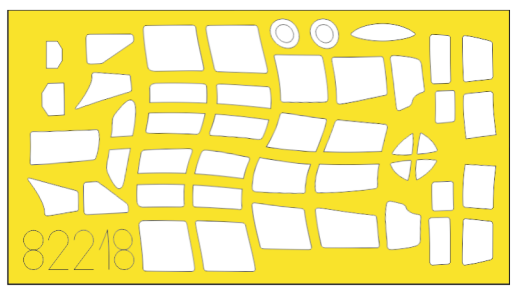

A Tsukuba Kōkūtai, Tsukuba Base, Japan, 1944

Tsukuba Kōkūtai training unit was separated from Kasumigaura Kōkūtai in December 1938. Over the time, the focus of training provided by the unit changed. In November 1944, Tsukuba Kōkūtai assigned experienced instructors to form a fighter squadron equipped with Zero and Shiden aircraft. This squadron engaged in combat with B-29 bombers and U.S. carrier-based aircraft as early as January and February 1945. At the end of March 1945, Tsukuba Kōkūtai was ordered to form its own Kamikaze units, designated Tsukuba-tai No. 1 to No. 6. However, the last two Kamikaze units were staffed by Zero pilots from Kōkūtai 721. In July 1943, a regulation was issued that, among other things, mandated that training aircraft deployed in combat operations or based in areas where the enemy was active should be painted like combat aircraft. In practice, this led to the repainting of already-produced A6M2-K trainers. One such aircraft was Tsu-415, which is known from a photograph showing it with a yellow-orange coating on all surfaces. However, in a later photograph, it appears camouflaged with dark green paint on the upper surfaces, while the original paint and markings on the tail remained unchanged.

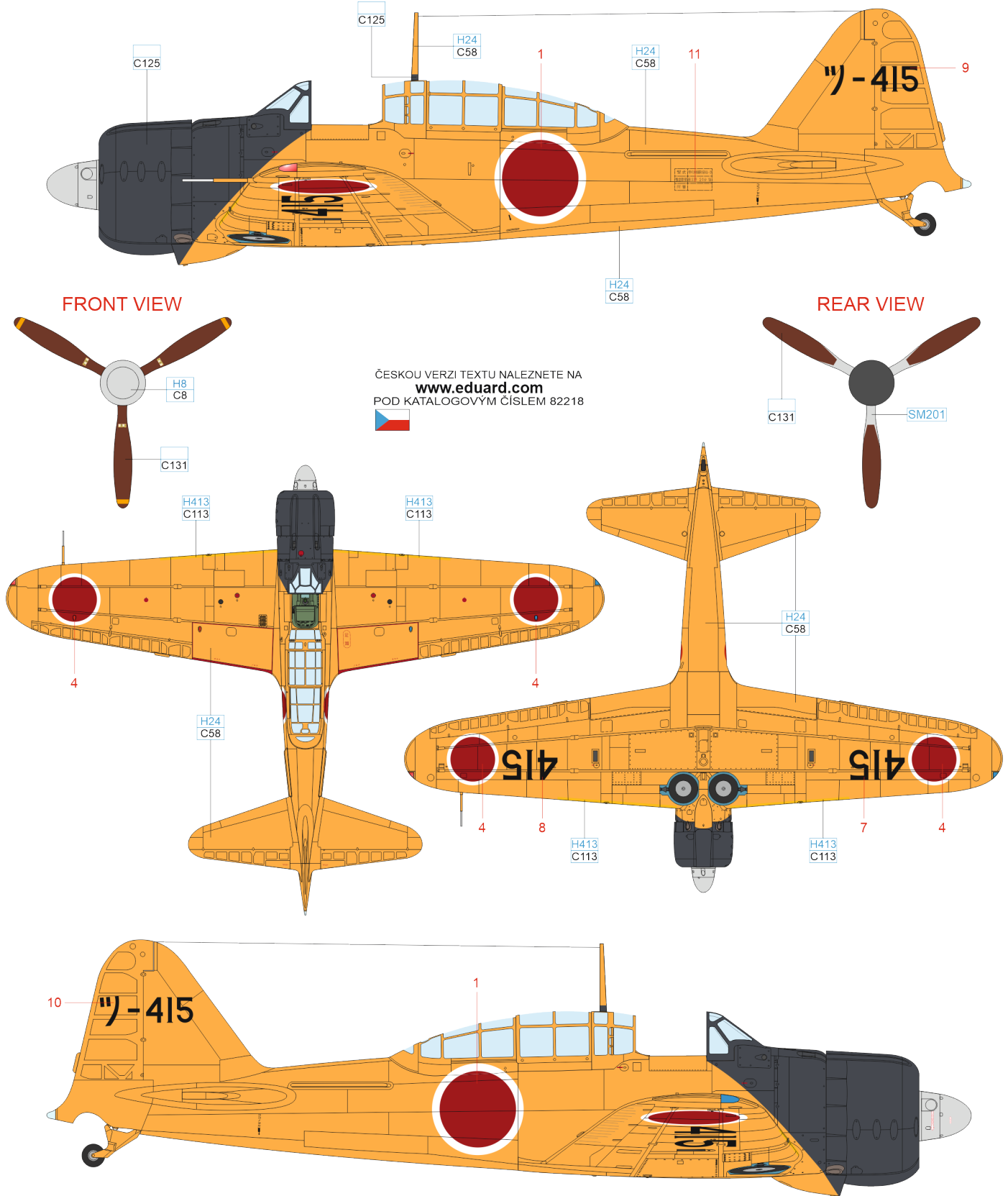

SILVER	H8 C8	RED BROWN	C131	SUPER FINE SILVER	SM201
ORANGE YELLOW	H24 C58	COWLING COLOR	C125	YELLOW	H413 C113

B probably Kōkūtai 332, Japan, 1945

This trainer aircraft, found in Japan at the end of the war, was captured on a color slide. The machine was likely assembled from at least two aircraft. In the photograph, it is clearly visible that the undersides of the wings are largely left unpainted, but part of the wing and the underside of the fuselage are painted in a yellow-orange color. The color of the undersides of the horizontal tail surfaces is not very clear in the photo, so it is possible they were left unpainted, or painted gray, and it cannot be ruled out that parts of them were also painted yellow-orange. From the photo, it is not entirely clear which part of the propeller assembly was left on the aircraft. It is possible that it is part of a spinner, painted in dark green. The aircraft likely belonged to a training squadron that was part of the Kōkūtai 332. When this IJN air group was established in August 1944, it was equipped with interceptors and two-seat float reconnaissance planes. Later, it was equipped with Zero fighters, J2M Raiden interceptors, and J1N1 Gekkō night fighters. It participated in the defense of the Philippines and defended Japan against B-29 bomber raids.

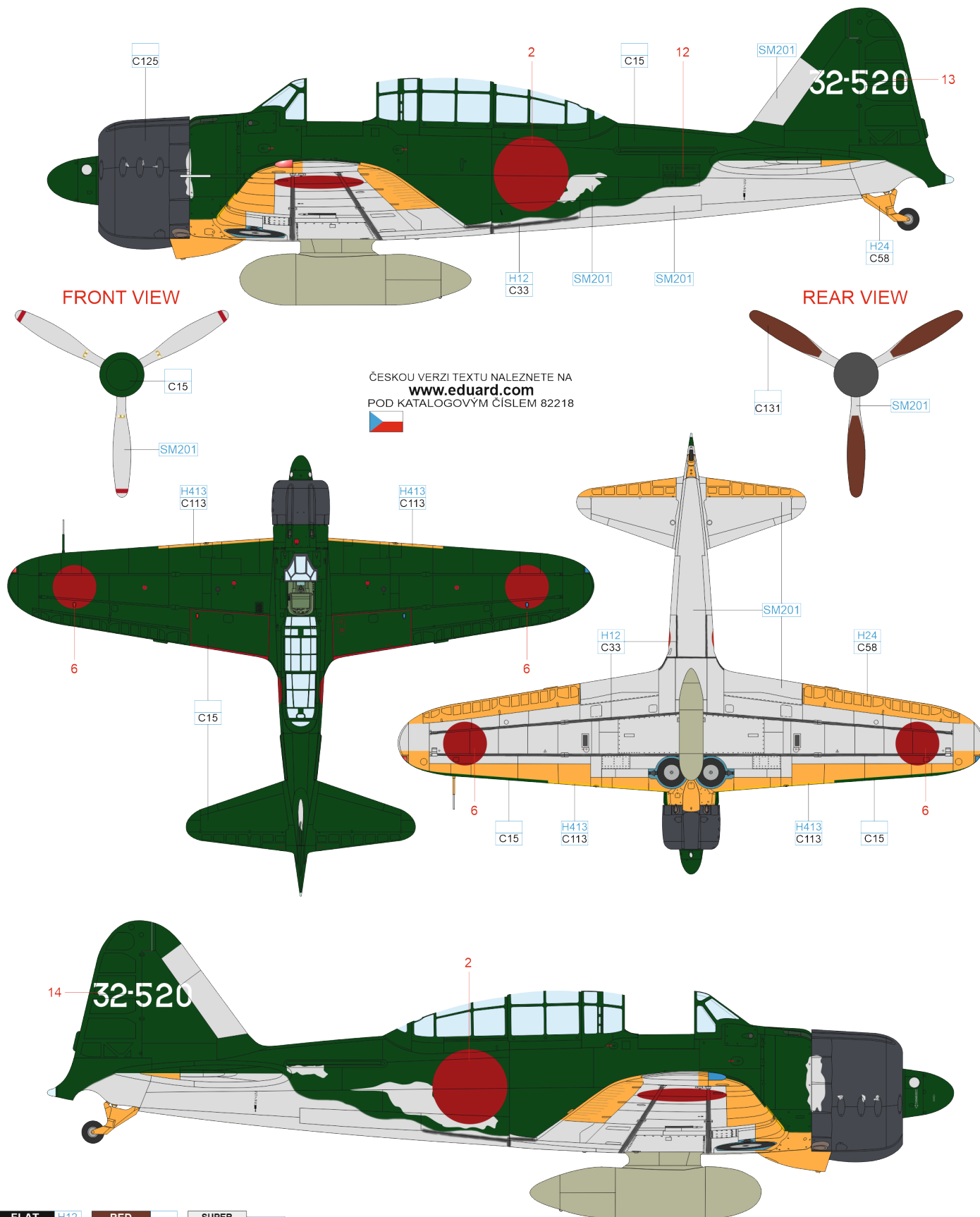

ČESKOU VERZI TEXTU NALEZNETE NA
www.eduard.com
 POD KATALOGOVÝM ČÍSLEM 82218



FLAT BLACK	H12 C33	RED BROWN	C131	SUPER FINE SILVER	SM201
DARK GREEN	C15	ORANGE YELLOW	H24 C58	YELLOW	H413 C113
				COWLING COLOR	C125

C Kōkūtai 205, Taiwan, 1945

This aircraft was captured by Chinese forces in Taiwan at the end of World War II. It is a trainer aircraft that originally belonged to the armament of Kōkūtai 205. This unit was formed in early February 1945 from personnel of various units who had been evacuated from the Philippines. The unit's official strength was 144 Zero fighter aircraft, divided among Hikōtai 302 (based in Taichū/Taichung), Hikōtai 315 (Tainan/Tai-nan), and Hikōtai 317 (Shinchiku/Hsinchu). After the American landing on Okinawa, the Japanese command decided to use all air units in Taiwan for special attack (Kamikaze) operations. For this purpose, two forward command posts were established for Kōkūtai 205 on the islands of Ishigaki-jima and Miyako-jima. The Kamikaze unit detached from Kōkūtai 205 was named Taigi-tai (Noble Cause Unit). It was deployed from April to June 1945, primarily targeting Royal Navy vessels. Taigi-tai claimed hits on the aircraft carriers HMS Formidable and HMS Indomitable.

FRESH PAINT

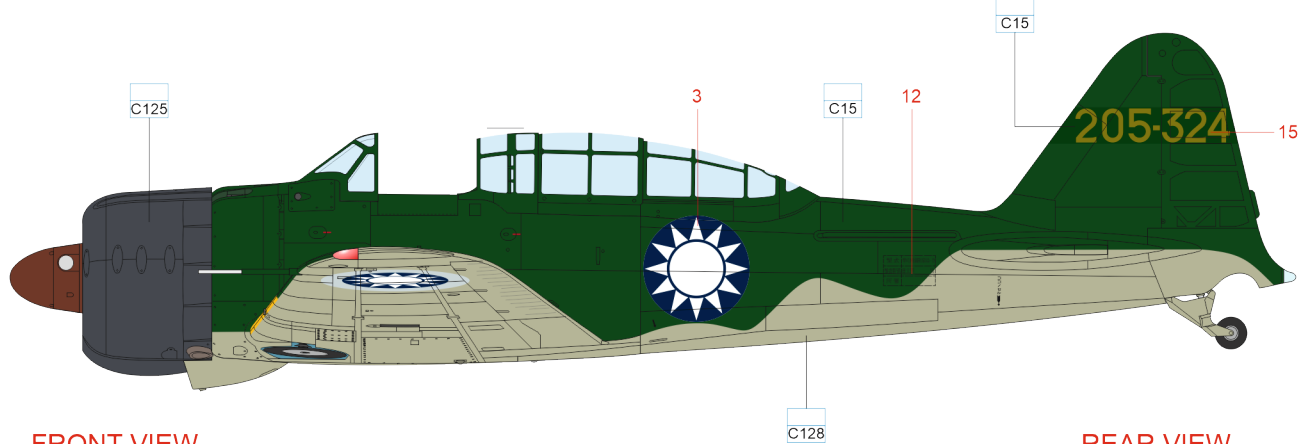

FRONT VIEW

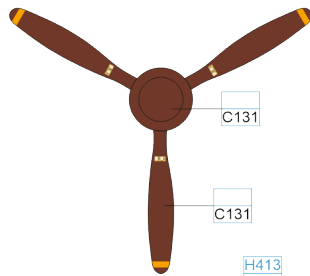

REAR VIEW

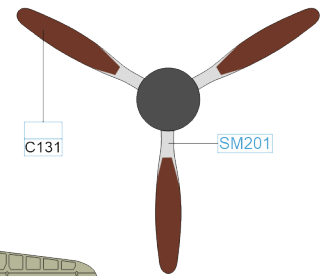

ČESKOU VERZI TEXTU NALEZNETE NA
www.eduard.com
POD KATALOGOVÝM ČÍSLEM 82218

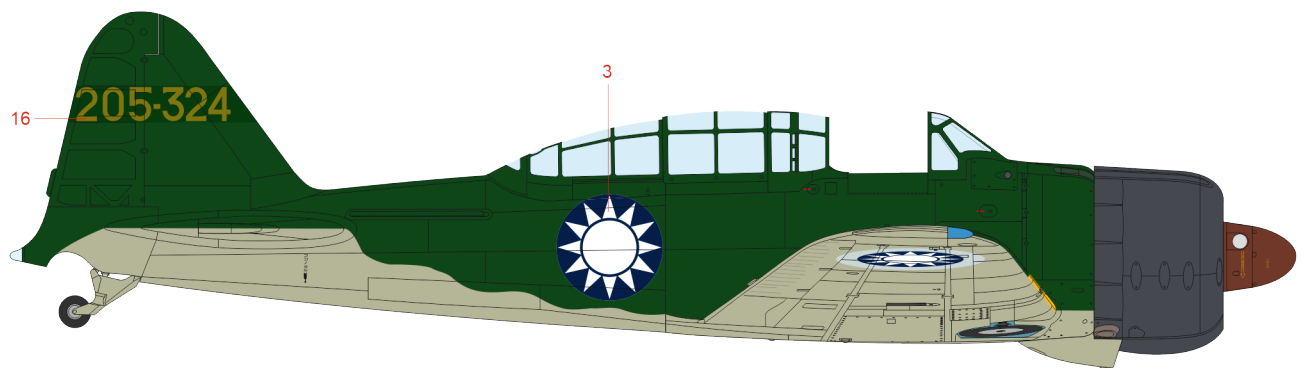
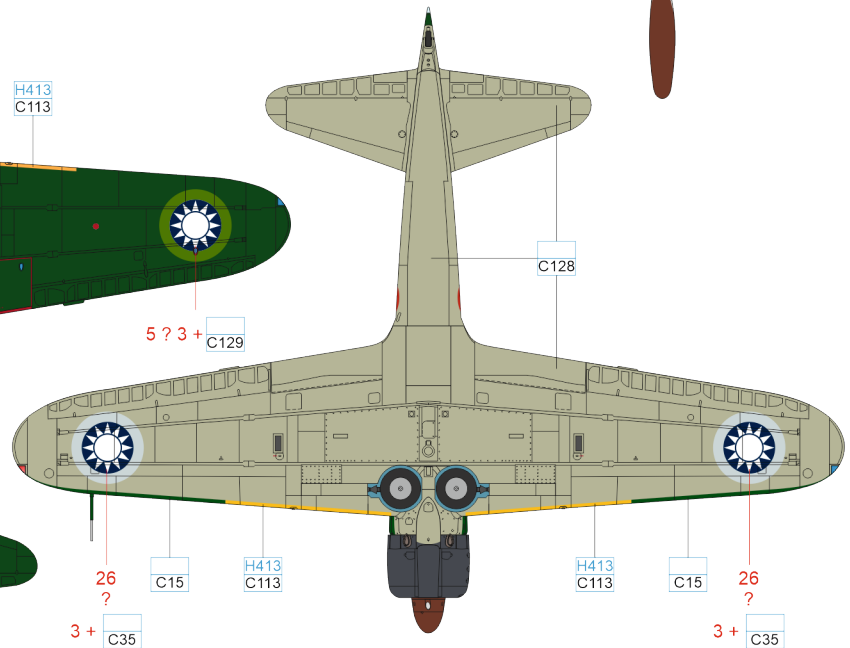
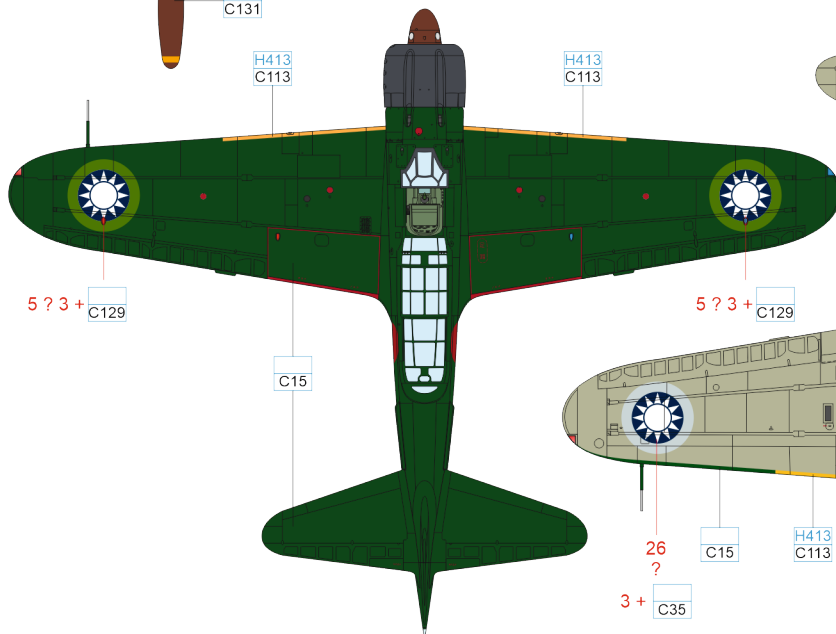

GRAY	C35	GRAY	C128	RED BROWN	C131	SUPER FINE SILVER	SM201
GREEN	C129	DARK GREEN	C15	COWLING COLOR	C125	YELLOW	H413 C113

D Ensign Daiji Matsufuji, Kamikaze Tokubetsu Kōgekитай, 1st Shichisei-tai, Kanoya airbase, Japan, April 1945

From April 3, 1945, a total of eight special attack units with the battle name Shichisei were organized from the airmen serving in Genzan Kōkūtai (II) and Hikōtai 306 (part of Kōkūtai 721). Lt. Miyatake, who was 24 years old at the time, led the 1st Shichisei-tai in an attack on a convoy off Okinawa on April 6, 1945. During that day, eleven other airmen from Genzan Kōkūtai (II) sacrificed their lives along with him. They took off successively in four formations. They were among the 524 aircraft of special attack units and escort fighters from IJN and IJA sent against Allied vessels off Okinawa as part of Operation Kikusui I. The U.S. Navy lost destroyers USS Bush (DD-529) and Colhoun (DD-801) and other ships were severely damaged. Shichisei units were sent against ships off Okinawa, Yoronjima, Kikai, and Tanegashima islands in several missions till May 14. Only one of them returned to base due to bad weather. The depicted Ke-427 aircraft was apparently assembled from two airframes with differently applied paint schemes. During a special attack mission on April 6, it was likely piloted by Ensign Daiji Matsufuji.

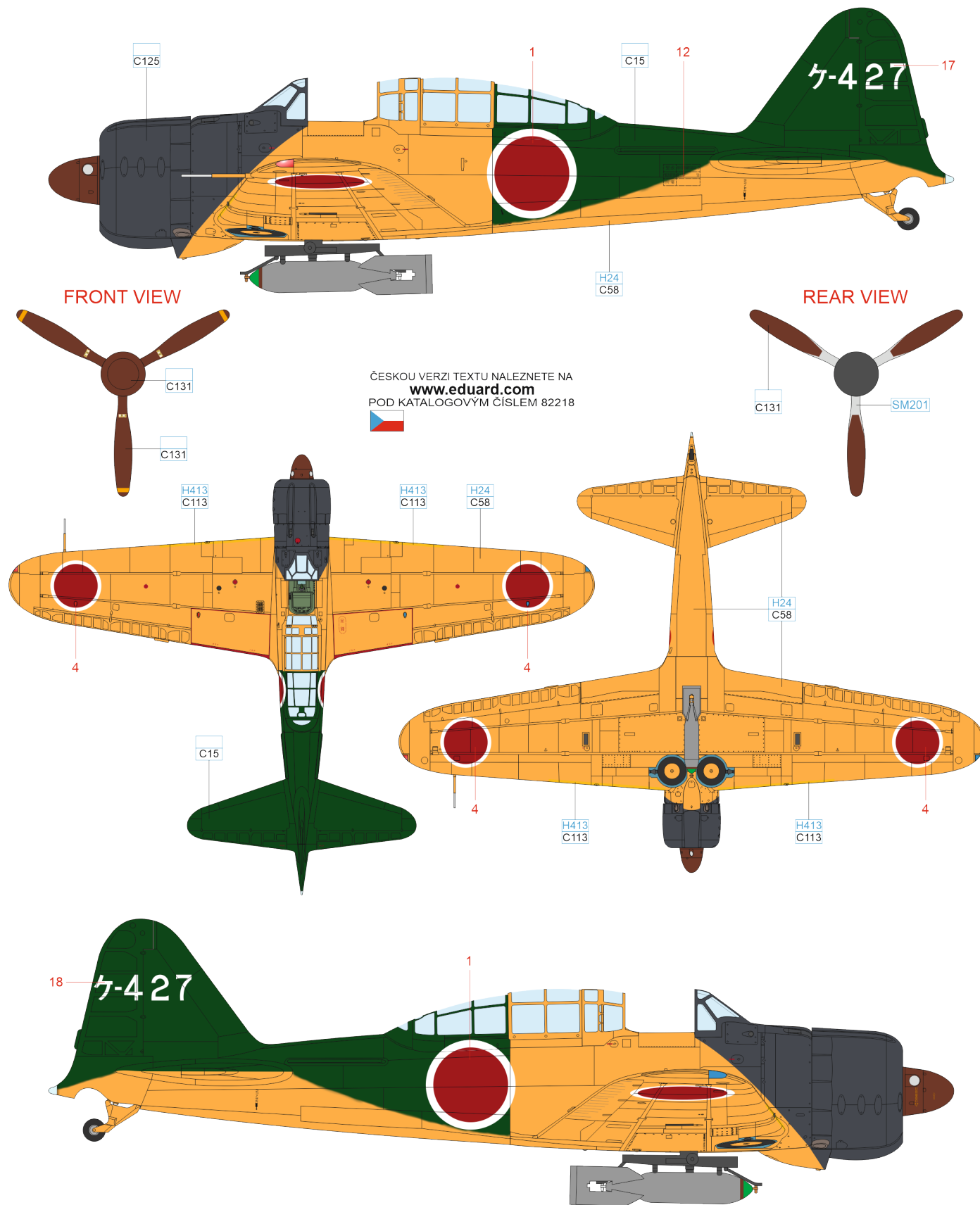

DARK GREEN	C15	RED	C131	SUPER FINE SILVER	SM201
ORANGE	H24	COWLING COLOR	C125	YELLOW	H413
YELLOW	C58				C113

E Tainan Kōkūtai (II), Tainan airbase, Taiwan, summer 1944

The designation of this training unit is the Katakana characters "Ta" and "I". The second Tainan Kōkūtai was established in April 1943 as an operational training unit. Its home base was again Tainan, as with the previous unit of that name, which became Kōkūtai 251 in late 1942. When Allied air raids on Taiwan began in the second half of the war, the airmen of Tainan Kōkūtai (II) joined in its defense. They fought both four-engine bombers and their escort fighters based in China as US Navy aircraft. Its first commander was Capt. Shigematsu Ichimura, who was commander of the 14th Kōkūtai in China in 1940. The most famous instructor who served with the unit was CPO Takeo Tanimizu, an ace with 18 kills to his credit. In January 1945, a special attack unit was organized from part of the Kōkūtai and participated in Kamikaze missions.

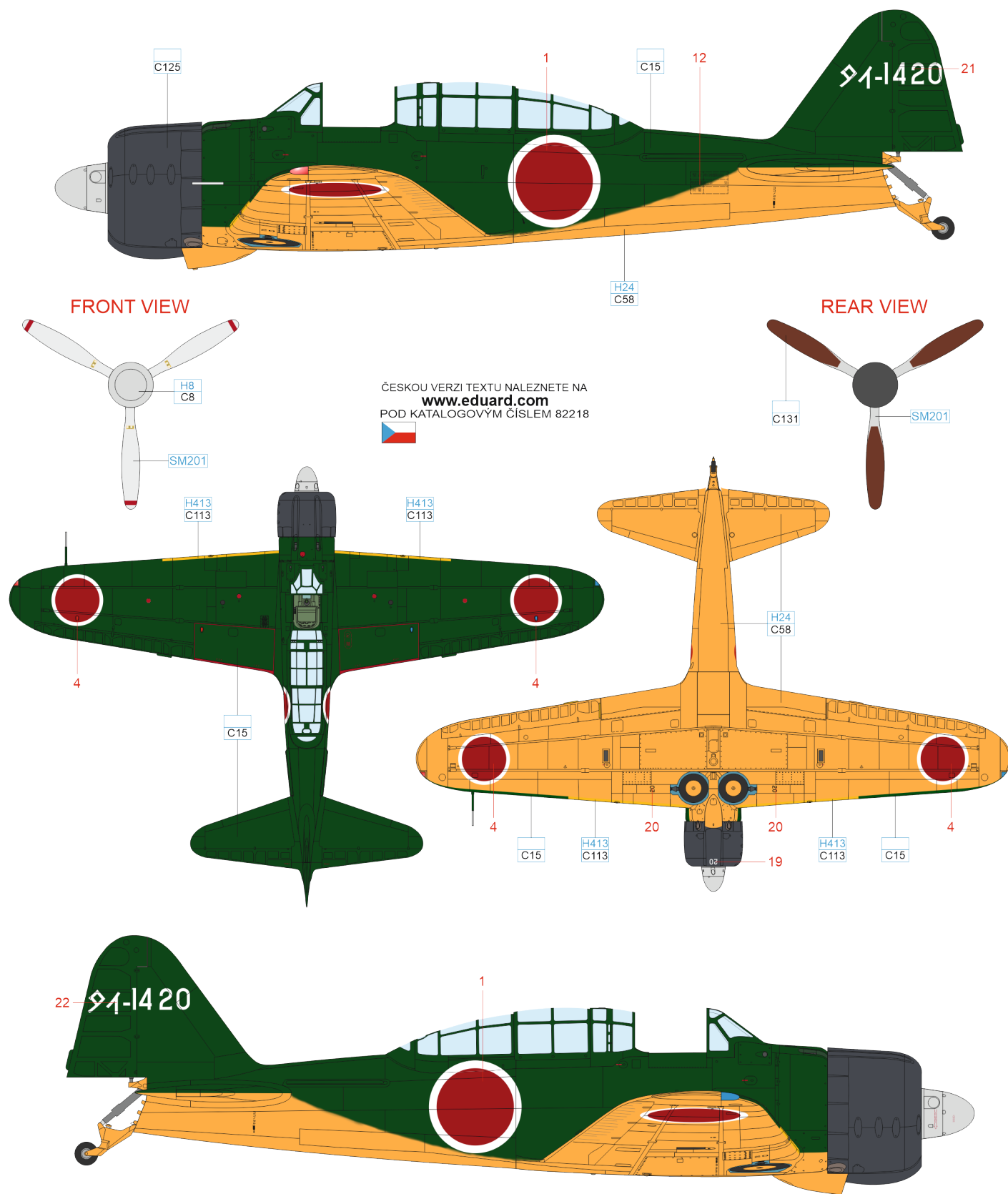

SILVER	H8 C8	RED BROWN	C131	SUPER FINE SILVER	SM201
DARK GREEN	C15	YELLOW	H413 C113	ORANGE YELLOW	H24 C58
				COWLING COLOR	C125

F Kōnoike Kōkūtai, Kōnoike airbase, Japan, 1944

The Kōnoike Air Group was established in mid-February 1944 and conducted training activities until mid-December 1944. Among its instructors were, for example, Warrant Officer Shigeo Sugi-o, who had over 20 victories to his credit, Warrant Officer Momoto Matsumura (13 victories), and Lieutenant Sumio Fukuda (11 victories). The latter two perished in October 1944 during the Battle of Leyte Gulf as members of carrier-based fighter units. Already during the fighting in the Philippines, Kōnoike Kōkūtai selected a number of volunteers from its ranks for special attack (Kamikaze) missions. The final phase of training for these Kamikaze pilots was completed in Taiwan. The Kōnoike base had two main runways measuring 1,800 and 1,400 meters in length and also had a number of smaller runways. During the autumn of 1944, the Kōnoike airfield became the first of several bases for the 721st Air Group, which was preparing for the deployment of MXY-7 Ōka rocket aircraft. In mid-February 1945, the airfield was the target of a devastating air raid by U.S. Navy aircraft. Some concrete shelters still survive in the area around the base to this day.

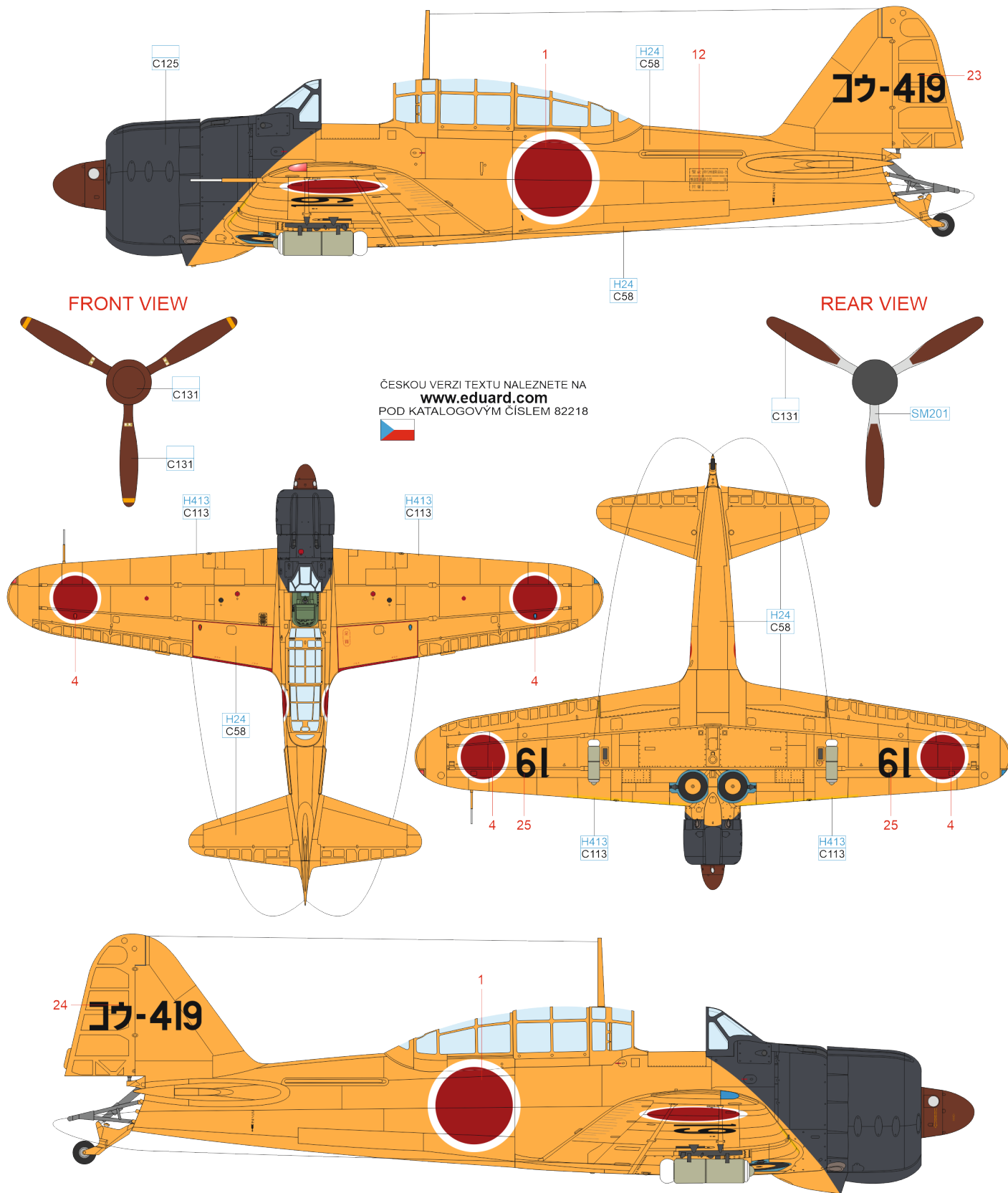

RED BROWN	C131	SUPER FINE SILVER	SM201
YELLOW	H413 C113	ORANGE YELLOW	H24 C58
		COWLING COLOR	C125

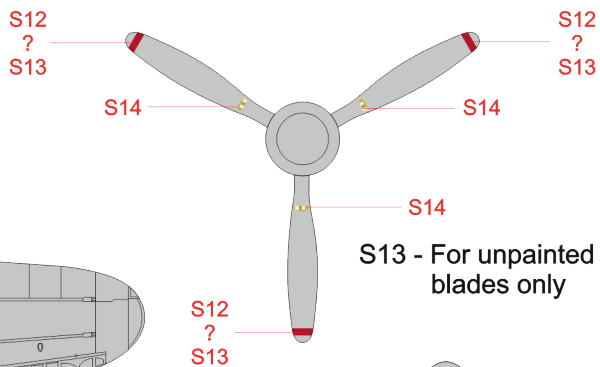
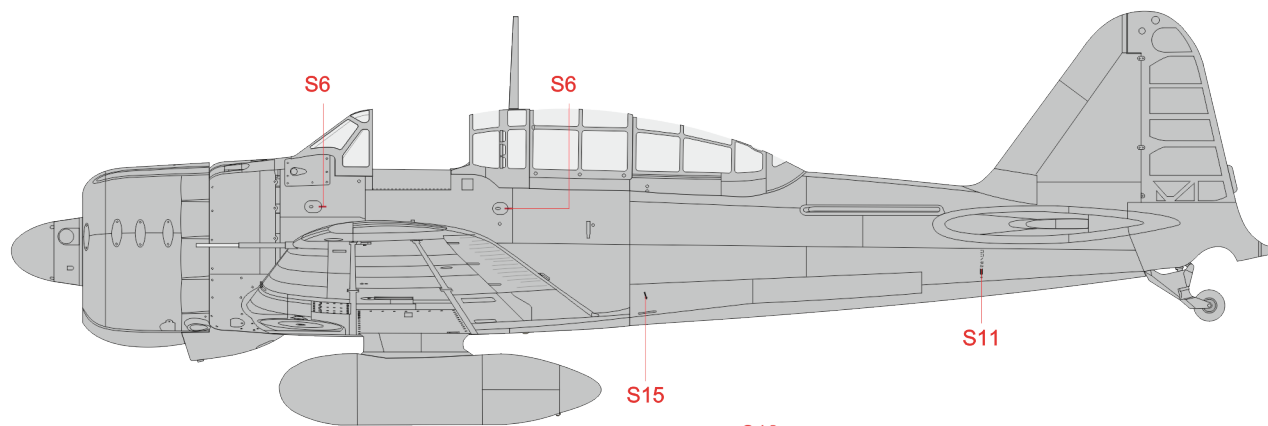

S13 - For unpainted blades only

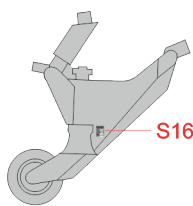
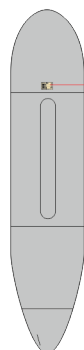
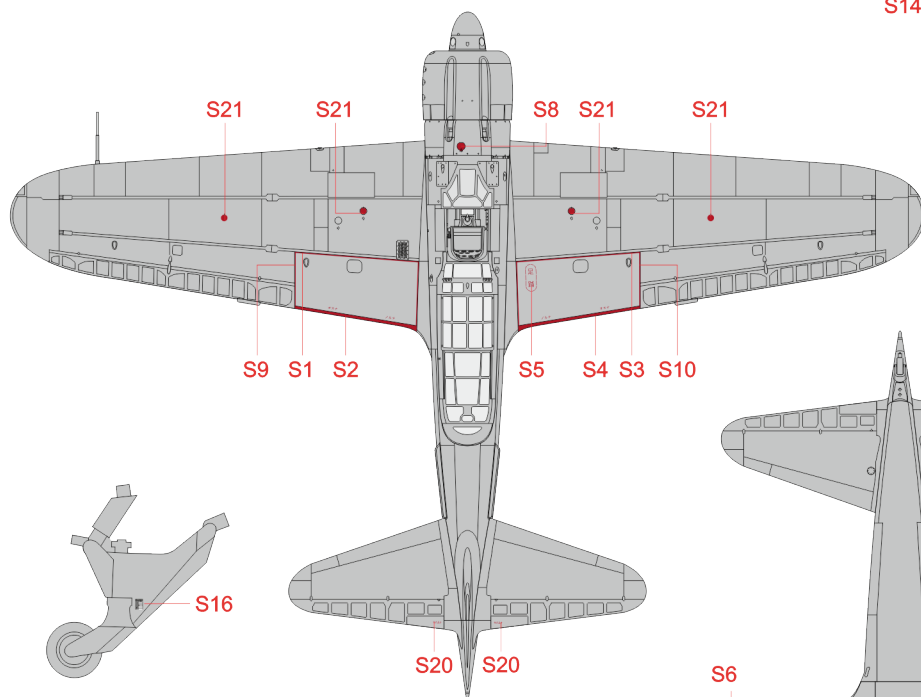

PORT SIDE STARBOARD

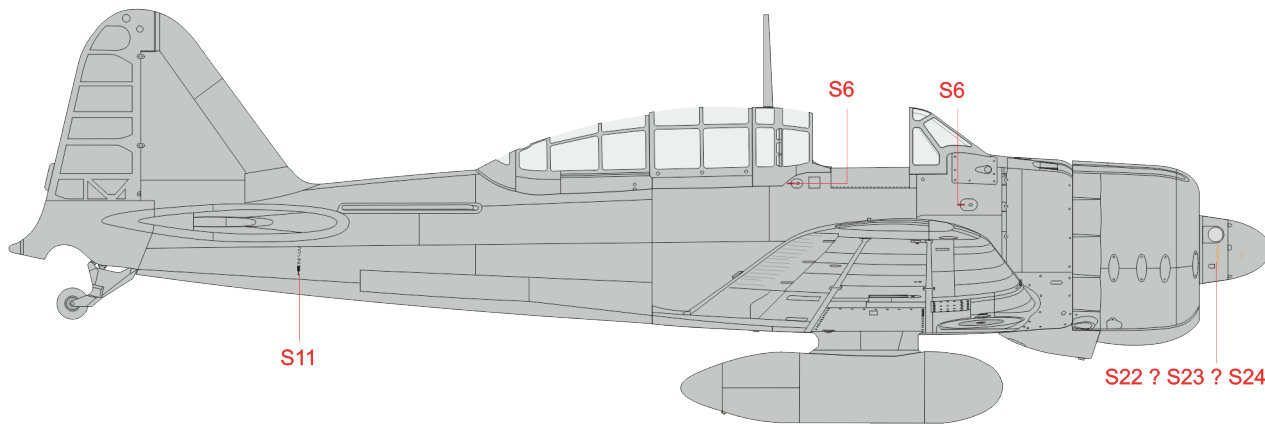
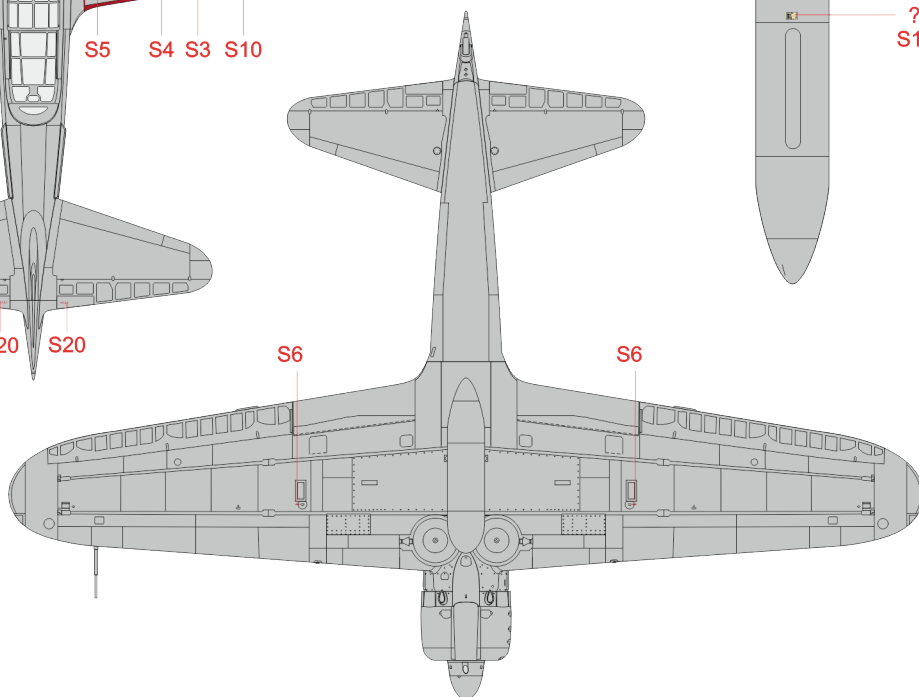
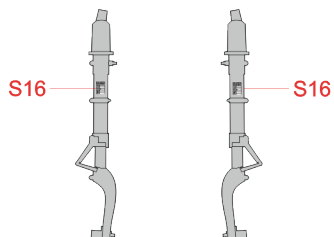

Eduard goodies for

A6M2-K 1/48

- 481162 A6M2-K landing flaps (PE-Set)
- 491522 A6M2-K upgrade set (PE-Set)
- FE1526 A6M2-K seatbelts STEEL (PE-Set)
- 648694 A6M2 engine PRINT (Brassin)
- 648722 A6M2 exhausts PRINT (Brassin)
- 648763 A6M2 engine complete PRINT (Brassin)
- 3DL48219 A6M2-K SPACE (3D Decal Set)
- 3DL48231 A6M-2K seatbelts SPACE (3D Decal Set)
- EX1112 A6M2-K TFace (Mask)

