

PLASTIC PARTS

A >

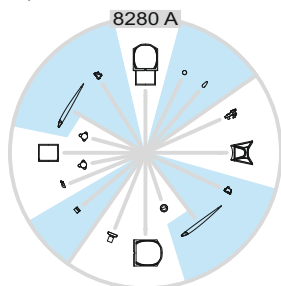

H >

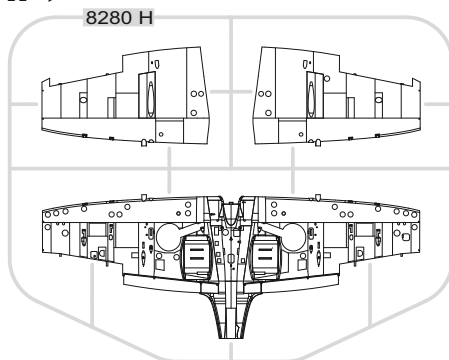

I >

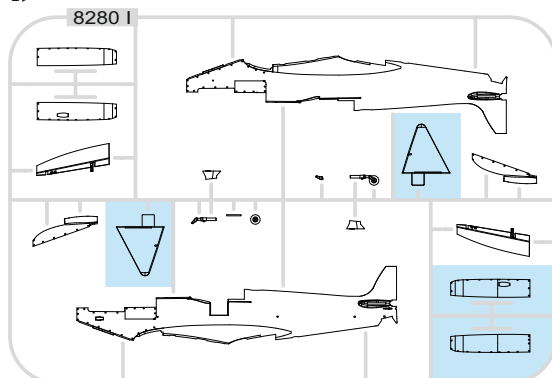

F >

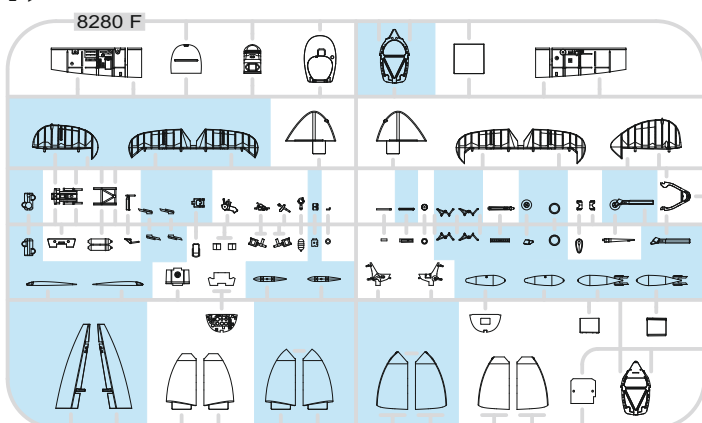

G >

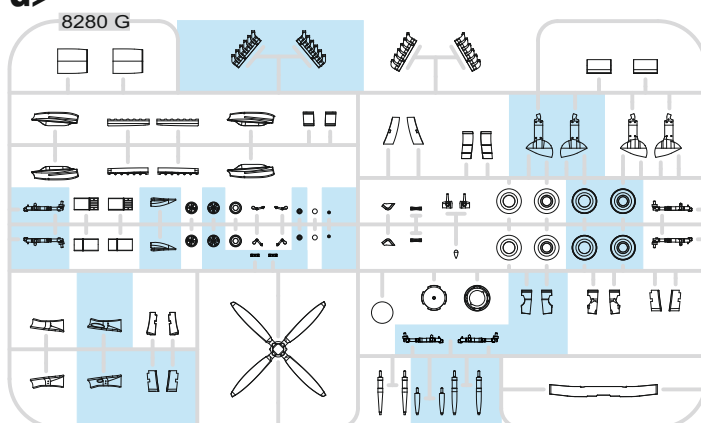

GUNZE	MISSION MODELS	
H4	C4	MMP-007 YELLOW
H11	C62	MMP-001 FLAT WHITE
H12	C33	MMP-047 FLAT BLACK
H13	C3	MMP-003 FLAT RED
H33	C81	RUSSET
H51	C11	MMP-063 LIGHT GULL GRAY
H72	C369	MMP-078 DARK EARTH
H77	C137	MMP-047 TIRE BLACK

GUNZE	MISSION MODELS	
H90	C47	CLEAR RED
H92	C49	CLEAR ORANGE
H94	C138	CLEAR GREEN
H302	C302	GREEN
H323	C323	MMP-092 LIGHT BLUE
H330	C361	MMP-077 DARK GREEN
H335	C363	MMP-094 MEDIUM SEAGRAY
C362	MMP-093	OCEAN GRAY

GUNZE	MISSION MODELS	
	C364	MMP-079 AIRCRAFT GRAY-GREEN
	C370	MMP-092 AZURE BLUE
METAL COLOR	METALLICS	
MC214	MMM-001	DARK IRON
MC218	MMM-003	ALUMINIUM
METAL COLOR	METALLICS	
SM2011	MMC-001	SUPER FINE SILVER

ATTENTION * UPOZORNĚNÍ * ACHTUNG * ATTENTION

GB

Carefully read instruction sheet before assembling. When you use glue or paint, do not use near open flame and use in well ventilated room. Keep out of reach of small children. Children must not be allowed to suck any part, or pull vinyl bag over the head.

CZ

Před započatím stavby si pečlivě prostudujte stavební návod. Při používání barev a lepidla pracujte v dobře větrané místnosti. Lepidla ani barvy nepoužívejte v blízkosti otevřeného ohně. Model není určen malým dětem, mohlo by dojít k požití drobných dílů.

D

Vor dem Zusammenbau die Bauanleitung gut durchlesen. Kleber und Farben nicht in der Nähe von offenem Feuer verwenden und für eine ausreichende Belüftung sorgen. Den Bausatz von kleinen Kindern fernhalten. Vermeiden Sie, dass Kinder Bauteile in den Mund nehmen oder sich Plastiktüten über den Kopf ziehen.

F

Lire soigneusement la fiche d'instructions avant d'assembler. Ne pas utiliser de colle ou de peinture à proximité d'une flamme nue, et aérer la pièce de temps en temps. Garder hors de portée des enfants en bas âge. Ne pas laisser les enfants mettre en bouche ou sucer les pièces, ou passer un sachet vinyl sur la tête.

INSTRUCTION SIGNS * INSTR. SYMBOLY * INSTRUKTION SINNBILDEN * SYMBOLES

OPTIONAL
VOLBABEND
OHNOUTSAND
BROUSITOPEN HOLE
VYVRTAT OTVORSYMETRICAL ASSEMBLY
SYMETRICKÁ MONTÁŽREMOVE
ODŘÍZNOUTREVERSE SIDE
OTOČITAPPLY EDUARD MASK
AND PAINT
POUŽIT EDUARD MASK
NABARVIT

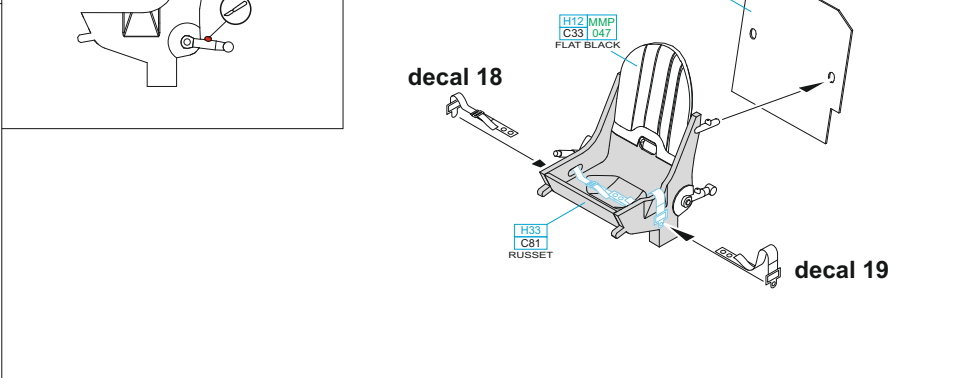
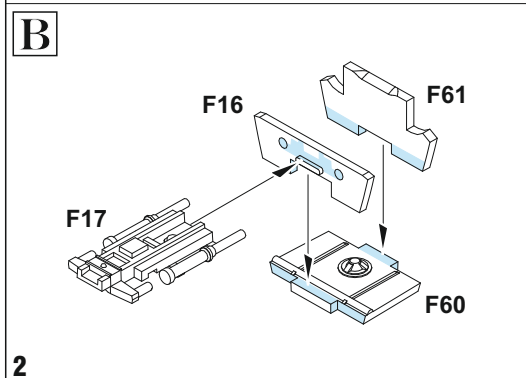
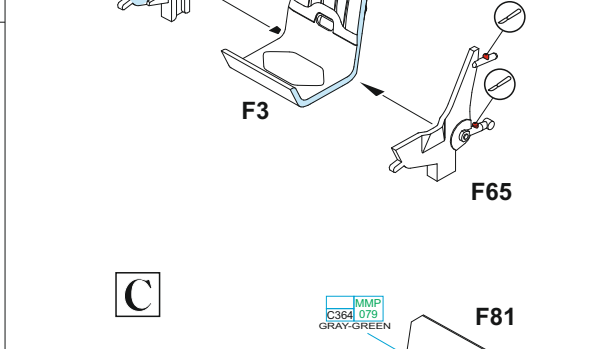
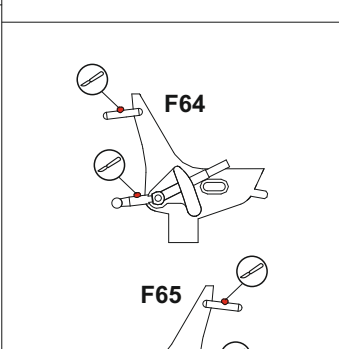
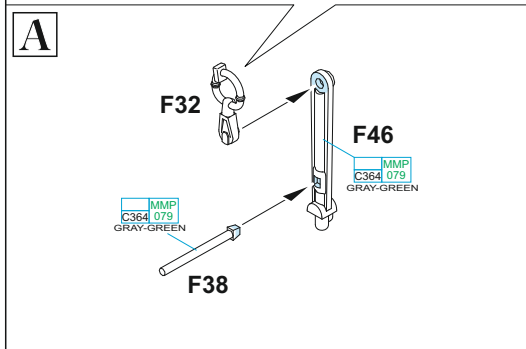
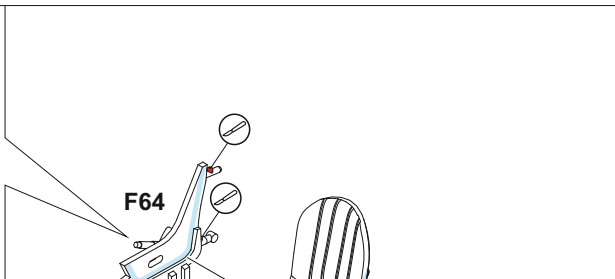
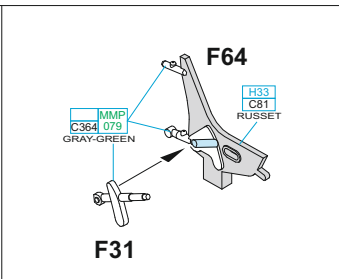
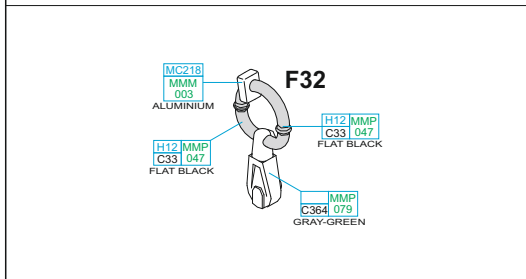
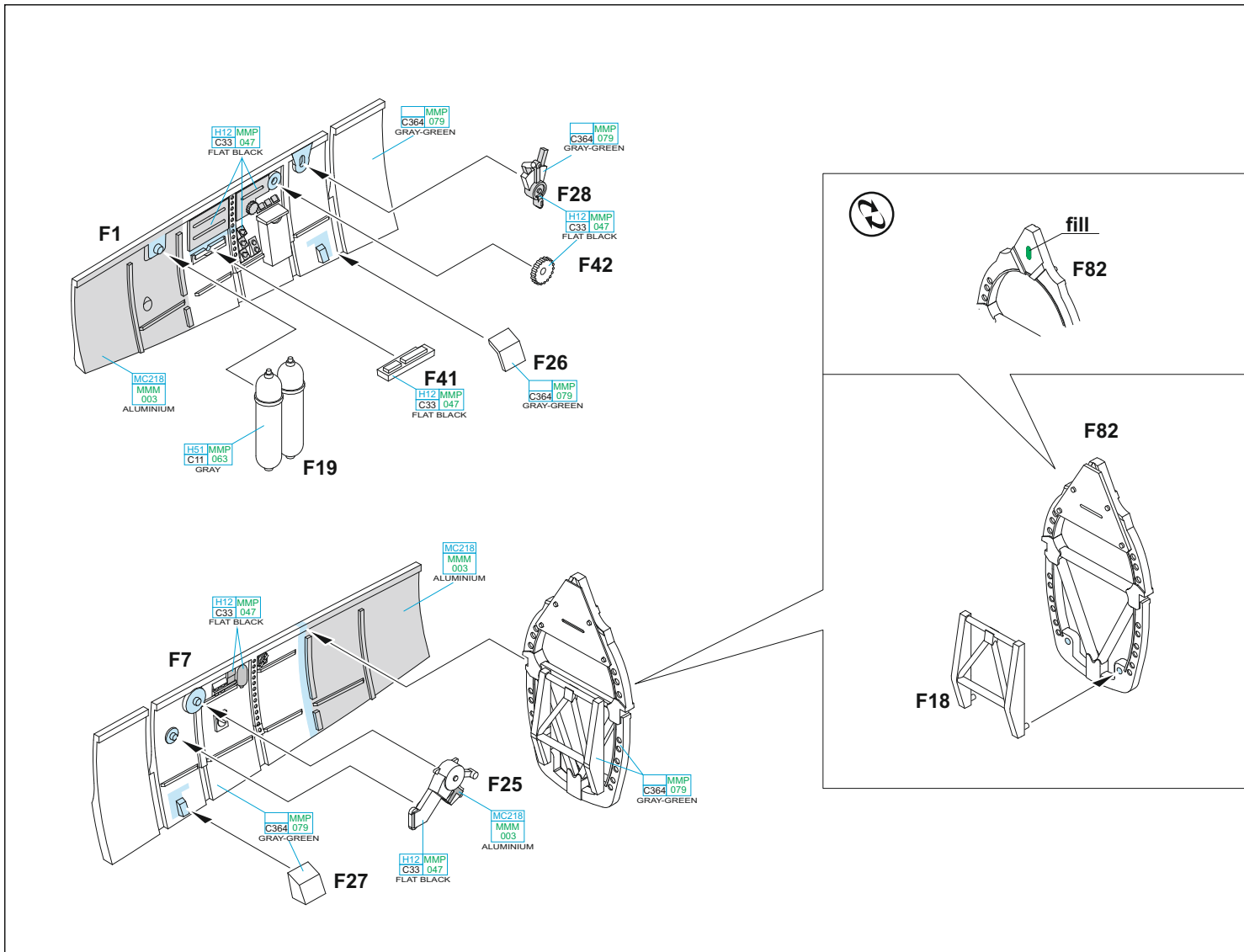

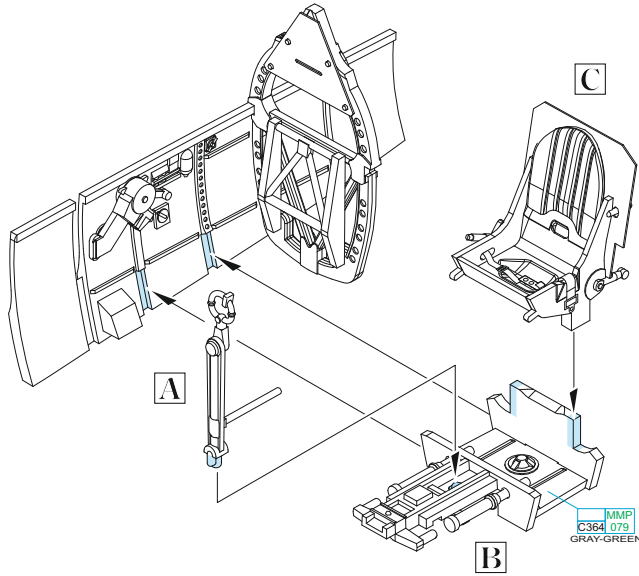

decal 20

MMP
C364 079
GRAY-GREEN

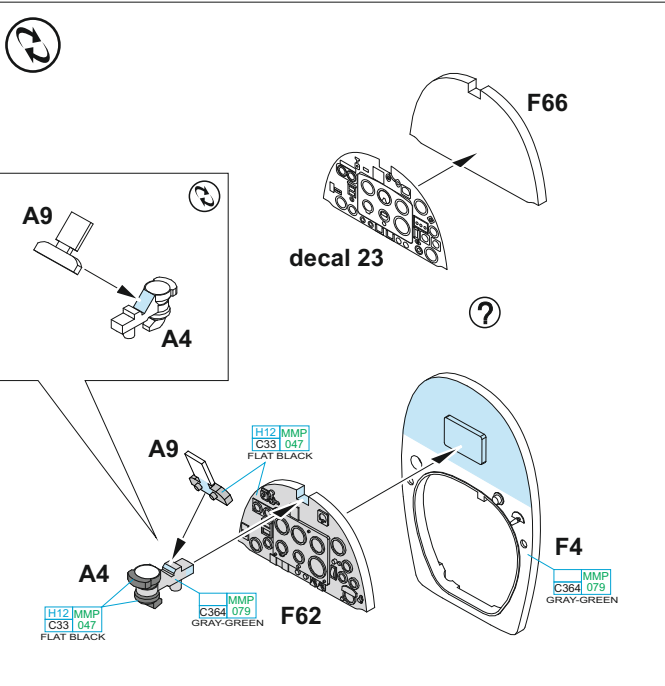

decal 23

F66

A9

A4

?

A9

H12 MMP
C33 047
FLAT BLACK

A4

MMP
C364 079
GRAY-GREEN

F62

F4

MMP
C364 079
GRAY-GREEN

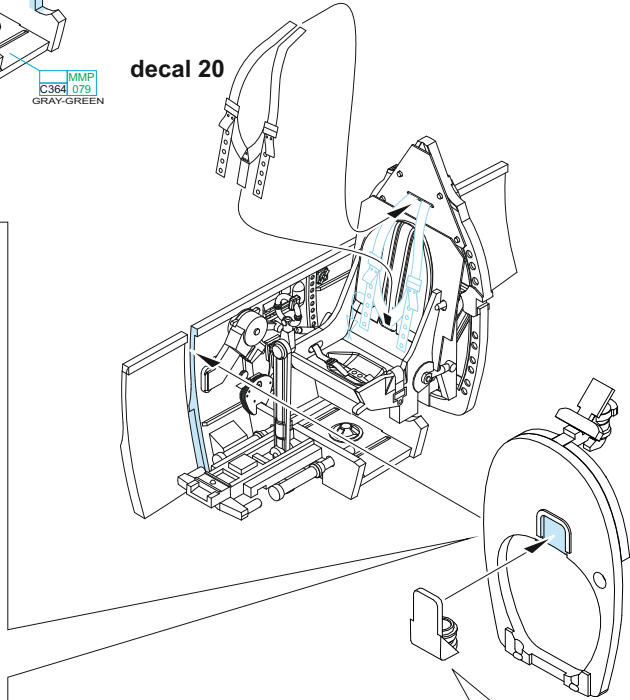

OPTIONAL:
decal 21



F43

H12 MMP
C33 047
FLAT BLACK

F23

MMP
C364 079
GRAY-GREEN

D

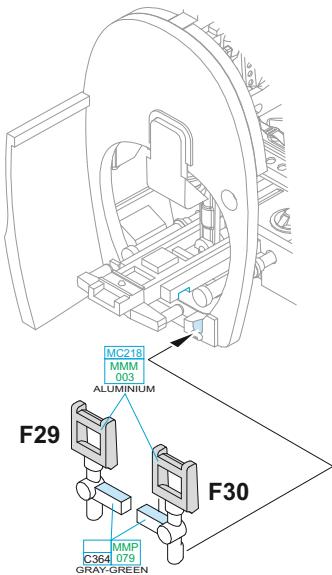

F29

F30

MC218
MMM
033
ALUMINIUM

MMP
C364 079
GRAY-GREEN

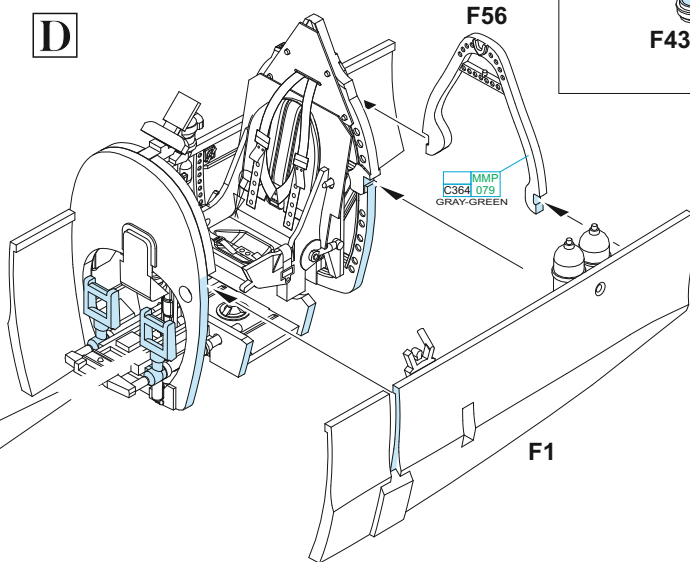

F56

MMP
C364 079
GRAY-GREEN

F1

⑦ FOR CLOSED CANOPY ONLY

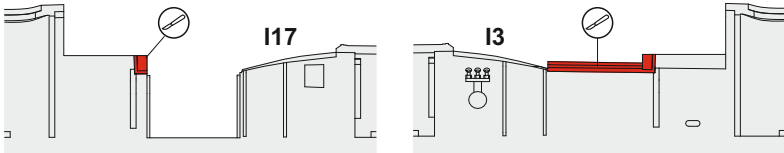

MMP
C364 079
GRAY-GREEN

I13

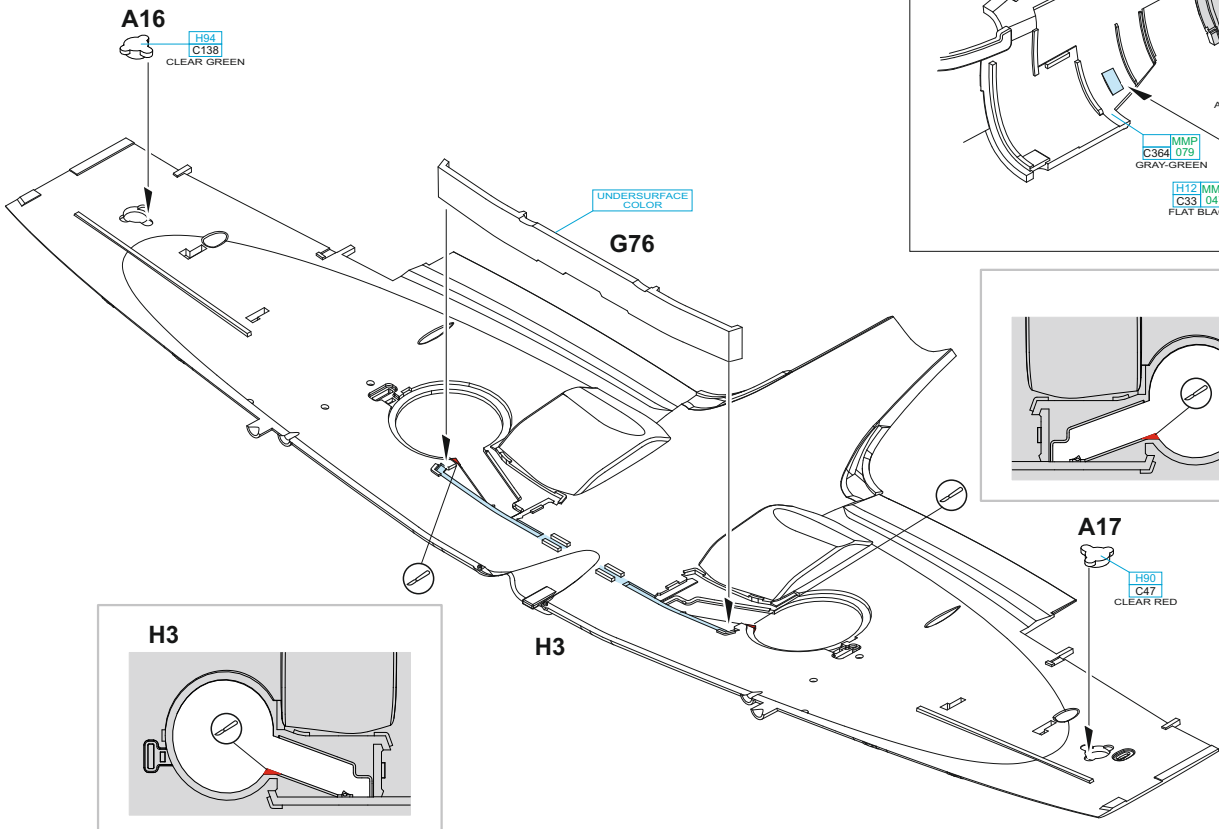
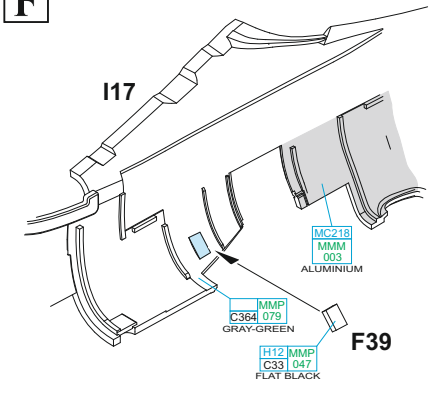
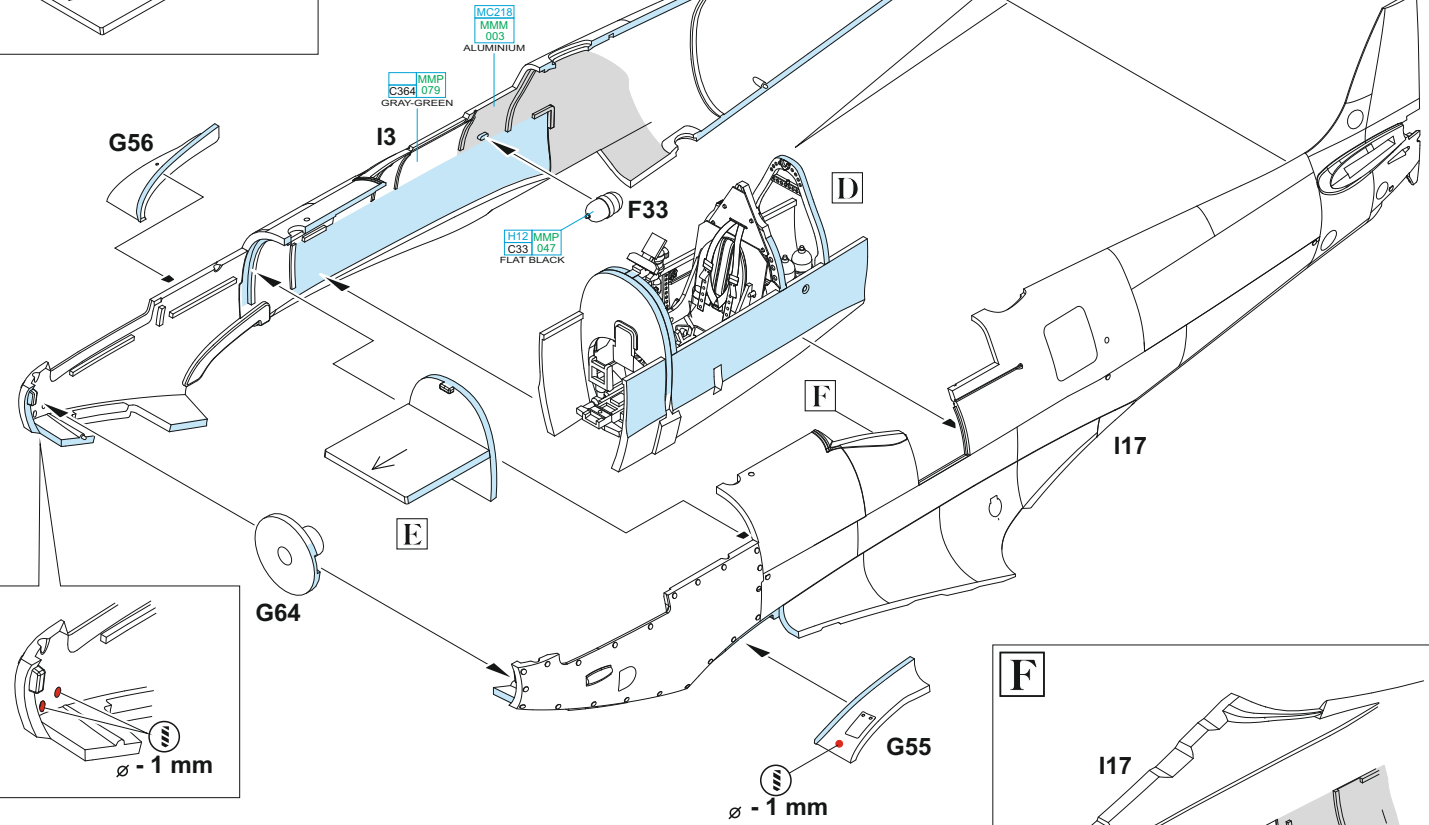
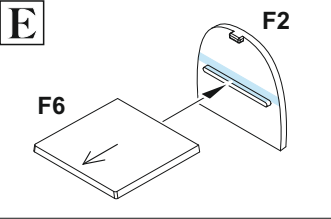
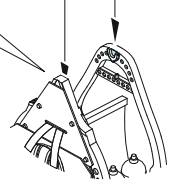
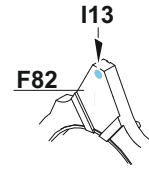

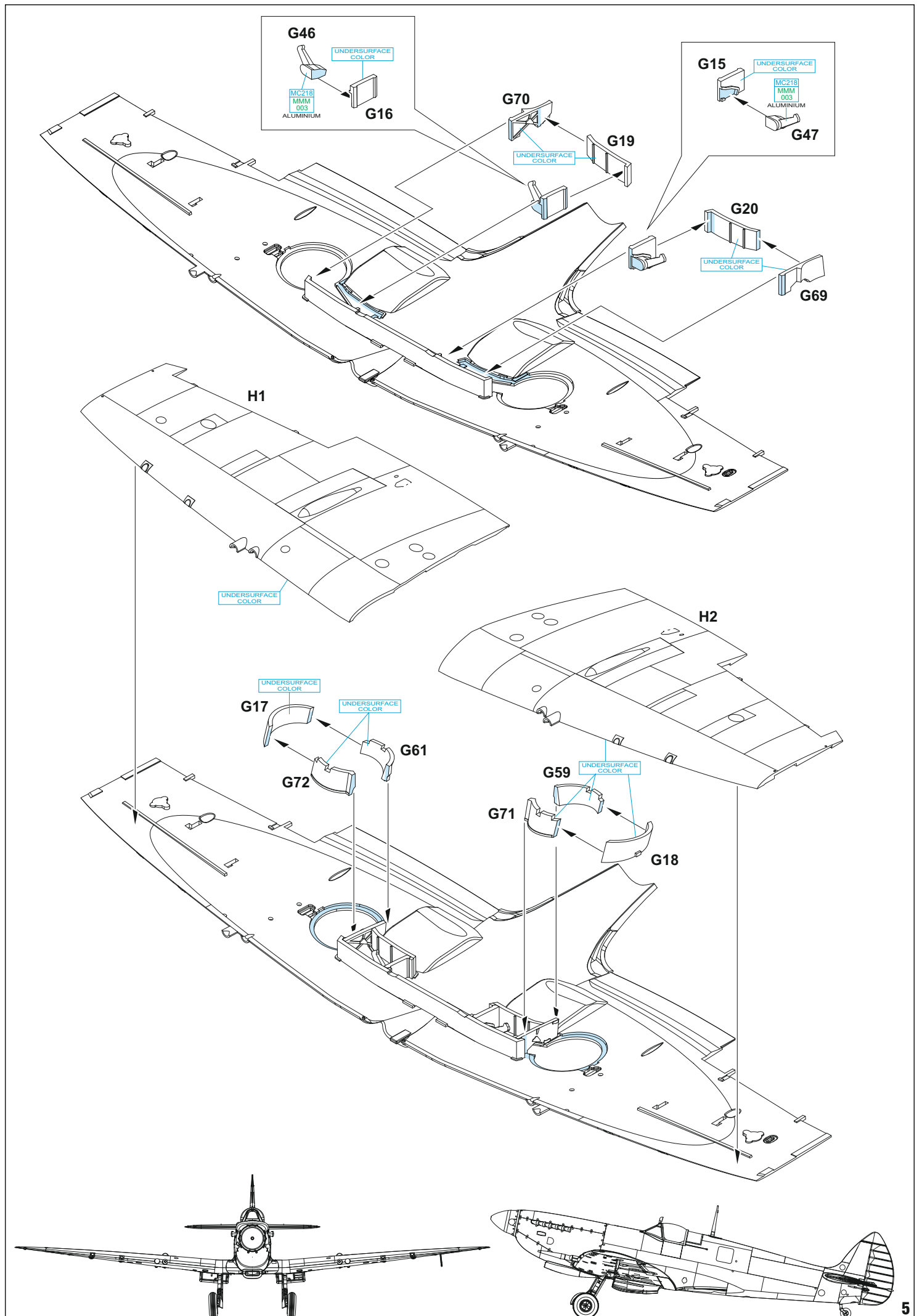

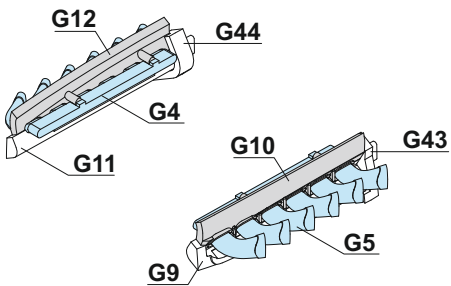
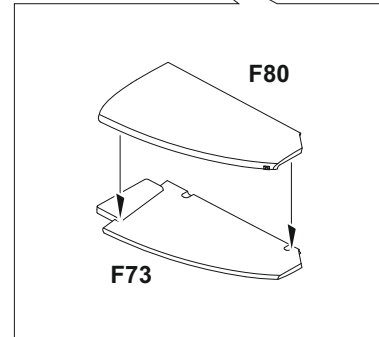
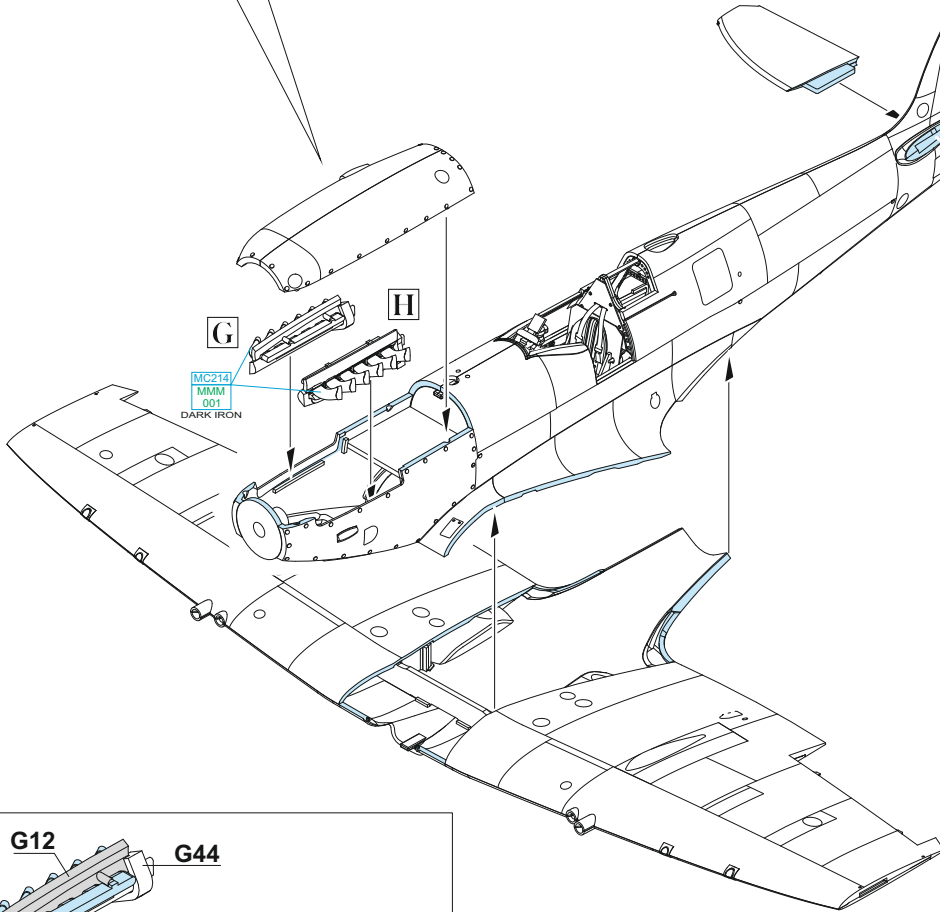
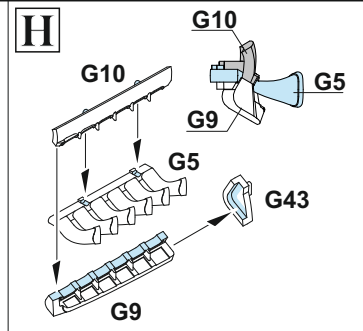
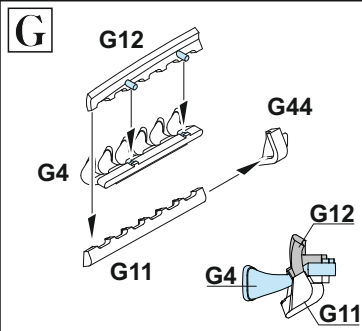
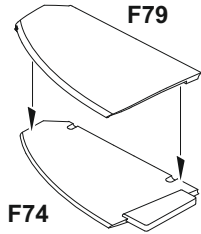
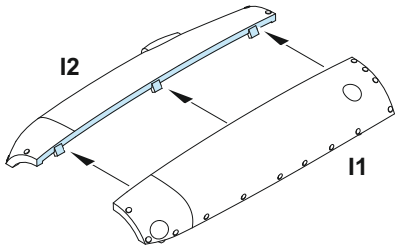

GLUE PARTS F52 & F53 ONE BY ONE

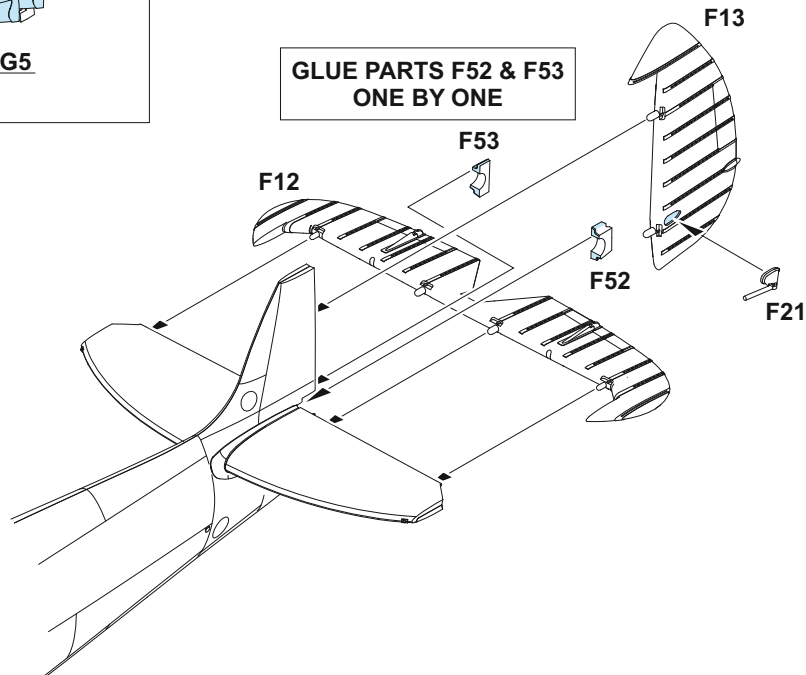

F11
H94
C138
CLEAR GREEN

I4

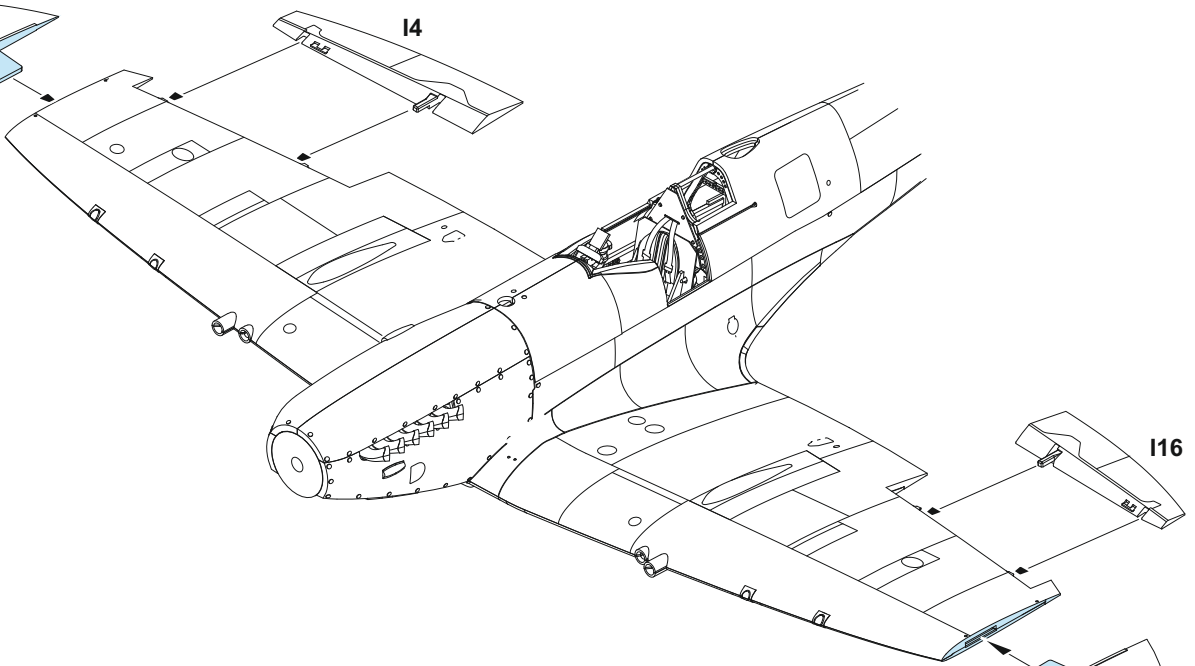

F10

H90
C47
CLEAR RED

I9

UNDERSURFACE
COLOR

I10

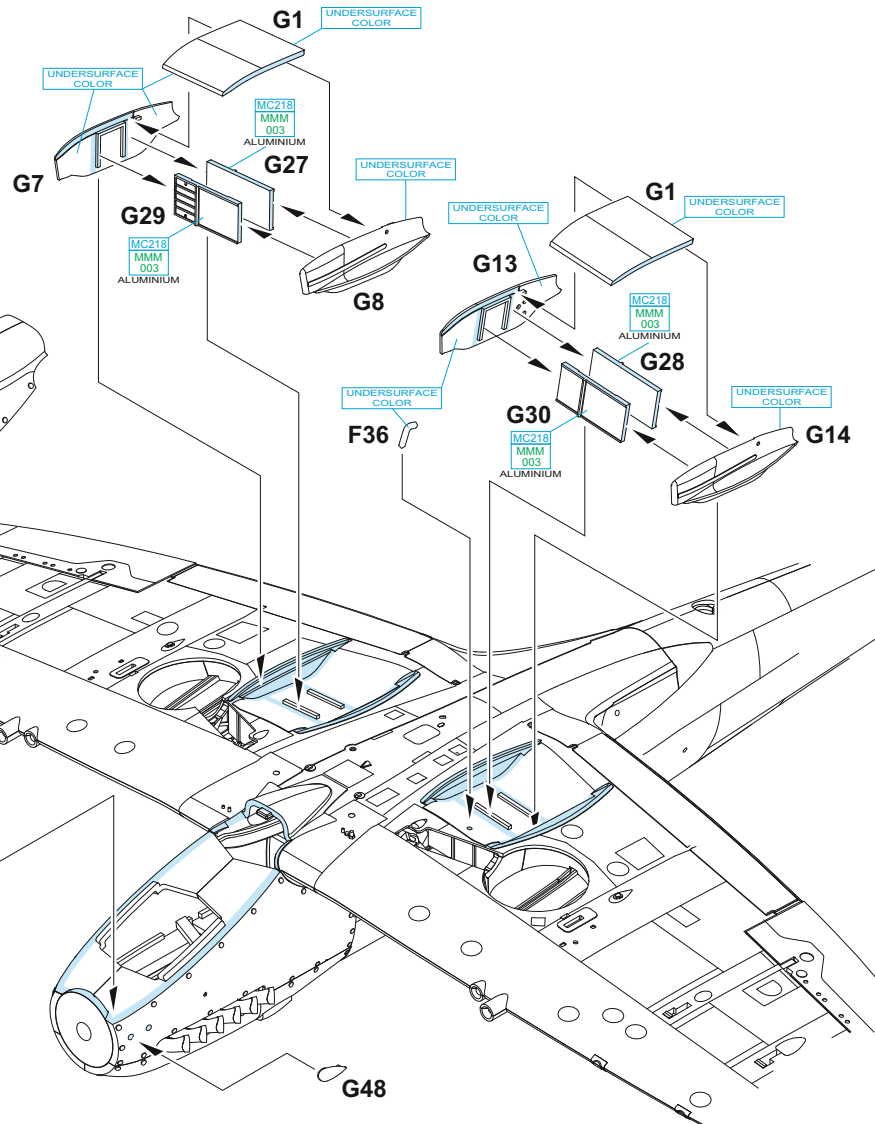
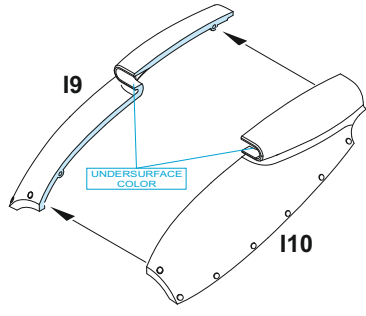

G48

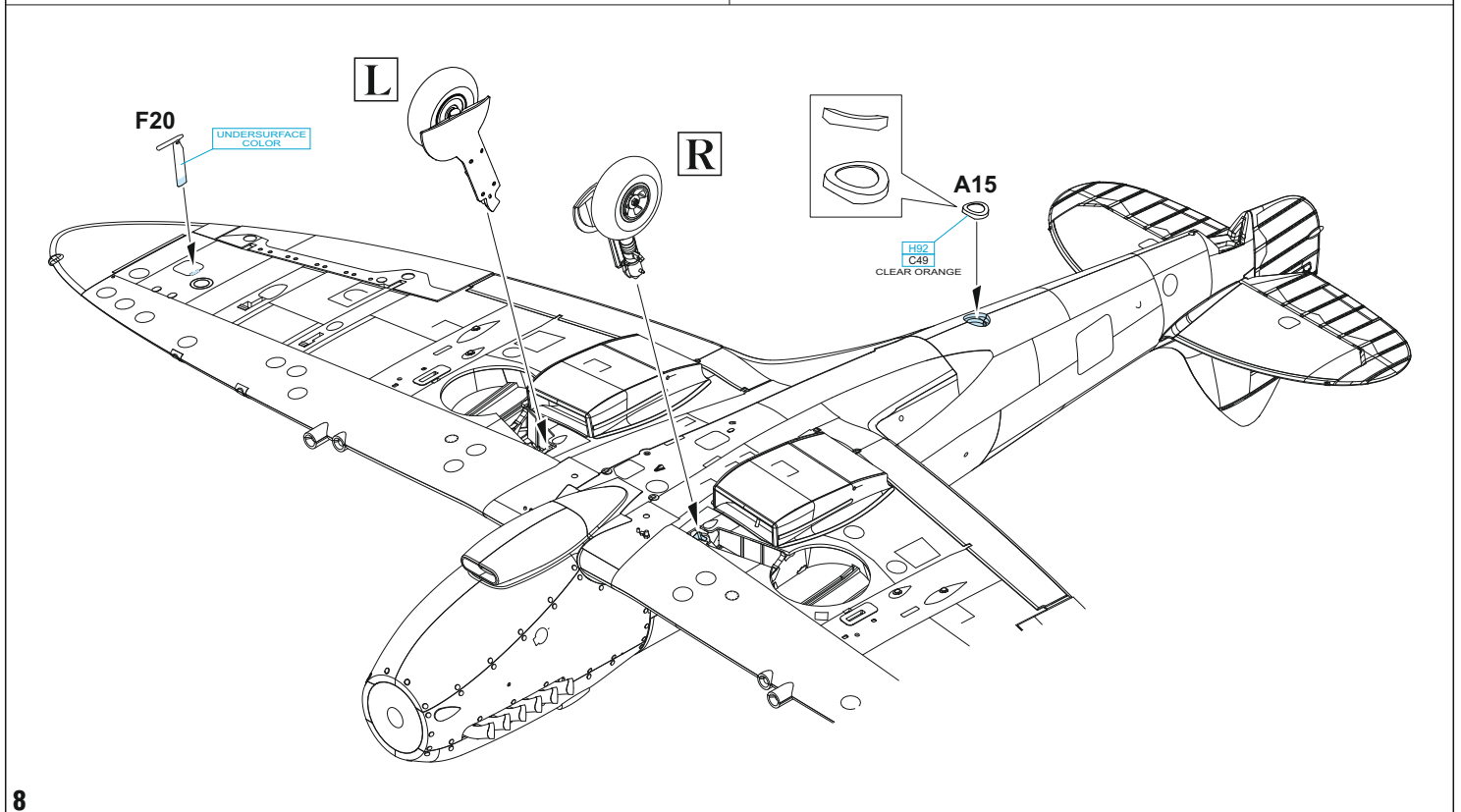
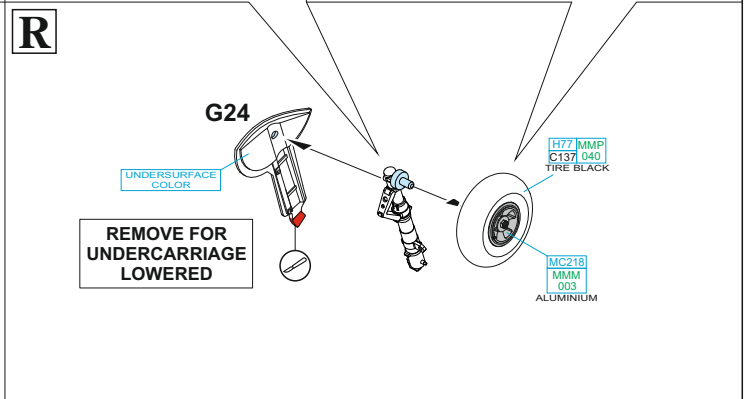
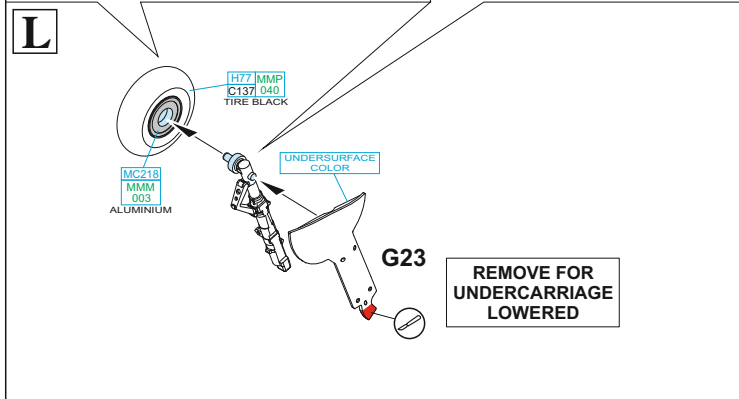
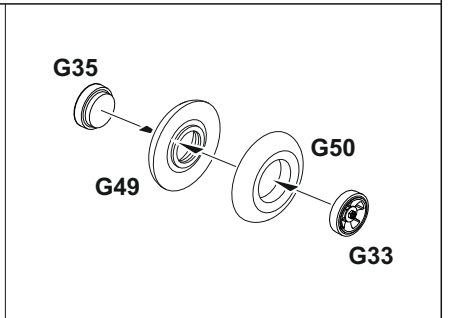
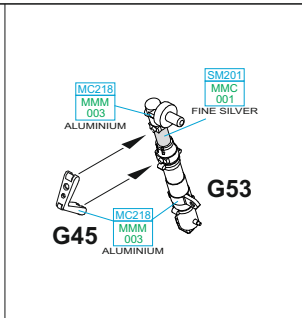
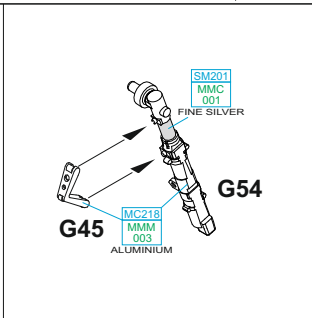
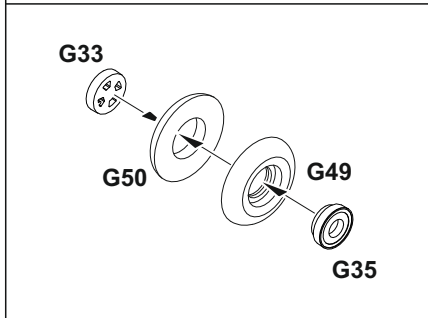
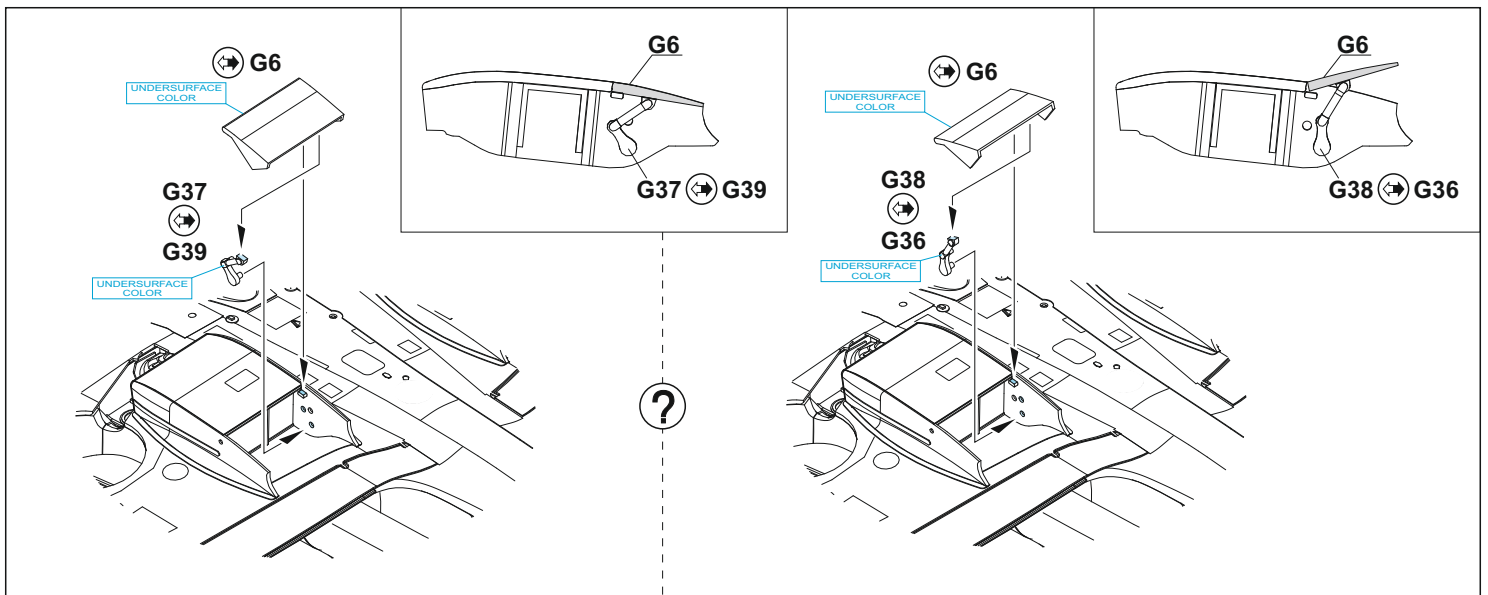

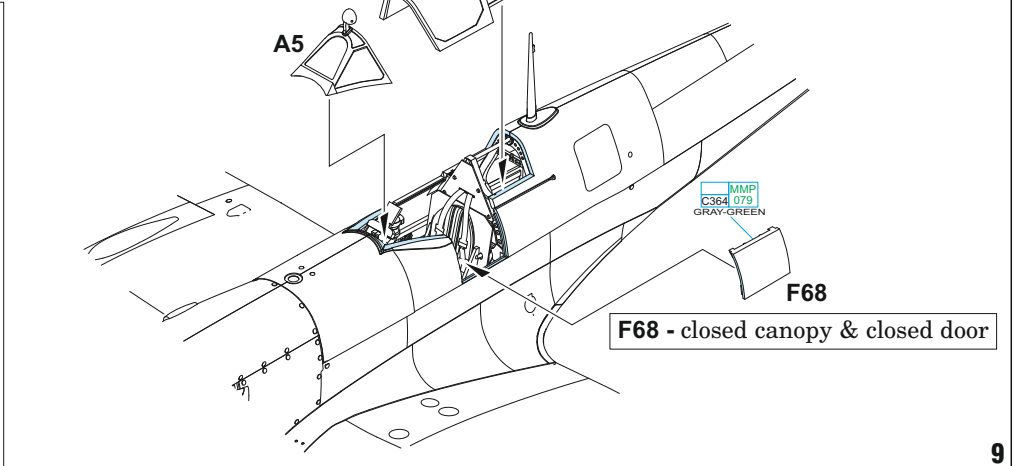
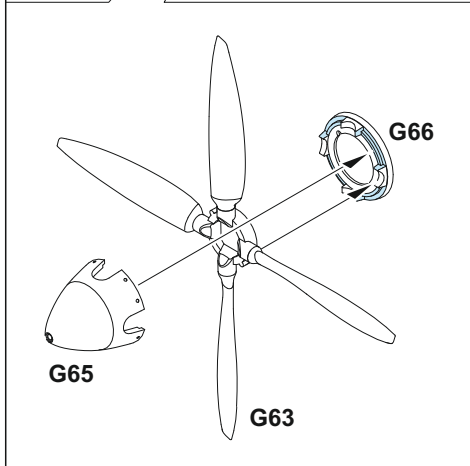
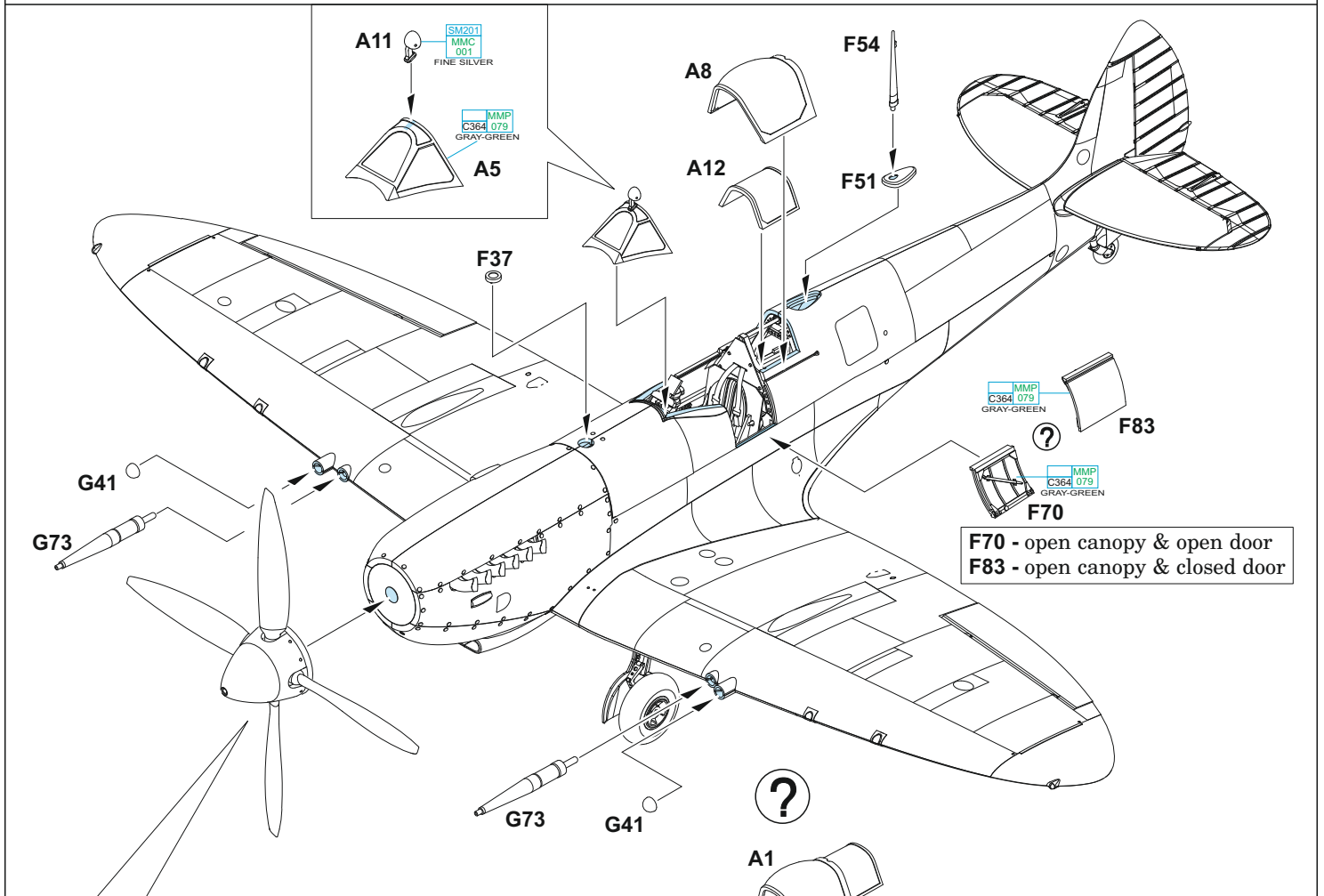
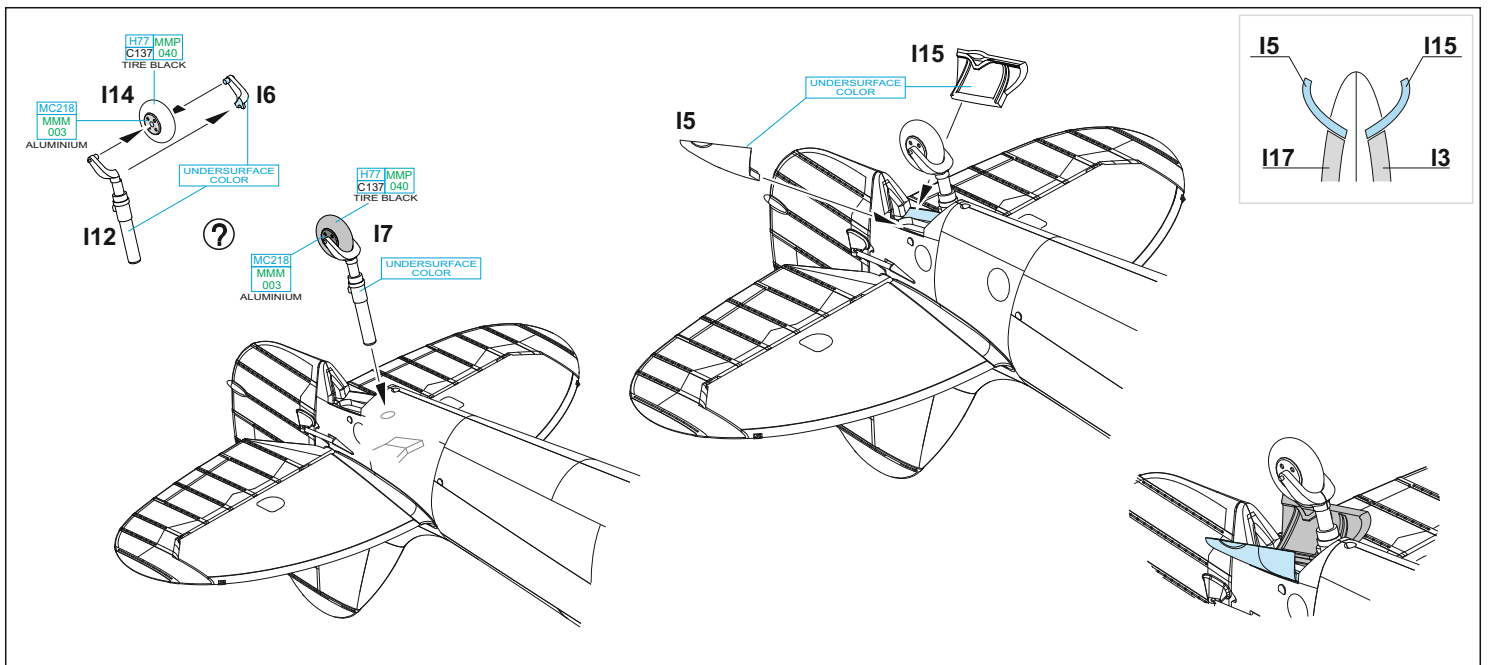

A A58-484, flown by G/Cpt Clive R. Caldwell, CO of No. 80 Wing, Morotai Island, Dutch East Indies, March 1945

With 27.5 confirmed aerial victories, Clive Caldwell is Australia's top scoring fighter ace of World War II. He was the top scoring allied ace in North Africa and the world's leading P-40 ace. He was also the only Australian fighter pilot to become a two-theatre ace, becoming an ace in both the Middle East and Pacific theatres. He scored his victories over the pilots of three countries, Germany, Italy and Japan. This Spitfire Mk.VIII A58-484 was flown by C. R. Caldwell in the winter of 1944 and spring 1945 while No. 80 Wing based on Morotai Island in North Moluku Islands. The aircraft seems to have some damage to the fin and rudder. There are signs of repair work on the top of the fin, which has probably been painted in a grey undercoat. A replacement rudder, apparently finished in Ocean Grey and Dark Green, has been fitted. Note the small wing national insignia roundels, applied over the overpainted larger original items. You can find more details about C. R. Caldwell and his aircraft in Eduard's publication 'Aussie Eight', written by Peter Malone, released by Eduard.

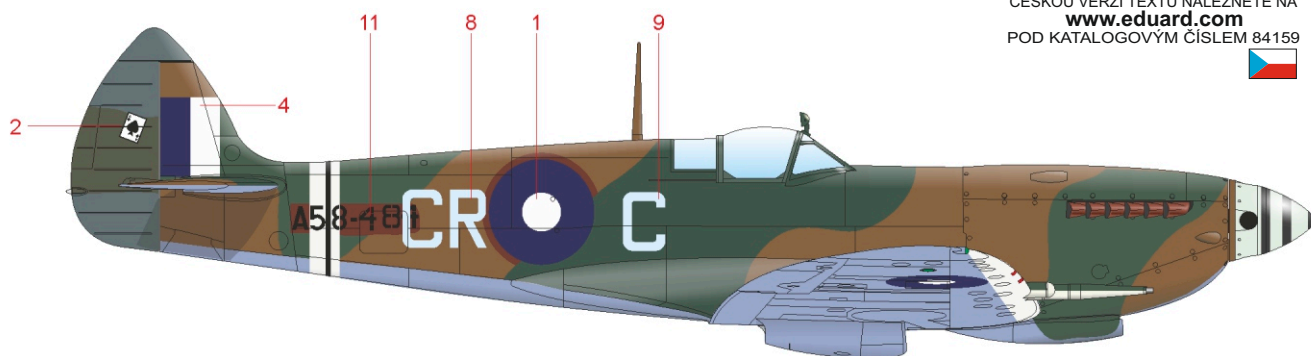
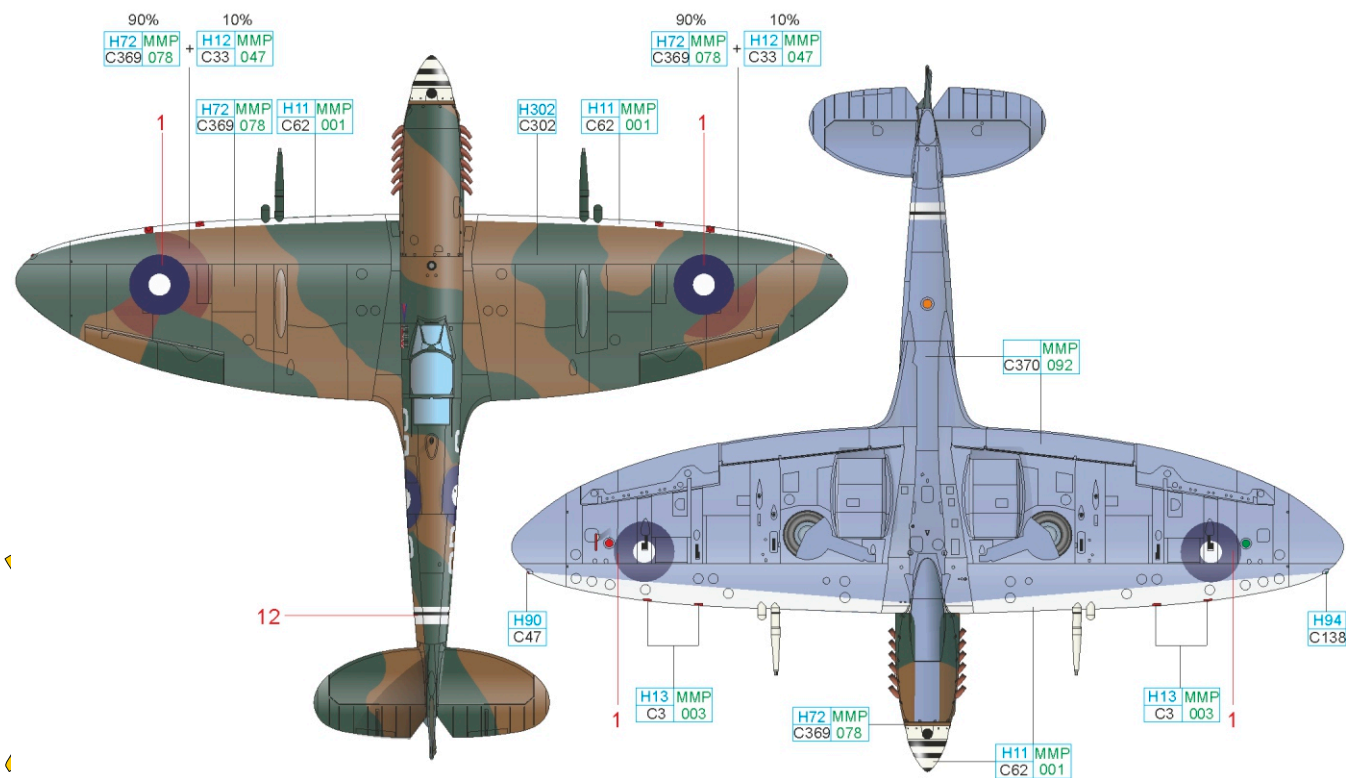
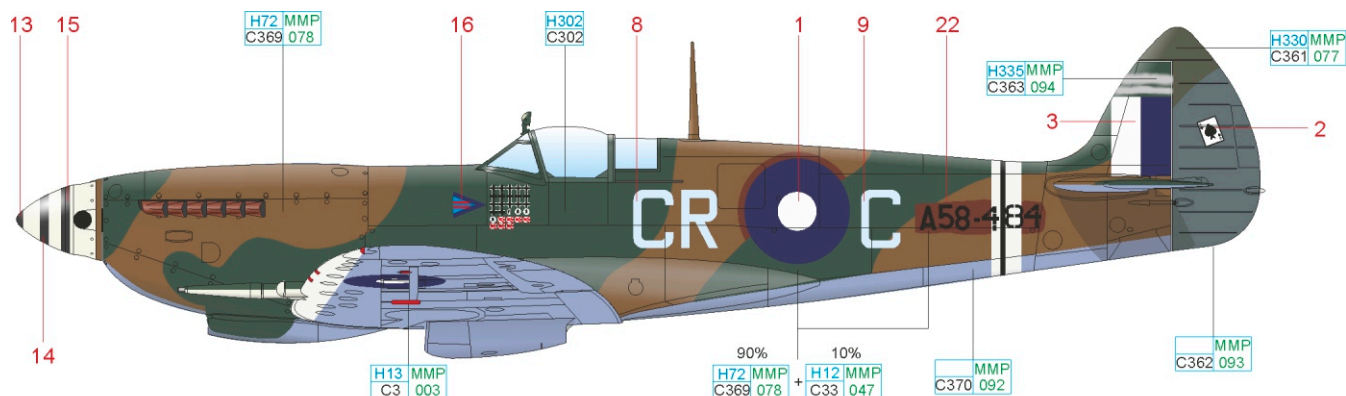

ČESKOU VERZI TEXTU NALEZNETE NA www.eduard.com
POD KATALOGOVÝM ČÍSLEM 84159



RED	H13 MMP C3 003	YELLOW	H4 MMP C4 007	WHITE	H11 MMP C62 001	MEDIUM SEA GRAY	H335 MMP C363 094
OCEAN GRAY	MMP C362 093	DARK GREEN	H330 MMP C361 077	GREEN	H302 C302	CLEAR RED	H90 C47
DARK EARTH	H72 MMP C369 078	AZURE BLUE	MMP C370 092	CLEAR GREEN	H94 C138	BLACK	H12 MMP C33 047

eduard

B A58-517, flown by F/O Norm Turnbull, No. 79 Squadron, Morotai Island, Dutch East Indies, April 1945

Norm Turnbull was a skilled fighter pilot with much combat experience from the European theatre. He was a sturdy man, which was the reason why ground crew members painted the grey elephant on his personal Spitfire. It is now certain that the elephant was grey, not pink as the emblem is often depicted. This has been personally confirmed by Norm Turnbull himself. Further confusion concerns his name. He legally changed his name to Norm Smithells after his mother remarried. His aircraft appears quite weathered in the photos taken during the spring of 1945, with many signs of repairs, and pain peeling away in many places, notably on the wings, where the original RAF yellow leading edge is visible under the new white RAAF paint. On the rear fuselage, the yellow component of the RAF roundel, the RAF serial and the Sky fuselage band appear to have been overpainted in RAAF Dark Sea Grey. You can find more details about Norm Turnbull and his aircraft in Eduard's publication 'Aussie Eight', written by Peter Malone and released by Eduard.

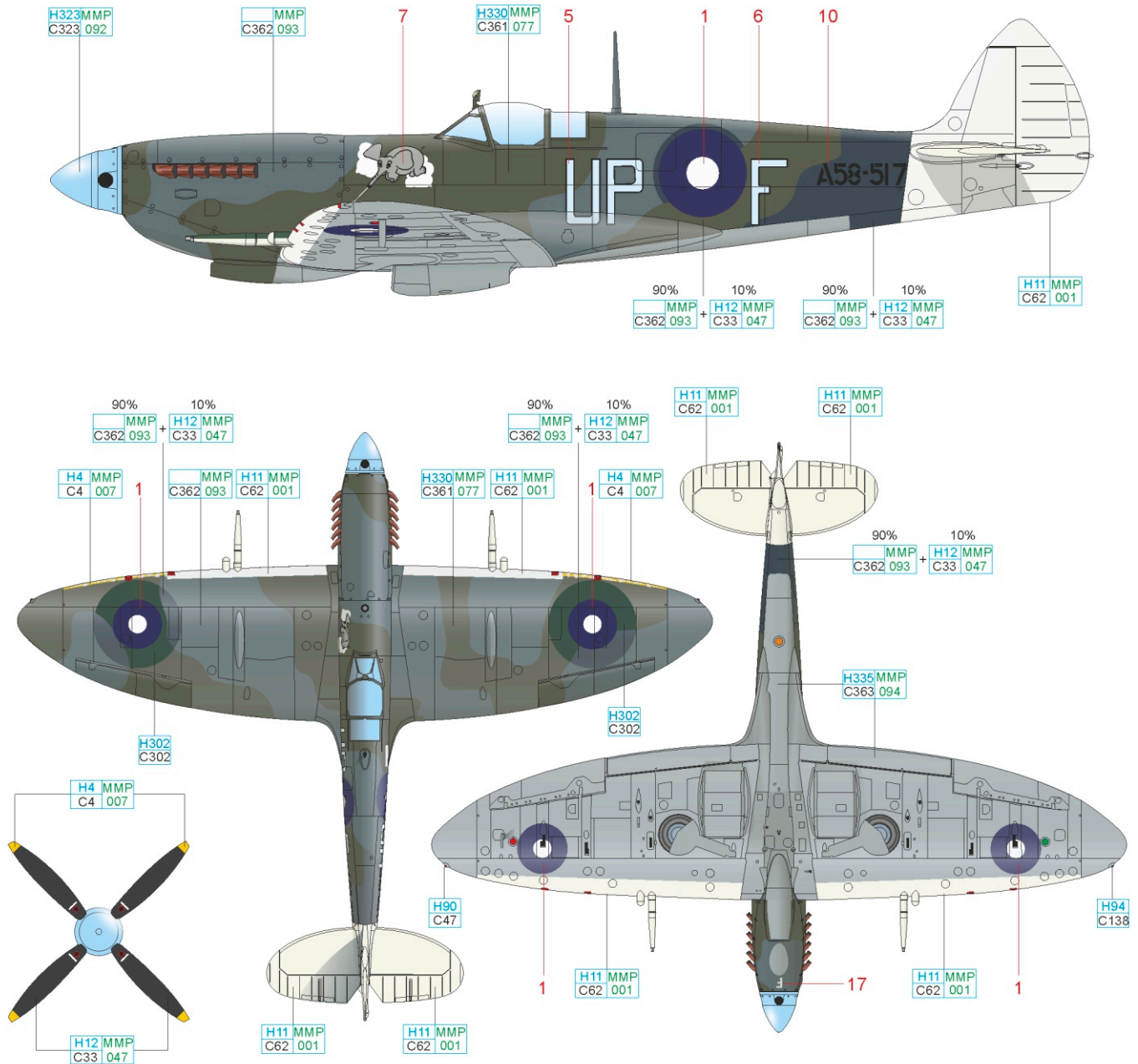

ČESKOU VERZI TEXTU NALEZNETE NA
www.eduard.com
 POD KATALOGOVÝM ČÍSLEM 84159

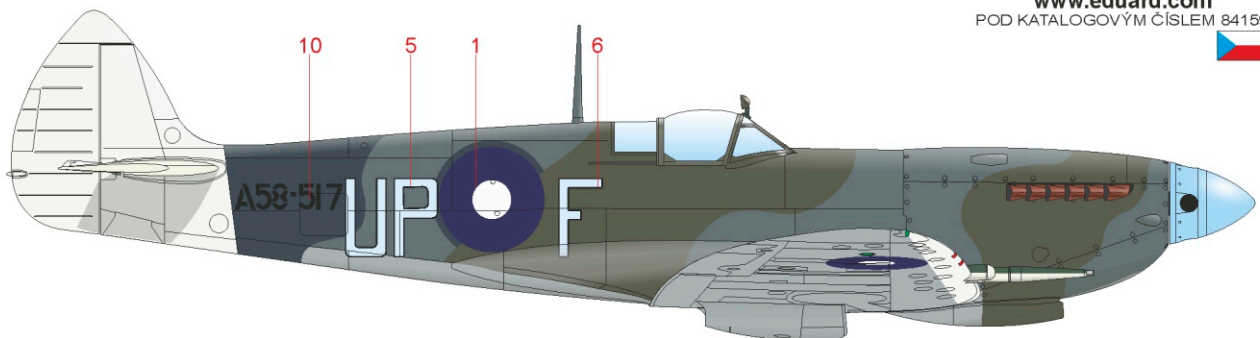

BLACK	H12 MMP C33 047	YELLOW	H4 MMP C4 007	CLEAR RED	H90 C47	CLEAR GREEN	H94 C138	GREEN	H302 C302
DARK GREEN	H330MMP C361 077	OCEAN GRAY	MMP C362 093	MEDIUM SEA GRAY	H335MMP C363 094	LIGHT BLUE	H323MMP C323 092	WHITE	H11 MMP C62 001

eduard

