

1

※ Tight fit

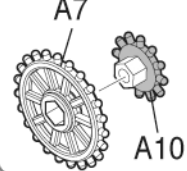

1

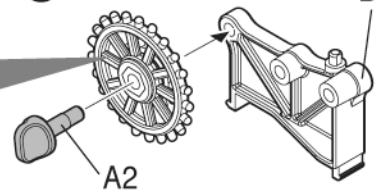

2

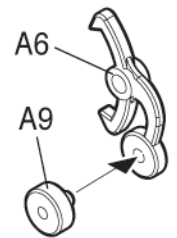
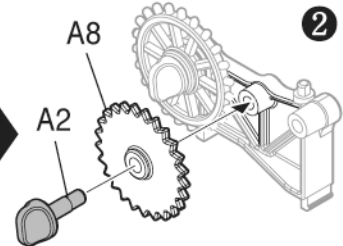

2

1

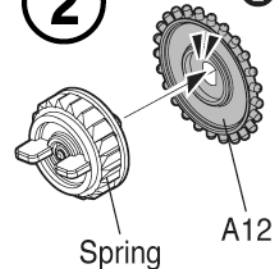

2

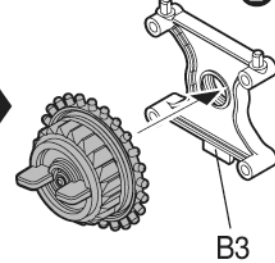

Press until it clicks into place.

B6

※ Note the direction.

A5

Click!

Click!

※ Start assembly with number ①

\*Bottom view

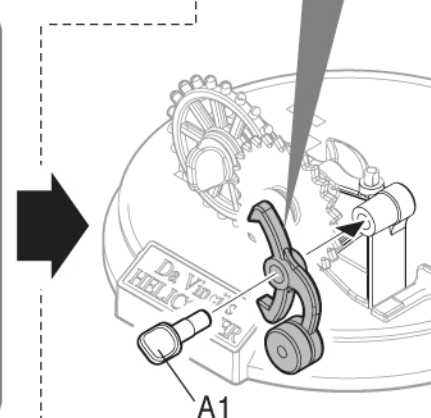
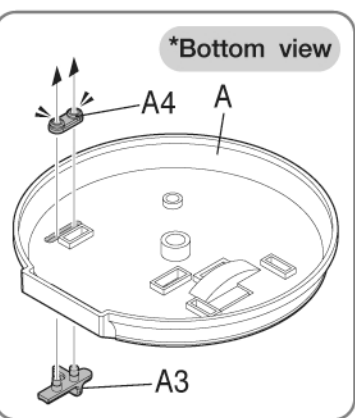
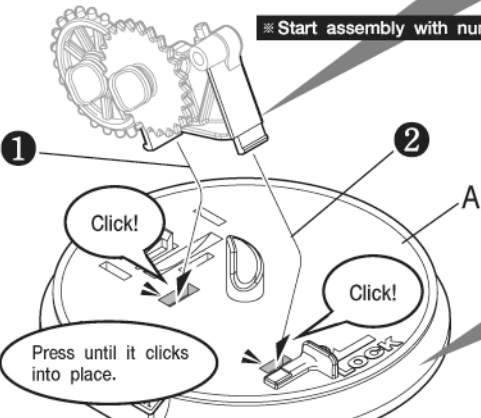

3

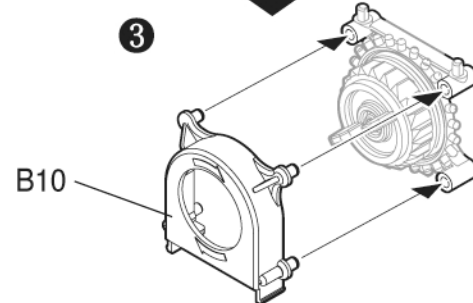

3

A11

1

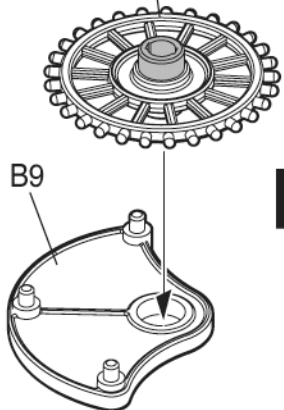

2

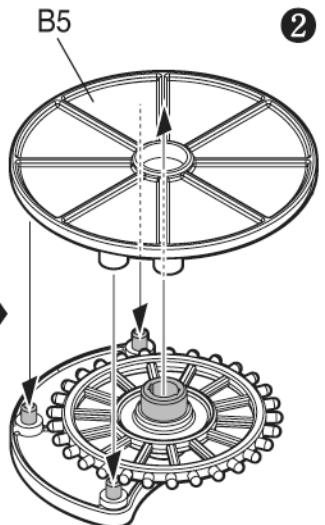

※ Note the direction.

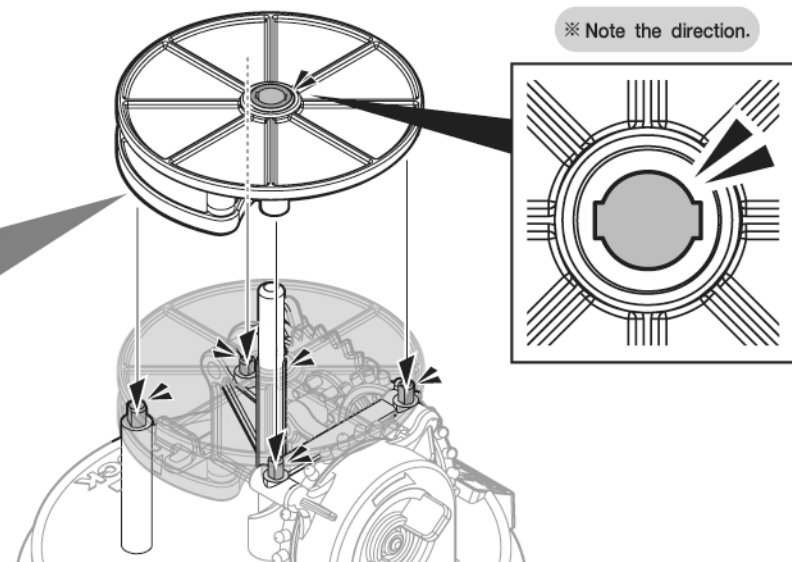

4

※ Tight fit

B7

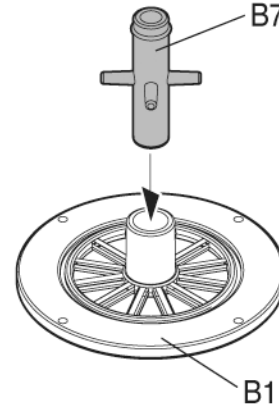

B1

1

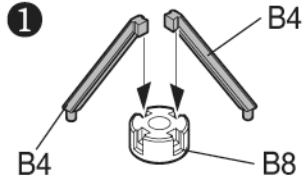

2

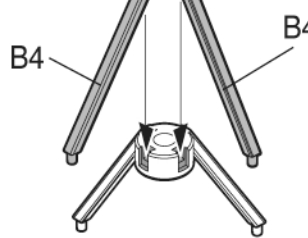

B4

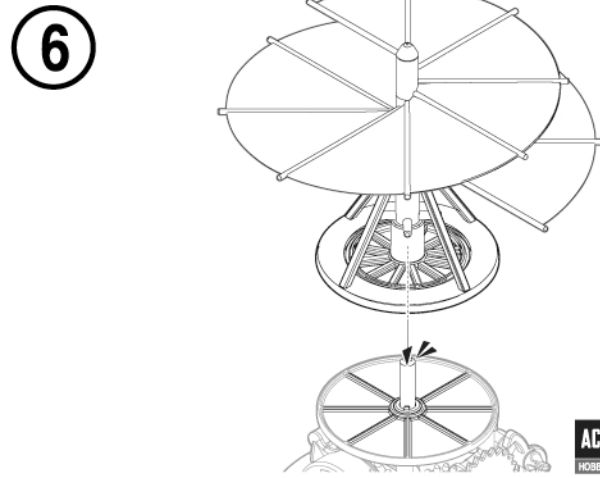
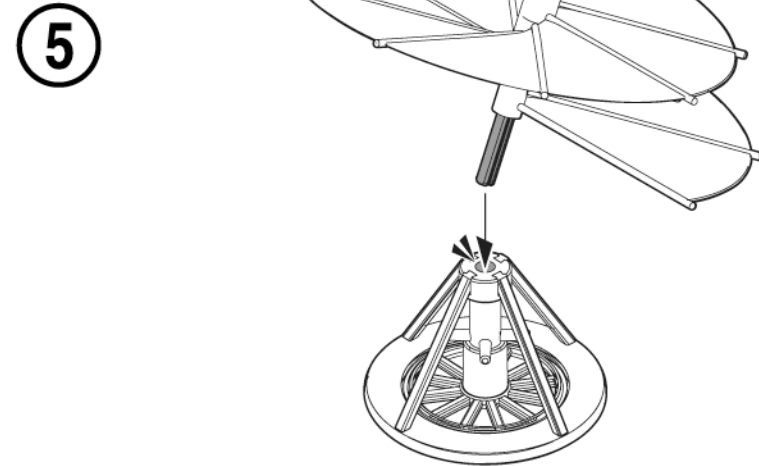
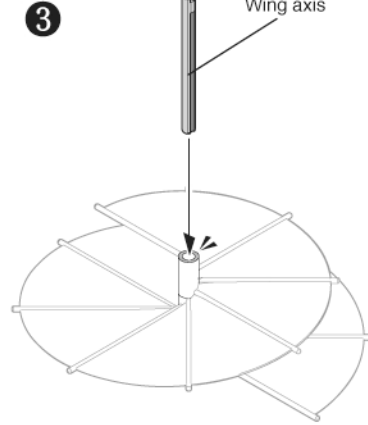
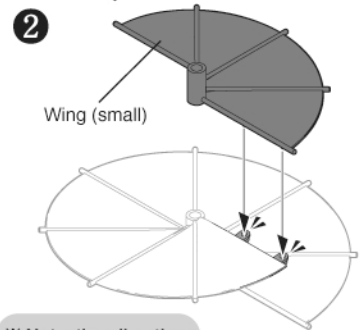
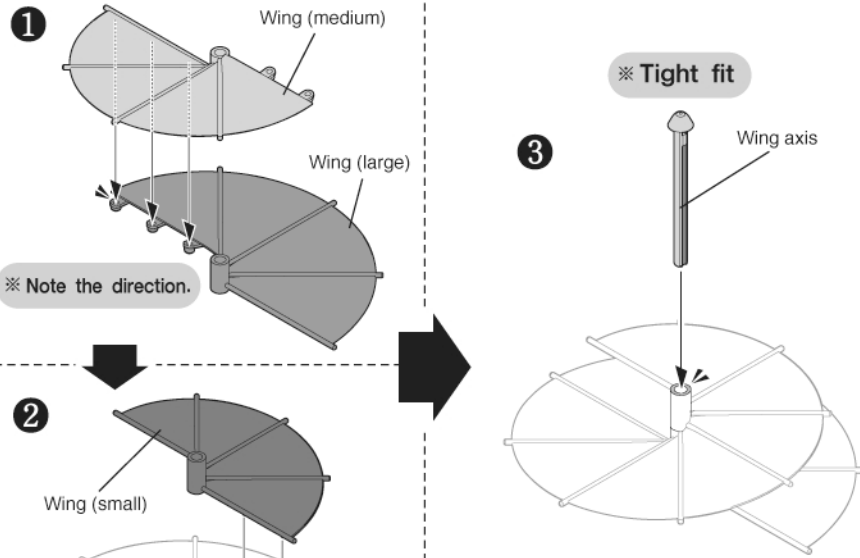

### How to operate the helicopter

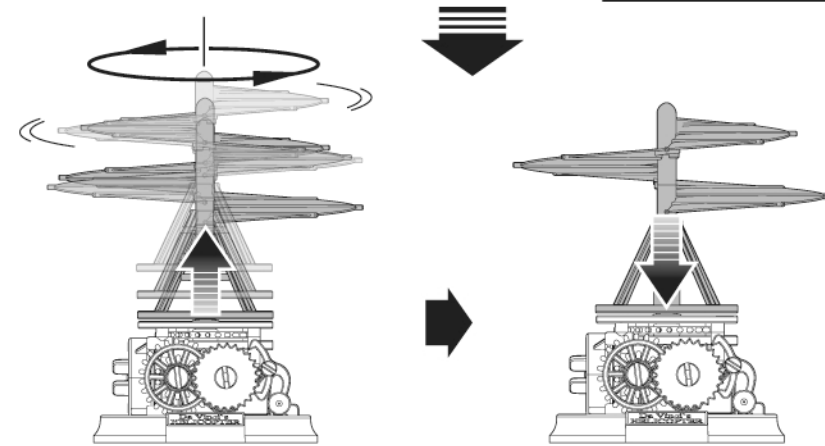
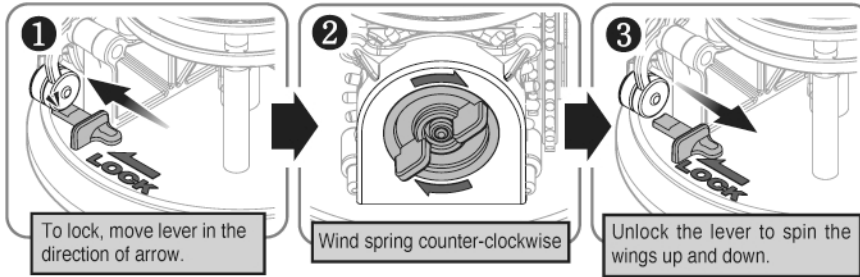

When it spins, the wing gradually rides up and down.

As it spins, it will continually move up and down.

**ACADEMY**  
HOBBY MODEL KITS  
18159

# da Vinci Helicopters

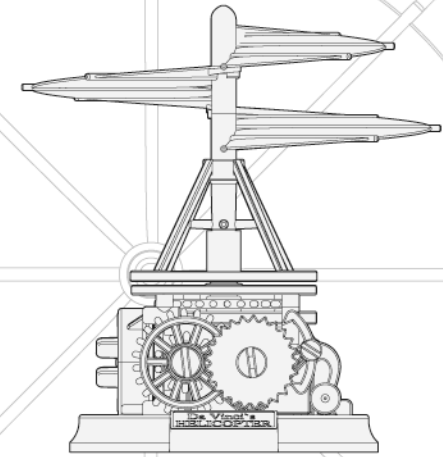

This helical design is based on a 1480's drawing by Leonardo da Vinci. Operation of the rotor wings could be powered by a pilot using his arms and legs. During takeoff, today's helicopters use a similar vertical rotation concept. It demonstrates a combination of natural and mechanical movements. A mechanical spring controls rotation and vertical movement of the wings.

#### Considerations:

- The kit is a replica of da Vinci's Aerial Screw design, a forerunner of the modern helicopter.
- Structurally unable to fly, da Vinci's design stimulated curiosity about the possibility of vertical flight.
- A mechanical spring controls rotation and vertical movement of the fuselage.

### Parts location diagram

